

- NOTES:
- PLEASE CONTACT TRAFFIC SIGNAL SECTION FOR PROPOSED DETECTOR LOOP DESIGN AT 815-434-8505 IF ANY OTHER LOOPS ARE DAMAGED.
 - 6' X 20' TYPICAL DETECTOR LOOPS WITH 6' SPACING 10' FROM PROJECTED EDGE LINE OR STOP BAR AS NOTED.
 - 4 TURNS REQUIRED ON ALL DETECTOR LOOPS.
 - DETECTOR LOOPS SHALL BE INSTALLED IN THE MILLED SURFACE PRIOR TO RESURFACING.
 - SAW CUT EXISTING LOOP TO BE ABANDONED

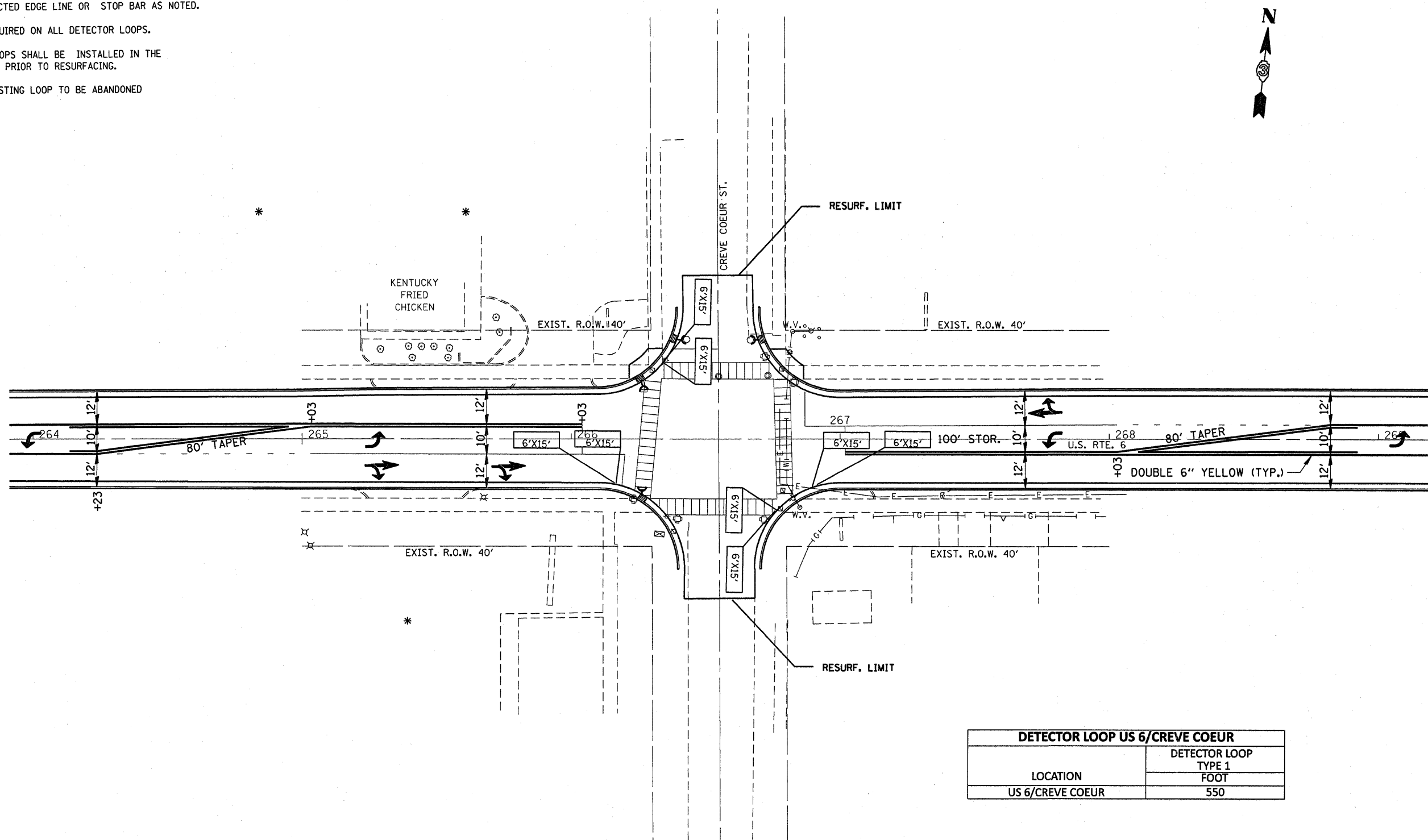

DETECTOR LOOP US 6/CREVE COEUR	
LOCATION	DETECTOR LOOP TYPE 1
US 6/CREVE COEUR	FOOT
	550

FILE NAME =	USER NAME = braboygo	DESIGNED -	REVISED -	STATE OF ILLINOIS DEPARTMENT OF TRANSPORTATION	DETECTOR LOOPS CREVE COEUR	F.A.P. RTE.	SECTION	COUNTY	TOTAL SHEETS	SHEET NO.	
c:\pwork\pwork\braboygo\08173862\d366\10-sht-details.dgn	PLOT SCALE = 50.0000' / IN.	DRAWN -	REVISED -			623	17RS-3; 33RS-5; (34)RS	•	55	46	
PLOT DATE = Feb 10, 2011 - 02:49:35 PM	DATE -	CHECKED -	REVISED -			CONTRACT NO. 66A10		ILLINOIS FED. AID PROJECT • BUREAU/LASALLE			
						SCALE:	SHEET NO. OF SHEETS	STA.	TO STA.		