

- LEGEND**
- TEMPORARY TRAFFIC SIGNAL
 - ▨ AREA OF CONSTRUCTION
 - ➔ DIRECTION OF TRAFFIC
 - ▩ PAVEMENT WIDENING
 - TEMPORARY CONCRETE BARRIER
 - ⊠ IMPACT ATTENUATOR
 - ▤ GEOTEXTILE RETAINING WALL
 - PEDESTRIAN PUSH BUTTON

PROP. CURVE IL61A
 PI STA. = 768+27.01
 $\Delta = 22^\circ 28' 00''$ (LT)
 $D = 3^\circ 08' 00''$
 $R = 1,828.59'$
 $T = 363.18'$
 $L = 717.02'$
 $E = 35.72'$
 $e = 5.6\%$
 $T.R. = 40'$
 $S.E. RUN = 149'$
 BEGIN SE TRANSITION AT STA. 763+25
 BEGIN FULL SE AT STA. 765+14
 END FULL SE AT STA. 771+31
 END SE TRANSITION AT STA. 773+20
 P.C. STA. = 764+63.83
 P.T. STA. = 771+80.85

- NOTES:**
- SUBGRADE PREPARATION REQUIRED FOR IMPACT ATTENUATOR AT STA. 771+00, LT. COST INCLUDED IN IMPACT ATTENUATOR, TEMPORARY (FULLY REDIRECTIVE, NARROW), TEST LEVEL 3.
 - INSTALL SOLAR-POWERED YELLOW FLASHING BEACON ON SIGAL AHEAD SIGN FOR SOUTHBOUND IL 61.

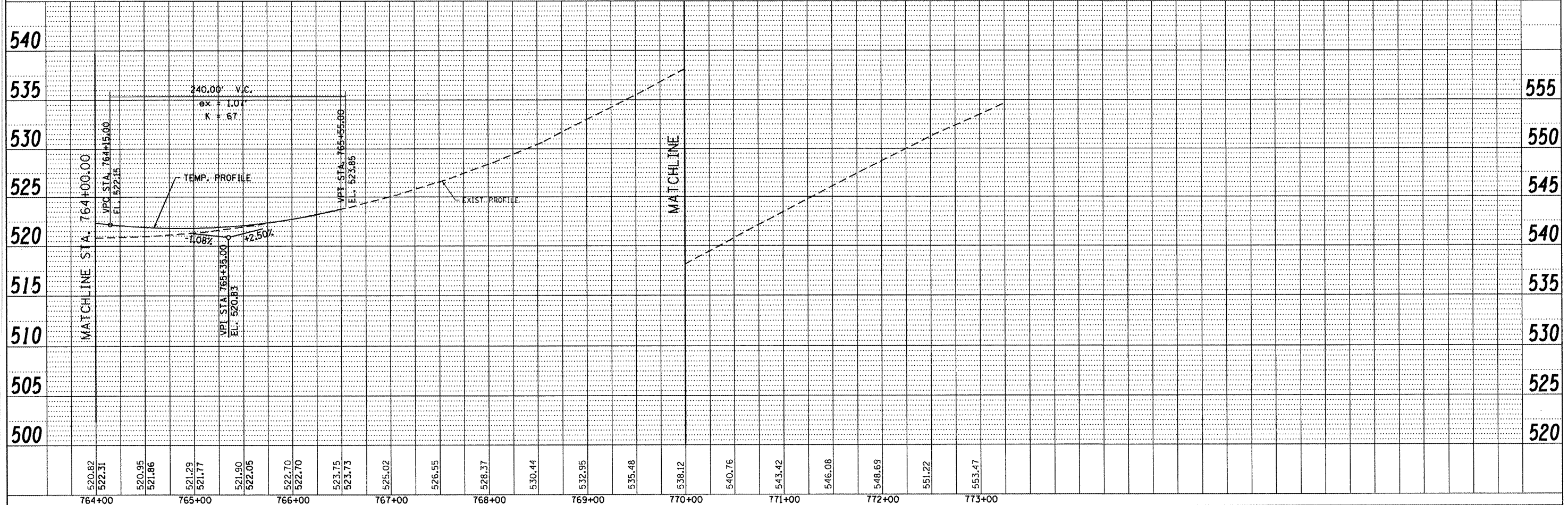

USER NAME = g.jameson	DESIGNED -	REVISED -	7018 KINGSMILL CT., SPRINGFIELD, IL (217) 483-9457 DESIGN FIRM #184001036	STATE OF ILLINOIS DEPARTMENT OF TRANSPORTATION	TRAFFIC CONTROL PLANS - STAGE II IL 61 OVER LAMOINE RIVER		P.A. RTE. 542	SECTION 105BR-1	COUNTY McDONOUGH	TOTAL SHEETS 117	SHEET NO. 36		
FILE NAME = D468482-stage 2	CHECKED -	REVISED -			SCALE: 1" = 50'	SHEET NO. 2 OF 2 SHEETS	STA. 764+00.00 TO STA. 773+25.00	CONTRACT NO. 68482					
PLOT DATE = 12/21/2010	DRAWN -	REVISED -			ILLINOIS FED. AID PROJECT								
PLOT TIME = 10:28:20 AM	CHECKED -	REVISED -											