

# LOCATION MAP 7 – PIATT COUNTY

## FAP 741 ( IL 105 ) FROM SO. OF BEMENT TO SO. OF CERRO GORDO

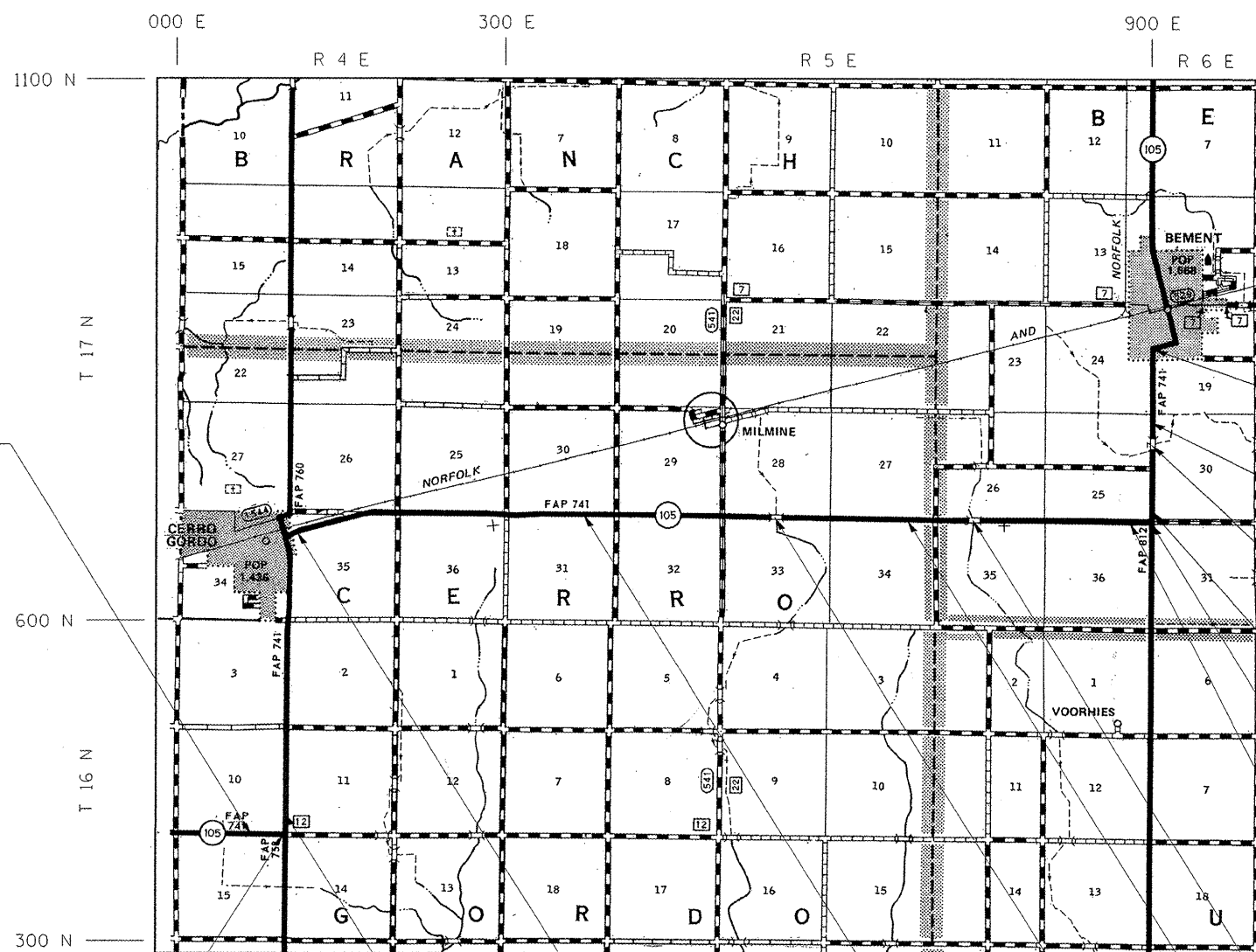

END PROJECT  
STA. 56+95.70

BEGIN PROJECT  
STA. 383+70.00

STATION EQUATION  
422+17.30(BK)=420+82.30(AH)

BRIDGE OMISSION-SN 074-0030  
STA. 422+76.00 TO STA. 423+44.00

STATION EQUATION  
459+00.00(BK)=510+00.00(AH)

STATION EQUATION  
513+06.20(BK)=460+72.10(AH)

STATION EQUATION  
468+80.20(BK)=470+11.01(AH)

STATION EQUATION  
890+88.40(BK)=  
890+86.10(AH)

BRIDGE OMISSION-SN 074-0080  
STA. 550+02.50 TO STA. 550+83.50

BRIDGE - SN 074-8030 / SN 074-8061  
STA. 579+42.55 TO STA. 580+05.46

BRIDGE OMISSION-SN 074-0079  
STA. 645+94.25 TO STA. 646+85.75

GROSS LENGTH OF LOCATION #7 = 66396.49 FT. = 12.575 MILE  
NET LENGTH OF LOCATION #7 = 66155.99 FT. = 12.530 MILE

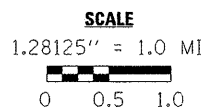

STATION EQUATION  
270+36.69 (BK)  
50+00.00 (AH) IL 105 (W)

STATION EQUATION  
1032+44.30(BK)=  
277+12.59(AH)

STATION EQUATION  
738+10.00(BK)=  
738+00.00(AH)

- D5 CRACK & JOINT SEAL 2011-1
- \*\* MCLEAN, DEWITT, & PIATT

FILE NAME =	USER NAME = bucklesjj	DESIGNED -	REVISED -	<b>STATE OF ILLINOIS DEPARTMENT OF TRANSPORTATION</b>	<b>LOCATION MAP #7</b>			F.A. RTE.	SECTION	COUNTY	TOTAL SHEETS	SHEET NO.
ei:\pwwork\pwwork\bucklesjj\d0252724\05	08880-shr\cover.dgn	DRAWN -	REVISED -		SCALE:	SHEET NO. 1 OF 1 SHEETS	STA. 383+70.00 TO STA. 56+95.70	VAR.	.	**	33	9
	PLOT SCALE = 40.0000 / IN.	CHECKED -	REVISED -								CONTRACT NO. 70880	
	PLOT DATE = 2/3/2011	DATE -	REVISED -								ILLINOIS FED. AID PROJECT	