

F.A.P. RTE.	SECTION	COUNTY	TOTAL SHEETS	SHEET NO.
	HSIP FY2011-1	MCLEAN	25	1
		ILLINOIS	CONTRACT NO. 70885	

FOR INDEX OF SHEETS, SEE SHEET NO. 2  
FOR SUMMARY OF QUANTITIES, SEE SHEET NO. 4

STATE OF ILLINOIS  
DEPARTMENT OF TRANSPORTATION  
DIVISION OF HIGHWAYS

**PROPOSED  
HIGHWAY PLANS**

FAI ROUTE 55 (I-55)  
SECTION HSIP FY2011-1  
PROJECT HSIP-055-4(175)141  
GUARDRAIL IMPACT ATTENUATORS  
MCLEAN COUNTY

C-95-071-10

STRUCTURES  
SN 057-0154 & 0155: Parapet Modification  
SN 057-0156: Crashwall vertical extension  
SN 057-0159 & 0160: Parapet Modification  
SN 057-0161: Crashwall vertical extension

D95-071-10

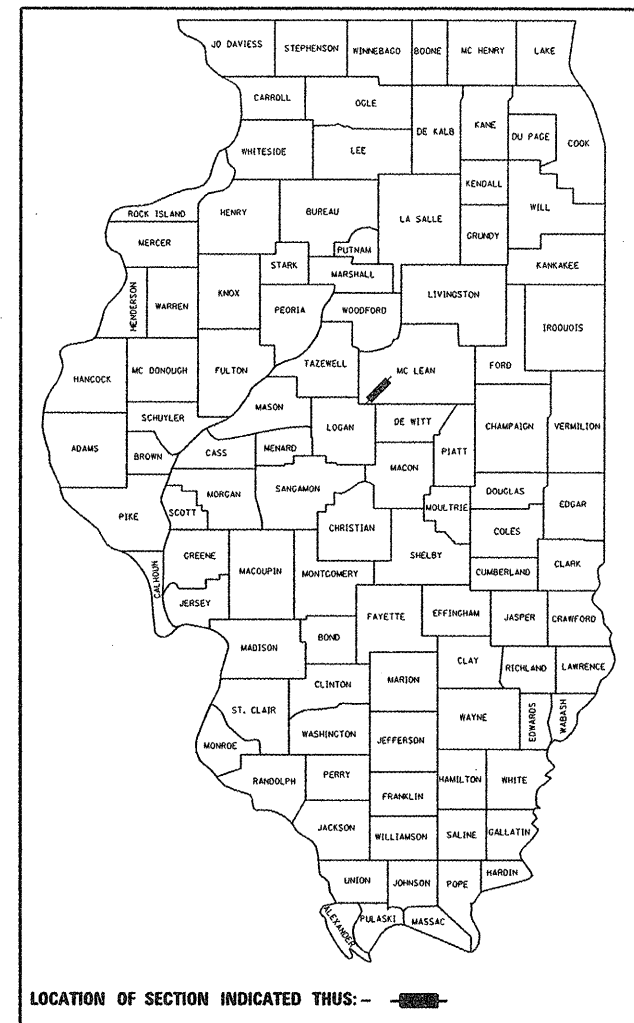

CURRENT ADT: (2009)  
**22,100**

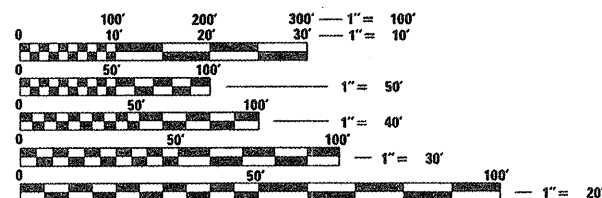

FULL SIZE PLANS HAVE BEEN PREPARED USING STANDARD ENGINEERING SCALES. REDUCED SIZED PLANS WILL NOT CONFORM TO STANDARD SCALES. IN MAKING MEASUREMENTS ON REDUCED PLANS, THE ABOVE SCALES MAY BE USED.

J.U.L.I.E.  
JOINT UTILITY LOCATION INFORMATION FOR EXCAVATION  
1-800-892-0123  
OR 811

STA. 783 + 30.73 BK =  
STA. 74 + 89.65 AH  
  
PROJECT BEGINS  
STA. 587 + 34.9

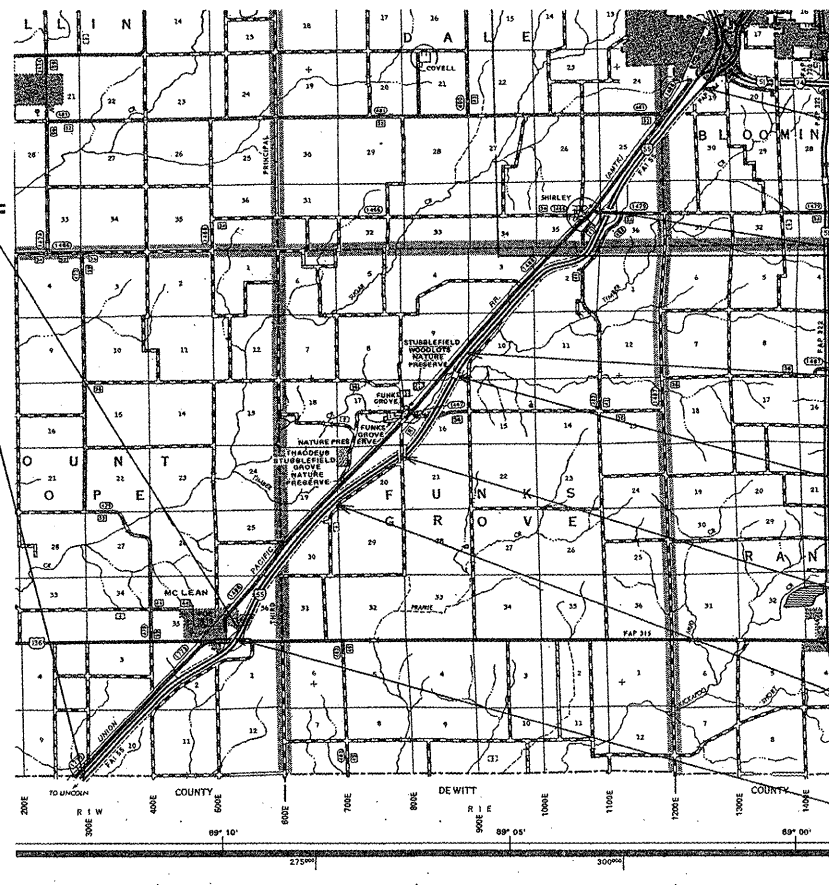

PROJECT ENDS  
STA. 590 + 00 (SB)  
  
SN 057-0161  
STA. 518 + 69.93  
  
STA. 381 + 37.19 BK =  
STA. 376 + 50.00 AH  
  
SN 057-0159/0160  
STA. 342 + 00.00  
  
SN 057-0156  
STA. 255 + 02.78  
  
STA. 252 + 74.34 BK =  
STA. 252 + 87.76 AH  
  
SN 057-0154/0155  
STA. 753 + 54.41

GROSS LENGTH = 71,579.95 FT. = 13.557 MILE  
NET LENGTH = 71,579.95 FT. = 13.557 MILE



PROJECT ENGINEER KEVIN TRAPP 217-466-7305  
PROJECT MANAGER MICHAEL LEROY 217-466-7228

CONTRACT NO. 70885

STATE OF ILLINOIS  
DEPARTMENT OF TRANSPORTATION  
DIVISION OF HIGHWAYS  
SUBMITTED 1/25 20 11  
Justin K. Cowan  
DEPUTY DIRECTOR OF HIGHWAYS, REGION ENGINEER  
Mauchas 20 11  
Saule E. Stitt P.E. Jr.  
acting ENGINEER OF DESIGN AND ENVIRONMENT  
Mauchas 20 11  
Christine M. Reedler  
DIRECTOR OF HIGHWAYS, CHIEF ENGINEER

PRINTED BY THE AUTHORITY  
OF THE STATE OF ILLINOIS