

PROP. CURVE BIKE01
 PI STA. = 0+51.60
 $\Delta = 28^\circ 56' 09''$ (RT)
 $D = 28^\circ 38' 52''$
 $R = 200.00'$
 $T = 51.60'$
 $L = 101.01'$
 $E = 6.55'$
 $e = N/A$
 $T.R. = N/A$
 $S.E. RUN = N/A$
 $P.C. STA. = 0+00.00$
 $P.T. STA. = 1+01.01$

PROP. CURVE BIKE02
 PI STA. = 1+28.69
 $\Delta = 49^\circ 32' 01''$ (LT)
 $D = 95^\circ 29' 35''$
 $R = 60.00'$
 $T = 27.68'$
 $L = 51.87'$
 $E = 6.08'$
 $e = N/A$
 $T.R. = N/A$
 $S.E. RUN = N/A$
 $P.C. STA. = 1+01.01$
 $P.T. STA. = 1+52.88$

PROP. CURVE BIKE03
 PI STA. = 2+30.72
 $\Delta = 36^\circ 40' 02''$ (RT)
 $D = 114^\circ 35' 30''$
 $R = 50.00'$
 $T = 16.57'$
 $L = 32.00'$
 $E = 2.67'$
 $e = N/A$
 $T.R. = N/A$
 $S.E. RUN = N/A$
 $P.C. STA. = 2+14.15$
 $P.T. STA. = 2+46.15$



PLAN	SURVEYED	DATE
NOTE BOOK	PLOTTED	
NO.	CHECKED	
	AT 100% CHECKED	
	FILE NAME	

PROFILE	SURVEYED	DATE
NOTE BOOK	GRADES CHECKED	
NO.	STRUCTURE NOTATIONS CHKD	

PROPOSED BIKE TRAIL RELOCATION

PRAIRIE DUPONT CANAL

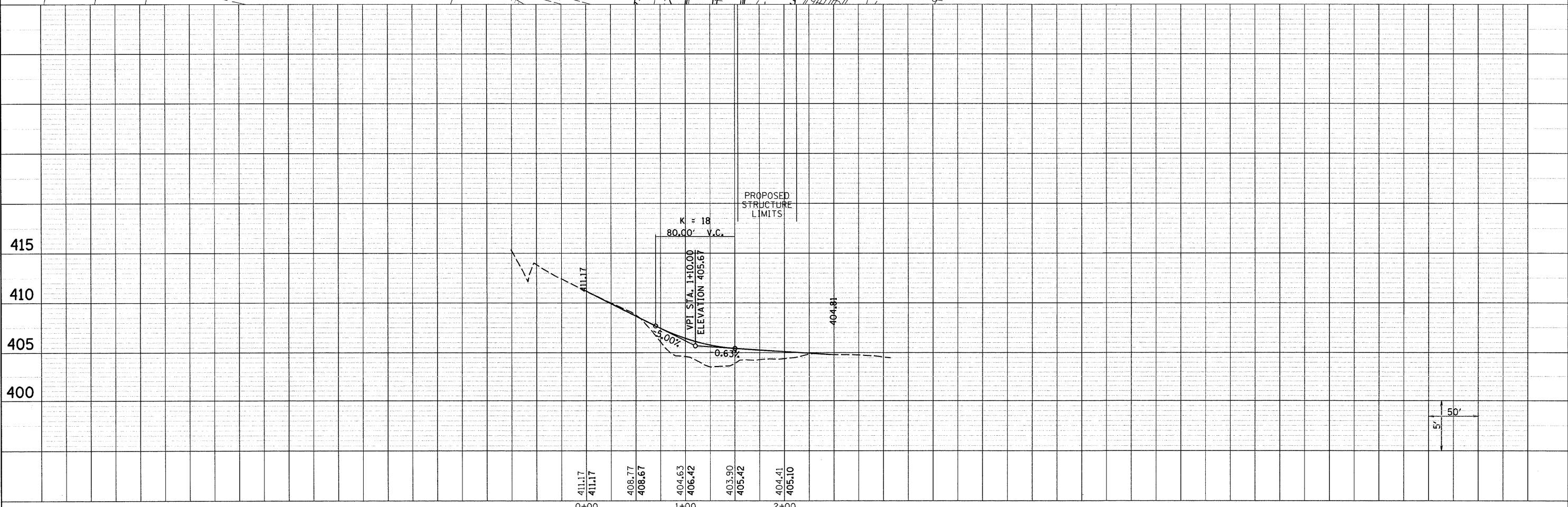
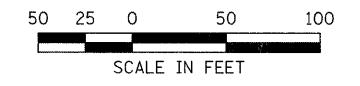

LAST SAVED = 8/3/2010
 PEN TABLE = V8-H617.tbl
 PLOT DRIVER = TR-V8pdf-Block.plt

FILE NAME =	USER NAME = berichmann	DESIGNED -	REVISED -	STATE OF ILLINOIS DEPARTMENT OF TRANSPORTATION	BIKE TRAIL PLAN & PROFILE	F.A.P. RTE.	SECTION	COUNTY	TOTAL SHEETS	SHEET NO.
1:\07078\cad\vt\plans\011-0876882-Sht-Plan-Profile-BikeTrail.dgn	DRAWN -	REVISED -	312			64-IVBR	ST CLAIR	259	22	
PLOT SCALE = 50.0023 ' / IN.	CHECKED -	REVISED -	CONTRACT NO. 76882							
PLOT DATE = 8/9/2010 10:21:48 AM	DATE -	REVISED -	FED. ROAD DIST. NO. ILLINOIS FED. AID PROJECT							
SCALE: 1" = 50' SHEET NO. 1 OF 1 SHEETS STA. 0+00.00 TO STA. 2+46.15										