

NOTES:
 DOTTED LINES SHALL CONSIST OF 2' LINE SEGMENTS WITH 6' GAP.
 RAISED REFLECTIVE PAVEMENT MARKERS SHALL BE INSTALLED ON ALL SKIP DASH CENTERLINES ACCORDING TO STD. 781001. SPACE AT 80' CENTERS STA. 272+00 TO STA. 286+39.5 AND 40' CENTERS STA. 286+39.5 TO STA. 292+01.38
 PRISMATIC CURB REFLECTORS SHALL BE INSTALLED ON EACH SIDE OF THE PROPOSED MEDIAN AT 40' CENTERS FROM STA. 275+95 TO STA. 291+95.
 THE TOP AND FACE OF CURB OF THE CONCRETE MEDIAN, TYPE SB SHALL BE PAINTED FROM STA. 286+39.50 TO STA. 292+01.38 IN ACCORDANCE WITH SECTION 780 OF THE STANDARD SPECIFICATIONS.
 THE TOP AND FACE OF THE CONCRETE MEDIAN FROM STA. 275+90.50 TO STA. 286+39.50 SHALL BE PAINTED ACCORDING TO THE SPECIAL PROVISION FOR PAINTING CONCRETE MEDIAN, SUPERSTRUCTURE.

MATCH LINE STA 282+00.00

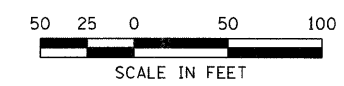
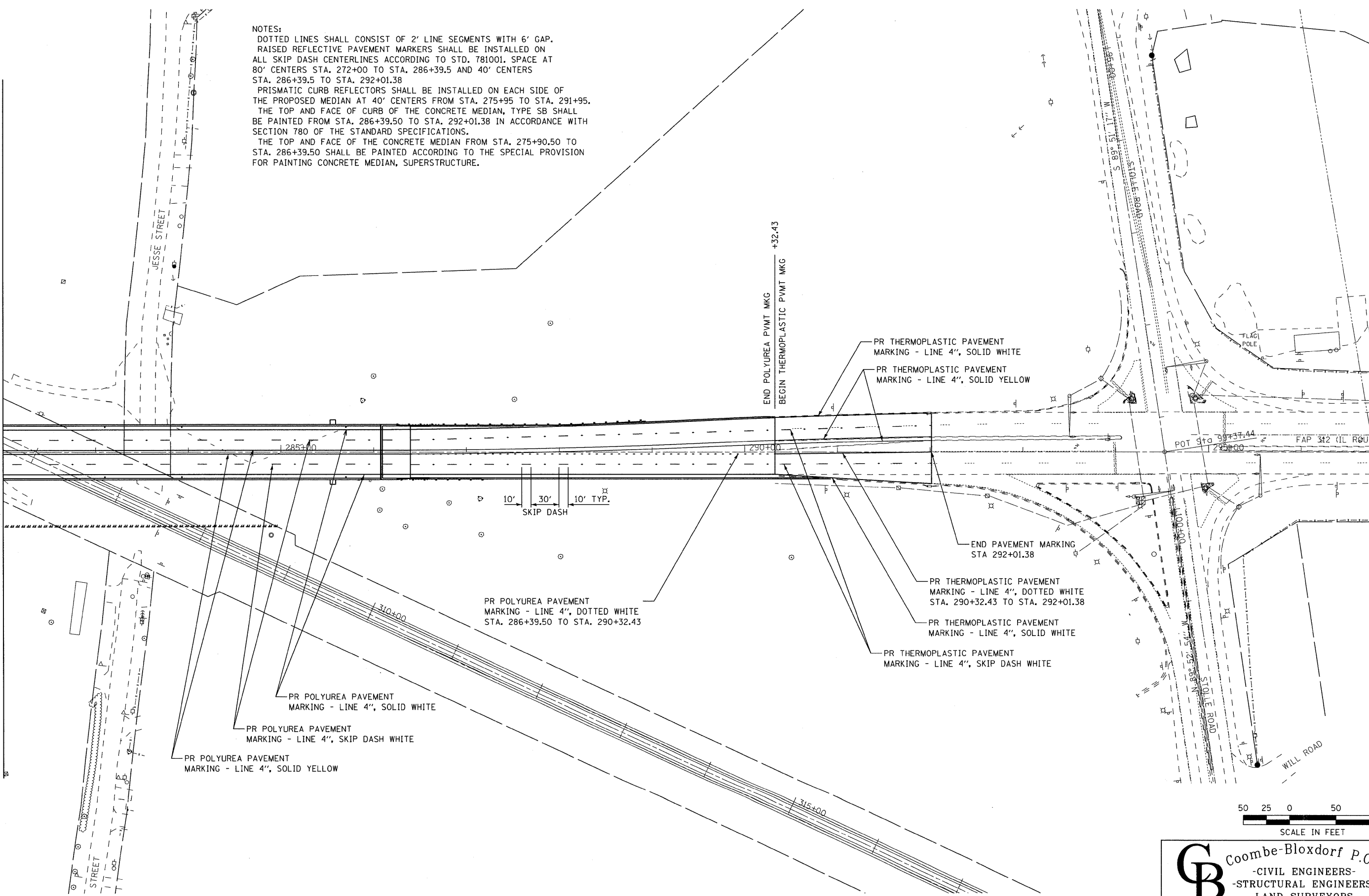

CB Coombe-Bloxdorf P.C.
 - CIVIL ENGINEERS -
 - STRUCTURAL ENGINEERS -
 - LAND SURVEYORS -
 Design Firm License No. 184-002703

FILE NAME = ...\\045-D876882-Sht-PMK-P1an-IL3-02.dgn

USER NAME = CFC...
 PLOT SCALE = 50.000000' / IN.
 PLOT DATE = 8/5/2018

DESIGNED -
 DRAWN -
 CHECKED -
 DATE -

REVISED -
 REVISED -
 REVISED -
 REVISED -

STATE OF ILLINOIS
 DEPARTMENT OF TRANSPORTATION

IL 3 PAVEMENT MARKING PLAN

SCALE: 1" = 50' SHEET NO. 2 OF 2 SHEETS STA. 282+00.00 TO STA. 296+00.00

F.A.P. RTE.	SECTION	COUNTY	TOTAL SHEETS	SHEET NO.
312	64-1VBR	ST. CLAIR	259	45
FED. ROAD DIST. NO.			ILLINOIS FED. AID PROJECT	
			CONTRACT NO. 76882	