

SEE DETAIL SHEET NO. 60 & 61 FOR SIDEROAD AND ENTRANCE TRANSITIONS.

EXIST. CURVE C2
 PI STA. = 480+71.78
 $\Delta = 18^\circ 25' 07''$ (LT)
 D = $1^\circ 29' 39''$
 R = 3,834.59'
 T = 621.71'
 L = 1,232.70'
 E = 50.07'
 e = -----
 T.R. = -----
 S.E. RUN = -----
 P.C. STA. = 474+50.07
 P.T. STA. = 486+82.76

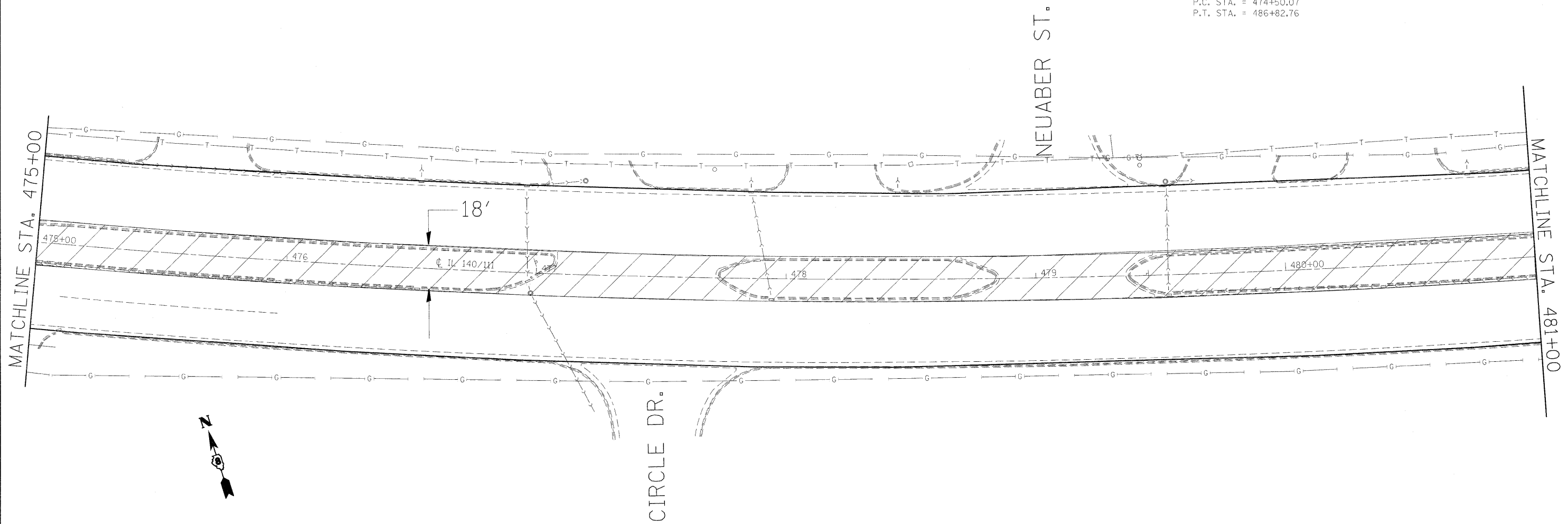
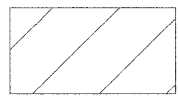

REMOVAL
 CURB, MEDIAN, & PAVEMENT REMOVAL
 PROPOSED
 PCC PAVEMENT 10" (JOINTED)
 4" AGGREGATE SUBBASE

FILE NAME =	USER NAME = #USER#	DESIGNED -	REVISED -	STATE OF ILLINOIS DEPARTMENT OF TRANSPORTATION	PLAN SHEET	F.A.P. RTE.	SECTION	COUNTY	TOTAL SHEETS	SHEET NO.	
#FILE#		DRAWN -	REVISED -			785	(132-2,3,4, 133-1RS)	MADISON	122	48	
PLOT SCALE = #SCALE#		CHECKED -	REVISED -			CONTRACT NO. 76B80					
PLOT DATE = #DATE#		DATE -	REVISED -			FED. ROAD DIST. NO. [ILLINOIS] FED. AID PROJECT					
				SCALE: _____ SHEET NO. ___ OF ___ SHEETS STA. _____ TO STA. _____							