

DETECTOR LOOP REQUIREMENTS AND CALCULATIONS

| LOOP | LOOP SIZE(FT) | REQUIRED # OF TURNS | CALCULATED INDUCTANCE MICROHENRIES (μH) | CALCULATED RESISTANCE OHMS (Ω) |
|------------------|---------------|---------------------|--|---|
| SB THRU LN-CD | 6X50 | 3-6-3 | 835 | 2.72 |
| SB RT TURN LN-CD | 6X38 | 3-6-3 | 654 | 2.31 |
| NB LT TURN LN-CD | 6X40 | 3-6-3 | 686 | 2.42 |
| NB THRU LN-CD | 6X40 | 3-6-3 | 683 | 2.37 |
| NB RT TURN LN-CD | 6X48 | 3-6-3 | 802 | 2.58 |

THE ABOVE VALUES ARE CALCULATED OF COMBINED LOOP AND LEAD-IN INDUCTANCE AND RESISTANCE. ACTUAL MEASURED VALUES SHOULD BE WITHIN +/- 20% OF THESE VALUES.

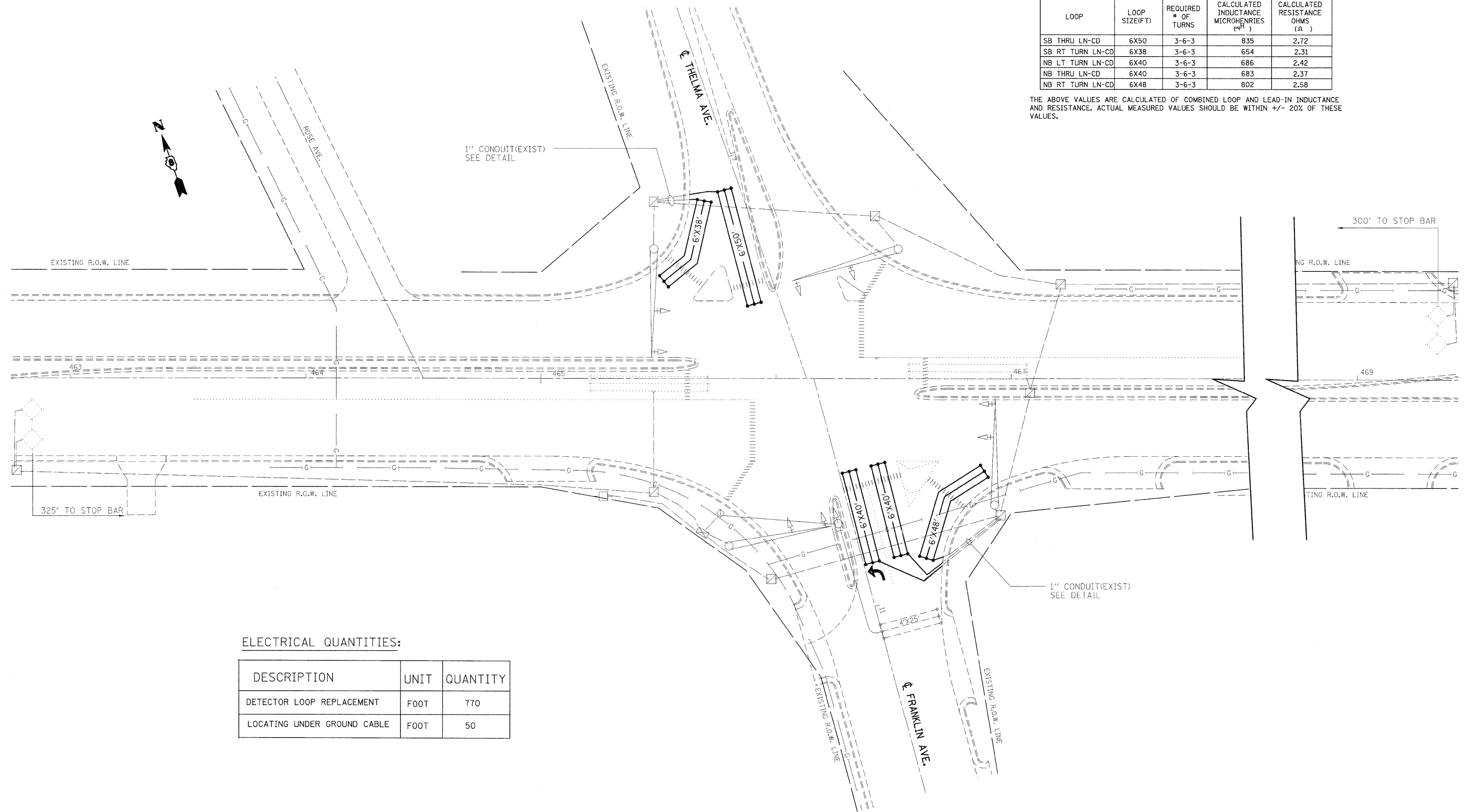

ELECTRICAL QUANTITIES:

| DESCRIPTION | UNIT | QUANTITY |
|-----------------------------|------|----------|
| DETECTOR LOOP REPLACEMENT | FOOT | 770 |
| LOCATING UNDER GROUND CABLE | FOOT | 50 |