

STATE OF ILLINOIS  
DEPARTMENT OF TRANSPORTATION  
DIVISION OF HIGHWAYS

**PROPOSED  
HIGHWAY PLANS**

F.A.I. 270 & F.A.P 785 (I-270 & IL RT 140)  
SECTION D-8 BRIDGE APPROACH 2011-1

**OVERLAY BRIDGE APPROACH  
BOND & MADISON COUNTIES**

C-98-115-10

FOR INDEX OF SHEETS, SEE SHEET NO. 2

DESIGN DESIGNATION

NA

ADT

	SN 060-0319, 0320	SN 003-0023
2009 ADT (ACTUAL) =	42,000	1,400
2011 ADT (ESTIMATED) =	42,800	1,450
2031 ADT (ESTIMATED) =	52,200	1,700
SU =	2.4%	5.0%
MU =	1.8%	5.0%
WB / EB =	53% / 47%	48% / 52%

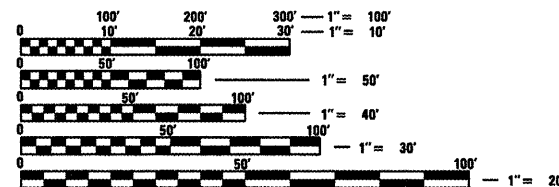

FULL SIZE PLANS HAVE BEEN PREPARED USING STANDARD ENGINEERING SCALES. REDUCED SIZED PLANS WILL NOT CONFORM TO STANDARD SCALES. IN MAKING MEASUREMENTS ON REDUCED PLANS, THE ABOVE SCALES MAY BE USED.

J.U.L.I.E.  
JOINT UTILITY LOCATION INFORMATION FOR EXCAVATION  
1-800-892-0123  
OR 811

PROJECT ENGINEER: PATTI LeBEAU (618) 346-3179  
PROJECT MANAGER: ROB HARBAUGH (618) 346-3329

CONTRACT NO. 76E22

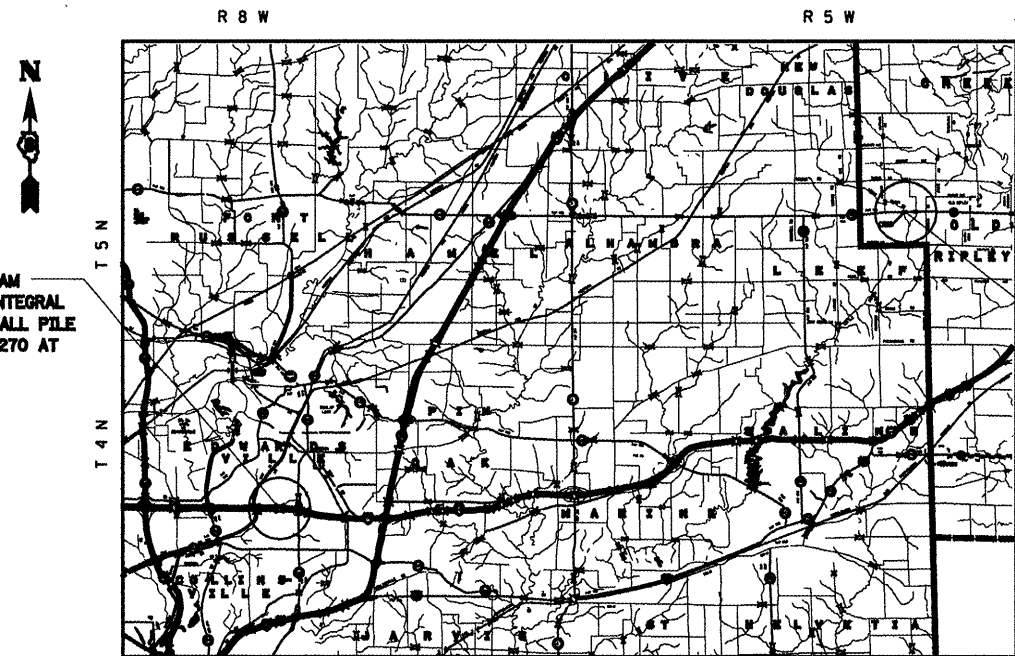

LOCATION MAP

NOT TO SCALE

TOTAL GROSS LENGTH = 1273.50 FT. = 0.241 MILE  
TOTAL NET LENGTH = 477.98 FT. = 0.091 MILE

SN 060-0319	GROSS LENGTH = 610.00 FT. = 0.116 MILE
	NET LENGTH = 287.22 FT. = 0.054 MILE
SN 060-0320	GROSS LENGTH = 513.50 FT. = 0.097 MILE
	NET LENGTH = 190.76 FT. = 0.036 MILE
SN 003-0023	GROSS LENGTH = 150.00 FT. = 0.028 MILE
	NET LENGTH = 150.00 FT. = 0.028 MILE

TWIN 4 SPAN P.P.C. I-BEAM SUPERSTRUCTURE WITH INTEGRAL ABUTMENTS AND SOLID WALL PILE BENT PIERS CARRYING I-270 AT JUDY'S BRANCH & STA 687+98.71

SN 060-0319  
LATITUDE: 38.75679°  
LONGITUDE: 89.96786°

SN 060-0320  
LATITUDE: 38.75679°  
LONGITUDE: 89.96789°

SN 003-0023

1 SPAN, 30' R.C. SLAB BRIDGE CARRYING IL 140 OVER LITTLE SILVER CREEK  
SN 003-0023  
& STA 1513+37  
LATITUDE: 38.88903°  
LONGITUDE: 89.61199°

F.A. RTE.	SECTION	COUNTY	TOTAL SHEETS	SHEET NO.
*	**	***	14	1
ILLINOIS			CONTRACT NO. 76E22	

- VARIOUS
  - D-8 BRIDGE APPROACH 2011-1
  - BOND & MADISON
- D-98-091-10

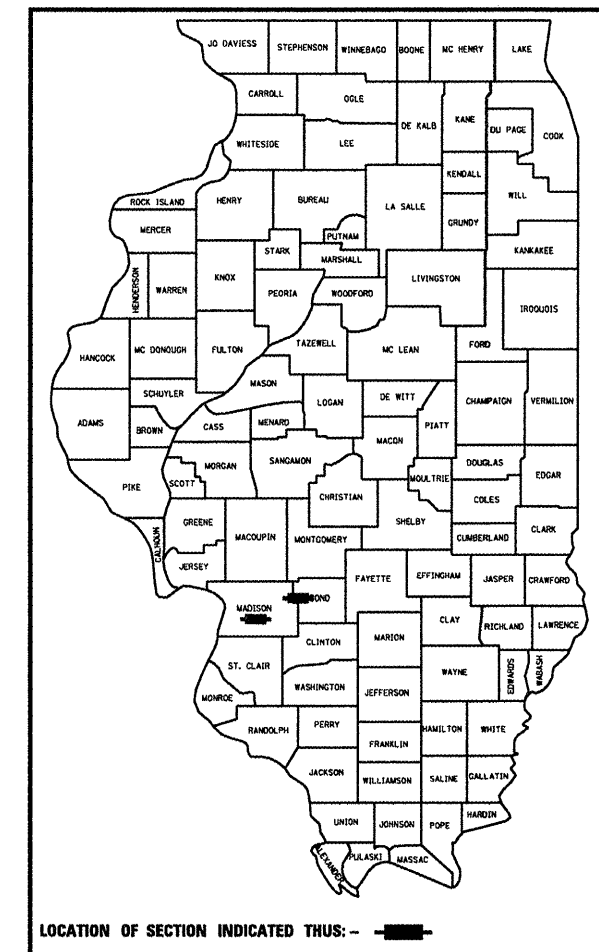

LOCATION OF SECTION INDICATED THUS: -

STATE OF ILLINOIS  
DEPARTMENT OF TRANSPORTATION  
DIVISION OF HIGHWAYS

SUBMITTED Feb 17 20 11  
M. C. Hamel  
DEPUTY DIRECTOR OF HIGHWAYS, REGION 5 ENGINEER

March 05 20 11  
Scott E. Stilt, P.E. I.A.  
ACTING ENGINEER OF DESIGN AND ENVIRONMENT

March 05 20 11  
Christine M. Reed I.A.  
DIRECTOR OF HIGHWAYS, CHIEF ENGINEER

**PRINTED BY THE AUTHORITY  
OF THE STATE OF ILLINOIS**

GENERAL NOTES

INDEX OF SHEETS

- 1 COVER SHEET
- 2 INDEX OF SHEETS, HIGHWAY STANDARDS, GENERAL NOTES, AND COMMITMENTS
- 3 SUMMARY OF QUANTITIES
- 4 LOCATION MAPS
- 5-7 TYPICAL SECTIONS
- 8-10 SCHEDULES OF QUANTITIES
- 11-14 PLAN AND PROFILE SHEETS

STANDARDS

000001-06	701311-03
001006	701400-03
630001-09	701401-06
631031-09	701406-06
635006-03	701426-04
635011-02	701901-01
701006-03	780001-02
701011-02	781001-03
701306-03	

1. THE STANDARDS AND REVISION NUMBERS LISTED SHALL APPLY TO THIS PROJECT.
2. THE CONTRACTOR SHALL VERIFY ALL DIMENSIONS AND CONDITIONS IN THE FIELD PRIOR TO CONSTRUCTION AND ORDERING MATERIALS.
3. IF ANY SECTION OR SUB-SECTION MONUMENTS ARE ENCOUNTERED, THE ENGINEER SHALL BE NOTIFIED BEFORE SUCH MONUMENTS ARE REMOVED OR RESURFACED OVER THE CONTRACTOR SHALL PROTECT AND CAREFULLY PRESERVE ALL PROPERTY MARKERS AND MONUMENTS UNTIL THE OWNER, AN AUTHORIZED SURVEYOR, OR AGENT HAS WITNESSED OR OTHERWISE REFERENCED THEIR LOCATION.
4. ILLINOIS STATE LAW REQUIRES A 48-HOUR NOTICE BE GIVEN TO ALL UTILITIES WITHIN THE PROJECT AREA BEFORE DIGGING. FIELD MARKING OF FACILITIES MAY BE OBTAINED BY CONTACTING J.U.L.I.E. OR FOR NON-MEMBERS, THE UTILITY COMPANY DIRECTLY. AGENCIES KNOWN TO HAVE FACILITIES WITHIN THE PROJECT AREA ARE AS FOLLOWS:

- ALHAMBRA-GRANTFORK TELEPHONE COMPANY (COMMUNICATIONS)
- AMERENIP (GAS & ELECTRIC)
- AT&T ILLINOIS (COMMUNICATIONS)
- CENTERPOINTS ENERGY (PIPELINE)
- CHARTER COMMUNICATIONS, INC. (COMMUNICATIONS)
- FRONTIER NORTH, INC. (COMMUNICATIONS)
- VILLAGE OF GLEN CARBON (WATER & SANITARY SEWER)
- SOUTHWESTERN ELECTRIC COOPERATIVE, INC. (ELECTRIC)
- THREE COUNTY PUBLIC WATER DISTRICT (WATER)
- LEVEL 3 COMMUNICATION (COMMUNICATIONS)

MEMBERS OF J.U.L.I.E. CALL TOLL FREE (800) 892-0123 OR 811 AND ARE INDICATED BY \*. NON-MEMBERS MUST BE NOTIFIED INDIVIDUALLY.

5. ANY AREAS DISTURBED DUE TO CONSTRUCTION ACTIVITIES SHALL BE SEEDED (TEMPORARY AND PERMANENT) AT THE CONTRACTOR'S EXPENSE AND NO OTHER COMPENSATION WILL BE PERMITTED.
6. THE THICKNESS OF HMA MIXTURES SHOWN ON THE PLANS IS THE NOMINAL THICKNESS. DEVIATIONS FROM THE NOMINAL THICKNESS WILL BE PERMITTED WHEN SUCH DEVIATIONS OCCUR DUE TO IRREGULARITIES IN THE EXISTING SURFACE OR BASE ON WHICH THE HMA MIXTURE IS PLACED.
7. AN ESTIMATED QUANTITY OF 165 TONS OF CUTTINGS IS FROM THE HOT-MIX ASPHALT SURFACE REMOVAL OPERATIONS.
8. SHORT-TERM PAVEMENT MARKING SHALL BE APPLIED TO THE MILLED, PRIMED, AND FINAL HMA SURFACE. A QUANTITY FOR TEMPORARY PAVEMENT MARKING EQUAL TO THE AMOUNT OF PERMANENT PAVEMENT MARKING HAS BEEN INCLUDED IN THE PLANS. "WORK ZONE PAVEMENT MARKING REMOVAL" SHALL BE PAID FOR THE FINAL SURFACE ONLY.
9. THE PORTABLE CHANGEABLE MESSAGE SIGNS SHALL BE PLACED AS DIRECTED BY THE ENGINEER. NO ADDITIONAL COMPENSATION SHALL BE ALLOWED FOR RELOCATION OF THESE SIGNS. THEY SHALL BE PLACED TWO WEEK PRIOR TO ANY LANE CLOSURE AND SHALL REMAIN UP FOR THE DURATION OF THE PROJECT.
10. IT SHALL BE THE CONTRACTOR'S RESPONSIBILITY TO INSURE THAT ADJACENT PAVEMENT OR APPURTENANCES ARE NOT DAMAGED DURING ANY CONSTRUCTION OPERATION.
11. ENTRANCES SHALL BE KEPT OPEN TO TRAFFIC AT ALL TIMES.
12. FLAGGERS SHALL BE PRESENT DURING ALL LANE CLOSURE HOURS INCLUDING LUNCH PERIODS. WHEN FLAGGERS ARE NOT REQUIRED, FLAGGER SIGNS MUST BE REMOVED OR COVERED. NO ADDITIONAL COMPENSATION WILL BE ALLOWED.
13. THE RE/RT SHALL RECORD THE EXISTING PAVEMENT MARKING LOCATIONS AND TYPES TO MAKE CERTAIN THAT THE PROPOSED PAVEMENT MARKINGS MATCH THE EXISTING PAVEMENT MARKINGS.
14. THE RESIDENT ENGINEER SHALL VERIFY THE EXISTANCE OF HIGHWAY LIGHTING AND/OR ITS UTILITIES WITHIN THE PROJECT LIMITS. IF HIGHWAY LIGHTING AND/OR ITS EXISTS WITHIN THE PROJECT LIMITS, AND IF THESE ITEMS REQUIRE LOCATING, THE CONTRACTOR SHALL BE DIRECTED TO DO SO ACCORDING TO SECTION 803 OF THE STANDARD SPECIFICATIONS. IF "LOCATING UNDERGROUND CABLE" IS NOT INCLUDED AS PART OF THE PLANS, THIS WORK SHALL BE PAID FOR ACCORDING TO ARTICLE 109.04 OF THE STANDARD SPECIFICATIONS.
15. PRIOR TO BEGINNING OF CONSTRUCTION, RE/RT SHALL OBTAIN ELEVATIONS TO DETERMINE EXISTING PROFILE GRADES. THESE MEASUREMENTS WILL BE USED TO DETERMINE PAY QUANTITIES FOR HMA SURFACE COURSE.

COMMITMENTS

NONE

- VARIOUS
- D-8 BRIDGE APPROACH 2011-1
- BOND & MADISON

FILE NAME = #FILE#	USER NAME = #USER#	DESIGNED -	REVISED -	<b>STATE OF ILLINOIS DEPARTMENT OF TRANSPORTATION</b>	<b>INDEX OF SHEETS, HIGHWAY STANDARDS &amp; GENERAL NOTES</b>	F.A. RTE.	SECTION	COUNTY	TOTAL SHEETS	SHEET NO.
	PLOT SCALE = #SCALE#	DRAWN -	REVISED -			*	**	***	14	2
	PLOT DATE = #DATE#	CHECKED -	REVISED -			CONTRACT NO. 76E22				
		DATE -	REVISED -			SCALE:	SHEET NO. OF SHEETS	STA. TO STA.	ILLINOIS FED. AID PROJECT	

# SUMMARY OF QUANTITIES

MADISON Co. BOND Co.

SUMMARY OF QUANTITIES			100% STATE TOTAL QUANTITIES	MADISON Co. BOND Co.		SUMMARY OF QUANTITIES			TOTAL QUANTITIES	CONSTRUCTION TYPE CODE		
CODE NO	ITEM	UNIT		URBAN 0004 060-0319, 060-0320	RURAL 0004 003-0023	CODE NO	ITEM	UNIT				
40600200	BITUMINOUS MATERIALS (PRIME COAT)	TON	1.2	1.1	0.1							
40600300	AGGREGATE (PRIME COAT)	TON	4	3.2	0.8							
40600982	HOT-MIX ASPHALT SURFACE REMOVAL - BUTT JOINT	SQ YD	206	206								
40600985	PORTLAND CEMENT CONCRETE SURFACE REMOVAL - BUTT JOINT	SQ YD	438	438								
40600990	TEMPORARY RAMP	SQ YD	124	124								
40603570	POLYMERIZED HOT-MIX ASPHALT SURFACE COURSE, MIX "E", N90	TON	209	166.5	42.5							
44000155	HOT-MIX ASPHALT SURFACE REMOVAL, 1 1/2"	SQ YD	294	59.3	234.7							
44000157	HOT-MIX ASPHALT SURFACE REMOVAL, 2"	SQ YD	1153	1153								
48101200	AGGREGATE SHOULDERS, TYPE B	TON	14	12.4	1.6							
48203100	HOT-MIX ASPHALT SHOULDERS	TON	112	112								
63301210	REMOVE AND REERECT STEEL PLATE BEAM GUARDRAIL, TYPE A	FOOT	412.5	412.5								
63302700	REMOVE AND REERECT TRAFFIC BARRIER TERMINALS, TYPE 6	EACH	8	8								
67000400	ENGINEER'S FIELD OFFICE, TYPE A	CAL MO	4	2	2							
67100100	MOBILIZATION	L SUM	1	0.7	0.3							
70100460	TRAFFIC CONTROL AND PROTECTION, STANDARD 701306	L SUM	1		1							
70100700	TRAFFIC CONTROL AND PROTECTION, STANDARD 701406	L SUM	1	1								
70100800	TRAFFIC CONTROL AND PROTECTION, STANDARD 701401	L SUM	1	1								
70106800	CHANGEABLE MESSAGE SIGN	CAL MO	6	6								
70300100	SHORT TERM PAVEMENT MARKING	FOOT	180	150.1	29.9							
70301000	WORK ZONE PAVEMENT MARKING REMOVAL	SQ FT	59.8	49.8	10							
* 78000200	THERMOPLASTIC PAVEMENT MARKING - LINE 4"	FOOT	1825	1431.2	393.8							
* 78100100	RAISED REFLECTIVE PAVEMENT MARKER	EACH	22	17	5							
* 78200410	GUARDRAIL MARKERS, TYPE A	EACH	13	13								
* 78200420	GUARDRAIL MARKERS, TYPE B	EACH	3	3								
* 78200430	GUARDRAIL MARKERS, TYPE C	EACH	3	3								
78300200	RAISED REFLECTIVE PAVEMENT MARKER REMOVAL	EACH	22	17	5							
Z0026346	NIGHTTIME WORK ZONE LIGHTING	L SUM	1	1								
Z0038114	PORTLAND CEMENT CONCRETE SURFACE REMOVAL 1/4"	SQ YD	339	339								
Z0038121	PORTLAND CEMENT CONCRETE SURFACE REMOVAL 2"	SQ YD	259	259								

\*SPECIALTY ITEM

• VARIOUS  
 •• D-8 BRIDGE APPROACH 2011-1  
 ••• BOND & MADISON



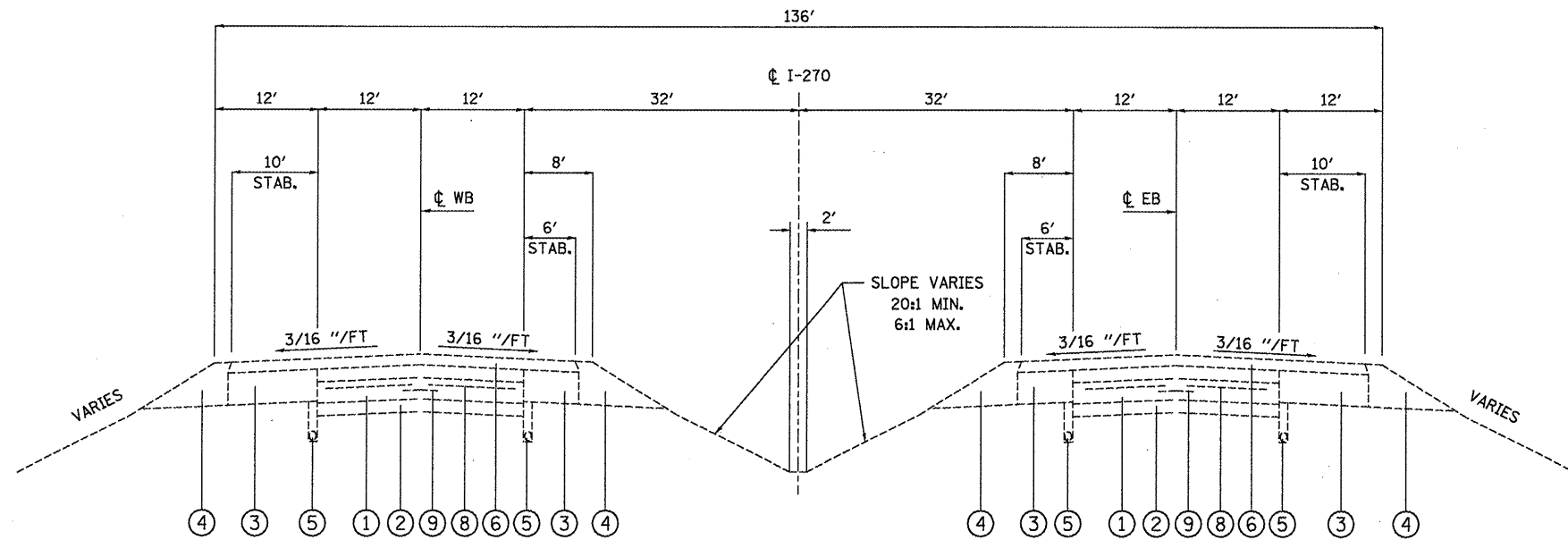

EXISTING TYPICAL SECTION

EB STA 689+96.40 TO STA 690+26.00  
WB STA 684+65.00 TO STA 685+38.28  
WB STA 690+49.51 TO STA 691+69.00

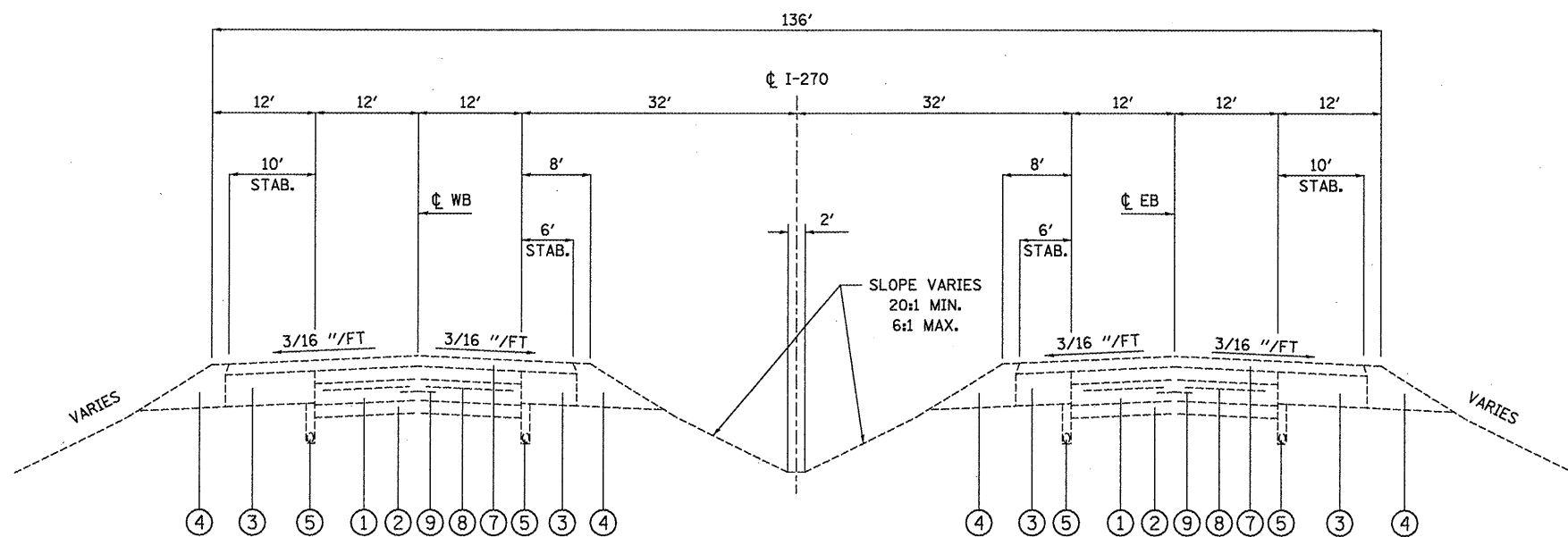

EXISTING TYPICAL SECTION

EB STA 685+12.50 TO STA 686+19.59  
EB STA 689+42.30 TO STA 689+96.40  
WB STA 685+41.83 TO STA 686+46.52  
WB STA 689+99.35 TO STA 691+69.00

MIXTURE REQUIREMENTS

MIXTURE USE	POLY SURFACE	SHOULDERS ≥ 2.25'	SHOULDERS < 2.25'
AC/PG	SBS PG 76-22	PG 64-22	PG 64-22
RAP % (MAX)	SEE SPEC.	See Contact RAP	See Contact RAP
DESIGN AIR Voids	4.0% @ Ndes=90	Special Provision	Special Provision
MIX COMPOSITION		**2.0% @ Ndes=30	**2.0% @ Ndes=30
(GRADATION MIXTURE)	IL 12.5	NMAS 3/4"	NMAS 1/2"
FRICITION AGG	MIXTURE "E"		

\*\* Top Lift SHOULDERS - DESIGN THIS MIX AT 2.0% VOIDS AND ADD ASPHALT TO REDUCE VOIDS TO 1.5%.

PLAN QUANTITIES FOR BITUMINOUS CONCRETE SURFACE COURSE ITEMS ARE CALCULATED USING A UNIT WEIGHT OF 112 LB/SQ YD/IN (59.8 KG/SQ M/25 MM THICKNESS).

LEGEND

- ① EXISTING PAVEMENT (10" JOINTED PCC)
- ② EXISTING 6" GRANULAR SUB-BASE
- ③ EXISTING HMA SHOULDERS (INSIDE DEPTH 7" - 15", OUTSIDE DEPTH 14" - 17 1/4")
- ④ EXISTING AGGREGATE SHOULDERS, TYPE B
- ⑤ EXISTING PIPE UNDERDRAIN
- ⑥ EXISTING HMA RESURFACING (8 5/8" - 10 1/4")
- ⑦ EXISTING PCC BRIDGE APPROACH PAVEMENT & PCC PAVEMENT CONNECTOR
- ⑧ EXISTING PAVEMENT FABRIC
- ⑨ EXISTING #5 DOWEL BARS @ 2'-6" CTRS
- ⑩ EXISTING P.C.C. PAVEMENT (9"-6"-9")
- ⑪ EXISTING P.C.C. WIDENING - 9"
- ⑫ EXISTING HMA SURFACING (±4")
- ⑬ EXISTING HMA SHOULDER - 6"
- ⑭ EXISTING AGGREGATE SHOULDER TYPE B (WEDGE)
- ⑮ EXISTING SLAB STRUCTURE - ±22"
- ⑯ PROPOSED PCC SURFACE REMOVAL - VARIES
- ⑰ PROPOSED HMA SURFACE REMOVAL - VARIES
- ⑱ PROPOSED POLYMERIZED HMA SURFACE COURSE - VARIES
- ⑲ PROPOSED HMA SURFACE REMOVAL - 1 1/2"
- ⑳ PROPOSED POLYMERIZED HMA SURFACE COURSE - 1 1/2"
- ㉑ PROPOSED AGGREGATE SHOULDER, TYPE B

• VARIOUS  
•• D-8 BRIDGE APPROACH 2011-1  
••• BOND & MADISON

FILE NAME = *FILEL*	USER NAME = *USER*	DESIGNED -	REVISED -	<b>STATE OF ILLINOIS DEPARTMENT OF TRANSPORTATION</b>	<b>I-270 TYPICAL SECTIONS</b>			F.A. RTE.	SECTION	COUNTY	TOTAL SHEETS	SHEET NO.
		DRAWN -	REVISED -		SCALE:	SHEET NO. 1 OF 3 SHEETS	STA.	TO STA.	•••	14	5	
		CHECKED -	REVISED -		CONTRACT NO. 76E22							
		DATE -	REVISED -		ILLINOIS FED. AID PROJECT							

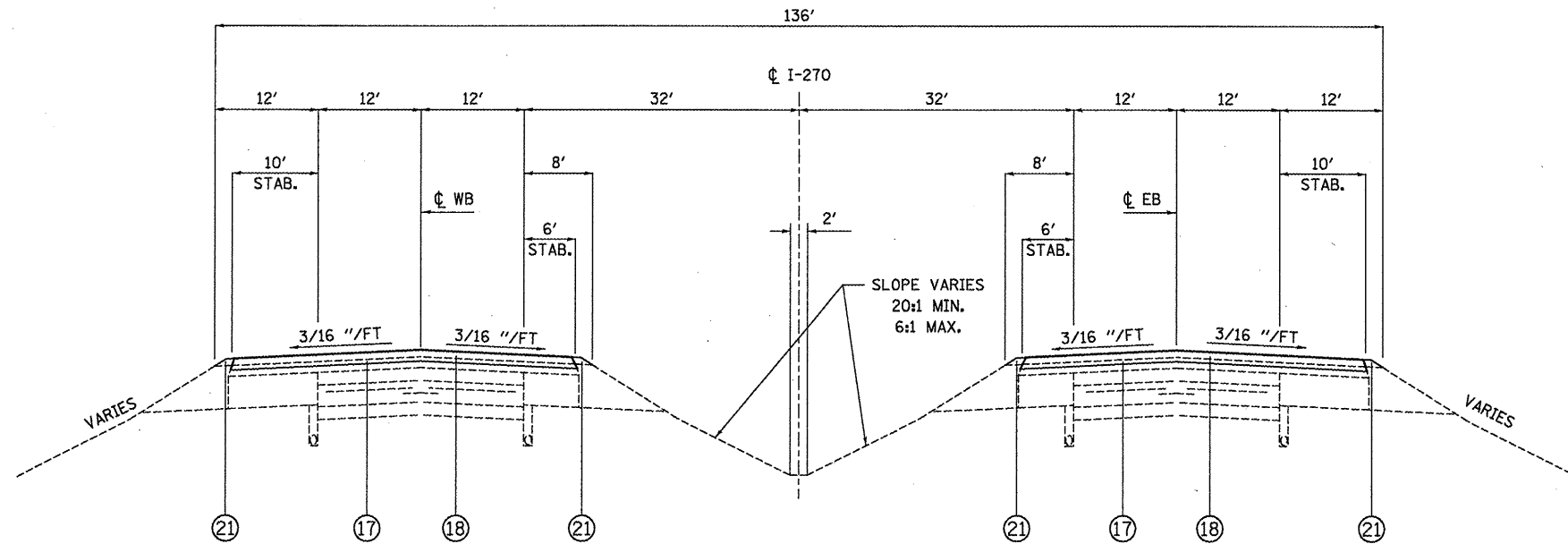

PROPOSED TYPICAL SECTION

EB STA 689+96.40 TO STA 690+26.00  
 WB STA 684+65.00 TO STA 685+38.28  
 WB STA 690+49.51 TO STA 691+69.00

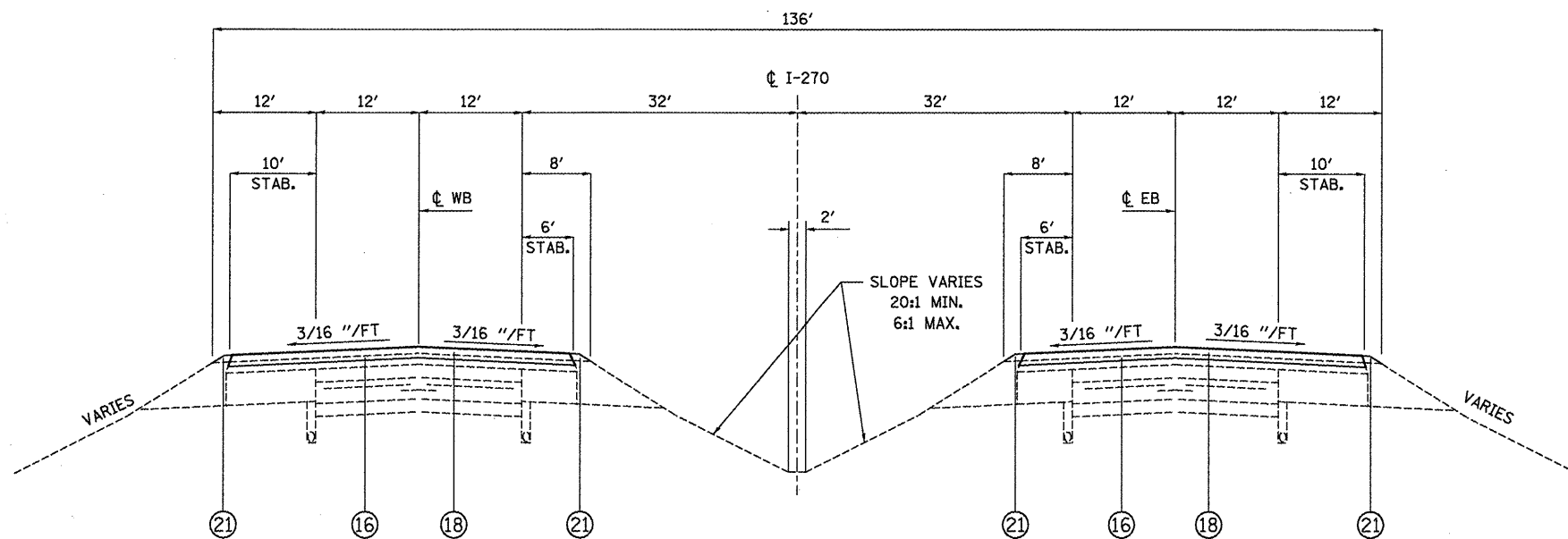

PROPOSED TYPICAL SECTION

EB STA 685+12.50 TO STA 686+19.59  
 EB STA 689+42.30 TO STA 689+96.40  
 WB STA 685+41.83 TO STA 686+46.52  
 WB STA 689+99.35 TO STA 691+69.00

LEGEND

- ① EXISTING PAVEMENT (10" JOINTED PCC)
- ② EXISTING 6" GRANULAR SUB-BASE
- ③ EXISTING HMA SHOULDERS (INSIDE DEPTH 7" - 15", OUTSIDE DEPTH 14" - 17 1/4")
- ④ EXISTING AGGREGATE SHOULDERS, TYPE B
- ⑤ EXISTING PIPE UNDERDRAIN
- ⑥ EXISTING HMA RESURFACING (8 5/8" - 10 1/4")
- ⑦ EXISTING PCC BRIDGE APPROACH PAVEMENT & PCC PAVEMENT CONNECTOR
- ⑧ EXISTING PAVEMENT FABRIC
- ⑨ EXISTING #5 DOWEL BARS @ 2'-6" CTRS
- ⑩ EXISTING P.C.C. PAVEMENT (9'-6"-9")
- ⑪ EXISTING P.C.C. WIDENING - 9"
- ⑫ EXISTING HMA SURFACING (±4")
- ⑬ EXISTING HMA SHOULDER - 6"
- ⑭ EXISTING AGGREGATE SHOULDER TYPE B (WEDGE)
- ⑮ EXISTING SLAB STRUCTURE - ±22"
- ⑯ PROPOSED PCC SURFACE REMOVAL - VARIES
- ⑰ PROPOSED HMA SURFACE REMOVAL - VARIES
- ⑱ PROPOSED POLYMERIZED HMA SURFACE COURSE - VARIES
- ⑲ PROPOSED HMA SURFACE REMOVAL - 1 1/2"
- ⑳ PROPOSED POLYMERIZED HMA SURFACE COURSE - 1 1/2"
- ㉑ PROPOSED AGGREGATE SHOULDER, TYPE B

• VARIOUS  
 •• D-8 BRIDGE APPROACH 2011-1  
 ••• BOND & MADISON

FILE NAME = #FILE#	USER NAME = #USER#	DESIGNED -	REVISED -	<b>STATE OF ILLINOIS DEPARTMENT OF TRANSPORTATION</b>	<b>I-270 TYPICAL SECTIONS</b>			F.A. RTE.	SECTION	COUNTY	TOTAL SHEETS	SHEET NO.	
	PLOT SCALE = #SCALE#	DRAWN -	REVISED -		SCALE:	SHEET NO. 2 OF 3 SHEETS	STA.	TO STA.	•	••	•••	14	6
	PLOT DATE = #DATE#	CHECKED -	REVISED -										
		DATE -	REVISED -										
CONTRACT NO. 76E22											ILLINOIS FED. AID PROJECT		

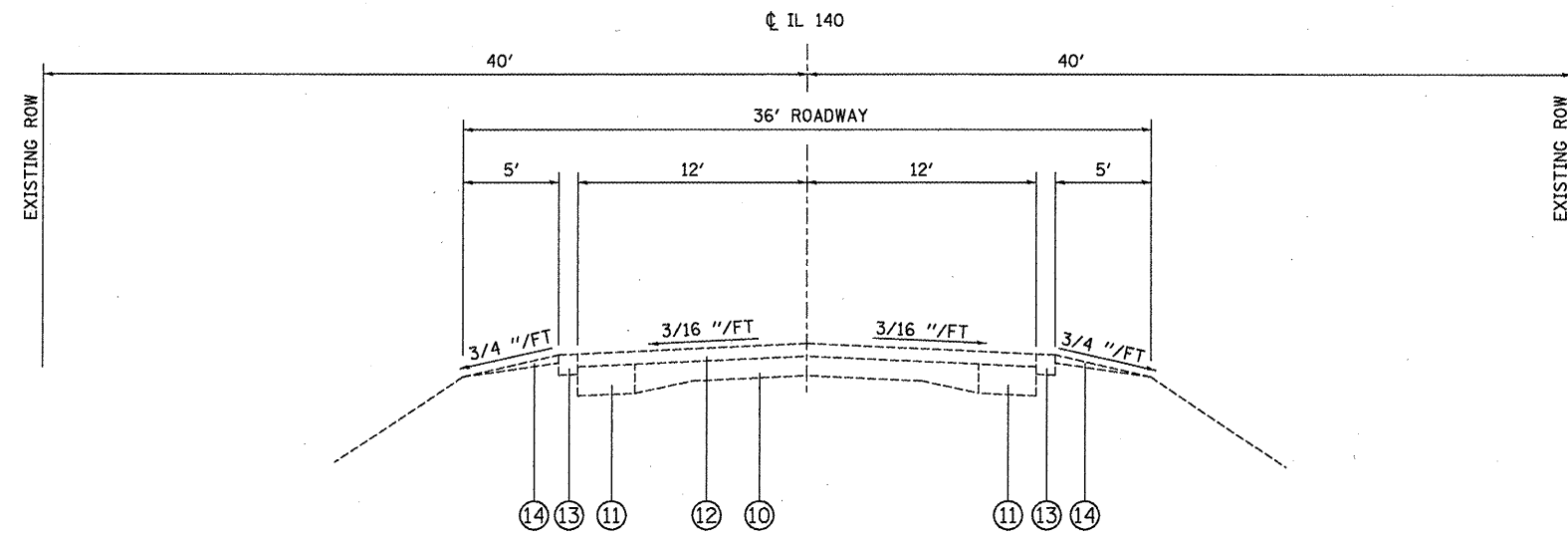

EXISTING IL 140 TYPICAL SECTION  
 STA 1512+50.00 TO STA 1513+20.71  
 STA 1513+53.35 TO STA 1514+25.00

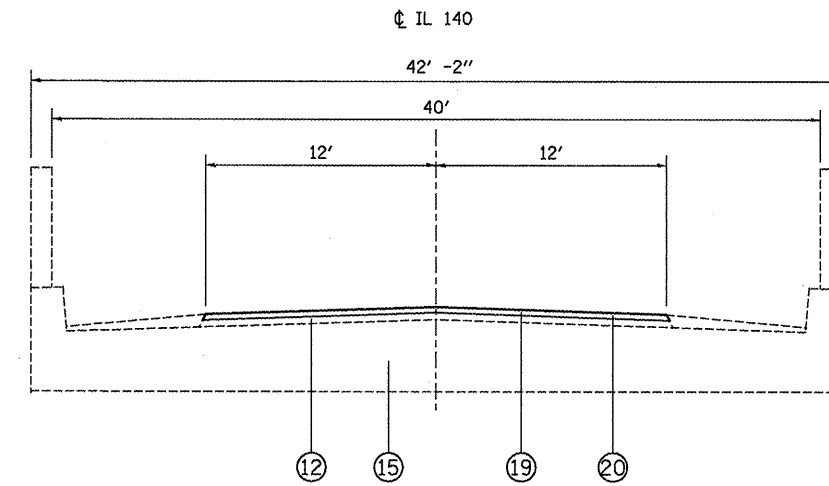

TYPICAL SECTION OVER SLAB STRUCTURE  
 STA 1513+20.71 TO STA 1513+53.35

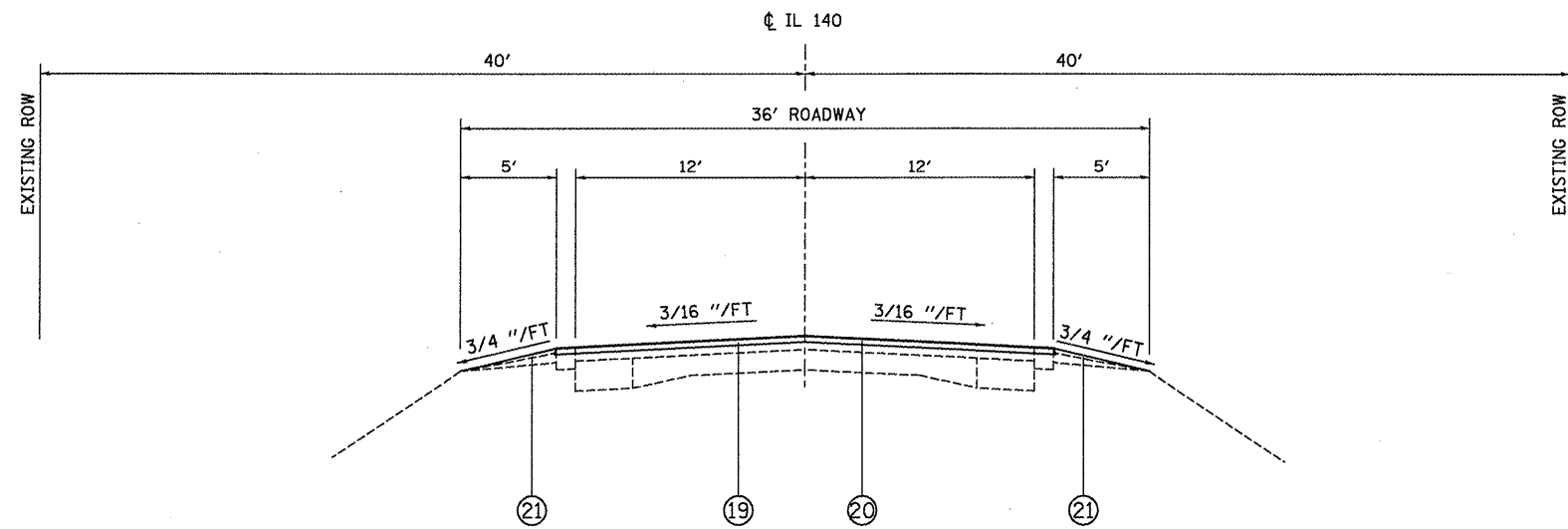

PROPOSED IL 140 TYPICAL SECTION  
 STA 1512+50.00 TO STA 1513+20.71  
 STA 1513+53.35 TO STA 1514+25.00

LEGEND

- ① EXISTING PAVEMENT (10" JOINTED PCC)
- ② EXISTING 6" GRANULAR SUB-BASE
- ③ EXISTING HMA SHOULDERS (INSIDE DEPTH 7" - 15", OUTSIDE DEPTH 14" - 17 1/4")
- ④ EXISTING AGGREGATE SHOULDERS, TYPE B
- ⑤ EXISTING PIPE UNDERDRAIN
- ⑥ EXISTING HMA RESURFACING (8 5/8" - 10 1/4")
- ⑦ EXISTING PCC BRIDGE APPROACH PAVEMENT & PCC PAVEMENT CONNECTOR
- ⑧ EXISTING PAVEMENT FABRIC
- ⑨ EXISTING #5 DOWEL BARS @ 2'-6" CTRS
- ⑩ EXISTING P.C.C. PAVEMENT (9"-6"-9")
- ⑪ EXISTING P.C.C. WIDENING - 9"
- ⑫ EXISTING HMA SURFACING (±4")
- ⑬ EXISTING HMA SHOULDER - 6"
- ⑭ EXISTING AGGREGATE SHOULDER TYPE B (WEDGE)
- ⑮ EXISTING SLAB STRUCTURE - ±22"
- ⑯ PROPOSED PCC SURFACE REMOVAL - VARIES
- ⑰ PROPOSED HMA SURFACE REMOVAL - VARIES
- ⑱ PROPOSED POLYMERIZED HMA SURFACE COURSE - VARIES
- ⑲ PROPOSED HMA SURFACE REMOVAL - 1 1/2"
- ⑳ PROPOSED POLYMERIZED HMA SURFACE COURSE - 1 1/2"
- ㉑ PROPOSED AGGREGATE SHOULDER, TYPE B

• VARIOUS  
 \*\* D-8 BRIDGE APPROACH 2011-1  
 \*\*\* BOND & MADISON

FILE NAME =	USER NAME = *USER*	DESIGNED -	REVISED -	<b>STATE OF ILLINOIS DEPARTMENT OF TRANSPORTATION</b>	<b>IL 140 TYPICAL SECTIONS</b>		F.A. RTE.	SECTION	COUNTY	TOTAL SHEETS	SHEET NO.
*FILEL*		DRAWN -	REVISED -		SCALE:	SHEET NO. 3 OF 3 SHEETS	STA.	TO STA.	***	14	7
	PLOT SCALE = *SCALE*	CHECKED -	REVISED -		CONTRACT NO. 76E22						
	PLOT DATE = *DATE*	DATE -	REVISED -		ILLINOIS FED. AID PROJECT						





RESURFACING SCHEDULE

LOCATION STA TO STA		HMA SURFACE REMOVAL, 1 1/2"	HMA SURFACE REMOVAL, 2"	HMA SURFACE REMOVAL - BUTT JOINT	PCC SURFACE REMOVAL, 1/4"	PCC SURFACE REMOVAL, 2"	PCC SURFACE REMOVAL - BUTT JOINT	TEMPORARY RAMP	BITUMINOUS MATERIAL PRIME COAT	AGGREGATE PRIME COAT	POLYMERIZED HMA SURFACE COURSE		HMA SHOULDERS	AGGREGATE SHOULDER, TYPE B
		SQ YD	SQ YD	SQ YD	SQ YD	SQ YD	SQ YD	SQ YD	TON	TON	VARIES	1.5"	TON	TON
I-270 EASTBOUND														
685+12.50 TO 685+89.59	PVMT CONN		154.2		103.3		102.3	35.5	0.1	0.3	28.2		19.0	2.4
685+89.59 TO 686+19.59	BR APPR				23.5		56.5	17.7	0.1	0.2	8.8		5.9	0.8
BRIDGE OMISSION														
689+42.30 TO 689+72.30	BR APPR					80.0			0.1	0.3	1.2		0.8	0.1
689+72.30 TO 689+96.40	PVMT CONN		48.2			64.3			0.1	0.2	3.6		2.4	0.4
689+96.40 TO 690+26.00	HMA	59.3	138.2						0.1	0.2	3.8		2.6	0.2
I-270 WESTBOUND														
684+65.00 TO 685+41.83	HMA		153.7	195.9				17.7	0.1	0.4	14.9		10.1	1.2
685+41.83 TO 686+16.52	PVMT CONN		149.4		199.1				0.1	0.4	53.5		35.9	3.2
686+16.52 TO 686+46.52	BR APPR				4.7		75.4	17.7	0.1	0.2	14.6		9.8	1.2
BRIDGE OMISSION														
689+69.35 TO 689+99.35	BR APPR				2.9		77.2	17.7	0.1	0.2	7.0		4.7	0.5
689+99.35 TO 690+49.51	PVMT CONN		100.4		5.5	114.7	126.6		0.1	0.3	10.9		7.3	0.8
690+49.51 TO 691+69.00	HMA		408.9	10.1				17.7	0.1	0.5	20.0		13.5	1.6
IL 140														
1512+50.00 TO 1514+25.00	HMA	233.7							0.1	0.8		42.5		1.6
SUBTOTAL											166.5	42.5		
TOTALS		293	1153	206	339	259	438	124	1.2	4	209		112	14

PAVEMENT MARKING SCHEDULE

LOCATION STA TO STA	SHORT-TERM PAVEMENT MARKING FOOT	WORK ZONE PAVEMENT MARKING REMOVAL SQ FT	THERMOPLASTIC PAVEMENT MARKING - 4"				RAISED REFLECTIVE PAVEMENT MARKER REMOVAL EACH	RAISED REFLECTIVE PAVEMENT MARKER EACH	REMOVE AND REERECT TBT, TYPE 6 EACH	REMOVE AND REERECT SPBCR, TYPE A FOOT
			YELLOW		WHITE					
			SKIP-DASH CENTERLINE	SOLID EDGE LINE	SKIP-DASH LANE LINES	SOLID EDGE LINE				
I-270 EASTBOUND										
685+12.50 TO 685+89.59	20.2	6.7		77.1	38.6	77.1	2	2	137.5	
685+89.59 TO 686+19.59	7.9	2.6		30.0	15.0	30.0	1	1	2	
BRIDGE OMISSION										
689+42.30 TO 689+72.30	7.9	2.6		30.0	15.0	30.0	1	1	2	
689+72.30 TO 689+96.40	6.4	2.1		24.1	12.2	24.1	1	1	12.5	
689+96.40 TO 690+26.00	7.8	2.6		29.7	15.0	29.7	1	1		
I-270 WESTBOUND										
684+65.00 TO 685+41.83	20.1	6.7		76.9	38.6	76.9	2	2		
685+41.83 TO 686+16.52	19.6	6.5		74.7	37.4	74.7	2	2		
686+16.52 TO 686+46.52	7.9	2.6		30.0	15.0	30.0	1	1	2	
BRIDGE OMISSION										
689+69.35 TO 689+99.35	7.9	2.6		30.0	15.0	30.0	1	1	2	
689+99.35 TO 690+49.67	13.2	4.4		50.4	25.2	50.4	2	2	101	
690+49.67 TO 691+69.00	31.2	10.4		119.3	59.8	119.3	3	3	161.5	
IL 140										
1512+50.00 TO 1514+25.00	29.9	10.0	43.8			350.0	5	5		
SUBTOTAL			43.8	572.2	286.8	922.2				
TOTAL		180	59.8	1825			22	22	8	412.5

- VARIOUS
- D-8 BRIDGE APPROACH 2011-1
- BOND & MADISON

FILE NAME =	USER NAME = #USER#	DESIGNED -	REVISED -	<b>STATE OF ILLINOIS DEPARTMENT OF TRANSPORTATION</b>	<b>SCHEDULES</b>				F.A. RTE.	SECTION	COUNTY	TOTAL SHEETS	SHEET NO.
#FILE#		DRAWN -	REVISED -		SCALE:	SHEET NO.	OF	SHEETS	STA.	TO STA.	CONTRACT NO. 76E22	14	9
	PLOT SCALE = #SCALE#	CHECKED -	REVISED -		ILLINOIS FED. AID PROJECT								
	PLOT DATE = #DATE#	DATE -	REVISED -										

PROFILE ELEVATION SCHEDULE

WESTBOUND			
STATION	EXIST. ELEV.	PROP. ELEV.	ELEV. CHANGE INCH
684+65.00	527.35	527.37	0.17
684+70	527.23	527.24	0.11
684+80	526.99	527.00	0.19
684+90	526.74	526.77	0.35
685+00	526.49	526.54	0.58
685+10	526.24	526.32	0.95
685+20	525.95	526.10	1.83
685+30	525.65	525.89	2.88
685+40	525.30	525.69	4.67
685+50	525.01	525.49	5.69
685+60	524.89	525.30	4.84
685+70	524.71	525.11	4.83
685+80	524.57	524.94	4.40
685+90	524.40	524.76	4.36
686+00	524.23	524.60	4.40
686+10	524.06	524.44	4.51
686+20	523.73	524.29	6.63
686+30	523.80	524.14	4.10
686+40	523.86	524.00	1.65
686+46.52	523.90	523.91	0.14
BRIDGE OMISSION			
689+69.35	520.45	520.45	0.05
689+70	520.43	520.44	0.11
689+80	520.21	520.31	1.22
689+90	519.98	520.18	2.46
690+00	519.86	520.06	2.35
690+10	519.92	519.94	0.19
690+20	519.78	519.82	0.50
690+30	519.63	519.71	0.99
690+40	519.42	519.60	2.11
690+50	519.28	519.50	2.60
690+60	519.27	519.40	1.53
690+70	519.19	519.30	1.33
690+80	519.11	519.21	1.19
690+90	519.03	519.12	1.15
691+00	518.95	519.04	1.14
691+10	518.87	518.96	1.19
691+20	518.78	518.89	1.28
691+30	518.71	518.82	1.35
691+40	518.68	518.76	0.96
691+50	518.65	518.69	0.59
691+60	518.62	518.64	0.27
691+69.00	518.59	518.59	0.02

EASTBOUND			
STATION	EXIST. ELEV.	PROP. ELEV.	ELEV. CHANGE INCH
685+12.50	527.01	527.01	-0.03
685+20	526.83	526.86	0.39
685+30	526.59	526.67	1.08
685+40	526.34	526.49	1.84
685+50	526.09	526.32	2.68
685+60	525.85	526.15	3.57
685+70	525.66	525.98	3.87
685+80	525.50	525.82	3.96
685+90	525.35	525.67	3.86
686+00	525.32	525.53	2.54
686+10	525.29	525.39	1.24
686+19.59	525.25	525.26	0.15
BRIDGE OMISSION			
689+42.30	520.94	520.94	0.06
689+50	520.82	520.83	0.14
689+60	520.66	520.68	0.26
689+70	520.50	520.54	0.45
689+80	520.33	520.40	0.85
689+90	520.15	520.27	1.37
690+00	520.01	520.14	1.51
690+10	519.94	520.01	0.87
690+20	519.87	519.90	0.31
690+26.00	519.83	519.83	0.01

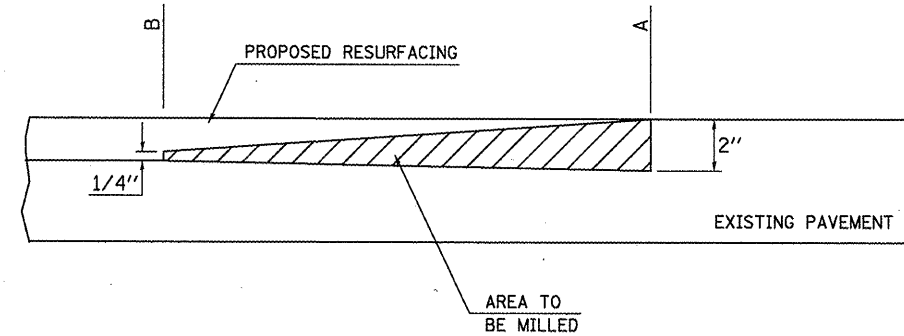

HMA - BUTT JOINT  
 WB - STA. 684+65.00 (B) TO STA. 685+38.28 (A)  
 WB - STA. 690+49.51 (A) TO STA. 690+53.28 (B)

PCC - BUTT JOINT  
 WB - STA. 686+18.27 (A) TO STA. 686+46.52 (B)  
 WB - STA. 689+69.35 (B) TO STA. 689+98.28 (A)  
 WB - STA. 690+00.81 (A) TO STA. 690+03.32 (B)  
 WB - STA. 690+03.32 (B) TO STA. 690+48.28 (A)  
 EB - STA. 685+12.50 (B) TO STA. 685+50.83 (A)  
 EB - STA. 685+98.42 (A) TO STA. 686+19.59 (B)

- VARIOUS
- D-8 BRIDGE APPROACH 2011-1
- BOND & MADISON

FILE NAME =	USER NAME = *USER*	DESIGNED -	REVISED -	<b>STATE OF ILLINOIS DEPARTMENT OF TRANSPORTATION</b>	<b>SCHEDULES &amp; DETAILS</b>				F.A. RTE.	SECTION	COUNTY	TOTAL SHEETS	SHEET NO.
*FILEL*		DRAWN -	REVISED -		SCALE:	SHEET NO.	OF	SHEETS	STA.	TO STA.	CONTRACT NO. 76E22	14	10
	PLOT SCALE = *SCALE*	CHECKED -	REVISED -		ILLINOIS FED. AID PROJECT								
	PLOT DATE = *DATE*	DATE -	REVISED -										

PLAN	REVISIONS	DATE
NOTE BOOK NO.	ALIGNED CHECKED	
	DATE FILE NAME	

PROFILE	SURVEYED	DATE
NOTE BOOK NO.	PLOTTED	
	GRADES CHECKED	
	STRUCTURE NOTATIONS OK'D	

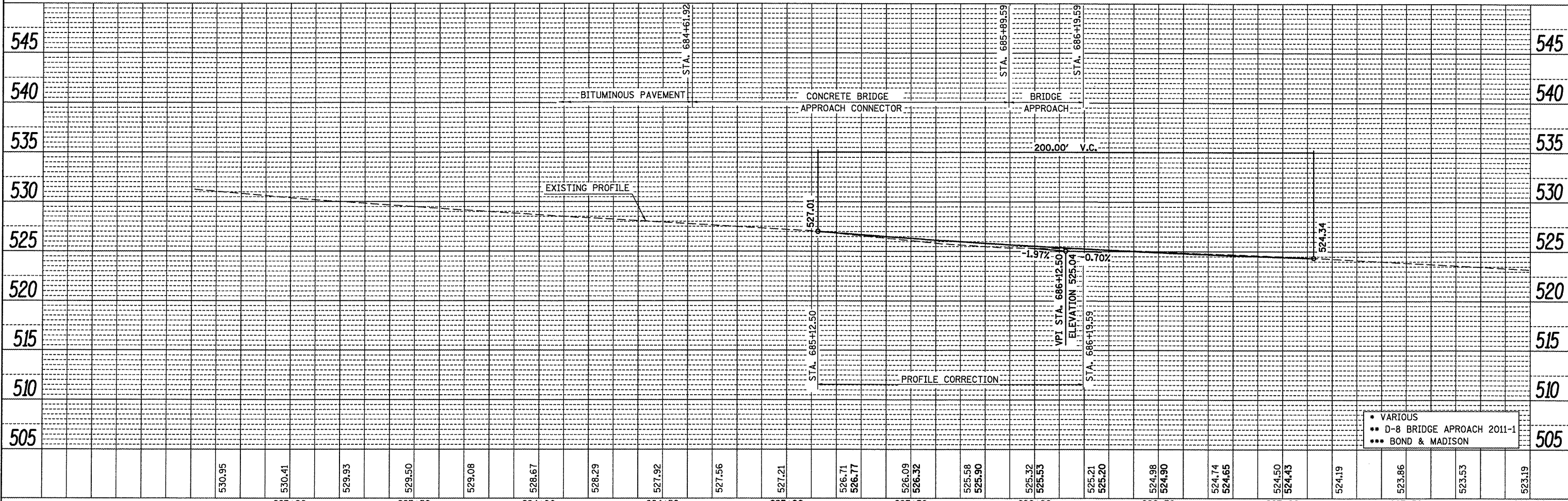
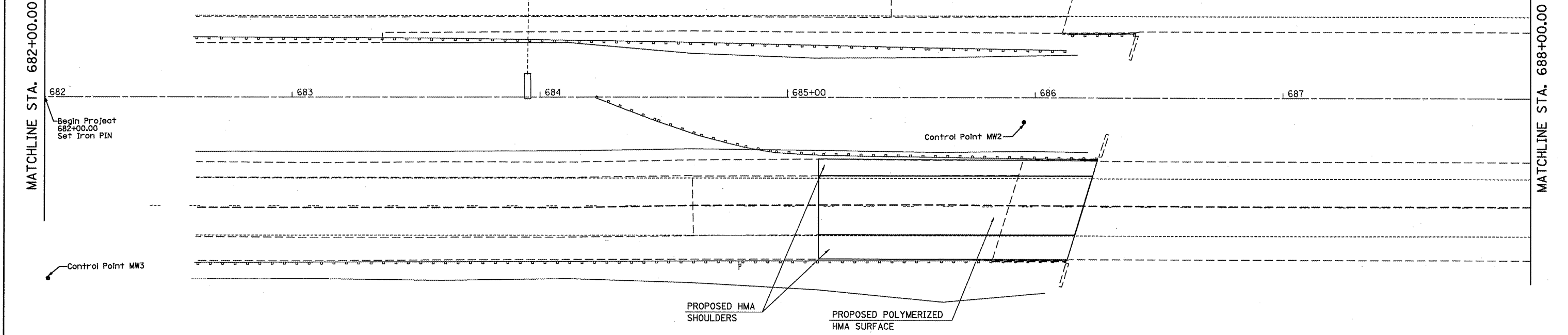

- VARIOUS
- \*\* D-8 BRIDGE APPROACH 2011-1
- \*\*\* BOND & MADISON

FILE NAME =	USER NAME = *USER*	DESIGNED -	REVISED -	<b>STATE OF ILLINOIS</b> <b>DEPARTMENT OF TRANSPORTATION</b>	<b>PLAN AND PROFILE I-270 EASTBOUND</b>		F.A. RTE.	SECTION	COUNTY	TOTAL SHEETS	SHEET NO.	
*FILE#		DRAWN -	REVISED -		SCALE: 20	SHEET NO. 1 OF 4 SHEETS	STA. 682+00 TO STA. 688+00	•	**	***	14	11
		CHECKED -	REVISED -		CONTRACT NO. 76E22							
		DATE -	REVISED -		ILLINOIS FED. AID PROJECT							

PLAN	SURVEYED	BY	DATE
	DESIGNED		
	CHECKED		
	IN CHARGE		
	NOTE BOOK		
	NO.		
	FILE NAME		

PROFILE	SURVEYED	BY	DATE
	DESIGNED		
	CHECKED		
	IN CHARGE		
	NOTE BOOK		
	NO.		
	FILE NAME		

MATCHLINE STA. 688+00.00

MATCHLINE STA. 694+00.00

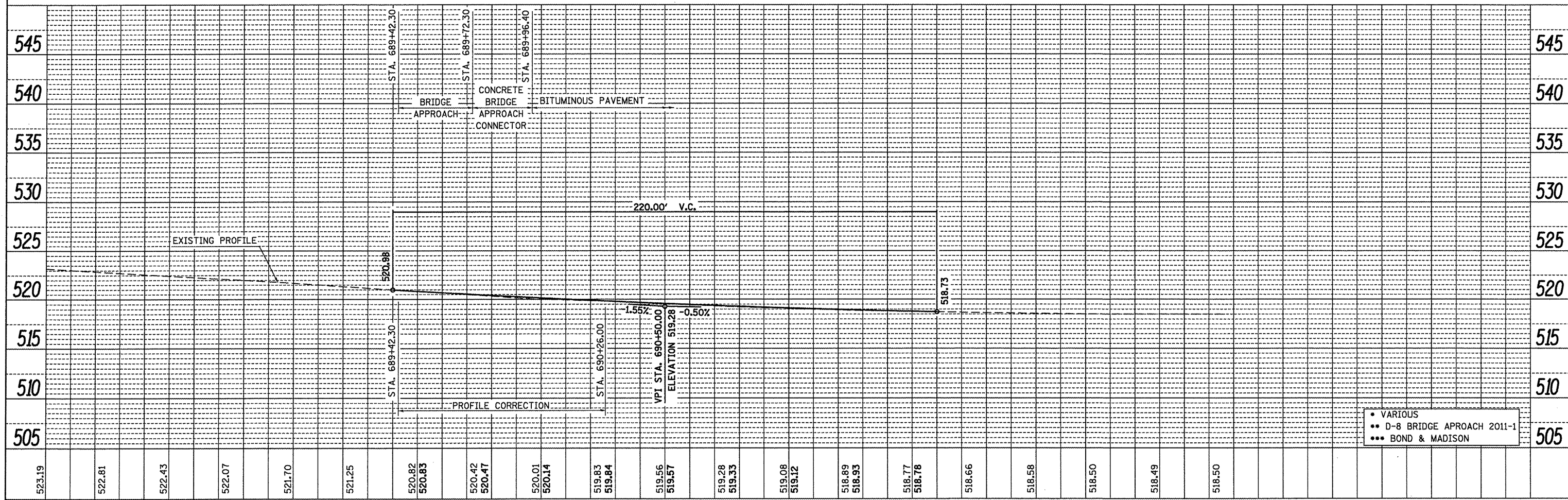
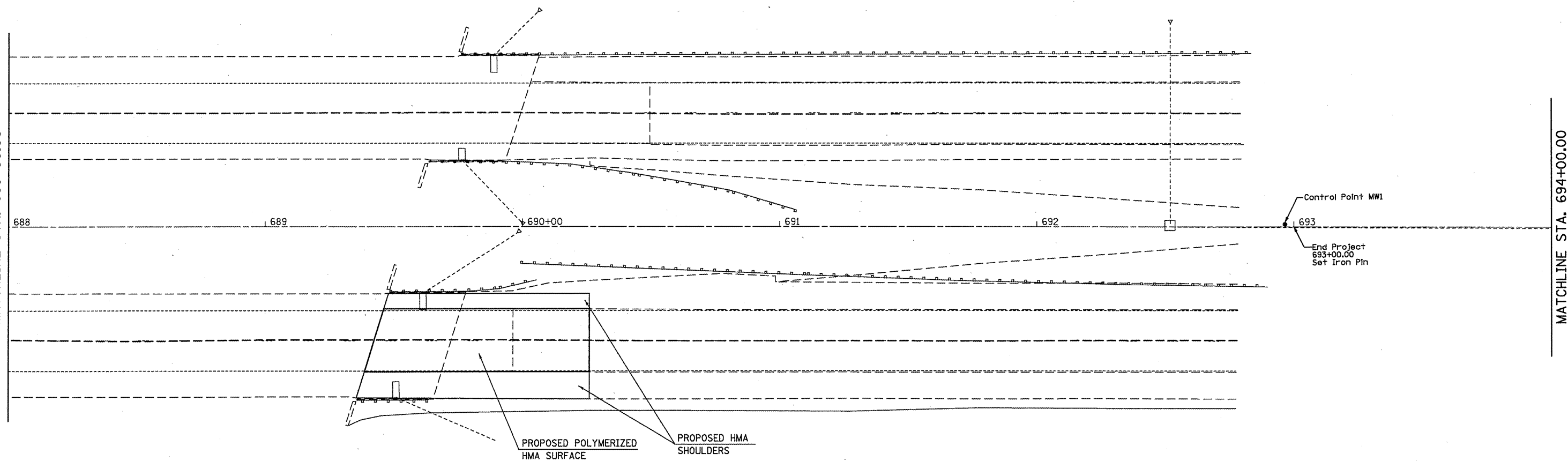

• VARIOUS  
 •• D-8 BRIDGE APPROACH 2011-1  
 ••• BOND & MADISON

FILE NAME =	USER NAME = #USER#	DESIGNED -	REVISED -	<b>STATE OF ILLINOIS DEPARTMENT OF TRANSPORTATION</b>	<b>PLAN AND PROFILE I-270 EASTBOUND</b>				F.A. RTE.	SECTION	COUNTY	TOTAL SHEETS	SHEET NO.
#FILE#		DRAWN -	REVISED -		SCALE: 20	SHEET NO. 2 OF 4 SHEETS	STA. 688+00	TO STA. 694+00	•	••	•••	14	12
		CHECKED -	REVISED -		CONTRACT NO. 76E22								
		DATE -	REVISED -		ILLINOIS FED. AID PROJECT								

PLAN	SURVEYED	BY	DATE
	PLOTTED		
	CHECKED		
	REVISED		
	NO. OF		
	REVISIONS		
	DATE		
	BY		
	DATE		

PROFILE	SURVEYED	BY	DATE
	PLOTTED		
	CHECKED		
	REVISED		
	NO. OF		
	REVISIONS		
	DATE		
	BY		
	DATE		

MATCHLINE STA. 682+00.00

MATCHLINE STA. 688+00.00

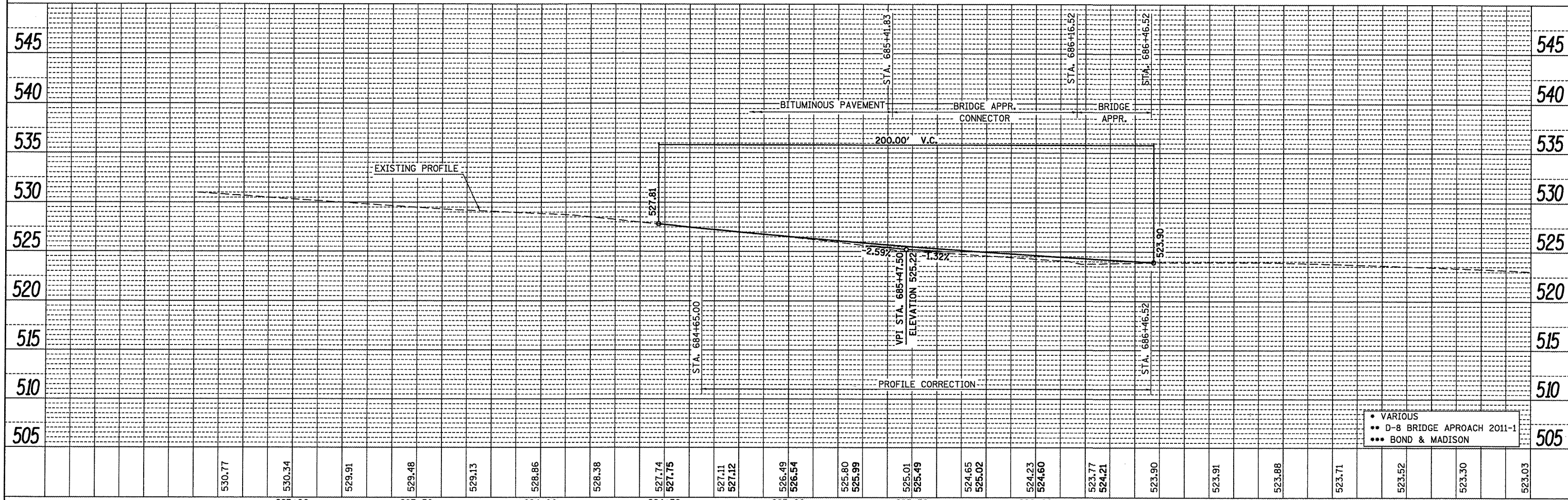
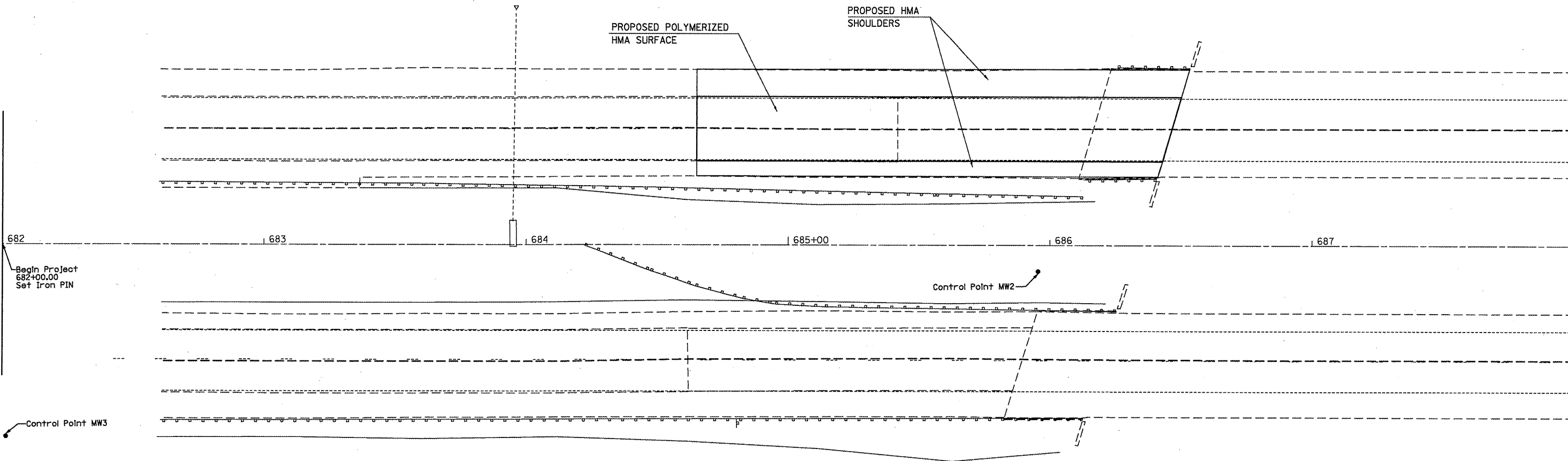

- VARIOUS
- D-8 BRIDGE APPROACH 2011-1
- BOND & MADISON

FILE NAME =	USER NAME = #USER#	DESIGNED -	REVISED -	<b>STATE OF ILLINOIS DEPARTMENT OF TRANSPORTATION</b>	<b>PLAN AND PROFILE I-270 WESTBOUND</b>	F.A. RTE.	SECTION	COUNTY	TOTAL SHEETS	SHEET NO.	
#FILE#		DRAWN -	REVISED -						14	13	
	PLOT SCALE = #SCALE#	CHECKED -	REVISED -			SCALE: 20	SHEET NO. 3 OF 4 SHEETS	STA. 682+00	TO STA. 688+00	CONTRACT NO. 76E22	
	PLOT DATE = #DATE#	DATE -	REVISED -			ILLINOIS FED. AID PROJECT					

PLAN	SURVEYED	BY	DATE
NO.	ALIGNED		
	GRADES CHECKED		
	BY		
	NOTE BOOK		
	NO.		
	PAID FILE NAME		

PROFILE	SURVEYED	BY	DATE
NO.	GRADES CHECKED		
	BY		
	NOTE BOOK		
	NO.		
	STRUCTURE		
	NOTATION		
	CHRD		

MATCHLINE STA. 688+00.00

MATCHLINE STA. 694+00.00

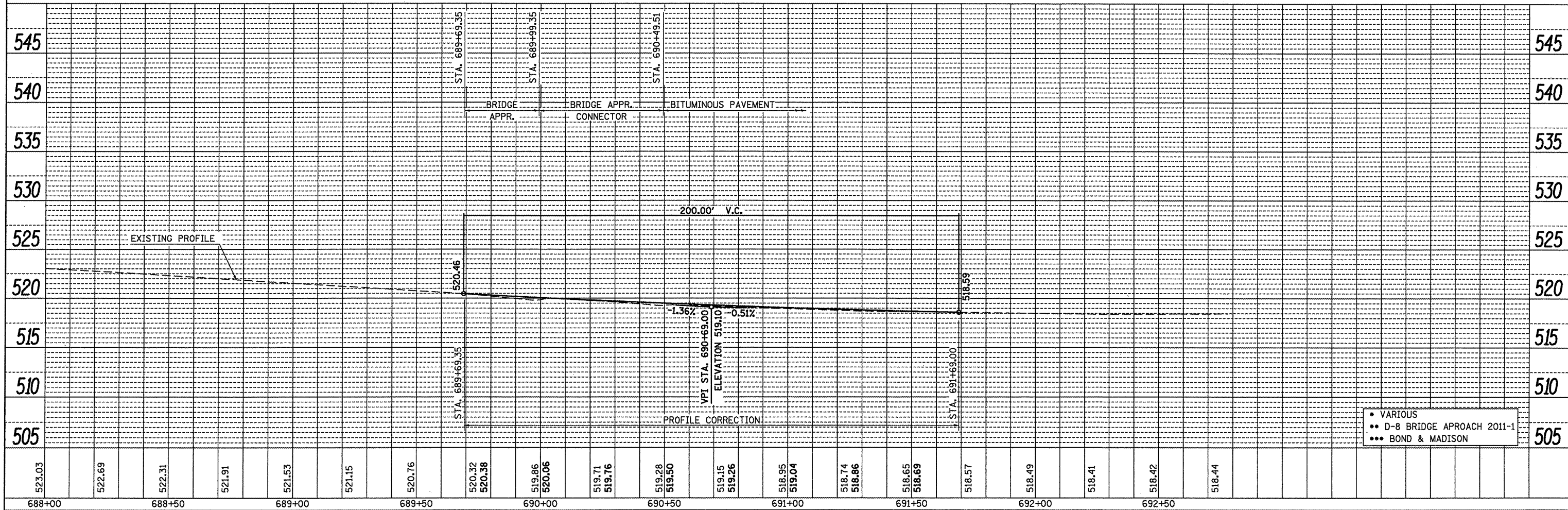
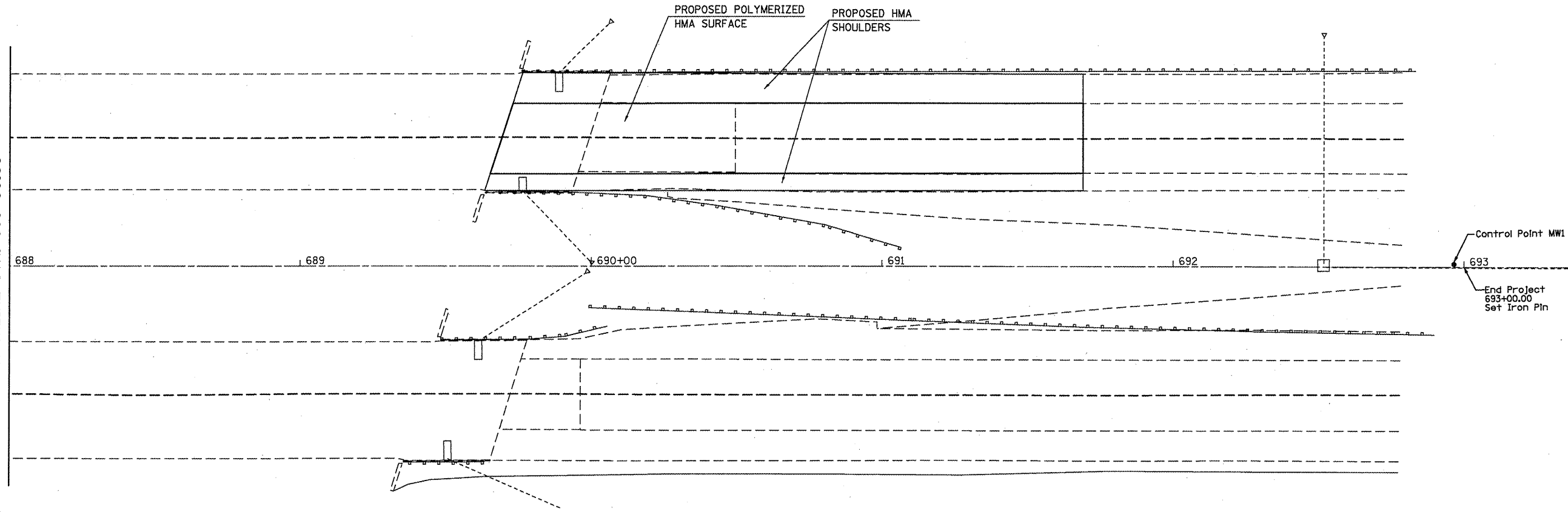

• VARIOUS  
 •• D-8 BRIDGE APPROACH 2011-1  
 ••• BOND & MADISON

FILE NAME =	USER NAME = #USER#	DESIGNED -	REVISED -	<b>STATE OF ILLINOIS</b> <b>DEPARTMENT OF TRANSPORTATION</b>	<b>PLAN AND PROFILE I-270 WESTBOUND</b>				F.A. RTE.	SECTION	COUNTY	TOTAL SHEETS	SHEET NO.
#FILE#		DRAWN -	REVISED -		SCALE: 20	SHEET NO. 4 OF 4 SHEETS	STA. 688+00	TO STA. 694+00				14	14
		CHECKED -	REVISED -						CONTRACT NO. 76E22				
		DATE -	REVISED -						ILLINOIS FED. AID PROJECT				