

NOTES

The cost of epoxy grouting bars shall be included with Reinforcement Bars, Epoxy Coated.
 Plan dimensions and details relative to existing plans are subject to nominal construction variations. The contractor shall field verify existing dimensions and details affecting new construction and make necessary approved adjustments prior to construction or ordering of materials. Such variations shall not be cause for additional compensation for a change in scope of the work, however, the Contractor will be paid for the quantity actually furnished at the unit price bid for the work.
 Reinforcement bars shall conform to the requirements of ASTM A 706, Gr. 60. See Special Provisions.
 Reinforcement bars designated (E) shall be epoxy coated.

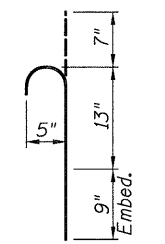

BAR n(E)

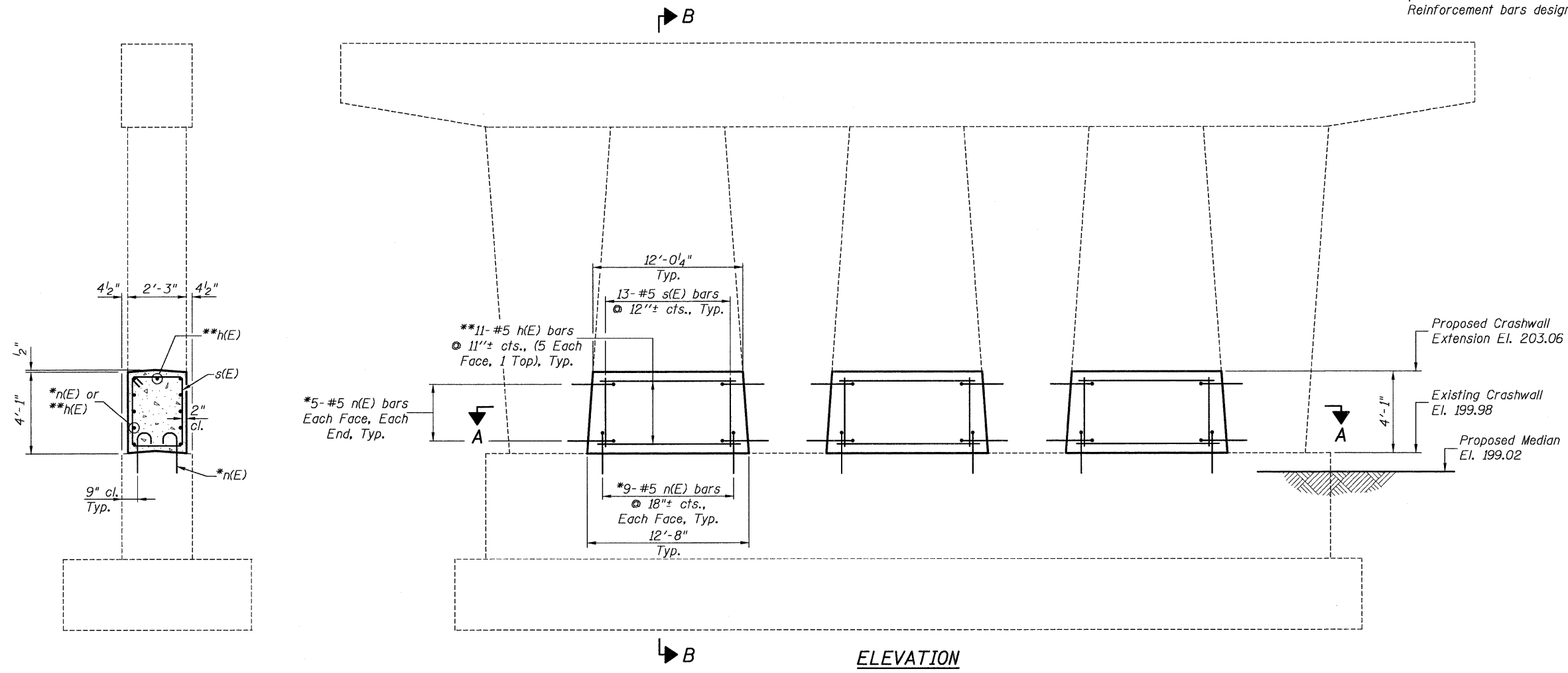
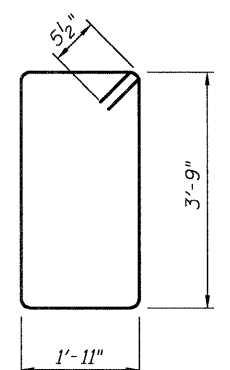

BAR s(E)

SECTION B-B

ELEVATION

BILL OF MATERIAL

Bar	No.	Size	Length	Shape
h(E)	33	#5	12'-2"	—
n(E)	114	#5	2'-5"	C
s(E)	39	#5	12'-3"	□
Concrete Structures			Cu. Yd.	12.6
Reinforcement Bars, Epoxy Coated			Pound	1,210

* Epoxy grout n(E) bars in 9" min. holes according to Article 584 of the Standard Specifications.

** Field cut h(E) bars to fit in field, as required.



Bradley G. Himmert Date: 2/4/11
 Bradley G. Himmert
 Licensed Structural Engineer
 in Illinois No. 081-005428 Expires: November 30, 2012

SECTION A-A

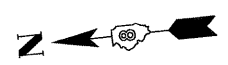

FILE NAME =	USER NAME =	DESIGNED -	REVISED -	STATE OF ILLINOIS DEPARTMENT OF TRANSPORTATION	DETAILS OF CRASHWALL EXTENSION MEDIAN PIER S.N.061-0010	F.A.I. RTE.	SECTION	COUNTY	TOTAL SHEETS	SHEET NO.	
hr\6513 idot.dwg	..USERDESCR..	CHECKED -	REVISED -			57	61-(1,2,3,4,5,6)-I	MARION	86	8	
PLOT SCALE =		DRAWN -	REVISED -			CONTRACT NO. 76E30					
PLOT DATE =		CHECKED -	REVISED -			ILLINOIS FED. AID PROJECT					

HMG NO. 6513.011