

F.A.P. RTE.	SECTION	COUNTY	TOTAL SHEETS	SHEET NO.
328	105B-2	WHITE	55	1
FED. ROAD DIST. NO.	ILLINOIS	CONTRACT NO. 78188		

STATE OF ILLINOIS
DEPARTMENT OF TRANSPORTATION
DIVISION OF HIGHWAYS

PROPOSED HIGHWAY PLANS

F.A.P. ROUTE 328 (US ROUTE 45)
SECTION 105B-2
PROJECT BRF-0328(030)
WHITE COUNTY
C-99-045-10
STRUCTURE REPLACEMENT
OVER BEAVER CREEK

INDEX OF SHEETS

SHEET NO.	DESCRIPTION
1.	COVER SHEET
2.	GENERAL NOTES AND STANDARDS
3.	SUMMARY OF QUANTITIES
4.-5.	TYPICAL SECTIONS
6.-7.	SCHEDULE OF QUANTITIES
8.	ALIGNMENT, TIES, AND BENCHMARKS SHEET
9.-11.	PLAN & PROFILE
12.	STAGE I CONSTRUCTION
13.	STAGE II CONSTRUCTION
14.	EROSION CONTROL PLAN
15.	PAVEMENT MARKING PLAN
16.	PAVED SHOULDER LAYOUT
17.	GUARDRAIL LAYOUT
18.	WIDE LOAD DETOUR
19.	R.O.W. SHEET
20.-21.	DISTRICT DETAILS
22.-43.	STRUCTURE PLANS
44.-45.	SOIL BORING
46.-55.	CROSS SECTIONS

UTILITIES

ELECTRIC:
WAYNE WHITE ELEC. COOP
1501 WEST MAIN ST.
FAIRFIELD, IL 62837
(618) 824-2196

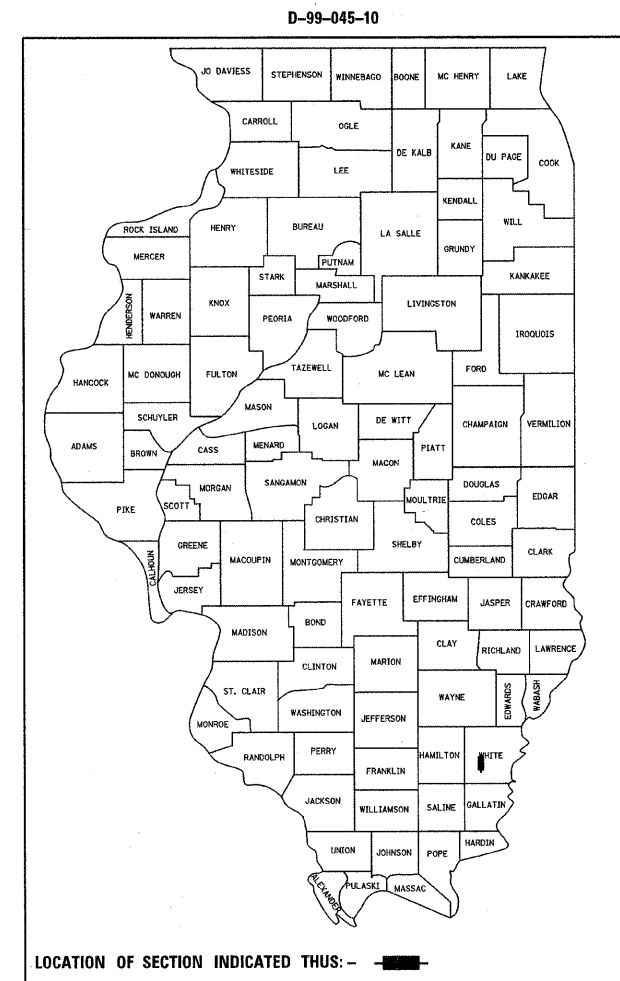

TRAFFIC DATA

FUNCTIONAL CLASSIFICATION:	OTHER PRINCIPAL ARTERIAL
DESIGN SPEED:	55 MPH
POSTED SPEED:	55 MPH
ADT:	1730 (2007)
PV:	77.75%
TRUCKS:	22.25%

PROJECT ENGINEER: DAVID PICHE (618) 351-5277

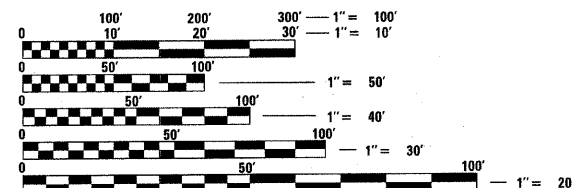

MILL SHOALS TOWNSHIP

FULL SIZE PLANS HAVE BEEN PREPARED USING STANDARD ENGINEERING SCALES. REDUCED SIZED PLANS WILL NOT CONFORM TO STANDARD SCALES. IN MAKING MEASUREMENTS ON REDUCED PLANS, THE ABOVE SCALES MAY BE USED.

J.U.L.I.E.
JOINT UTILITY LOCATION INFORMATION FOR EXCAVATION
1-800-892-0123
OR 811

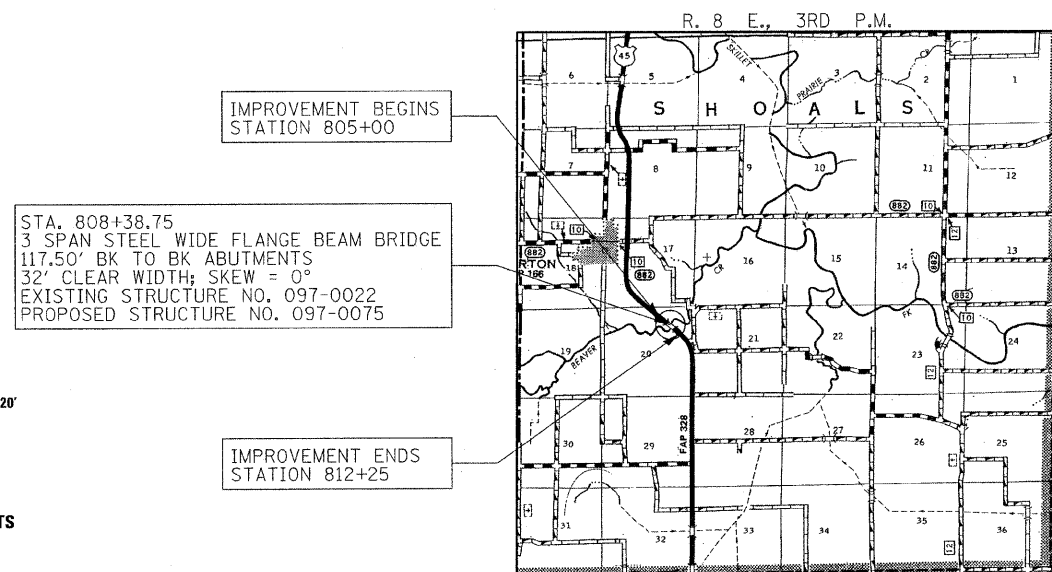

LOCATION MAP

APPROXIMATE SCALE: 0 1 MILE

NET LENGTH OF PROJECT = 725.00 FEET = 0.137 MILES
GROSS LENGTH OF PROJECT = 725.00 FEET = 0.137 MILES
ROADWAY LENGTH = 607.50 FEET = 0.115 MILES
BRIDGE LENGTH = 117.50 FEET = 0.022 MILES

HAMPTON, LENZINI AND RENWICK, INC.
CIVIL ENGINEERS - STRUCTURAL ENGINEERS - LAND SURVEYORS
3085 STEVENSON DRIVE, SUITE 201
SPRINGFIELD, ILLINOIS 62703
217.546.3400 www.hlrengineering.com

HLR
184.000959
ILLINOIS PROFESSIONAL DESIGN FIRM LS / PE / SE CORPORATION

DATE: 1/5/2011

LOUIS F. HAUBER
PROFESSIONAL ENGINEER
STATE OF ILLINOIS
NO. 123456

EXPIRES: 11/30/2011

STATE OF ILLINOIS
DEPARTMENT OF TRANSPORTATION
DIVISION OF HIGHWAYS

SUBMITTED Jan 28 2011
May C. Rami
DEPUTY DIRECTOR OF HIGHWAYS, REGION ENGINEER

March 25 2011
Scott E. Stitt, P.E.
ENGINEER OF DESIGN AND ENVIRONMENT

March 25 2011
Christina M. Reardon
DIRECTOR OF HIGHWAYS, CHIEF ENGINEER

**PRINTED BY THE AUTHORITY
OF THE STATE OF ILLINOIS**

CONTRACT NO. 78188