

NOTE:
 THE CONTRACTOR NEEDS TO BE AWARE THAT WETLANDS EXIT IMMEDIATELY OUTSIDE OUR
 CONSTRUCTION LIMITS FROM STA. 806+50 LT TO STA. 808+00 LT, STA. 808+50 LT TO STA. 810+25 LT
 AND STA. 809+00 RT TO STA. 810+25 RT. THESE AREAS MUST NOT BE DISTURBED BY THE CONTRACTOR.

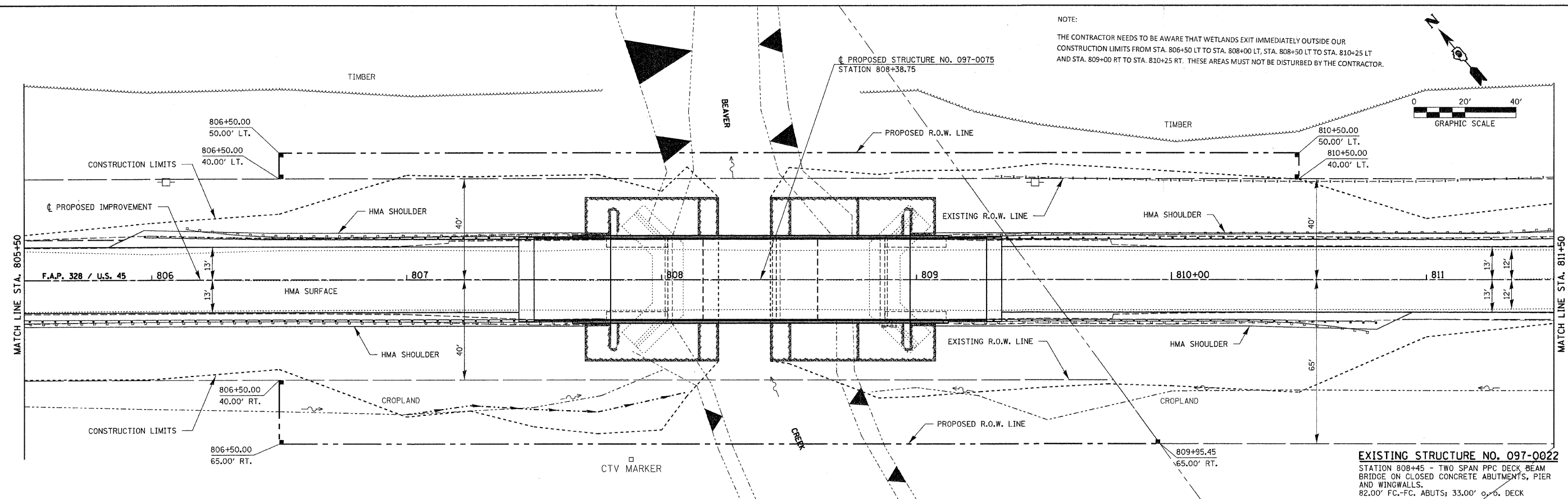
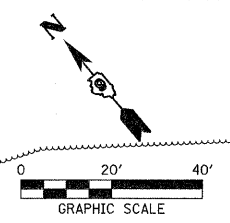

EXISTING STRUCTURE NO. 097-0022
 STATION 808+45 - TWO SPAN PPC DECK BEAM
 BRIDGE ON CLOSED CONCRETE ABUTMENTS, PIER
 AND WINGWALLS.
 82.00' FC-FC, ABUTS; 33.00' o-g, DECK

PLAN	DATE
BY	
NO.	
DATE	
BY	
NO.	
DATE	
BY	
NO.	
DATE	
BY	
NO.	
DATE	
BY	
NO.	
DATE	

PROFILE	DATE
BY	
NO.	
DATE	
BY	
NO.	
DATE	
BY	
NO.	
DATE	
BY	
NO.	
DATE	
BY	
NO.	
DATE	

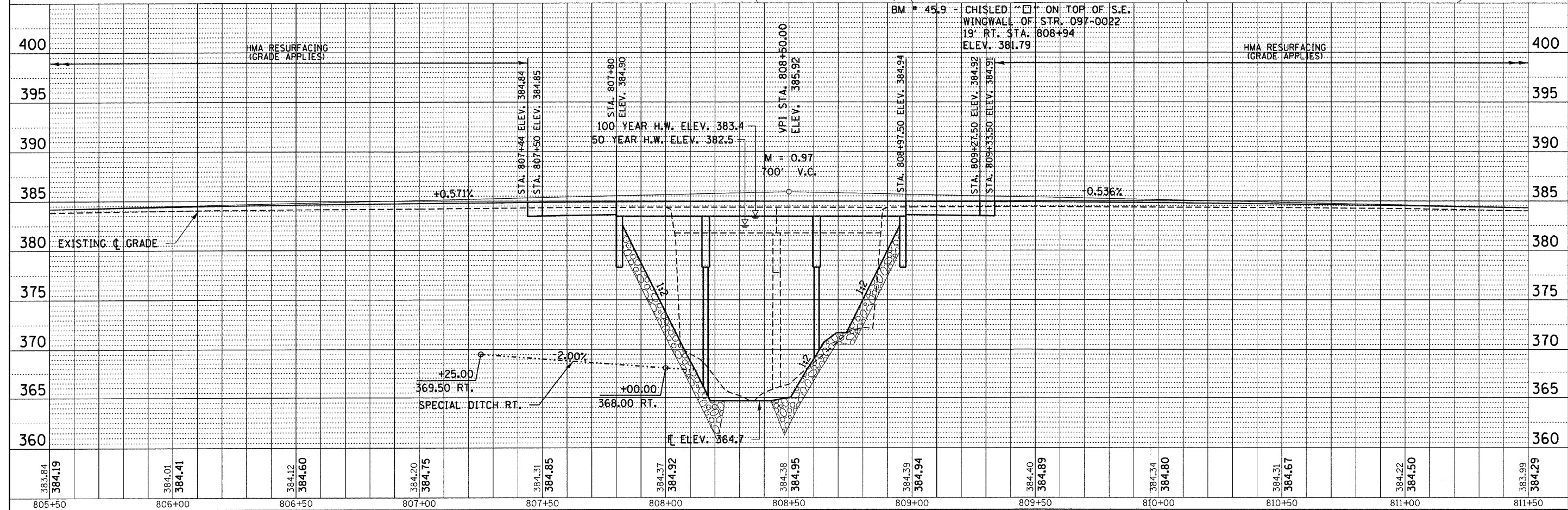

FILE NAME = 092116-ht-pp2.dgn	USER NAME =	DESIGNED - L.F.S.	REVISED -	STATE OF ILLINOIS DEPARTMENT OF TRANSPORTATION		PLAN & PROFILE U.S. ROUTE 45	F.A.P. 328	SECTION 1058-2	COUNTY WHITE	TOTAL SHEETS 55	SHEET NO. 10
PLOT SCALE =	CHECKED - J.W.F.	REVISED -	CONTRACT NO. 78188								
PLOT DATE = 1/5/2011	DATE - 09/14/10	REVISED -	ILLINOIS FED. AID PROJECT								
SCALE: 20H5V		SHEET NO. 2 OF 3 SHEETS					STA. 805+50 TO STA. 811+50		FED. ROAD DIST. NO.		