

85534

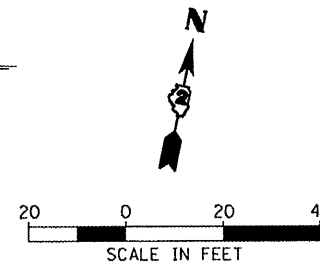
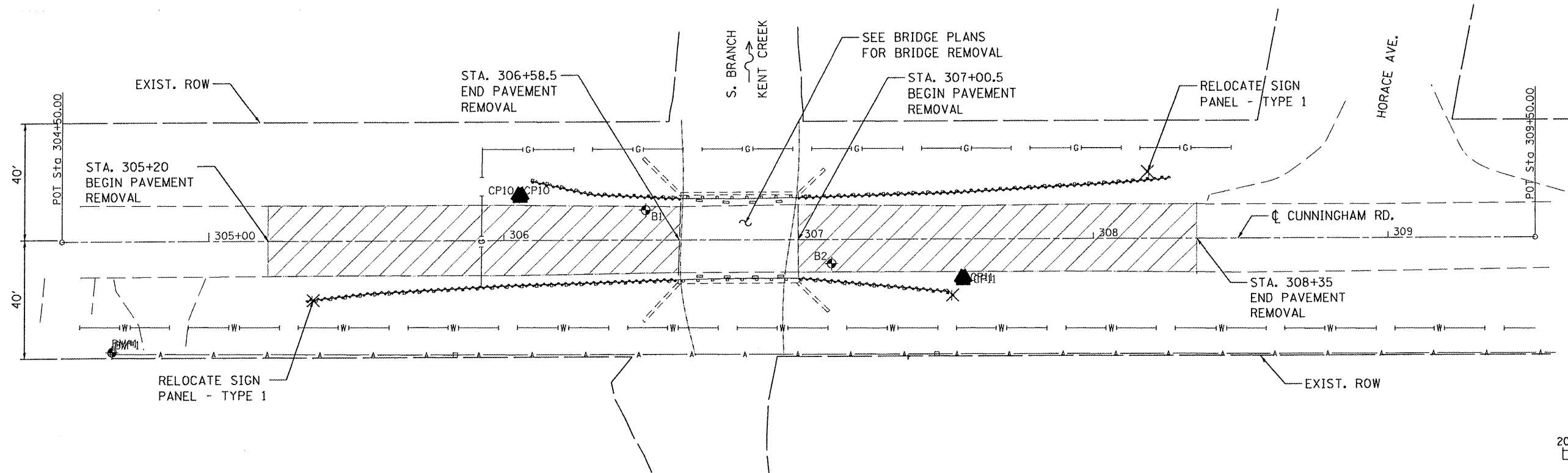

- LEGEND**
- ✕ SIGN PANEL AND POST
 - ~~~~~ GUARDRAIL REMOVAL
 - ▨ PAVEMENT REMOVAL

BENCHMARK				
BENCHMARK	STATION	OFFSET	DESCRIPTION	ELEVATION
BM#1	304+66.99	38.3' RT	SPIKE IN POWERPOLE, SOUTHWEST OF BRIDGE.	740.29

ALIGNMENT DATA		
ALIGNMENT STA	NORTHING	EASTING
STA 305+20	2040934.292	2576961.730
STA 308+35	2040994.563	2577270.910

CONTROL POINTS			
POINT	NORTHING	EASTING	DESCRIPTION
CP10	2040965.36	2577042.79	SET 1/2" PIPE W/CAP
CP11	2040966.30	2577195.87	SET 1/2" PIPE W/CAP

HANSON
 Hanson Professional Services Inc.

LAYOUT: JDM 01/09/11
 DRAWN: JDM 02/03/11
 CHECKED: DPA 02/03/11
 FILE NAME: \\1181job\NRL\854\CADD\Road\Sheet\VC-184-REM.dgn

FILE NAME =	USER NAME =	DESIGNED - DPA	REVISED -	STATE OF ILLINOIS DEPARTMENT OF TRANSPORTATION	ALIGNMENT, TIES, BENCHMARK, AND REMOVAL PLAN CUNNINGHAM ROAD BRIDGE REPLACEMENT ROCKFORD, ILLINOIS	F.A.U. RTE.	SECTION	COUNTY	TOTAL SHEETS	SHEET NO.
1181job\NRL\854\CADD\Road\Sheet\VC-184-REM.dgn		DRAWN - JDM	REVISED -			5077	10-00462-00-BR	WINNEBAGO	21	4
PLOT SCALE = AS SHOWN		CHECKED - DPA	REVISED -			CONTRACT NO. 85534				
PLOT DATE = 02/04/2011		DATE - 02/03/11	REVISED -			SHEET NO. OF SHEETS	STA. - TO STA. -	FED. ROAD DIST. NO. ILLINOIS FED. AID PROJECT		