

STATION	LT / RT	OFFSET	TYPE	CONTROL ELEVATION	FLOWLINE ELEVATION	INVERT ELEVATIONS				NOTE
						N	E	S	W	
3365+75.00	RT	13.00'	IN TY G-1	705.04	701.54	701.79	701.59		701.54	
3365+75.00	LT	13.00'	IN TY G-1	705.04	701.93			701.93		
3367+50.00	RT	13.00'	IN TY G-1	707.46	703.92	704.12	704.33		703.92	
3367+50.00	LT	13.00'	IN TY G-1	707.46	704.26			704.26		
3369+50.00	RT	13.00'	IN TY G-1	710.22	707.00	707.08	707.06		707.00	
3369+50.00	LT	13.00'	IN TY G-1	710.22	707.22			707.22		

FROM STR.	TO STR.	LENGTH	CLASS	TYPE	DIA	SLOPE
18A	16	171.0'	A	1	15"	1.4%
18A	18A	28.0'	A	1	12"	0.5%
18B	18	172.0'	A	1	15"	1.4%
19	18	28.0'	A	1	12"	0.5%
20	18	197.0'	A	1	12"	1.4%
20A	20	28.0'	A	1	12"	0.5%

DATE	BY
DATE	BY
DATE	BY
DATE	BY
DATE	BY
DATE	BY

DATE	BY
DATE	BY
DATE	BY
DATE	BY
DATE	BY

MATCH LINE STA 3364+00.00  
SEE PLAN AND PROFILE SHEET 2 OF 5

MATCH LINE STA 3370+00.00  
SEE PLAN AND PROFILE SHEET 4 OF 5

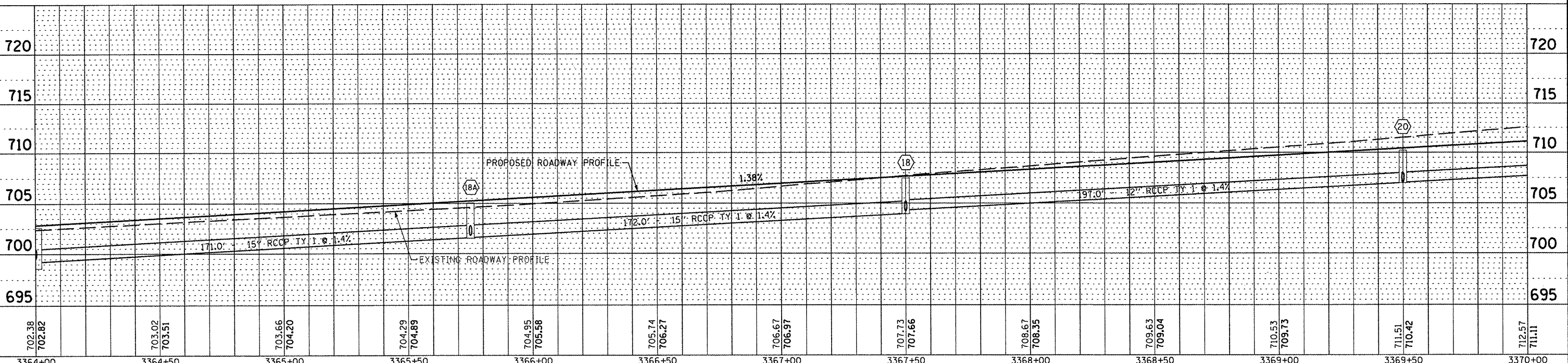
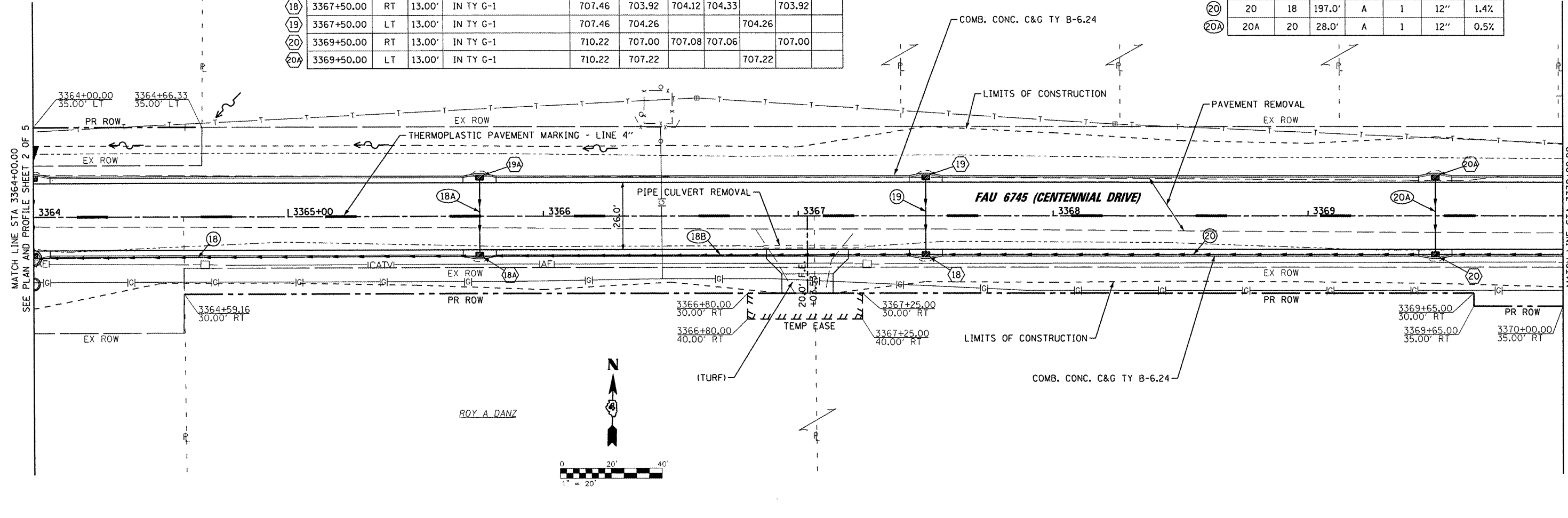

FILE NAME =	USER NAME = rmbredle	DESIGNED - BAB/RAW	REVISED -	<p align="center"><b>STATE OF ILLINOIS DEPARTMENT OF TRANSPORTATION</b></p> <p align="center"><b>CENTENNIAL DRIVE PHASE IV PLAN &amp; PROFILE</b></p>	F.A.U. RTE. 6745	SECTION 07-00130-03-PV	COUNTY TAZEWELL	TOTAL SHEETS 39	SHEET NO. 11
		DRAWN - BAB	REVISED -		SCALE: 1" = 20'	SHEET NO. 3 OF 5 SHEETS		STA. 3364+00.00 TO STA. 3370+00.00	
		CHECKED - RMB	REVISED -		CONTRACT NO. 89481				
		DATE - 03/02/2011	REVISED -		ILLINOIS FED. AID PROJECT				