

PLAN	REVISIONS	DATE
NO.	BY	
NO.	DATE	
NO.	DATE	
NO.	DATE	
NO.	DATE	
NO.	DATE	
NO.	DATE	
NO.	DATE	
NO.	DATE	
NO.	DATE	

PROFILE	REVISIONS	DATE
NO.	BY	
NO.	DATE	
NO.	DATE	
NO.	DATE	
NO.	DATE	
NO.	DATE	
NO.	DATE	
NO.	DATE	
NO.	DATE	
NO.	DATE	

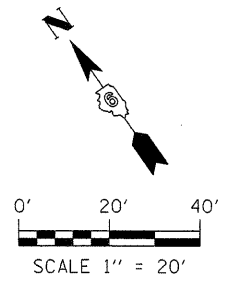
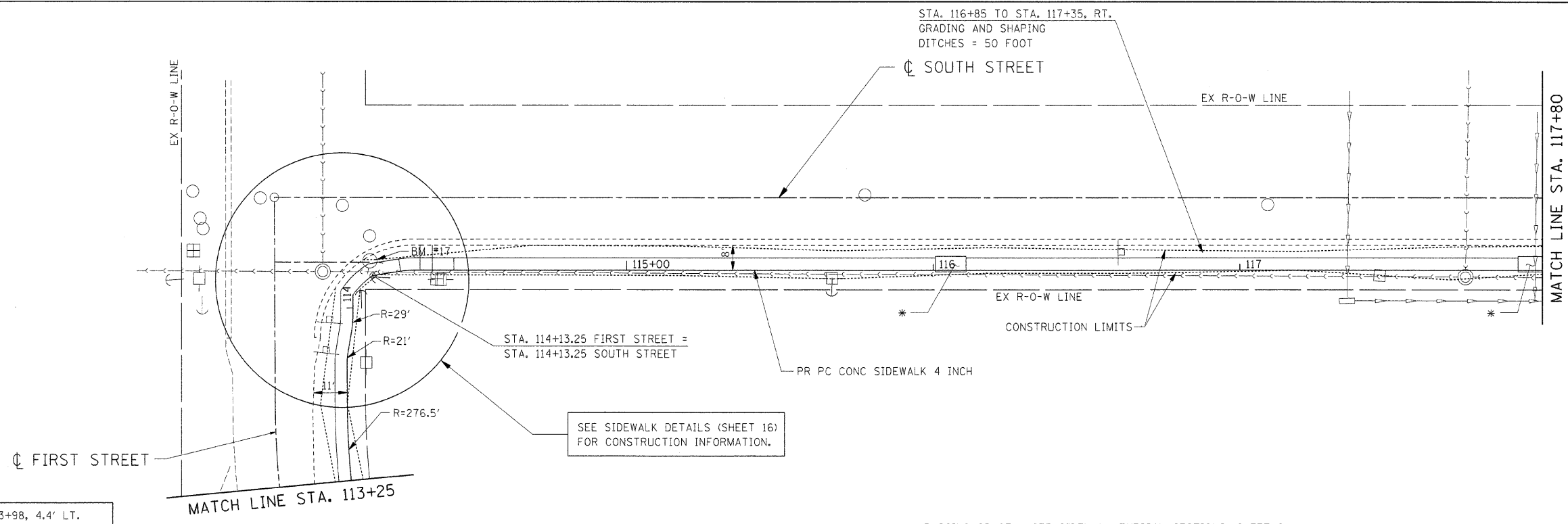

**LEGEND**  
TBR - TO BE RELOCATED

BM #17 STA. 113+98, 4.4' LT.  
CHISELED "+" TOP OF S BOLT  
OF FIRE HYDRANT  
ELEV. 582.29

SEE SIDEWALK DETAILS (SHEET 16)  
FOR CONSTRUCTION INFORMATION.

\* PASSING SPACE - SEE SIDEWALK TYPICAL SECTIONS (SHEET 9).  
PROVIDE 5'x10' PASSING SPACE AT APPROXIMATE LOCATIONS  
SHOWN. MINOR ADJUSTMENTS MAY BE MADE IN THE FIELD.  
200' MAX. BETWEEN PASSING SPACES.

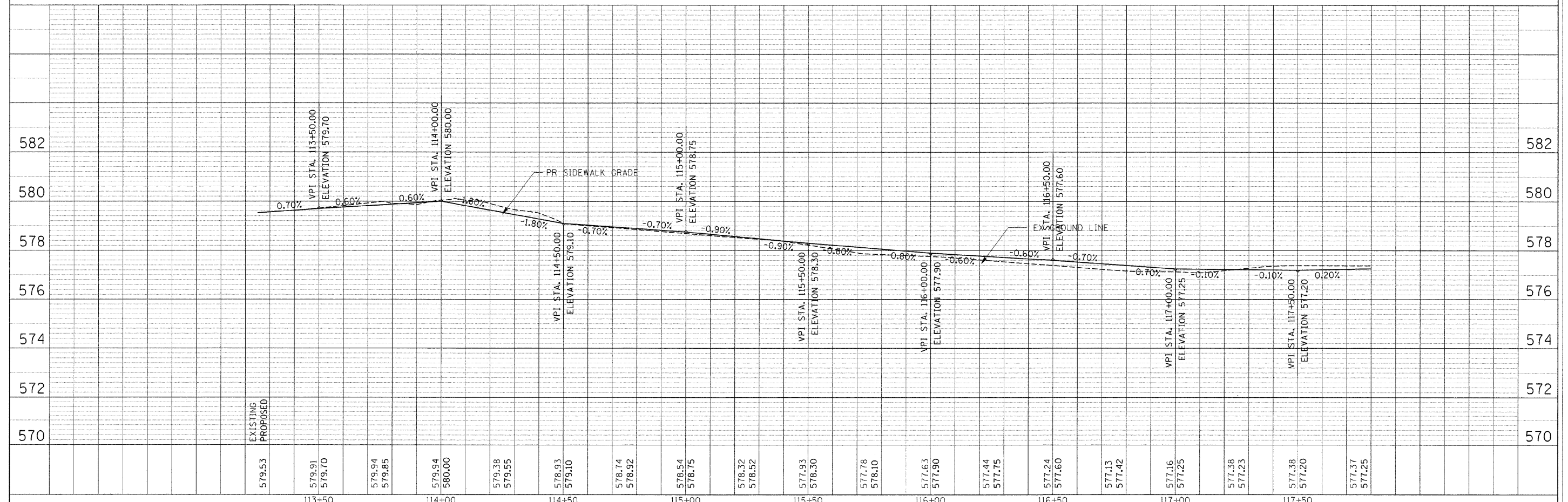

FILE NAME = G:\S07009-01\ssd\2010\7009PP04.SHT	USER NAME = IE Consultants	DESIGNED -	REVISED -	<b>VILLAGE OF SHERMAN</b>	<b>FIRST / SOUTH STREET - PLAN &amp; PROFILE</b>				F.A. RTE.	SECTION	COUNTY	TOTAL SHEETS	SHEET NO.
		DRAWN -	REVISED -		<b>STA 113 + 25 TO STA 117 + 80</b>				08-00014-00-SW	SANGAMON	26	13	
		CHECKED -	REVISED -		SCALE: SHEET NO. OF SHEETS STA. TO STA.				CONTRACT NO. 93486				
		DATE -	REVISED -		FED. ROAD DIST. NO. [ILLINOIS] FED. AID PROJECT								