

F.A.U. RTE.	SECTION	COUNTY	TOTAL SHEETS	SHEET NO.
7982	*	SANGAMON	63	21
STA.		TO STA.		
FED. ROAD DIST. NO.		ILLINOIS FED. AID PROJECT		
* 10-00447-04-PV		CITY OF SPRINGFIELD		

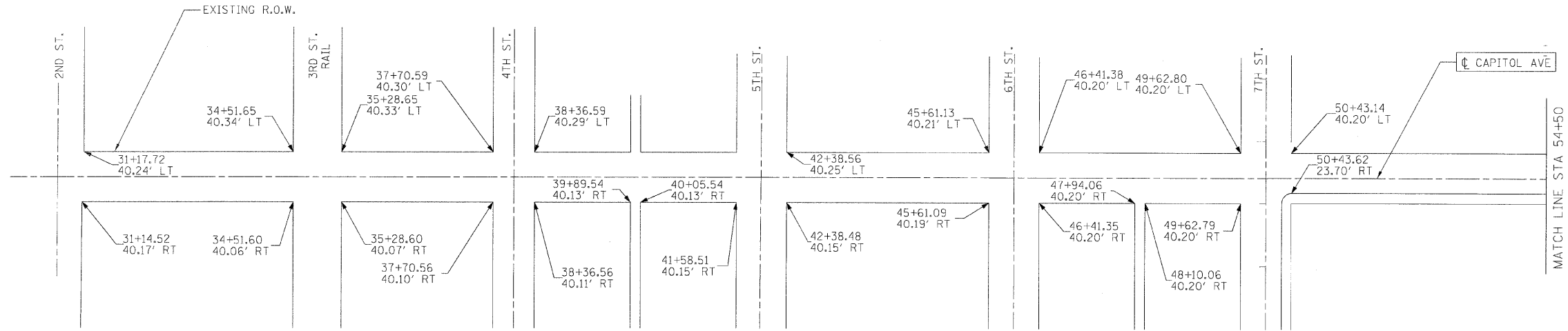

PERMANENT LANDSCAPE EASEMENT TABLE

150 STA.	69+44.65	OFFSET:	40.20' RT
151 STA.	68+71.96	OFFSET:	40.20' RT
152 STA.	68+71.96	OFFSET:	45.20' RT
153 STA.	69+44.65	OFFSET:	45.20' RT

TEMPORARY CONSTRUCTION EASEMENT TABLE

351 STA.	69+44.64	OFFSET:	45.20' RT
352 STA.	69+39.65	OFFSET:	45.20' RT
353 STA.	69+39.66	OFFSET:	82.20' RT
354 STA.	69+44.66	OFFSET:	82.20' RT
307 STA.	69+44.62	OFFSET:	40.20' LT
308 STA.	69+23.15	OFFSET:	40.22' LT
309 STA.	69+23.15	OFFSET:	45.22' LT
310 STA.	69+39.62	OFFSET:	45.20' LT
311 STA.	69+39.61	OFFSET:	81.14' LT
312 STA.	69+44.55	OFFSET:	81.14' LT
313 STA.	69+44.58	OFFSET:	180.66' LT
314 STA.	69+12.58	OFFSET:	180.66' LT
315 STA.	69+12.57	OFFSET:	252.65' LT
316 STA.	69+44.57	OFFSET:	252.65' LT

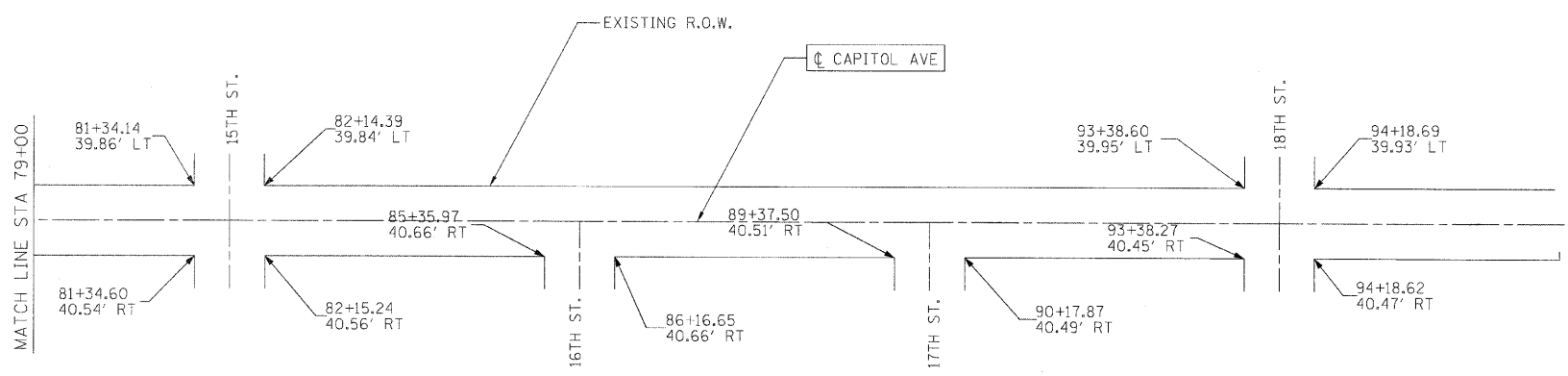
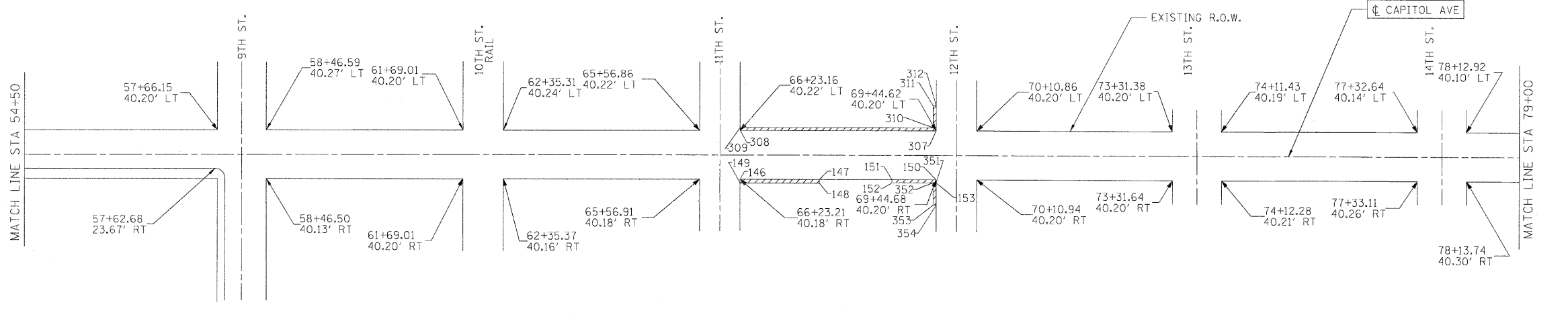

LEGEND

- PROPOSED PERMANENT EASEMENT
- PROPOSED TEMPORARY EASEMENT
- EXISTING RIGHT OF WAY

(AS SHOWN IN PLANS)

REVISIONS	
NAME	DATE

NOTE: EASEMENTS TO BE ACQUIRED BY THE CITY OF SPRINGFIELD.

ILLINOIS DEPARTMENT OF TRANSPORTATION
EXISTING RIGHT-OF-WAY

FAU RTE 7982 CAPITOL AVE
SEC NO. 10-00447-04-PV
SANGAMON COUNTY, ILLINOIS

SCALE: VERT. _____
HORIZ. _____
DATE 11/19/10
DRAWN BY RSJ
CHECKED BY MH



PLOT DATE = 01/11/2011
FILE NAME = I:\92_00447-04-PV\9200447-04-PV_Section-3-11b - 18x11-C-104.dwg
PLOT SCALE = 100.0000 / 1 in.
USER NAME = JohnB20944

LAYOUT	LLP	02/23/07
DRAWN	LLP	02/23/07
REVIEWED	MH	09/19/07