

F.A.U. RTE.	SECTION	COUNTY	TOTAL SHEETS	SHEET NO.
7982	*	SANGAMON	63	30
STA.		TO STA.		
FED. ROAD DIST. NO.		ILLINOIS FED. AID PROJECT		
* 10-00447-04-PV		CITY OF SPRINGFIELD		

NOTE 1 - INTERSECTION SIDEWALK IMPROVEMENTS INCLUDE SIDEWALK AND CURB REMOVAL, PROPOSED PCC SIDEWALK, CURB RAMPS, DETECTABLE WARNINGS AND COMBINATION CONCRETE CURB AND GUTTER (SPECIAL). SEE STREETSCAPE IMPROVEMENT PLANS FOR DETECTABLE WARNING PAVERS.

NOTE 2 - ESTIMATED QUANTITIES HAVE BEEN INCLUDED FOR PROPOSED PCC SIDEWALKS, CURB AND GUTTER (SPECIAL) AND DRIVEWAY PAVEMENT. THE ENGINEER SHALL DETERMINE PROPOSED LOCATIONS.

LEGEND

BITUMINOUS RESURFACING



POINT NUMBER	STATION	OFFSET	POINT NUMBER	STATION	OFFSET	POINT NUMBER	STATION	OFFSET
1	85+36.94	19.77' RT	9	86+12.31	18.99' RT	17	86+05.23	34.40' LT
2	85+41.44	19.77' RT	10	86+16.31	19.04' RT	18	86+09.38	34.40' LT
3	85+41.43	34.60' RT	11	86+16.32	34.73' RT	19	86+04.84	18.78' LT
4	85+59.88	34.61' RT	12	86+16.33	38.57' RT	20	86+09.89	18.79' LT
5	85+60.51	38.61' RT	13	86+11.02	38.58' RT			
6	85+41.88	38.60' RT	14	85+92.12	39.09' RT			
7	85+37.46	38.60' RT	15	85+92.81	34.09' RT			
8	85+37.43	34.52' RT	16	86+12.32	34.57' RT			

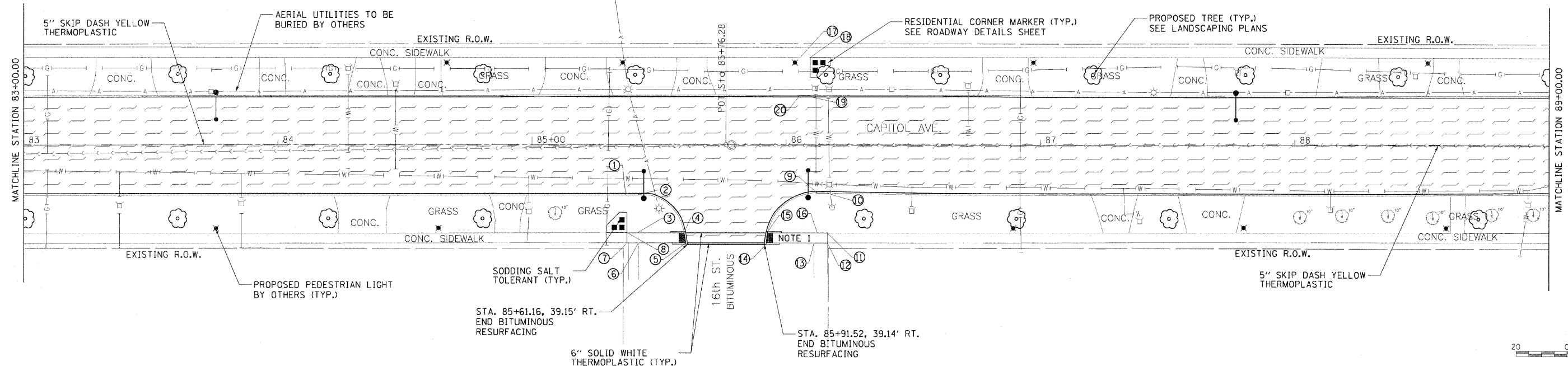

POINT NUMBER	STATION	OFFSET	POINT NUMBER	STATION	OFFSET
1	89+37.98	19.72' RT	9	90+11.53	19.56' RT
2	89+43.11	19.52' RT	10	90+16.53	19.49' RT
3	89+60.97	34.24' RT	11	90+16.04	34.79' RT
4	89+42.58	34.25' RT	12	90+15.95	38.62' RT
5	89+61.71	38.74' RT	13	90+12.01	38.51' RT
6	89+42.54	38.34' RT	14	89+93.52	39.01' RT
7	89+38.50	38.37' RT	15	89+94.23	34.01' RT
8	89+38.62	34.22' RT	16	90+11.99	34.69' RT

POINT NUMBER	STATION	OFFSET	POINT NUMBER	STATION	OFFSET
1	93+41.06	38.01' LT	9	93+43.18	19.79' RT
2	93+45.06	38.01' LT	10	93+48.18	21.99' RT
3	93+56.59	38.51' LT	11	93+47.68	34.58' RT
4	93+56.08	33.51' LT	12	93+56.11	34.08' RT
5	93+45.09	34.01' LT	13	93+56.49	39.08' RT
6	93+44.36	19.43' LT	14	93+47.64	38.58' RT
7	93+40.36	19.27' LT	15	93+43.68	38.55' RT
8	93+41.09	34.08' LT	16	93+43.68	34.93' RT

POINT NUMBER	STATION	OFFSET	POINT NUMBER	STATION	OFFSET
17	94+12.30	21.48' RT	25	94+13.56	20.37' LT
18	94+17.30	19.83' RT	26	94+18.56	20.11' LT
19	94+16.80	35.29' RT	27	94+18.07	34.37' LT
20	94+16.84	39.29' RT	28	94+18.06	38.32' LT
21	94+12.86	39.17' RT	29	94+14.11	38.32' LT
22	94+01.83	39.66' RT	30	94+01.76	38.83' LT
23	94+02.15	34.66' RT	31	94+02.34	33.83' LT
24	94+12.80	35.17' RT	32	94+14.07	34.32' LT

POINT NUMBER	STATION	OFFSET
33	93+26.10	34.10' LT
34	93+26.10	38.03' LT
35	93+28.70	34.53' RT
36	93+28.70	38.54' RT

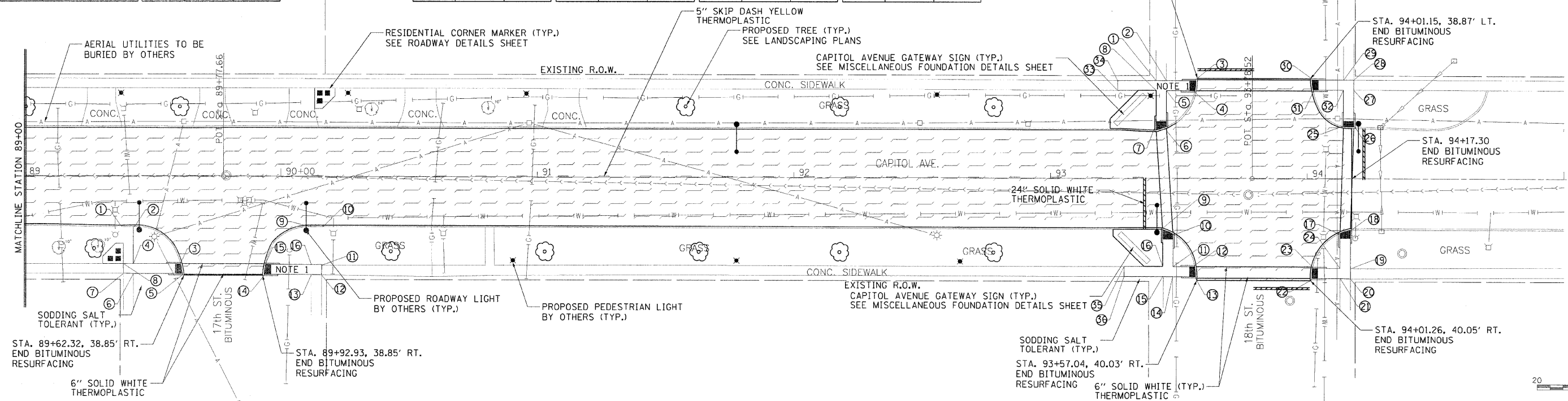

LAYOUT DATE: 00/00/00
 DRAWN BY: D.L.C. 03/15/07
 REVIEWED BY: M.H. 09/19/07
 PLOT DATE: 01/11/2011
 FILE NAME: I:\222\454\22528414\CD\00\Road\Misc\Section\Sheet\Section_3-11b - 18th St - 419 RPP - 16-18.dgn
 PLOT SCALE: 1"=20.00'
 USER NAME: Johna80944