

FAU. RTE.	SECTION	COUNTY	TOTAL SHEETS	SHEET NO.
7982	*	SANGAMON	63	37
STA.		TO STA.		
FED. ROAD DIST. NO.	ILLINOIS	FED. AID PROJECT		
10-00447-04-PV	CITY OF SPRINGFIELD			

**PLAN ENLARGEMENT PAVEMENT KEYED NOTES**

- 1 TYPE 1 PCC PAVEMENT - ROADWAY PAVEMENT
- 2 TYPE 2 PCC PAVEMENT - PRIMARY SIDEWALK PAVEMENT, BROOM FINISH
- 3 TYPE 3 PCC PAVEMENT - SIDEWALK BAND, SMOOTH TROWEL FINISH
- 4 TYPE 1-PCC PAVER AUTUMN BLEND 90° HERRINGBONE PATTERN
- 5 TYPE 2-PCC PAVER PRAIRIE BLEND 90° HERRINGBONE PATTERN
- 6 TYPE 3-PCC PAVER BUFF RUNNING BOND PATTERN
- 7 TYPE 4-PCC PAVER NATURAL BASKETWEAVE PATTERN
- 8 TYPE 5-PCC PAVER CHARCOAL STACKED BOND PATTERN
- 9 DETECTABLE WARNING PAVER
- 10 TYPE 5-PCC PAVER CHARCOAL 90° HERRINGBONE PATTERN
- 11 TYPE 5-PCC PAVER CHARCOAL BASKETWEAVE PATTERN 2 COURSE WIDTH
- 12 TYPE 6-PCC PAVER GOLD BOND PATTERN
- 13 TYPE 5-PCC PAVER CHARCOAL BOND PATTERN

- GENERAL NOTES:
- A DOUBLE ROW STACKED BOND IS TO BE USED ADJACENT TO ALL CONCRETE PAVEMENT. PAVERS TO BE CUT INSIDE THIS STACKED BOND BAND. NO PAVERS TO BE CUT IN THE RUNNING BOND BAND ADJACENT TO CONCRETE.
  - ALL PATTERNS ARE SHOWN FOR DIFFERENTIATING PAVER TYPES. PATTERNS NOT REPRESENTATIVE OF ACTUAL PAVER LAYOUT.

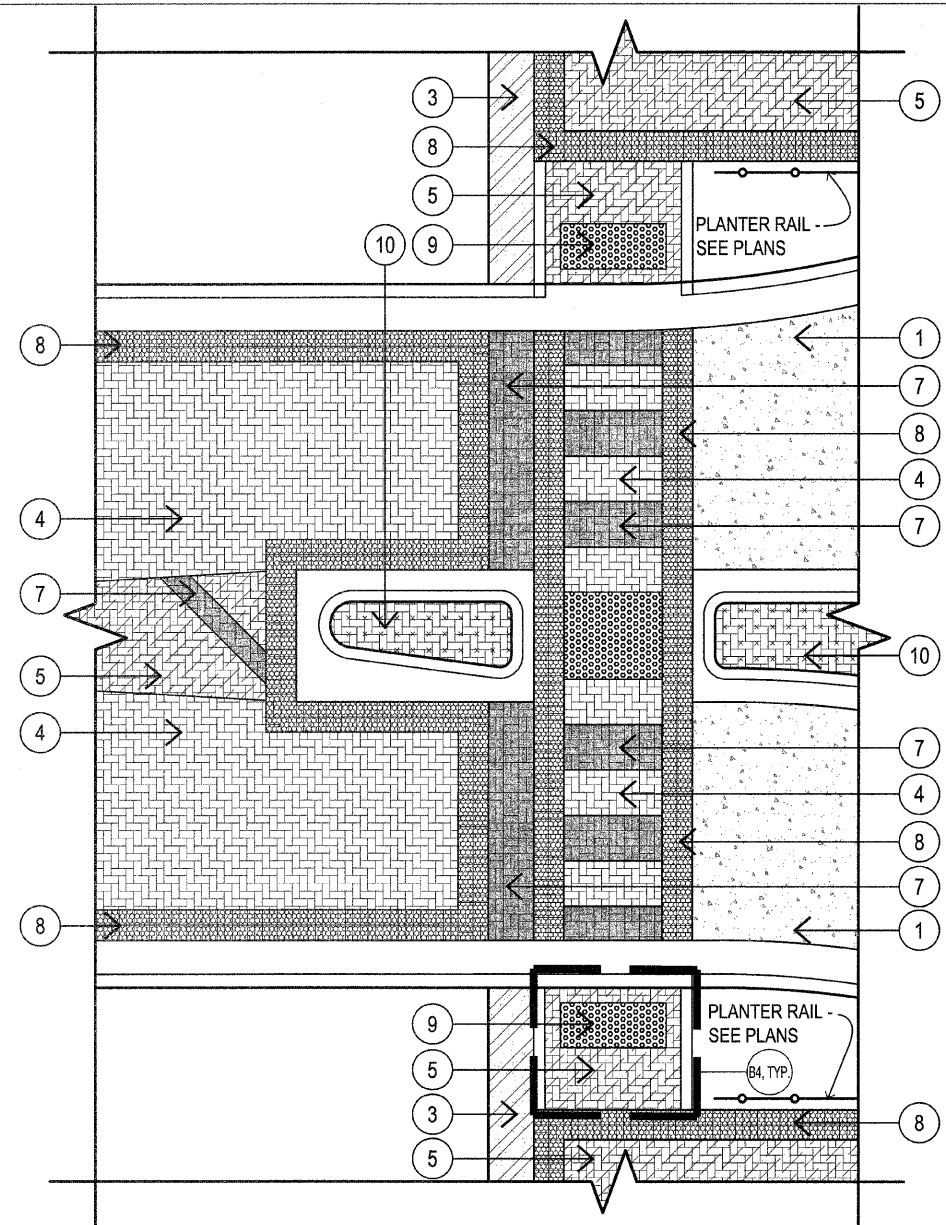

**H2 PLAN: ROAD & MEDIAN STREET PAVEMENT & MARKINGS @ ROUNDABOUT WEST CROSSWALK**  
N.T.S. / DO NOT SCALE

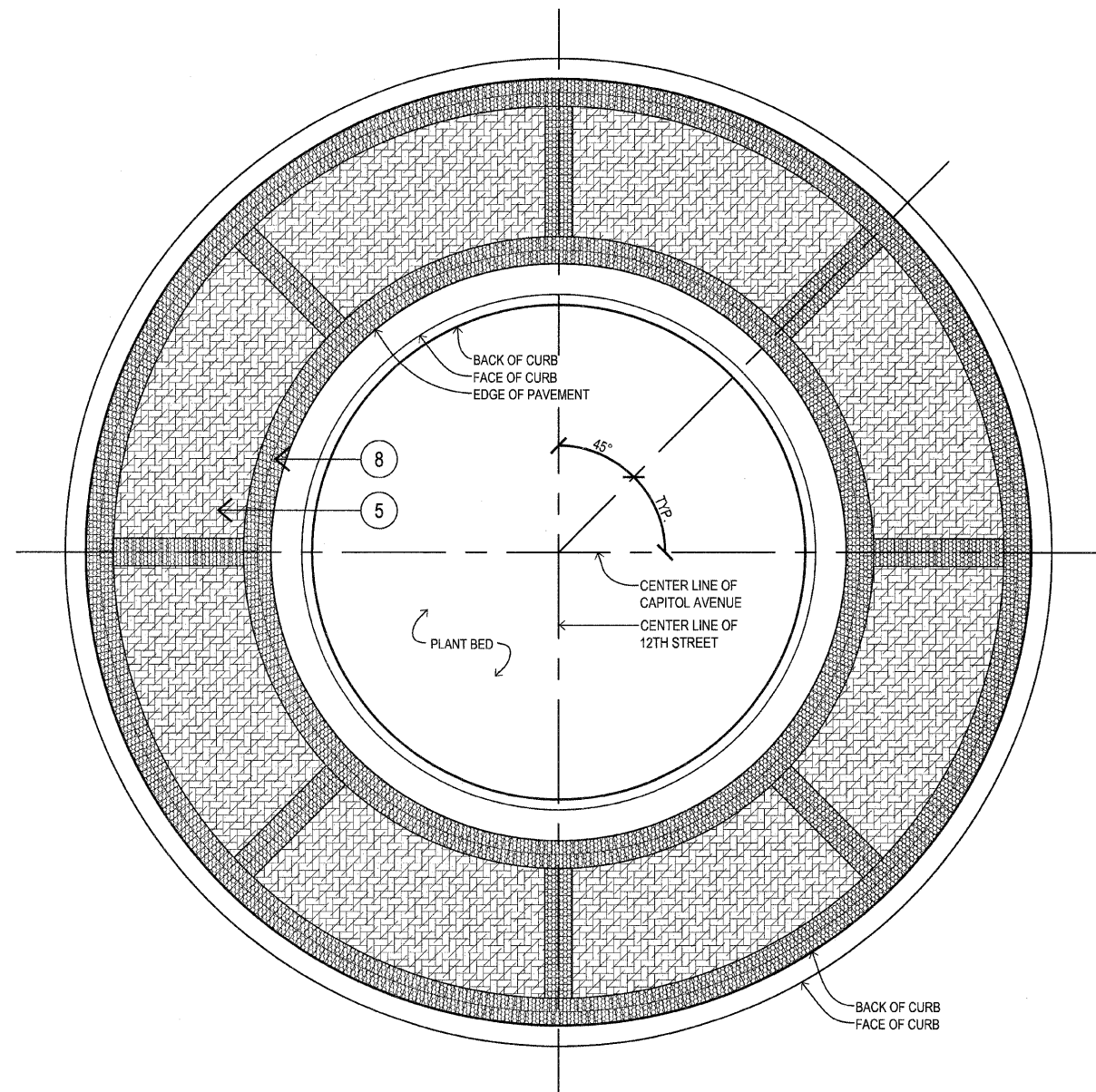

**H3 PLAN: ROUNDABOUT PAVEMENT @ 12TH STREET**  
N.T.S. / DO NOT SCALE

**RDS**  
PLANNING • DESIGN

# 2009-11-16  
 # 102248 (J.L. D'Amico-Pharm)-11th-MK.dwg  
 # VAKES  
 # JAH  
 PLOT DATE  
 FILE NAME  
 PLOT SCALE  
 USER NAME

REVISIONS	
NAME	DATE

ILLINOIS DEPARTMENT OF TRANSPORTATION  
**STREETScape IMPROVEMENT**  
 PLAN ENLARGEMENTS - SHEET H  
 FAU RTE 7982 CAPITOL AVE  
 SEC NO. 10-00447-04-PV  
 SANGAMON COUNTY, ILLINOIS

SCALE: VERT. \_\_\_\_\_  
 DATE: \_\_\_\_\_

DRAWN BY: JM  
 CHECKED BY: PD