

FAU RTE.	SECTION	COUNTY	TOTAL SHEETS	SHEET NO.
7982	10-00447-04-PV	SANGAMON	63	44
STA. TO STA.				
FED. ROAD DIST. NO. ILLINOIS FED. AID PROJECT				

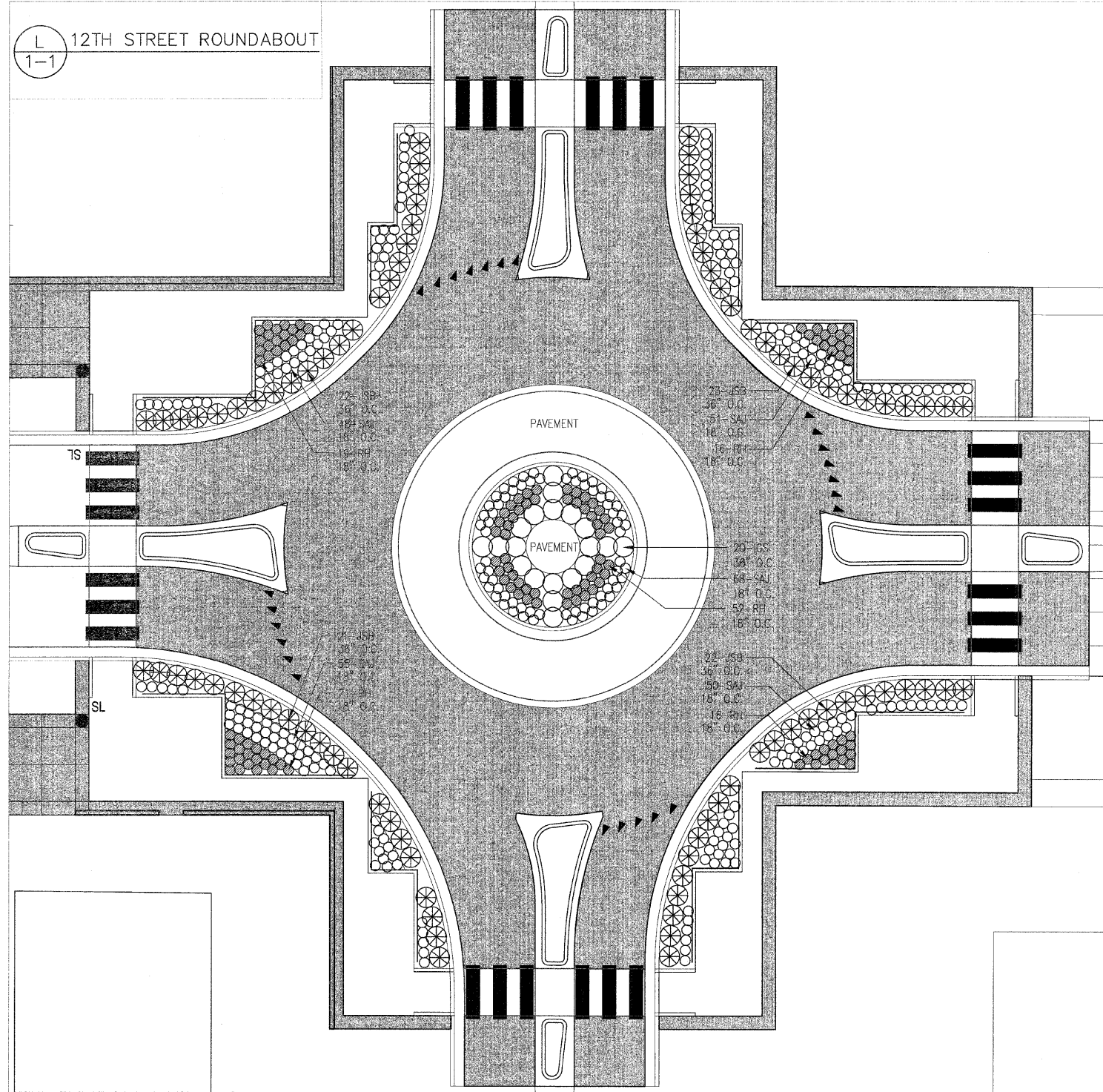

1-2 CAPITOL AVENUE NEAR CORNER (CNC)
PLANTING AREA

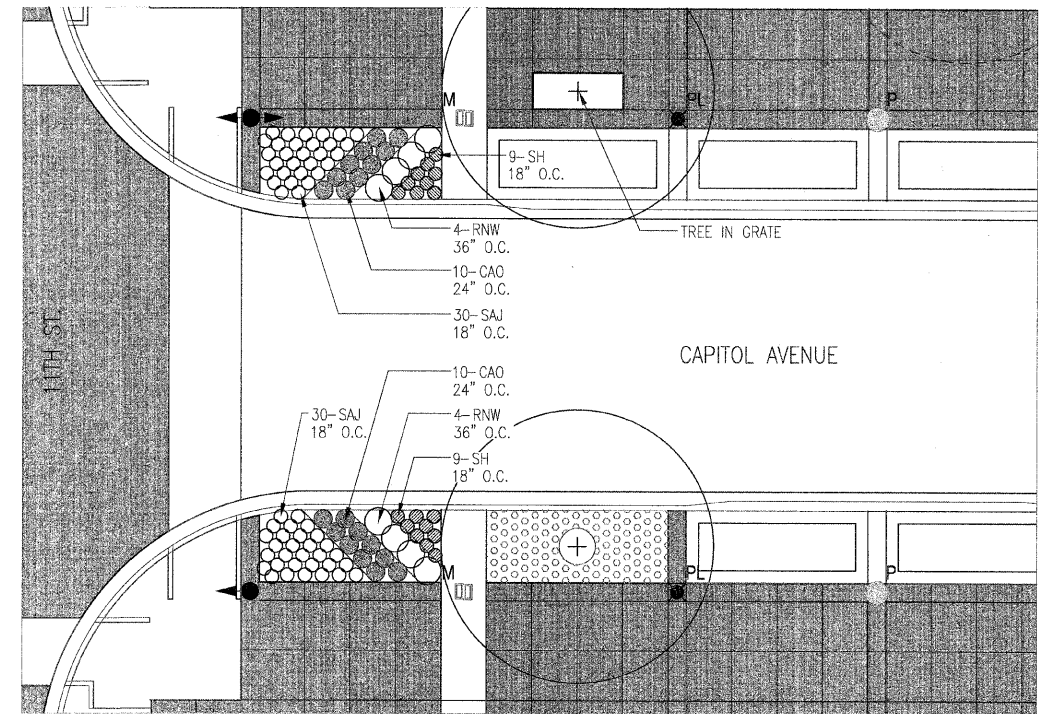

CNC-TYPICAL NEAR CORNER PLANT LIST

QUANTITY	DESIGNATION	BOTANICAL NAME	COMMON NAME	SIZE
SHRUBS				
8	RNW	ROSA 'NEARLY WILD'	NEARLY WILD ROSE	5-GAL. 24" HEIGHT
PERENNIALS AND GROUNDCOVERS				
20	CAO	CALAMAGROSTIS ACUTIFLORA 'OVERDAM'	FEATHER REED GRASS	1-GAL. WELL DEVELOPED
60	SAJ	SEDUM 'AUTUMN JOY'	AUTUMN JOY SEDUM	1-GAL. WELL DEVELOPED
18	SH	SPOROBOLUS HETEROLEPIS	PRAIRIE DROPSEED	1-GAL. WELL DEVELOPED

12TH STREET ROUNDABOUT PLANT SCHEDULE

QUANTITY	DESIGNATION	BOTANICAL NAME	COMMON NAME	SIZE
SHRUBS				
20	IGS	ILEX GLABRA 'SHAMROCK'	SHAMROCK INKBERRY HOLLY	5-GAL. WELL DEVELOPED
PERENNIALS AND GROUNDCOVERS				
88	JSB	JUNIPERUS SABINA 'BUFFALO'	BUFFALO JUNIPER	3-GAL. WELL DEVELOPED
124	RH	RUDBECKIA HIRTA 'GOLDSTRUM'	BLACK-EYED SUSAN	1-GAL. WELL DEVELOPED
272	SAJ	SEDUM X 'AUTUMN JOY'	AUTUMN JOY SEDUM	1-GAL. WELL DEVELOPED

Massie & Massie Associates

1210 S. 5th Street, Springfield, IL 62703 217-544-3210
421 West Main Street, Decatur, IL 62522 217-424-0792

PLOT DATE = 01/12/11
FILE NAME = MMA Capitol Avenue Planting Plan
PLOT SCALE = 1:10
USER NAME =



REVISIONS	
NAME	DATE

ILLINOIS DEPARTMENT OF TRANSPORTATION
1100 BLOCK
PLANTING DETAILS
FAU RTE 7982 CAPITOL AVE
SEC NO. 10-00447-04-PV
SANGAMON COUNTY, ILLINOIS

SCALE: VERT. _____
 HORIZ. _____
DATE _____

DRAWN BY NFB
CHECKED BY KM