

PROPOSED WATERMAIN BELOW EXISTING SEWER LINE WITH 18" MINIMUM SEPERATION.

NOTE: CLASS IV MATERIAL SHALL BE COMPACTED TO 95% OF STANDARD PROCTOR MAXIMUM DENSITY.

GUIDELINES

1. Omit Select Granular Cradle and Granular Backfill to one (1) foot over top of pipe and use Select Excavated Material (Class IV) AND compact for 10 feet on either side of sewer line.
2. If Select Granular Backfill exists, remove within width of existing Sewer line trench and replace with Select Excavated Material (Class IV) and compact.
3. Use a casing for proposed Watermain and seal ends of casing.

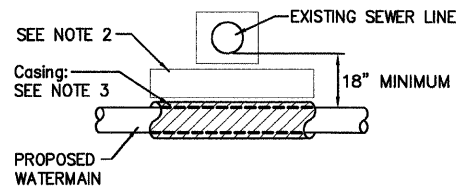

PROPOSED WATERMAIN ABOVE EXISTING SEWER LINE WITH LESS THAN 18" SEPERATION.

NOTE: CLASS IV MATERIAL SHALL BE COMPACTED TO 95% OF STANDARD PROCTOR MAXIMUM DENSITY.

GUIDELINES

1. Omit Select Granular Cradle and Granular Backfill to one (1) foot over top of pipe and use Select Excavated Material (Class IV) AND compact for 10 feet on either side of sewer line.
2. If Select Granular Backfill exists, remove within width of existing Sewer line trench and replace with Select Excavated Material (Class IV) and compact.
3. Use a casing for proposed Watermain and seal ends of casing.
4. Point loads shall not be allowed between watermain or watermain casing and sewer.

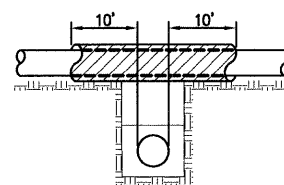

PROPOSED WATERMAIN BELOW EXISTING SEWER LINE WITH LESS THAN 18" MINIMUM SEPERATION.

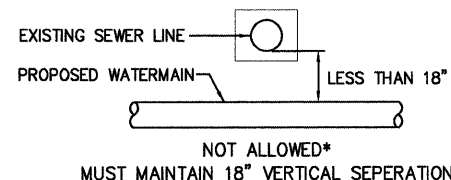

PROPOSED WATERMAIN ABOVE EXISTING SEWER LINE WITH 18" MINIMUM SEPERATION.

NOTE: CLASS IV MATERIAL SHALL BE COMPACTED TO 95% OF STANDARD PROCTOR MAXIMUM DENSITY.

GUIDELINES

1. Omit Select Granular Cradle and Granular Backfill to one (1) foot over top of pipe and use Select Excavated Material (Class IV) AND compact for 10 feet on either side of sewer line.
2. If Select Granular Backfill exists, remove within width of existing Sewer line trench and replace with Select Excavated Material (Class IV) and compact.

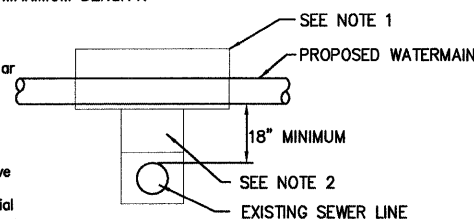

GENERAL NOTES

1. THE STANDARD SPECIFICATIONS FOR WATER AND SEWER MAIN CONSTRUCTION IN ILLINOIS 6TH EDITION SHALL APPLY TO THIS WORK (EXCEPT DIVISION D).
2. THE UTILITY COMPANIES HAVE BEEN NOTIFIED OF THE IMPENDING PROJECT. EXISTING UNDERGROUND UTILITIES WERE NOT FIELD LOCATED FOR THE PREPARATION OF THE PLANS. THE CONTRACTOR SHALL HAVE THE RESPONSIBILITY BEFORE ANY CONSTRUCTION WORK HAS BEGUN, OF OBTAINING FROM ALL UTILITIES THE EXACT LOCATION OF ANY UNDERGROUND FACILITIES IN THE AREA OF CONSTRUCTION, WHETHER INDICATED ON THE PLANS OR NOT. ANY FACILITIES DISTURBED BY THE CONTRACTOR SHALL BE RESTORED BY HIM AT HIS OWN EXPENSE. THE CONTRACTOR SHALL COORDINATE WITH THE PROPER UTILITY THE RELOCATION OF ANY FACILITY DESIGNATED ON THE PLANS OR DEEMED NECESSARY TO BE RELOCATED BY THE ENGINEER IN ORDER TO COMPLETE CONSTRUCTION OF THE PROJECT.
3. WATER MAIN PIPE SHALL BE:
PVC SDR-21 ASTM D2241, JOINTS-SINGLE GASKET RUBBER, ASTM F-477.
4. WATER SUPPLIES SHALL BE PROTECTED PER SECTION 370.350 OF THE ILLINOIS RECOMMENDED STANDARDS FOR SEWAGE WORKS.
5. WATER MAIN SHALL BE PRESSURE TESTED WITH WATER AT 100 PSI FOR ONE HOUR WITHOUT LEAKAGE.

IL 45 TO EAST OF BOX

1 TYPICAL CONCRETE BLOCKING DETAIL

Scale: Not To Scale

FILE NAME = 0019198_WM-DETAILS-west.dgn	USER NAME = #USER#	DESIGNED RJB/ACH	REVISED -	CITY OF EFFINGHAM	RICKELMAN AVE (FAU 8376) SECTION 07-00112-00-PV WATER MAIN GENERAL NOTES AND DETAILS	F.A.U. RTE. 8376	SECTION 07-00112-00-PV	COUNTY EFFINGHAM	TOTAL SHEETS 53	SHEET NO. 30	
PLOT SCALE = #SCALE#	CHECKED - ACH	DRAWN - JTC	REVISED -			SCALE: N.T.S.	SHEET NO. OF SHEETS	STA. 13+80.0	TO STA. 24+60.0	FED. ROAD DIST. NO.	ILLINOIS FED. AID PROJECT
PLOT DATE = 10/19/2010	DATE 10/19/10	CHECKED - ACH	REVISED -			CONTRACT NO. 95635					
		DATE 10/19/10	REVISED -								

FARNSWORTH GROUP, INC.

CONSULTING ENGINEERS - 104 NORTH SECOND STREET, SUITE A, EFFINGHAM, IL 62401 (217)342-5668 / (217)342-5853 FAX