

DATE	10/19/2010
USER	JTC
PROJECT	25+50.00
SCALE	1"=10'
PLotted	10/19/2010
Checked	PJM
Designed	PSA
Drawn	JTC

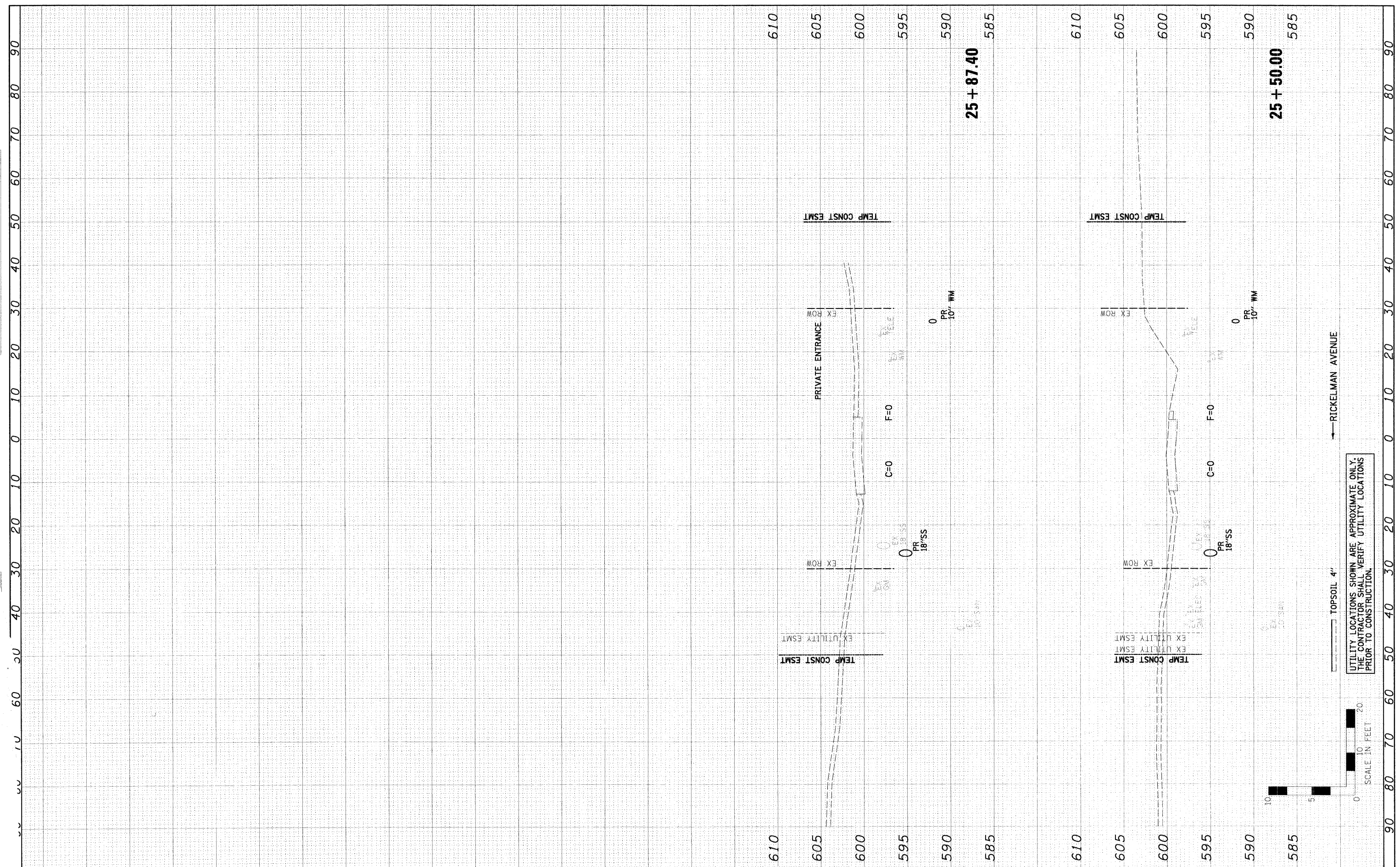

FILE NAME = 198148.vsect-west.dgn	USER NAME = JUSER4	DESIGNED - PSA	REVISED -	CITY OF EFFINGHAM	RICKELMAN AVE (FAU 8376) SECTION 07-00112-00-PV CROSS SECTIONS			F.A.U. RTE. 8376	SECTION 07-00112-00-PV	COUNTY EFFINGHAM	TOTAL SHEETS 53	SHEET NO. 53	
PLLOT SCALE = #SCALE#	CHECKED - PJM	DATE - 10/19/10	REVISED -		SCALE: H=10', V=5'	SHEET NO. OF SHEETS	STA. 25+50.00 TO STA. 25+87.40	FED. ROAD DIST. NO.	ILLINOIS FED. AID PROJECT	CONTRACT NO. 95635			
PLLOT DATE = 10/19/2010	DATE - 10/19/10	REVISED -	REVISED -		UTILITY LOCATIONS SHOWN ARE APPROXIMATE ONLY. THE CONTRACTOR SHALL VERIFY UTILITY LOCATIONS PRIOR TO CONSTRUCTION.								
<table border="0" style="width: 100%;"> <tr> <td style="width: 50%; text-align: center;"> FARNSWORTH GROUP, INC. CONSULTING ENGINEERS - 104 NORTH SECOND STREET, SUITE A, EFFINGHAM, IL 62401 (217)342-5668 / (217)342-5853 FAX </td> <td style="width: 50%; text-align: center;"> ← RICKELMAN AVENUE TOPSOIL 4" </td> </tr> </table>												FARNSWORTH GROUP, INC. CONSULTING ENGINEERS - 104 NORTH SECOND STREET, SUITE A, EFFINGHAM, IL 62401 (217)342-5668 / (217)342-5853 FAX	← RICKELMAN AVENUE TOPSOIL 4"
FARNSWORTH GROUP, INC. CONSULTING ENGINEERS - 104 NORTH SECOND STREET, SUITE A, EFFINGHAM, IL 62401 (217)342-5668 / (217)342-5853 FAX	← RICKELMAN AVENUE TOPSOIL 4"												