

F.A.U. RTE.	SECTION	COUNTY	TOTAL SHEETS	SHEET NO.
8979	05-00017-00-PV	MADISON	37	25
STA. 10+00.00		TO STA. 21+75.00		
FED. ROAD DIST. NO.	ILLINOIS	FEDERAL AID PROJECT		

NOTE:
ALL JOINTS SHALL BE SEALED ACCORDING TO ARTICLE 420.12 OF THE STANDARD SPECIFICATIONS.

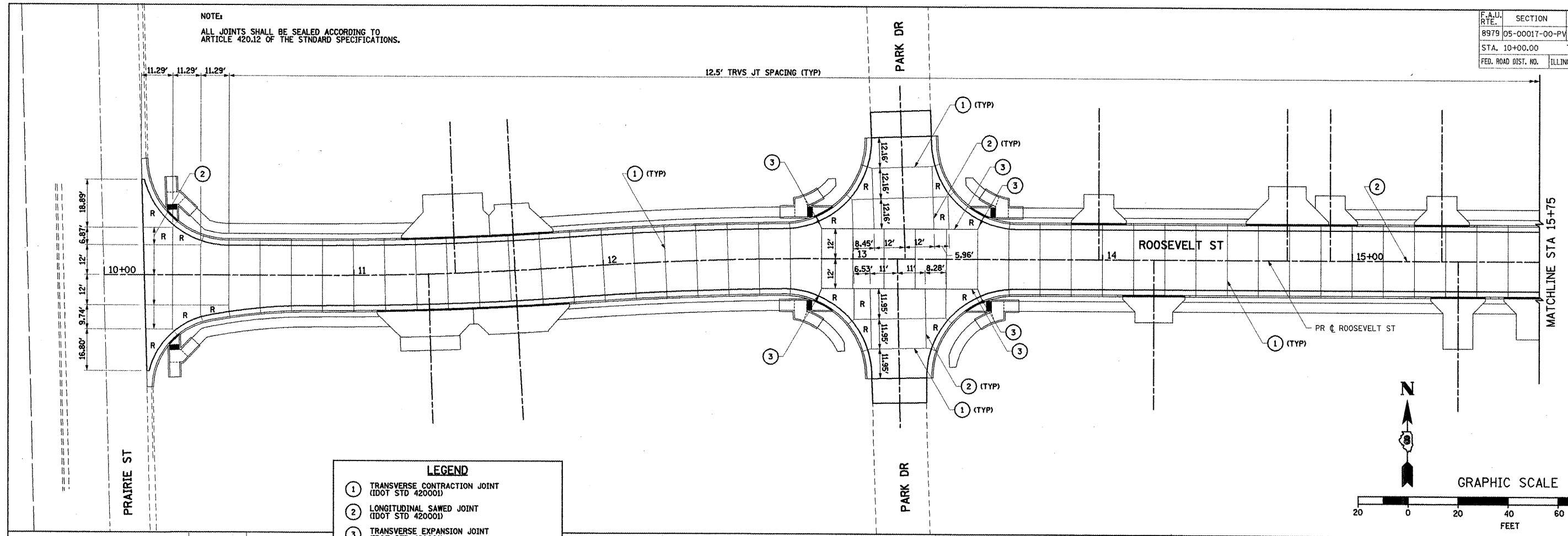

LEGEND

- ① TRANSVERSE CONTRACTION JOINT (DOT STD 420001)
- ② LONGITUDINAL SAWED JOINT (DOT STD 420001)
- ③ TRANSVERSE EXPANSION JOINT (DOT STD 420001)
- ④ EXPANSION JOINT WITH THICKENED EDGE (DOT STD BLR 10)
- ⑤ LONGITUDINAL CONSTRUCTION JOINT WITH TIE BAR GROUTED IN PLACE (DOT STD 420001)
- R PAVEMENT FABRIC (DOT STD 420701)

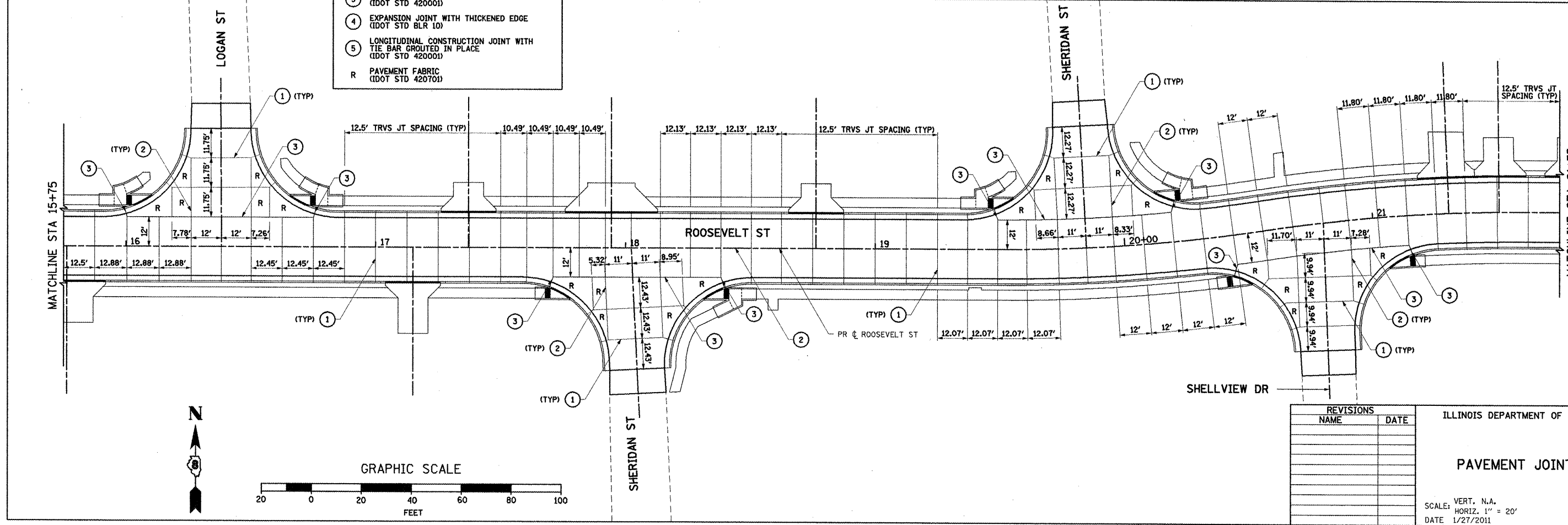

REVISIONS	
NAME	DATE

ILLINOIS DEPARTMENT OF TRANSPORTATION

PAVEMENT JOINTING PLAN

SCALE: VERT. N.A.
HORIZ. 1" = 20'
DATE 1/27/2011

DRAWN BY RJM, AJK
CHECKED BY JWB

PLOT DATE = 1/27/2011
 FILE NAME = I:\11444\11444\05-00017-00-PV\sheet\p15025.dwg
 PLOT SCALE = 42.2633 / IN.
 USER NAME = Rmujj Millanbure