

F.A.S.	SECTION	COUNTY	TOTAL SHEETS	SHEET NO.
880	08-00103-00-RS	HAMILTON	8	3
FED. ROAD DIST. NO. 7		ILLINOIS	BELLE PRAIRIE RD	

SCHEDULE FOR SIGNS & POSTS

STA	LOCATION	MUTCD CODE	STYLE	SIZE	SQ. FT.	METAL POST TYPE A LENGTH
57+60	23' RT	W1-2R	CURVE, RT	30"x30"	6.25	12'
		W13-1P	40 MPH	18"x18"	2.25	
70+82	23' LT	W1-2L	CURVE, LT	30"x30"	6.25	12'
		W13-1P	40 MPH	18"x18"	2.25	
179+67	23' RT	W1-4L	REV CURVE	30"x30"	6.25	12'
		W13-1P	40 MPH	18"x18"	2.25	
204+30	23' LT	W1-4L	REV CURVE	30"x30"	6.25	12'
		W13-1P	40 MPH	18"x18"	2.25	
TOTAL					34.00	48'

SCHEDULE OF PAVEMENT MARKINGS

STATION TO STATION	LOCATION	LENGTH (FOOT)
CENTERLINE		
0+50	62+50	CL 1550
66+00	184+00	CL 2350
EDGE LINE LEFT		
0+00	64+02	LT 6402
64+42	115+09	LT 5067
115+49	140+86	LT 2537
141+26	202+50	LT 6124
EDGE LINE RIGHT		
0+50	115+09	RT 11509
115+49	167+32	RT 5183
167+72	202+50	RT 3478
NO PASSING		
53+50	66+00	RT 1250
62+50	75+00	LT 1250
96+25	102+25	RT 600
105+25	111+25	LT 600
142+25	148+00	RT 575
151+50	157+00	LT 550
175+50	202+50	RT 2700
184+00	202+50	LT 1850
TOTAL "PAVEMENT MARKING - LINE 4" = 54125		

SCHEDULE OF SIDE ROADS & PRIVATE ENTRANCES

STATION	LOCATION	TYPE	QNTY (TON)
2+41	RT	PE	2.1
51+65	LT	PE	2.4
56+71	RT	PE	2.1
64+22	LT	SR	14.0
75+67	LT	PE	1.8
103+11	RT	PE	5.2
105+11	RT	PE	5.2
115+29	LT/RT	SR	28.0
136+16	LT	PE	4.1
138+60	LT	PE	2.1
141+06	LT	SR	14.0
148+55	LT	PE	2.4
167+52	RT	SR	14.0
180+60	LT	PE	1.8
197+61	LT	PE	2.1
TOTAL =			101.6 (TON)

HOT-MIX ASPHALT SURFACE COURSE, MIX "C", N50 (INCLUDED)

SCHEDULE OF PAVEMENT REMOVAL & REPLACEMENT (SPECIAL)

STATION	STATION	LOCATION	WIDTH (FT)	SQ. YD.	TON
22+81	23+06	6' LT	3.0'	8.3	3.7
23+41	23+71	7' LT	2.5'	8.3	3.7
24+51	24+86	6' LT	4.0'	15.6	7.0
25+18	25+38	4' LT	3.0'	6.7	3.0
48+74	49+29	LT EDGE	5.0'	30.5	13.7
49+41	49+81	6' LT	3.0'	13.3	6.0
50+79	51+19	6' LT	3.0'	13.3	6.0
109+12	111+02	9' LT	4.0'	84.4	37.8
111+02	114+62	6' LT	3.0'	120.0	53.8
130+82	131+92	6.5' RT	3.0'	23.3	10.4
TOTALS =				323.7	145.1

THIS QUANTITY IS INCLUDED IN THE "PAVEMENT REMOVAL AND REPLACEMENT (SPECIAL)" ITEM OF THE SUMMARY OF QUANTITIES.

SCHEDULE OF MAILBOX TURNOUTS

STATION	LOCATION	QNTY (TON)
51+40	LT	2.5
56+55	RT	2.5
103+10	LT	2.5
103+10	LT	2.5
137+35	LT	2.5
148+70	LT	2.5
180+70	LT	2.5
197+40	LT	2.5
TOTAL =		17.5

HOT-MIX ASPHALT SURFACE COURSE, MIX "C", N50 (INCLUDED)

SCHEDULE FOR SUPERELEVATION RATES

CURVE #1	TANGENT RUNOUT BEGINS	STA 52+21.97
	S.E. RUNOFF BEGINS	STA 52+54.23
	FULL S.E. BEGINS	STA 53+14.93
	FULL S.E. ENDS	STA 54+74.47
	S.E. RUNOFF ENDS	STA 55+35.17
	TANGENT RUNOUT ENDS	STA 55+67.43
	S.E. RATE =	0.0294 FT/FT
CURVE #2	TANGENT RUNOUT BEGINS	STA 55+92.59
	S.E. RUNOFF BEGINS	STA 56+24.99
	FULL S.E. BEGINS	STA 56+79.52
	FULL S.E. ENDS	STA 58+43.16
	S.E. RUNOFF ENDS	STA 58+97.69
	TANGENT RUNOUT ENDS	STA 59+30.09
	S.E. RATE =	0.0263 FT/FT
CURVE #3	TANGENT RUNOUT BEGINS	STA 59+18.35
	S.E. RUNOFF BEGINS	STA 59+50.88
	FULL S.E. BEGINS	STA 61+15.88
	FULL S.E. ENDS	STA 67+27.59
	S.E. RUNOFF ENDS	STA 68+92.59
	TANGENT RUNOUT ENDS	STA 69+24.82
	S.E. RATE =	0.08 FT/FT
CURVE #4	TANGENT RUNOUT BEGINS	STA 181+25.63
	S.E. RUNOFF BEGINS	STA 181+57.86
	FULL S.E. BEGINS	STA 183+22.86
	FULL S.E. ENDS	STA 189+50.55
	S.E. RUNOFF ENDS	STA 191+15.55
	TANGENT RUNOUT ENDS	STA 191+47.78
	S.E. RATE =	0.08 FT/FT
CURVE #5	TANGENT RUNOUT BEGINS	STA 192+48.96
	S.E. RUNOFF BEGINS	STA 192+81.19
	FULL S.E. BEGINS	STA 194+46.19
	FULL S.E. ENDS	STA 200+75.37
	S.E. RUNOFF ENDS	STA 202+40.37
	TANGENT RUNOUT ENDS	STA 202+72.60
	S.E. RATE =	0.08 FT/FT

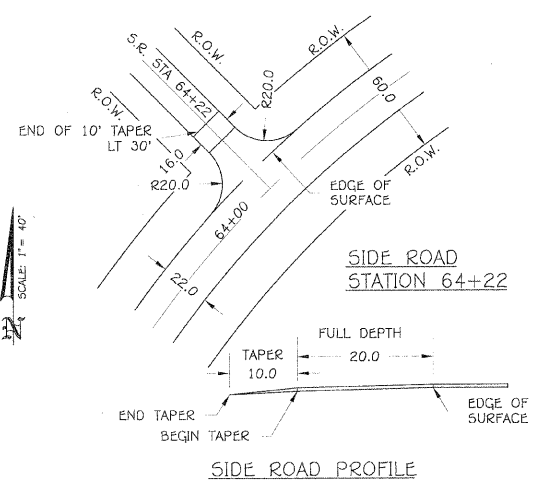

HOT-MIX ASPHALT SURFACE COURSE, MIX "C", N50 = 14.00 TON (INCLUDED)

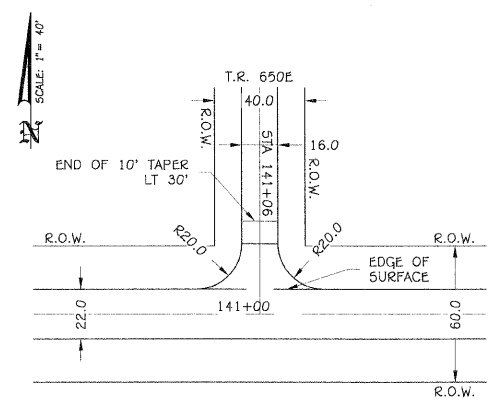

HOT-MIX ASPHALT SURFACE COURSE, MIX "C", N50 = 14.00 TON (INCLUDED)

**HAMILTON COUNTY
HIGHWAY DEPARTMENT**

100 SOUTH JACKSON, McLEANSBORO, ILLINOIS
engineer@hiltonco.us
(618) 643-2714

EXPIRES 11/30/2011

Signature: *Kevin Phillips*

Date: 2/24/2011

**FAS 880 (CH 8)
BELLE PRAIRIE ROAD
08-00103-00-RS
HAMILTON COUNTY, ILLINOIS**

SHEET TITLE: SCHEDULES & DETAILS

Date: 1/6/2011

Rev. Date:

Scale: N.T.S.

Sheet: **3**