





TEMPORARY SEEDING NOTE

THE GRADING LIMITS ARE SHOWN ON THE STAKING PLAN SHEETS BY A HEAVY DASHED LINE (- - -). ALL AREAS WITHIN THESE LIMITS, AND THE LIMITS OF THE PROPOSED CLEARING AND GRUBBING, EXCEPT THE PROPOSED PAVEMENT, SHALL BE LIMED, FERTILIZED AND SEEDED IN ACCORDANCE WITH THE FOLLOWING FORMULA AND RATES OF APPLICATION.

SEEDING (MINIMUM POUNDS OF PURE LIVE SEED PER ACRE)
 PERENNIAL RYEGRASS _____ 50
 SPRING OATS* _____ 64
 *OTHER SEEDS MAY BE USED IF APPROVED BY THE ENGINEER.
 AREA TO BE SEEDED _____ 43.7 ACRES
 DATE SEEDING COMPLETED _____

LEGEND

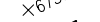
-  EXISTING PAVEMENT
-  PROPOSED PAVEMENT
-  PROPOSED GRADING AND SEEDING LIMITS
-  PROPOSED RCCP
-  EXISTING GRADE
-  PROPOSED GRADE

TAXIWAY B INTERSECTION DATA

PROPOSED N-S RUNWAY STA. 116+01.03
 EXISTING TAXIWAY B STA. 409+19.63

E-W RUNWAY INTERSECTION DATA

PROPOSED N-S RUNWAY STA. 120+01.04
 EXISTING E-W RUNWAY STA. 126+70.00

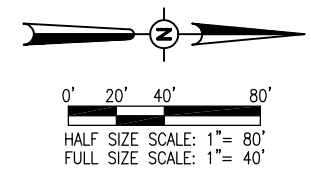
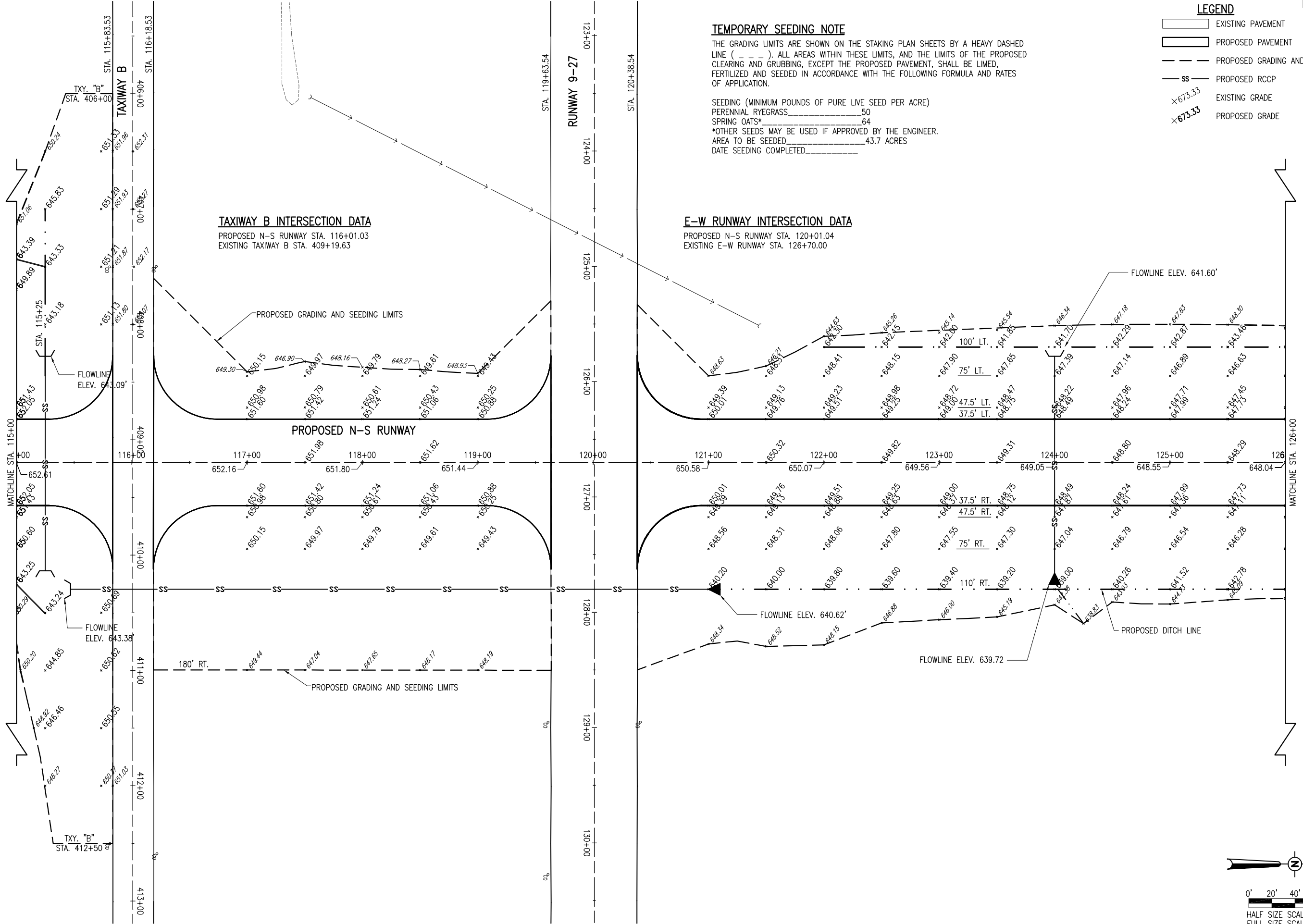

<p>CONSTRUCT CROSSWIND RUNWAY 18-36</p> <p>PROPOSED STAKING PLAN STA. 115+00 TO STA. 126+00</p>	<p>HANSON Professional Services Inc. 1526 South Sixth Street Springfield, Illinois 62703-2886 www.hanson-inc.com Offices Nationwide</p>									
<p>Hanson Proj. No. 10A0053 Filename R-191STK.DWG Scale 1" = 40' Date 03/10/11</p>										
<table border="1" style="width: 100%; border-collapse: collapse;"> <tr> <td>LAYOUT</td> <td>BAK</td> <td>01/04/11</td> </tr> <tr> <td>DRAWN</td> <td>BAK</td> <td>01/04/11</td> </tr> <tr> <td>REVIEWED</td> <td>CAH</td> <td>xx/xx/xx</td> </tr> </table>		LAYOUT	BAK	01/04/11	DRAWN	BAK	01/04/11	REVIEWED	CAH	xx/xx/xx
LAYOUT	BAK	01/04/11								
DRAWN	BAK	01/04/11								
REVIEWED	CAH	xx/xx/xx								
<p>17</p> <p>17 of 137 sheets</p>										

**EDGAR COUNTY AIRPORT
 PARIS, ILLINOIS**

ILL. PROJ.: PRG-4018
 A.I.P. PROJ.: 3-17-0077-B13