

MAR 11, 2011 10:34 AM RINKED0461 C:\P\WSE_WORK\DO_NOT_DELETE\DMST8063\RP-131DRN_L1.DWG

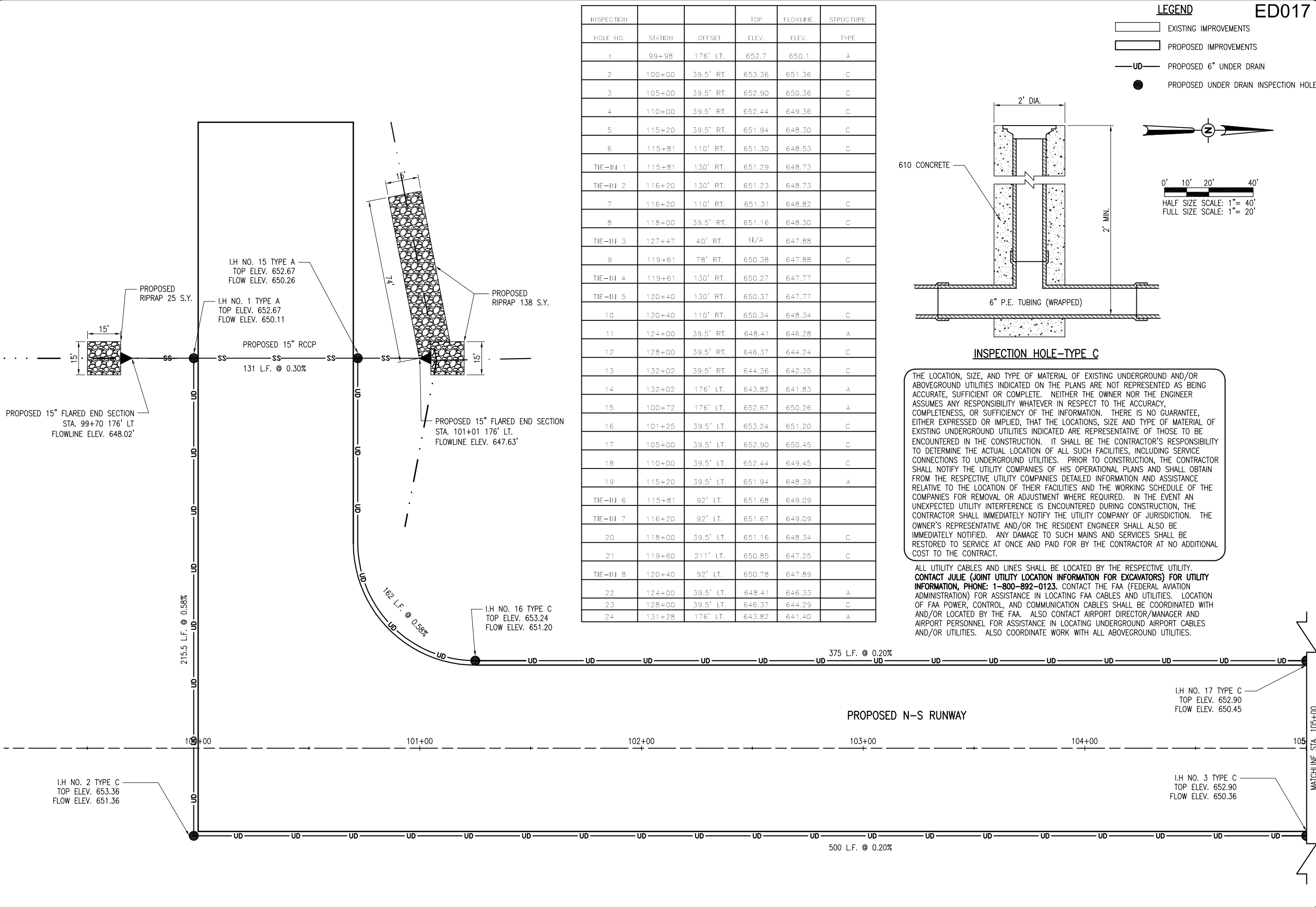

INSPECTION			TOP	FLOWLINE	STRUCTURE
HOLE NO.	STATION	OFFSET	ELEV.	ELEV.	TYPE
1	99+98	176' LT.	652.7	650.1	A
2	100+00	39.5' RT.	653.36	651.36	C
3	105+00	39.5' RT.	652.90	650.36	C
4	110+00	39.5' RT.	652.44	649.36	C
5	115+20	39.5' RT.	651.94	648.30	C
6	115+81	110' RT.	651.30	648.53	C
TIE-IN 1	115+81	130' RT.	651.29	648.73	
TIE-IN 2	116+20	130' RT.	651.23	648.73	
7	116+20	110' RT.	651.31	648.82	C
8	118+00	39.5' RT.	651.16	648.30	C
TIE-IN 3	127+47	40' RT.	N/A	647.88	
9	119+61	78' RT.	650.38	647.88	C
TIE-IN 4	119+61	130' RT.	650.27	647.77	
TIE-IN 5	120+40	130' RT.	650.37	647.77	
10	120+40	110' RT.	650.34	648.34	C
11	124+00	39.5' RT.	648.41	646.28	A
12	128+00	39.5' RT.	646.37	644.24	C
13	132+02	39.5' RT.	644.36	642.35	C
14	132+02	176' LT.	643.82	641.83	A
15	100+72	176' LT.	652.67	650.26	A
16	101+25	39.5' LT.	653.24	651.20	C
17	105+00	39.5' LT.	652.90	650.45	C
18	110+00	39.5' LT.	652.44	649.45	C
19	115+20	39.5' LT.	651.94	648.39	A
TIE-IN 6	115+81	92' LT.	651.68	649.09	
TIE-IN 7	116+20	92' LT.	651.67	649.09	
20	118+00	39.5' LT.	651.16	648.34	C
21	119+60	211' LT.	650.85	647.25	C
TIE-IN 8	120+40	92' LT.	650.78	647.89	
22	124+00	39.5' LT.	648.41	646.33	A
23	128+00	39.5' LT.	646.37	644.29	C
24	131+28	176' LT.	643.82	641.40	A

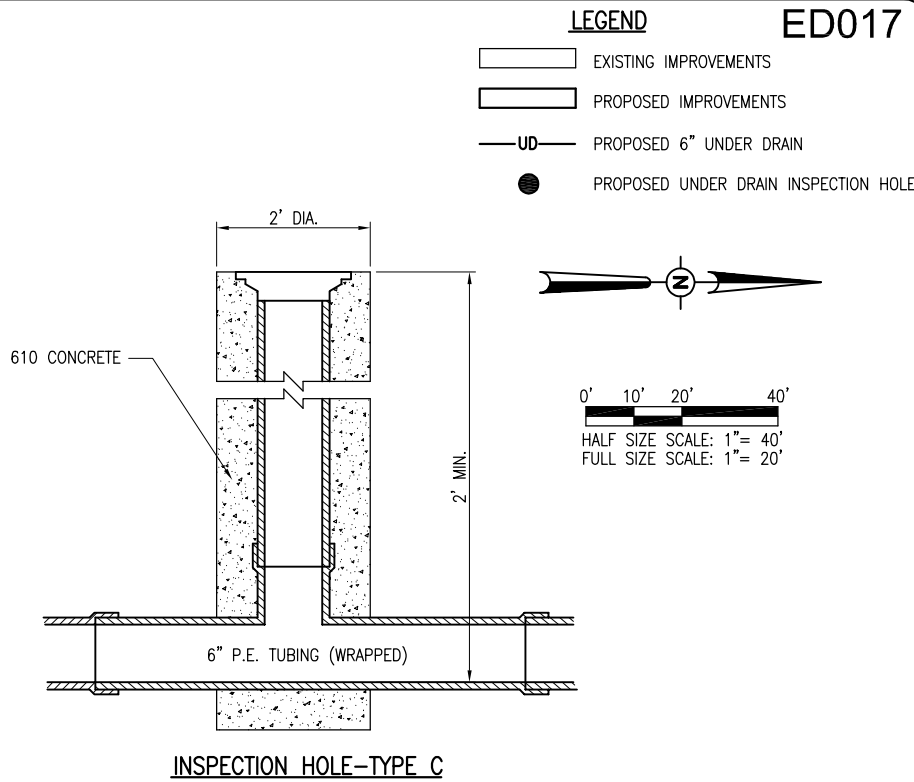

INSPECTION HOLE-TYPE C

THE LOCATION, SIZE, AND TYPE OF MATERIAL OF EXISTING UNDERGROUND AND/OR ABOVEGROUND UTILITIES INDICATED ON THE PLANS ARE NOT REPRESENTED AS BEING ACCURATE, SUFFICIENT OR COMPLETE. NEITHER THE OWNER NOR THE ENGINEER ASSUMES ANY RESPONSIBILITY WHATEVER IN RESPECT TO THE ACCURACY, COMPLETENESS, OR SUFFICIENCY OF THE INFORMATION. THERE IS NO GUARANTEE, EITHER EXPRESSED OR IMPLIED, THAT THE LOCATIONS, SIZE AND TYPE OF MATERIAL OF EXISTING UNDERGROUND UTILITIES INDICATED ARE REPRESENTATIVE OF THOSE TO BE ENCOUNTERED IN THE CONSTRUCTION. IT SHALL BE THE CONTRACTOR'S RESPONSIBILITY TO DETERMINE THE ACTUAL LOCATION OF ALL SUCH FACILITIES, INCLUDING SERVICE CONNECTIONS TO UNDERGROUND UTILITIES. PRIOR TO CONSTRUCTION, THE CONTRACTOR SHALL NOTIFY THE UTILITY COMPANIES OF HIS OPERATIONAL PLANS AND SHALL OBTAIN FROM THE RESPECTIVE UTILITY COMPANIES DETAILED INFORMATION AND ASSISTANCE RELATIVE TO THE LOCATION OF THEIR FACILITIES AND THE WORKING SCHEDULE OF THE COMPANIES FOR REMOVAL OR ADJUSTMENT WHERE REQUIRED. IN THE EVENT AN UNEXPECTED UTILITY INTERFERENCE IS ENCOUNTERED DURING CONSTRUCTION, THE CONTRACTOR SHALL IMMEDIATELY NOTIFY THE UTILITY COMPANY OF JURISDICTION. THE OWNER'S REPRESENTATIVE AND/OR THE RESIDENT ENGINEER SHALL ALSO BE IMMEDIATELY NOTIFIED. ANY DAMAGE TO SUCH MAINS AND SERVICES SHALL BE RESTORED TO SERVICE AT ONCE AND PAID FOR BY THE CONTRACTOR AT NO ADDITIONAL COST TO THE CONTRACT.

ALL UTILITY CABLES AND LINES SHALL BE LOCATED BY THE RESPECTIVE UTILITY. **CONTACT JULIE (JOINT UTILITY LOCATION INFORMATION FOR EXCAVATORS) FOR UTILITY INFORMATION, PHONE: 1-800-892-0123.** CONTACT THE FAA (FEDERAL AVIATION ADMINISTRATION) FOR ASSISTANCE IN LOCATING FAA CABLES AND UTILITIES. LOCATION OF FAA POWER, CONTROL, AND COMMUNICATION CABLES SHALL BE COORDINATED WITH AND/OR LOCATED BY THE FAA. ALSO CONTACT AIRPORT DIRECTOR/MANAGER AND AIRPORT PERSONNEL FOR ASSISTANCE IN LOCATING UNDERGROUND AIRPORT CABLES AND/OR UTILITIES. ALSO COORDINATE WORK WITH ALL ABOVEGROUND UTILITIES.

REVISION	DATE			
EDGAR COUNTY AIRPORT PARIS, ILLINOIS				
A.I.P. PROJ.: 3-17-0077-B13				
IL PROJ.: PRG-4018				
Hanson Proj. No.	10A0053	LAYOUT	BAK	01/10/11
Filename	R-131DRN_1.DWG	DRAWN	BAK	01/10/11
Scale	NOT TO SCALE	REVIEWED	xx	xx/xx/xx
Date	03/10/11			
HANSON Professional Services Inc. 1525 South Sixth Street Springfield, Illinois 62703-2886 www.hanson-inc.com Offices Nationwide				
CONSTRUCT CROSSWIND RUNWAY 18-36				
PROPOSED DRAINAGE PLAN STA. 100+00 TO STA. 105+00				
27 27 of 137 sheets				