

STATE OF ILLINOIS
DEPARTMENT OF TRANSPORTATION

F.A.P. RTE.	SECTION	COUNTY	TOTAL SHEETS	SHEET NO.
749	(120)	DOUGLAS	6	1
		ILLINOIS	CONTRACT NO. 70F80	

FOR INDEX OF SHEETS SEE SHEET NO. 2
FOR SUMMARY OF QUANTITIES SEE SHEET NO. 3

PROPOSED HIGHWAY PLANS

F.A.P. ROUTE 749 (IL 133)
SECTION (120)
SHOULDER REPAIR
DOUGLAS COUNTY

TRAFFIC DATA

FAP RTE. 749 (IL 133)

	LEG "A"	LEG "B"
2022 ADT =	6,350	4,850
PV % =	87.4%	85.1%
SU % =	6.7%	7.2%
MU % =	5.9%	7.7%

TRAFFIC DATA LOCATIONS

LEG "A" = VINE ST TO CEDAR LN
LEG "B" = CEDAR LN TO TR 8A (100E)

FUNCTIONAL CLASSIFICATION
MINOR ARTERIAL

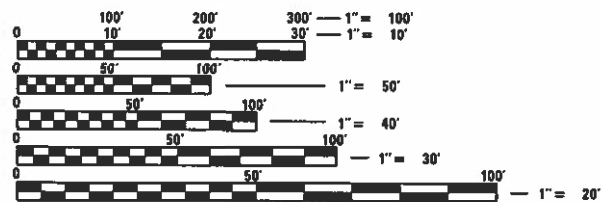

FULL SIZE PLANS HAVE BEEN PREPARED USING STANDARD ENGINEERING SCALES. REDUCED SIZED PLANS WILL NOT CONFORM TO STANDARD SCALES. IN MAKING MEASUREMENTS ON REDUCED PLANS, THE ABOVE SCALES MAY BE USED.

J.U.L.I.E.
JOINT UTILITY LOCATION INFORMATION FOR EXCAVATORS
1-800-892-0123
OR 811 BOURBON TOWNSHIP

PROJECT ENGINEER: RYAN CARROLL
SQUAD LEADER: SAMUEL MEGLI
PHONE NUMBER: 217-465-4181
CONTRACT NO. 70F80

GROSS LENGTH = 5808.00 FT. = 1.100 MILE
NET LENGTH = 5808.00 FT. = 1.100 MILE

C-95-031-22
VINE ST TO CR 100E

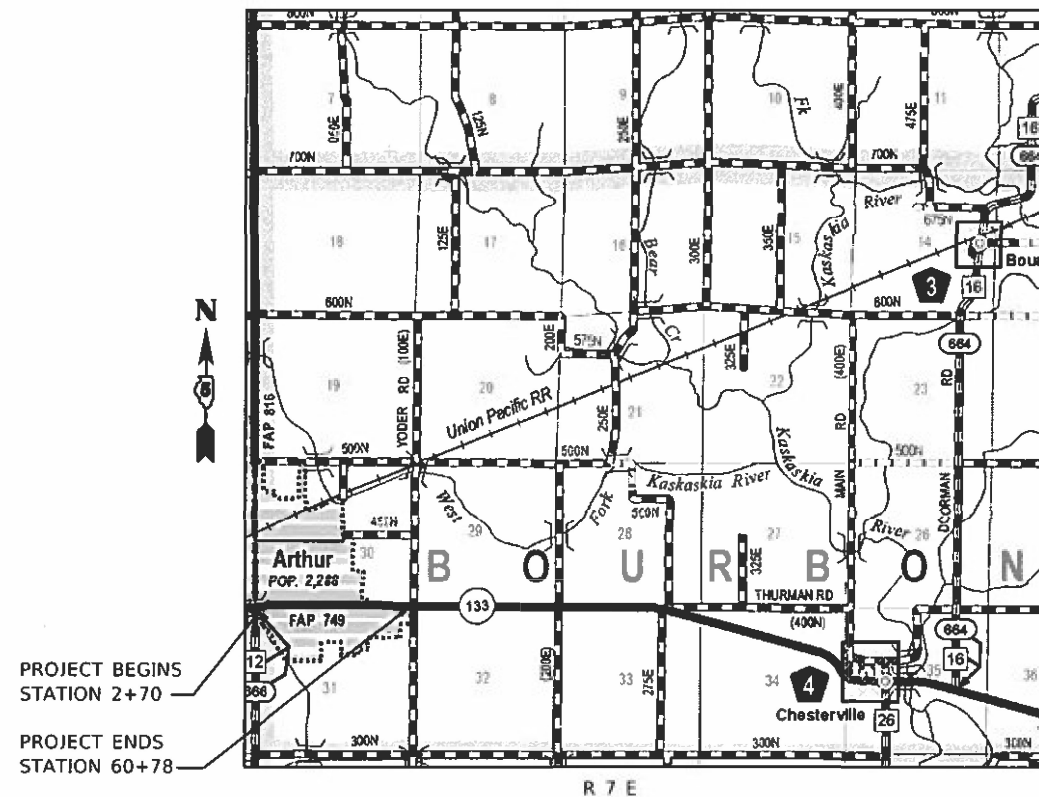

PROJECT BEGINS
STATION 2+70
PROJECT ENDS
STATION 60+78

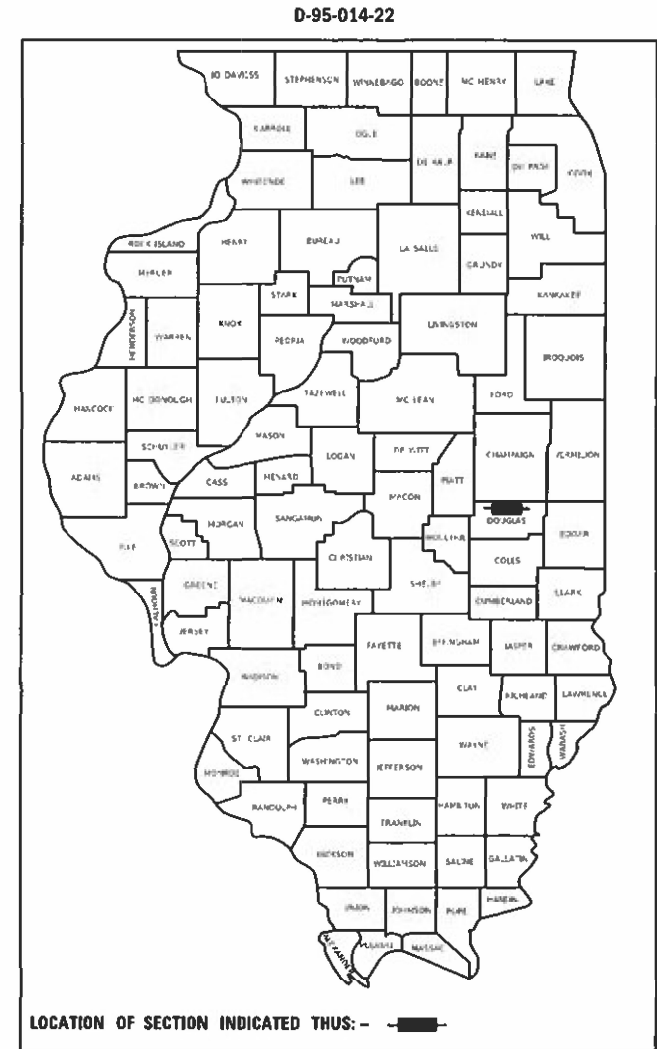

STATE OF ILLINOIS
DEPARTMENT OF TRANSPORTATION

SUBMITTED 1/25 20 22
Kensila A. Barnett REGIONAL ENGINEER

March 25 20 22
Stephen M. Smith ENGINEER OF DESIGN AND ENVIRONMENT

March 25 20 22
Stephen M. Smith DIRECTOR OF HIGHWAYS PROJECT IMPLEMENTATION

PRINTED BY THE AUTHORITY
OF THE STATE OF ILLINOIS

INDEX OF SHEETS

DESCRIPTION	SHEET NO.
COVER	1
INDEX OF SHEETS, LIST OF STANDARDS, GENERAL NOTES & COMMITMENTS	2
SUMMARY OF QUANTITIES	3
TYPICAL CROSS-SECTIONS	4
SCHEDULES OF QUANTITIES	5
ALIGNMENT, TIES, AND BENCHMARKS	6

GENERAL NOTES

G.N.-100A
ELECTRONIC FILES AND/OR ELECTRONIC SURVEY INFORMATION INCLUDING CADD FILES WILL NOT BE AVAILABLE TO THE CONTRACTOR.

G.N.-105.09A
ALL ELEVATIONS SHOWN IN THE PLANS ARE BASED ON NORTH AMERICAN VERTICAL DATUM OF 1988. (NAVD 88)

G.N. -406H

MIXTURE REQUIREMENTS

THE FOLLOWING MIXTURE REQUIREMENTS ARE APPLICABLE FOR THIS PROJECT:

LOCATION(S):	IL 133
MIXTURE USE(S):	BUGGY SHOULDER (ONE 2-1/4" LIFT)
AC/PG:	SBS PG 70-22
DESIGN AIR VOIDS	4.0% @ Ndes=90
MIXTURE COMP (GRADATION)	IL-9.5
FRICTION AGGREGATE	*
MIXTURE WEIGHT	112
QUALITY MANAGEMENT PROGRAM	QC/QA
SUBLLOT SIZE	N.A.
MATERIAL TRANSFER DEVICE (REQUIRED)	NO

* SEE "HMA SHOULDERS, SPECIAL" FOR AGGREGATE REQUIREMENT

LIST OF STANDARDS

STANDARD NO.	DESCRIPTION
000001-08	STANDARD SYMBOLS, ABBREVIATIONS AND PATTERNS
001006	DECIMAL OF AN INCH AND OF A FOOT
701001-02	OFF-ROAD OPERATIONS, 2L, 2W, MORE THAN 15' (4.5 M) AWAY
701006-05	OFF-ROAD OPERATIONS, 2L, 2W, 15' (4.5 M) TO 24" (600 MM) FROM PAVEMENT
701011-04	OFF-ROAD MOVING OPERATIONS, 2L, 2W, DAY ONLY
701301-04	LANE CLOSURE, 2L, 2W, SHORT TIME OPERATIONS
701306-04	LANE CLOSURE, 2L, 2W, SLOW MOVING OPERATIONS DAY ONLY, FOR SPEEDS ≥ 45
701501-06	URBAN LANE CLOSURE, 2L, 2W, UNDIVIDED
701901-08	TRAFFIC CONTROL DEVICES

COMMITMENTS

THERE ARE NO COMMITMENTS FOR THIS CONTRACT

MODEL: I:\MODEL\MHFE
 FILE: MHFE.dwg
 PLOT DATE: 01/25/22
 PLOT SCALE: 1/4" = 1'-0"
 PLOT SIZE: 11x17
 PLOT ORIENT: L
 PLOT RANGE: 0,0,0,0
 PLOT CENTER: 0,0,0,0
 PLOT OFFSET: 0,0,0,0
 PLOT TITLE: INDEX OF SHEETS, LIST OF STANDARDS, GENERAL NOTES & COMMITMENTS
 PLOT USER: meglisk
 PLOT PLOTTER: HP DesignJet T1100e
 PLOT PLOTTER_DRIVER: HPGL-ETL
 PLOT PLOTTER_OPTIONS: /r /s /m /n /p /t /u /v /w /x /y /z /aa /ab /ac /ad /ae /af /ag /ah /ai /aj /ak /al /am /an /ao /ap /aq /ar /as /at /au /av /aw /ax /ay /az /ba /bb /bc /bd /be /bf /bg /bh /bi /bj /bk /bl /bm /bn /bo /bp /bq /br /bs /bt /bu /bv /bw /bx /by /bz /ca /cb /cc /cd /ce /cf /cg /ch /ci /cj /ck /cl /cm /cn /co /cp /cq /cr /cs /ct /cu /cv /cw /cx /cy /cz /da /db /dc /dd /de /df /dg /dh /di /dj /dk /dl /dm /dn /do /dp /dq /dr /ds /dt /du /dv /dw /dx /dy /dz /ea /eb /ec /ed /ee /ef /eg /eh /ei /ej /ek /el /em /en /eo /ep /eq /er /es /et /eu /ev /ew /ex /ey /ez /fa /fb /fc /fd /fe /ff /fg /fh /fi /fj /fk /fl /fm /fn /fo /fp /fq /fr /fs /ft /fu /fv /fw /fx /fy /fz /ga /gb /gc /gd /ge /gf /gg /gh /gi /gj /gk /gl /gm /gn /go /gp /gq /gr /gs /gt /gu /gv /gw /gx /gy /gz /ha /hb /hc /hd /he /hf /hg /hh /hi /hj /hk /hl /hm /hn /ho /hp /hq /hr /hs /ht /hu /hv /hw /hx /hy /hz /ia /ib /ic /id /ie /if /ig /ih /ii /ij /ik /il /im /in /io /ip /iq /ir /is /it /iu /iv /iw /ix /iy /iz /ja /jb /jc /jd /je /jf /jg /jh /ji /jj /jk /jl /jm /jn /jo /jp /jq /jr /js /jt /ju /jv /jw /jx /jy /jz /ka /kb /kc /kd /ke /kf /kg /kh /ki /kj /kk /kl /km /kn /ko /kp /kq /kr /ks /kt /ku /kv /kw /kx /ky /kz /la /lb /lc /ld /le /lf /lg /lh /li /lj /lk /ll /lm /ln /lo /lp /lq /lr /ls /lt /lu /lv /lw /lx /ly /lz /ma /mb /mc /md /me /mf /mg /mh /mi /mj /mk /ml /mm /mn /mo /mp /mq /mr /ms /mt /mu /mv /mw /mx /my /mz /na /nb /nc /nd /ne /nf /ng /nh /ni /nj /nk /nl /nm /nn /no /np /nq /nr /ns /nt /nu /nv /nw /nx /ny /nz /oa /ob /oc /od /oe /of /og /oh /oi /oj /ok /ol /om /on /oo /op /oq /or /os /ot /ou /ov /ow /ox /oy /oz /pa /pb /pc /pd /pe /pf /pg /ph /pi /pj /pk /pl /pm /pn /po /pp /pq /pr /ps /pt /pu /pv /pw /px /py /pz /qa /qb /qc /qd /qe /qf /qg /qh /qi /qj /qk /ql /qm /qn /qo /qp /qq /qr /qs /qt /qu /qv /qw /qx /qy /qz /ra /rb /rc /rd /re /rf /rg /rh /ri /rj /rk /rl /rm /rn /ro /rp /rq /rr /rs /rt /ru /rv /rw /rx /ry /rz /sa /sb /sc /sd /se /sf /sg /sh /si /sj /sk /sl /sm /sn /so /sp /sq /sr /ss /st /su /sv /sw /sx /sy /sz /ta /tb /tc /td /te /tf /tg /th /ti /tj /tk /tl /tm /tn /to /tp /tq /tr /ts /tt /tu /tv /tw /tx /ty /tz /ua /ub /uc /ud /ue /uf /ug /uh /ui /uj /uk /ul /um /un /uo /up /uq /ur /us /ut /uu /uv /uw /ux /uy /uz /va /vb /vc /vd /ve /vf /vg /vh /vi /vj /vk /vl /vm /vn /vo /vp /vq /vr /vs /vt /vu /vv /vw /vx /vy /vz /wa /wb /wc /wd /we /wf /wg /wh /wi /wj /wk /wl /wm /wn /wo /wp /wq /wr /ws /wt /wu /wv /ww /wx /wy /wz /xa /xb /xc /xd /xe /xf /xg /xh /xi /xj /xk /xl /xm /xn /xo /xp /xq /xr /xs /xt /xu /xv /xw /xx /xy /xz /ya /yb /yc /yd /ye /yf /yg /yh /yi /yj /yk /yl /ym /yn /yo /yp /yq /yr /ys /yt /yu /yv /yw /yx /yy /yz /za /zb /zc /zd /ze /zf /zg /zh /zi /zj /zk /zl /zm /zn /zo /zp /zq /zr /zs /zt /zu /zv /zw /zx /zy /zz

USER NAME = meglisk	DESIGNED -	REVISED -
	DRAWN -	REVISED -
PLOT SCALE = 40,0000 * / in.	CHECKED -	REVISED -
PLOT DATE = 01/25/22	DATE -	REVISED -

**STATE OF ILLINOIS
DEPARTMENT OF TRANSPORTATION**

**INDEX OF SHEETS, LIST OF STANDARDS,
GENERAL NOTES & COMMITMENTS**

SCALE: SHEET NO. 1 OF 1 SHEETS STA. TO STA.

F.A.P. RTE.	SECTION	COUNTY	TOTAL SHEETS	SHEET NO.
749	(120)	DOUGLAS	6	2
				CONTRACT NO. 70F80
		ILLINOIS	FED. AID PROJECT	

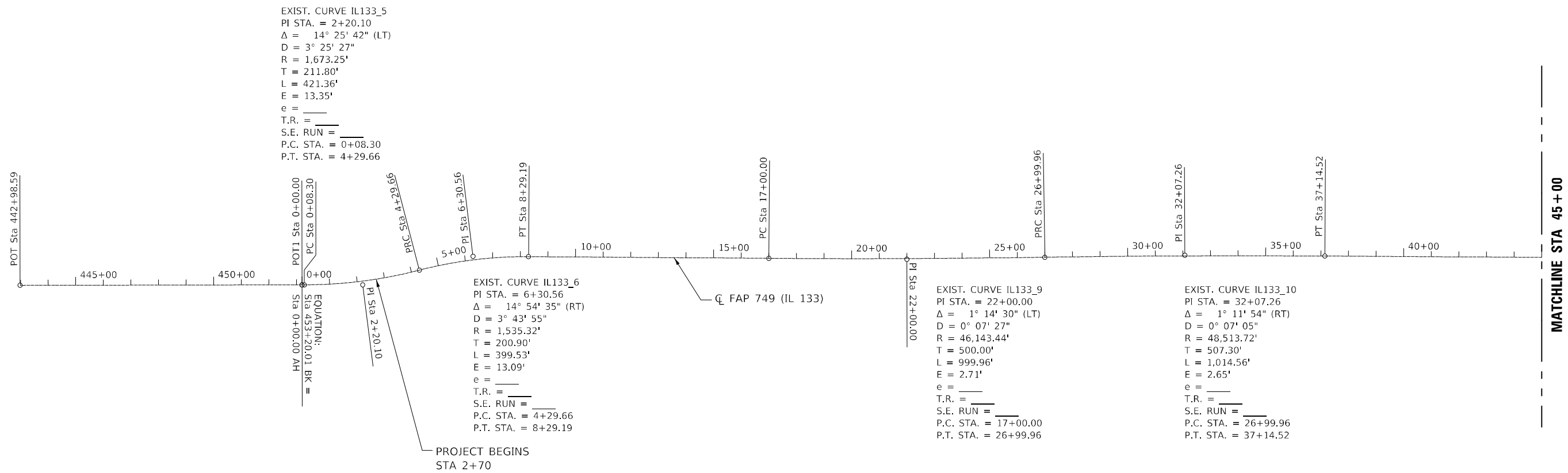

FAP 749 (IL 133) CENTERLINE CONTROL POINTS

POINT NO	NORTHING	EASTING	STATION	OFFSET	DESCRIPTION
23	1108393.194	944979.151	0+00	0.00	POT
40	1108393.206	944987.451	0+08.30	0.00	PC
25	1108393.516	945199.251	2+18.98	13.35	PI (2+20.10)
42	1108446.589	945404.293	4+29.66	0.00	PRC
29	1108496.931	945598.784	6+29.42	-13.09	PI (6+30.56)
43	1108495.540	945799.680	8+29.19	0.00	PT
44	1108489.490	946670.470	17+00.00	0.00	PC
32	1108486.020	947170.457	21+99.98	2.71	PI (22+00.00)
46	1108493.380	947670.400	26+99.96	0.00	PRC
33	1108500.854	948177.647	32+07.24	-2.65	PI (32+07.26)
47	1108497.720	948684.940	37+14.53	0.00	PT
17	1108479.844	951574.683	66+04.32	0.00	POT
6117	1108474.660	950982.904	60+12.59	8.84	SECTION CORNER

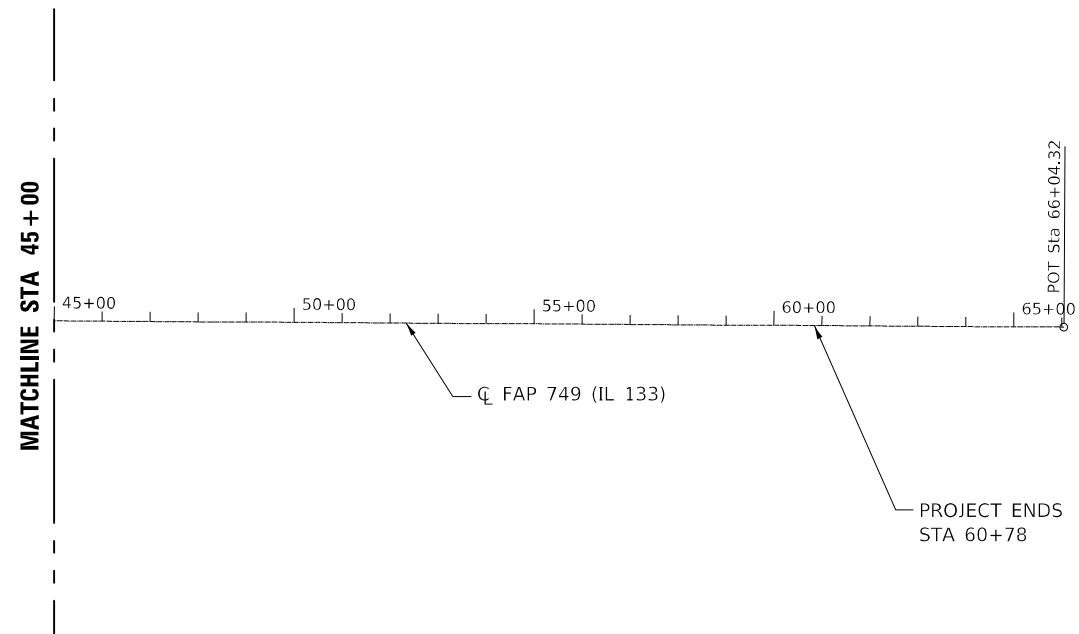

MODEL: \\MODEL\MAME
 FILE NAME: \\PUB\cpx\beefay.com\PI\DOT\Documents\DOT\Office\Dir\drf_5\Project\DOT\Documents\DOT\Office\Dir\drf_5\080-sh-A7B.dgn

USER NAME = meglisk	DESIGNED -	REVISED -
DRAWN -	REVISED -	
PLOT SCALE = 40,0000 * / in.	CHECKED -	REVISED -
PLOT DATE = 01/25/22	DATE -	REVISED -

STATE OF ILLINOIS
DEPARTMENT OF TRANSPORTATION

ALIGNMENTS, TIES, AND BENCHMARKS

SCALE: SHEET NO. 1 OF 1 SHEETS STA. TO STA.

F.A.P. RTE.	SECTION	COUNTY	TOTAL SHEETS	SHEET NO.
749	(120)	DOUGLAS	6	6
CONTRACT NO. 70F80				
ILLINOIS FED. AID PROJECT				