

STATE OF ILLINOIS  
DEPARTMENT OF TRANSPORTATION

F.A.U. RTE.	SECTION	COUNTY	TOTAL SHEETS	SHEET NO.
1608	2021-080-RS	COOK	24	1
		ILLINOIS	CONTRACT NO. 62P17	

FOR INDEX OF SHEETS, SEE SHEET NO. 2

**PROPOSED  
HIGHWAY PLANS**

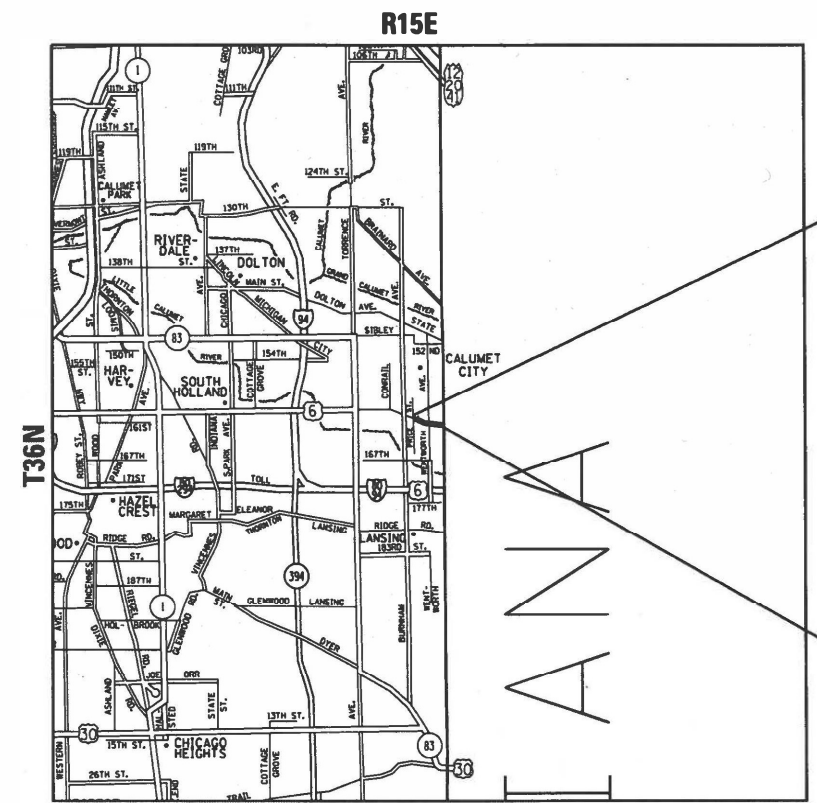
F.A.U. ROUTE 1608: RIVER OAKS DR.  
PRICE AVE TO STATE LINE RD  
SECTION 2021-080-RS  
PROJECT STP-7FSE(963)  
DESIGNED OVERLAY WITH ADA IMPROVEMENTS  
COOK COUNTY  
C-91-214-21

**TRAFFIC DATA**

EXISTING ADT = 15,100 (2018)  
POSTED SPEED LIMIT = 35 MPH

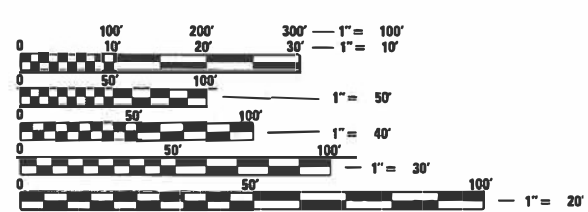


THE IMPROVEMENT IS LOCATED IN THE CITY OF CALUMET CITY



PROJECT BEGINS  
STA. 16 + 08

PROJECT ENDS  
STA. 51 + 64



FULL SIZE PLANS HAVE BEEN PREPARED USING STANDARD ENGINEERING SCALES. REDUCED SIZED PLANS WILL NOT CONFORM TO STANDARD SCALES. IN MAKING MEASUREMENTS ON REDUCED PLANS, THE ABOVE SCALES MAY BE USED.

J.U.L.I.E.  
JOINT UTILITY LOCATION INFORMATION FOR EXCAVATORS  
1-800-892-0123  
OR 811

PROJECT ENGINEER: RODRIGO LEDEZMA (847) 705-4580  
PROJECT MANAGER: J. ALAIN MIDY (847) 221-3056

GROSS LENGTH = 3,556 FT. = 0.673 MILE  
NET LENGTH = 3,556 FT. = 0.673 MILE

CONTRACT NO. 62P17

STATE OF ILLINOIS  
DEPARTMENT OF TRANSPORTATION

SUBMITTED April 28, 2022

[Signature] REGIONAL ENGINEER  
March 25, 2022

[Signature] ENGINEER OF DESIGN AND ENVIRONMENT  
March 25, 2022

[Signature] DIRECTOR OF HIGHWAYS PROJECT IMPLEMENTATION

PRINTED BY THE AUTHORITY  
OF THE STATE OF ILLINOIS

**INDEX OF SHEETS**

1	COVER SHEET
2	INDEX OF SHEETS, STANDARDS AND GENERAL NOTES
3-5	SUMMARY OF QUANTITIES
6	TYPICAL SECTIONS
7-8	ROADWAY PLAN SHEETS
9	ADA DETAILS
10	DETECTOR LOOP DETAILS
11	DETAILS FOR FRAMES AND LIDS ADJUSTMENT WITH MILLING (BD-08)
12	PAVEMENT PATCHING FOR HMA SURFACED PAVEMENT (BD-22)
13	CURB OR CURB AND GUTTER REMOVAL AND REPLACEMENT (BD-24)
14	BUTT JOINT AND HMA TAPER DETAILS (BD-32)
15	HMA TAPER AT EDGE OF P.C.C. PAVEMENT (BD-33)
16	TRAFFIC CONTROL AND PROTECTION FOR SIDE ROADS, INTERSECTIONS, AND DRIVEWAYS (TC-10)
17	TYPICAL APPLICATIONS RAISED REFLECTOR PAVEMENT MARKERS (SNOW-PLOW RESISTANT) (TC-11)
18	DISTRICT ONE TYPICAL PAVCEMENT MARKINGS (TC-13)
19	TRAFFIC CONTROL AND PROTECTION AT TURN BAYS (TO REMAIN OPEN TO TRAFFIC) (TC-14)
20	SHORT TERM PAVEMENT MARKING LETTERS AND SYMBOLS (TC-16)
21	ARTERIAL ROAD INFORMATION SIGN (TC-22)
22	DRIVEWAY ENTRANCE SIGNING (TC-26)
23	DISTRICT 1 - DETECTOR LOOP INSTALLATION DETAILS FOR ROADWAY RESURFACING (TS-07)
24	PROJECT DETAILS FOR PARALLEL CURB RAMPS (PD-06)

**STATE STANDARDS**

000001-08	STANDARD SYMBOLS, ABBREVIATIONS AND PATTERNS
442201-03	CLASS C AND D PATCHES
606001-08	CONCRETE CURB TYPE B AND COMBINATION CONCRETE CURB AND GUTTER
701006-05	OFF-RD OPERATIONS, 2L, 2W, 15' (4.5 m) TO 24" (600 mm) FROM PAVEMENT EDGE
701101-05	OFF-RD OPERATIONS, MULTILANE, 15' (4.5m) TO 24" (600mm) FROM PAVEMENT EDGE
701106-02	OFF-RD OPERATIONS, MULTILANE, MORE THAN 15' (4.5m) AWAY
701301-04	LANE CLOSURE, 2L, 2W, SHORT TIME OPERATIONS
701311-03	LANE CLOSURE, 2L, 2W, MOVING OPERATIONS - DAY ONLY
701427-05	LANE CLOSURE, MULTILANE, INTERMITTENT OR MOVING OPER., FOR SPEEDS < 40 MPH
701501-06	URBAN LANE CLOSURE, 2L, 2W, UNDIVIDED
701602-10	URBAN LANE CLOSURE, MULTILANE, 2W WITH BIDIRECTIONAL LEFT TURN LANE
701606-10	URBAN SINGLE LANE CLOSURE, MULTILANE, 2W WITH MOUNTABLE MEDIAN
701611-01	URBAN HALF ROAD CLOSURE, MULTILANE, 2W WITH MOUNTABLE MEDIAN
701701-10	URBAN LANE CLOSURE, MULTILANE INTERSECTION
701801-06	SIDEWALK, CORNER OR CROSSWALK CLOSURE
701901-08	TRAFFIC CONTROL DEVICES

**GENERAL NOTES**

1. BEFORE STARTING ANY EXCAVATION, THE CONTRACTOR SHALL CALL "J.U.L.I.E." AT (800) 892-0123 OR 811 FOR FIELD LOCATIONS OF BURIED ELECTRIC, TELEPHONE AND GAS UTILITIES. 48 HOUR NOTIFICATION IS REQUIRED.
2. TEN (10) FOOT TRANSITIONS SHALL BE USED TO MATCH PROPOSED CURB AND GUTTER AND MEDIAN ITEMS OF WORK TO EXISTING CURBS AND GUTTER AND MEDIANS IN THE FIELD, UNLESS OTHERWISE SHOWN. THE TRANSITIONS SHALL BE PAID FOR AT THE CONTRACT UNIT PRICE FOR THE PROPOSED ITEMS OF WORK SPECIFIED.
3. THE CONTRACTOR SHALL COORDINATE CONSTRUCTION ACTIVITIES WITH UTILITY COMPANIES, AND THE CITY OF CALUMET CITY.
4. THE CONTRACTOR WILL NOT BE ALLOWED TO SET UP A YARD OR FIELD OFFICE ON STATE PROPERTY WITHOUT WRITTEN PERMISSION FROM THE DEPARTMENT.
5. ANY PAVEMENT MARKINGS AND RAISED REFLECTIVE PAVEMENT MARKERS OBLITERATED BY MILLING AND RESURFACING OPERATIONS ON SIDE STREETS AND ENTRANCES SHALL BE REPLACED AND PAID FOR IN KIND.
6. ALL DAMAGE TO EXISTING PAVEMENT MARKINGS OR RAISED REFLECTIVE PAVEMENT MARKERS OUTSIDE THE REMOVAL LINE SHOWN ON THE PLANS SHALL BE REPLACED AT NO ADDITIONAL COST TO THE DEPARTMENT.
7. BEFORE BEGINNING ANY WORK, THE CONTRACTOR SHALL RETAIN AND RECORD FOR FUTURE REFERENCE, ALL EXISTING PAVEMENT MARKING LINES (AND RAISED REFLECTIVE PAVEMENT MARKERS) IN ORDER THAT THESE LOCATIONS CAN BE RE-ESTABLISHED FOR STRIPING. EXACT LOCATIONS OF ALL PAVEMENT MARKINGS SHALL BE AS DIRECTED BY THE ENGINEER.
8. ALL PAVEMENT PATCHING LOCATIONS WILL BE DETERMINED IN THE FIELD BY THE ENGINEER.
9. LOCATION OF COMBINATION CONCRETE CURB AND GUTTER REMOVAL AND REPLACEMENT, WILL BE DETERMINED IN THE FIELD BY THE ENGINEER.
10. DRAINAGE ADJUSTMENT OR RECONSTRUCTION LOCATIONS WILL BE DETERMINED IN THE FIELD BY THE ENGINEER.
11. IT SHALL BE THE CONTRACTOR'S RESPONSIBILITY TO VERIFY ALL DIMENSIONS AND CONDITIONS EXISTING IN THE FIELD PRIOR TO CONSTRUCTION AND ORDERING OF MATERIALS.
12. FRAMES AND GRATES ADJUSTMENT OF PRIVATE UTILITIES WITHIN THE LIMITS OF THE IMPROVEMENTS SHALL BE DONE BY THEIR RESPECTIVE OWNERS AND ARE NOT PART OF THIS CONTRACT.
13. SIDEWALK REMOVAL AND P.C.C. SIDEWALK 5" LOCATIONS SHALL BE DETERMINED BY THE ENGINEER.
14. THE CONTRACTOR SHALL CONTACT THE DISTRICT ONE TRAFFIC CONTROL SUPERVISOR AT KALPANA.KANNAN-HOSADURGA@ILLINOIS.GOV A MINIMUM OF 72 HOURS IN ADVANCE OF BEGINNING WORK.
15. THE ENGINEER SHALL CONTACT PATRICE HARRIS, AREA TRAFFIC FIELD TECHNICIAN, AT PATRICE.HARRIS@ILLINOIS.GOV A MINIMUM OF TWO (2) WEEKS PRIOR TO THE PLACEMENT OF PERMANENT PAVEMENT MARKINGS.
16. THESE PLANS HAVE BEEN PREPARED FROM NOTES RECEIVED FROM THE BUREAU OF CONSTRUCTION.
17. THE THICKNESS OF THE HMA MIXTURE SHOWN ON THE PLANS IS THE NOMINAL THICKNESS. DEVIATIONS FROM THE NOMINAL THICKNESS WILL BE PERMITTED WHEN SUCH DEVIATIONS OCCUR DUE TO IRREGULARITIES IN THE EXISTING SURFACE OR BASE ON WHICH THE HMA MIXTURE IS PLACED.
18. THE CONTRACTOR SHALL BE REQUIRED TO PROVIDE ACCESS TO ABUTTING PROPERTY AT ALL TIMES DURING THE CONSTRUCTION OF THIS PROJECT.
19. THE CONTRACTOR WILL BE REQUIRED TO KEEP A RECORD OF THE LOCATIONS OF PLATED STRUCTURES BY STATION AND OFFSET LEFT OR RIGHT OF THE CENTERLINE OF PAVEMENT.
20. THE CONTRACTOR WILL BE REQUIRED TO KEEP A RECORD OF THE LOCATIONS OF THE BURIED STRUCTURES ACCORDING TO THE STATION AND DISTANCE LEFT OR RIGHT OF THE CENTERLINE OF PAVEMENT. UPON COMPLETION OF THE WORK, THE CONTRACTOR WILL DELIVER THE RECORD TO THE ENGINEER.
21. EXISTING BROKEN FRAMES AND LIDS SHALL BE REMOVED AND DISPOSED OF BY THE CONTRACTOR AND SHALL BE REPLACED AS DIRECTED BY THE ENGINEER. REPLACEMENT FRAMES AND LIDS WILL BE PAID FOR ACCORDING TO ARTICLE 109.04 OF THE STANDARD SPECIFICATIONS UNLESS A SEPARATE PAY ITEM HAS BEEN PROVIDED.
22. DO NOT SCALE PLANS FOR CONSTRUCTION DIMENSIONS.
23. DOUBLE LANE MARKERS ARE TO BE USED AS SHOWN ON THE DISTRICT ONE DETAIL "TYPICAL APPLICATIONS 3/4" RAISED REFLECTIVE PAVEMENT MARKERS (SNOW-PLOW RESISTANT)" SHOWN IN THE PLANS.
24. PAVEMENT MARKING TAPE, TYPE III SHALL BE USED FOR SHORT TERM PAVEMENT MARKINGS ON ALL FINAL SURFACES.
25. WHEN THE MILLED PAVEMENT IS OPEN TO TRAFFIC THE MAXIMUM GRADE DIFFERENTIAL BETWEEN PASSES OF THE MILLING MACHINE SHALL NOT EXCEED 1/2 INCHES (40 mm) WHERE THE SPEED LIMIT IS 40 MPH (80 km/h) OR LESS AND 1 INCH (25 mm) WHERE THE SPEED LIMIT IS GREATER THAN 40 MPH (80 km/h). WITH WRITTEN APPROVAL OF THE ENGINEER, A MAXIMUM GRADE DIFFERENTIAL OF 3 INCHES (75 mm) MAY BE ALLOWED IF THE EDGE OF THE MILLING IS SLOPED A MINIMUM 1:3 (V:H) OR A NOTCHED LONGITUDINAL WEDGE IS USED.
26. BUTT JOINTS WILL BE INSTALLED AT THE ENDS OF ALL RESURFACING (WHERE RESURFACING MEETS EXISTING PAVEMENT) ACCORDING TO THE "BUTT JOINT AND HOT-MIX ASPHALT TAPER DETAILS" SHEET INCLUDED IN THE PLANS, UNLESS OTHERWISE SPECIFIED.
27. OVERNIGHT LANE CLOSURES SHALL NOT BE ALLOWED FOR REHABILITATION PROJECTS INVOLVING DAYTIME MILLING AND RESURFACING OPERATIONS AND CLASS D PATCHING UNLESS OTHER CONDITIONS WARRANT EXTENDED LANE CLOSURES AS DETERMINED AND APPROVED IN WRITING BY THE ENGINEER OR AS PROVIDED FOR IN THE CONTRACT SPECIFICATIONS.
28. ALL MILLED SURFACES SHALL BE AT A UNIFORM CROSS SLOPE PER LANE AND FREE OF ANY RIDGES BETWEEN PASSES. ANY DEVIATIONS SHALL BE CORRECTED AT NO COST TO THE DEPARTMENT.

MODEL Default  
 FILE NAME: p:\uldest-pw-bentley.com\p\INDOT\Documents\DOT Office\District 1\Project\11782-1\CADD\data\Design\11782-1-arh-agencere.dgn

USER NAME = rothjp	DESIGNED -	REVISED -
	DRAWN -	REVISED -
PLOT SCALE = 100,0000' / in.	CHECKED -	REVISED -
PLOT DATE = 2/4/2022	DATE -	REVISED -

**STATE OF ILLINOIS  
DEPARTMENT OF TRANSPORTATION**

**INDEX OF SHEETS, STANDARDS AND GENERAL NOTES  
RIVER OAKS DR. - PRICE AVE. TO STATE LINE RD.**

SCALE: SHEET 1 OF 1 SHEETS STA. TO STA.

F.A.U. RTE.	SECTION	COUNTY	TOTAL SHEETS	SHEET NO.
1608	2021-080-R5	COOK	24	2
CONTRACT NO. 62P17				
ILLINOIS FED. AID PROJECT				

SUMMARY OF QUANTITIES			URBAN TOTAL QUANTITIES	CONSTRUCTION TYPE CODE				
CODE NO	ITEM	UNIT		0005 80% FED 20% STATE				
20200100	EARTH EXCAVATION	CU YD	5	5				
21101615	TOPSOIL FURNISH AND PLACE, 4"	SO YD	129	129				
25200110	SODDING, SALT TOLERANT	SO YD	129	129				
25200200	SUPPLEMENTAL WATERING	UNIT	1	1				
40600290	BITUMINOUS MATERIALS (TACK COAT)	POUND	15488	15488				
40600370	LONGITUDINAL JOINT SEALANT	FOOT	10668	10668				
40600400	MIXTURE FOR CRACKS, JOINTS, AND FLANGEWAYS	TON	35	35				
40600982	HOT-MIX ASPHALT SURFACE REMOVAL - BUTT JOINT	SO YD	217	217				
40602985	HOT-MIX ASPHALT BINDER COURSE, IL-9.5, N70	TON	2524	2524				
40604062	HOT-MIX ASPHALT SURFACE COURSE, IL-9.5, MIX "D", N70	TON	2249	2249				
42001300	PROTECTIVE COAT	SO YD	107	107				
42400200	PORTLAND CEMENT CONCRETE SIDEWALK 5 INCH	SO FT	355	355				
42400800	DETECTABLE WARNINGS	SO FT	36	36				

SUMMARY OF QUANTITIES			URBAN TOTAL QUANTITIES	CONSTRUCTION TYPE CODE				
CODE NO	ITEM	UNIT		0005 80% FED 20% STATE				
44000164	HOT-MIX ASPHALT SURFACE REMOVAL, 3 3/4"	SO YD	22944	22944				
44000600	SIDEWALK REMOVAL	SO FT	355	355				
44201798	CLASS D PATCHES, TYPE I, 13 INCH	SO YD	58	58				
44201803	CLASS D PATCHES, TYPE II, 13 INCH	SO YD	459	459				
44201807	CLASS D PATCHES, TYPE III, 13 INCH	SO YD	345	345				
44201809	CLASS D PATCHES, TYPE IV, 13 INCH	SO YD	287	287				
60250200	CATCH BASINS TO BE ADJUSTED	EACH	2	2				
60252800	CATCH BASINS TO BE RECONSTRUCTED	EACH	3	3				
60255500	MANHOLES TO BE ADJUSTED	EACH	2	2				
60257900	MANHOLES TO BE RECONSTRUCTED	EACH	2	2				
60260100	INLETS TO BE ADJUSTED	EACH	2	2				
60262700	INLETS TO BE RECONSTRUCTED	EACH	1	1				
60300305	FRAMES AND LIDS TO BE ADJUSTED	EACH	10	10				
60406000	FRAMES AND LIDS, TYPE 1, OPEN LID	EACH	2	2				
60406100	FRAMES AND LIDS, TYPE 1, CLOSED LID	EACH	2	2				

FILE NAME =	USER NAME = rthjp	DESIGNED -	REVISED -
pw\N\dot-pw\benrey.com\PI\DOT\Documents\DOT - Office\District\Projects\DIR\B2\NCADD\dot-Design\DIR\B21-st-500\dot-DRAWN -		CHECKED -	REVISED -
	PLOT SCALE = 100,0000' / 1in	DATE -	REVISED -
	PLOT DATE = 2/14/2022		

**STATE OF ILLINOIS  
DEPARTMENT OF TRANSPORTATION**

**RIVER OAKS DR. - PRICE AVE. TO STATE LINE RD.  
SUMMARY OF QUANTITIES**

SCALE: SHEET NO. 1 OF 3 SHEETS STA. TO STA.

F.A.U. RTE.	SECTION	COUNTY	TOTAL SHEETS	SHEET NO.
1608	2021-080-RS	COOK	24	3
FED. ROAD DIST. NO. 1 ILLINOIS FED. AID PROJECT			CONTRACT NO. 62P17	

SUMMARY OF QUANTITIES			URBAN TOTAL QUANTITIES	CONSTRUCTION TYPE CODE				
CODE NO	ITEM	UNIT		0005 80% FED 20% STATE				
* 66900200	NON-SPECIAL WASTE DISPOSAL	CU YD	5	5				
* 66900530	SOIL DISPOSAL ANALYSIS	EACH	1	1				
* 66901001	REGULATED SUBSTANCES PRE-CONSTRUCTION PLAN	L SUM	1	1				
* 66901003	REGULATED SUBSTANCES FINAL CONSTRUCTION REPORT	L SUM	1	1				
* 66901006	REGULATED SUBSTANCES MONITORING	CAL DA	3	3				
67100100	MOBILIZATION	L SUM	1	1				
70102620	TRAFFIC CONTROL AND PROTECTION, STANDARD 701501	L SUM	1	1				
70102625	TRAFFIC CONTROL AND PROTECTION, STANDARD 701606	L SUM	1	1				
70102632	TRAFFIC CONTROL AND PROTECTION, STANDARD 701602	L SUM	1	1				
70102634	TRAFFIC CONTROL AND PROTECTION, STANDARD 701611	L SUM	1	1				
70102635	TRAFFIC CONTROL AND PROTECTION, STANDARD 701701	L SUM	1	1				
70102640	TRAFFIC CONTROL AND PROTECTION, STANDARD 701801	L SUM	1	1				

SUMMARY OF QUANTITIES			URBAN TOTAL QUANTITIES	CONSTRUCTION TYPE CODE				
CODE NO	ITEM	UNIT		0005 80% FED 20% STATE				
70300100	SHORT TERM PAVEMENT MARKING	FOOT	4707	4707				
70300150	SHORT TERM PAVEMENT MARKING REMOVAL	SO FT	1569	1569				
70300211	TEMPORARY PAVEMENT MARKING LETTERS AND SYMBOLS - PAINT	SO FT	194	194				
70300221	TEMPORARY PAVEMENT MARKING - LINE 4"- PAINT	FOOT	10775	10775				
70300241	TEMPORARY PAVEMENT MARKING - LINE 6"- PAINT	FOOT	1143	1143				
70300251	TEMPORARY PAVEMENT MARKING - LINE 8"- PAINT	FOOT	99	99				
70300261	TEMPORARY PAVEMENT MARKING - LINE 12"- PAINT	FOOT	628	628				
70300281	TEMPORARY PAVEMENT MARKING - LINE 24"- PAINT	FOOT	301	301				
70306120	TEMPORARY PAVEMENT MARKING - LINE 4"- TYPE III TAPE	FOOT	1569	1569				
* 78000100	THERMOPLASTIC PAVEMENT MARKING - LETTERS AND SYMBOLS	SO FT	194	194				
* 78000200	THERMOPLASTIC PAVEMENT MARKING - LINE 4"	FOOT	10775	10775				
* 78000400	THERMOPLASTIC PAVEMENT MARKING - LINE 6"	FOOT	1143	1143				

FILE NAME =	USER NAME = rthjp	DESIGNED -	REVISED -
pw\N\dot-pw\benley.com\PI\DOT Documents\DOT - Office\District\Projects\DIR\B2\NCAD\Design\DIR\B21-st-500\DRAWN		CHECKED -	REVISED -
		DATE -	REVISED -

**STATE OF ILLINOIS  
DEPARTMENT OF TRANSPORTATION**

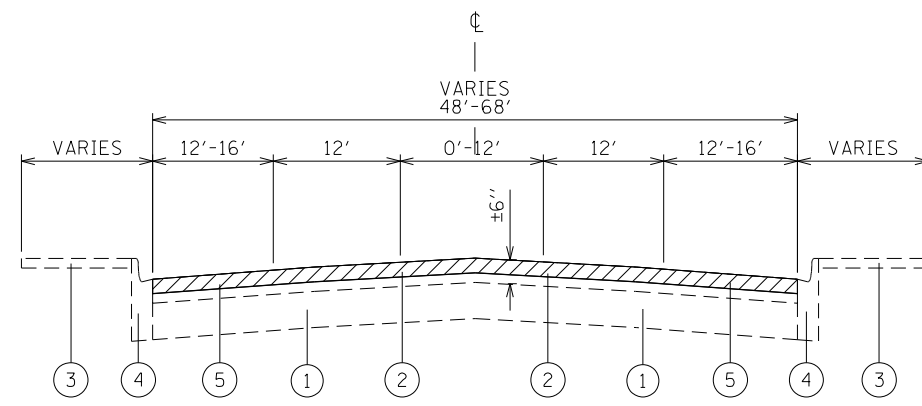
**RIVER OAKS DR. - PRICE AVE. TO STATE LINE RD.  
SUMMARY OF QUANTITIES**

SCALE: SHEET NO. 2 OF 3 SHEETS STA. TO STA.

F.A.U. RTE.	SECTION	COUNTY	TOTAL SHEETS	SHEET NO.
1608	2021-080-RS	COOK	24	4
CONTRACT NO. 62P17				
FED. ROAD DIST. NO. 1 ILLINOIS FED. AID PROJECT				

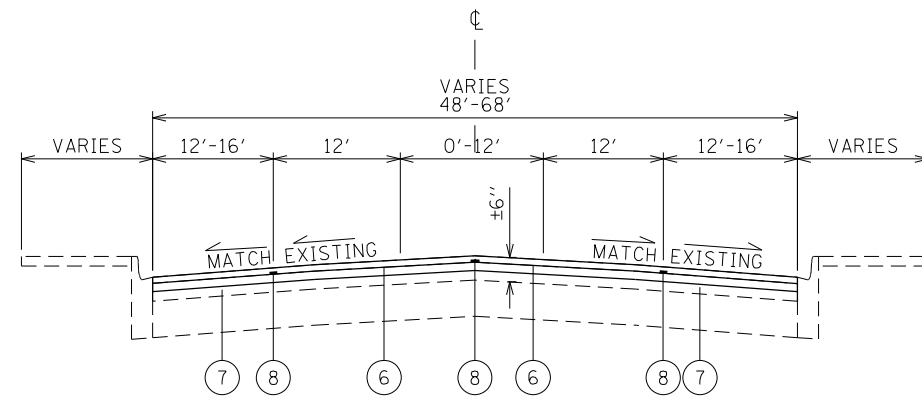
SUMMARY OF QUANTITIES			URBAN TOTAL QUANTITIES	CONSTRUCTION TYPE CODE				
CODE NO	ITEM	UNIT		0005 80% FED 20% STATE	100% STATE			
* 78000500	THERMOPLASTIC PAVEMENT MARKING - LINE 8"	FOOT	99	99				
* 78000600	THERMOPLASTIC PAVEMENT MARKING - LINE 12"	FOOT	628	628				
* 78000650	THERMOPLASTIC PAVEMENT MARKING - LINE 24"	FOOT	301	301				
* 78100100	RAISED REFLECTIVE PAVEMENT MARKER	EACH	209	209				
78300200	RAISED REFLECTIVE PAVEMENT MARKER REMOVAL	EACH	209	209				
78300202	PAVEMENT MARKING REMOVAL - WATER BLASTING	SO FT	5654	5654				
* 88600600	DETECTOR LOOP REPLACEMENT	FOOT	826	826				
* 89500400	RELOCATE EXISTING PEDESTRIAN PUSH-BUTTON	EACH	2	2				
X0320050	CONSTRUCTION LAYOUT (SPECIAL)	L SUM	1	1				
X4060995	TEMPORARY RAMP, SPECIAL	SO YD	284	284				
X5537800	STORM SEWERS TO BE CLEANED 12"	FOOT	200	200				
X6030310	FRAMES AND LIDS TO BE ADJUSTED (SPECIAL)	EACH	12	12				
X6700410	ENGINEER'S FIELD OFFICE, TYPE A (SPECIAL)	CAL MO	6	6				

SUMMARY OF QUANTITIES			URBAN TOTAL QUANTITIES	CONSTRUCTION TYPE CODE				
CODE NO	ITEM	UNIT		0005 80% FED 20% STATE	100% STATE			
Z0004562	COMBINATION CONCRETE CURB AND GUTTER REMOVAL AND REPLACEMENT	FOOT	200	200				
Z0018400	DRAINAGE STRUCTURES TO BE ADJUSTED	EACH	4	4				
Z0018500	DRAINAGE STRUCTURES TO BE CLEANED	EACH	10	10				
Z0030850	TEMPORARY INFORMATION SIGNING	SO FT	51.4	51.4				
Ø Z0076600	TRAINEES	HOURS	500	500				
Ø Z0076604	TRAINEES - TRAINING PROGRAM GRADUATE	HOURS	500	500				



**EXISTING RIVER OAKS DRIVE**

STA. 16+08 TO STA. 51+64



**PROPOSED RIVER OAKS DRIVE**

STA. 16+08 TO STA. 51+64

**CONTRACTOR SHALL MILL FIRST BEFORE PATCHING**

THE LONGITUDINAL JOINT SEALANT SHALL BE PLACED OVER THE HMA BINDER COURSE IL-9.5 N70

**LEGEND**

- ① EXISTING P.C.C. PAVEMENT, ±9"
- ② EXISTING HOT-MIX ASPHALT PAVEMENT, ±6"
- ③ EXISTING CONCRETE SIDEWALK
- ④ EXISTING COMB. CONC. CURB AND GUTTER
- ⑤ PROPOSED HOT-MIX ASPHALT SURFACE REMOVAL, 3¾"
- ⑥ PROPOSED HMA SURFACE COURSE, MIX "D", IL-9.5, N70, 1¾"
- ⑦ PROPOSED HMA BINDER COURSE, IL-19.0, N70, 2"
- ⑧ PROPOSED LONGITUDINAL JOINT SEALANT

HOT-MIX ASPHALT MIXTURE REQUIREMENTS		QMP
MIXTURE TYPE	AIR VOIDS @ Ndes	
<b>PAVEMENT RESURFACING</b>		
HMA SURFACE COURSE, MIX "D", IL-9.5, N70, 1¾"	4% @ 70 Gyr.	OCP
HMA BINDER COURSE, IL-9.5, N70, 2"	4% @ 70 Gyr.	OCP
<b>PATCHING</b>		
CLASS D PATCH (HMA BINDER IL-19 mm)	4% @ 70 Gyr.	QC/QA
<b>TEMPORARY RAMP, SPECIAL</b>		
HMA BINDER COURSE, IL-9.5, N70	4% @ 70 Gyr.	QC/QA

QMP Designations: Quality Control/Quality Assurance (QC/QA); Quality Control for Performance (OCP); Pay for Performance (PFP)

THE UNIT WEIGHT USED TO CALCULATE ALL HMA SURFACE MIXTURE QUANTITIES IS 112 LBS/SQ YD/IN.

THE "AC TYPE" FOR POLYMERIZED HMA MIXES SHALL BE "SBS/SBR PG 76-22" AND FOR NON-POLYMERIZED HMA THE "AC TYPE" SHALL BE "PG 64-22" UNLESS MODIFIED BY RECLAIMED MATERIAL SPECIFICATIONS.

MODEL: Default  
 FILE: \\blmfe-pw-bentley.com\P\INDOT\Documents\DOT Office\Dir\rdet\_1\Project\117821\CADD\Drawings\117821-Sub-z\p1c1.dgn

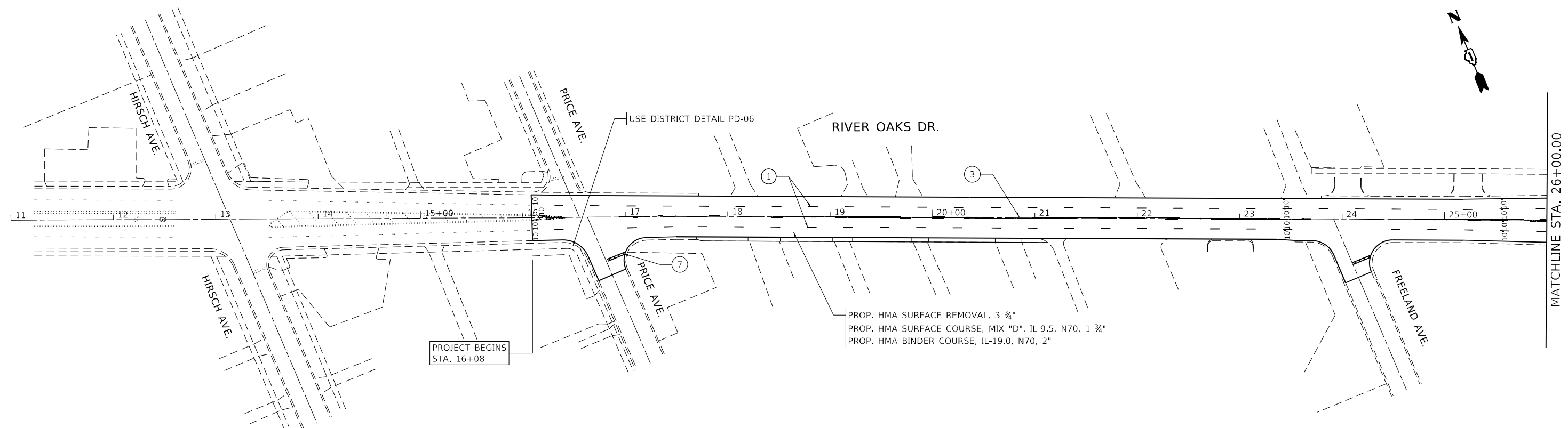
USER NAME = rothjp	DESIGNED -	REVISED -
	DRAWN -	REVISED -
PLOT SCALE = 100,0000' / in.	CHECKED -	REVISED -
PLOT DATE = 2/9/2022	DATE -	REVISED -

**STATE OF ILLINOIS  
DEPARTMENT OF TRANSPORTATION**

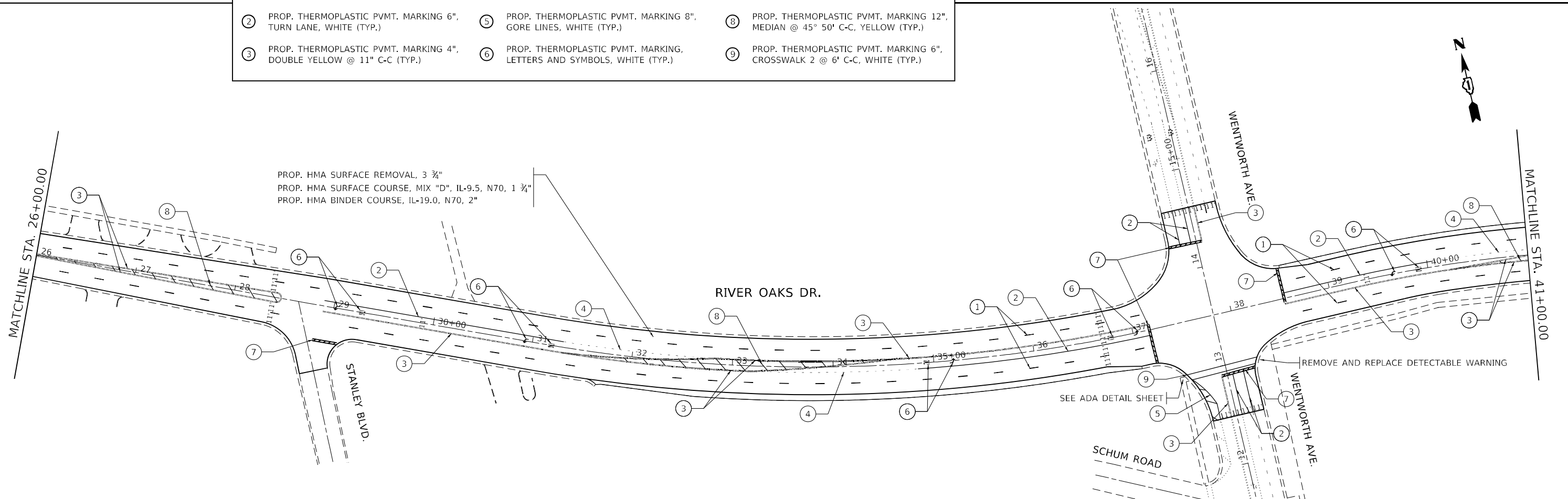
**TYPICAL SECTIONS  
RIVER OAKS DR. - PRICE AVE. TO STATE LINE RD.**

SCALE: SHEET 1 OF 1 SHEETS STA. TO STA.

F.A.U. RTE.	SECTION	COUNTY	TOTAL SHEETS	SHEET NO.
1608	2021-080-R5	COOK	24	6
CONTRACT NO. 62P17				
ILLINOIS FED. AID PROJECT				



- |   |  |  |
|---|--|--|
| ① PROP. THERMOPLASTIC PVMT. MARKING 4", 10' DASH 30' SKIP, WHITE (TYP.) | ④ PROP. THERMOPLASTIC PVMT. MARKING 6", 2' DASH 6' SKIP, WHITE (TYP.)  | ⑦ PROP. THERMOPLASTIC PVMT. MARKING 24", STOP BAR, WHITE (TYP.)              |
| ② PROP. THERMOPLASTIC PVMT. MARKING 6", TURN LANE, WHITE (TYP.)         | ⑤ PROP. THERMOPLASTIC PVMT. MARKING 8", GORE LINES, WHITE (TYP.)       | ⑧ PROP. THERMOPLASTIC PVMT. MARKING 12", MEDIAN @ 45° 50' C-C, YELLOW (TYP.) |
| ③ PROP. THERMOPLASTIC PVMT. MARKING 4", DOUBLE YELLOW @ 11" C-C (TYP.)  | ⑥ PROP. THERMOPLASTIC PVMT. MARKING, LETTERS AND SYMBOLS, WHITE (TYP.) | ⑨ PROP. THERMOPLASTIC PVMT. MARKING 6", CROSSWALK 2 @ 6' C-C, WHITE (TYP.)   |



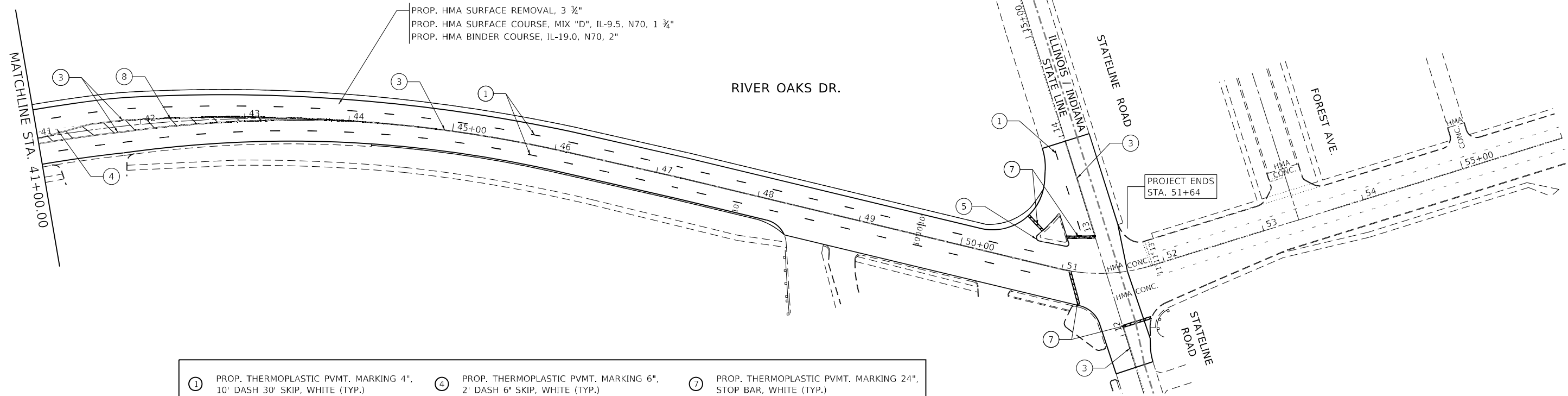
MODEL: Default  
 FILE: \\na16c-pw\ludect-pw\benefit.com\PIV\DOT\Documents\DOT Office\District: 11\Project\11782\11782\11782-1-ar-ban.dgn

USER NAME = rothp	DESIGNED -	REVISED -
DRAWN -	REVISOR -	
PLOT SCALE = 100,0000' / in.	CHECKED -	REVISOR -
PLOT DATE = 2/4/2022	DATE -	REVISOR -

**STATE OF ILLINOIS**  
**DEPARTMENT OF TRANSPORTATION**

<b>ROADWAY PLAN</b>	
<b>RIVER OAKS DR. (PRICE AVE. TO STATE LINE RD.)</b>	
SCALE: 1"=50'	SHEET 1 OF 2 SHEETS STA. TO STA.

F.A.U. RTE.	SECTION	COUNTY	TOTAL SHEETS	SHEET NO.
1608	2021-080-R5	COOK	24	7
CONTRACT NO. 62P17				
ILLINOIS FED. AID PROJECT				



- |   |  |  |
|---|--|--|
| ① PROP. THERMOPLASTIC PVMT. MARKING 4", 10' DASH 30' SKIP, WHITE (TYP.) | ④ PROP. THERMOPLASTIC PVMT. MARKING 6", 2' DASH 6' SKIP, WHITE (TYP.)  | ⑦ PROP. THERMOPLASTIC PVMT. MARKING 24", STOP BAR, WHITE (TYP.)              |
| ② PROP. THERMOPLASTIC PVMT. MARKING 6", TURN LANE, WHITE (TYP.)         | ⑤ PROP. THERMOPLASTIC PVMT. MARKING 8", GORE LINES, WHITE (TYP.)       | ⑧ PROP. THERMOPLASTIC PVMT. MARKING 12", MEDIAN @ 45° 50' C-C, YELLOW (TYP.) |
| ③ PROP. THERMOPLASTIC PVMT. MARKING 4", DOUBLE YELLOW @ 11" C-C (TYP.)  | ⑥ PROP. THERMOPLASTIC PVMT. MARKING, LETTERS AND SYMBOLS, WHITE (TYP.) | ⑨ PROP. THERMOPLASTIC PVMT. MARKING 6", CROSSWALK 2 @ 6' C-C, WHITE (TYP.)   |

PROP. HMA SURFACE REMOVAL, 3 3/4"  
 PROP. HMA SURFACE COURSE, MIX "D", IL-9.5, N70, 1 3/4"  
 PROP. HMA BINDER COURSE, IL-19.0, N70, 2"

MODEL: Default  
 FILE NAME: p:\project\aw\_bentley.com\p\i\dot\Documents\DOT Office\District 1\Project\ID11782\ICADD\data\Design\ID11782\_1.dwg  
 DATE: 2/4/2022

USER NAME = rothjp	DESIGNED -	REVISED -
PLOT SCALE = 100,0000' / in.	DRAWN -	REVISED -
PLOT DATE = 2/4/2022	CHECKED -	REVISED -
	DATE -	REVISED -

**STATE OF ILLINOIS  
 DEPARTMENT OF TRANSPORTATION**

<b>ROADWAY PLAN</b>			
<b>RIVER OAKS DR. (PRICE AVE. TO STATE LINE RD.)</b>			
SCALE: 1"=50'	SHEET 2	OF 2 SHEETS	STA. TO STA.

F.A.U. RTE.	SECTION	COUNTY	TOTAL SHEETS	SHEET NO.
1608	2021-080-R5	COOK	24	8
CONTRACT NO. 62P17				
ILLINOIS FED. AID PROJECT				







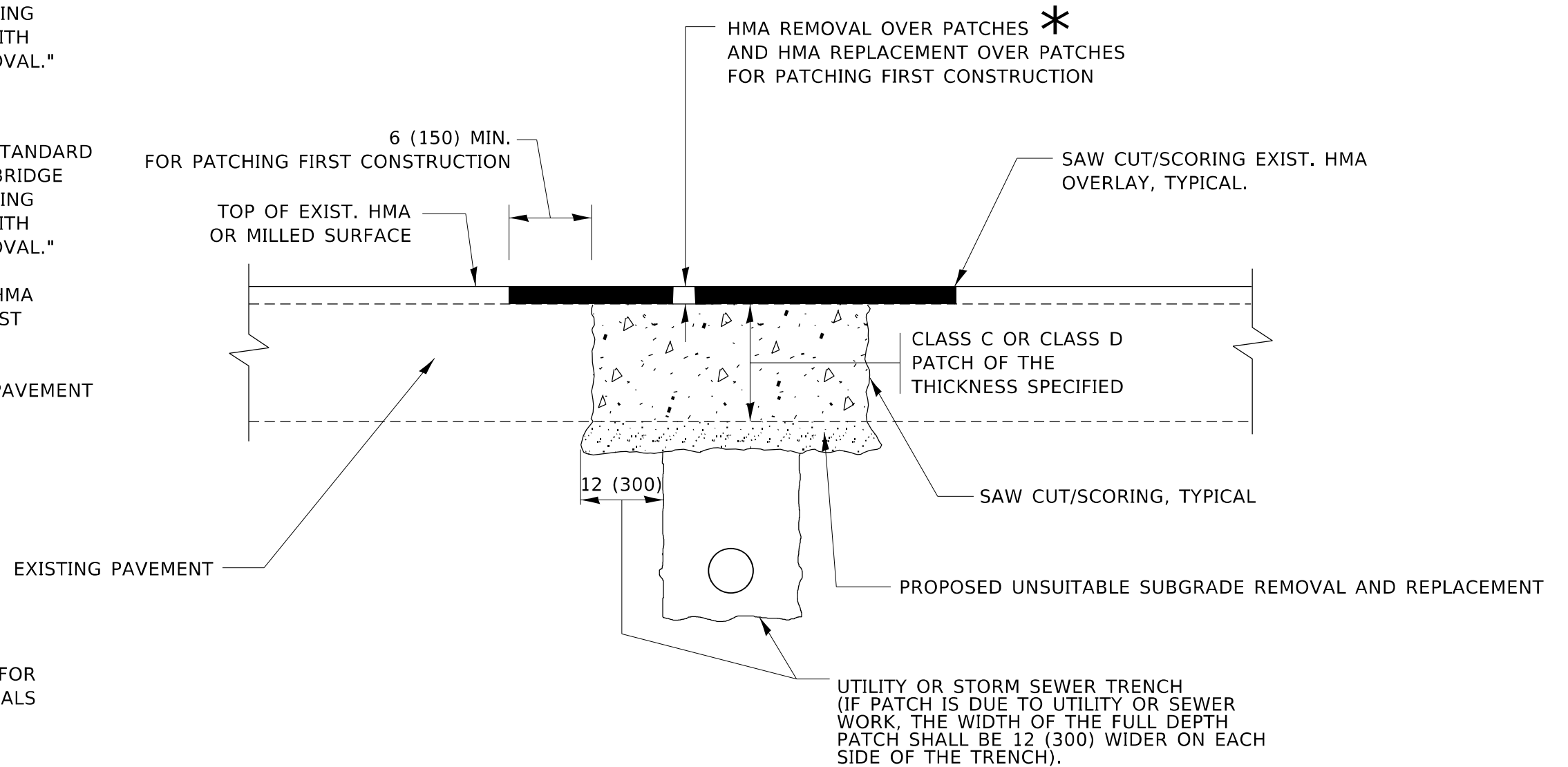


**METHOD OF MEASUREMENT**

REFER TO SECTION 442 OF THE STANDARD SPECIFICATIONS FOR ROAD AND BRIDGE CONSTRUCTION AND THE RECURRING SPECIAL PROVISION "PATCHING WITH HOT-MIX ASPHALT OVERLAY REMOVAL."

**BASIS OF PAYMENT**

1. REFER TO SECTION 442 OF THE STANDARD SPECIFICATIONS FOR ROAD AND BRIDGE CONSTRUCTION AND THE RECURRING SPECIAL PROVISION "PATCHING WITH HOT-MIX ASPHALT OVERLAY REMOVAL."
2. SAW CUT/SCORING OF EXISTING HMA OVERLAY IS INCLUDED IN THE COST OF PAVEMENT PATCHING.
3. SAW CUT/SCORING OF EXISTING PAVEMENT IS INCLUDED IN THE COST OF PAVEMENT PATCHING.



\* SEE TYPICAL SECTIONS FOR THICKNESS AND MATERIALS

**SEQUENCE OF CONSTRUCTION (PATCHING FIRST)**

1. REMOVE THE EXISTING HMA MATERIAL OVER THE AREA TO BE PATCHED.
2. REMOVE AND REPLACE WITH CLASS C OR D PATCH.
3. REPLACE HMA MATERIAL OVER THE AREA TO BE PATCHED.

**SEQUENCE OF CONSTRUCTION (MILLING FIRST)**

1. MILL HMA FIRST IF THERE IS AT LEAST 4½ INCHES OR MORE OF HMA MATERIAL ON TOP OF THE EXISTING PAVEMENT OR IF THE PAVEMENT IS FULL DEPTH HMA. A MINIMUM OF 2 INCHES OF HMA MATERIAL SHALL BE IN PLACE AFTER MILLING.
2. REMOVE AND REPLACE WITH FULL DEPTH CLASS D PATCHES TO TOP OF MILLED SURFACE.

ALL DIMENSIONS ARE IN INCHES (MILLIMETERS) UNLESS OTHERWISE SHOWN.

MODEL: Default FILE: hma17e.pxd Subject: hma17e.dwg User: rshah Date: 10/25/22

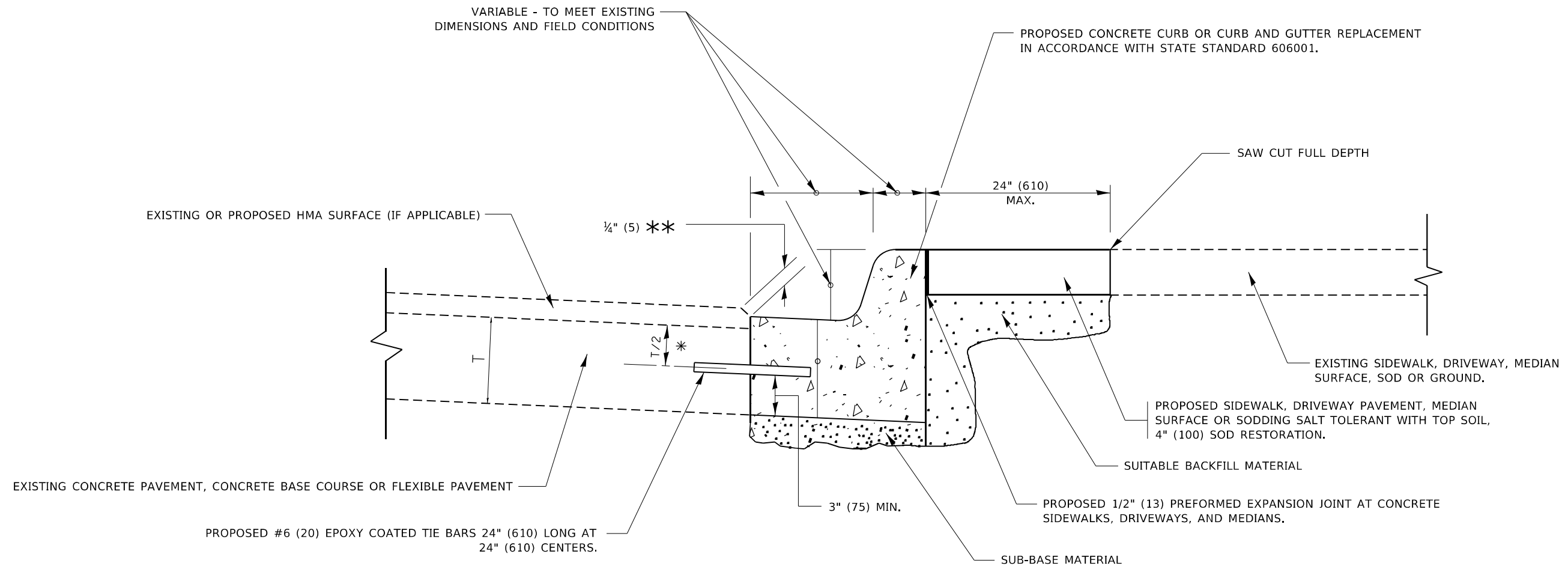
USER NAME = rshah	DESIGNED - R. SHAH	REVISED - R. BORO 01-01-07
	DRAWN -	REVISED - R. BORO 09-04-07
PLOT SCALE = 100,0000' / in.	CHECKED -	REVISED - K. ENG 10-27-08
PLOT DATE = 2/4/2022	DATE - 10-25-94	REVISED - K. SMITH 02-01-22

**STATE OF ILLINOIS  
DEPARTMENT OF TRANSPORTATION**

**PAVEMENT PATCHING FOR  
HMA SURFACED PAVEMENT**

SCALE: NONE SHEET 1 OF 1 SHEETS STA. TO STA.

F.A.U. RTE.	SECTION	COUNTY	TOTAL SHEETS	SHEET NO.
1608	2021-080-R5	COOK	24	12
<b>BD400-04 (BD-22)</b>			CONTRACT NO. 62P17	
ILLINOIS FED. AID PROJECT				



- \* 3" (75) MINIMUM FROM TOP AND BOTTOM OF THE CONCRETE PAVEMENT OR BASE COURSE.
- \*\* IF THE FINAL SURFACE OF THE PAVEMENT IS CONCRETE, THE GUTTER IS TO BE FLUSH WITH THE PAVEMENT.

# CURB OR CURB AND GUTTER REMOVAL AND REPLACEMENT

ALL DIMENSIONS ARE IN INCHES (MILLIMETERS) UNLESS OTHERWISE SHOWN.

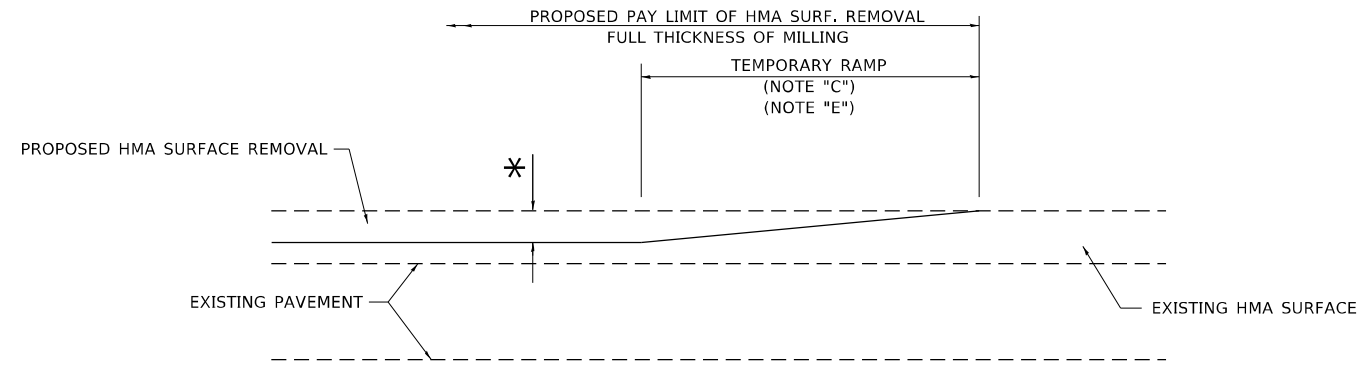
MODEL: Default  
FILE: \\nafe-pw\ultra-pw-beadefy.com\PIV\DOT\Documents\DOT Office\Dir\rdet - \Project\11782\1\CAD\data\Design\BdRst.dgn

USER NAME = rothjp	DESIGNED - A. HOUSEH	REVISED - A. ABBAS 03-21-97
	DRAWN -	REVISED - M. GOMEZ 01-22-01
PLOT SCALE = 100,0000 ' / in.	CHECKED -	REVISED - R. BORO 12-15-09
PLOT DATE = 2/4/2022	DATE - 03-11-94	REVISED - K. SMITH 07-11-19

**STATE OF ILLINOIS  
DEPARTMENT OF TRANSPORTATION**

<b>CURB OR CURB AND GUTTER REMOVAL AND REPLACEMENT</b>			
SCALE: NONE	SHEET 1	OF 1 SHEETS	STA. TO STA.

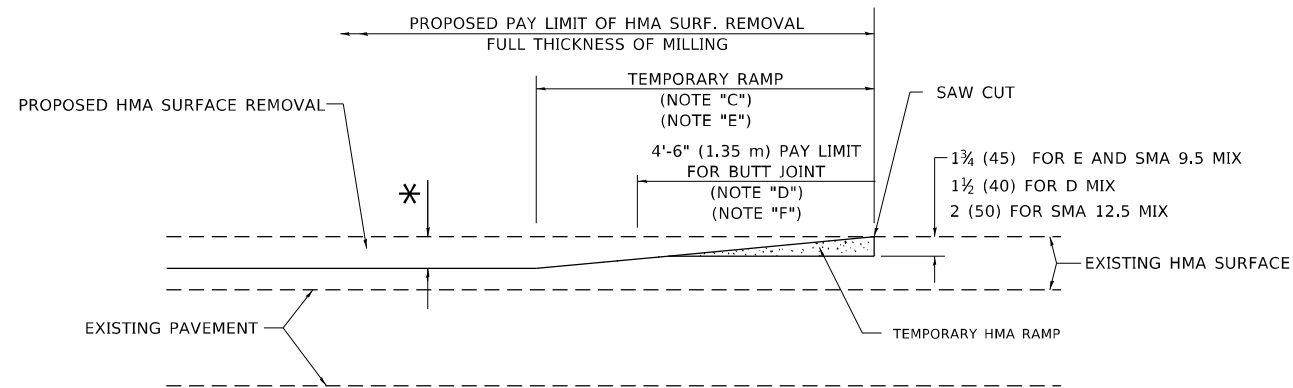
F.A.U. RTE.	SECTION	COUNTY	TOTAL SHEETS	SHEET NO.
1608	2021-080-R5	COOK	24	13
<b>BD600-06 (BD-24)</b>		CONTRACT NO. 62P17		
ILLINOIS FED. AID PROJECT				



**MILLED TEMPORARY RAMP**

(FOR BUTT JOINT AND HMA TAPER SEE DETAIL BELOW)

**OPTION 1**

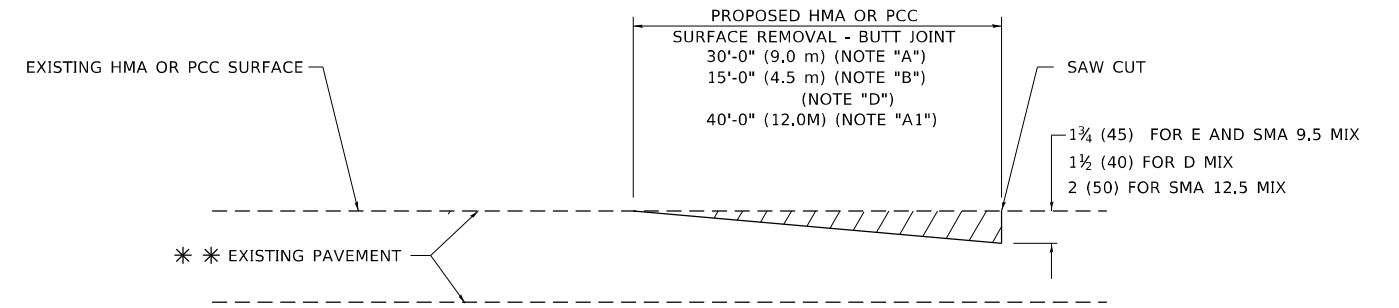


**HMA CONSTRUCTED TEMPORARY RAMP**

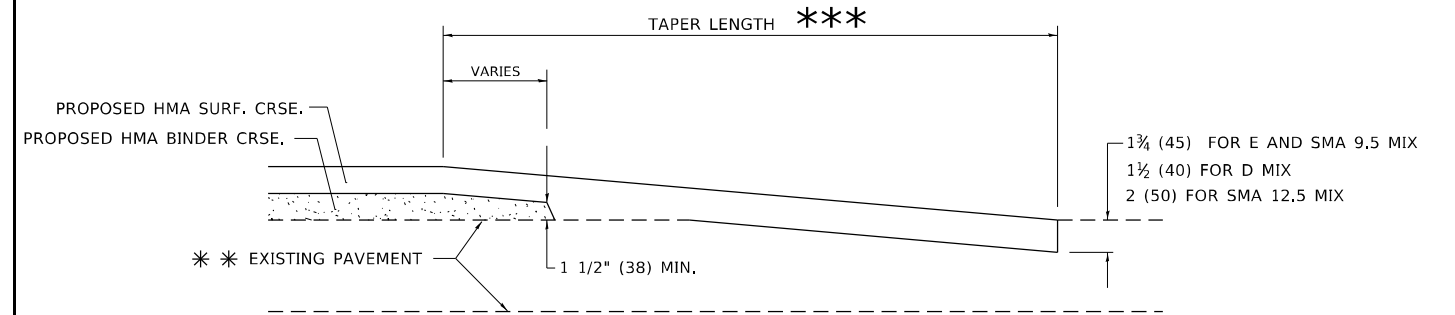
(FOR BUTT JOINT AND HMA TAPER SEE DETAIL BELOW)

**OPTION 2**

**TYPICAL TEMPORARY RAMP**



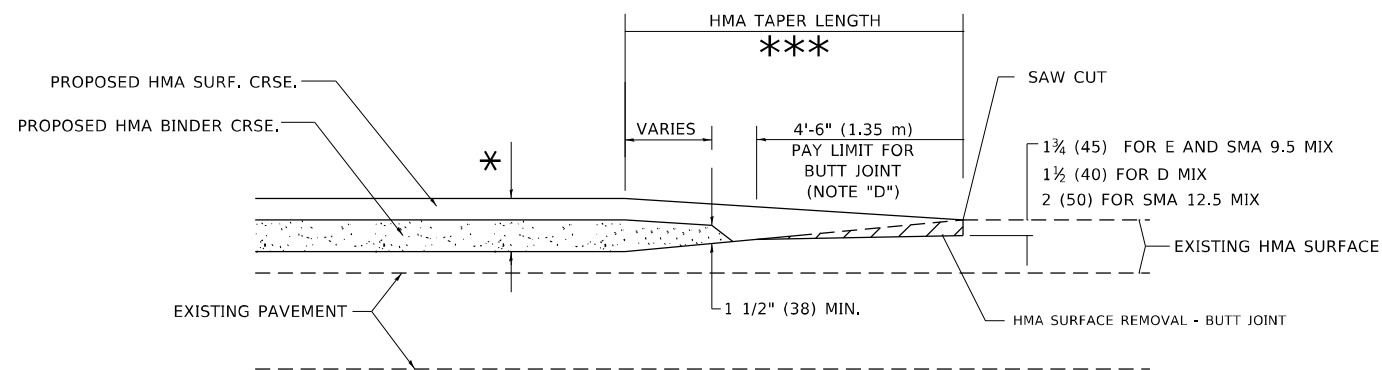
**BUTT JOINT DETAIL**



**HMA TAPER DETAIL**

**TYPICAL BUTT JOINT AND HMA TAPER FOR RESURFACING ONLY**

\*\*\* PC CONCRETE, HMA OR HMA RESURFACED PAVEMENT.



**BUTT JOINT AND HMA TAPER**

**TYPICAL BUTT JOINT AND HMA TAPER FOR MILLING AND RESURFACING**

**GENERAL NOTES**

- A. MAINLINE ARTERIAL ROADWAYS AND MAJOR SIDE ROADS.
- A1. INTERSTATES
- B. MINOR SIDE ROADS.
- C. THE TEMP. RAMP SHALL BE CONSTRUCTED IMMEDIATELY UPON REMOVAL OF THE EXISTING HMA SURFACE.
- D. THE BUTT JOINT SHALL BE CONSTRUCTED IMMEDIATELY PRIOR TO PLACING THE PROPOSED HMA COURSES.
- E. TAPER THE TEMP. RAMP AT A RATE OF 3' - 4" (1.02m) PER 1 INCH (25 mm) OF MILLING THICKNESS.  
\* SEE TYPICAL SECTIONS FOR MILLING THICKNESS.
- F. SEE ARTICLE 406.08 AND 406.14 OF THE STANDARD SPECIFICATIONS FOR "HMA AND/OR PCC SURFACE REMOVAL, BUTT JOINT".  
\*\*\* 20'-0" (6.1 m) PER 1 (25) RESURFACING (NOTE "A")  
10'-0" (3.0 m) PER 1 (25) RESURFACING (NOTE "B")

**BASIS OF PAYMENT**

1. THE BUTT JOINT WILL BE PAID FOR AT THE CONTRACT UNIT PRICE PER SQUARE YARD (SQUARE METER) FOR "HOT-MIX ASPHALT SURFACE REMOVAL - BUTT JOINT" OR FOR "PORTLAND CEMENT CONCRETE SURFACE REMOVAL- BUTT JOINT".
2. THE TEMPORARY RAMP AND SAW CUT SHALL BE INCLUDED IN THE UNIT COST FOR HMA OR PCC SURFACE REMOVAL-BUTT JOINT.

ALL DIMENSIONS ARE IN INCHES (MILLIMETERS) UNLESS OTHERWISE SHOWN.

MODEL: Default  
 FILE: \\blmfe-prod\blmfe\proj\blmfe\blmfe.com\PIV\DOT\Documents\DOT Office\Dir\rdet\_1\Project\11782\1\CAD\data\Design\BtJStc.dgn  
 PROJECT: 11782

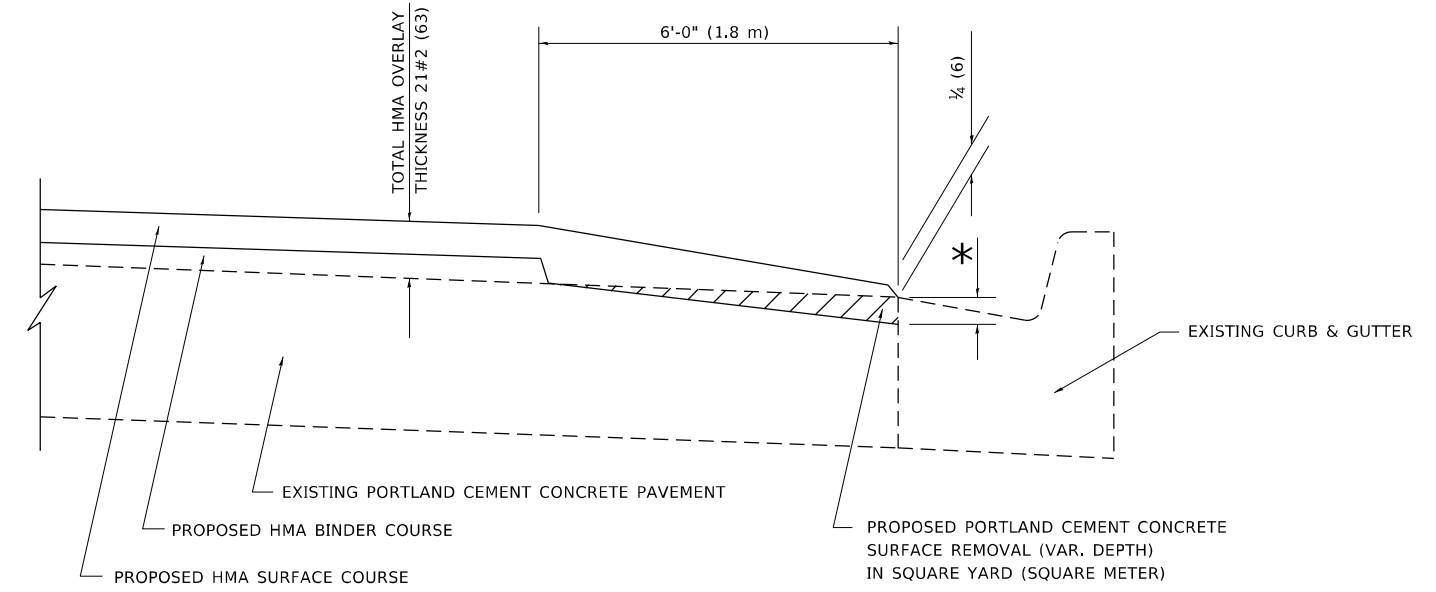
USER NAME = rothjp	DESIGNED - M. DE YONG	REVISED - A. ABBAS 03-21-97
PLOT SCALE = 100,0000' / in.	DRAWN -	REVISED - M. GOMEZ 04-06-01
PLOT DATE = 2/4/2022	CHECKED -	REVISED - R. BORO 01-01-07
	DATE - 06-13-90	REVISED - K. SMITH 02-01-22

STATE OF ILLINOIS  
DEPARTMENT OF TRANSPORTATION

BUTT JOINT AND  
HMA TAPER DETAILS

SCALE: NONE SHEET 1 OF 1 SHEETS STA. TO STA.

F.A.U. RTE.	SECTION	COUNTY	TOTAL SHEETS	SHEET NO.
1608	2021-080-R5	COOK	24	14
BD400-05 BD-32			CONTRACT NO. 62P17	
ILLINOIS FED. AID PROJECT				



**HMA TAPER AT  
EDGE OF P.C.C. PAVEMENT**

HMA SURFACE COURSE	HMA BINDER COURSE	* MILLING AT GUTTER FLAG	
MIX	THICKNESS	THICKNESS	
D	1 1/2 (38)	1 (25)	1 1/4 (33)
E OR SMA 9.5	1 3/4 (44)	3/4 (19)	1 1/2 (38)

ALL DIMENSIONS ARE IN INCHES (MILLIMETERS) UNLESS OTHERWISE SHOWN.

MODEL: Default  
 FILE NAME: p:\ultra\paw\bea\paw.com\PIV\DOT\Documents\DOT Office\Dir\rdet\_1\Project\117821\CADD\data\Design\BdR5St.dgn

USER NAME = rothjp	DESIGNED - R. SHAH	REVISED - E. GOMEZ 12-21-00
	DRAWN - JIS	REVISED - R. BORO 01-01-07
PLOT SCALE = 100,0000' / in.	CHECKED - A. ABBAS	REVISED - JP CHANG 07-08-16
PLOT DATE = 2/4/2022	DATE - 09-10-94	REVISED - K. SMITH 02-01-22

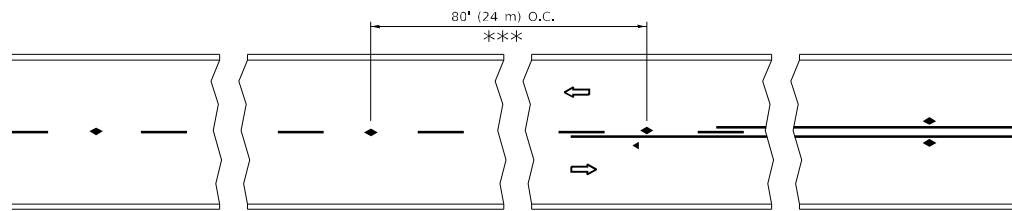
**STATE OF ILLINOIS  
DEPARTMENT OF TRANSPORTATION**

<b>HMA TAPER AT EDGE OF P.C.C. PAVEMENT</b>			
SCALE: NONE	SHEET 1	OF 1 SHEETS	STA. TO STA.

F.A.U. RTE.	SECTION	COUNTY	TOTAL SHEETS	SHEET NO.
1608	2021-080-R5	COOK	24	15
<b>BD400-06</b>	<b>BD-33</b>	CONTRACT NO. 62P17		
ILLINOIS FED. AID PROJECT				

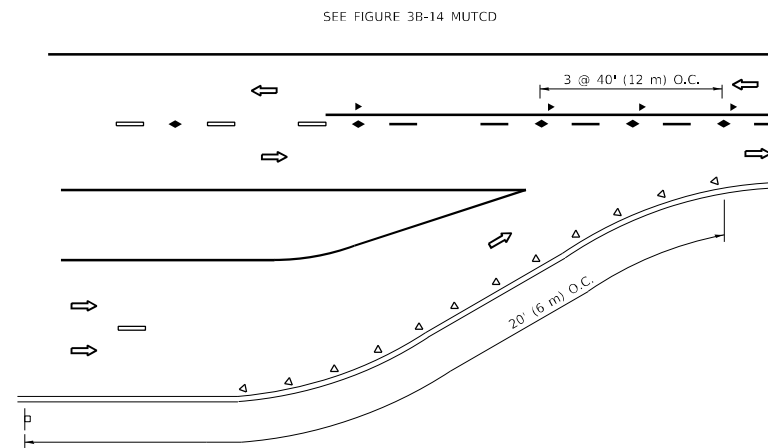




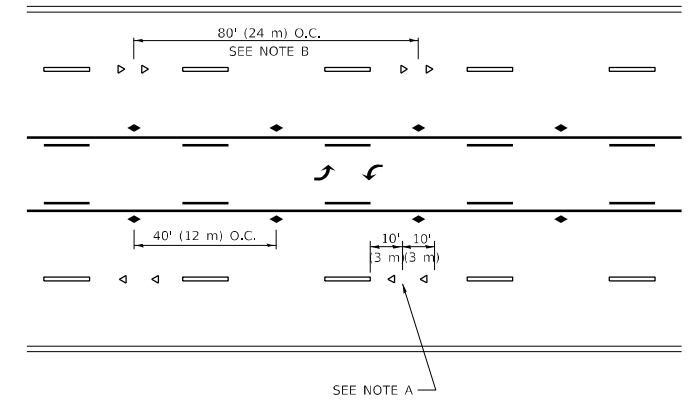


\*\*\* REDUCE TO 40' (12 m) O.C. ON CURVES WITH POSTED OR ADVISORY SPEED 45 M.P.H. (70 km/h) OR LESS.

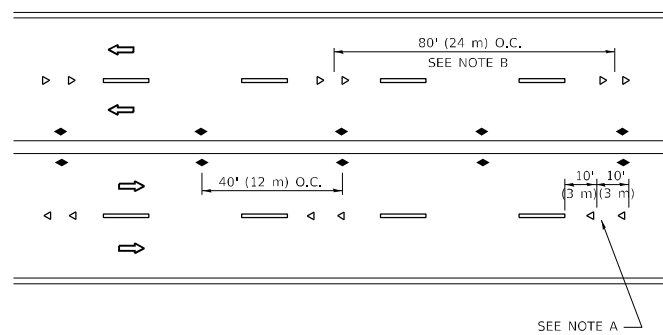
**TWO-LANE/TWO-WAY**



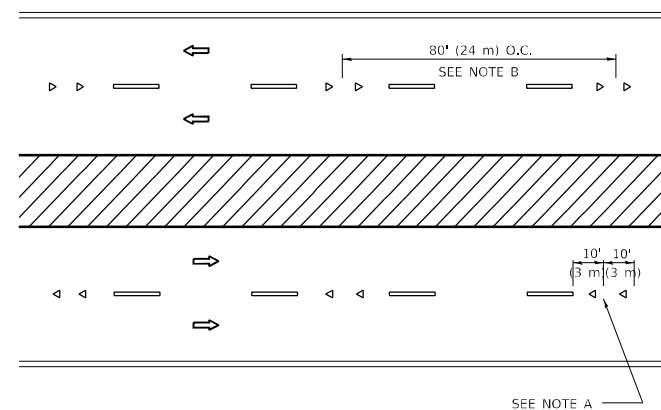
**LANE REDUCTION TRANSITION**



**TWO-WAY LEFT TURN**



**MULTI-LANE/UNDIVIDED**



**MULTI-LANE/DIVIDED**

**GENERAL NOTES**

1. MARKERS USED WITH DASHED LINES SHALL BE CENTERED IN THE GAP BETWEEN SEGMENTS.
2. MARKERS USED ADJACENT TO SOLID LINES SHALL BE OFFSET 2 TO 3 (50 TO 75) TOWARD TRAFFIC AS SHOWN.
3. MARKERS THROUGH TANGENTS LESS THAN 500' (150 m) IN LENGTH BETWEEN CURVES SHALL BE INSTALLED AT THE LESSER OF THE TWO CURVE SPACINGS.
4. MARKERS ARE TO BE USED ADJACENT TO BOTH SOLID WHITE LINES IN DUAL LEFT TURN LANES

**SYMBOLS**

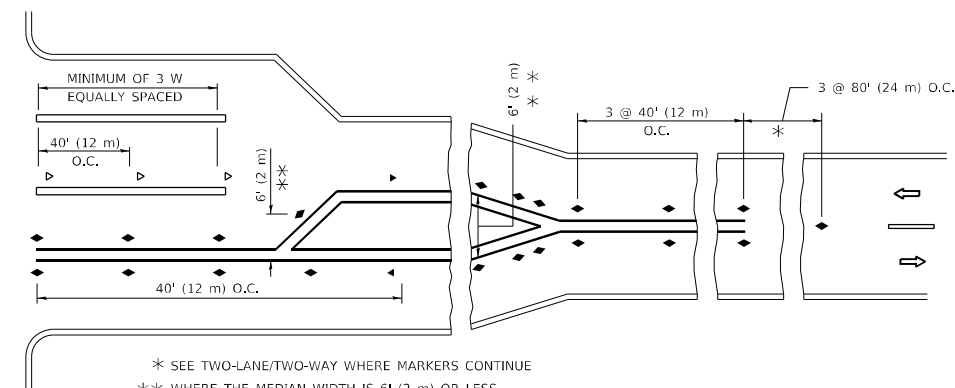
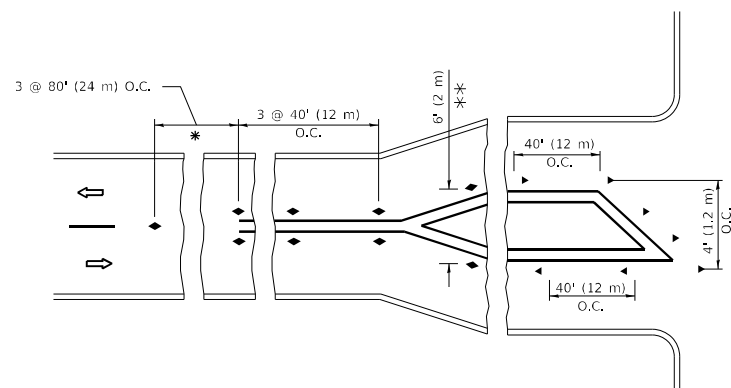
- YELLOW STRIPE
- WHITE STRIPE
- ◀ ONE-WAY AMBER MARKER
- ◀ ONE-WAY CRYSTAL MARKER (W/O)
- ◆ TWO-WAY AMBER MARKER

**LANE MARKER NOTES**

- A. USE DOUBLE LANE LINE MARKERS SPACED AS SHOWN.
- B. REDUCE TO 40' (12 m) O.C. ON CURVES WHERE ADVISORY SPEEDS ARE 10 M.P.H (20 km/h) LOWER THAN POSTED SPEEDS.

**DESIGN NOTES**

1. DOUBLE LANE LINE MARKERS SHALL BE USED UNLESS SPECIFIED OTHERWISE.
2. EXCEPT AS SHOWN ON THE LANE REDUCTION TRANSITION AND FREEWAY EXIT RAMP DETAIL, MARKERS ARE NOT TO BE SPECIFIED ON RIGHT EDGE LINES.
3. THE EXACT MARKER LIMITS, SPACING, AND COLOR SHALL BE INCLUDED IN THE PLANS WHEN STANDARD SPECIFICATIONS ARE NOT BEING USED.
4. MARKERS SHOULD NOT BE USED ALONGSIDE CURBS EXCEPT FOR EXTREMELY SHORT SECTIONS OF CURBS WHERE NOT MORE THAN TWO MARKERS WOULD BE INVOLVED.



**TURN LANES**

\* SEE TWO-LANE/TWO-WAY WHERE MARKERS CONTINUE  
 \*\* WHERE THE MEDIAN WIDTH IS 6' (2 m) OR LESS USE TWO-WAY MARKERS.

All dimensions are in inches (millimeters) unless otherwise shown.

MODEL: Default  
 FILE: \\nafe... \public\aw\_bentley.com\PIV\DOT\Documents\DOT Office\Dir\drt... \Project\11782\ICAD\DrawData\Design\BdfStd.dgn

USER NAME = rothp	DESIGNED -	REVISED - T. RAMMACHER 03-12-99
PLOT SCALE = 100,0000' / in.	DRAWN -	REVISED - T. RAMMACHER 01-06-00
PLOT DATE = 2/4/2022	CHECKED -	REVISED - C. JUCIUS 09-09-09
	DATE -	REVISED - C. JUCIUS 07-01-13

**STATE OF ILLINOIS  
 DEPARTMENT OF TRANSPORTATION**

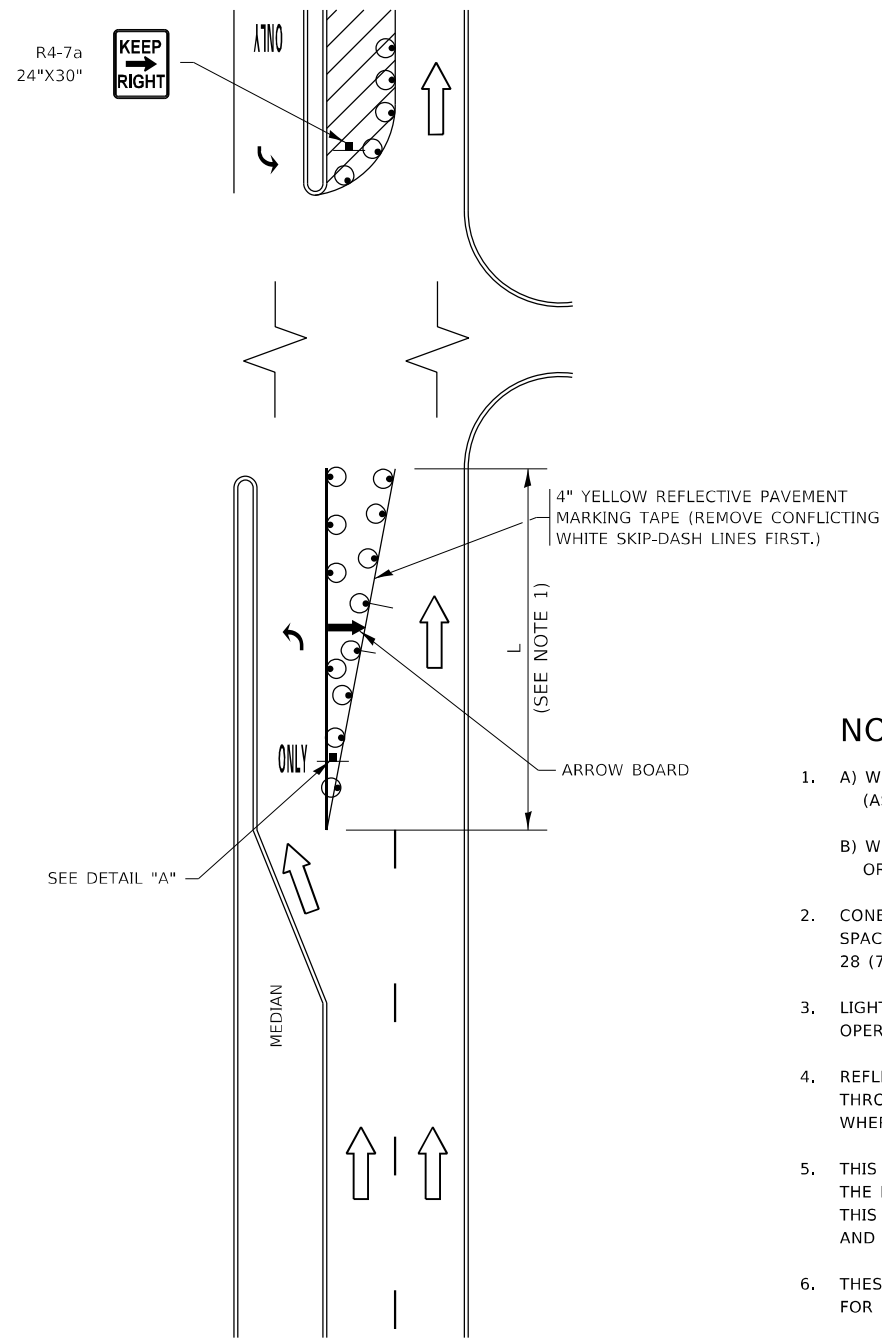
**TYPICAL APPLICATIONS  
 RAISED REFLECTIVE PAVEMENT MARKERS (SNOW-PLOW RESISTANT)**

SCALE: NONE SHEET 1 OF 1 SHEETS STA. TO STA.

F.A.U. RTE.	SECTION	COUNTY	TOTAL SHEETS	SHEET NO.
1608	2021-080-R5	COOK	24	17
TC-11			CONTRACT NO. 62P17	
ILLINOIS FED. AID PROJECT				

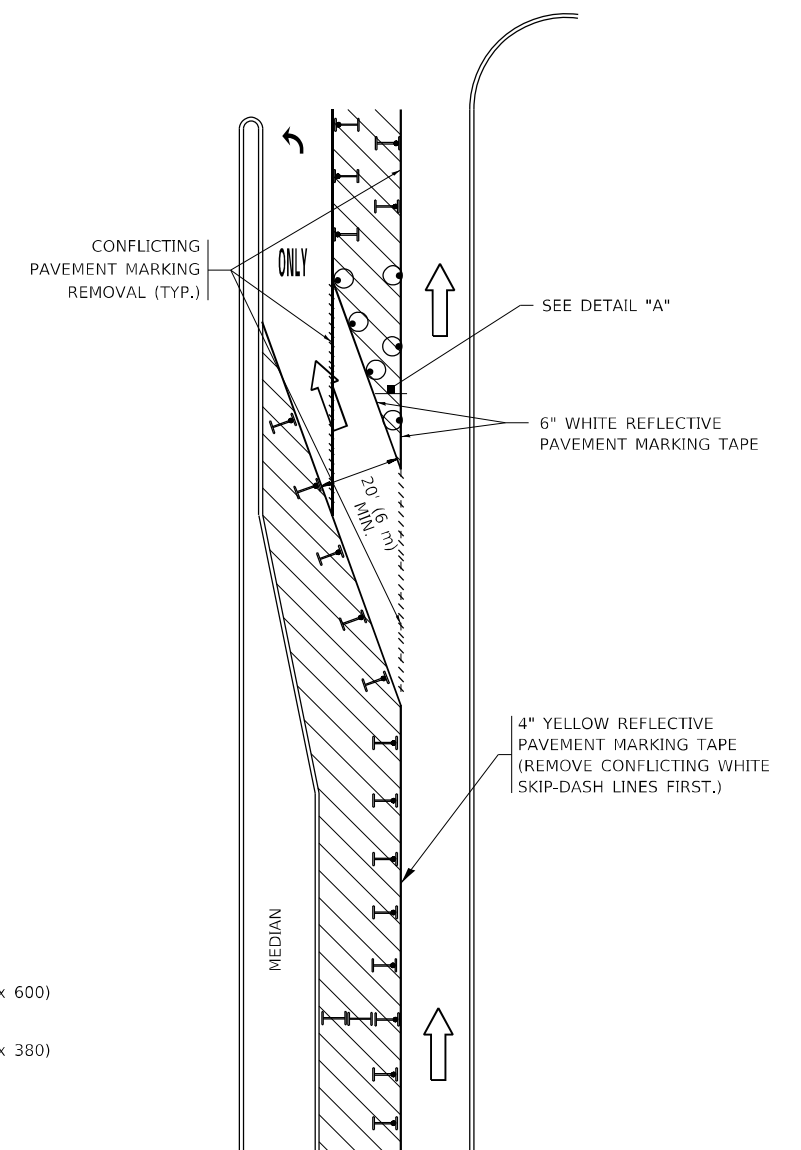


# TURN BAY ENTRANCE AT START OF LANE CLOSURE TAPER

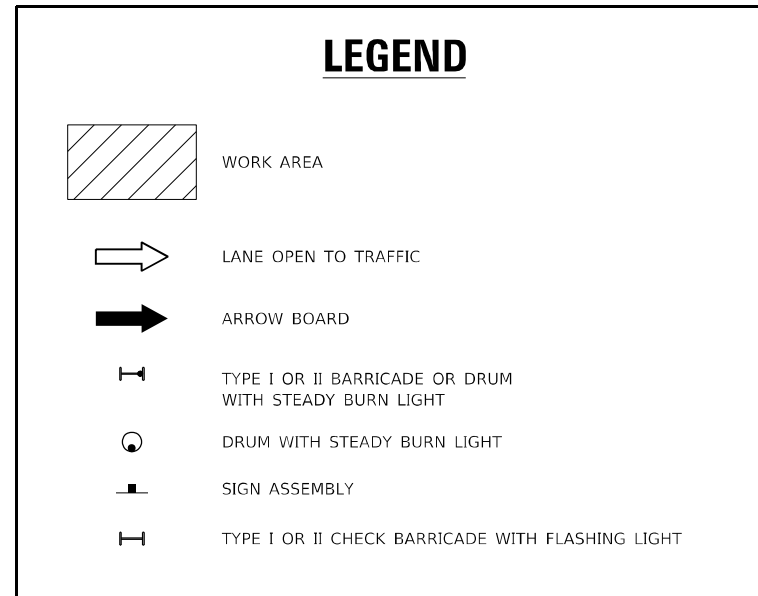


**FIGURE 1**

# TURN BAY ENTRANCE WITHIN A LANE CLOSURE

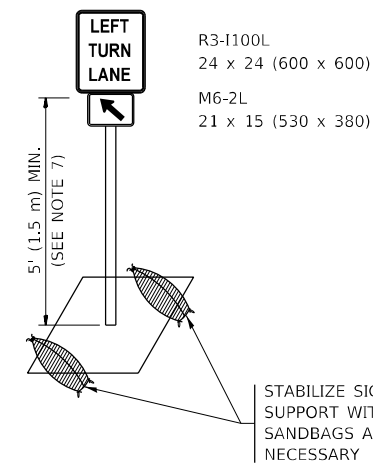


**FIGURE 2**



### NOTES:

1. A) WHEN "L" IS  $\leq$  THE STORAGE LENGTH OF THE TURN LANE (AS SHOWN IN FIG. 1), USE FIGURE 1.  
B) WHEN "L" IS  $>$  THE STORAGE LENGTH OF THE TURN LANE OR THE TURN LANE IS WITHIN THE LANE CLOSURE, USE FIGURE 2.
2. CONES MAY BE SUBSTITUTED FOR BARRICADES OR DRUMS AT HALF THE SPACING DURING DAY OPERATIONS. CONES SHALL BE A MINIMUM OF 28 (710) IN HEIGHT.
3. LIGHTS WILL NOT BE REQUIRED ON BARRICADES OR DRUMS FOR DAY OPERATIONS. ALL LIGHTS SHALL BE MONODIRECTIONAL.
4. REFLECTIVE TEMPORARY PAVEMENT MARKINGS SHALL BE PLACED THROUGHOUT THE BARRICADED AREAS OF EACH TURN BAY AS SHOWN WHERE THE CLOSURE TIME IS GREATER THAN FOURTEEN (14) DAYS.
5. THIS APPLICATION ALSO APPLIES WHEN WORK IS BEING PERFORMED IN THE RIGHT LANE(S) AND THE RIGHT TURN BAY IS TO REMAIN OPEN. UNDER THIS CONDITION, "RIGHT TURN LANE" R3-1100R 24 x 24 (600 x 600) AND M6-2R 21 x 15 (530 x 380) SHALL BE USED.
6. THESE CONTROLS SHALL SUPPLEMENT MAINLINE TRAFFIC CONTROL FOR LANE CLOSURES.
7. THE SIGNS SHALL BE MOUNTED ABOVE THE BARRICADES/DRUMS ON SEPARATE SIGN SUPPORTS THAT MEET NCHRP 350 OR MASH REQUIREMENTS.
8. TRAFFIC CONTROL AND PROTECTION AT TURN BAYS (TO REMAIN OPEN TO TRAFFIC) SHALL BE INCLUDED IN THE COST OF SPECIFIED TRAFFIC CONTROL STANDARDS OR ITEMS.



**DETAIL A**

All dimensions are in inches (millimeters) unless otherwise shown.

MODEL: Default  
FILE: \\na16f-pw\public\paw\_bentley.com\PIV\DOT\Documents\DOT Office\Dir\rdt\_1\Project\1011782\1\CAD\Drawings\Design\BartStc.dgn

USER NAME = rothjp	DESIGNED - T. RAMMACHER 09-08-94	REVISED - R. BORO 09-14-09
	DRAWN - A. HOUSEH 11-07-95	REVISED - A. SCHUETZE 07-01-13
PLOT SCALE = 100,0000' / in.	CHECKED - A. HOUSEH 10-12-96	REVISED - A. SCHUETZE 09-15-16
PLOT DATE = 2/4/2022	DATE - T. RAMMACHER 01-06-00	REVISED -

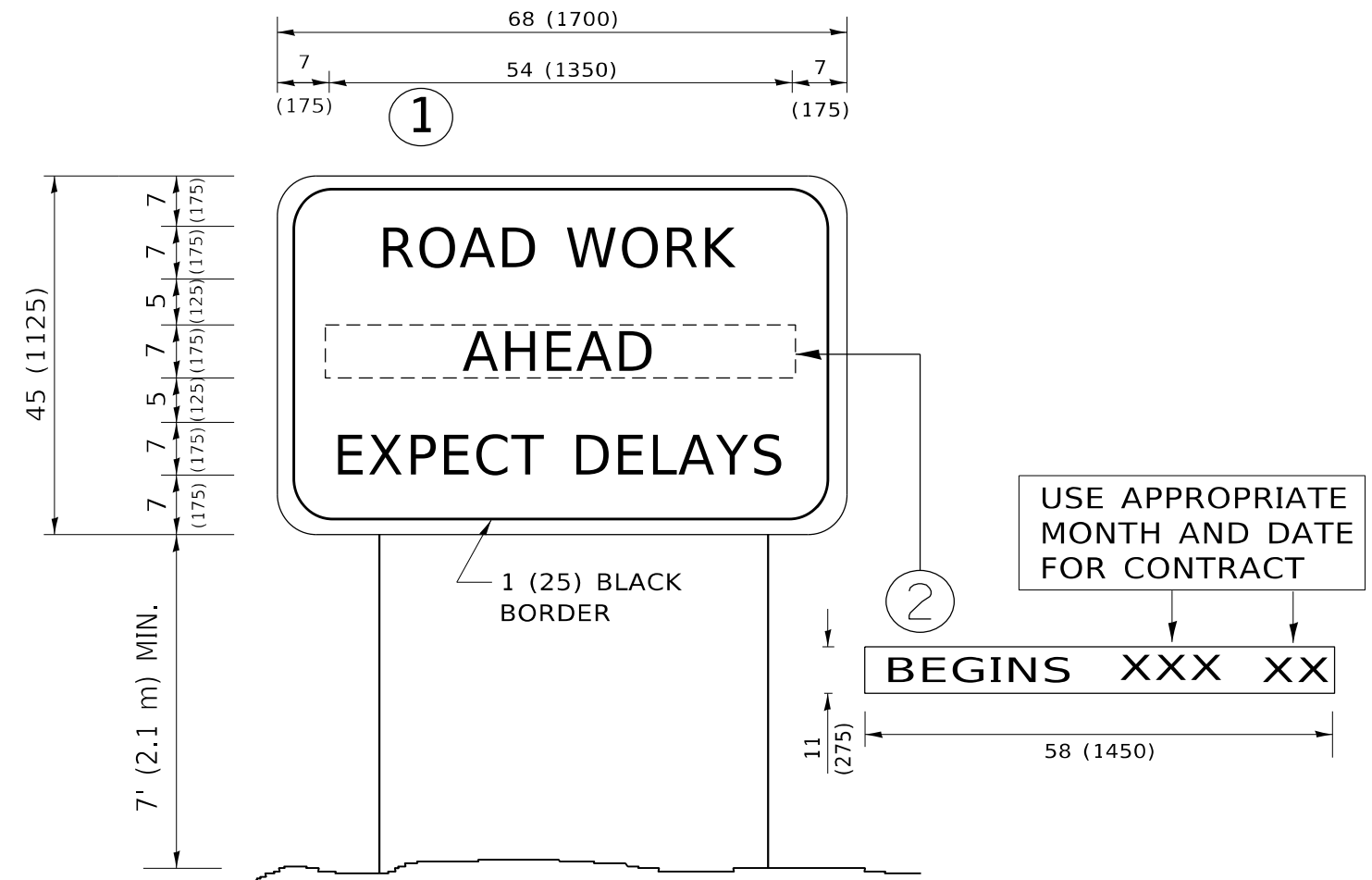
**STATE OF ILLINOIS  
DEPARTMENT OF TRANSPORTATION**

**TRAFFIC CONTROL AND PROTECTION AT TURN BAYS  
(TO REMAIN OPEN TO TRAFFIC)**

SCALE: NONE SHEET 1 OF 1 SHEETS STA. TO STA.

F.A.U. RTE.	SECTION	COUNTY	TOTAL SHEETS	SHEET NO.
1608	2021-080-R5	COOK	24	19
TC-14		CONTRACT NO. 62P17		
ILLINOIS FED. AID PROJECT				





**NOTES:**

1. USE BLACK LETTERING ON ORANGE BACKGROUND.
2. ERECT SIGNS IN ADVANCE OF THE LOCATION FOR THE "ROAD CONSTRUCTION AHEAD" SIGN AT LOCATIONS AS DIRECTED BY THE ENGINEER.
3. ERECT SIGN ① WITH INSTALLED PANEL ② ONE WEEK PRIOR TO THE START OF CONSTRUCTION.
4. REMOVE PANEL ② SOON AFTER THE START OF CONSTRUCTION.
5. SEE SPECIAL PROVISION FOR "TEMPORARY INFORMATION SIGNING" FOR ADDITIONAL INFORMATION.
6. ONE SIGN ASSEMBLY EQUALS 25.70 SQ. FT. (2.3 SQ. M.)
7. SHALL BE PAID FOR AS TEMPORARY INFORMATION SIGNING.

ALL DIMENSIONS ARE IN INCHES (MILLIMETERS) UNLESS OTHERWISE SHOWN.

MODEL: Default  
 FILE: \\nafe-pw-bentley.com\PW\DOT\Documents\DOT Office\Dir\drt\_1\Project\117821\CADD\data\Design\BtES.dgn

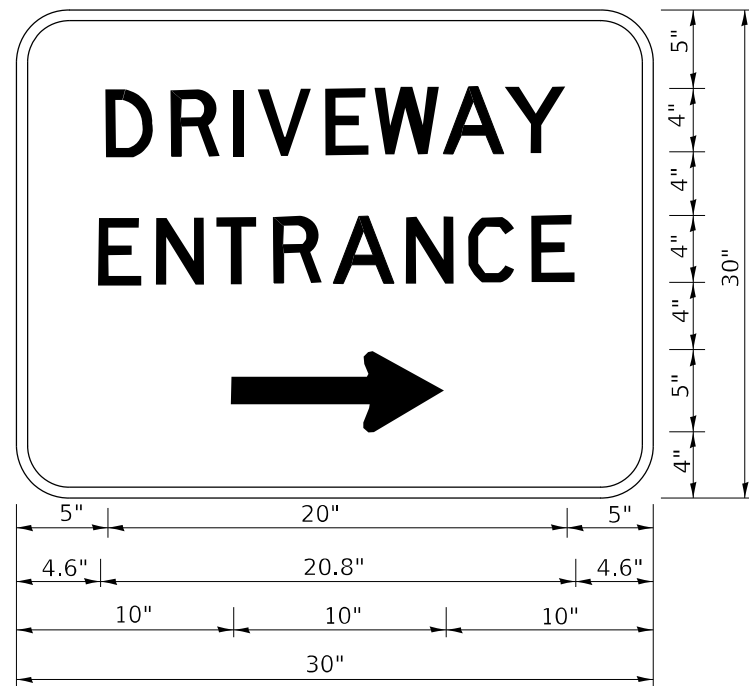
USER NAME = rothjp	DESIGNED -	REVISED - R. MIRS 09-15-97
	DRAWN -	REVISED - R. MIRS 12-11-97
PLOT SCALE = 100,0000 ' / in.	CHECKED -	REVISED - T. RAMMACHER 02-02-99
PLOT DATE = 2/4/2022	DATE -	REVISED - C. JUCIUS 01-31-07

**STATE OF ILLINOIS  
DEPARTMENT OF TRANSPORTATION**

**ARTERIAL ROAD  
INFORMATION SIGN**

SCALE: NONE SHEET 1 OF 1 SHEETS STA. TO STA.

F.A.U. RTE.	SECTION	COUNTY	TOTAL SHEETS	SHEET NO.
1608	2021-080-R5	COOK	24	21
<b>TC-22</b>			CONTRACT NO. 62P17	
ILLINOIS FED. AID PROJECT				



3.0" RADIUS, 0.5" BORDER, WHITE ON GREEN; REFLECTORIZED  
 "DRIVEWAY" D; "ENTRANCE" D; STANDARD ARROW CUSTOM 12.0" x 5.0"

NOTES:

1. HALF OF THE SIGNS WILL REQUIRE A LEFT HAND FACING ARROW.
2. TWO SIGNS SHALL BE USED AT EACH COMMERCIAL ENTRANCE PLACED BACK-TO-BACK: ONE WITH A RIGHT HAND ARROW (SHOWN) SHALL BE PLACED ON THE NEAR RIGHT SIDE THE DRIVEWAY AND ONE WITH A LEFT HAND ARROW SHALL BE PLACED ON THE FAR LEFT SIDE OF THE DRIVEWAY.
3. SIGNS TO BE PAID FOR AS ITEM "TEMPORARY INFORMATION SIGNING".

MODEL: Default  
 FILE NAME: p:\project\aw\_bentley.com\P\INDOT\Documents\DOT Office\Dir\rdet\_1\Project\1011782\ICAD\ata\Design\BdfSt6.dgn

USER NAME = rothjp	DESIGNED -	REVISED - C. JUCIUS 02-15-07
	DRAWN -	REVISED -
PLOT SCALE = 100,0000 ' / in.	CHECKED -	REVISED -
PLOT DATE = 2/4/2022	DATE -	REVISED -

**STATE OF ILLINOIS  
 DEPARTMENT OF TRANSPORTATION**

**DRIVEWAY ENTRANCE SIGNING**

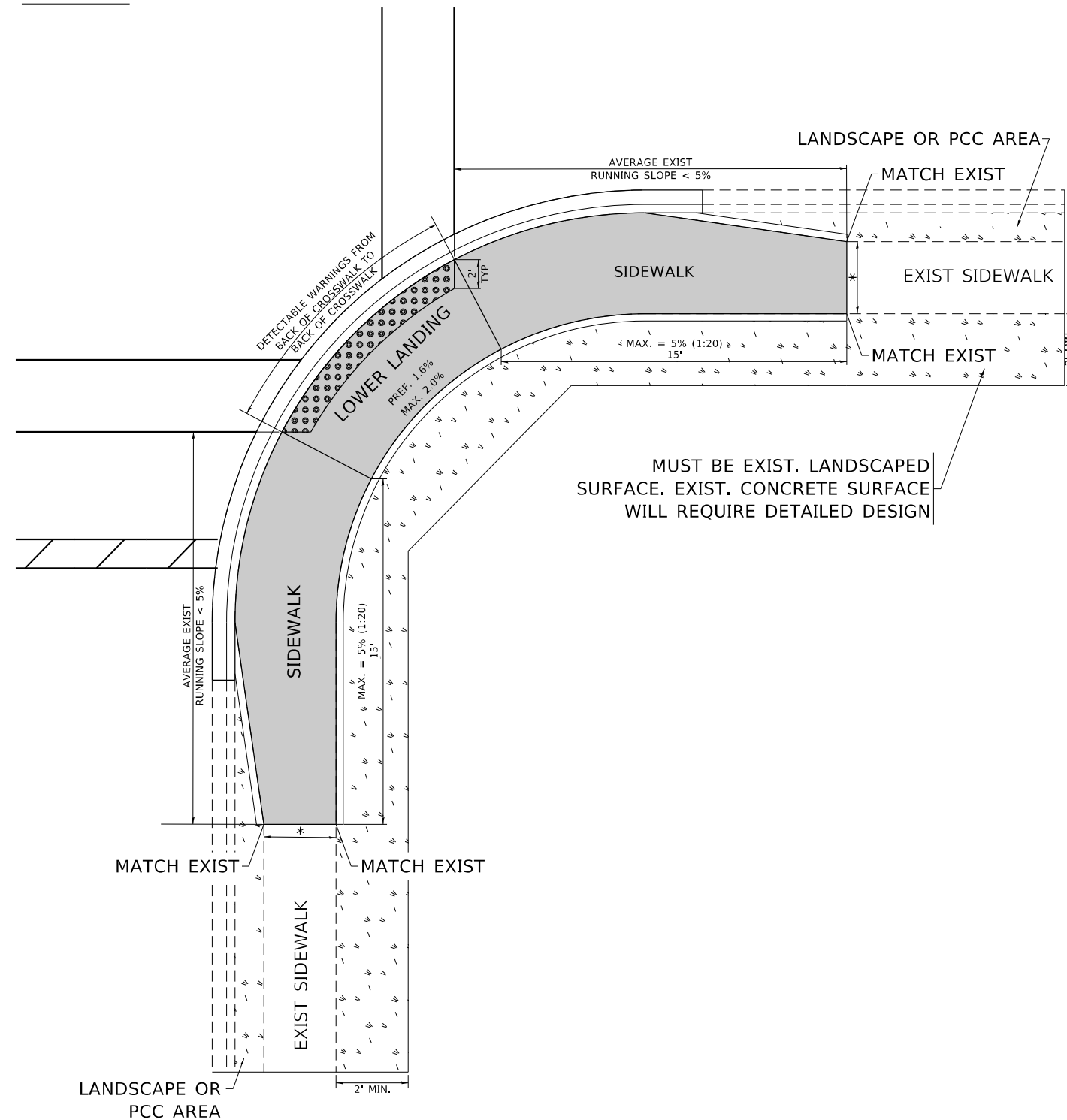
SCALE: NONE SHEET 1 OF 1 SHEETS STA. TO STA.

F.A.U. RTE.	SECTION	COUNTY	TOTAL SHEETS	SHEET NO.
1608	2021-080-R5	COOK	24	22
<b>TC-26</b>			CONTRACT NO. 62P17	
ILLINOIS FED. AID PROJECT				

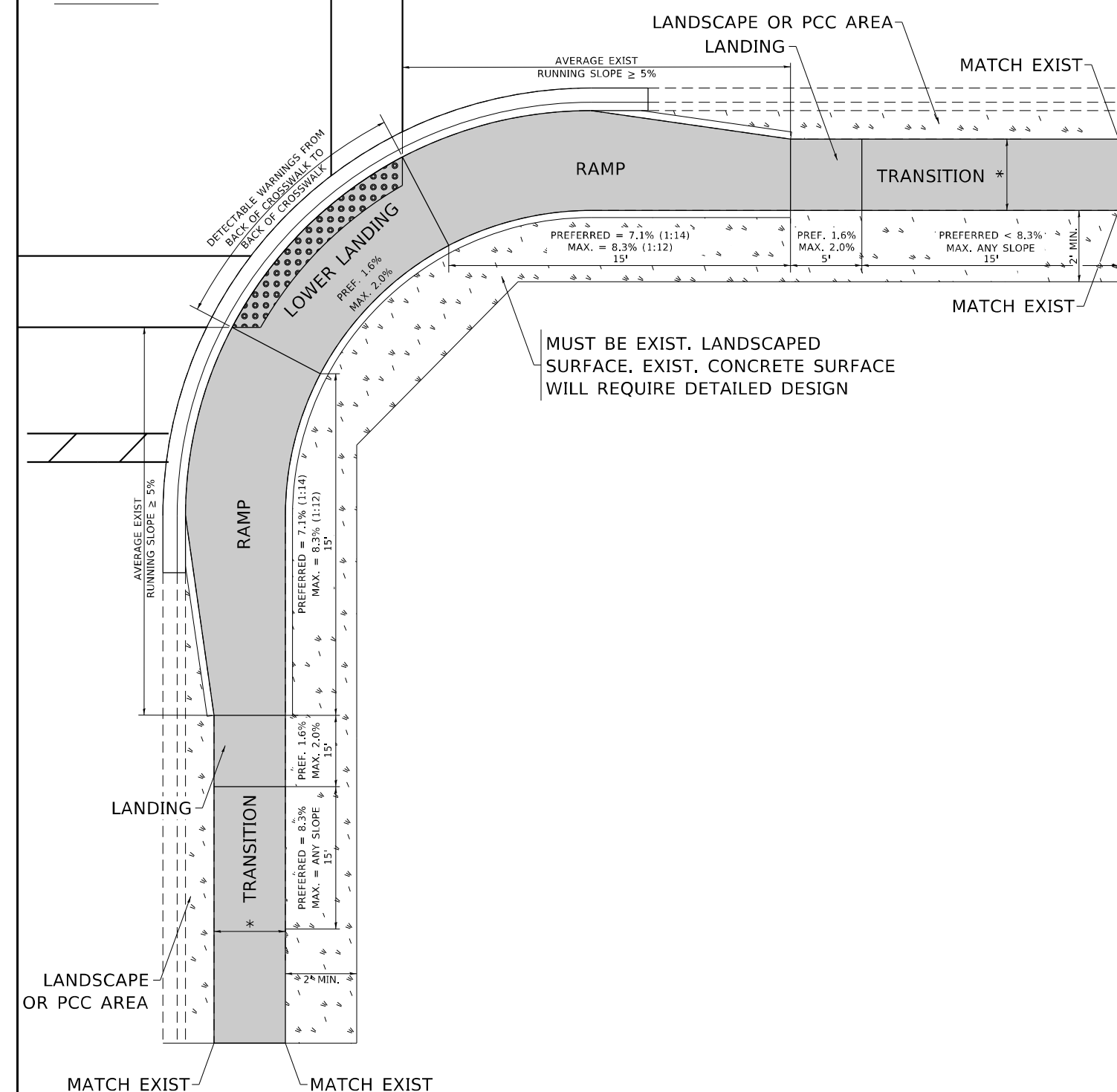


# ADA DETAIL FOR PARALLEL CURB RAMPS ADJACENT TO LANDSCAPING




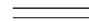
**PD-06A**



**PD-06B**



**LEGEND**

-  EXIST. GRASS
-  PROPOSED SIDEWALK
-  DETECTABLE WARNINGS
-  PROPOSED SIDE CURB

**CONSTRUCTION NOTES:**

- 1) ALL CROSS SLOPES ARE PREFERRED 1.6% (1:64), MAXIMUM 2% (1:50) EXCEPT WHEN TRANSITIONING TO EXISTING SIDEWALK
- \* MATCH EXISTING SIDEWALK WIDTH

MODEL: Default  
FILE NAME: p:\project-cw-beadley.com\PIV\DOT\Documents\DOT Office\Dir\rdet\_1\Project\117821\CAD\data\Design\BRTS\06.dgn

USER NAME = rothp	DESIGNED -	REVISED -
DRAWN - R. LEDEZMA	REVISOR -	REVISOR -
PLOT SCALE = 100,0000' / in.	CHECKED -	REVISOR -
PLOT DATE = 2/4/2022	DATE - 10/02/2019	REVISOR -

**STATE OF ILLINOIS  
DEPARTMENT OF TRANSPORTATION**

**PROJECT DETAIL FOR PARALLEL CURB RAMPS  
(PD-06)**

SCALE: NONE    SHEET    OF    SHEETS    STA.    TO STA.

F.A.U. RTE.	SECTION	COUNTY	TOTAL SHEETS	SHEET NO.
1608	2021-080-R5	COOK	24	24
PD-06		CONTRACT NO. 62P17		
ILLINOIS FED. AID PROJECT				