

STATE OF ILLINOIS
DEPARTMENT OF TRANSPORTATION

F.A.P. RTE.	SECTION	COUNTY	TOTAL SHEETS	SHEET NO.
326	(125)RS-6,(126)RS-4&(127X)RS-3	FORD	20	1
		ILLINOIS	CONTRACT NO. 66L03	

INDEX OF SHEETS

- 1 COVER SHEET
- 2 GENERAL NOTES & COMMITMENTS
- 3-6 SUMMARY OF QUANTITIES
- 7 TYPICAL SECTION
- 8-14 SCHEDULES
- 15 LAYOUT MAP
- 16-20 MISCELLANEOUS DETAILS

LIST OF ILLINOIS DOT HIGHWAY STANDARDS

- 000001-08 STANDARD SYMBOLS, ABBREVIATIONS AND PATTERNS
- 001006 DECIMAL OF AN INCH AND OF A FOOT
- 280001-07 TEMPORARY EROSION CONTROL SYSTEMS
- 406201-01 MAILBOX TURNOUT
- 701001-02 OFF-RD OPERATIONS, 2L, 2W, MORE THAN 15' (4.5 m) AWAY
- 701006-05 OFF-RD OPERATIONS, 2L, 2W, 15' (4.5 m) TO 24' (600 mm) FROM PAVEMENT EDGE
- 701101-05 OFF-RD OPERATIONS, MULTILANE, 15' (4.5 m) TO 24" (600 mm) FROM PAVEMENT EDGE
- 701201-05 LANE CLOSURE, 2L, 2W, DAY ONLY, FOR SPEEDS ≥ 45 MPH
- 701301-04 LANE CLOSURE, 2L, 2W, SHORT TIME OPERATIONS
- 701306-04 LANE CLOSURE, 2L, 2W, SLOW MOVING OPERATIONS DAY ONLY, FOR SPEEDS ≥ 45 MPH
- 701311-03 LANE CLOSURE 2L, 2W MOVING OPERATIONS-DAY ONLY
- 701901-08 TRAFFIC CONTROL DEVICES
- 780001-05 TYPICAL PAVEMENT MARKINGS
- 781001-04 TYPICAL APPLICATIONS RAISED REFLECTIVE PAVEMENT MARKERS

**PROPOSED
HIGHWAY PLANS**

**FAP ROUTE 326 (IL 47)
SECTION (125)RS-6,(126)RS-4&(127X)RS-3
PROJECT NHPP-E4IE(937)
SMART MILL & RESURFACE
FORD COUNTY**

C-93-086-20

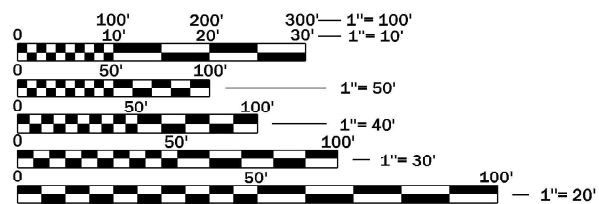

FULL SIZE PLANS HAVE BEEN PREPARED USING STANDARD ENGINEERING SCALES. REDUCED SIZED PLANS WILL NOT CONFORM TO STANDARD SCALES. IN MAKING MEASUREMENTS ON REDUCED PLANS, THE ABOVE SCALES MAY BE USED.

J.U.L.I.E.
JOINT UTILITY LOCATION INFORMATION FOR EXCAVATION
1-800-892-0123
OR 811

PROJECT ENGINEER: JOE KANNEL, P.E.
UNIT CHIEF: JORDAN LONGNECKER
DISTRICT 3 NO. (815) 434-6131
CONTRACT NO. 66L03

**PROJECT BEGINS
STA. 679 + 58**

**SN 027-2521
STA. 678 + 35**

**SN 027-0091
OMISSION
STA. 557 + 81 TO 559 + 28**

**SN 027-2523
STA. 232 + 47**

**PROJECT ENDS
STA. 115 + 50**

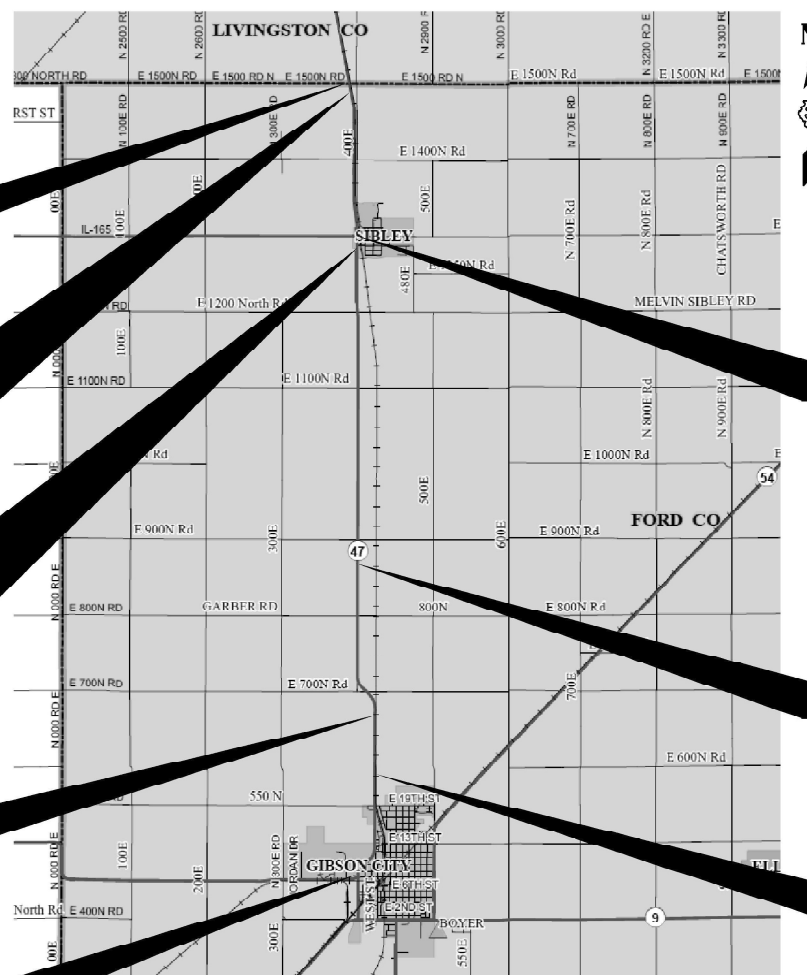

GROSS LENGTH = 56408 FT. = ±10.68 MILES
NET LENGTH = 56261 FT. = ±10.66 MILES

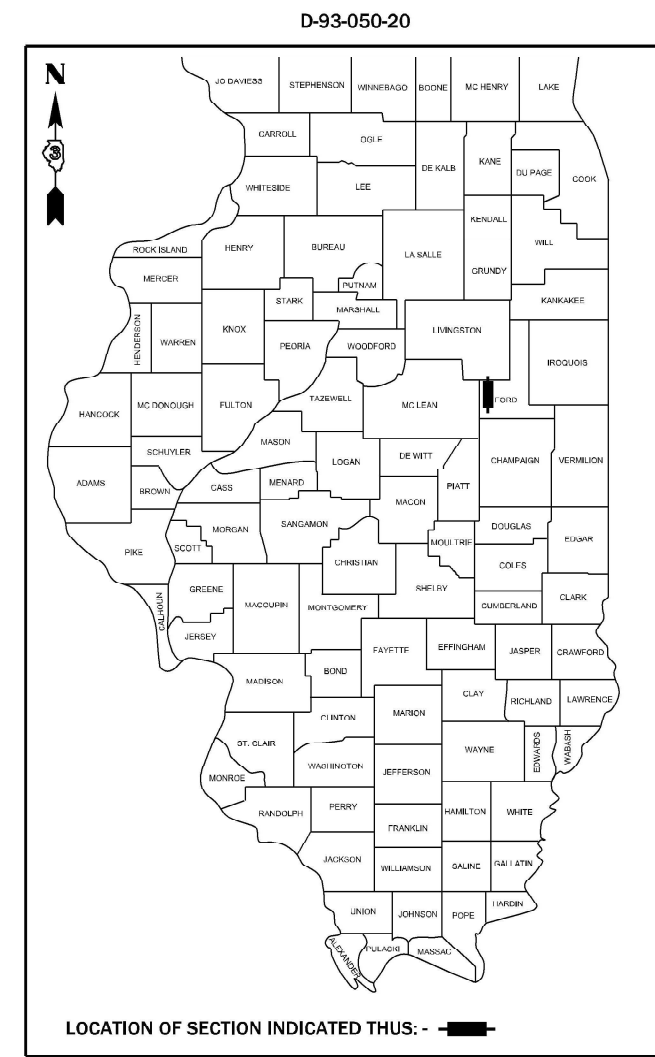

**FUNCTIONAL CLASSIFICATION:
OTHER PRINCIPAL ARTERIAL
RURAL**
2019 ADT: 2850
PV = 65.4% SU = 3.9% MU = 30.7%

STATE OF ILLINOIS
DEPARTMENT OF TRANSPORTATION
SUBMITTED February 18, 2022
[Signature]
REGIONAL ENGINEER
March 25, 2022
[Signature]
ENGINEER OF DESIGN AND ENVIRONMENT
March 25, 2022
[Signature]
DIRECTOR OF HIGHWAYS PROJECT IMPLEMENTATION

**PRINTED BY THE AUTHORITY
OF THE STATE OF ILLINOIS**

GENERAL NOTES

THE HMA SURFACE OF ALL MAILBOX TURNOUTS, PRIVATE ENTRANCES, COMMERCIAL ENTRANCES, AND SIDE ROADS SHALL BE MADE NEATLY, IN A WORKMANLIKE MANNER, AND SHALL ACCURATELY CONFORM TO THE SHAPES AND DIMENSIONS SHOWN ON THE PLAN DETAILS. IF REQUIRED BY THE ENGINEER, THE CONTRACTOR SHALL SAW CUT THE HMA SURFACE TO CONFORM TO THE SHAPES AND DIMENSIONS SHOWN ON THE PLAN DETAILS. THIS WORK WILL BE INCLUDED IN THE COST OF THE HMA SURFACE.

EXCEPT AS NOTED ON THE PLANS, PAVEMENT GRADES SHOWN ARE AT THE TOP OF PAVEMENT SURFACES.

BEFORE ORDERING PIPE CULVERTS OR PIPE DRAINS, THE CONTRACTOR SHALL CONSULT THE ENGINEER FOR EXACT LENGTHS.

THE ENGINEER WILL BE THE SOLE JUDGE CONCERNING CURING TIME FOR THE VARIOUS HMA LIFTS.

ON EXISTING PAVEMENT WHICH MAY BE SUPERELEVATED, THE NEW HMA PAVEMENT SHALL BE BUILT WITH THE SAME SUPERELEVATION UNLESS NEW SUPERELEVATION RATES ARE GIVEN ON THE PLANS.

ALL ELEVATIONS REFERRING TO U.S.G.S. MEAN SEA LEVEL DATUM.

THE FOLLOWING RATES OF APPLICATION HAVE BEEN USED IN CALCULATING PLAN QUANTITIES:

GRANULAR MATERIALS	2.05	TONS / CU YD
HMA RESURFACING	112	LBS / SQ YD / IN
SHORT TERM PAVEMENT MARKING	10	FT /100 FT OF APPLICATION
MIX FOR CRACKS, JTS & FLGWYS	0.0003	TONS / SQ YD
LEVEL BINDER (HAND METHOD)	0.0005	TONS / SQ YD

ALL DAMAGE TO DEPARTMENT OWNED UNDERGROUND FACILITIES, CAUSED BY THE CONTRACTOR SHALL BE REPAIRED TO THE SATISFACTION OF THE ENGINEER AND AT NO EXPENSE TO THE DEPARTMENT. THIS SHALL INCLUDE ALL TEMPORARY REPAIRS REQUIRED TO KEEP THE FACILITY OPERATIONAL WHILE MATERIAL IS BEING OBTAINED TO MAKE PERMANENT REPAIRS. SPLICING OF ELECTRIC CABLE WILL NOT BE ALLOWED. ELECTRIC CABLE SHALL BE REPLACED FROM POLE TO POLE OR CONTROLLER.

THE CONTRACTOR SHALL CONTACT JULIE AT LEAST 48 HOURS PRIOR TO EXCAVATION TO DETERMINE WHICH UTILITIES ARE WITH THE AREA.

COMMITMENTS

WORK NEAR SN 027-2007 AT DRUMMER CREEK SHOULD BE DONE DURING LOW FLOW CONDITIONS.

HMA MIXTURE REQUIREMENT TABLE		
LOCATIONS:	ENTIRE PROJECT	ENTIRE PROJECT
MIXTURE USE(S):	HMA SURFACE COURSE	INCIDENTAL HMA
BINDER GRADE (PG):	PG 64-22	PG 64-22
DESIGN AIR VOIDS:	4.0% @ N70	4.0% @ N70
MIXTURE COMPOSITION: (MIXTURE GRADATION)	IL-9.5	IL-9.5
FRICITION AGGREGATE:	MIXTURE C	
MIXTURE WEIGHT:	112.0 LB/SY/IN	112.0 LB/SY/IN
QUALITY MANAGEMENT PROGRAM:	QCP	QC/QA
SUBLOT SIZE:	1000 TONS	N/A
DENSITY TEST METHOD:	CORES	SATISFACTION OF ENGINEER
MATERIAL TRANSFER DEVICE (REQUIRED)	YES	NO

STATE OF ILLINOIS
DEPARTMENT OF TRANSPORTATION
DISTRICT THREE
AS BUILT INFORMATION

STATE OF ILLINOIS
DEPARTMENT OF TRANSPORTATION
DISTRICT THREE

SUPERVISING CONSTRUCTION FIELD ENGINEER

PREPARED BY: _____
DISTRICT STUDIES & PLANS ENGINEER

RESIDENT ENGINEER / TECHNICIAN

DATE: _____

START & END DATES
OF CONSTRUCTION:

EXAMINED BY: _____
DISTRICT CONSTRUCTION ENGINEER

INSPECTORS:

DISTRICT MATERIALS ENGINEER

DISTRICT OPERATIONS ENGINEER

**STATE OF ILLINOIS
DEPARTMENT OF TRANSPORTATION**

GENERAL NOTES

SCALE: _____ SHEET 1 OF 1 SHEETS STA. _____ TO STA. _____

F.A.P. RTE.	SECTION	COUNTY	TOTAL SHEETS	SHEET NO.
326	(125)RS-6,(126)RS-4&(127)RS-3	FORD	20	2
CONTRACT NO. 66L03			ILLINOIS FED. AID PROJECT	

CODE NO.	ITEM	UNIT	TOTAL QUANTITY	CONSTR. CODE	
				80% FED 20% ST	
				ROADWAY	RURAL
20300100	CHANNEL EXCAVATION	CU YD	3		3
20400800	FURNISHED EXCAVATION	CU YD	36		36
21400100	GRADING AND SHAPING DITCHES	FOOT	2400		2400
25000210	SEEDING, CLASS 2A	ACRE	0.8		0.8
25000400	NITROGEN FERTILIZER NUTRIENT	POUND	76		76
25000500	PHOSPHORUS FERTILIZER NUTRIENT	POUND	76		76
25000600	POTASSIUM FERTILIZER NUTRIENT	POUND	76		76
25100630	EROSION CONTROL BLANKET	SQ YD	4074		4074
28100107	STONE RIPRAP, CLASS A4	SQ YD	74		74
28200200	FILTER FABRIC	SQ YD	74		74
40200800	AGGREGATE SURFACE COURSE, TYPE B	TON	134		134
40600290	BITUMINOUS MATERIALS (TACK COAT)	POUND	86791		86791
40600370	LONGITUDINAL JOINT SEALANT	FOOT	55752		55752
40600400	MIXTURE FOR CRACKS, JOINTS, AND FLANGWAYS	TON	56		56

MODEL: Default
 FILE NAME: p:\project-aw-beadley.com\PIV\DOT\Documents\DOT Office\Dir\dir: 3\project\0366103\CADD\DATA\0366103-pl-500.dgn

USER NAME = longneckerjh	DESIGNED - EM	REVISED - _____
	DRAWN - EM	REVISED - _____
PLOT SCALE = 100,0000' / in.	CHECKED - JL	REVISED - _____
PLOT DATE = 2/23/2022	DATE - 2/23/2022	REVISED - _____

**STATE OF ILLINOIS
DEPARTMENT OF TRANSPORTATION**

SUMMARY OF QUANTITIES

SCALE: _____ SHEET 1 OF 4 SHEETS STA. _____ TO STA. _____

F.A.P. RTE.	SECTION	COUNTY	TOTAL SHEETS	SHEET NO.
326	(125)RS-6,(126)RS-4&,(127X)RS-3	FORD	20	3
CONTRACT NO. 66L03				
ILLINOIS FED. AID PROJECT				

CONSTR. CODE
80% FED 20% ST

CODE NO.	ITEM	UNIT	TOTAL QUANTITY	ROADWAY
				0005 RURAL
40600901	HOT-MIX ASPHALT BINDER COURSE (HAND METHOD), N70	TON	93	93
40600990	TEMPORARY RAMP	SQ YD	581	581
40604052	HOT-MIX ASPHALT SURFACE COURSE, IL-9.5, MIX "C", N70	TON	15698	15698
40800050	INCIDENTAL HOT-MIX ASPHALT SURFACING	TON	873	873
44000155	HOT-MIX ASPHALT SURFACE REMOVAL, 1 1/2"	SQ YD	186877	186877
44200956	CLASS B PATCHES, TYPE II, 9 INCH	SQ YD	165	165
48102100	AGGREGATE WEDGE SHOULDER, TYPE B	TON	3528	3528
54260315	TRAVERSABLE PIPE GRATE FOR CONCRETE END SECTION	FOOT	44	44
54261818	STEEL FLARED END SECTIONS, EQUIVALENT ROUND-SIZE 18"	EACH	2	2
54263336	CONCRETE END SECTION, STANDARD 542011, 36", 1:3	EACH	2	2
60905305	BOX CULVERTS TO BE CLEANED	FOOT	270	270
* 66700205	PERMANENT SURVEY MARKERS, TYPE I	EACH	11	11
* 66900200	NON-SPECIAL WASTE DISPOSAL	CU YD	86	86
* 66900530	SOIL DISPOSAL ANALYSIS	EACH	4	4

*= SPECIALTY ITEM

MODEL: Default
 FILE: \\mifs-pw-beadley.com\PW\DOT\Documents\DOT Office\Dir\dir: 3\Project\10366103\CADD\Drawn\10366103-pl-500.dgn

USER NAME = longneckerjh	DESIGNED - EM	REVISED - _____	STATE OF ILLINOIS DEPARTMENT OF TRANSPORTATION	SUMMARY OF QUANTITIES			F.A.P. RTE.	SECTION	COUNTY	TOTAL SHEETS	SHEET NO.
PLOT SCALE = 100,0000' / in.	DRAWN - EM	REVISED - _____					326	(125)RS-6,(126)RS-4&(127X)RS-3	FORD	20	4
PLOT DATE = 2/23/2022	CHECKED - JL	REVISED - _____		SCALE: _____ SHEET 2 OF 4 SHEETS STA. _____ TO STA. _____			CONTRACT NO. 66L03				
DATE - 2/23/2022	DATE - 2/23/2022	REVISED - _____					ILLINOIS FED. AID PROJECT				

CONSTR. CODE	
80% FED	20% ST

CODE NO.	ITEM	UNIT	TOTAL QUANTITY	ROADWAY	
				0005	RURAL
* 66901001	REGULATED SUBSTANCES PRE-CONSTRUCTION PLAN	L SUM	1		1
* 66901003	REGULATED SUBSTANCES FINAL CONSTRUCTION REPORT	L SUM	1		1
* 66901006	REGULATED SUBSTANCES MONITORING	CAL DA	5		5
67000400	ENGINEER'S FIELD OFFICE, TYPE A	CAL MO	5		5
67100100	MOBILIZATION	L SUM	1		1
70100450	TRAFFIC CONTROL AND PROTECTION, STANDARD 701201	L SUM	1		1
70100460	TRAFFIC CONTROL AND PROTECTION, STANDARD 701306	L SUM	1		1
70300100	SHORT TERM PAVEMENT MARKING	FOOT	27795		27795
70300150	SHORT TERM PAVEMENT MARKING REMOVAL	SQ FT	9265		9265
* 78000100	THERMOPLASTIC PAVEMENT MARKING - LETTERS AND SYMBOLS	SQ FT	62.4		62.4
* 78000200	THERMOPLASTIC PAVEMENT MARKING - LINE 4"	FOOT	4276		4276
* 78000500	THERMOPLASTIC PAVEMENT MARKING - LINE 8"	FOOT	335		335
* 78000600	THERMOPLASTIC PAVEMENT MARKING - LINE 12"	FOOT	408		408

*= SPECIALTY ITEM

MODEL: D:\draft
 FILE NAME: P:\11636246\Bentley.com\PROJECTS\DOT_Offices\District_3\Projects\2022\66L03\CADD\2022\66L03-R1-500.dgn

USER NAME = longneckerjh	DESIGNED - EM	REVISED - _____
	DRAWN - EM	REVISED - _____
PLOT SCALE = 100.0000' / in.	CHECKED - JL	REVISED - _____
PLOT DATE = 2/23/2022	DATE - 2/23/2022	REVISED - _____

**STATE OF ILLINOIS
DEPARTMENT OF TRANSPORTATION**

SUMMARY OF QUANTITIES

SCALE: _____ SHEET 3 OF 4 SHEETS STA. _____ TO STA. _____

F.A.P. RTE.	SECTION	COUNTY	TOTAL SHEETS	SHEET NO.
326	(125)RS-6,(126)RS-4&(127X)RS-3	FORD	20	5
ILLINOIS FED. AID PROJECT			CONTRACT NO. 66L03	

CONSTR. CODE	
80% FED	20% ST

CODE NO.	ITEM	UNIT	TOTAL QUANTITY	ROADWAY	
				0005	RURAL
* 78001110	PAINT PAVEMENT MARKING - LINE 4"	FOOT	286060		286060
* 78001130	PAINT PAVEMENT MARKING - LINE 6"	FOOT	23263		23263
* 78011000	GROOVING FOR RECESSED PAVEMENT MARKING, LETTERS AND SYMBOLS	SQ FT	62.4		62.4
* 78011025	GROOVING FOR RECESSED PAVEMENT MARKING 5"	FOOT	4276		4276
* 78011045	GROOVING FOR RECESSED PAVEMENT MARKING 9"	FOOT	335		335
* 78011065	GROOVING FOR RECESSED PAVEMENT MARKING 13"	FOOT	408		408
* 78100100	RAISED REFLECTIVE PAVEMENT MARKER	EACH	735		735
	78300200 RAISED REFLECTIVE PAVEMENT MARKER REMOVAL	EACH	663		663
	X0327809 LINEAR DELINEATOR PANELS, 4 INCH	EACH	14		14
	X4401198 HOT-MIX ASPHALT SURFACE REMOVAL, VARIABLE DEPTH	SQ YD	5974		5974
	X5430101 INSERTION CULVERT LINER (SPECIAL), LOCATION 1	FOOT	42		42
	X5537800 STORM SEWERS TO BE CLEANED 12"	FOOT	68		68
	Z0030850 TEMPORARY INFORMATION SIGNING	SQ FT	42		42
	Z0034105 MATERIAL TRANSFER DEVICE	TON	15698		15698
	Z0048665 RAILROAD PROTECTIVE LIABILITY INSURANCE	L SUM	1		1

*= SPECIALTY ITEM

MODEL: Default
FILE NAME: p:\project-pw-beadley.com\PIV\DOT\Documents\DOT Office\Dir\dir: 3\project\0366103\CADD\data\0366103-pl-500.dgn

USER NAME = longneckerjh	DESIGNED - EM	REVISED - _____
	DRAWN - EM	REVISED - _____
PLOT SCALE = 100,0000 ' / in.	CHECKED - JL	REVISED - _____
PLOT DATE = 2/23/2022	DATE - 2/23/2022	REVISED - _____

**STATE OF ILLINOIS
DEPARTMENT OF TRANSPORTATION**

SUMMARY OF QUANTITIES

SCALE: _____ SHEET 4 OF 4 SHEETS STA. _____ TO STA. _____

F.A.P. RTE.	SECTION	COUNTY	TOTAL SHEETS	SHEET NO.
326	(125)RS-6,(126)RS-4&(127X)RS-3	FORD	20	6
			CONTRACT NO. 66L03	
ILLINOIS FED. AID PROJECT				

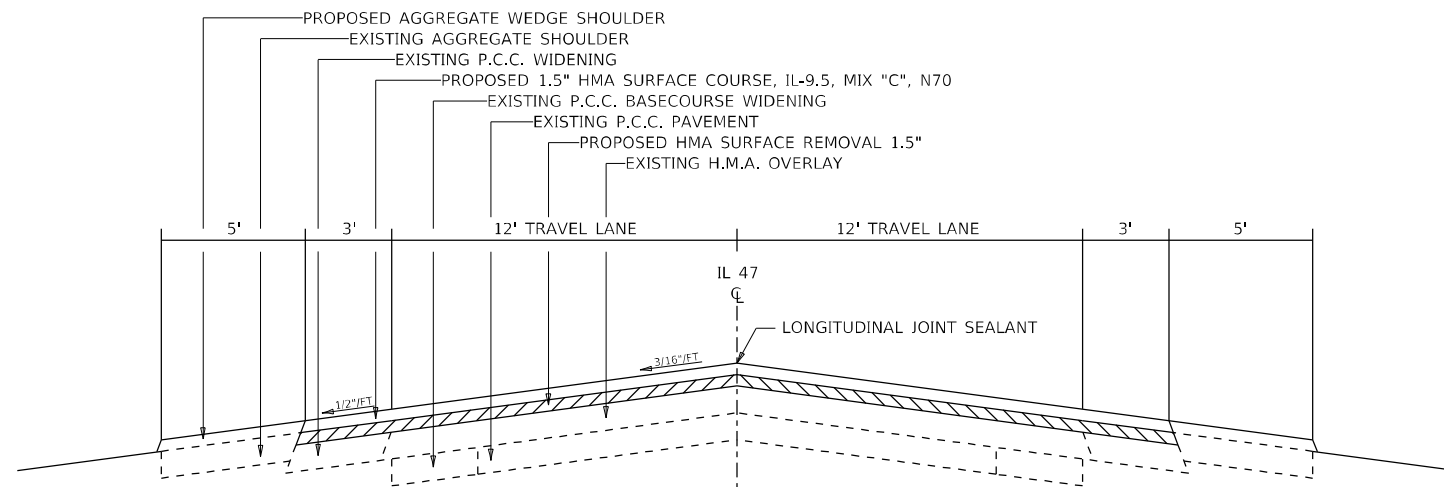

PROPOSED TYPICAL SECTION

STA. 120+50 TO STA. 557+81
 OMISSION 557+81 TO 559+28 (SN 027-0091)
 STA. 559+28 TO STA. 564+90

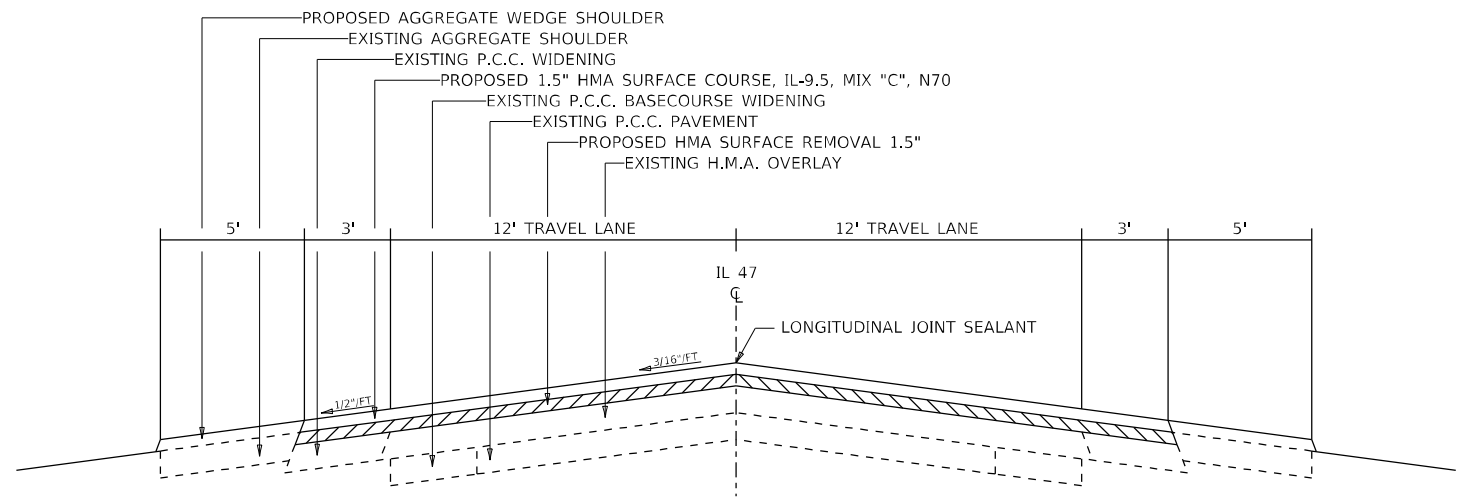

PROPOSED TYPICAL SECTION

STA. 575+72 TO STA. 679+58

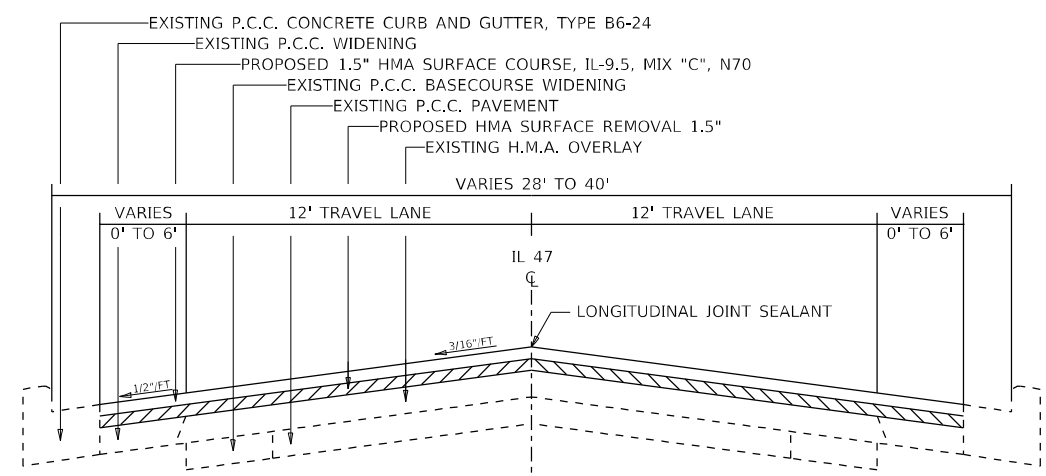

PROPOSED TYPICAL SECTION

STA. 564+90 TO STA. 572+72

MODEL: Default
 FILE: \\na11e1-pw-bentley.com\PW\DOT\Documents\DOT Office\Dir\dir: 3\Project\03666\03\CAD\Drawings\03666\03666.dgn

USER NAME = longneckerjh	DESIGNED - CJ	REVISED - _____
DRAWN - CJ	REVISIONS - _____	
PLOT SCALE = 100,0000' / in.	CHECKED - JL	REVISIONS - _____
PLOT DATE = 2/22/2022	DATE - 2/22/2022	REVISIONS - _____

**STATE OF ILLINOIS
 DEPARTMENT OF TRANSPORTATION**

TYPICAL SECTION	
SCALE: _____	SHEET 1 OF 1 SHEETS
STA. _____	TO STA. _____

F.A.P. RTE.	SECTION	COUNTY	TOTAL SHEETS	SHEET NO.
326	(125)RS-6,(126)RS-4&(127)RS-3	FORD	20	7
CONTRACT NO. 66L03				
ILLINOIS FED. AID PROJECT				

MAINLINE SCHEDULE

LOCATION	LENGTH	HMA SURF REM 1 - 1/2"	HMA SURF CSE IL - 9.5 MIX 'C' N70	LONG JOINT SEAL	AGG WEDGE SHLD TYPE B	TEMP RAMP	BIT MAT (TACK COAT)	MIX FOR CRACKS, JOINTS & FLGWYS	HMA BIND. (H.M)
	FOOT	SQ YD	TON	FOOT	TON	SQ YD	POUND	TON	TON
120+50 TO 197+80	7730	25767	2164	7730	489	17	11595	8	13
197+80 TO 198+05	25	92	8	25	2		41	0	0
198+05 TO 199+15	110	440	37	110	7		198	0	0
199+15 TO 199+38	23	84	7	23	1		38	0	0
199+38 TO 231+75	3237	10790	906	3237	205		4856	3	5
231+75 TO 231+93	18	66	6	18	1		30	0	0
231+93 TO 232+95	102	408	34	102	6		184	0	0
232+95 TO 233+23	28	103	9	28	2		46	0	0
233+32 TO 554+99	32167	107223	9007	32167	2035		48250	32	54
554+99 TO 557+81	282	1128	95	282	18	20	508	0	1
557+81 TO 559+28 SN 027-0091 OMISSION	147								
559+28 TO 562+02	274	1096	92	274	17	20	493	0	1
562+02 TO 565+00	298	993	83	298	19		447	0	0
565+00 TO 566+99	199	531	45	199	13		239	0	0
566+99 TO 568+99	200	667	56	200	13		300	0	0
568+99 TO 574+99	600	2400	202	600	38		1080	1	1
574+99 TO 577+39	240	880	74	240	15		396	0	0
577+39 TO 677+39	10000	33333	2800	10000	633		15000	10	17
677+39 TO 679+58	219	876	74	219	14	20	394	0	0
TOTAL	55899	186877	15699	55752	3528	77	84095	54	92

MODEL: Default
 FILE: Mainline_schedule.dwg
 C:\Users\paw.bentley.com\PIV\DOT\Documents\DOT Office\Dir\dir: 3\Project\0366103\CADD\data\0366103-mainline-schedule.dgn

USER NAME = longneckerjh	DESIGNED - CJ	REVISED - _____
	DRAWN - CJ	REVISED - _____
PLOT SCALE = 100,0000' / in.	CHECKED - JL	REVISED - _____
PLOT DATE = 2/22/2022	DATE - 2/22/2022	REVISED - _____

**STATE OF ILLINOIS
DEPARTMENT OF TRANSPORTATION**

SCHEDULES			
SCALE: _____	SHEET 1	OF 7 SHEETS	STA. _____ TO STA. _____

F.A.P. RTE.	SECTION	COUNTY	TOTAL SHEETS	SHEET NO.
326	(125)RS-6,(126)RS-4&(127)RS-3	FORD	20	8
CONTRACT NO. 66L03			ILLINOIS FED. AID PROJECT	

PAVEMENT MARKING SCHEDULE

LOCATION	LENGTH FOOT	PAINT PAV'T MARK.			THERMOPLASTIC PAVEMENT MARKING					GROOVING FOR PAVEMENT MARKING				RAISED REFL	RAISED REFL
		4 INCH		6 INCH	LETTERS & SYMBOLS SQ FT	4 INCH YELLOW FOOT	8 INCH WHITE FOOT	12 INCH		L&S SQ FT	5 INCH FOOT	9 INCH FOOT	13 INCH FOOT	PVMT MARK REM EACH	PVMT MARK EACH
		WHITE	YELLOW	YELLOW				WHITE	YELLOW						
		FOOT	FOOT	FOOT	FOOT	FOOT	FOOT	FOOT	FOOT	FOOT	FOOT	FOOT	FOOT	FOOT	FOOT
120+50 TO 197+80	7730	30920		2873										87	97
197+80 TO 198+05	25	100		13										0	0
198+05 TO 199+15	110	440		55										1	1
199+15 TO 199+38	23	92		12										0	0
199+38 TO 231+75	3237	12948		1619										36	40
231+75 TO 231+93	18	72		9										0	0
231+93 TO 232+95	102	408		51										1	1
232+95 TO 233+23	28	112		14										0	0
233+32 TO 554+99	32167	128668		12970										362	402
554+99 TO 557+81	282	1128		141										4	4
557+81 TO 559+28 SN 027-0091	147	588		74											
559+28 TO 562+02	274	1096		137										3	3
562+02 TO 565+00	298	1192		149										4	4
565+00 TO 566+99	199	796		62										2	2
566+99 TO 568+99	200	800													
568+99 TO 574+99	600	2400													
574+99 TO 577+39	240	960													
577+39 TO 677+39	10000	40000		4974										113	125
677+39 TO 679+58	219	876		110										3	3
NO PASSING ZONES															
120+50 TO 138+88 BOTH	1838		7352												
138+88 TO 145+72 LT	684		1368												
159+63 TO 168+76 RT	913		1826												
168+76 TO 170+23 BOTH	147		588												
170+23 TO 174+85 LT	462		924												
179+95 TO 189+18 RT	923		1846												
191+23 TO 199+36 LT	813		1626												
230+22 TO 239+95 RT	973		1946												
239+95 TO 276+61 BOTH	3666		14664												
276+61 TO 287+18 LT	1057		2114												
304+19 TO 312+26 RT	807		1614												
319+84 TO 321+05 LT	121		242												
331+98 TO 339+87 LT	789		1578												
445+61 TO 453+77 LT	816		1632												
453+77 TO 476+66 BOTH	2289		9156												
469+77 TO 485+81 LT	1604		3208												
488+52 TO 494+85 LT	633		1266												
505+77 TO 516+18 RT	1041		2082												
516+18 TO 518+90 BOTH	272		1088												
518+90 TO 524+39 LT	549		1098												
562+57 TO 566+24 RT	367		734												
566+24 TO 571+52 MEDIAN	528			31.2	2112	165	40	144	31.2	2112	165	184	23	26	
572+50 TO 577+91 MEDIAN	541			31.2	2164	170	44	180	31.2	2164	170	224	24	27	
577+91 TO 582+58 LT	467		934												
595+71 TO 603+39 RT	768		1536												
606+61 TO 614+22 LT	761		1522												
SUBTOTAL		223596	61944	23263	62.4	4276	335	84	324	62.4	4276	335	408	663	735
TOTAL		223596	61944	23263	62.4	4276	335	84	324	62.4	4276	335	408	663	735

MODEL: Default
 FILE: \\nafe-pw-beadley.com\FW\DOT\Documents\DOT Office\Dir\Dir: 3\Project\0366\03\CAD\Drawings\0366\0366-03-pav-schedule.dgn

USER NAME = longneckerjh	DESIGNED - CJ	REVISED - _____
DRAWN - CJ	REVISED - _____	
PLOT SCALE = 100,0000' / in.	CHECKED - JL	REVISED - _____
PLOT DATE = 2/22/2022	DATE - 2/22/2022	REVISED - _____

**STATE OF ILLINOIS
DEPARTMENT OF TRANSPORTATION**

SCHEDULES			
SCALE: _____	SHEET 4	OF 7 SHEETS	STA. _____ TO STA. _____

F.A.P. RTE.	SECTION	COUNTY	TOTAL SHEETS	SHEET NO.
326	(125)RS-6,(126)RS-4&(127)RS-3	FORD	20	9
CONTRACT NO. 66L03				
ILLINOIS FED. AID PROJECT				

SEEDING SCHEDULE									
LOCATION	SIDE	LENGTH	WIDTH	SEEDING CL 2A	NITRO FERT NUT	PHOSP FERT NUT	POT FERT NUT	EROSION CONTROL BLANKET	
STA TO STA		FOOT	FOOT	ACRE	LB	LB	LB	SQ YD	
126+80	ELM ST	ALL QUADS	80	5	0.009	0.81	0.81	0.81	44
137+43	12TH ST	ALL QUADS	80	5	0.009	0.81	0.81	0.81	44
169+43	19TH ST	ALL QUADS	160	5	0.018	1.62	1.62	1.62	89
176+60	177+60	LT	100	12	0.028	2.52	2.52	2.52	133
177+71	CULVERT	OUTLET	35	12	0.01	0.9	0.9	0.9	47
210+61	CULVERT	OUTLET	35	12	0.01	0.9	0.9	0.9	47
224+50	225+50	LT	100	12	0.028	2.52	2.52	2.52	133
251+23	700N RD	ALL QUADS	160	5	0.018	1.62	1.62	1.62	89
256+80	CULVERT	OUTLET	35	12	0.01	0.9	0.9	0.9	47
259+89	400N RD	ALL QUADS	80	5	0.009	0.81	0.81	0.81	44
306+40	800 N RD	ALL QUADS	160	5	0.018	1.62	1.62	1.62	89
359+50	900 N RD	ALL QUADS	160	5	0.018	1.62	1.62	1.62	89
379+20	380+20	RT	100	12	0.028	2.52	2.52	2.52	133
395+85	396+85	LT	100	12	0.028	2.52	2.52	2.52	133
396+85	CULVERT	OUTLET	35	12	0.01	0.9	0.9	0.9	47
401+70	403+20	RT	150	12	0.041	3.69	3.69	3.69	200
429+70	432+20	RT	250	12	0.069	6.21	6.21	6.21	333
439+50	440+50	LT	100	12	0.028	2.52	2.52	2.52	133
440+46	CULVERT	OUTLET	35	12	0.01	0.9	0.9	0.9	47
440+50	441+50	LT	100	12	0.028	2.52	2.52	2.52	133
441+00	442+50	LT	150	12	0.041	3.69	3.69	3.69	200
461+30	462+30	RT	100	12	0.028	2.52	2.52	2.52	133
465+65	1100N RD	ALL QUADS	160	5	0.018	1.62	1.62	1.62	89
480+68	CULVERT	OUTLET	35	12	0.01	0.9	0.9	0.9	47
504+60	506+00	RT	140	12	0.039	3.51	3.51	3.51	187
509+00	511+50	LT	250	12	0.069	6.21	6.21	6.21	333
518+90	1200N RD	ALL QUADS	160	5	0.018	1.62	1.62	1.62	89
521+64	CULVERT	OUTLET	35	12	0.01	0.9	0.9	0.9	47
541+00	541+60	LT	60	12	0.017	1.53	1.53	1.53	80
564+50	565+00	RT	50	12	0.014	1.26	1.26	1.26	67
565+00	CULVERT	OUTLET	9	12	0.002	0.18	0.18	0.18	12
566+65	CULVERT	OUTLET	10	12	0.003	0.27	0.27	0.27	13
568+20	569+40	RT	120	12	0.033	2.97	2.97	2.97	160

GUARDRAIL SCHEDULE		
LOCATION	QUADRANT	LINEAR DELINEATOR PANELS 4"
		EACH
SN 027-2523 232+00 TO 233+00	W	1
	E	1
SN 027-0091 559+50 TO 561+10	NW	2
	SW	1
	NE	2
	SE	3
SN 027-2521 18+59 TO 21+11	W	2
	E	2
TOTAL		14

MODEL: Default
 FILE: \\mfrs-pw-bentley.com\FW\DOT\Documents\DOT Office\Dir\dir: 3\Project\0366\03\CADD\Draw\0366\0366-03-seed-schedule.dgn

USER NAME = longneckerjh	DESIGNED - CJ	REVISED - _____
	DRAWN - CJ	REVISED - _____
PLOT SCALE = 100,0000' / in.	CHECKED - JL	REVISED - _____
PLOT DATE = 2/22/2022	DATE - 2/22/2022	REVISED - _____

**STATE OF ILLINOIS
DEPARTMENT OF TRANSPORTATION**

SCHEDULES			
SCALE: _____	SHEET 3	OF 7 SHEETS	STA. _____ TO STA. _____

F.A.P. RTE.	SECTION	COUNTY	TOTAL SHEETS	SHEET NO.
326	(125)RS-6,(126)RS-4&(127)RS-3	FORD	20	11
CONTRACT NO. 66L03				
ILLINOIS FED. AID PROJECT				

MONUMENT NUMBER	DESCRIPTION	APPROXIMATE LOCATION	EXISTING MONUMENT TYPE	PROPOSED MONUMENT TYPE	MONUMENT RECORD TO BE RECORDED	RESPONSIBILITY
A047150	NE CORNER SECTION 34, T25N, R7E, 3RD PM	ILL RTE 165 INTERSECTION	MAG NAIL	TYPE 1	YES	1
A047151	E QTR CORNER SECTION 34, T25N, R7E, 3RD PM	1/2 MI S OF ILL RTE 165 INTERSECTION	BRASS PLAQUE	TYPE 1	YES	1
047152	SE CORNER SECTION 34, T25N, R7E, 3RD PM	W SIDE OF E 1200 N RD INTERSECTION	BRASS PLAQUE	TYPE 1	YES	1
047153	NE CORNER SECTION 3, T24N, R7E, 3RD PM	E SIDE OF E 1200 N RD INTERSECTION	BRASS PLAQUE	TYPE 1	YES	1
A047155	NE CORNER SECTION 10, T24N, R7E, 3RD PM	1100 N RD INTERSECTION	MAG NAIL	TYPE 1	YES	1
A047156	E QTR CORNER SECTION 10, T24N, R7E, 3RD PM	1/2 MI S OF 1100 N RD INTERSECTION	BRASS PLAQUE	TYPE 1	YES	1
A047157	NE CORNER SECTION 15, T24N, R7E, 3RD PM	1 MI S OF 1100 N RD INTERSECTION	BRASS PLAQUE	TYPE 1	YES	1
A047158	E QTR CORNER SECTION 15, T24N, R7E, 3RD PM	1/2 MI N OF E 900 N RD INTERSECTION	BRASS PLAQUE	TYPE 1	YES	1
A047159	SE CORNER SECTION 15, T24N, R7E, 3RD PM	E 900 N RD INTERSECTION	BRASS PLAQUE	TYPE 1	YES	1
A047160	E QTR CORNER SECTION 22, T24N, R7E, 3RD PM	1/2 MI S OF E 900 N RD INTERSECTION	BRASS PLAQUE	TYPE 1	YES	1
A047161	SE CORNER SECTION 22, T24N, R7E, 3RD PM	E 800 N RD INTERSECTION	BRASS PLAQUE	TYPE 1	YES	1
047164	PRIVATE SURVEY NAIL ON CL OF RTE. 47	1390'+/- N OF E 550 N RD	MAG NAIL	MAG NAIL	NO	2

ONLY THE ORIGINAL SCOPE OF THIS JOB HAS BEEN SEARCHED FOR MONUMENTS. R.E. MUST INFORM PLATS AND PLANS TO SEARCH FOR ADDITIONAL MONUMENTS PRIOR TO MILLING IF ADDENDUMS HAVE BEEN ADDED TO THIS JOB.

*** RE WILL INFORM PLATS AND PLANS OF THE ANTICIPATED MILLING SCHEDULE FOR THE PURPOSE OF VERIFYING BURIED MONUMENT LOCATIONS EXPOSED BY THE MILLING ***

UNKNOWN MONUMENTS SET BY OTHERS MAY EXIST. IF AN UNLISTED MONUMENT IS FOUND, R.E. IS REQUIRED TO PROTECT THE MONUMENT FROM DAMAGE UNTIL A PLATS AND PLANS LAND SURVEYOR CAN DOCUMENT THE MONUMENT. PLATS AND PLANS WILL RESET SUCH MONUMENTS IN KIND FOLLOWING CONSTRUCTION.

UPON PAVING COMPLETION, R.E. WILL DIRECT PLATS AND PLANS TO STAKE FOR TYPE 1 CORING AND SET THE OTHER LISTED MONUMENT.

NOTE: FOR BIDDING PURPOSES NO CONTRACTED LAND SURVEYING SERVICES WILL BE REQUIRED. PLATS AND PLANS WILL PREPARE THE REQUIRED MONUMENT RECORDS.

RESPONSIBILITY:

- 1) RESIDENT TO RE-ESTABLISH MONUMENT (PAY ITEM REQUIRED. PERMANENT SURVEY MARKER, TYPE 1)
- 2) PLATS AND PLANS TO RE-ESTABLISH MONUMENT

MODEL: Default
 FILE: \\mfrp-pw-bentley.com\FWIDOT\Documents\DOT Office\Dir\rdt_3\Project\03666\03\CAD\Drawn\03666\03-Plat-Schedule.dgn

USER NAME = longneckerjh	DESIGNED - CJ	REVISED - _____
	DRAWN - CJ	REVISED - _____
PLOT SCALE = 100,0000' / in.	CHECKED - JL	REVISED - _____
PLOT DATE = 2/22/2022	DATE - 2/22/2022	REVISED - _____

**STATE OF ILLINOIS
DEPARTMENT OF TRANSPORTATION**

SCHEDULES			
SCALE: _____	SHEET 7	OF 7 SHEETS	STA. _____ TO STA. _____

F.A.P. RTE.	SECTION	COUNTY	TOTAL SHEETS	SHEET NO.
326	(125)RS-6,(126)RS-4&(127)RS-3	FORD	20	14
CONTRACT NO. 66L03				
ILLINOIS FED. AID PROJECT				

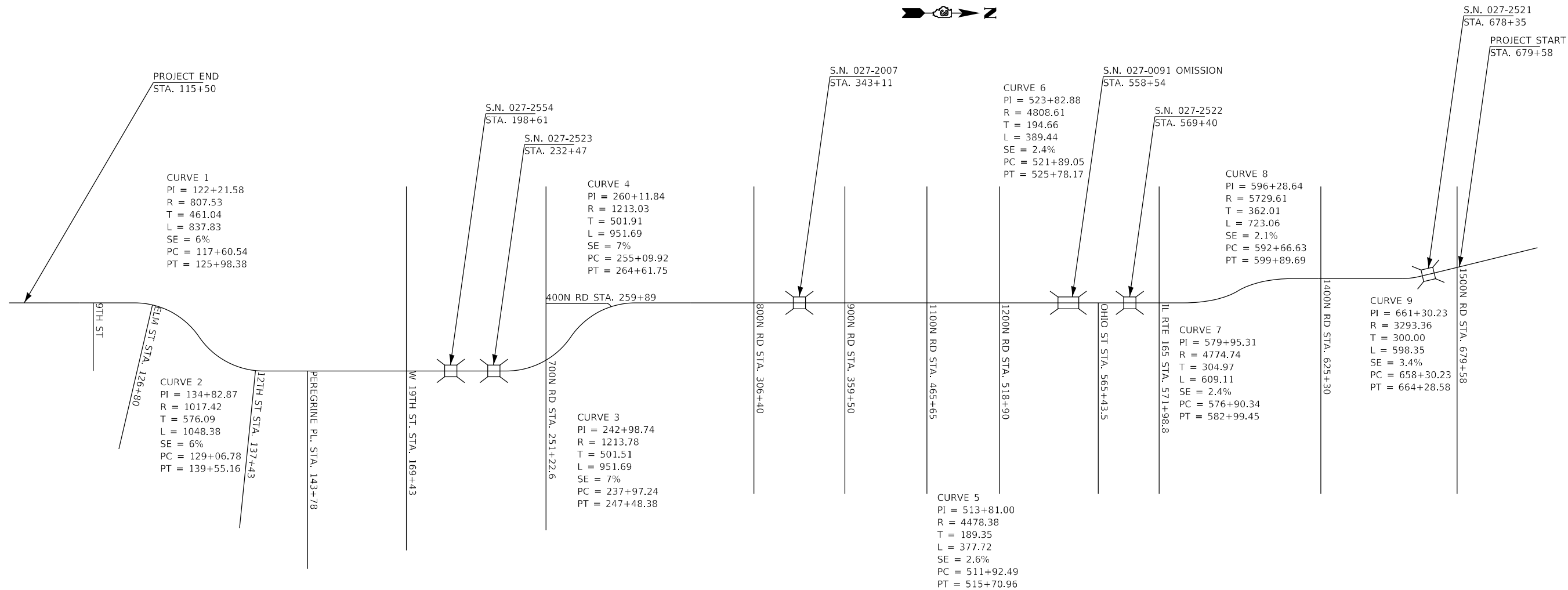

MODEL: Default
 FILE: \\nafe\p\sub\ct-pw-bead\p\p\p\DOT Documents\1001 Office\Dir\rdt_3\Project\103661\03\CADD\data\103661_03-she-dim.dgn

USER NAME = longneckerjh	DESIGNED - CJ	REVISED -
	DRAWN - CJ	REVISED -
PLOT SCALE = 100,0000' / in.	CHECKED - JL	REVISED -
PLOT DATE = 2/22/2022	DATE - 2/22/2022	REVISED -

**STATE OF ILLINOIS
DEPARTMENT OF TRANSPORTATION**

LAYOUT MAP			
SCALE:	SHEET 1	OF 1	SHEETS
	STA.		TO STA.

F.A.P. RTE.	SECTION	COUNTY	TOTAL SHEETS	SHEET NO.
326	(125)RS-6,(126)RS-4&(127)RS-3	FORD	20	15
CONTRACT NO. 66L03			ILLINOIS FED. AID PROJECT	

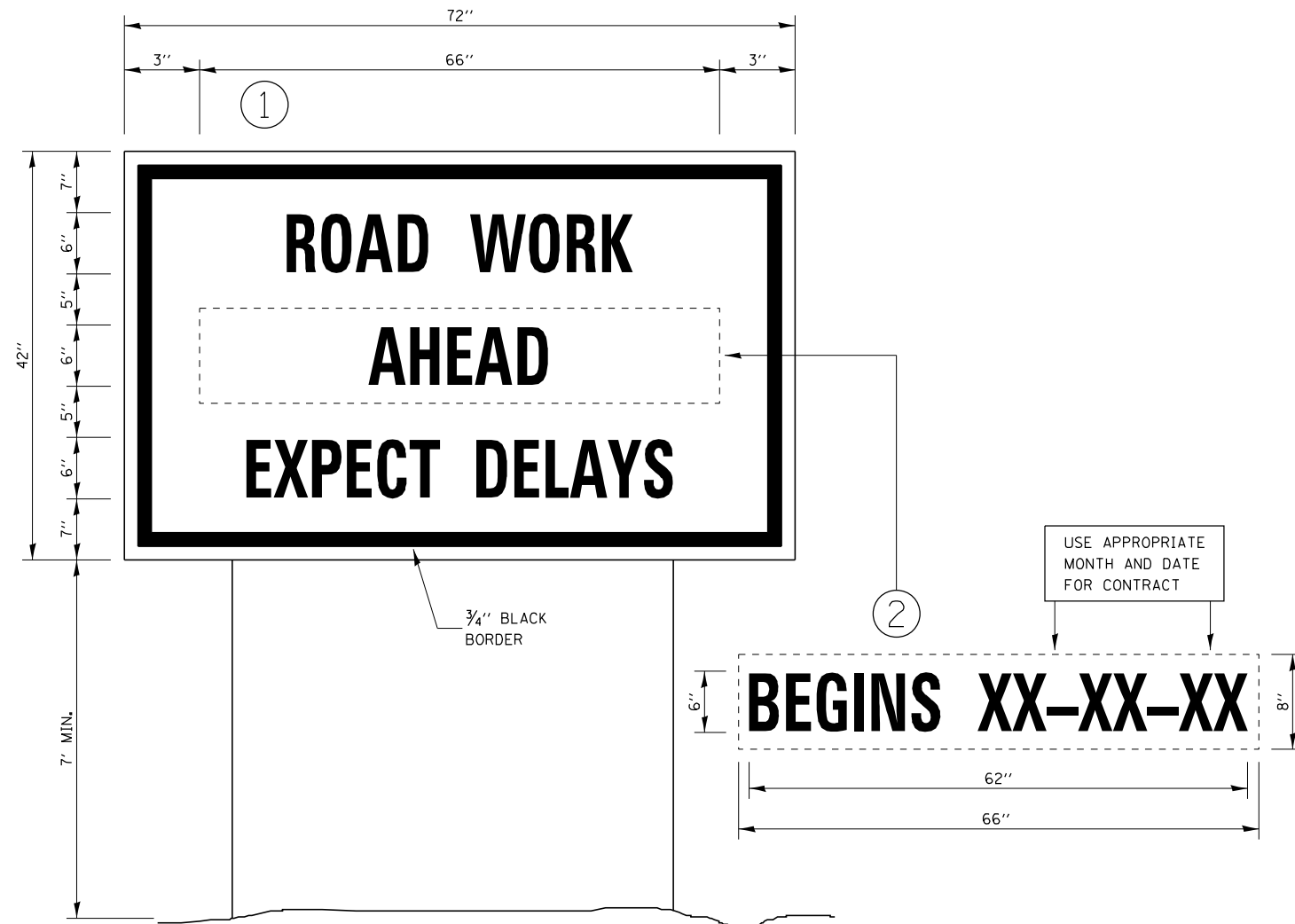

TEMPORARY INFORMATION SIGNING

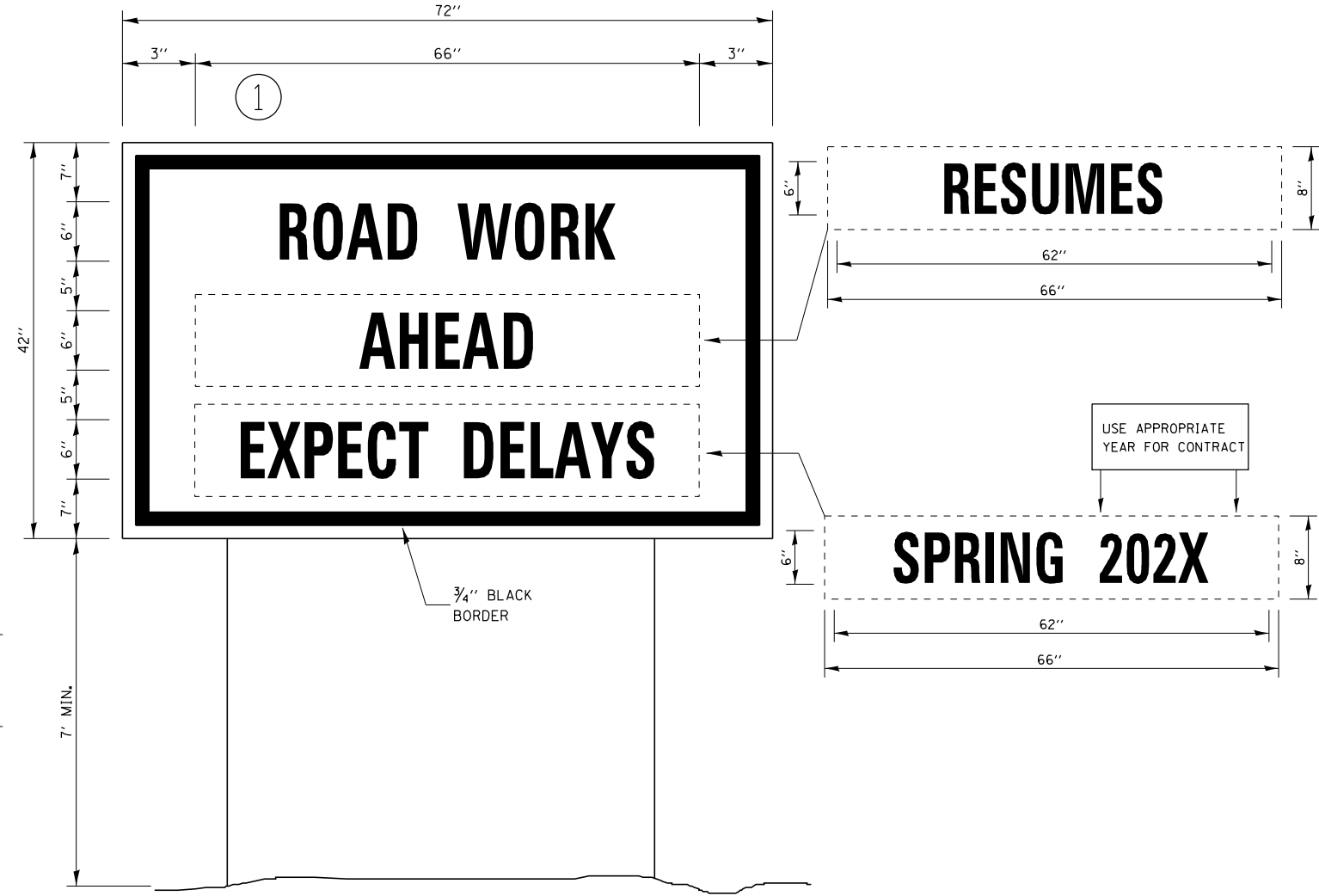

WINTER SHUT DOWN SIGNING

NOTES:

1. USE 6" D BLACK LETTERING ON FLOURESENT ORANGE BACKGROUND.
2. ERECT SIGNS AT LOCATIONS IN ADVANCE OF THE "ROAD CONSTRUCTION AHEAD" SIGNS AS DIRECTED BY THE ENGINEER.
3. ERECT SIGN ① WITH INSTALLED PANEL ② A MINIMUM OF ONE WEEK PRIOR TO THE START OF THE LANE CLOSURE.
4. REMOVE PANEL ② ON THAT DATE.
5. SEE SPECIAL PROVISION "TEMPORARY INFORMATION SIGNING" FOR ADDITIONAL INFORMATION.
6. WILL BE PAID FOR PER SQ FT AS "TEMPORARY INFORMATION SIGNING". EACH SIGN = 21 SQ FT AND THE DATE PANEL ② WILL NOT BE MEASURED SEPARATELY FOR PAYMENT.

MODEL: Default
 FILE: \\nafe-pw-bentley.com\PW\DOT\Documents\DOT Office\Dir\dr: 3\Project\0366\03\CADD\0366\03\plc-dentilr.dgn

USER NAME = longneckerjh	DESIGNED - CJ	REVISED - _____
	DRAWN - CJ	REVISED - _____
PLOT SCALE = 100,0000' / in.	CHECKED - JL	REVISED - _____
PLOT DATE = 2/22/2022	DATE - 2/22/2022	REVISED - _____

**STATE OF ILLINOIS
DEPARTMENT OF TRANSPORTATION**

DETAILS

SCALE: _____ SHEET 1 OF 7 SHEETS STA. _____ TO STA. _____

F.A.P. RTE.	SECTION	COUNTY	TOTAL SHEETS	SHEET NO.
326	(125)RS-6.(126)RS-4&(127)RS-3	FORD	20	16
CONTRACT NO. 66L03				
ILLINOIS FED. AID PROJECT				

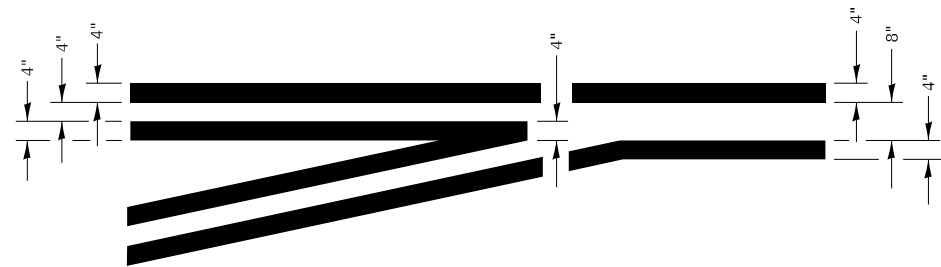

**LEFT TURN LANE
TYPICAL APPLICATION**

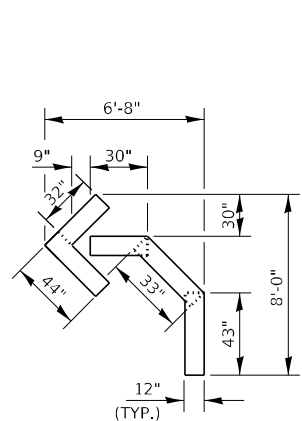

QUANTITY
12" LINE = 16 LIN FT
OR 4" LINE = 48 LIN FT

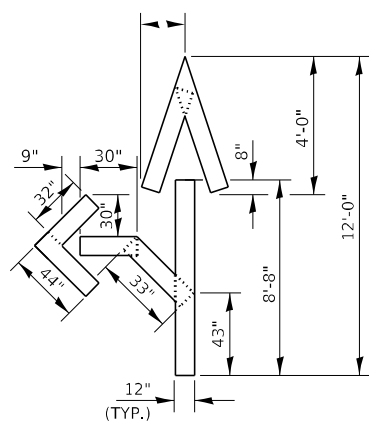

QUANTITY
12" LINE = 29 LIN FT
OR 4" LINE = 87 LIN FT

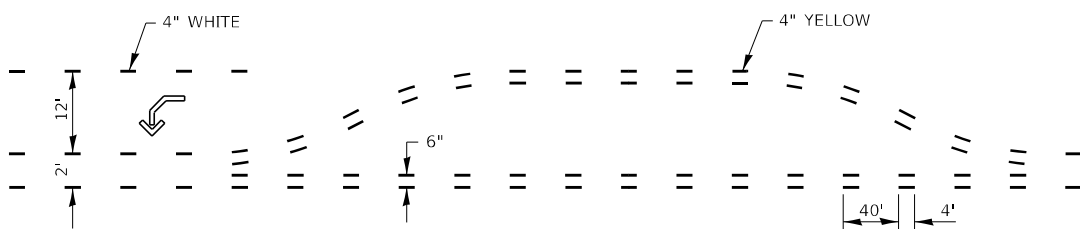

**SHORT-TERM PAVEMENT MARKING
FOR MEDIANS AND ARROWS**

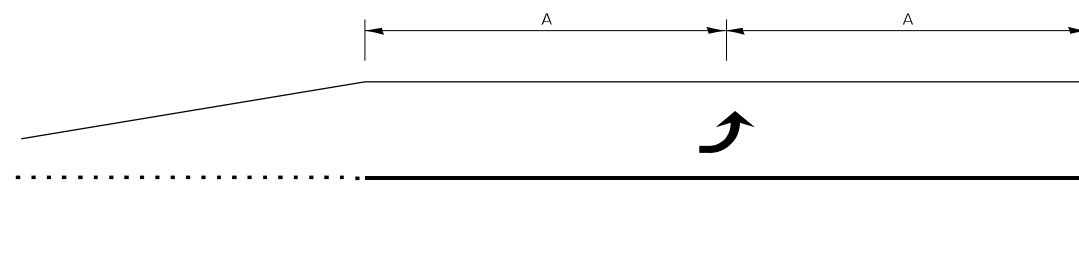

99' AND UNDER

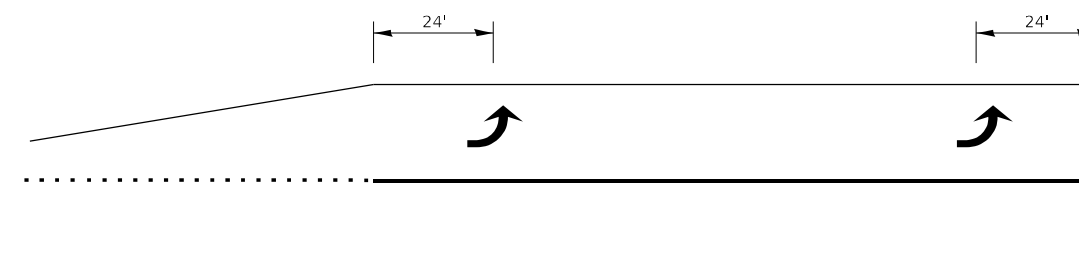

100' TO 149'

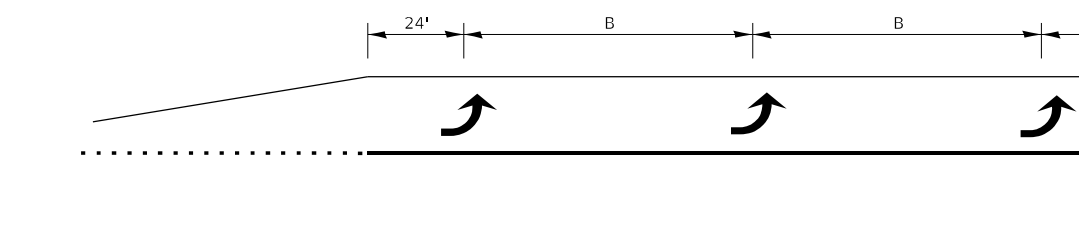

150' AND LONGER

**TYPICAL PLACEMENT OF ARROWS
IN TURN LANES**

MODEL: Default
FILE: Mainfile_pav/subject-pav-bee/efw.com/PIV/IDOT/Document/1/IDOT_Offices/Dir/efw/3/Project/ID366/03/CADD/Draw/ID366/03-pav-detailed.dgn

USER NAME = longneckerjh	DESIGNED - CJ	REVISED - _____
DRAWN - CJ	DRAWN - CJ	REVISED - _____
PLOT SCALE = 100,0000' / in.	CHECKED - JL	REVISED - _____
PLOT DATE = 2/22/2022	DATE - 2/22/2022	REVISED - _____

**STATE OF ILLINOIS
DEPARTMENT OF TRANSPORTATION**

DETAILS			
SCALE: _____	SHEET 2	OF 7 SHEETS	STA. _____ TO STA. _____

F.A.P. RTE.	SECTION	COUNTY	TOTAL SHEETS	SHEET NO.
326	(125)RS-6,(126)RS-4&(127)RS-3	FORD	20	17
CONTRACT NO. 66L03				
ILLINOIS FED. AID PROJECT				

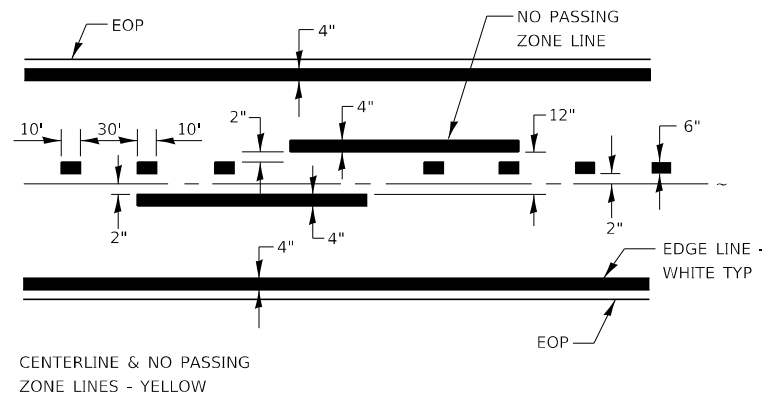

PAVEMENT MARKING

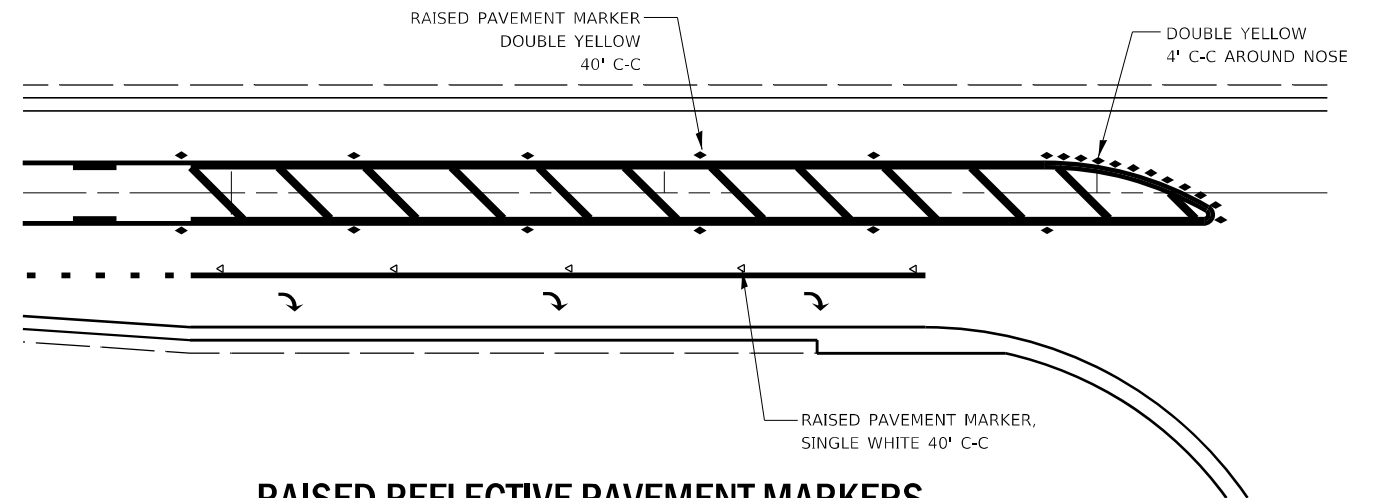

**RAISED REFLECTIVE PAVEMENT MARKERS
@ RIGHT TURN LANE**

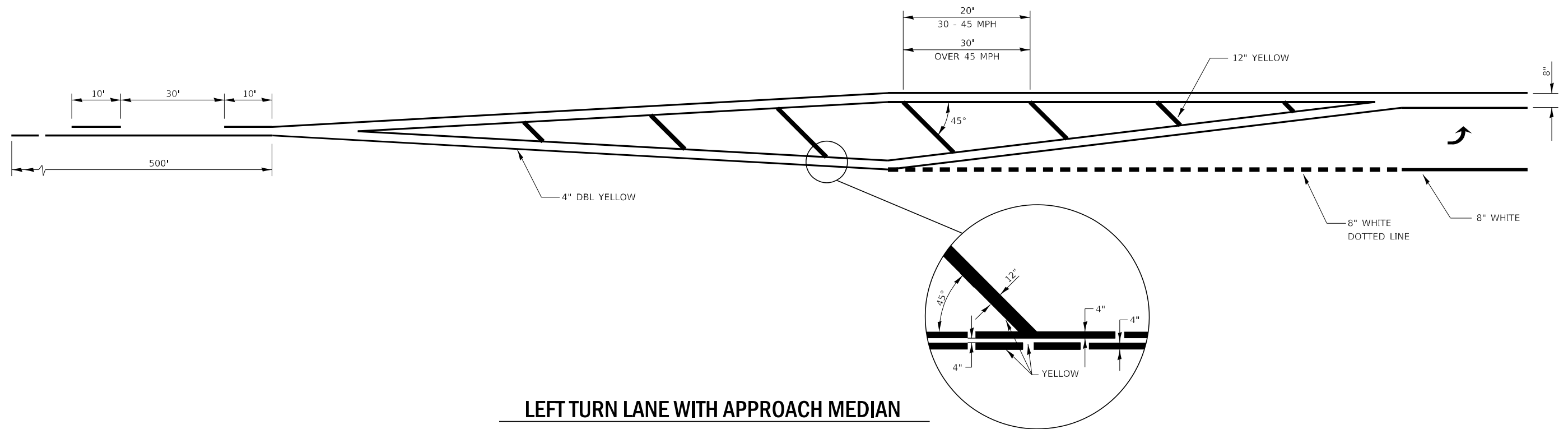

LEFT TURN LANE WITH APPROACH MEDIAN

MODEL: Default
 FILE: \\na11c:\pub\lsc\paw_bentley.com\PIV\DOT\Documents\DOT Office\Dir\rdt_3\Project\10366103\CADD\Drawn\10366103-plc-dentillr.dgn

USER NAME = longneckerjh	DESIGNED - CJ	REVISED - _____
DRAWN - CJ	REVISOR - _____	
PLOT SCALE = 100,0000' / in.	CHECKED - JL	REVISOR - _____
PLOT DATE = 2/22/2022	DATE - 2/22/2022	REVISOR - _____

**STATE OF ILLINOIS
DEPARTMENT OF TRANSPORTATION**

DETAILS

SCALE: _____ SHEET 3 OF 7 SHEETS STA. _____ TO STA. _____

F.A.P. RTE.	SECTION	COUNTY	TOTAL SHEETS	SHEET NO.
326	(125)RS-6.(126)RS-4&(127)RS-3	FORD	20	18
CONTRACT NO. 66L03				
ILLINOIS FED. AID PROJECT				

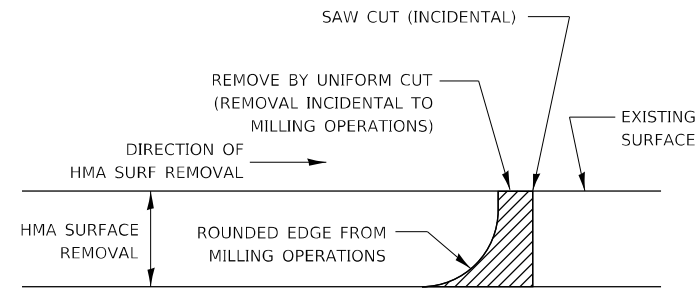

NOTE:

WHEN MILLING OPERATIONS PRODUCE A ROUNDED EDGE, THEN A SAW CUT SHALL BE USED TO MANUFACTURE A PERPENDICULAR EDGE AS SHOWN IN THE DETAIL. THE ENGINEER SHALL BE THE SOLE JUDGE CONCERNING THE USE OF THIS DETAIL

HMA DETAIL AT BUTT JOINTS

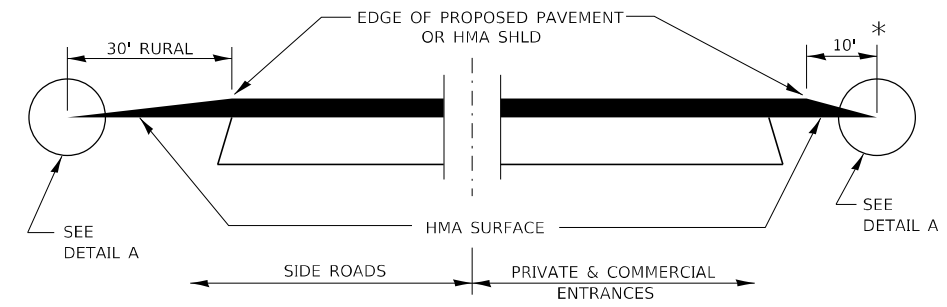

SECTION A-A DETAILS AT ENTRANCES & SIDE ROADS

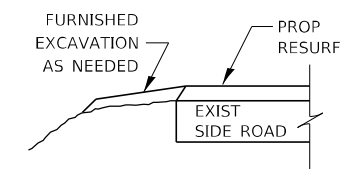

SECTION B-B

IF NEEDED, THE COST OF FURNISHED EXCAVATION AND ASSOCIATED SEEDING ITEMS WILL BE INCLUDED IN THE COST OF THE PAVING PAY ITEMS

* THE COST OF REMOVAL AT EXISTING HMA OR PCC LOCATIONS SHALL BE PAID FOR PER SQ YD BY THE APPROPRIATE PAY ITEM. REMOVAL AT THE EXISTING AGG LOCATIONS SHALL BE INCIDENTAL TO THE HMA. A-3 LOCATIONS SHALL BE FEATHER TAPERED.

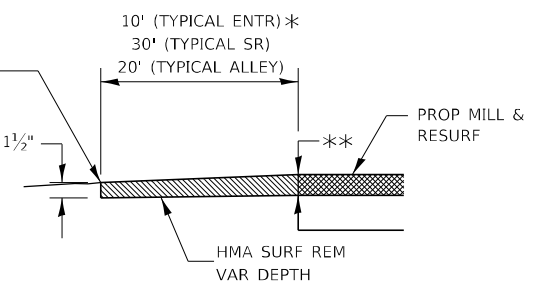

DETAIL A

** 2 3/4" STA 694+00 TO STA 31+00
3 3/4" STA 31+00 TO STA 369+00

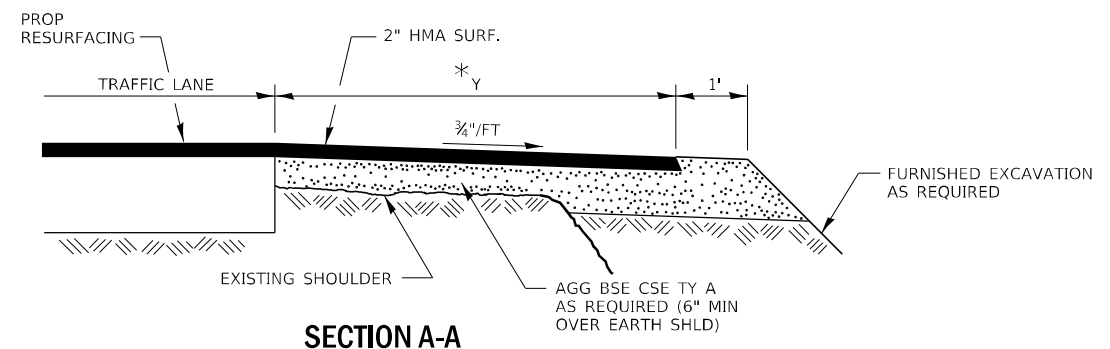
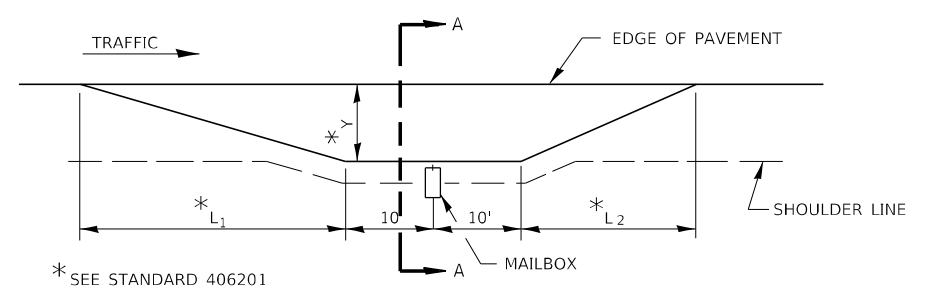

SECTION A-A

RURAL MAILBOX TURNOUT DETAILS

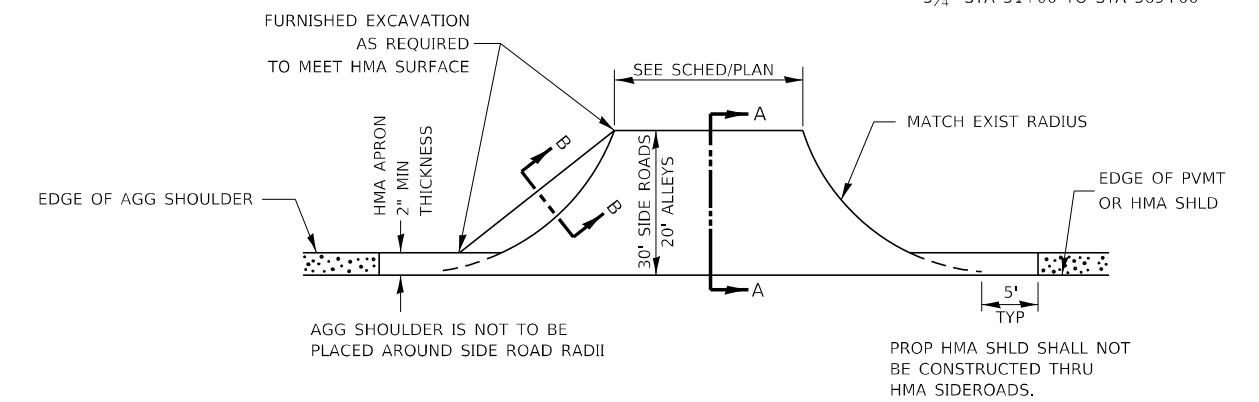

PLAN AT SIDE ROADS AND ALLEYS

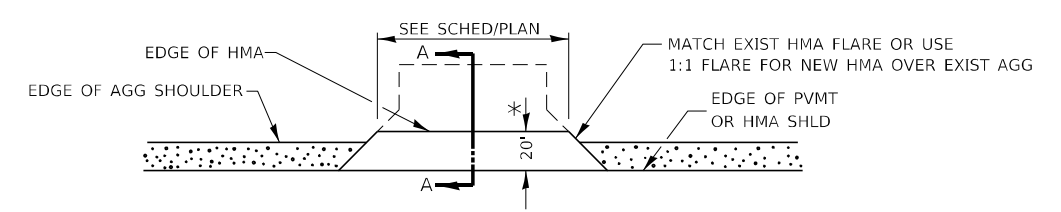

PLAN AT PRIVATE & COMMERCIAL ENTRANCES

(DO NOT RESURFACE FIELD ENTRANCES)

* PROPOSED HMA RESURFACING AT PUBLIC EDUCATIONAL FACILITY ENTRANCES SHALL BE EXTENDED TO THE RIGHT-OF-WAY LIMITS.

MODEL: Default
FILE: \\blmfe-pw-backend.com\PW\DOT\Documents\DOT\Office\Dir\dr: 3\Project\10366103\CAD\Drawings\10366103-pw-detailed.dgn

USER NAME = longneckerjh	DESIGNED - CJ	REVISED - _____
DRAWN - CJ	REVISIONS - _____	
PLOT SCALE = 100,0000' / in.	CHECKED - JL	REVISED - _____
PLOT DATE = 2/22/2022	DATE - 2/22/2022	REVISED - _____

**STATE OF ILLINOIS
DEPARTMENT OF TRANSPORTATION**

SCALE: _____		SHEET 4 OF 7 SHEETS		STA. _____ TO STA. _____	
--------------	--	---------------------	--	--------------------------	--

F.A.P. RTE.	SECTION	COUNTY	TOTAL SHEETS	SHEET NO.
326	(125)RS-6,(126)RS-4&(127)RS-3	FORD	20	19
CONTRACT NO. 66L03				
ILLINOIS FED. AID PROJECT				

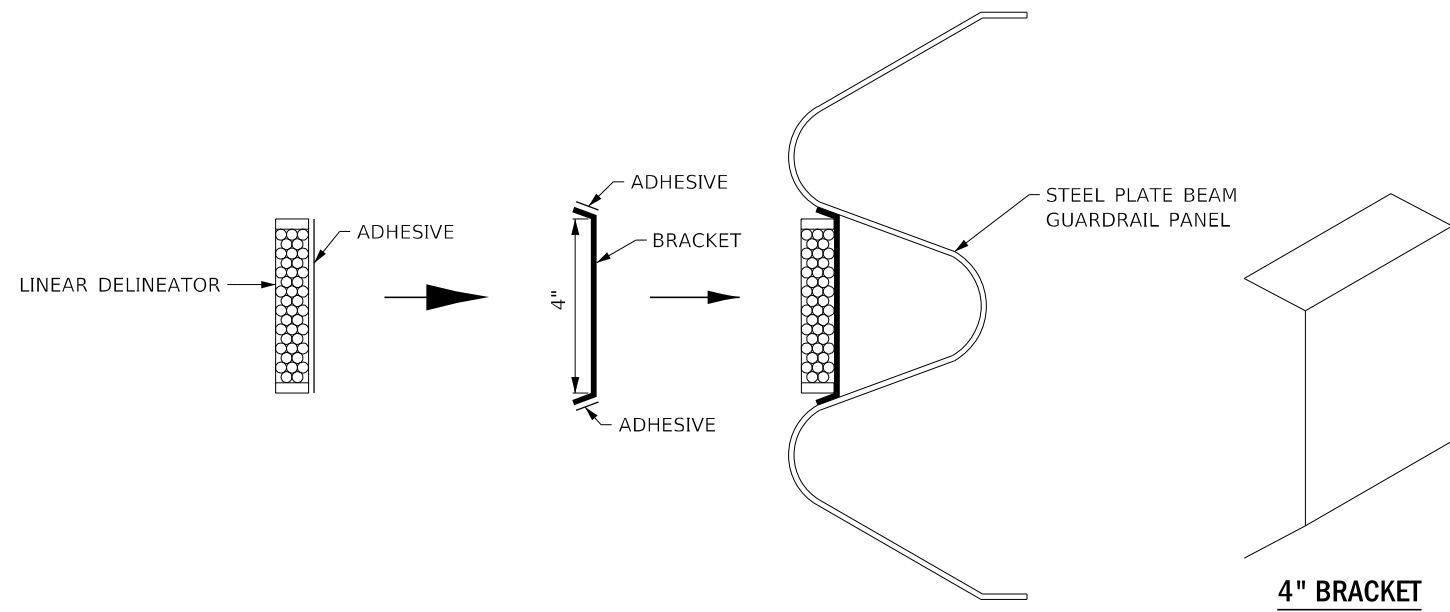

LINEAR DELINEATOR APPLICATION TO STANDARD GALVANIZED GUARDRAIL

LINEATOR DELINEATOR SHALL BE APLLIED ACCORDING TO THE MANUFACTURER'S RECOMMENDATIONS

MODEL: Default
 FILE NAME: p:\ultra-cw-beadray.com\P\I\DOT\Documents\DOT Office\Dir\rdt_3\Project\03666\03\CADD\03666\03-plc-dentil.dgn

USER NAME = longneckerjh	DESIGNED - EM	REVISED - _____
	DRAWN - EM	REVISED - _____
PLOT SCALE = 100,0000' / in.	CHECKED - JL	REVISED - _____
PLOT DATE = 2/22/2022	DATE - 2/22/2022	REVISED - _____

**STATE OF ILLINOIS
DEPARTMENT OF TRANSPORTATION**

DETAILS

SCALE: _____ SHEET 7 OF 7 SHEETS STA. _____ TO STA. _____

F.A.P. RTE.	SECTION	COUNTY	TOTAL SHEETS	SHEET NO.
326	(125)RS-6,(126)RS-4&(127)RS-3	FORD	20	20
CONTRACT NO. 66L03				
ILLINOIS FED. AID PROJECT				