

04-29-2022 LETTING ITEM 117

STATE OF ILLINOIS
DEPARTMENT OF TRANSPORTATION
PLANS FOR PROPOSED
ILLINOIS TRANSPORTATION ENHANCEMENT PROGRAM

VILLAGE OF RANTOUL, ILLINOIS
MAPLEWOOD DRIVE (FAU 7094)
MULTI-USE PATH

SECTION 20-00115-00-BT
PROJECT NO. BA04(565)
TRAIL PROJECT
JOB NO. C-95-014-22

F.A.U. RTE.	SECTION	COUNTY	TOTAL SHEETS	SHEET NO.
4094	20-00115-00-BT	CHAMPAIGN	23	1
		ILLINOIS	CONTRACT NO. 91614	

FOR INDEX OF SHEETS AND LIST OF HIGHWAY STANDARDS, SEE SHEET NO. 2

GAS
NICOR GAS
1844 FERRY ROAD
NAPERVILLE, ILLINOIS

CABLE T.V.
MEDIACOM
1251 EAST GROVE AVENUE
RANTOUL, ILLINOIS

TELEPHONE
FRONTIER COMMUNICATIONS
112 WEST ELM STREET
SYCAMORE, ILLINOIS

WATER, SEWER & ELECTRIC
VILLAGE OF RANTOUL
200 WEST GROVE AVENUE
RANTOUL, ILLINOIS

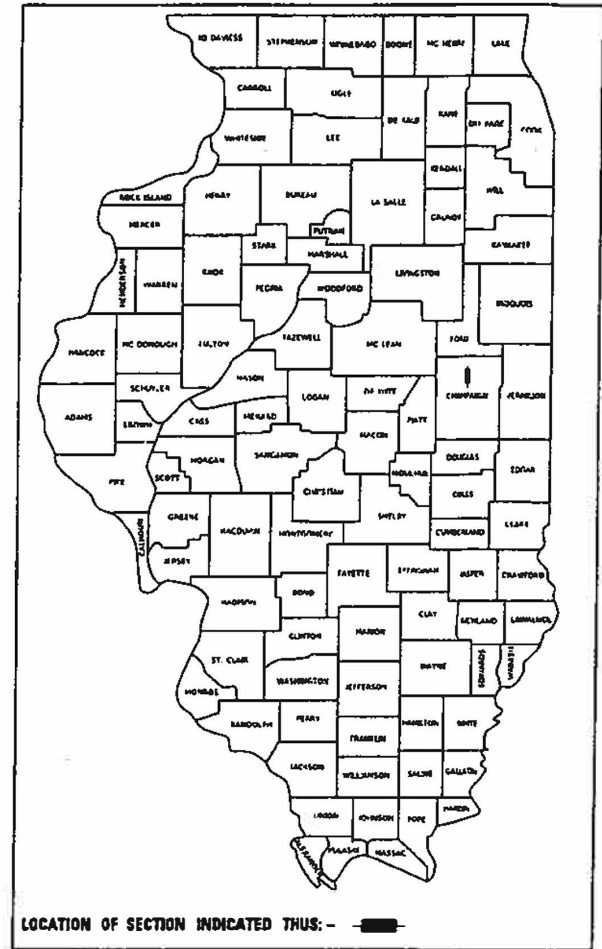

DESCRIPTION OF WORK
THIS PROJECT CONSISTS OF CONSTRUCTING A PORTLAND CEMENT CONCRETE MULTI-USE PATH ALONG THE ALIGNMENT OF THE EXISTING SIDEWALK. ALSO INCLUDED IS ADA RAMP CONSTRUCTION, PAVEMENT MARKING, SIGNAGE, AND RELATED WORK.

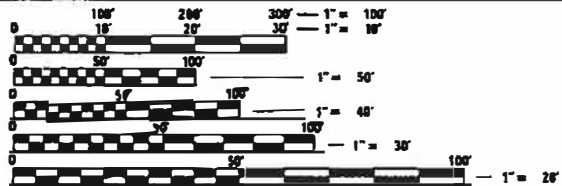

FULL SIZE PLANS HAVE BEEN PREPARED USING STANDARD ENGINEERING SCALES. REDUCED SIZED PLANS WILL NOT CONFORM TO STANDARD SCALES. IN MAKING MEASUREMENTS ON REDUCED PLANS, THE ABOVE SCALES MAY BE USED.

J.U.L.I.E.
JOINT UTILITY LOCATION INFORMATION FOR EXCAVATORS
1-800-892-0123
OR 811

PROJECT MANAGER:
W. SHANE LARSON, P.E.
HUTCHISON ENGINEERING, INC.
PEORIA, ILLINOIS

CONTRACT NO. 91614

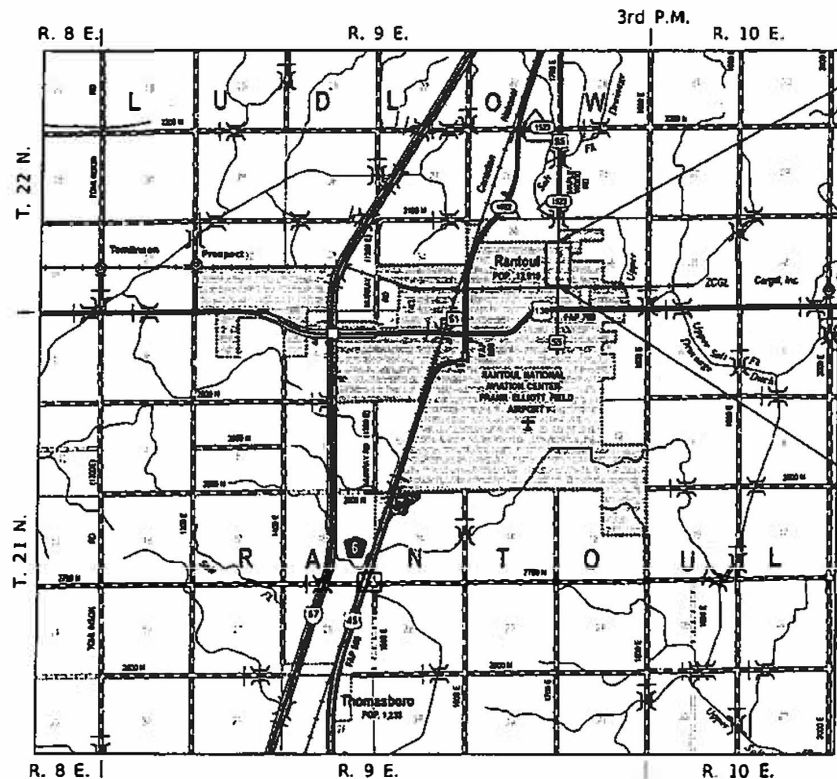

SECTION ENDS
STATION 170+72.59

SECTION BEGINS
STATION 145+26.45

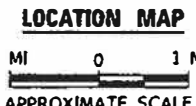
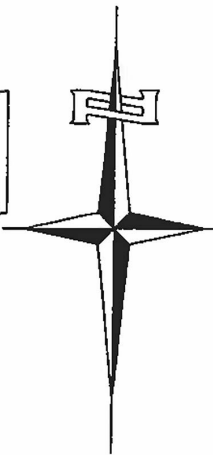

GROSS LENGTH = 2,546.14 FT. = 0.482 MILES
NET LENGTH = 2,546.14 FT. = 0.482 MILES

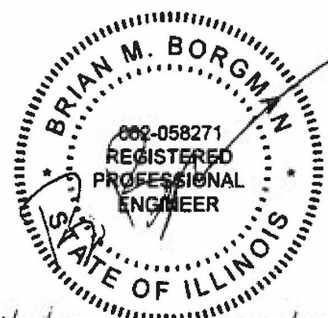

11/4/2022
Hutchison Engineering, Inc.
Since 1945
JACKSONVILLE • PEORIA • SHOREWOOD
CARBONDALE • MOLINE
Illinois Professional Design Firm No. 184-000825

APPROVED 1/12/2022
Paul J. Kelly
PUBLIC WORKS - VILLAGE OF RANTOUL

APPROVED 1-12-2022
Charles Smith
MAYOR - VILLAGE OF RANTOUL

PASSED JANUARY 27, 2022
[Signature]
DISTRICT FIVE ENGINEER OF LOCAL ROADS & STREETS

RELEASING FOR BID
BASED ON LIMITED
REVIEW January 28, 2022
[Signature]
REGION 3 ENGINEER - ILLINOIS DEPT OF TRANSPORTATION

GENERAL NOTES

1. THE LOCATION OF UNDERGROUND UTILITIES SHOWN ON THE PLANS REPRESENTS THE BEST KNOWLEDGE OF THE VILLAGE AND THE INDICATED ADJUSTMENTS OR RECONSTRUCTION ARE CONSIDERED TO BE REASONABLY ACCURATE. IT SHALL BE THE CONTRACTORS RESPONSIBILITY TO VERIFY LOCATIONS OF UNDERGROUND INSTALLATIONS BEFORE STARTING CONSTRUCTION OPERATIONS. THE CONTRACTOR SHALL INDEMNIFY THE VILLAGE, ITS OFFICERS, AND EMPLOYEES AGAINST ALL CLAIMS DUE TO DAMAGE TO CORPORATE OR PRIVATE PROPERTY RESULTING FROM HIS CONSTRUCTION OPERATIONS AS DESCRIBED IN ARTICLE 107.20 AND 107.26 OF THE STANDARD SPECIFICATIONS FOR ROAD AND BRIDGE CONSTRUCTION.
2. THE CONTRACTOR MAY BE REQUIRED TO CONDUCT SOME OF HIS PAVING, GRADING AND SHOULDER OPERATIONS AROUND TRANSMISSION POLES AND UNDER TRANSMISSION LINES. THE ADDED COST OF SO DOING SHALL BE INCLUDED WITH THE COST OF THE CONTROLLING PAY ITEM FOR THE OPERATION.
3. EXISTING CONCRETE BASES AND OTHER MISCELLANEOUS CONCRETE FROM WORK NOT SPECIFICALLY SHOWN ON THE PLANS, BUT INTERFERING WITH PROPOSED CONSTRUCTION, SHALL BE REMOVED AND VOID FILLED WITH TRENCH BACKFILL. ALL COSTS ASSOCIATED WITH THIS WORK SHALL BE INCLUDED IN THE COST OF THE CONTROLLING PAY ITEM FOR THE OPERATION.
4. WHERE SECTION OR SUB-SECTION MONUMENTS ARE ENCOUNTERED, THE ENGINEER SHALL BE NOTIFIED BEFORE SUCH MONUMENTS ARE REMOVED. THE CONTRACTOR SHALL PROTECT AND PRESERVE PROPERTY MARKERS AND MONUMENTS UNTIL THE OWNER, AN AUTHORIZED SURVEYOR OR AGENT HAS WITNESSED OR OTHERWISE REFERENCED THEIR LOCATION.
5. WHEREVER IN THESE PLANS REFERENCE IS MADE TO THE "STANDARD SPECIFICATIONS", IT IS UNDERSTOOD TO INCLUDE THE "SUPPLEMENTAL SPECIFICATIONS" INCLUDED IN THE PROPOSAL.
6. ALL ELEVATIONS SHOWN REFER TO THE U.S.G.S. DATUM AT MEAN SEA LEVEL.
7. THE CONTRACTOR WILL BE REQUIRED TO COMPLY WITH ALL STATE REGULATIONS REGARDING AIR, WATER AND NOISE POLLUTION. THE CONTRACTOR WILL NOT BE ALLOWED TO BUILD FIRES ON THE SITE.
8. IT IS THE CONTRACTOR'S RESPONSIBILITY TO ASCERTAIN EXISTING FIELD CONDITIONS BEFORE BIDDING ON THIS PROJECT, SPECIFICALLY AS THEY RELATE TO THE LUMP SUM PAY ITEMS.
9. THE CONTRACTOR SHALL NOTIFY THE AGENCIES AND UTILITIES AT LEAST 10 (TEN) DAYS PRIOR TO ANY CONSTRUCTION IN THE AREA AND SHALL COMPLY WITH ALL RESTRICTIONS FOR EQUIPMENT MOVEMENTS AND CLEARANCES AS REGARDS TO THEIR FACILITIES.
10. BEFORE STARTING ANY EXCAVATION, THE CONTRACTOR MUST CALL J.U.L.I.E. AT 1-800-892-0123 OR 811 FOR FIELD LOCATIONS OF BURIED ELECTRICAL, TELEPHONE, GAS FACILITIES, AND ALL PUBLIC UTILITIES. A 48 HOUR NOTIFICATION IS REQUIRED.
11. THE CONTRACTOR SHALL USE ALL NECESSARY PRECAUTIONS AND PROTECTIVE MEASURES REQUIRED TO MAINTAIN EXISTING UTILITIES, SEWER AND APPURTENANCES THAT MUST BE KEPT IN OPERATION. IN PARTICULAR, THE CONTRACTOR WILL TAKE ADEQUATE MEASURES TO PREVENT THE UNDERMINING OF UTILITIES AND SEWERS WHICH ARE STILL IN SERVICE.
12. VERIFICATION OF DIMENSIONS: IT IS THE CONTRACTOR'S RESPONSIBILITY TO VERIFY ALL DIMENSIONS AND CONDITIONS EXISTING IN THE FIELD PRIOR TO CONSTRUCTION AND ORDERING MATERIALS.
13. THE CONTRACTOR SHALL BE REQUIRED TO PROVIDE ACCESS TO ABUTTING PROPERTY OWNERS AT ALL TIMES DURING CONSTRUCTION OF THE PROJECT.
14. DURING CONSTRUCTION OPERATIONS, IF ANY LOOSE MATERIAL IS DEPOSITED IN THE FLOW LINE OF DITCHES, GUTTERS OR DRAINAGE STRUCTURES SO THAT THE NATURAL FLOW OF WATER IS OBSTRUCTED, IT SHALL BE REMOVED AT THE CLOSE OF EACH WORKING DAY. AT THE CONCLUSION OF CONSTRUCTION OPERATIONS, ALL DRAINAGE STRUCTURES SO AFFECTED SHALL BE FREE FROM ALL DEBRIS. THIS WORK SHALL BE CONSIDERED INCLUDED IN THE COST OF THE CONTRACT.
15. ALL FRAMES, GRATES, SIGNS, FENCES AND DELINEATORS, DRIVEWAY PAVEMENT, CURB AND GUTTER, NEW OR EXISTING, DAMAGED THROUGH CONTRACTOR'S NEGLIGENCE DURING CONSTRUCTION SHALL BE REPLACED BY THE CONTRACTOR AT HIS EXPENSE.
16. THE COST OF ADDITIONAL LABOR AND MATERIALS NOT ACCOUNTED FOR ON THE PLANS, WHICH MIGHT BE INVOLVED IN MAINTAINING THE FLOW OF STORM WATER TO EXISTING DRAINAGE STRUCTURES, SHALL BE INCLUDED IN THE COST OF THE CONTROLLING PAY ITEM FOR THE OPERATION.
17. TRAFFIC SIGNS REMOVED MUST BE RESET AT THEIR PERMANENT LOCATIONS IN A WORKMANLIKE MANNER AND VISIBLE TO TRAFFIC ON THE ROADWAY AS DIRECTED BY THE ENGINEER. THESE SIGNS SHALL BE RESET BEFORE THE ROADWAY IS OPEN TO TRAFFIC. COST OF SUCH WORK SHALL BE CONSIDERED INCLUDED IN THE COST OF THE CONTRACT.
18. ANY FENCES, PLANTS OR LANDSCAPING WITHIN THE LIMITS OF IMPROVEMENTS SHALL BE REMOVED AS DIRECTED BY THE ENGINEER. THIS WORK SHALL NOT BE PAID FOR SEPARATELY, BUT SHALL BE INCLUDED IN THE COST OF THE EARTH EXCAVATION.
19. PROPOSED PCC DRIVEWAY PAVEMENT IS TO BE USED AT THE DISCRETION OF THE ENGINEER TO BLEND THE PROPOSED WORK INTO EXISTING DRIVEWAY GRADES.

INDEX OF SHEETS

1	COVER SHEET
2	GENERAL NOTES, INDEX OF SHEETS, HIGHWAY STANDARDS
3	TYPICAL SECTIONS
4-6	SUMMARY OF QUANTITIES
7-8	SCHEDULES OF QUANTITIES
9	ALIGNMENTS AND BENCHMARKS
10-12	ROADWAY PLANS
13-23	RAMP DETAILS

HIGHWAY STANDARDS

000001-08	STANDARD SYMBOLS, ABBREVIATIONS AND PATTERNS
001006	DECIMAL OF AN INCH AND OF A FOOT
280001-07	TEMPORARY EROSION CONTROL SYSTEMS
424001-11	PERPENDICULAR CURB RAMPS FOR SIDEWALKS
424026-03	ENTRANCE/ALLEY PEDESTRIAN CROSSINGS
606001-08	CONCRETE CURB TYPE B AND COMBINATION CURB AND GUTTER
701006-05	OFF-RD OPERATIONS, 2L, 2W, 15' TO 24" FROM PAVEMENT EDGE
701101-05	OFF-RD OPERATIONS, MULTILANE, 15' TO 24" FROM PAVEMENT EDGE
701606-10	URBAN SINGLE LANE CLOSURE, MULTILANE, 2W WITH MOUNTABLE MEDIAN
701801-06	SIDEWALK, CORNER, OR CROSSWALK CLOSURE
701901-08	TRAFFIC CONTROL DEVICES
720001-01	SIGN PANEL MOUNT DETAILS
720006-04	SIGN PANEL ERECTION DETAILS
720011-01	METAL POSTS FOR SIGNS, MARKERS & DELINEATORS
780001-05	TYPICAL PAVEMENT MARKINGS

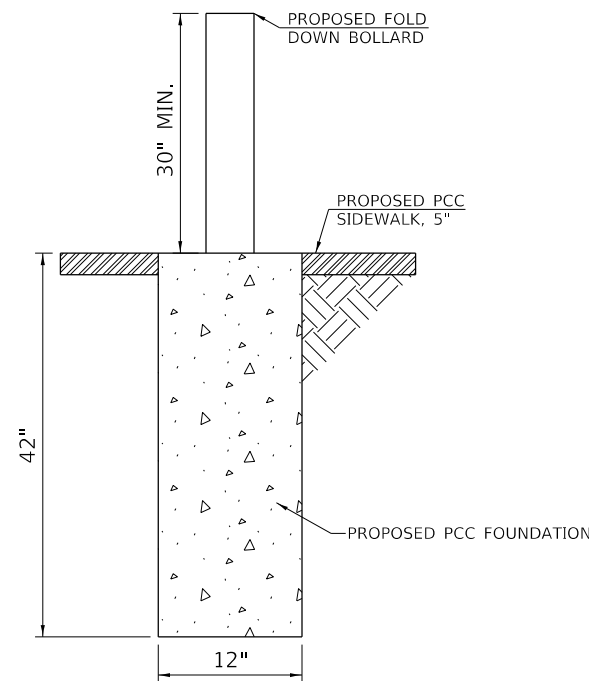

NOTE:
FOLD DOWN BOLLARD AND BASE SHALL BE 4" OR LESS WHEN COLLAPSED.

FOLD DOWN BOLLARD NOT TO SCALE

MODEL: 1100BELMAME
FILE: 1100BELMAME_V1224 - Maplewood Bike Path ITEP Application (Routemaplewood Bike Path ITEP Application.dgn)

Since 1945
Hutchison Engineering, Inc.
JACKSONVILLE • PEORIA • SHOREWOOD
CARBONDALE • MOLINE
Illinois Professional Design Firm No. 184-000825

USER NAME = CBossert	DESIGNED - CMB	REVISED -
	DRAWN - CMB	REVISED -
PLOT SCALE = 2,0000' / In.	CHECKED - BMB	REVISED -
PLOT DATE = 12/27/2021	DATE - 08/2021	REVISED -

**STATE OF ILLINOIS
DEPARTMENT OF TRANSPORTATION**

MAPLEWOOD DRIVE (FAU 4094) MULTI-USE PATH	
GENERAL NOTES, INDEX OF SHEETS, HIGHWAY STANDARDS	
SCALE: N/A	SHEET 1 OF 1 SHEETS

F.A.U. RTE.	SECTION	COUNTY	TOTAL SHEETS	SHEET NO.
4094	20-00115-00-BT	CHAMPAIGN	23	2
			CONTRACT NO. 91614	
		ILLINOIS	FED. AID PROJECT	

CODE NO.	ITEM	UNIT	TOTAL QUANTITY	80% ITEP
				20% STATE SAFETY
				0028 URBAN
Δ 20100110	TREE REMOVAL (6 TO 15 UNITS DIAMETER)	UNIT	43	43
Δ 20100210	TREE REMOVAL (OVER 15 UNITS DIAMETER)	UNIT	46	46
20200100	EARTH EXCAVATION	CU YD	285	285
25000100	SEEDING, CLASS 1	ACRE	0.25	0.25
25000400	NITROGEN FERTILIZER NUTRIENT	POUND	20	20
25000500	PHOSPHORUS FERTILIZER NUTRIENT	POUND	20	20
25000600	POTASSIUM FERTILIZER NUTRIENT	POUND	20	20
28000250	TEMPORARY EROSION CONTROL SEEDING	POUND	22	22
28000400	PERIMETER EROSION BARRIER	FOOT	2180	2180
28000500	INLET AND PIPE PROTECTION	EACH	7	7
42001300	PROTECTIVE COAT	SQ YD	2853	2853
42300200	PORTLAND CEMENT CONCRETE DRIVEWAY PAVEMENT, 6 INCH	SQ YD	83	83
42300400	PORTLAND CEMENT CONCRETE DRIVEWAY PAVEMENT, 8 INCH	SQ YD	56	56
* 42400200	PORTLAND CEMENT CONCRETE SIDEWALK 5 INCH	SQ FT	23909	23909

Δ SPECIALTY ITEMS

MODEL: SMOBELMAMES
FILE: NAME: V:\1524 - Maplewood Bike Path ITEP Application (Rantoul)\CADD\Sheet\04-4524-sni-50001.dgn

Hutchison Engineering, Inc.
Since 1945
JACKSONVILLE PEORIA SHOREWOOD
CARBONDALE MOLINE
Illinois Professional Design Firm No. 184-000825

USER NAME = BBergman	DESIGNED - CMB	REVISED -
PLOT SCALE = 2.0000' / in.	DRAWN - CMB	REVISED -
PLOT DATE = 1/12/2022	CHECKED - BMB	REVISED -
	DATE - 08/2021	REVISED -

STATE OF ILLINOIS
DEPARTMENT OF TRANSPORTATION

MAPLEWOOD DRIVE (FAU 4094) MULTI-USE PATH
SUMMARY OF QUANTITIES

SCALE: N/A SHEET 1 OF 3 SHEETS

F.A.U. RTE.	SECTION	COUNTY	TOTAL SHEETS	SHEET NO.
4094	20-00115-00-BT	CHAMPAIGN	23	4
CONTRACT NO. 91614				
ILLINOIS FED. AID PROJECT				

CODE NO.	ITEM	UNIT	TOTAL QUANTITY	80% ITEP
				20% STATE SAFETY
				0028
				URBAN
42400800	DETECTABLE WARNINGS	SQ FT	220	220
44000200	DRIVEWAY PAVEMENT REMOVAL	SQ YD	264	264
* 44000500	COMBINATION CURB AND GUTTER REMOVAL	FOOT	209	209
* 44000600	SIDEWALK REMOVAL	SQ FT	9228	9228
* 60255500	MANHOLES TO BE ADJUSTED	EACH	3	3
* 60604400	COMBINATION CONCRETE CURB AND GUTTER, TYPE B-6.18	FOOT	209	209
67100100	MOBILIZATION	L SUM	1	1
△ 72000100	SIGN PANEL - TYPE 1	SQ FT	25	25
△ 72900100	METAL POST - TYPE A	FOOT	110	110
△ 78005130	EPOXY PAVEMENT MARKING - LINE 6"	FOOT	316	316
△ 78005150	EPOXY PAVEMENT MARKING - LINE 12"	FOOT	397	397
△ 78005180	EPOXY PAVEMENT MARKING - LINE 24"	FOOT	67	67
78300202	PAVEMENT MARKING REMOVAL - WATER BLASTING	SQ FT	292	292
* X0350805	FOLD DOWN BOLLARDS	EACH	11	11

△ SPECIALTY ITEMS

MODEL: SMOBELMVAE
FILE NAME: V:\524 - Maplewood Blk Path ITEP Application - (Rantall)\CADD\CADD Sheets\05-4524-silic-50002.dgn

Hutchison Engineering, Inc. <small>Since 1945</small> JACKSONVILLE • PEORIA • SHOREWOOD CARBONDALE • MOLINE <small>Illinois Professional Design Firm No. 184-000825</small>	USER NAME = CBurke	DESIGNED - CMB	REVISED -	STATE OF ILLINOIS DEPARTMENT OF TRANSPORTATION	MAPLEWOOD DRIVE (FAU 4094) MULTI-USE PATH SUMMARY OF QUANTITIES		F.A.U. RTE.	SECTION	COUNTY	TOTAL SHEETS	SHEET NO.
	PLOT SCALE = 2.0000' / in.	CHECKED - BMB	REVISED -				4094	20-00115-00-BT	CHAMPAIGN	23	5
	PLOT DATE = 1/11/2022	DATE - 08/2021	REVISED -				CONTRACT NO. 91614				
							SCALE: N/A		SHEET 2 OF 3 SHEETS		ILLINOIS FED. AID PROJECT

CODE NO.	ITEM	UNIT	TOTAL QUANTITY	80% ITEP
				20% STATE
				SAFETY
				0028
				URBAN
* X6024503	INLETS TO BE ADJUSTED WITH NEW FRAME AND GRATE (SPECIAL)	EACH	4	4
* X7010216	TRAFFIC CONTROL AND PROTECTION, (SPECIAL)	L SUM	1	1
* Z0013798	CONSTRUCTION LAYOUT	L SUM	1	1

Δ SPECIALTY ITEMS

MODEL: SMOBELWAMES
FILE NAME: V:\524 - Maplewood Blk. Path ITEP Application (Rantoul)\CADD\CADD Sheets\06-4524-sic-50003.dgn

Hutchison Engineering, Inc. <small>Since 1945</small> JACKSONVILLE • PEORIA • SHOREWOOD CARBONDALE • MOLINE Illinois Professional Design Firm No. 154-000825	USER NAME = CBossert	DESIGNED - CMB	REVISED -	STATE OF ILLINOIS DEPARTMENT OF TRANSPORTATION	MAPLEWOOD DRIVE (FAU 4094) MULTI-USE PATH SUMMARY OF QUANTITIES	F.A.U. RTE. 4094	SECTION 20-00115-00-BT	COUNTY CHAMPAIGN	TOTAL SHEETS 23	SHEET NO. 6
	PLOT SCALE = 2.0000' / in.	CHECKED - BMB	REVISED -			SCALE: N/A	SHEET 3 OF 3 SHEETS	ILLINOIS FED. AID PROJECT		CONTRACT NO. 91614
PLOT DATE = 12/27/2021	DATE - 08/2021	REVISED -								

SIGNING SCHEDULE

STATION	FACING	DESIGNATION	72000100	72900100	DESCRIPTION
			SIGN PANEL - TYPE 1	METAL POST - TYPE A	
			SQ FT	FOOT	
145+62.52	N	S1-1	2.3	10.0	"STOP" (18"x18")
147+64.51	S	S1-1	2.3	10.0	"STOP" (18"x18")
148+07.87	N	S1-1	2.3	10.0	"STOP" (18"x18")
155+86.73	S	S1-1	2.3	10.0	"STOP" (18"x18")
156+25.30	N	S1-1	2.3	10.0	"STOP" (18"x18")
159+92.09	S	S1-1	2.3	10.0	"STOP" (18"x18")
160+39.92	N	S1-1	2.3	10.0	"STOP" (18"x18")
166+37.87	S	S1-1	2.3	10.0	"STOP" (18"x18")
166+77.61	N	S1-1	2.3	10.0	"STOP" (18"x18")
170+22.58	S	S1-1	2.3	10.0	"STOP" (18"x18")
170+62.45	N	S1-1	2.3	10.0	"STOP" (18"x18")
TOTAL			24.8	110.0	
USE			25	110	

BOLLARD SCHEDULE

STATION	OFFSET	X0350805
		FOLD DOWN BOLLARDS
		EACH
145+62.48	11.00' LT	1
147+64.51	11.00' LT	1
148+07.87	11.00' LT	1
155+86.73	11.00' LT	1
156+25.30	11.00' LT	1
159+92.08	25.58' LT	1
160+41.39	25.58' LT	1
166+37.87	14.00' LT	1
166+77.61	14.00' LT	1
170+22.58	14.00' LT	1
170+62.53	14.00' LT	1
TOTAL		11
USE		11

INLET AND PIPE PROTECTION SCHEDULE

STATION	OFFSET	28000500
		INLET AND PIPE PROTECTION
		EACH
145+60.05	05.95' RT	1
147+71.20	05.43' LT	1
148+01.27	05.16' LT	1
155+93.72	12.39' LT	1
156+18.26	14.15' LT	1
170+29.69	23.55' LT	1
170+55.52	22.94' LT	1
TOTAL		7
USE		7

SIDEWALK SCHEDULE

STATION TO STATION	42400200	42400800	42001300	20200100	25000100	25000400	25000500	25000600	28000250	
	PORTLAND CEMENT CONCRETE SIDEWALK 5 INCH	DETECTABLE WARNINGS	PROTECTIVE COAT	EARTH EXCAVATION	SEEDING, CLASS 1	NITROGEN FERTILIZER NUTRIENT	PHOPHOROUS FERTILIZER NUTRIENT	POTASSIUM FERTILIZER NUTRIENT	TEMPORARY EROSION CONTROL SEEDING	
	SQ FT		SQ YD	CU YD	ACRE	POUND				
145+56.22	147+70.76	2156.5	40.0	239.6	25.8	0.02	1.8	1.8	1.8	2.0
148+01.72	155+92.93	7984.0	40.0	887.1	95.2	0.07	6.5	6.5	6.5	7.3
156+19.06	159+98.09	3876.6	40.0	430.7	45.6	0.03	3.1	3.1	3.1	3.5
160+35.38	166+43.87	6141.9	40.0	682.4	73.2	0.06	5.0	5.0	5.0	5.6
166+71.61	170+28.73	3582.9	40.0	398.1	43.0	0.03	3.0	3.0	3.0	3.3
170+56.41	170+72.59	166.7	20.0	18.5	1.9	0.00	0.1	0.1	0.1	0.1
TOTAL		23908.6	220.0	2656.5	284.9	0.22	19.6	19.6	19.6	21.7
USE		23909	220	2657	285	0.25	20	20	20	22

TREE REMOVAL SCHEDULE

STATION	OFFSET	20100110	20100210
		TREE REMOVAL	
		6 TO 15 UNITS DIAMETER	OVER 15 UNITS DIAMETER
		UNIT	
149+04.07	0.91' RT	6	
149+12.10	3.41' RT	6	
149+54.98	4.66' RT	14	
163+81.81	08.73' LT	8	
164+26.56	09.37' LT	9	
166+82.47	09.58' LT		22
167+68.46	09.89' LT		24
TOTAL		43	46
USE		43	46

MODEL: I:\MODELS\MJMS FILES - Model - 03224 - Maplewood Bike Path ITP Application (Ranish)\CADD\CADD_Sheets\07-424-44-In-Schedule.dgn

ADJUSTMENT SCHEDULE

STATION	OFFSET	60255500	X6026200
		MANHOLES TO BE ADJUSTED	INLETS TO BE ADJUSTED WITH NEW FRAME AND GRATE (SPECIAL)
		EACH	
147+71.20	05.43' LT		1
148+01.27	05.16' LT		1
148+12.88	14.26' LT	1	
155+93.72	12.39' LT		1
156+18.26	14.15' LT		1
157+47.77	03.70' LT	1	
160+41.25	32.90' LT	1	
TOTAL		3	4
USE		3	4

PAVEMENT MARKING SCHEDULE

STATION TO STATION	78005130	78005150	78005180	78300202	
	EPOXY PAVEMENT MARKING			PAVEMENT MARKING REMOVAL	
	SOLID WHITE				
	6"	12"	24"	SQ FT	
145+26.45	145+40.28		13.8	27.6	
145+26.45	145+54.38	55.5	65.8	27.8	
145+62.48	145+63.48		5.0		
147+63.51	147+64.51		5.0		
147+72.47	147+99.91	54.2	60.0	27.1	
147+72.87	147+86.26		13.4	26.8	
148+07.87	148+08.87		5.0		
155+85.73	155+86.73		5.0		
155+94.69	156+17.34	44.6	48.0	22.3	
155+94.95	156+05.97		11.0	22.0	
156+25.30	156+26.30		5.0		
159+91.09	159+92.09		5.0		
160+00.15	160+16.73			33.2	
160+00.17	160+33.31	66.2	72.0	33.1	
160+41.39	160+42.39		5.0		
166+36.84	166+37.84		5.0		
166+45.85	166+69.64	47.4	48.0	23.7	
166+77.61	166+78.61		5.0		
170+21.58	170+22.58		5.0		
170+30.56	170+54.59	47.5	48.0	23.8	
170+30.65	170+42.58		11.9	23.8	
170+62.53	170+63.53		5.0		
TOTAL		315.4	396.8	66.7	291.1
USE		316	397	67	292

REMOVAL SCHEDULE

STATION TO STATION	44000600	44000200	
	SIDEWALK REMOVAL	DRIVEWAY PAVEMENT REMOVAL	
	SQ FT	SQ YD	
145+55.46	146+45.50	354.5	
146+45.50	146+57.66	11.8	
146+55.41	147+71.44	442.1	
148+01.09	149+36.16	544.7	
149+36.16	149+48.40	13.7	
149+48.40	151+74.40	920.6	
151+74.40	151+86.59	13.3	
151+86.46	152+97.48	440.8	
152+97.48	153+10.37	14.3	
153+10.25	153+55.09	173.8	
153+55.05	153+66.74	12.3	
153+66.35	154+19.92	208.7	
154+18.99	154+31.69	12.7	
154+30.38	155+93.20	650.7	
156+18.70	158+30.15	827.8	
158+30.06	158+54.01	26.6	
158+54.00	159+97.97	731.2	
160+35.20	162+95.29	1308.4	
162+95.29	163+14.38	21.2	
163+14.38	166+44.64	1270.6	
166+71.49	170+28.70	1295.3	
170+56.42	170+72.52	58.2	
TOTAL		9227.4	125.8
USE		9228	126

EROSION BARRIER SCHEDULE

STATION TO STATION	28000400	
	PERIMETER EROSION BARRIER	
	FOOT	
145+56.83	146+45.49	88.7
146+55.12	147+70.16	115.0
148+02.22	149+36.35	134.1
149+48.17	149+71.04	22.9
149+78.04	150+00.85	22.8
150+12.49	150+61.90	49.4
150+73.68	151+20.08	46.4
151+31.95	151+74.39	42.4
151+86.47	152+36.08	49.6
152+47.71	152+97.49	49.8
153+10.29	153+55.06	44.8
153+66.67	154+19.91	53.2
154+31.67	154+73.90	42.2
154+86.11	155+57.58	71.5
155+62.58	155+92.38	29.8
156+19.65	157+12.13	92.5
157+27.85	158+30.06	107.3
158+54.01	159+98.09	144.1
160+35.99	162+95.24	261.6
163+14.47	166+43.65	329.2
166+71.85	170+28.31	356.5
170+56.84	170+74.52	25.6
TOTAL		2179.4
USE		2180

CURB AND GUTTER SCHEDULE

STATION TO STATION	60604400	44000500	42001300	
	COMBINATION CONCRETE CURB AND GUTTER, TYPE B-6.18	CURB AND GUTTER REMOVAL	PROTECTIVE COAT	
	FOOT		SQ YD	
145+55.59	145+57.07	20.1	20.1	5.6
147+69.92	147+71.38	20.1	20.1	5.6
148+01.17	148+02.46	20.1	20.1	5.6
155+92.14	155+93.45	20.1	20.1	5.6
156+18.46	156+19.89	20.1	20.1	5.6
159+98.65	159+98.68	20.0	20.0	5.6
160+34.79	160+34.81	20.0	20.0	5.6
166+43.66	166+44.45	16.0	16.0	4.4
166+71.02	166+71.86	16.1	16.1	4.5
170+28.21	170+29.33	18.1	18.1	5.0
170+55.79	170+56.91	18.1	18.1	5.0
TOTAL		208.8	208.8	58.0
USE		209	209	58

ENTRANCE SCHEDULE (ESTIMATED)

STATION	42300200	42300400	42001300	44000200
	PORTLAND CEMENT CONCRETE DRIVEWAY PAVEMENT		PROTECTIVE COAT	DRIVEWAY PAVEMENT REMOVAL
	6 INCH	8 INCH	SQ YD	
146+50	6.7		6.7	6.7
150+07	6.7		6.7	6.7
150+68	13.3		13.3	13.3
151+26	20.0		20.0	20.0
151+81	6.7		6.7	6.7
152+42	6.7		6.7	6.7
153+04	13.3		13.3	13.3
157+20	8.9		8.9	8.9
163+05		55.6	55.6	55.6
TOTAL	82.3	55.6	137.9	137.9
USE	83	56	138	138

MODEL: H:\MODELS\MH15.FE FILE: MH15.FE, 01/24/22 - Maplewood Bike Path ITP Application (R:\m\j\cadd\CADD_Sheets\08-4324-4-In-SCHED02.dgn)

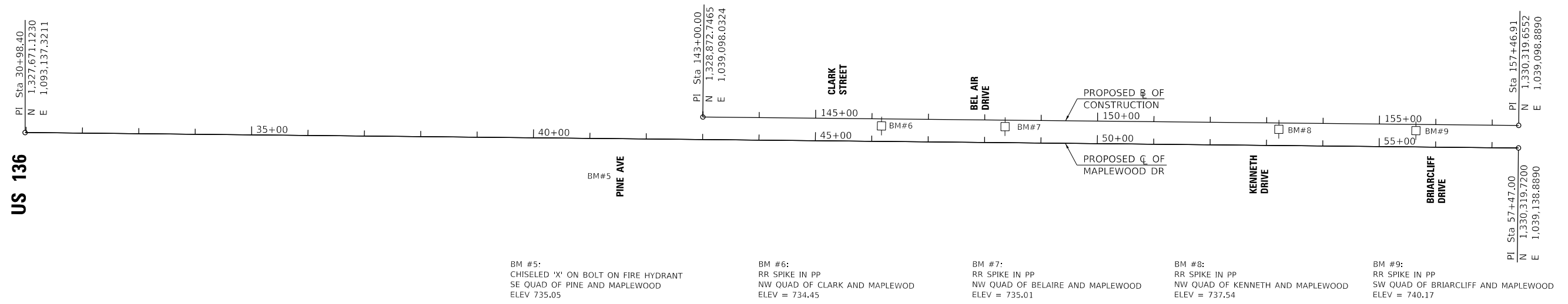

BM #5:
CHISELED 'X' ON BOLT ON FIRE HYDRANT
SE QUAD OF PINE AND MAPLEWOOD
ELEV 735.05

BM #6:
RR SPIKE IN PP
NW QUAD OF CLARK AND MAPLEWOOD
ELEV = 734.45

BM #7:
RR SPIKE IN PP
NW QUAD OF BELLAIR AND MAPLEWOOD
ELEV = 735.01

BM #8:
RR SPIKE IN PP
NW QUAD OF KENNETH AND MAPLEWOOD
ELEV = 737.54

BM #9:
RR SPIKE IN PP
SW QUAD OF BRIARCLIFF AND MAPLEWOOD
ELEV = 740.17

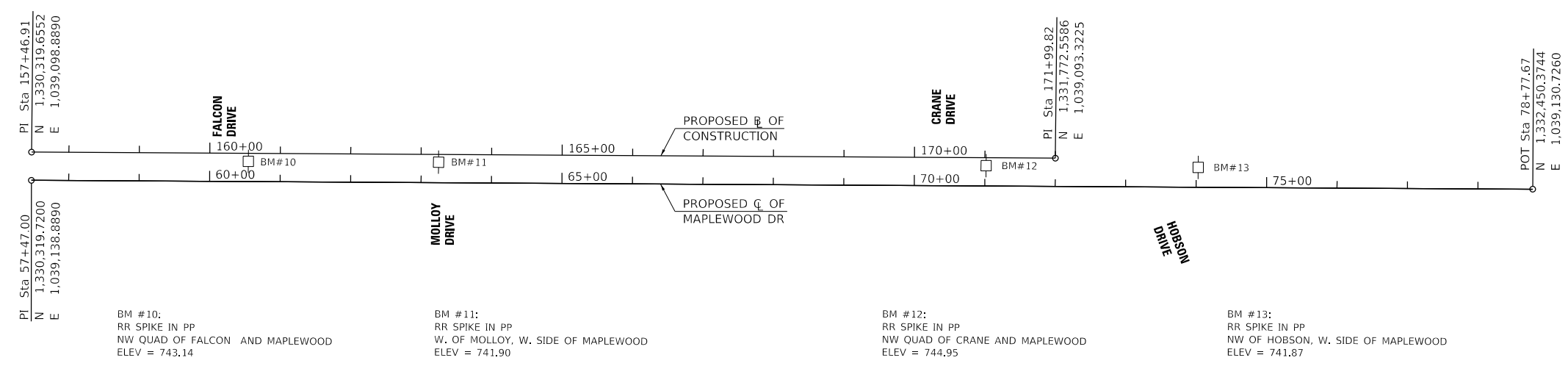

BM #10:
RR SPIKE IN PP
NW QUAD OF FALCON AND MAPLEWOOD
ELEV = 743.14

BM #11:
RR SPIKE IN PP
W. OF MOLLOY, W. SIDE OF MAPLEWOOD
ELEV = 741.90

BM #12:
RR SPIKE IN PP
NW QUAD OF CRANE AND MAPLEWOOD
ELEV = 744.95

BM #13:
RR SPIKE IN PP
NW OF HOBSON, W. SIDE OF MAPLEWOOD
ELEV = 741.87

MODEL: 140626\M41E5
FILE: M41E5_V1.dwg - Maplewood Bike Path ITP Application (Printed)\CADD\CADD_Sheets\09-424-31-RT-01.dgn

Hutchison Engineering, Inc.
Since 1945
JACKSONVILLE • PEORIA • SHOREWOOD
CARBONDALE • MOLINE
Illinois Professional Design Firm No. 184-000825

USER NAME = CBossert	DESIGNED - CMB	REVISED -
	DRAWN - CMB	REVISED -
PLOT SCALE = 200,0000' / In.	CHECKED - BMB	REVISED -
PLOT DATE = 12/27/2021	DATE - 08/2021	REVISED -

**STATE OF ILLINOIS
DEPARTMENT OF TRANSPORTATION**

**MAPLEWOOD DRIVE (FAU 4094) MULTI-USE PATH
ALIGNMENT AND BENCHMARKS**

SCALE: 1"=100'-0" SHEET 1 OF 1 SHEETS STA. 5+17.20 TO STA. 77+66.86

F.A.U. RTE.	SECTION	COUNTY	TOTAL SHEETS	SHEET NO.
4094	20-00115-00-BT	CHAMPAIGN	23	9
CONTRACT NO. 91614				
ILLINOIS		FED. AID PROJECT		



LEGEND

- ① PROPOSED SIDEWALK, 5"
- ② PROPOSED ADA SIDEWALK RAMP. SEE RAMP DETAILS.
- ③ PROPOSED COMBINATION CURB AND GUTTER, TYPE B-6.18, TO BE REMOVED AND REPLACED. SEE RAMP DETAILS.
- ④ PROPOSED EPOXY PAVEMENT MARKING - LINE 6"
- ⑤ PROPOSED EPOXY PAVEMENT MARKING - LINE 12"
- ⑥ PROPOSED EPOXY PAVEMENT MARKING - LINE 24"
- ADJ PROPOSED STRUCTURE TO BE ADJUSTED

- PROPOSED SIDEWALK REMOVAL
- PROPOSED ENTRANCE REMOVAL
- PROPOSED INLET AND PIPE PROTECTION
- PROPOSED SIGN ASSEMBLY
- PROPOSED FOLD DOWN BOLLARD
- PROPOSED PERIMETER EROSION BARRIER

MODEL Default
 FILE Name: 20224 - Maplewood Bike Path ITP Application (Routin)\CAD\CADD\Streets\10-4324-41-SP04.dwg
 Since 1945
Hutchison Engineering, Inc.
 JACKSONVILLE • PEORIA • SHOREWOOD
 CARBONDALE • MOLINE
 Illinois Professional Design Firm No. 184-000825

USER NAME = CBossert	DESIGNED - CMB	REVISED -
PLOT SCALE = 40,0000 ' / In.	DRAWN - CMB	REVISED -
PLOT DATE = 12/27/2021	CHECKED - BMB	REVISED -
	DATE - 08/2021	REVISED -

STATE OF ILLINOIS
DEPARTMENT OF TRANSPORTATION

MAPLEWOOD DRIVE (FAU 4094) MULTI-USE PATH
ROADWAY PLAN SHEETS
 SCALE: 1"=20'-0" SHEET 1 OF 3 SHEETS STA. 40+00.00 TO STA. 52+00.00

F.A.U. RTE.	SECTION	COUNTY	TOTAL SHEETS	SHEET NO.
4094	20-00115-00-BT	CHAMPAIGN	23	10
			CONTRACT NO. 91614	
ILLINOIS FED. AID PROJECT				

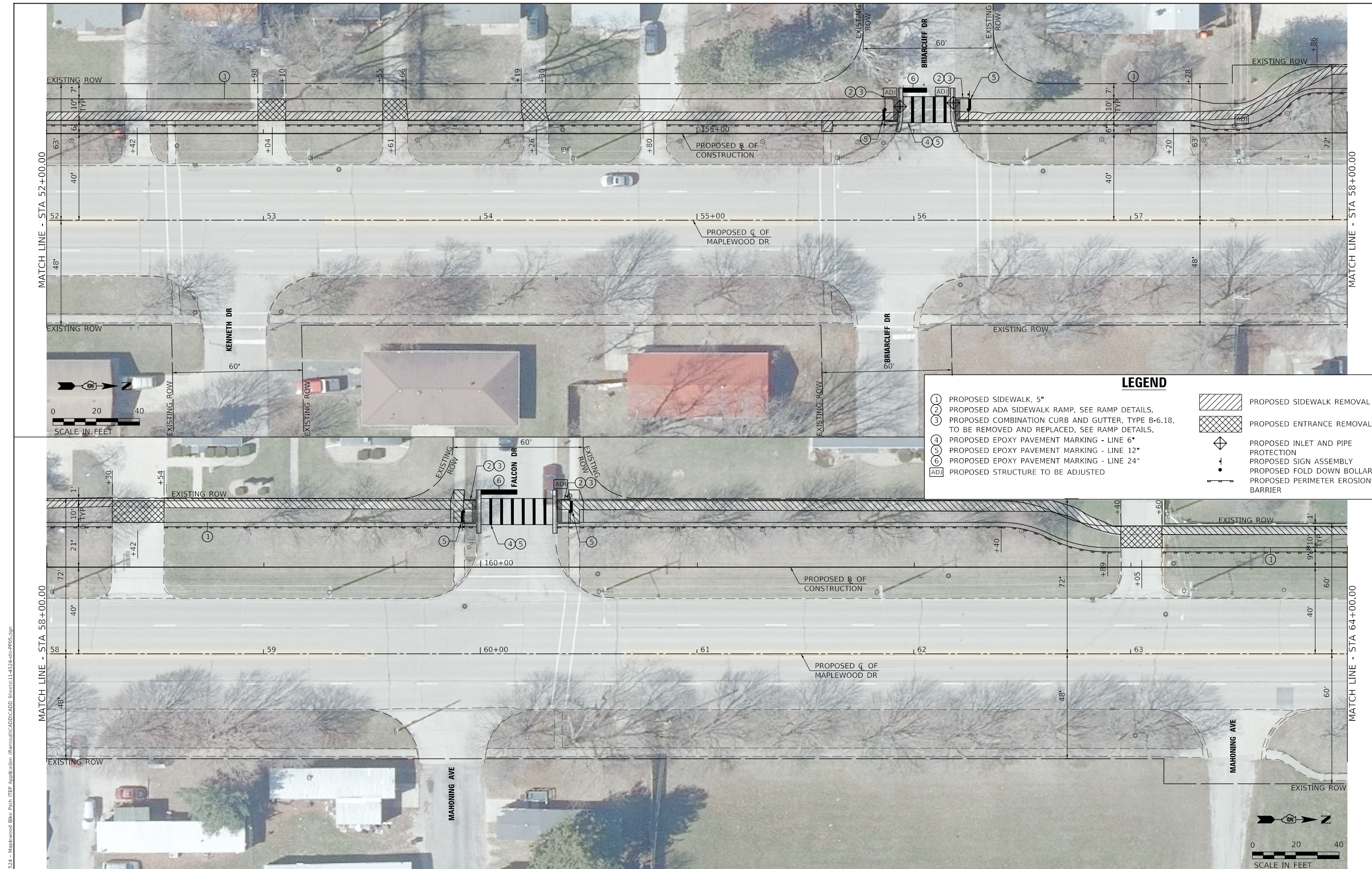

MATCH LINE - STA 52+00.00

MATCH LINE - STA 58+00.00

MATCH LINE - STA 58+00.00

MATCH LINE - STA 64+00.00

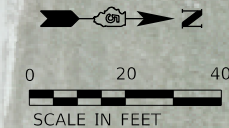
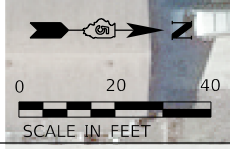

LEGEND	
①	PROPOSED SIDEWALK, 5"
②	PROPOSED ADA SIDEWALK RAMP. SEE RAMP DETAILS.
③	PROPOSED COMBINATION CURB AND GUTTER, TYPE B-6.18, TO BE REMOVED AND REPLACED. SEE RAMP DETAILS.
④	PROPOSED EPOXY PAVEMENT MARKING - LINE 6"
⑤	PROPOSED EPOXY PAVEMENT MARKING - LINE 12"
⑥	PROPOSED EPOXY PAVEMENT MARKING - LINE 24"
ADJ	PROPOSED STRUCTURE TO BE ADJUSTED
	PROPOSED SIDEWALK REMOVAL
	PROPOSED ENTRANCE REMOVAL
	PROPOSED INLET AND PIPE PROTECTION
	PROPOSED SIGN ASSEMBLY
	PROPOSED FOLD DOWN BOLLARD
	PROPOSED PERIMETER EROSION BARRIER

MODEL Default
 FILE Name: W:\224 - Maplewood Bike Path ITEP Application (Printout)\CAD\CADD_Sheets\1-42344-10-PP05.dwg
 Since 1945
Hutchison Engineering, Inc.
 JACKSONVILLE • PEORIA • SHOREWOOD
 CARBONDALE • MOLINE
 Illinois Professional Design Firm No. 184-000825

USER NAME = CBossert	DESIGNED - CMB	REVISED -
PLOT SCALE = 40,0000 ' / In.	DRAWN - CMB	REVISED -
PLOT DATE = 12/27/2021	CHECKED - BMB	REVISED -
	DATE - 08/2021	REVISED -

STATE OF ILLINOIS
DEPARTMENT OF TRANSPORTATION

MAPLEWOOD DRIVE (FAU 4094) MULTI-USE PATH
ROADWAY PLAN SHEETS

SCALE: 1"=20'-0" SHEET 2 OF 3 SHEETS STA. 52+00.00 TO STA. 64+00.00

F.A.U. RTE.	SECTION	COUNTY	TOTAL SHEETS	SHEET NO.
4094	20-00115-00-BT	CHAMPAIGN	23	11
			CONTRACT NO. 91614	
		ILLINOIS	FED. AID PROJECT	

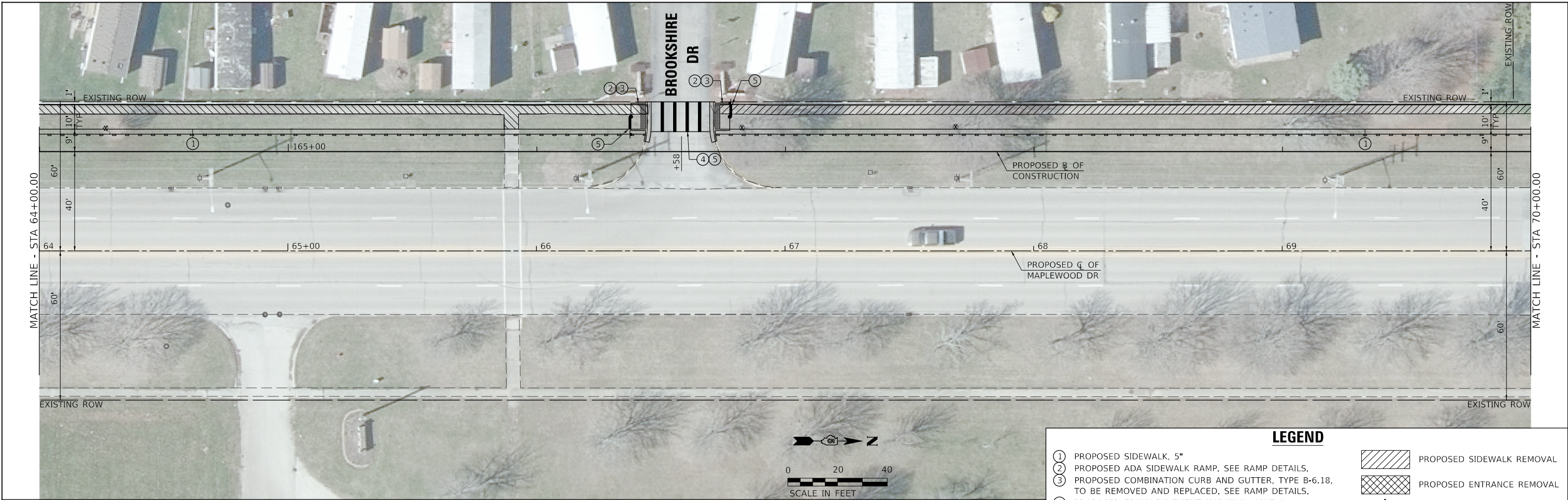

LEGEND

- ① PROPOSED SIDEWALK, 5"
- ② PROPOSED ADA SIDEWALK RAMP. SEE RAMP DETAILS.
- ③ PROPOSED COMBINATION CURB AND GUTTER, TYPE B-6.18, TO BE REMOVED AND REPLACED, SEE RAMP DETAILS.
- ④ PROPOSED EPOXY PAVEMENT MARKING - LINE 6"
- ⑤ PROPOSED EPOXY PAVEMENT MARKING - LINE 12"
- ⑥ PROPOSED EPOXY PAVEMENT MARKING - LINE 24"
- ADJ PROPOSED STRUCTURE TO BE ADJUSTED

- PROPOSED SIDEWALK REMOVAL
- PROPOSED ENTRANCE REMOVAL
- PROPOSED INLET AND PIPE PROTECTION
- PROPOSED SIGN ASSEMBLY
- PROPOSED FOLD DOWN BOLLARD
- PROPOSED PERIMETER EROSION BARRIER

MODEL Default
 FILE Name: V:\224 - Maplewood Bike Path ITEP Application (Routin)\CAD\CADD Streets\12-23-24-14-1-SPR06.dwg
 Since 1945
Hutchison Engineering, Inc.
 JACKSONVILLE • PEORIA • SHOREWOOD
 CARBONDALE • MOLINE
 Illinois Professional Design Firm No. 184-000825

USER NAME = CBossert	DESIGNED -	REVISED -
PLOT SCALE = 40,0000 ' / In.	DRAWN -	REVISED -
PLOT DATE = 12/27/2021	CHECKED -	REVISED -
	DATE -	REVISED -

STATE OF ILLINOIS
DEPARTMENT OF TRANSPORTATION

MAPLEWOOD DRIVE (FAU 4094) MULTI-USE PATH
ROADWAY PLAN SHEETS
 SCALE: 1"=20'-0" SHEET 3 OF 3 SHEETS STA. 64+00.00 TO STA. 76+00.00

F.A.U. RTE.	SECTION	COUNTY	TOTAL SHEETS	SHEET NO.
4094	20-00115-00-BT	CHAMPAIGN	23	12
			CONTRACT NO. 91614	
		ILLINOIS FED. AID PROJECT		

NORTH MAPLEWOOD DRIVE / CLARK STREET INTERSECTION

NORTHWEST QUADRANT SIDEWALK

HIGHWAY STD. 424001 - PERPENDICULAR CURB RAMP FOR SIDEWALKS

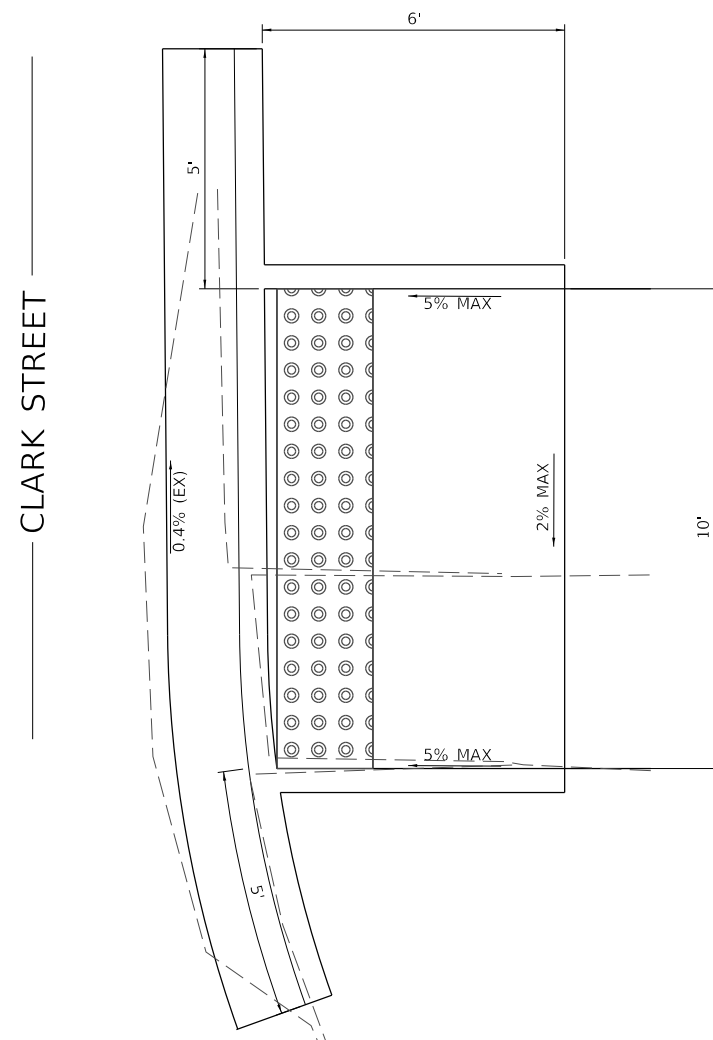

THE CONTRACTOR SHALL VERIFY EXISTING FIELD CONDITIONS PRIOR TO THE CONSTRUCTION OF ANY RAMP OR SIDEWALK. ANY ADJUSTMENTS NECESSARY TO MEET EXISTING FIELD CONDITIONS SHALL BE APPROVED BY THE ENGINEER PRIOR TO CONSTRUCTION.

MODEL Default
FILE Name: V:\24 - Maplewood Bike Path ITP Application (Printed)\CADD\CADD_Sheets\13-424-24-511-Ramp01.dgn

Hutchison Engineering, Inc.
Since 1945
JACKSONVILLE • PEORIA • SHOREWOOD
CARBONDALE • MOLINE
Illinois Professional Design Firm No. 184-000825

USER NAME = CBossert	DESIGNED - CMB	REVISED -
	DRAWN - CMB	REVISED -
PLOT SCALE = 4,000' / 1",	CHECKED - BMB	REVISED -
PLOT DATE = 12/27/2021	DATE - 08/2021	REVISED -

**STATE OF ILLINOIS
DEPARTMENT OF TRANSPORTATION**

**MAPLEWOOD DRIVE (FAU 4094) MULTI-USE PATH
SIDEWALK RAMP DETAIL SHEETS**

SCALE: N/A SHEET 1 OF 11 SHEETS

F.A.U. RTE.	SECTION	COUNTY	TOTAL SHEETS	SHEET NO.
4094	20-00115-00-BT	CHAMPAIGN	23	13
ILLINOIS			FED. AID PROJECT	

CONTRACT NO. 91614

NORTH MAPLEWOOD DRIVE /BEL AIRE DRIVE INTERSECTION
SOUTHWEST QUADRANT SIDEWALK
 HIGHWAY STD. 424001 - PERPENDICULAR CURB RAMPS FOR SIDEWALKS

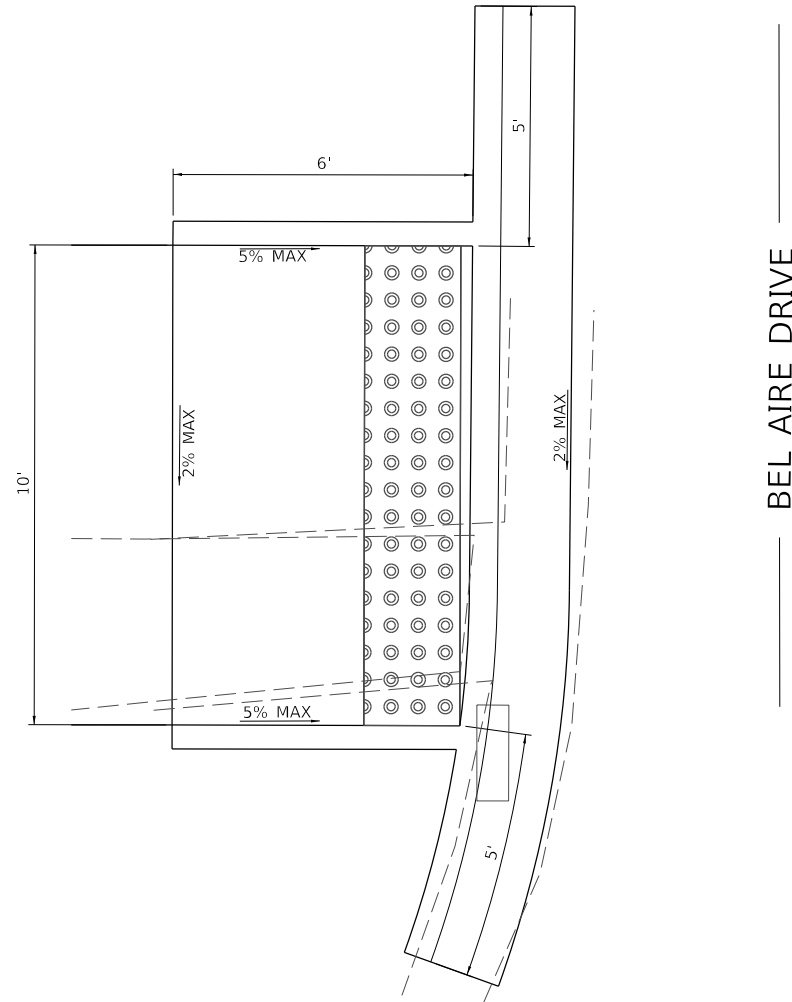

THE CONTRACTOR SHALL VERIFY EXISTING FIELD CONDITIONS PRIOR TO THE CONSTRUCTION OF ANY RAMP OR SIDEWALK. ANY ADJUSTMENTS NECESSARY TO MEET EXISTING FIELD CONDITIONS SHALL BE APPROVED BY THE ENGINEER PRIOR TO CONSTRUCTION.

MODEL Default
 FILE Name: V:\224 - Maplewood Bike Path ITEP Application (Ramp)\CADD\CADD - Streets\14-424-41-5-ramp02.dgn

Hutchison Engineering, Inc.
 Since 1945
 JACKSONVILLE • PEORIA • SHOREWOOD
 CARBONDALE • MOLINE
 Illinois Professional Design Firm No. 184-000825

USER NAME = CBossert	DESIGNED - CMB	REVISED -
	DRAWN - CMB	REVISED -
PLOT SCALE = 4,0000' / In.	CHECKED - BMB	REVISED -
PLOT DATE = 12/27/2021	DATE - 08/2021	REVISED -

STATE OF ILLINOIS
DEPARTMENT OF TRANSPORTATION

MAPLEWOOD DRIVE (FAU 4094) MULTI-USE PATH
SIDEWALK RAMP DETAIL SHEETS

SCALE: N/A SHEET 2 OF 11 SHEETS

F.A.U. RTE.	SECTION	COUNTY	TOTAL SHEETS	SHEET NO.
4094	20-00115-00-BT	CHAMPAIGN	23	14
ILLINOIS			FED. AID PROJECT	

CONTRACT NO. 91614

NORTH MAPLEWOOD DRIVE /BEL AIRE DRIVE INTERSECTION
NORTHWEST QUADRANT SIDEWALK
 HIGHWAY STD. 424001 - PERPENDICULAR CURB RAMP FOR SIDEWALKS



— BEL AIRE DRIVE —

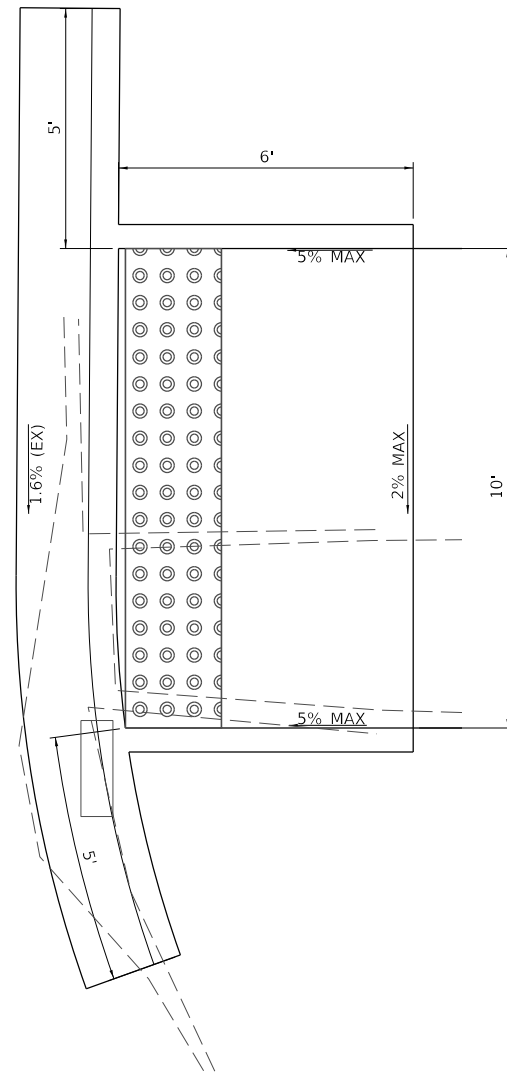

THE CONTRACTOR SHALL VERIFY EXISTING FIELD CONDITIONS PRIOR TO THE CONSTRUCTION OF ANY RAMP OR SIDEWALK. ANY ADJUSTMENTS NECESSARY TO MEET EXISTING FIELD CONDITIONS SHALL BE APPROVED BY THE ENGINEER PRIOR TO CONSTRUCTION.

MODEL Default
 FILE Name: 24-0224 - Maplewood Bike Path ITEP Application (Printout)\CADD\CADD_Sheets\15-424001-SidewalkRamp03.dwg

Hutchison Engineering, Inc.
 Since 1945
 JACKSONVILLE • PEORIA • SHOREWOOD
 CARBONDALE • MOLINE
 Illinois Professional Design Firm No. 184-000825

USER NAME = CBossert	DESIGNED - CMB	REVISED -
	DRAWN - CMB	REVISED -
PLOT SCALE = 4,000' / 1",	CHECKED - BMB	REVISED -
PLOT DATE = 12/27/2021	DATE - 08/2021	REVISED -

STATE OF ILLINOIS
DEPARTMENT OF TRANSPORTATION

MAPLEWOOD DRIVE (FAU 4094) MULTI-USE PATH
SIDEWALK RAMP DETAIL SHEETS

SCALE: N/A SHEET 3 OF 11 SHEETS

F.A.U. RTE.	SECTION	COUNTY	TOTAL SHEETS	SHEET NO.
4094	20-00115-00-BT	CHAMPAIGN	23	15
ILLINOIS			FED. AID PROJECT	

CONTRACT NO. 91614

NORTH MAPLEWOOD DRIVE / BRIARCLIFF DRIVE
SOUTHWEST QUADRANT SIDEWALK
 HIGHWAY STD. 424001 - PERPENDICULAR CURB RAMP FOR SIDEWALKS

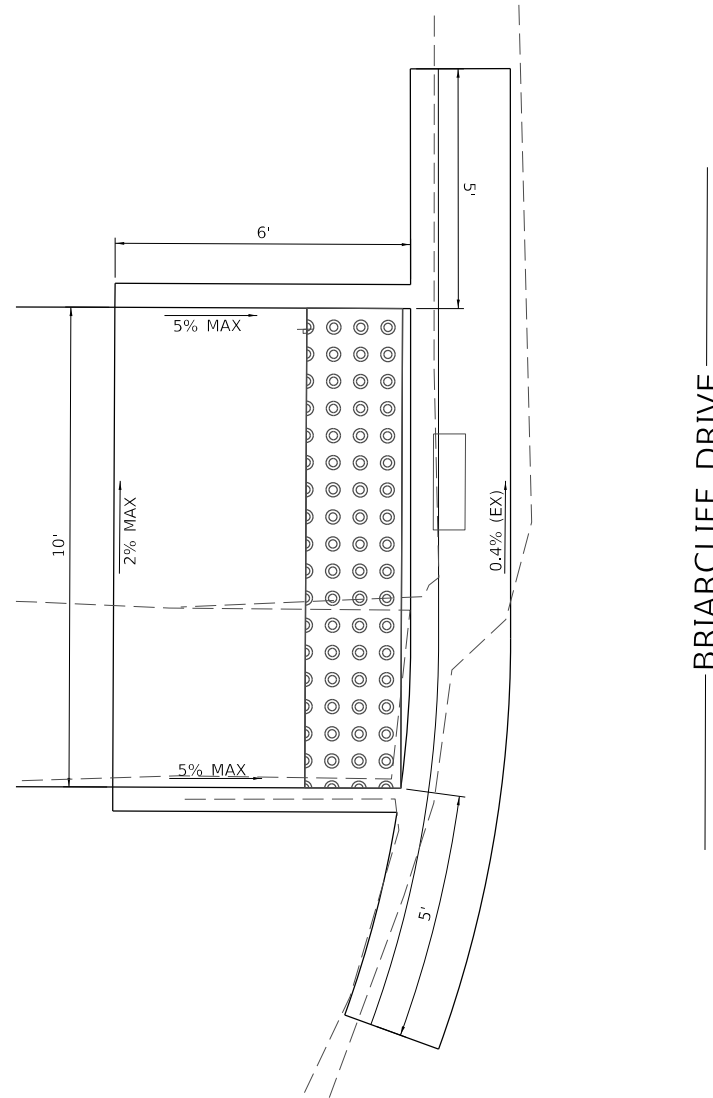

THE CONTRACTOR SHALL VERIFY EXISTING FIELD CONDITIONS PRIOR TO THE CONSTRUCTION OF ANY RAMP OR SIDEWALK. ANY ADJUSTMENTS NECESSARY TO MEET EXISTING FIELD CONDITIONS SHALL BE APPROVED BY THE ENGINEER PRIOR TO CONSTRUCTION.

MODEL Default
 FILE Name: V:\224 - Maplewood Bike Path ITP Application (Printed)\CADD\CADD_Sheets\16-424-01-Sidewalk.dgn

Hutchison Engineering, Inc.
 Since 1945
 JACKSONVILLE • PEORIA • SHOREWOOD
 CARBONDALE • MOLINE
 Illinois Professional Design Firm No. 184-000825

USER NAME = CBossert	DESIGNED - CMB	REVISED -
	DRAWN - CMB	REVISED -
PLOT SCALE = 4,000' / 1" =	CHECKED - BMB	REVISED -
PLOT DATE = 12/27/2021	DATE - 08/2021	REVISED -

STATE OF ILLINOIS
DEPARTMENT OF TRANSPORTATION

MAPLEWOOD DRIVE (FAU 4094) MULTI-USE PATH
SIDEWALK RAMP DETAIL SHEETS

SCALE: N/A SHEET 4 OF 11 SHEETS

F.A.U. RTE.	SECTION	COUNTY	TOTAL SHEETS	SHEET NO.
4094	20-00115-00-BT	CHAMPAIGN	23	16
ILLINOIS FED. AID PROJECT			CONTRACT NO. 91614	

NORTH MAPLEWOOD DRIVE / BRIARCLIFF DRIVE INTERSECTION
NORTHWEST QUADRANT SIDEWALK
 HIGHWAY STD. 424001 - PERPENDICULAR CURB RAMPS FOR SIDEWALKS

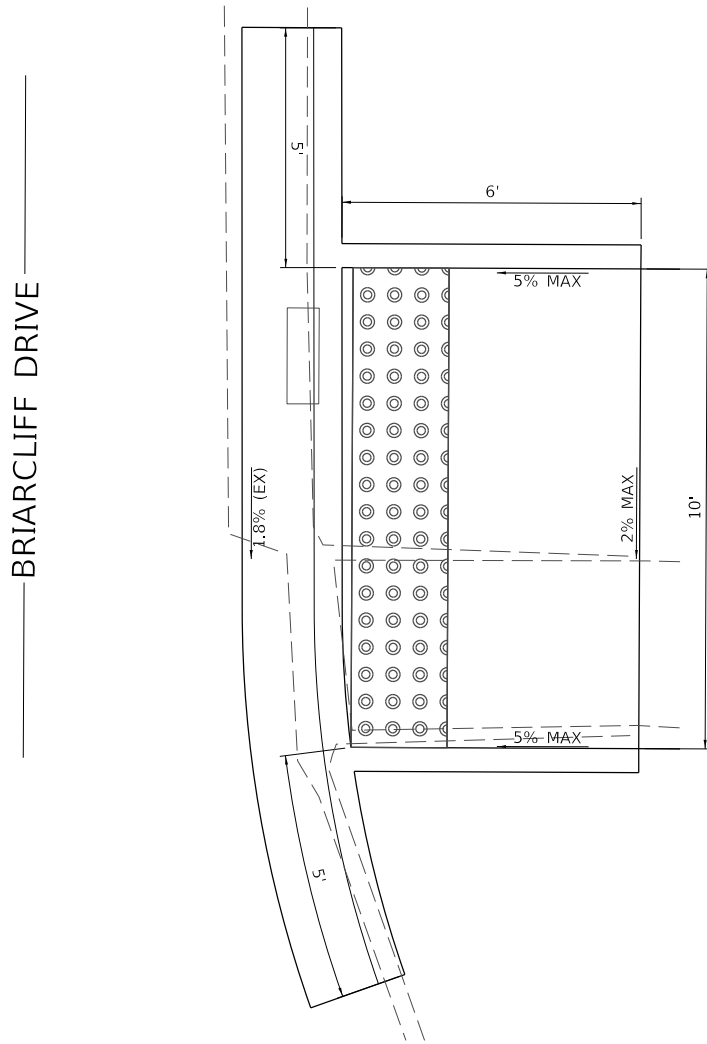

THE CONTRACTOR SHALL VERIFY EXISTING FIELD CONDITIONS PRIOR TO THE CONSTRUCTION OF ANY RAMP OR SIDEWALK. ANY ADJUSTMENTS NECESSARY TO MEET EXISTING FIELD CONDITIONS SHALL BE APPROVED BY THE ENGINEER PRIOR TO CONSTRUCTION.

MODEL Default
 FILE Name: V:\224 - Maplewood Bike Path ITEP Application (Printed)\CADD\CADD_Sheets\17-424-01-SidewalkRamp05.dwg

Hutchison Engineering, Inc.
 Since 1945
 JACKSONVILLE • PEORIA • SHOREWOOD
 CARBONDALE • MOLINE
 Illinois Professional Design Firm No. 184-000825

USER NAME = CBossert	DESIGNED - CMB	REVISED -
	DRAWN - CMB	REVISED -
PLOT SCALE = 4,0000' / In.	CHECKED - BMB	REVISED -
PLOT DATE = 12/27/2021	DATE - 08/2021	REVISED -

STATE OF ILLINOIS
DEPARTMENT OF TRANSPORTATION

MAPLEWOOD DRIVE (FAU 4094) MULTI-USE PATH
SIDEWALK RAMP DETAIL SHEETS

SCALE: N/A SHEET 5 OF 11 SHEETS

F.A.U. RTE.	SECTION	COUNTY	TOTAL SHEETS	SHEET NO.
4094	20-00115-00-BT	CHAMPAIGN	23	17
ILLINOIS FED. AID PROJECT			CONTRACT NO. 91614	

**NORTH MAPLEWOOD DRIVE /BROOKSHIRE DRIVE INTERSECTION
SOUTHWEST QUADRANT SIDEWALK**

HIGHWAY STD. 424026 - ENTRANCE/ALLEY PEDESTRIAN CROSSINGS

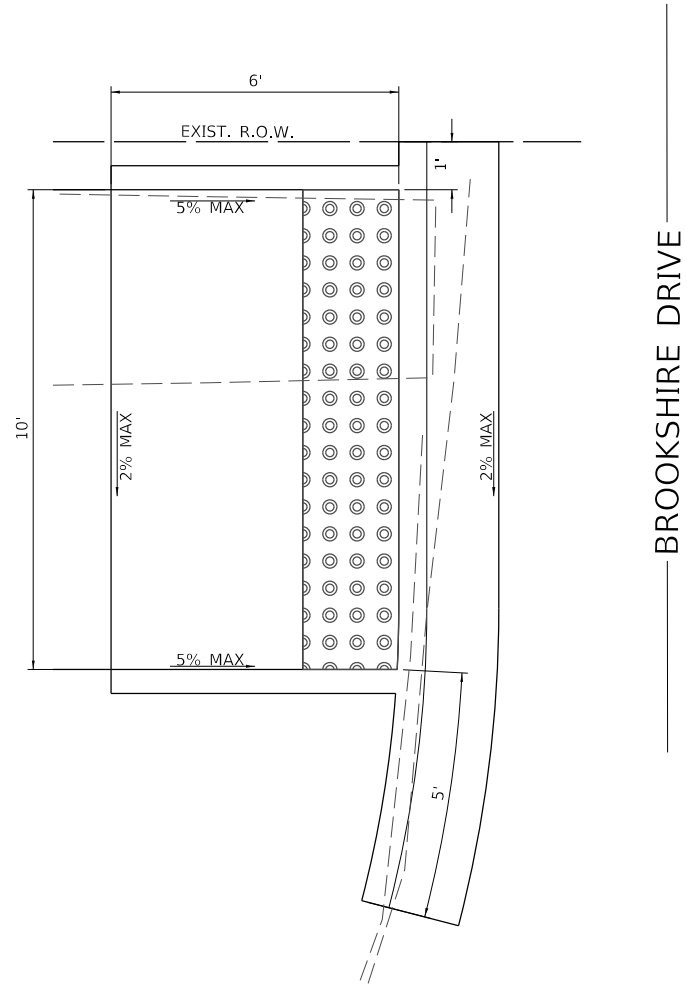

BROOKSHIRE DRIVE

THE CONTRACTOR SHALL VERIFY EXISTING FIELD CONDITIONS PRIOR TO THE CONSTRUCTION OF ANY RAMP OR SIDEWALK. ANY ADJUSTMENTS NECESSARY TO MEET EXISTING FIELD CONDITIONS SHALL BE APPROVED BY THE ENGINEER PRIOR TO CONSTRUCTION.

MODEL Default
FILE Name: E:\324 - Maplewood Bike Path ITEP Application (Printed)\CADD\CADD_Sheets\324-424-41-Samp08.dwg

Hutchison Engineering, Inc.
Since 1945
JACKSONVILLE • PEORIA • SHOREWOOD
CARBONDALE • MOLINE
Illinois Professional Design Firm No. 184-000825

USER NAME = CBossert	DESIGNED - CMB	REVISED -
	DRAWN - CMB	REVISED -
PLOT SCALE = 4,0000' / In.	CHECKED - BMB	REVISED -
PLOT DATE = 12/27/2021	DATE - 08/2021	REVISED -

**STATE OF ILLINOIS
DEPARTMENT OF TRANSPORTATION**

**MAPLEWOOD DRIVE (FAU 4094) MULTI-USE PATH
SIDEWALK RAMP DETAIL SHEETS**

SCALE: N/A SHEET 8 OF 11 SHEETS

F.A.U. RTE.	SECTION	COUNTY	TOTAL SHEETS	SHEET NO.
4094	20-00115-00-BT	CHAMPAIGN	23	20
ILLINOIS			FED. AID PROJECT	

CONTRACT NO. 91614

NORTH MAPLEWOOD DRIVE /BROOKSHIRE DRIVE INTERSECTION
NORTHWEST QUADRANT SIDEWALK
 HIGHWAY STD. 424026 - ENTRANCE/ALLEY PEDESTRIAN CROSSINGS

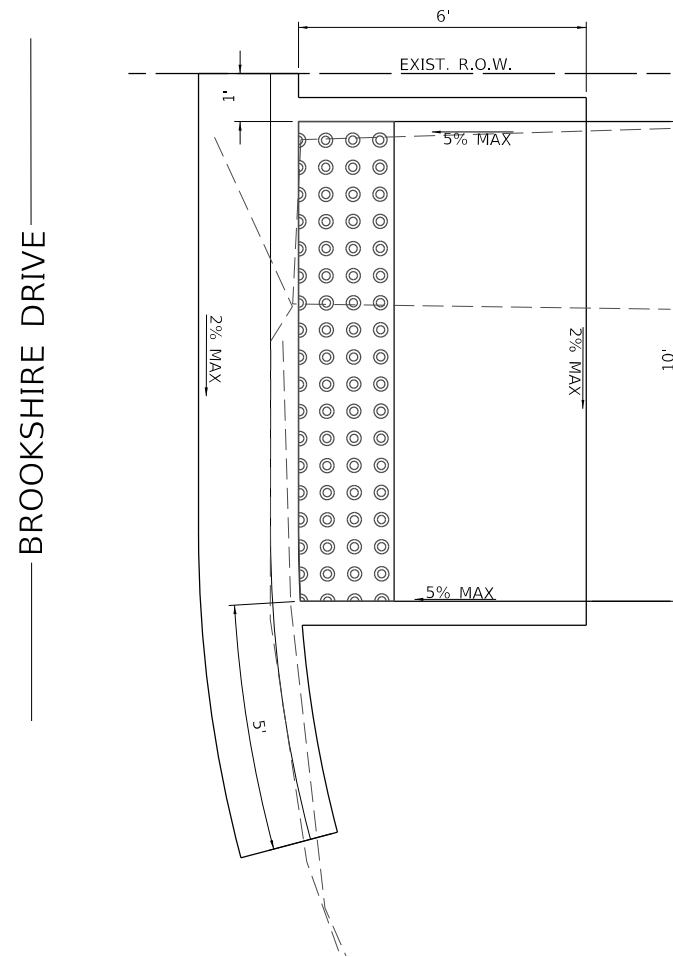

THE CONTRACTOR SHALL VERIFY EXISTING FIELD CONDITIONS PRIOR TO THE CONSTRUCTION OF ANY RAMP OR SIDEWALK. ANY ADJUSTMENTS NECESSARY TO MEET EXISTING FIELD CONDITIONS SHALL BE APPROVED BY THE ENGINEER PRIOR TO CONSTRUCTION.

MODEL Default
 FILE Name: 24-024 - Maplewood Bike Path ITEP Application (Printed)CADD\CADD - Streets\24-024-Bike-Ramp\09.dgn

Hutchison Engineering, Inc.
 Since 1945
 JACKSONVILLE • PEORIA • SHOREWOOD
 CARBONDALE • MOLINE
 Illinois Professional Design Firm No. 184-000825

USER NAME = CBossert	DESIGNED - CMB	REVISED -
	DRAWN - CMB	REVISED -
PLOT SCALE = 4,0000' / In.	CHECKED - BMB	REVISED -
PLOT DATE = 12/27/2021	DATE - 08/2021	REVISED -

STATE OF ILLINOIS
DEPARTMENT OF TRANSPORTATION

MAPLEWOOD DRIVE (FAU 4094) MULTI-USE PATH
SIDEWALK RAMP DETAIL SHEETS

SCALE: N/A SHEET 9 OF 11 SHEETS

F.A.U. RTE.	SECTION	COUNTY	TOTAL SHEETS	SHEET NO.
4094	20-00115-00-BT	CHAMPAIGN	23	21
ILLINOIS FED. AID PROJECT			CONTRACT NO. 91614	

NORTH MAPLEWOOD DRIVE /CRANE DRIVE INTERSECTION
SOUTHWEST QUADRANT SIDEWALK
 HIGHWAY STD. 424001 - PERPENDICULAR CURB RAMP FOR SIDEWALKS

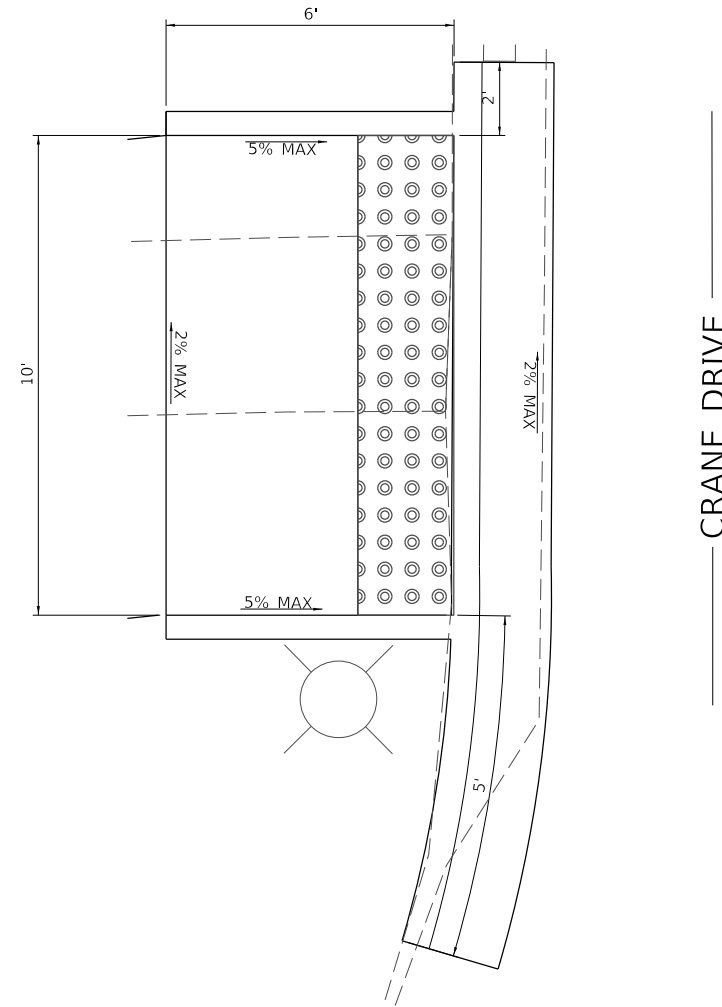

THE CONTRACTOR SHALL VERIFY EXISTING FIELD CONDITIONS PRIOR TO THE CONSTRUCTION OF ANY RAMP OR SIDEWALK. ANY ADJUSTMENTS NECESSARY TO MEET EXISTING FIELD CONDITIONS SHALL BE APPROVED BY THE ENGINEER PRIOR TO CONSTRUCTION.

MODEL Default
 FILE Name: 24-0324 - Maplewood Bike Path ITEP Application (Printout)\CADD\CADD_Sheets\324-0324-01-Sidewalk10.dgn

Hutchison Engineering, Inc.
 Since 1945
 JACKSONVILLE • PEORIA • SHOREWOOD
 CARBONDALE • MOLINE
 Illinois Professional Design Firm No. 184-000825

USER NAME = CBossert	DESIGNED -	REVISED -
	DRAWN -	REVISED -
PLOT SCALE = 4,0000' / In.	CHECKED -	REVISED -
PLOT DATE = 12/27/2021	DATE -	REVISED -

STATE OF ILLINOIS
DEPARTMENT OF TRANSPORTATION

MAPLEWOOD DRIVE (FAU 4094) MULTI-USE PATH
SIDEWALK RAMP DETAIL SHEETS

SCALE: N/A SHEET 10 OF 11 SHEETS STA. TO STA.

F.A.U. RTE.	SECTION	COUNTY	TOTAL SHEETS	SHEET NO.
4094	20-00115-BT	CHAMPAIGN	23	22
CONTRACT NO. 91614				
ILLINOIS FED. AID PROJECT				

NORTH MAPLEWOOD DRIVE /CRANE DRIVE INTERSECTION
NORTHWEST QUADRANT SIDEWALK
 HIGHWAY STD. 424001 - PERPENDICULAR CURB RAMP FOR SIDEWALKS

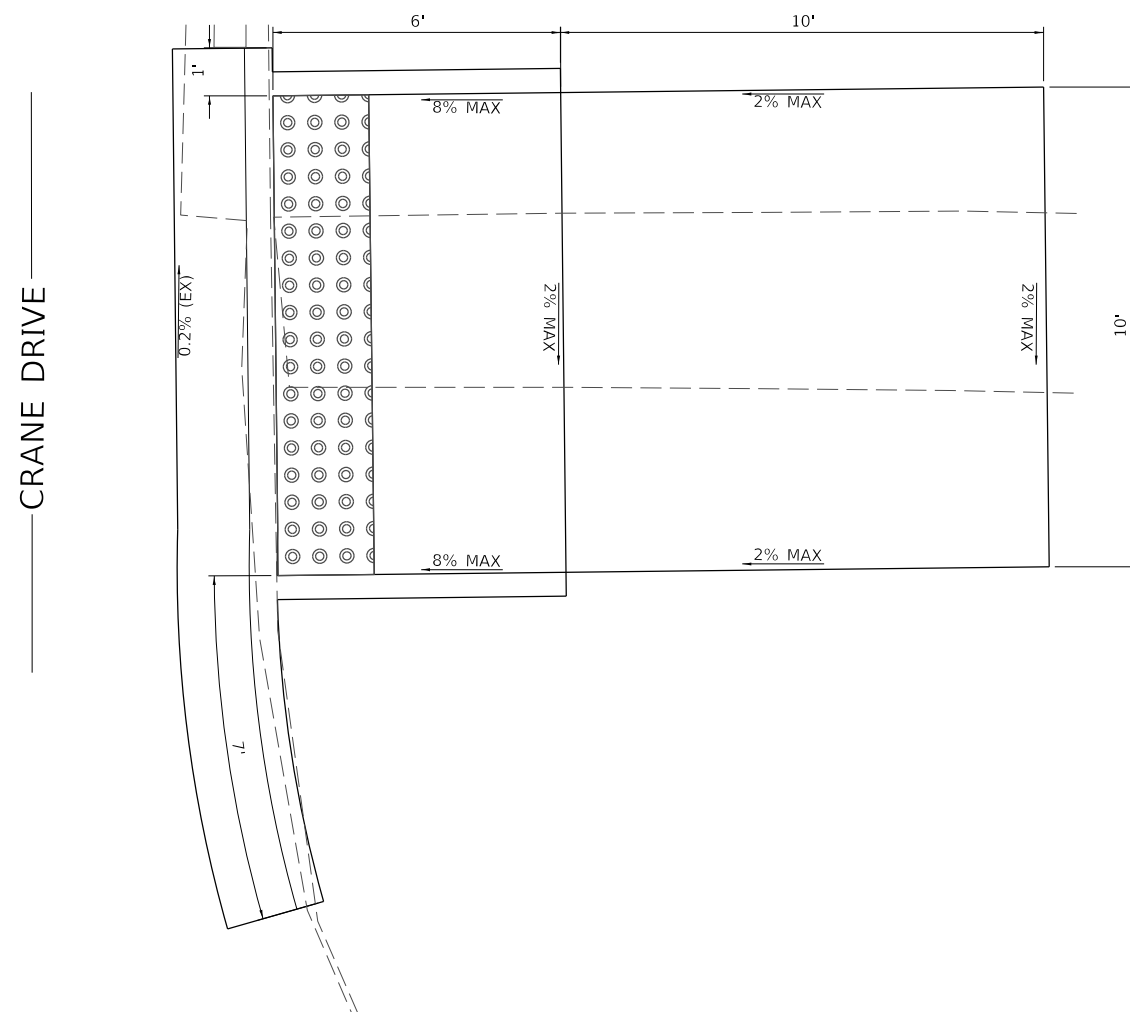

CRANE DRIVE

THE CONTRACTOR SHALL VERIFY EXISTING FIELD CONDITIONS PRIOR TO THE CONSTRUCTION OF ANY RAMP OR SIDEWALK. ANY ADJUSTMENTS NECESSARY TO MEET EXISTING FIELD CONDITIONS SHALL BE APPROVED BY THE ENGINEER PRIOR TO CONSTRUCTION.

MODEL Default
 FILE North_VA224 - Maplewood Bike Path ITEP Application (Printout)\CADD\CADD - Streets\3242424444-11-Ramp11.dgn

Hutchison Engineering, Inc.
 Since 1945
 JACKSONVILLE • PEORIA • SHOREWOOD
 CARBONDALE • MOLINE
 Illinois Professional Design Firm No. 184-000825

USER NAME = CBossert	DESIGNED - CMB	REVISED -
	DRAWN - CMB	REVISED -
PLOT SCALE = 4,0000' / In.	CHECKED - BMB	REVISED -
PLOT DATE = 12/27/2021	DATE - 08/2021	REVISED -

STATE OF ILLINOIS
DEPARTMENT OF TRANSPORTATION

MAPLEWOOD DRIVE (FAU 4094) MULTI-USE PATH
SIDEWALK RAMP DETAIL SHEETS

SCALE: N/A SHEET 11 OF 11 SHEETS

F.A.U. RTE.	SECTION	COUNTY	TOTAL SHEETS	SHEET NO.
4094	20-00115-00-BT	CHAMPAIGN	23	23
CONTRACT NO. 91614				
ILLINOIS FED. AID PROJECT				