

Note:
To be constructed in accordance with the state of Ill. State Highway Dept. Contract Form and General Specifications for Bridge Work, Edition of 1924.

BILL OF MATERIAL.

Bars	No	Size	Length
V	107	1/2" φ	6'-0"
V ₁	6	1/2" φ	5'-3"
V ₂	13	1/2" φ	6'-6"
V ₃	3	1/2" φ	7'-0"
V ₄	8	1/2" φ	7'-6"
V ₅	8	1/2" φ	9'-6"
h	15	1/2" φ	11'-0"
h ₁	15	1/2" φ	8'-6"
a	166	3/4" φ	21'-9"
b	86	1/2" φ	19'-0"
c	9	1/2" φ	19'-9"
m	8	1/2" φ	5'-0"
t	32	1/2" φ	3'-6"
d	28	1/2" φ	3'-6"

Bill Sta. 319+03 (62)
2-5/16 in boxelder tree El. = 182.49

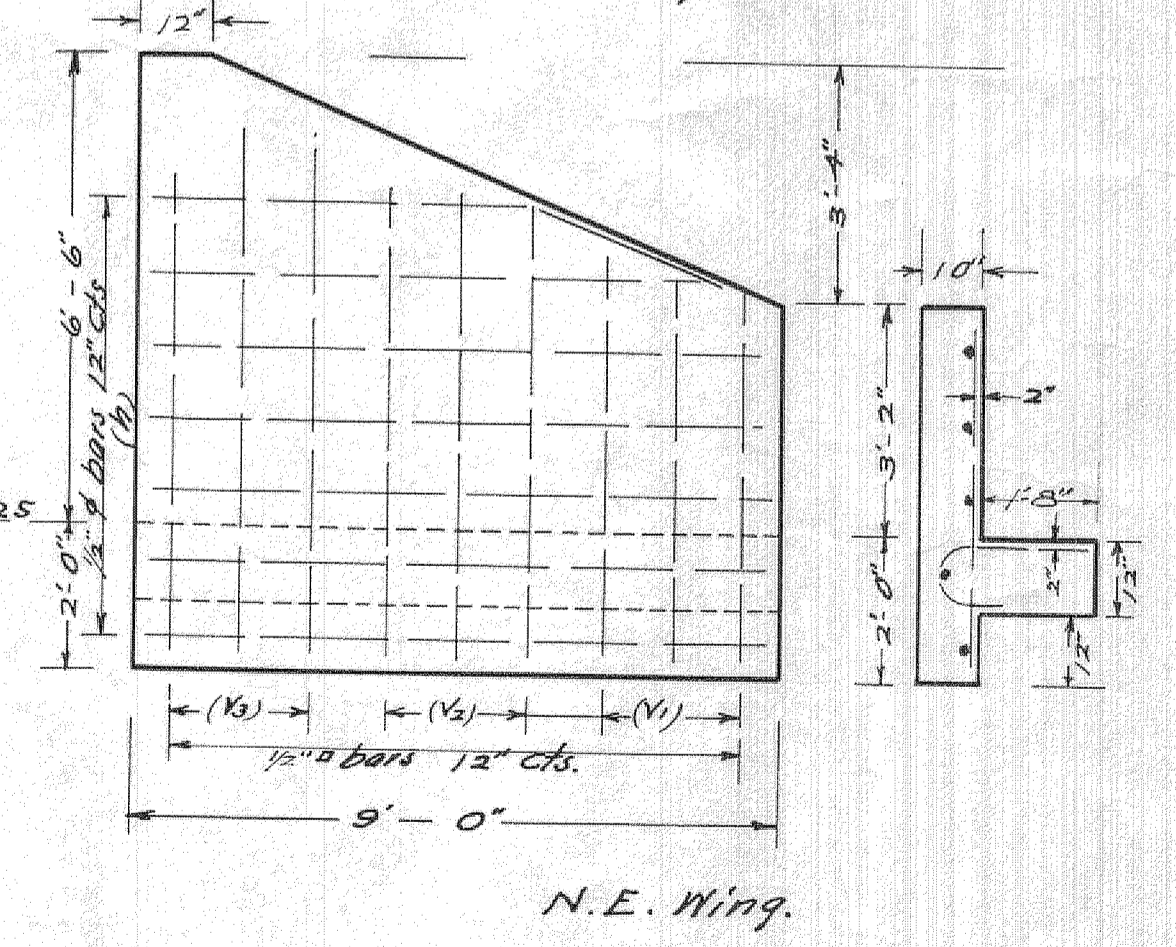
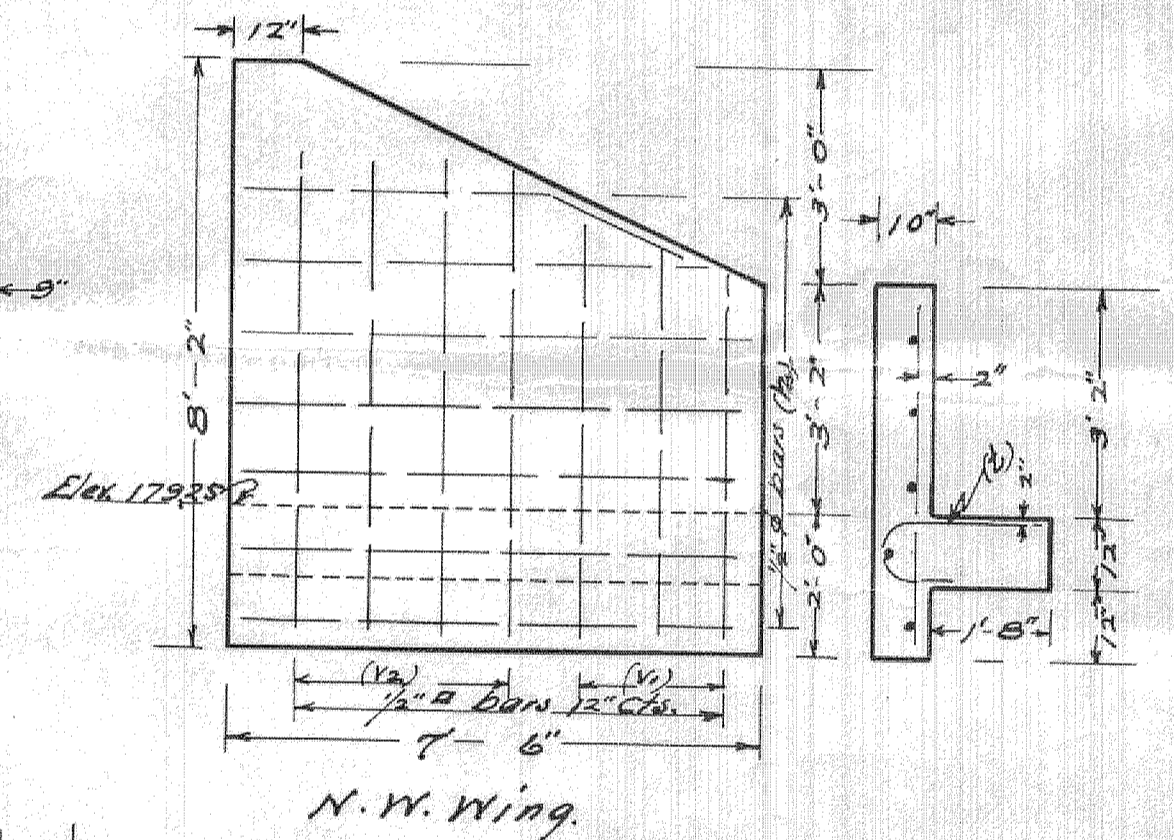

Bridge No 9-2-19
Book 73-Page 12
Drawn by S.B.H.
Checked by R.C.
Date April 1929

