

	USER NAME = Emily Munday	DESIGNED - EM	REVISED - 4/19/22	<b>STATE OF ILLINOIS DEPARTMENT OF TRANSPORTATION</b>	<b>STAGE CONSTRUCTION &amp; MAINTENANCE OF TRAFFIC GLEN AVENUE RECONSTRUCTION</b>	F.A.U. RTE. = 6650	SECTION = 18-00029-00-PV	COUNTY = PEORIA	TOTAL SHEETS = 112	SHEET NO. = 32
	PLOT SCALE = 100.0000' / in.	CHECKED - EH	REVISOR -			SCALE: 1" = 50'	SHEET 2 OF 8 SHEETS	STA. TO STA.	CONTRACT NO. 89789	
PLOT DATE = 4/19/2022 - 8:54:30 PM	DATE = DECEMBER 2021	REVISOR -	REVISOR -							

MODEL: Stage 1  
 FILE: Model: C:\Roads\20060603-200DrawRoadway\CADD\_Sheets...

License No. 184-000613 © Copyright CMT, Inc.

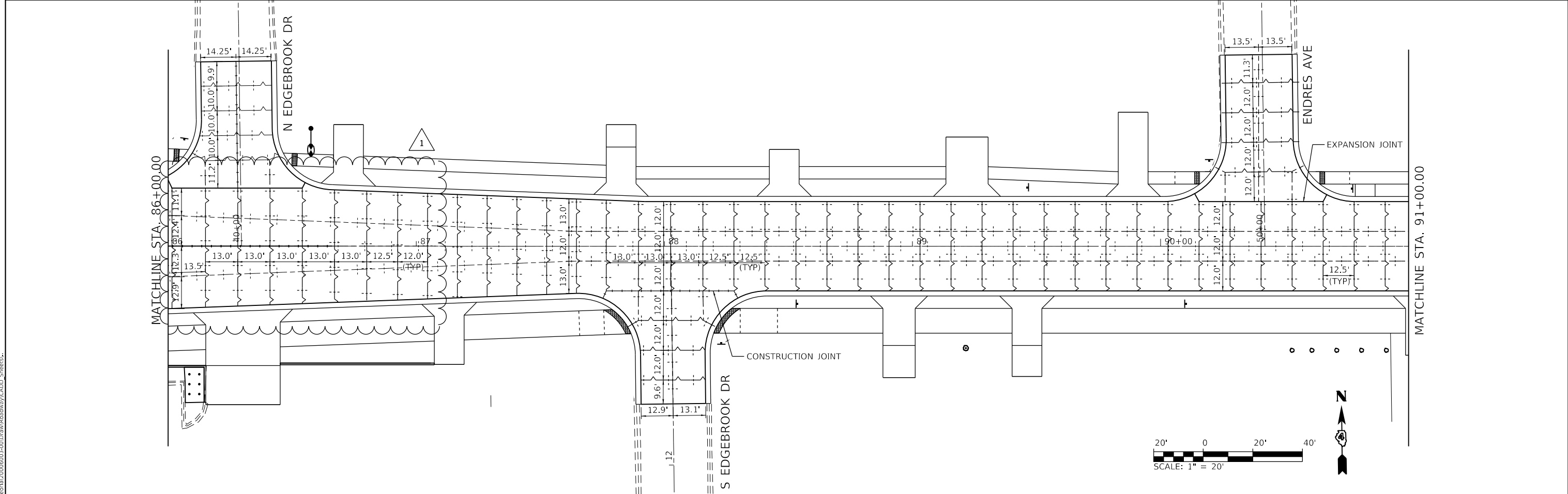
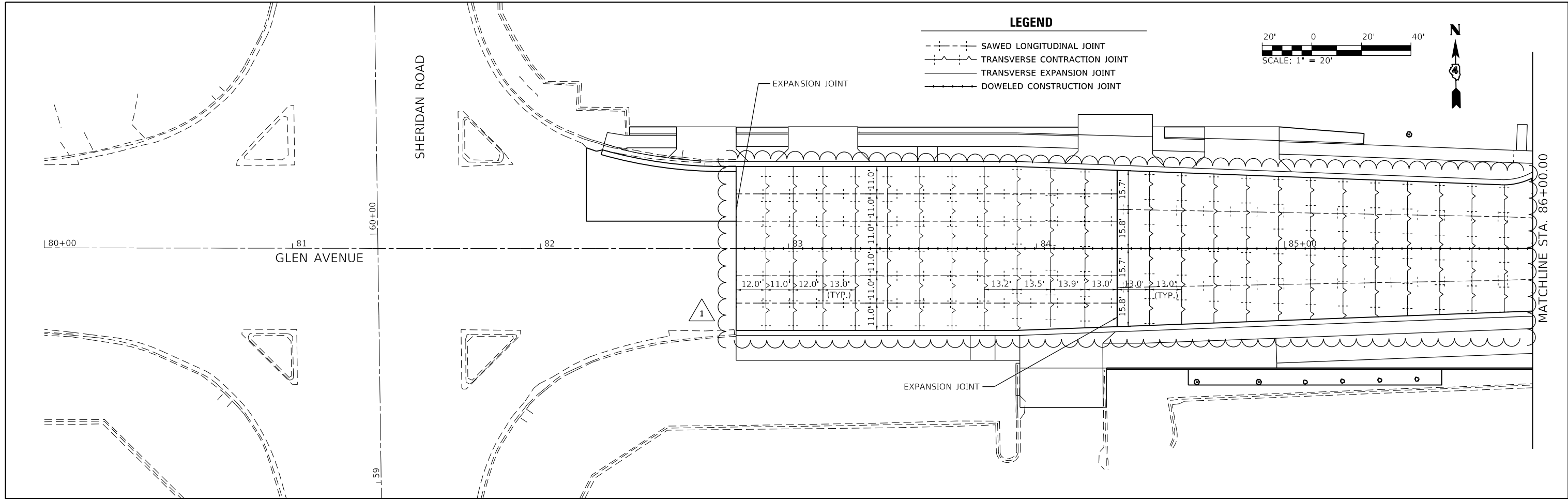

MODEL: Default  
 FILE: M:\GIS\_E\Projects\20060603-200DrawRoadway\CADD\_Sheets.



USER NAME = Emily Munday	DESIGNED - EM	REVISED -  4/19/22
PLOT SCALE = 40.0000 "/td> <td>DRAWN - AH</td> <td>REVISED -</td>	DRAWN - AH	REVISED -
PLOT DATE = 4/19/2022 - 8:23:42 PM	CHECKED - EH	REVISED -
	DATE - DECEMBER 2021	REVISED -

**STATE OF ILLINOIS  
 DEPARTMENT OF TRANSPORTATION**

**PAVEMENT JOINTING PLANS  
 GLEN AVENUE RECONSTRUCTION**

SCALE: 1" = 20' SHEET 1 OF 3 SHEETS STA. 80+00.00 TO STA. 91+00.00

F.A.U. RTE.	SECTION	COUNTY	TOTAL SHEETS	SHEET NO.
6650	18-00029-00-PV	PEORIA	112	56
CONTRACT NO. 89789				
ILLINOIS FED. AID PROJECT				