

STATE OF ILLINOIS
DEPARTMENT OF TRANSPORTATION

168'-11 1/2" End to End of Deck

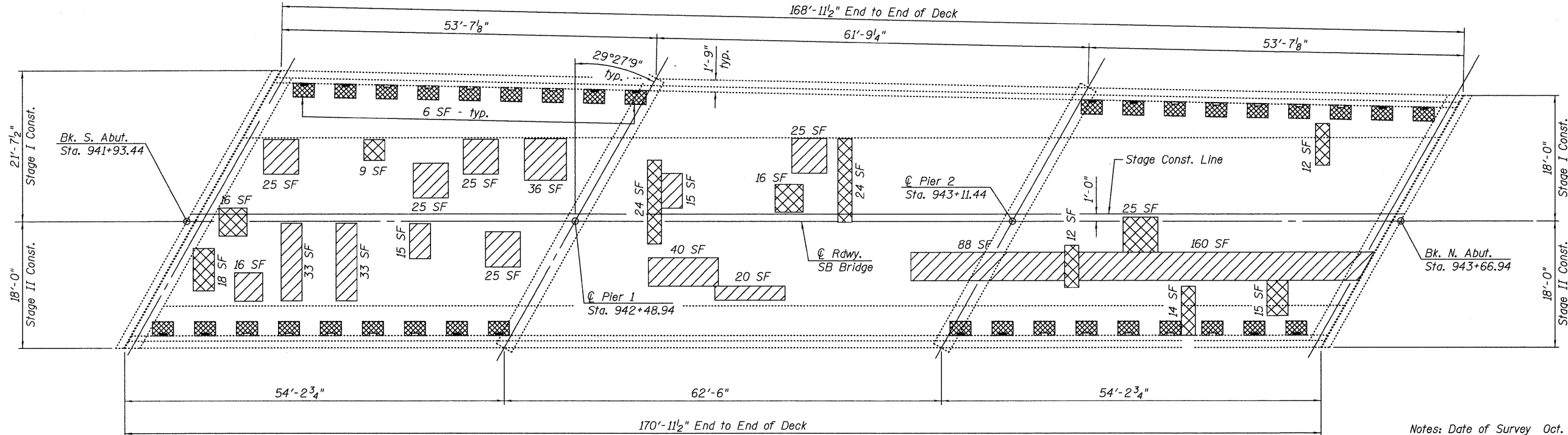

SB BRIDGE - DECK SLAB REPAIR PLAN

Notes: Date of Survey Oct. 2009

The Engineer shall record the actual Deck Slab Repair areas in the plans. Patches shown are taken from existing inspection reports. Full depth patches shall only be used in areas where Hydr-Scarification reveals or produces unsound concrete as determined by the Engineer. See Special Provisions for Deck Slab Repair.

170'-11 1/2" End to End of Deck

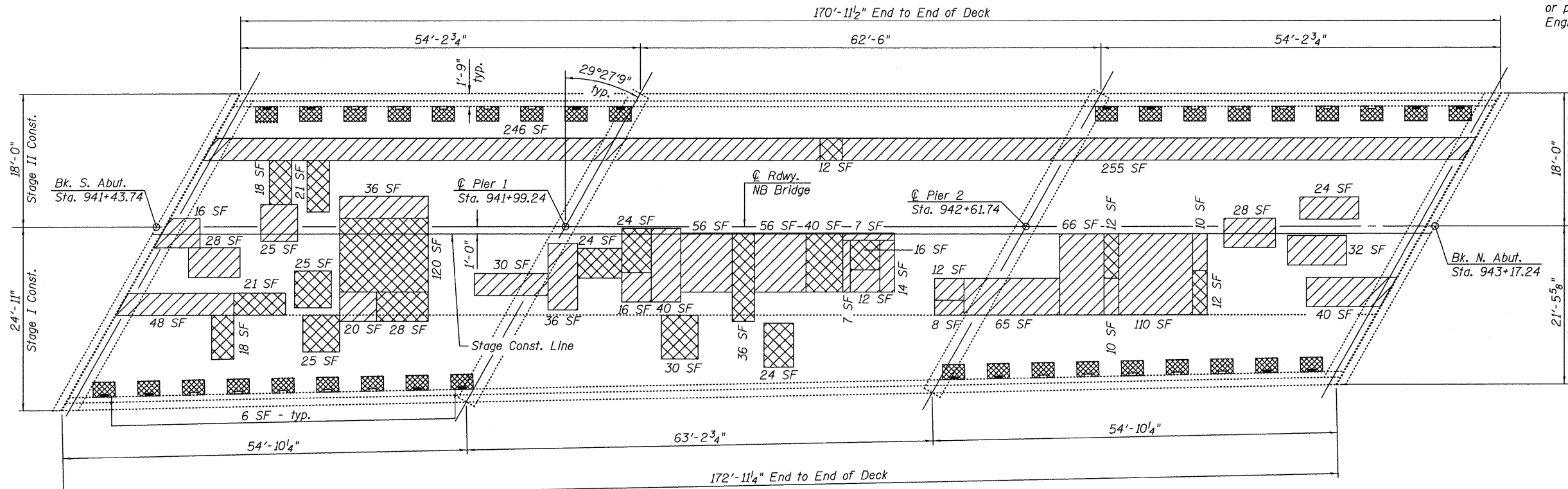

NB BRIDGE - DECK SLAB REPAIR PLAN

LEGEND

- * Deck Slab Repair (Partial) = 222 SY
- Deck Slab Repair (Full Depth, Type II) = 121 SY
- 4" x 12" Drain to be extended (See detail sheet 22 of 23).
- 4" x 12" Drain to be plugged (See detail sheet 22 of 23).

* For information only. Cost to be included with Bridge Deck Hydro-Scarification 1/2".

DESIGNED - CMV
CHECKED - SDS
DRAWN - DLH
CHECKED - CMV

WHKS & CO.
ENGINEERING
7018 KINGSMILL CT.,
SPRINGFIELD, IL
(217) 483-9457
DESIGN FIRM #184001036

DECK SLAB REPAIR PLAN
I-57 OVER ABANDONED RAILROAD
F.A.I. RTE. 57 - SECTION 99-2VB-I-1
WILL COUNTY
STATION 942+54.75
STRUCTURE NO. 099-0038 (NB)
STRUCTURE NO. 099-0039 (SB)

SHEET NO. 5 23 SHEETS	F.A.I. RTE.	SECTION	COUNTY	TOTAL SHEETS	SHEET NO.
	57	99-2VB-I-1	WILL	38	15
C-91-215-10			CONTRACT NO. 60J25		
ILLINOIS FED. AID PROJECT					