







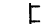

LEGEND

-  WORK AREA
-  IMPACT ATTENUATORS, TEMPORARY
-  TYPE III BARRICADE
-  TEMPORARY CONCRETE BARRIER
-  DRUM WITH STEADY BURN MONODIRECTIONAL LIGHT/
DIRECTION INDICATOR BARRICADE WITH STEADY BURN
MONODIRECTIONAL LIGHT (PER HWY. STD. 701321-10)
-  SIGN
-  DETECTOR LOOPS
-  TRAFFIC SIGNAL

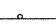

- STAGE II CONSTRUCTION:**
1. CLOSE NORTH HALF OF FLOSSMOOR ROAD IN ACCORDANCE WITH HIGHWAY STANDARD 701321 AND AS SHOWN IN THE PLANS.
 2. PERFORM NORTH HALF STRUCTURAL AND APPROACH ROADWAY REPAIRS AS SHOWN IN THE PLANS.
 3. APPLY PERMANENT PAVEMENT MARKINGS AND RAISED REFLECTIVE PAVEMENT MARKERS UNDER HIGHWAY STANDARD 701311.

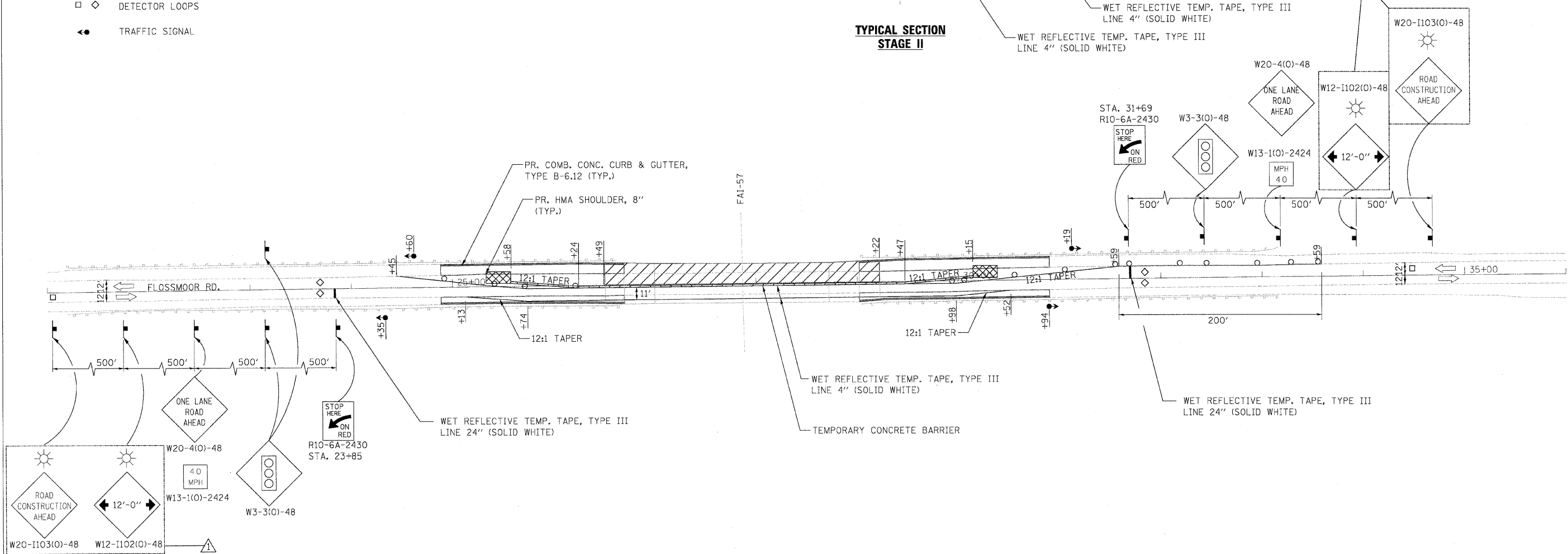
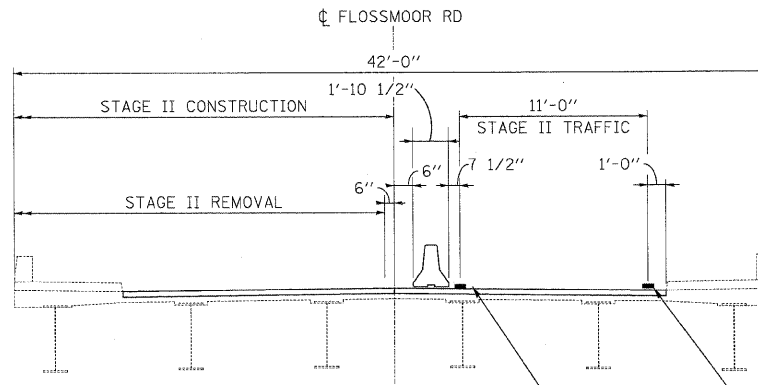
NOTE:

1. FIRST TWO WARNING SIGNS IN EACH DIRECTION REQUIRE MONO-DIRECTIONAL FLASHING BEACONS.

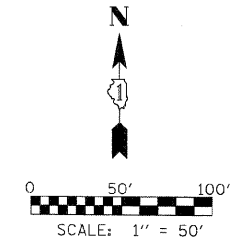

FILE NAME =	USER NAME = #USER#	DESIGNED - SEW	REVISED -	STATE OF ILLINOIS DEPARTMENT OF TRANSPORTATION	MAINTENANCE OF TRAFFIC-STAGE 2 FLOSSMOOR ROAD OVER I-57	F.A.I. RTE. 57	SECTION 0607-1007 HB-I	COUNTY COOK	TOTAL SHEETS 29	SHEET NO. 6	
*FILE#		DRAWN - SEW	REVISED -		SCALE: 1"=50'	SHEET NO. OF SHEETS	STA.	TO STA.	CONTRACT NO. 60J26		
		CHECKED - FML	REVISED -						ILLINOIS FED. AID PROJECT		
		DATE - 12/2009	REVISED -								