

STATE OF ILLINOIS
DEPARTMENT OF TRANSPORTATION

Existing Structure:
Structure No. 016-1099 was built in 1966 as F.A.I. Rte. 57, Section 0607-1007 HB. In 1977, bituminous overlay was placed on the bridge. In 1993, the bituminous surface was replaced with bituminous concrete surface and waterproofing membrane system, and the neoprene expansion joint was replaced with strip seal joint. Existing structure is a two span continuous steel superstructure with a 7" reinforced concrete deck supported by a multi column pier and vaulted abutments, 174'-6" bk. to bk. abutments, 42'-0" out to out deck with no skew. Stage construction shall be utilized to maintain traffic during construction.

SCOPE OF WORK

1. Remove concrete deck and parapet adjacent to expansion joints
2. Remove existing bituminous overlay
3. Apply 1/2" hydro-scarification on deck
4. Repair deck slab
5. Replace concrete deck and parapet adjacent to expansion joints
6. Remove and replace strip seal at expansion joints
7. Apply protective coat to new concrete slab and top and traffic faces of new parapet
8. Place 2 1/4" latex concrete overlay
9. Patch and overlay approaches
10. Apply protective coat and bridge deck grooving to top of overlay
11. Provide preformed joint strip seal expansion joints at abutments
12. Clean and reseal relief joints
13. Repair deteriorated concrete on abutments
14. Jack and remove existing abutment bearings and replace with elastomeric bearings.
15. Install permanent protective shield.
16. Apply Concrete Sealer to existing top and inside vertical faces of sidewalks and parapets.

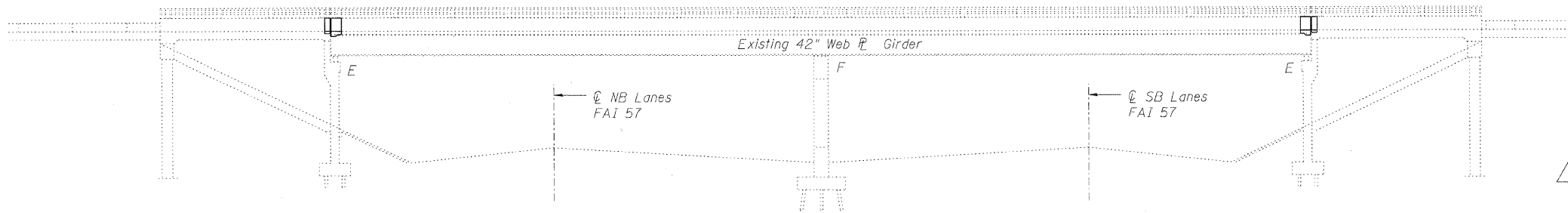

ELEVATION

INDEX OF SHEETS

1. General Plan and Elevation
2. General Notes and Details
3. Temporary Concrete Barrier for Stage Construction
4. Deck Slab Repair
- 4A. Protective Shield Details
5. Expansion Joint Concrete Removal
6. Expansion Joint Concrete Details
7. Bearing Details
8. Abutment Repair
9. Preformed Joint Strip Seal
10. Bar Splicer Assembly and Mechanical Splicer Details

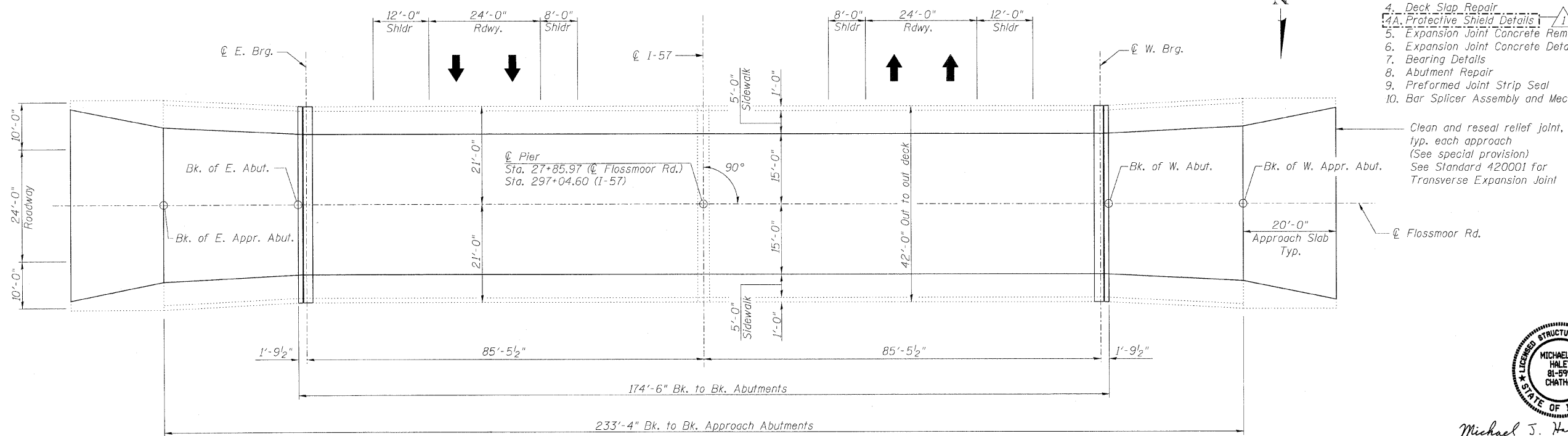

PLAN

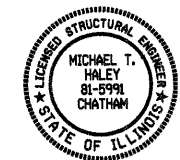

Michael J. Haley 1/27/10
Michael T. Haley Date
Licensed Structural Engineer
State of Illinois No. 81-5991
Expires 11/30/2010

DESIGN SPECIFICATIONS

(New Construction)
2002 AASHTO "Standard Specifications for Highway Bridges"

LOADING HS 20-44

(Original Construction)

DESIGN STRESSES

FIELD UNITS

Existing Construction
f_c = 1,400 psi (Substructure & Superstructure)
f_s = 20,000 psi (Reinforcement)
f_s = 20,000 psi (Structural Steel)

New Construction
f_c = 3,500 psi
f_y = 60,000 psi (Reinforcement)
f_y = 36,000 psi (Structural Steel) (M270 Gr. 36)

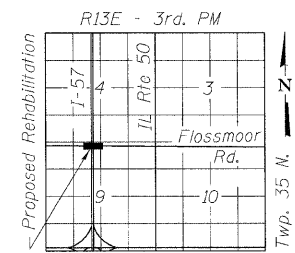

LOCATION SKETCH

**GENERAL PLAN AND ELEVATION
FLOSSMOOR RD. OVER F.A.I. RTE 57
F.A.I. RTE 57 - SECTION 0607-1007 HB-I
COOK COUNTY
STATION 297+04.60
STRUCTURE NO. 016-1099**

LIN ENGINEERING, LTD. Consulting Engineers Chatham, Illinois <small>Designed By: YMK Checked By: MTH Drawn By: YMK Date: 1/2010 File: 08-K099.dgn</small>	SHEET NO. 1	F.A.I. RTE. 57	SECTION 0607-1007 HB-I	COUNTY COOK	TOTAL SHEETS 29	SHEET NO. 8
	10 SHEETS	CONTRACT NO. 60J26				
FED. ROAD DIST. NO. - ILLINOIS FED. AID PROJECT						