

QUANTITY
 4 (100) LINE = 64.1 ft. (19.7 m)
 21.1 sq. ft. (1.97 sq. m)

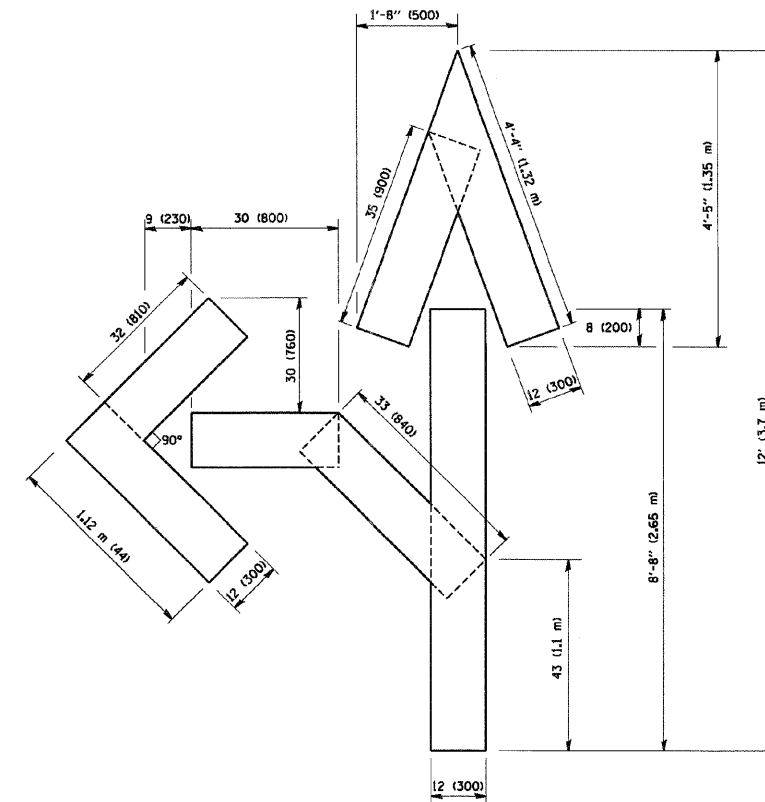

QUANTITY
 4 (100) LINE = 82.5 ft. (25.3 m)
 27.5 sq. ft. (2.53 sq. m)

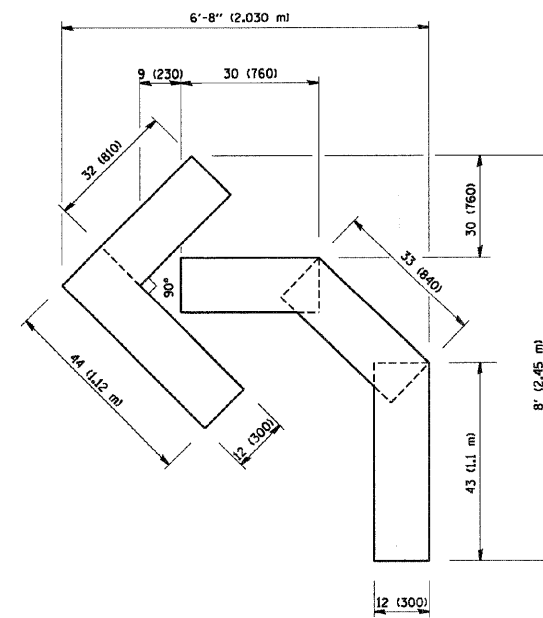

QUANTITY
 4 (100) LINE = 45.5 ft. (13.9 m)
 15.2 sq. ft. (1.39 sq. m)

All dimensions are in inches (millimeters) unless otherwise shown.

PAVEMENT MARKING LETTERS AND SYMBOLS FOR TRAFFIC STAGING

FILE NAME =	USER NAME = #USER*	DESIGNED -	REVISED -	STATE OF ILLINOIS DEPARTMENT OF TRANSPORTATION	DISTRICT STANDARDS FLOSSMOOR ROAD OVER I-57			F.A.I. RTE.	SECTION	COUNTY	TOTAL SHEETS	SHEET NO.			
#FILEL#		DRAWN -	REVISED -		SCALE: NONE	SHEET NO.	OF	SHEETS	STA.	TO STA.	57	0607-1007 HB-1	COOK	29	26
		PLOT SCALE = #SCALE*	REVISED -								TC-16	CONTRACT NO. 60J26			
		PLOT DATE = #DATE*	REVISED -								FED. ROAD DIST. NO.	ILLINOIS FED. AID PROJECT			