

WESTBOUND I-94 EXIT
TO WESTBOUND WILLOW ROAD DETOUR
FOR MOT STAGE 2

NOTES

1. CHANGEABLE MESSAGE SIGNS ARE TO BE PLACED TWO (2) WEEKS PRIOR TO THE START OF THE DETOUR. CHANGEABLE MESSAGE SIGNS TO BE PAID FOR SEPARATELY - NOT COVERED UNDER THE COST OF THE DETOUR.
2. ANY EXISTING SIGNS THAT CONTRADICT THE DETOUR SIGNAGE AS SHOWN ON THE PLANS SHALL BE COVERED PRIOR TO THE OPENING OF THE DETOUR ROUTE, INCIDENTAL TO THE PAY ITEM, "TRAFFIC CONTROL AND PROTECTION". COVERS SHALL BE REMOVED AT THE TIME THE DETOUR SIGNS ARE REMOVED.
3. ALL SIGNAGE SHALL BE IN ACCORDANCE WITH THE APPLICABLE PROVISIONS OF THE STATE OF ILLINOIS "STANDARD SPECIFICATIONS FOR ROAD AND BRIDGE CONSTRUCTION ADOPTED JANUARY 1, 2007". "THE QUALITY STANDARD FOR WORK ZONE TRAFFIC CONTROL DEVICES REVISED 6/8/05", THE DETAILS OF THESE PLANS, THE "2009 MANUAL OF UNIFORM TRAFFIC CONTROL DEVICES" AND THE SPECIAL PROVISIONS FOR "TRAFFIC CONTROL AND PROTECTION FOR TEMPORARY DETOUR".
4. IF DEEMED NECESSARY BY THE ENGINEER, A PRE-CONSTRUCTION MEETING WITH THE CONTRACTOR SHALL BE HELD AT LEAST TWO WEEKS PRIOR TO THE DAY THE DETOUR IS TO BE IN EFFECT. THE ROAD SHALL NOT BE CLOSED UNTIL ALL DETOUR SIGNAGE IS IN PLACE.
5. THE SIGNAGE AS SHOWN ON THE PLANS IS DEEMED TO BE THE MINIMUM REQUIRED. THE CONTRACTOR SHALL MAKE ALL CHANGES DEEMED NECESSARY BY THE ENGINEER. ADDITIONS AND DELETIONS OF TRAFFIC CONTROL FOR THIS DETOUR SHALL BE CONSIDERED INCLUDED IN "TRAFFIC CONTROL AND PROTECTION FOR TEMPORARY DETOUR".
6. ALL DETOUR SIGNS SHALL BE REMOVED ONCE CONSTRUCTION IS COMPLETE AND AREA IS REOPENED TO THRU TRAFFIC.
7. ALL SIGNS SHOWN SHALL BE FURNISHED, ERECTED, AND MAINTAINED BY THE CONTRACTOR.

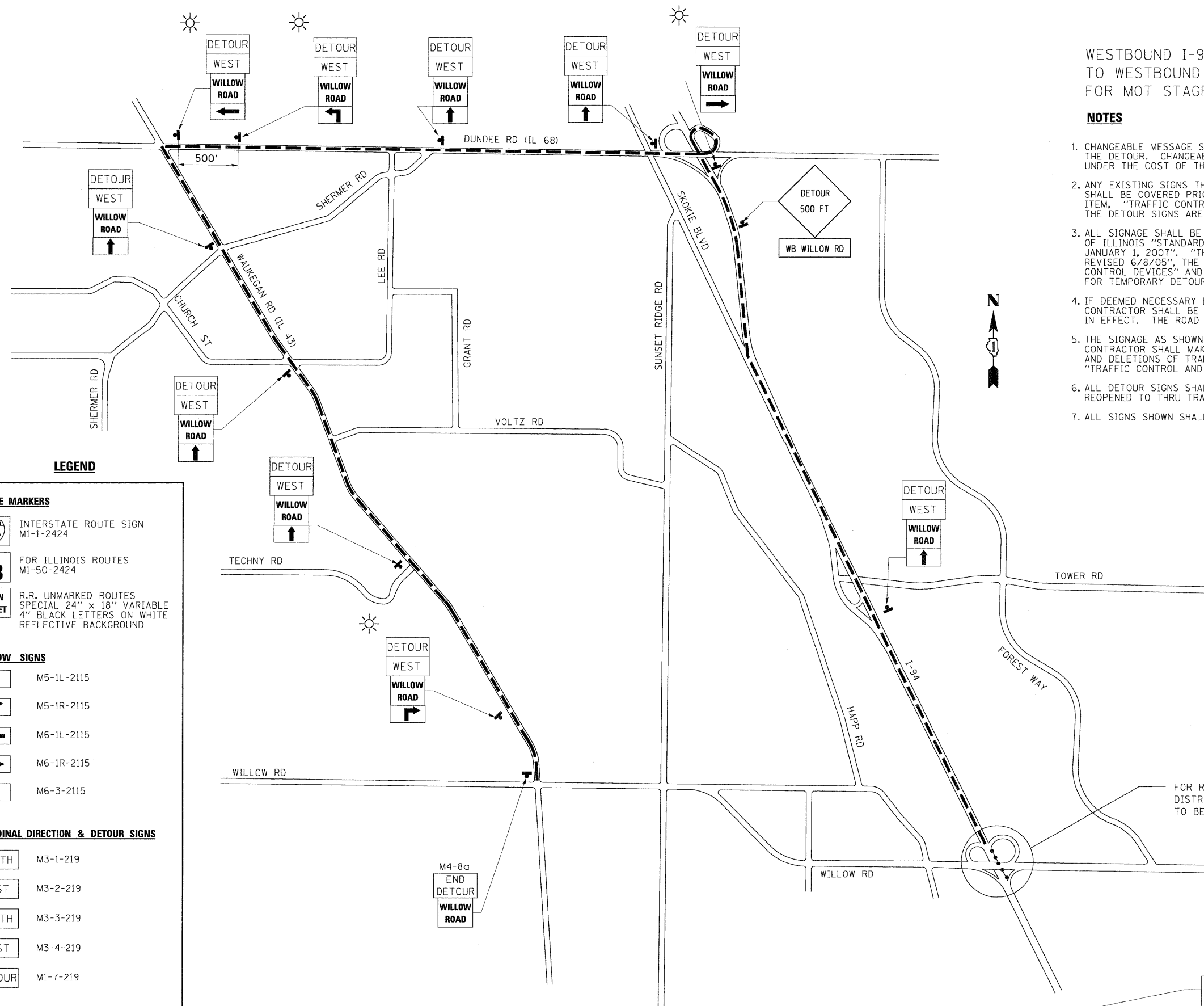

LEGEND

ROUTE MARKERS

INTERSTATE ROUTE SIGN
M1-1-2424

FOR ILLINOIS ROUTES
M1-50-2424

MAIN STREET
R.R. UNMARKED ROUTES
SPECIAL 24" x 18" VARIABLE
4" BLACK LETTERS ON WHITE
REFLECTIVE BACKGROUND

ARROW SIGNS

M5-1L-2115

M5-1R-2115

M6-1L-2115

M6-1R-2115

M6-3-2115

CARDINAL DIRECTION & DETOUR SIGNS

NORTH M3-1-219

EAST M3-2-219

SOUTH M3-3-219

WEST M3-4-219

DETOUR M1-7-219

FOR RAMP CLOSURE DETAILS SEE
DISTRICT 1 STANDARD TC-8.
TO BE PAID FOR AS "TRAFFIC CONTROL AND PROTECTION (EXPRESSWAYS)".

DENOTES WITH AMBER FLASHING LIGHT
* * CHANGEABLE MESSAGE SIGN
SEE NOTE 1.

* *