

STATE OF ILLINOIS
DEPARTMENT OF TRANSPORTATION
DIVISION OF HIGHWAYS

**PROPOSED
HIGHWAY PLANS**

F.A.U. ROUTE 1324/US 14 (Dempster St.) AT CREEK
(0.1 MI. EAST OF I-294)
SECTION 3014-I
PROJECT NO. M-1324(006)
BRIDGE DECK OVERLAY, BRIDGE JOINT REPAIR
COOK COUNTY
JOB NO. C-91-230-10

F.A.U. RTE.	SECTION	COUNTY	TOTAL SHEETS	SHEET NO.
1324	3014-I	COOK	19	1
FED. ROAD DIST. NO. 1		ILLINOIS	CONTRACT NO. 60J40	

D-91-230-10



LOCATION OF SECTION INDICATED THUS: — ■ —

FOR INDEX OF SHEETS, SEE SHEET NO. 2
FOR LIST OF STANDARDS, SEE SHEET NO. 2

IMPROVEMENT LOCATED IN
PARK RIDGE, IL

S.N. 016-1033
ADT = 41,100 (2007)
POSTED SPEED: 35 MPH

IMPROVEMENT BEGINS:
STA. 45 + 64.08

IMPROVEMENT ENDS:
STA. 45 + 98.08

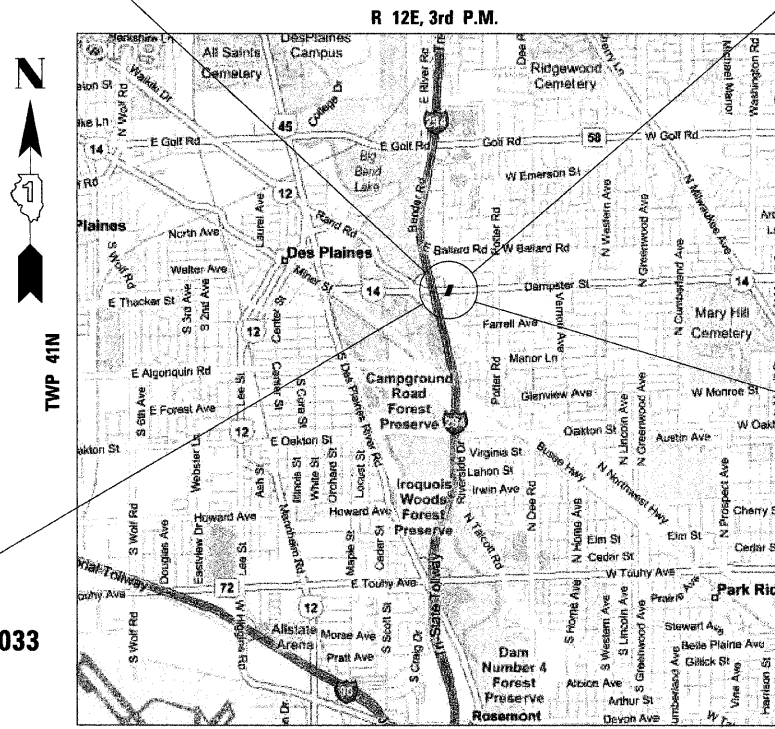

PROJECT LOCATION

US ROUTE 14
(DEMPSTER ST.)
EXISTING S.N. 016-1033

MAINE TOWNSHIP
LOCATION MAP

GRAPHIC SCALES:

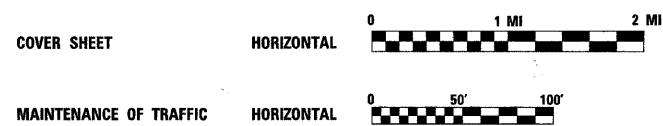

FULL SIZE PLANS HAVE BEEN PREPARED USING STANDARD
ENGINEERING SCALES. REDUCED SIZED PLANS WILL NOT
CONFORM TO STANDARD SCALES. IN MAKING MEASUREMENTS
ON REDUCED PLANS, THE ABOVE SCALES MAY BE USED.

J.U.L.I.E.
JOINT UTILITY LOCATION INFORMATION FOR EXCAVATION
1-800-892-0123
OR 811

PROJECT ENGINEER: MICHELLE A. AQUINO - (847) 705-4606
PROJECT MANAGER: RAJENDRA C. SHAH - (847) 705-4555
CONTRACT NO.: 60J40

GROSS AND NET LENGTH OF IMPROVEMENT = 33 FEET = 0.006 MILE



Fred M. Lin
FRED M. LIN, P.E.
ILLINOIS REGISTERED ENGINEER NO. 062-056704
REGISTRATION EXPIRES NOV. 30, 2011

PREPARED BY:
LIN ENGINEERING, LTD.
CHATHAM, ILLINOIS 62629
(217) 483-4168

STATE OF ILLINOIS
DEPARTMENT OF TRANSPORTATION
DIVISION OF HIGHWAYS

SUBMITTED JANUARY 22, 2010

Diana M. O'Keefe
DEPUTY DIRECTOR OF HIGHWAYS, REGION ENGINEER

March 19 2010

Scott E. Stitt, P.E.
REGISTERED ENGINEER OF DESIGN AND ENVIRONMENT

March 19 2010

Christine M. Reed
DIRECTOR OF HIGHWAYS, CHIEF ENGINEER

PRINTED BY THE AUTHORITY
OF THE STATE OF ILLINOIS