

STATE OF ILLINOIS
DEPARTMENT OF TRANSPORTATION

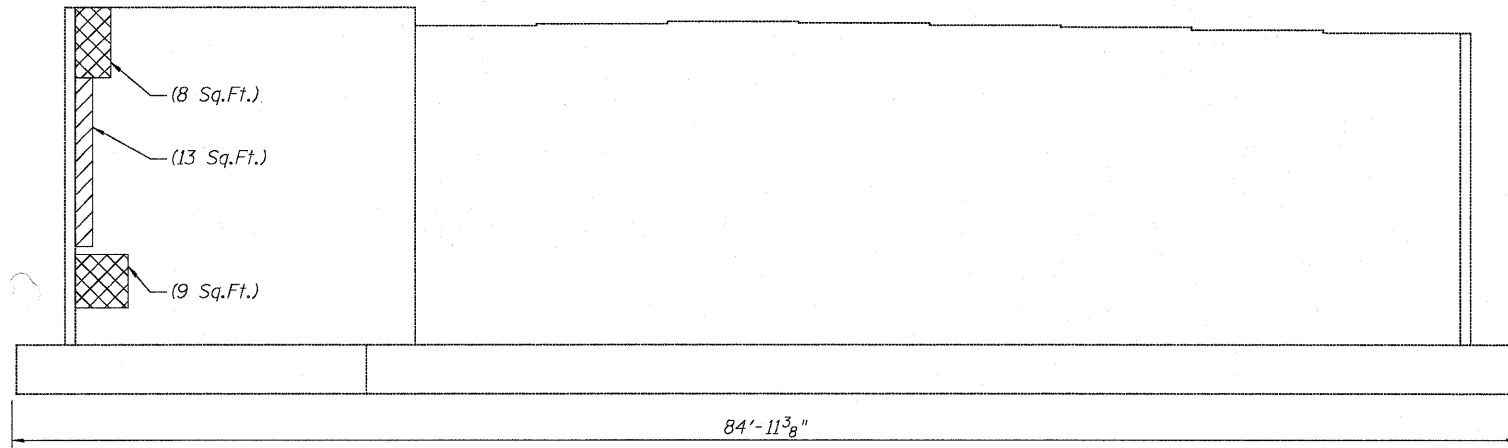

WEST ABUTMENT

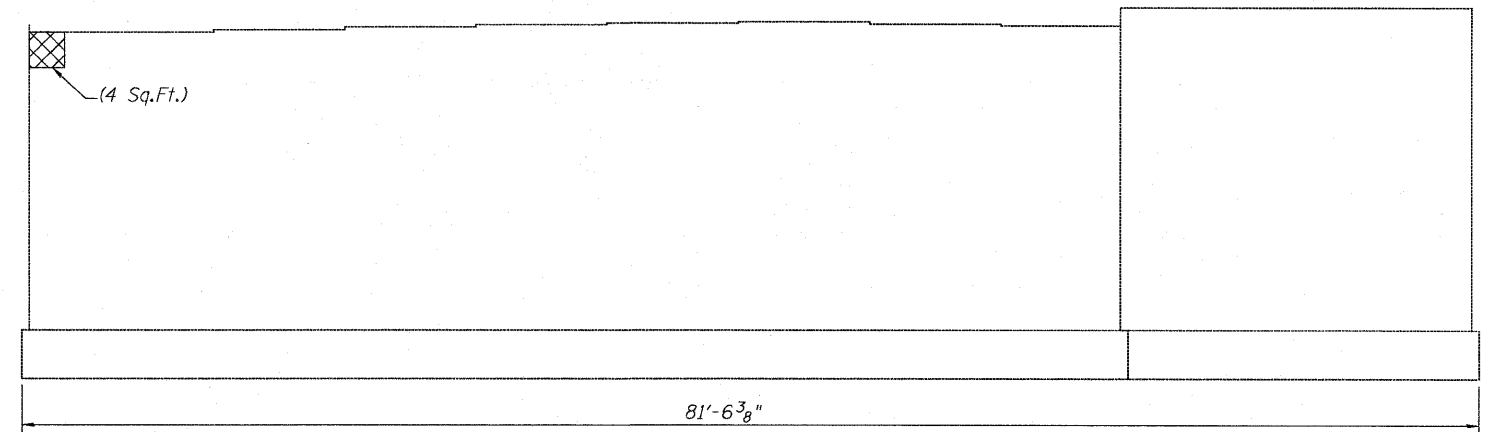

PIER - WEST ELEVATION

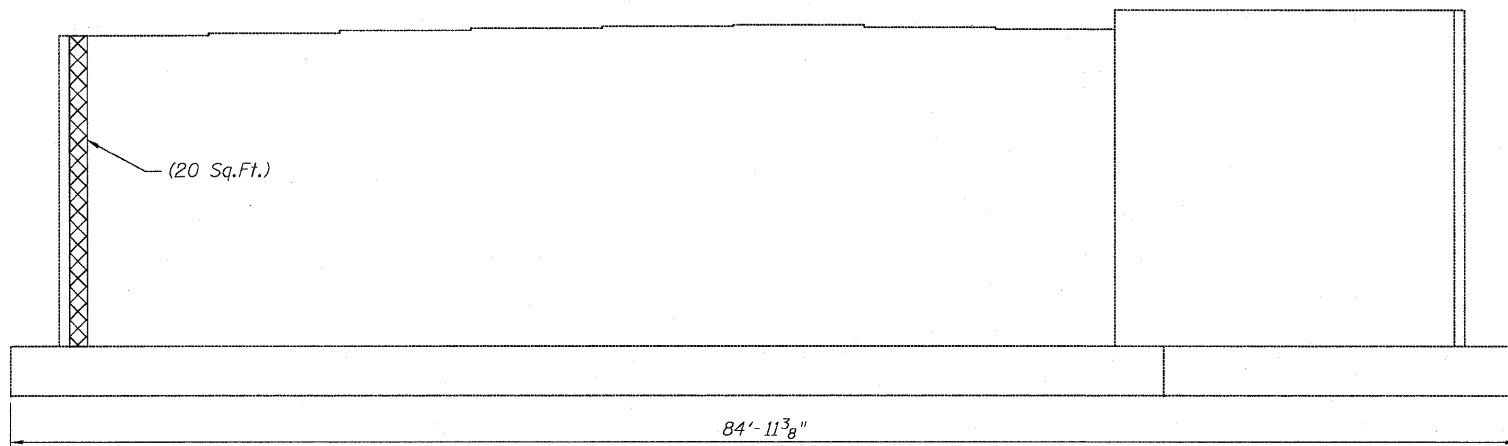

EAST ABUTMENT

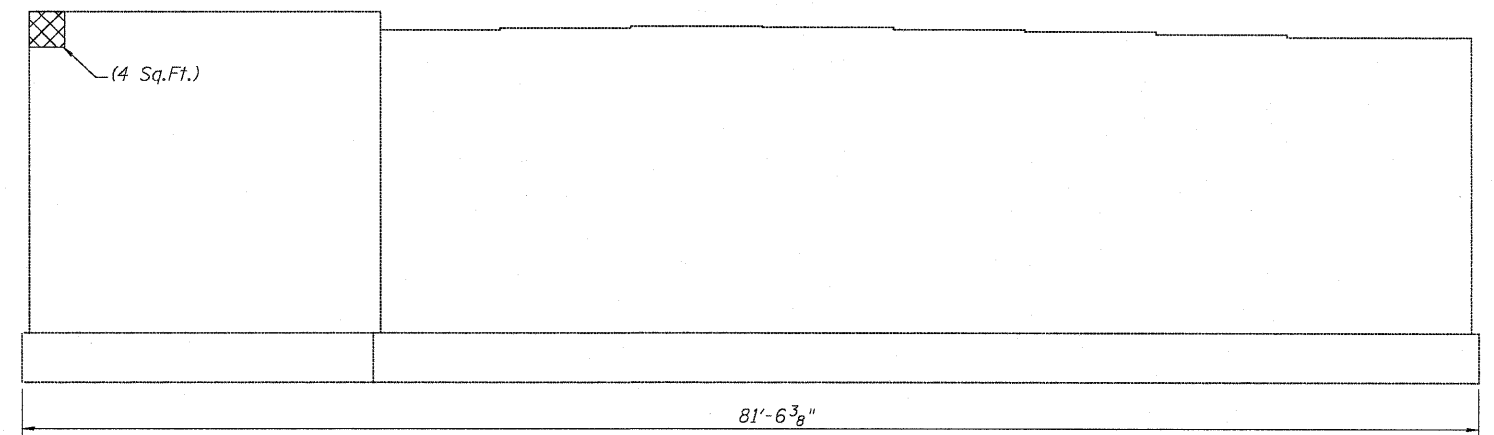



PIER - EAST ELEVATION

BILL OF MATERIAL

ITEM	UNIT	QUANTITY
Structural Repair of Concrete (Depth equal to or less than 5 inches)	Sq. Ft.	13
Structural Repair of Concrete (Depth greater than 5 inches)	Sq. Ft.	45

LEGEND:

-  Structural Repair of Concrete
(Depth equal to or less than 5 inches)
-  Structural Repair of Concrete
(Depth greater than 5 inches)

Note:
Repair of the existing Abutment and Piers shall include
but may not be limited to the areas shown.
The actual areas to be repaired will be determined
by the Engineer at the time of construction.

DESIGNED	JPM
CHECKED	TG
DRAWN	MPS
CHECKED	JPM, TG



180 S. WACKER DRIVE, SUITE 700, CHICAGO, IL 60606, P.312-686-8918 F.312-686-8415

SUBSTRUCTURE REPAIR DETAILS
STRUCTURE NO. 016-0928

SHEET NO. 57	F.A.P. RTE.	SECTION	COUNTY	TOTAL SHEETS	SHEET NO.
	376	2009-1161	COOK	23	14
S11 SHEETS			CONTRACT NO. 60J41		
ILLINOIS FED. AID PROJECT					