

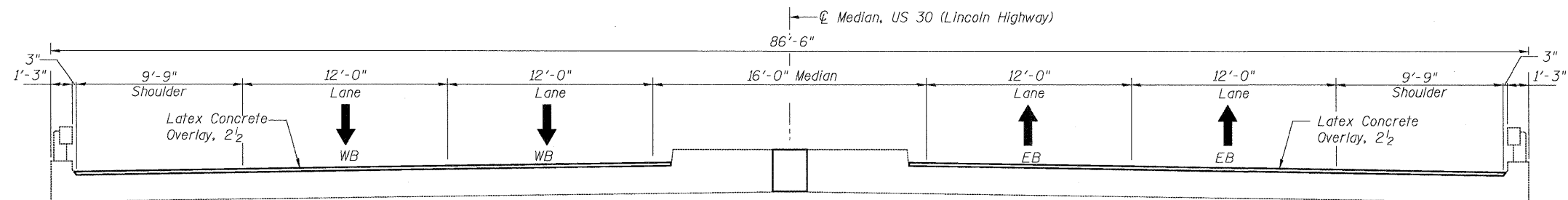

STATE OF ILLINOIS  
DEPARTMENT OF TRANSPORTATION

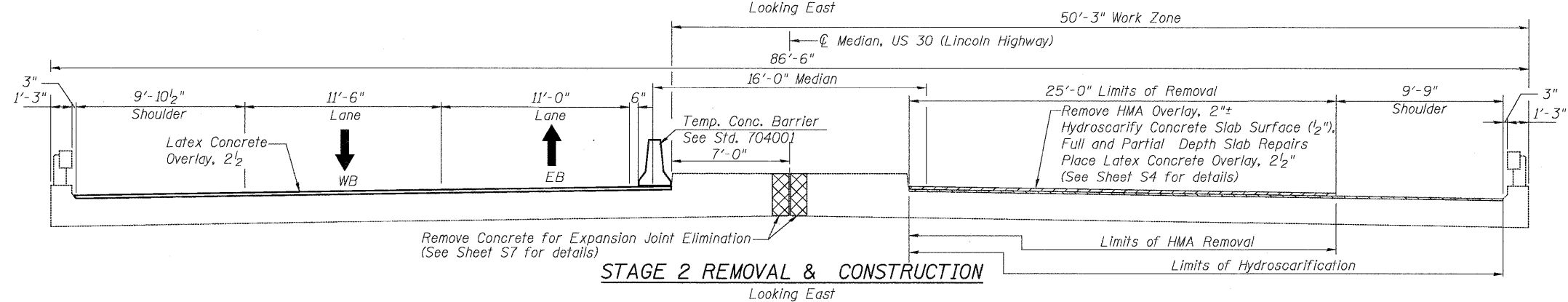
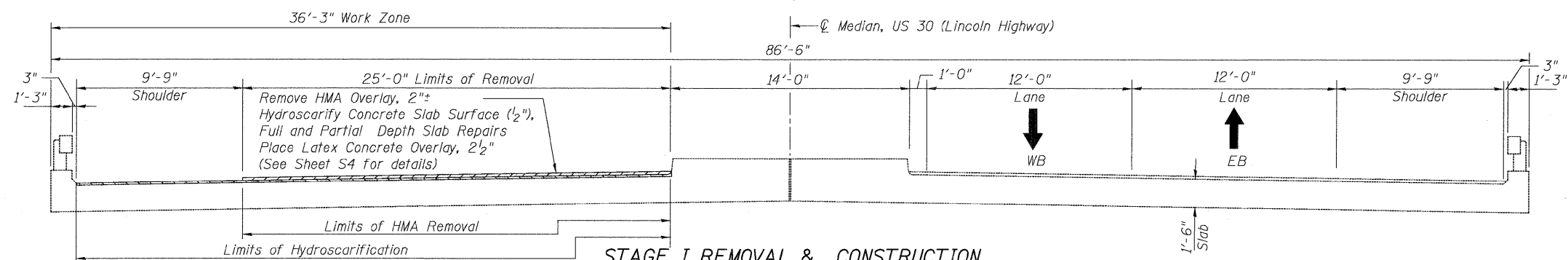
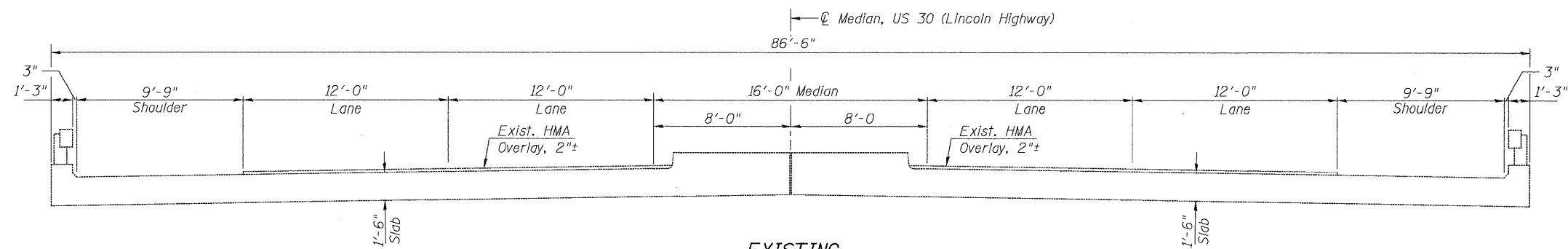
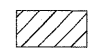
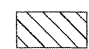

LEGEND:

-  HMA Overlay Removal
-  Bridge Deck Hydro-scarification 1/2"
-  Concrete Removal

STAGE CONSTRUCTION DETAILS  
STRUCTURE NO. 016-0286

DESIGNED	JPM
CHECKED	TG
DRAWN	MPS
CHECKED	JPM, TG



100 S. WACKER DRIVE SUITE 700, CHICAGO IL 60606 . P:312-606-0910 F:312-606-0415

SHEET NO. S2	F.A.P. RTE.	SECTION	COUNTY	TOTAL SHEETS	SHEET NO.
	353	23 R-B-I	COOK	20	10
S7 SHEETS		CONTRACT NO. 60J43			
ILLINOIS FED. AID PROJECT					