

STATE OF ILLINOIS
DEPARTMENT OF TRANSPORTATION

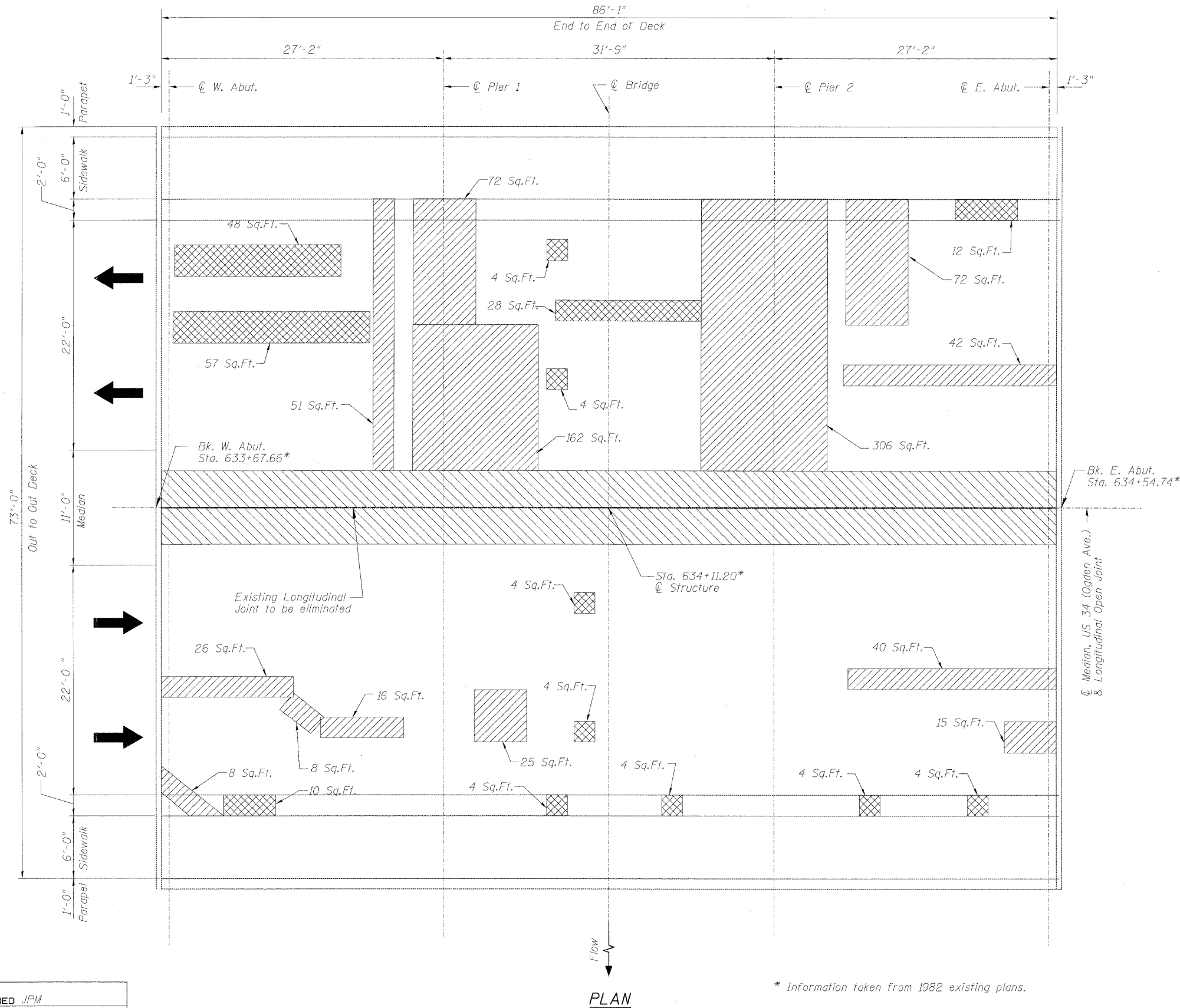

Note:
Repair of the existing bridge deck shall include but may not be limited to the areas shown. The actual areas to be repaired will be determined by the Engineer at the time of construction.

BILL OF MATERIAL

ITEM	UNIT	QUANTITY
Deck Slab Repair (Full Depth, Type I)	Sq. Yd.	4
Deck Slab Repair (Full Depth, Type II)	Sq. Yd.	18
Concrete Removal	Cu. Yd.	44

LEGEND:

- Deck Slab Repair (Partial)
- Deck Slab Repair (Full Depth)
- Concrete Removal

BRIDGE DECK PATCHING PLAN
STRUCTURE NO. 022-0148

* Information taken from 1982 existing plans.

DESIGNED	JPM
CHECKED	TG
DRAWN	MPS
CHECKED	JPM, TG



180 S. WACKER DRIVE SUITE 700, CHICAGO, IL 60606, P.312-686-8918 F.312-686-8415

SHEET NO. 54	F.A.P. RTE.	SECTION	COUNTY	TOTAL SHEETS	SHEET NO.
	311	10 B-I	DUPAGE	20	12
57 SHEETS			CONTRACT NO. 60J45		
ILLINOIS FED. AID PROJECT					