

STATE OF ILLINOIS
DEPARTMENT OF TRANSPORTATION

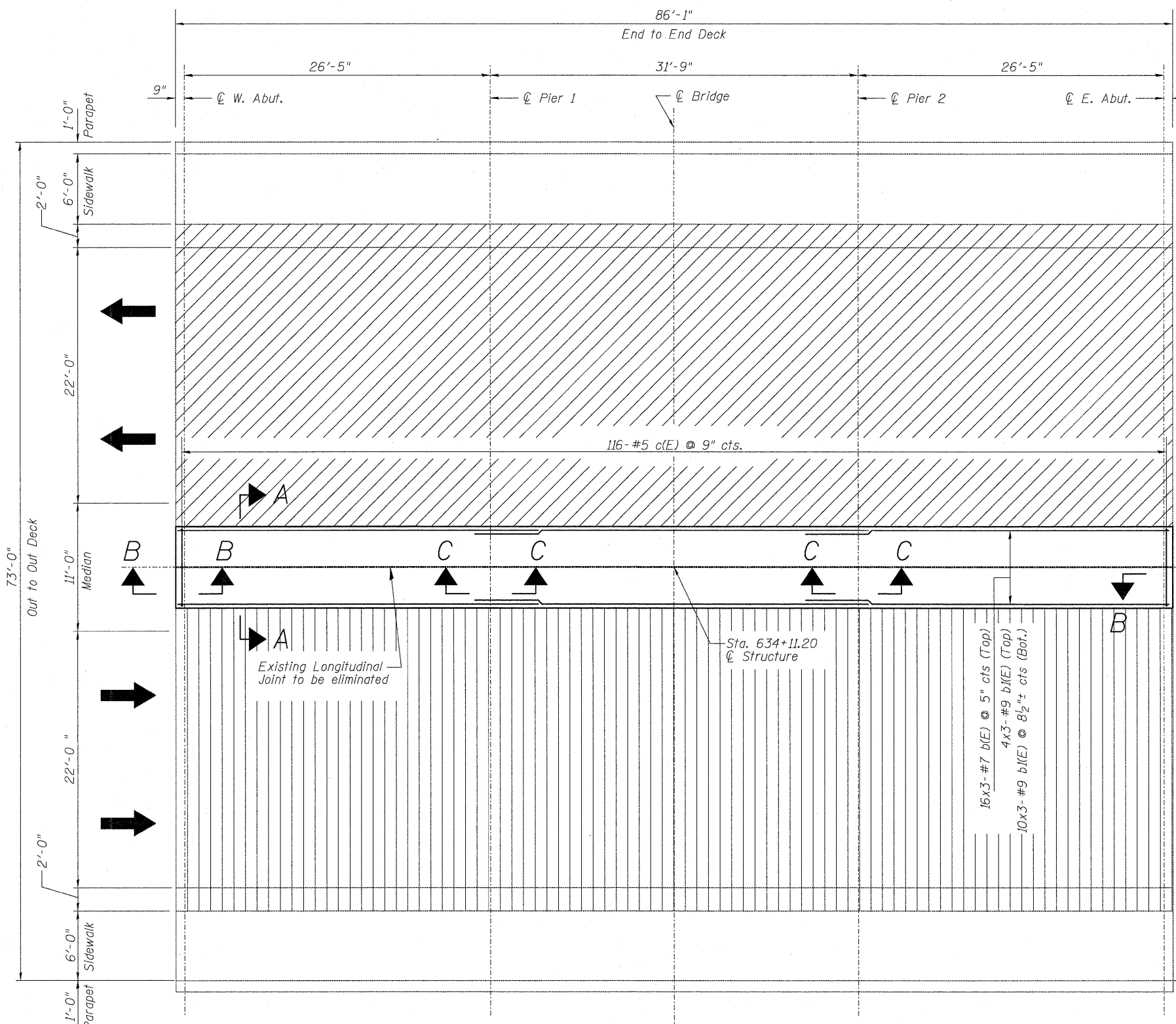

MINIMUM BAR LAP

#7 bars = 3'-5"
#9 bars = 5'-9"

PLAN

Note:
See Sheet S5 for Section B-B
and Section C-C Details.

LEGEND:

- Bridge Deck Hydro-Scarification 3"[±]
- Concrete Removal
- Bridge Deck Hydro-Scarification 3"₈

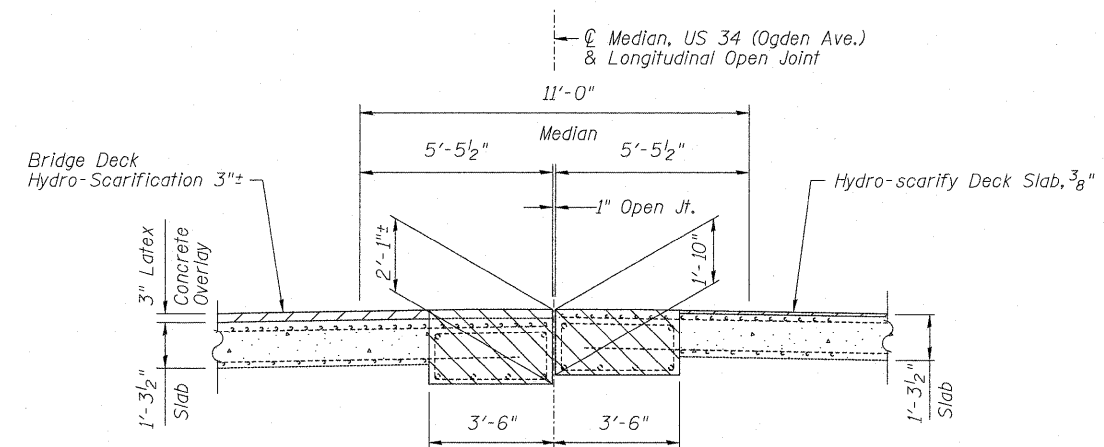

SECTION A-A
EXISTING

Note:
Any reinforcement bars that are damaged during concrete removal operations shall be repaired or replaced using an approved bar splicer or anchorage system. Cost included with "Concrete Removal".

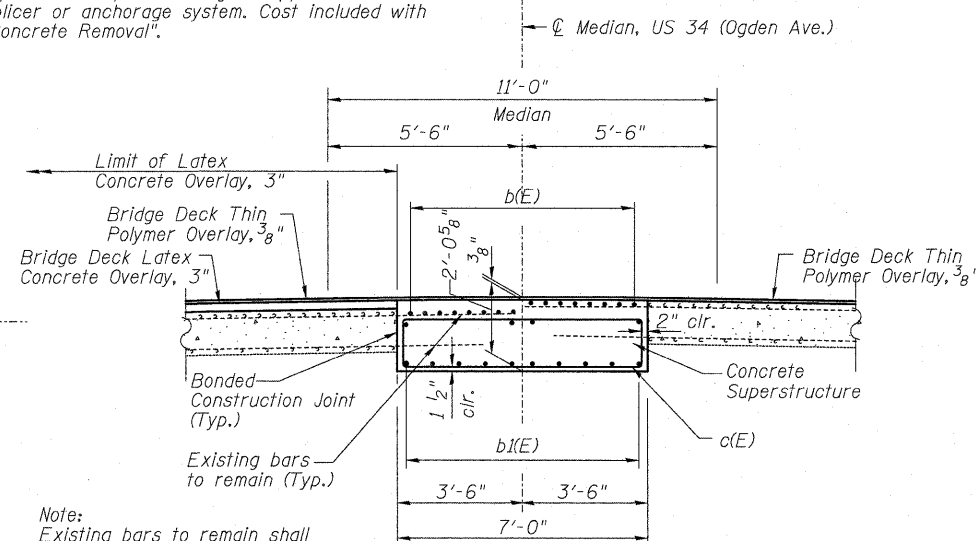

SECTION A-A
PROPOSED

Note:
Existing bars to remain shall be cleaned, straightened and incorporated into new concrete.

BAR LIST

Bar	No.	Size	Length	Shape
b(E)	48	#7	31'-0"	—
b1(E)	42	#9	32'-6"	—
c(E)	116	#5	17'-1"	□

BILL OF MATERIAL

ITEM	UNIT	QUANTITY
Bridge Deck Hydro-scarification 3" ₈	Sq. Yd.	249
Bridge Deck Hydro-Scarification 3"	Sq. Yd.	249
Reinforcement Bar, Epoxy Coated	Pound	9,750
Concrete Superstructure	Cu. Yd.	46
Bridge Deck Thin Polymer Overlay 3" ₈	Sq. Yd.	565
Bridge Deck Latex Concrete Overlay 3"	Sq. Yd.	250

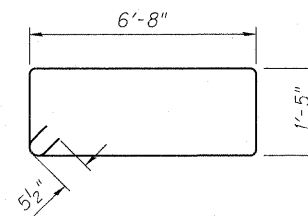

Note:
Bars indicated thus 4x3-#9 etc.
indicates 4 lines of bars with
3 lengths per line.

DECK PLAN & MEDIAN
RECONSTRUCTION DETAILS
STRUCTURE NO. 022-0148

DESIGNED	JPM
CHECKED	TG
DRAWN	MPS
CHECKED	JPM, TG



180 S. WACKER DRIVE, SUITE 700, CHICAGO, IL 60606, P.312-686-8918 F.312-686-8415

SHEET NO. S7	F.A.P. RTE.	SECTION	COUNTY	TOTAL SHEETS	SHEET NO.
	311	10 B-I	DUPAGE	20	15
S7 SHEETS			CONTRACT NO. 60J45		
ILLINOIS FED. AID PROJECT					