

F.A.P. RTE.	SECTION	COUNTY	TOTAL SHEETS	SHEET NO.
360	49 B-1	KANE	18	1
FED. ROAD DIST. NO.		ILLINOIS	CONTRACT NO. 60J47	

D-91-237-10

STATE OF ILLINOIS  
DEPARTMENT OF TRANSPORTATION  
DIVISION OF HIGHWAYS

**PLANS FOR PROPOSED  
FEDERAL AID HIGHWAY**

(F.A.P. ROUTE 360) IL ROUTE 25  
OVER POPLAR CREEK (0.4 MI SOUTH OF US 20)

SECTION: 49 B-1  
KANE COUNTY PROJECT: F-0360(013)

C-91-237-10  
BRIDGE REHABILITATION PROJECT  
SN 045-5000



LOCATION OF SECTION INDICATED THUS: - [black rectangle] -

PROJECT LOCATED ADJACENT TO THE  
CITY OF BARTLETT, IN THE CITY OF ELGIN

FOR INDEX OF SHEETS, SEE SHEET NO. 2

DESIGN DESIGNATION  
MINOR ARTERIAL

ADT 13000 (2000)  
POSTED SPEED LIMIT 35 MPH

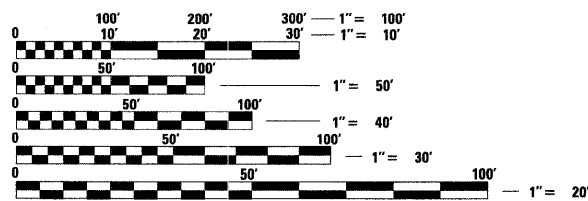

FULL SIZE PLANS HAVE BEEN PREPARED USING STANDARD  
ENGINEERING SCALES. REDUCED SIZED PLANS WILL NOT  
CONFORM TO STANDARD SCALES. IN MAKING MEASUREMENTS  
ON REDUCED PLANS, THE ABOVE SCALES MAY BE USED.

J.U.L.I.E.  
JOINT UTILITY LOCATION INFORMATION FOR EXCAVATION  
1-800-892-0123  
OR 811

PROJECT MANAGER: KIM HARVEY (847) 705-4055  
PROJECT ENGINEER: ERSKINE W. KLYCE (847) 705-4594

CONTRACT NO. 60J47

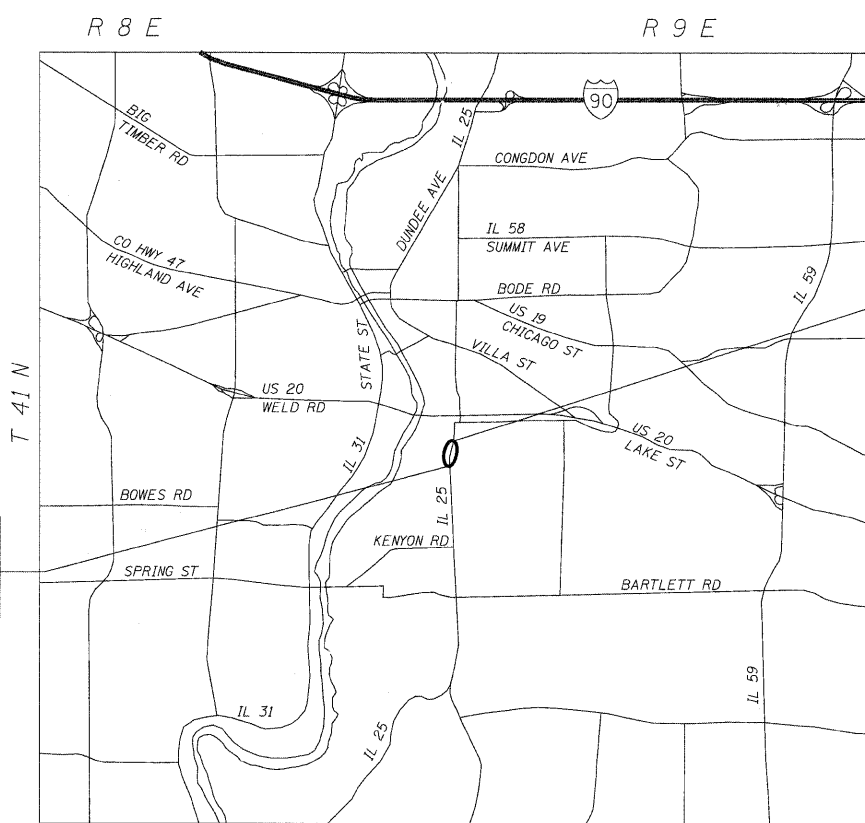

PROJECT BEGINS  
STA. 365+14.15

PROJECT ENDS  
STA. 365+68.01

ELGIN TOWNSHIP  
LOCATION MAP

NET AND GROSS LENGTH OF PROJECT = 53.86' = 0.010 MI

STATE OF ILLINOIS  
DEPARTMENT OF TRANSPORTATION  
DIVISION OF HIGHWAYS

SUBMITTED JANUARY 28 2010

*Diana M. O'Keefe*  
DEPUTY DIRECTOR OF HIGHWAYS, REGION ENGINEER

March 19, 2010  
*Scott E. Stitt, P.E.*  
Acting ENGINEER OF DESIGN AND ENVIRONMENT

March 19, 2010  
*Christie M. Reed*  
DIRECTOR OF HIGHWAYS, CHIEF ENGINEER

PRINTED BY THE AUTHORITY  
OF THE STATE OF ILLINOIS

LOWCO, INC.  
CONSULTING ENGINEERS  
1560 WALL ST., SUITE 222  
NAPERVILLE, ILLINOIS 60563 PH: (630) 577-9100

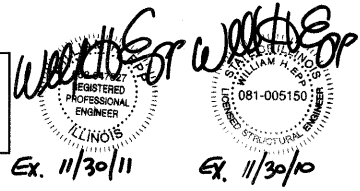

<u>SHEET NO.</u>	<u>TITLE</u>
1	TITLE SHEET
2	GENERAL NOTES, STATE STANDARDS AND INDEX OF SHEETS
3	SUMMARY OF QUANTITIES
4	TYPICAL SECTIONS
5	STAGING TYPICAL SECTIONS
6	CONSTRUCTION STAGING PLAN - STAGE 1
7	CONSTRUCTION STAGING PLAN - STAGE 2
8	CONSTRUCTION STAGING PLAN - STAGE 3
9	PAVEMENT MARKING PLAN
10-13	STRUCTURAL PLANS
14	RAISED REFLECTIVE PAVEMENT MARKERS (SNOW-PLOW RESISTANT)
15	DISTRICT ONE TYPICAL PAVEMENT MARKINGS
16	PAVEMENT MARKING AND SYMBOLS FOR TRAFFIC STAGING
17	SIGNING FOR FLAGGING OPERATIONS AT WORK ZONE OPENINGS
18	ARTERIAL ROAD INFORMATION SIGN
	HIGHWAY STANDARDS

STATE STANDARDS

<u>SHEET NO.</u>	<u>TITLE</u>
000001-05	STANDARD SYMBOLS, ABBREVIATIONS AND PATTERNS
701606-06	URBAN LANE CLOSURE, MULTILANE, 2W WITH MOUNTABLE MEDIAN
701901-01	TRAFFIC CONTROL DEVICES
704001-06	TEMPORARY CONCRETE BARRIER

GENERAL NOTES

ALL ELEVATIONS ARE BASED ON UNITED STATES COAST AND GEODETIC SURVEY DATUM.

DIMENSIONS ARE IN ENGLISH UNITS UNLESS OTHERWISE NOTED.

BEFORE STARTING ANY EXCAVATION, THE CONTRACTOR SHALL CALL "JULIE" AT 800-892-0123 FOR FIELD LOCATIONS OF BURIED ELECTRIC, TELEPHONE, AND GAS FACILITIES (48 HOURS NOTIFICATION IS REQUIRED).

THE CONTRACTOR WILL NOT BE ALLOWED TO SET UP A YARD OR FIELD OFFICE ON STATE PROPERTY WITHOUT WRITTEN PERMISSION FROM THE DEPARTMENT.

IT SHALL BE THE CONTRACTOR'S RESPONSIBILITY TO VERIFY ALL DIMENSIONS AND CONDITIONS EXISTING IN THE FIELD PRIOR TO CONSTRUCTION AND ORDERING MATERIALS.

ANY REFERENCE TO STANDARDS IN THE PLANS OR SPECIAL PROVISIONS SHALL BE INTERPRETED TO BE THE LATEST STANDARDS OF THE DEPARTMENT LISTED IN THE PLANS WITH THE LATEST NUMBERS.

WHEN ARTIFICIAL LIGHTING IS UTILIZED IN NIGHT OPERATIONS, THE CONTRACTOR SHALL EXERCISE THE UTMOST PRECAUTIONS IN PREVENTING ADVERSE VISIBILITY TO THE MOTORING PUBLIC AND ADJOINING PROPERTIES.

THE RESIDENT ENGINEER SHALL CONTACT MR. DON CHIARUGI, AREA TRAFFIC ENGINEER, AT (847) 741-9857 AT A MINIMUM OF 2 WEEKS PRIOR TO THE PLACEMENT OF PERMANENT PAVEMENT MARKING.

THE RESIDENT ENGINEER SHALL CONTACT THE TRAFFIC CONTROL SUPERVISOR AT (847) 705-4470 A MINIMUM OF 72 HOURS PRIOR TO THE PLACEMENT OF ANY TEMPORARY TRAFFIC CONTROL DEVICES.

ALL WORK IS TO BE COMPLETED WITHIN 15 WORKING DAYS.

BEFORE BEGINNING ANY WORK, THE CONTRACTOR SHALL RETAIN AND RECORDED FOR FUTURE REFERENCE, ALL EXISTING PAVEMENT MARKING LINES (AND RAISED REFLECTIVE MARKERS) IN ORDER THAT THESE LOCATIONS CAN BE RE-ESTABLISHED FOR STRIPING. EXACT LOCATIONS OF ALL PAVEMENT MARKINGS SHALL BE DIRECTED BY THE ENGINEER.



DESIGNED - MJY	REVISED -
DRAWN - ST, TSC	REVISED -
CHECKED - MJY, DC	REVISED -
DATE - 1/29/2010	REVISED -

**STATE OF ILLINOIS  
DEPARTMENT OF TRANSPORTATION**

**GENERAL NOTES, STATE STANDARDS AND INDEX OF SHEETS  
IL ROUTE 25 OVER POPLAR CREEK**

SCALE: NONE | SHEET NO. 2 OF 18 SHEETS | STA. 365+14.15 TO STA. 365+68.01

F.A.P. RTE.	SECTION	COUNTY	TOTAL SHEETS	SHEET NO.
360	49 B-1	KANE	18	2
D-91-237-10		CONTRACT NO. 60J47		
FED. ROAD DIST. NO.		[ILLINOIS] FED. AID PROJECT		

SUMMARY OF QUANTITIES			80% FED. 20% STATE			SUMMARY OF QUANTITIES			80% FED. 20% STATE		
CODE NO.	ITEM	UNIT	URBAN TOTAL	ROADWAY 1000	BRIDGE X020-2A	CODE NO.	ITEM	UNIT	URBAN TOTAL	ROADWAY 1000	BRIDGE X020-2A
28100807	STONE DUMPED RIPRAP, CLASS A4	TON	50		50	X0322944	BRIDGE DECK THIN POLYMER OVERLAY 3/8"	SQ YD	284		284
28200200	FILTER FABRIC	SQ YD	60		60	X0325775	WET REFLECTIVE TEMPORARY TAPE, TYPE III, 4 INCH	FOOT	7110	7110	
50300300	PROTECTIVE COAT	SQ YD	362		362	X0325841	WET REFLECTIVE TEMPORARY TAPE, TYPE III, 24 INCH	FOOT	144	144	
67000400	ENGINEER'S FIELD OFFICE, TYPE A	CAL MO	3	3		X0325842	WET REFLECTIVE TEMPORARY TAPE, TYPE III, LETTERS AND SYMBOLS	SQ FT	368	368	
67100100	MOBILIZATION	L SUM	1	1		Z0013798	CONSTRUCTION LAYOUT	L SUM	1	1	
70101800	TRAFFIC CONTROL AND PROTECTION, (SPECIAL)	L SUM	1	1		Z0030240	IMPACT ATTENUATORS, TEMPORARY (NON-REDIRECTIVE), TEST LEVEL 2	EACH	2	2	
70103815	TRAFFIC CONTROL SURVEILLANCE	CAL DA	6	6		Z0030340	IMPACT ATTENUATORS, RELOCATE (NON-REDIRECTIVE), TEST LEVEL 2	EACH	4	4	
70106800	CHANGEABLE MESSAGE SIGN	CAL MO	4	4							
70400100	TEMPORARY CONCRETE BARRIER	FOOT	469	469							
70400200	RELOCATE TEMPORARY CONCRETE BARRIER	FOOT	938	938							
* 78000100	THERMOPLASTIC PAVEMENT MARKING-LETTERS AND SYMBOLS	SQ FT	123	123							
* 78000200	THERMOPLASTIC PAVEMENT MARKING-LINE 4"	FOOT	4085	3829	256						
* 78000650	THERMOPLASTIC PAVEMENT MARKING-LINE 24"	FOOT	48	48							
* <del>78008210</del>	<del>POLYUREA PAVEMENT MARKING TYPE I LINE 4"</del>	<del>FOOT</del>	<del>256</del>		<del>256</del>						
* 78100105	RAISED REFLECTIVE PAVEMENT MARKER (BRIDGE)	EACH	8		8						
* 78200530	BARRIER WALL MARKERS, TYPE C	EACH	38	38							
78300100	PAVEMENT MARKING REMOVAL	SQ FT	1494	1494							
78300200	RAISED REFLECTIVE PAVEMENT MARKER REMOVAL	EACH	8		8						
X0320532	CONCRETE BRIDGE DECK SCARIFICATION (3/8 INCH)	SQ YD	284		284						
X0322256	TEMPORARY INFORMATION SIGNING	SQ FT	52	52							

\* SPECIALTY ITEMS

**LONCO, INC.**  
CONSULTING ENGINEERS  
1560 WALL ST, SUITE 222  
NAPERVILLE, ILLINOIS 60563 PH 630/577-9100

DESIGNED - MJY	REVISED -
DRAWN - SLV	REVISED -
CHECKED - MJY, DC	REVISED -
DATE - 01/29/2010	REVISED -

**STATE OF ILLINOIS  
DEPARTMENT OF TRANSPORTATION**

**SUMMARY OF QUANTITIES  
IL ROUTE 25 OVER POPLAR CREEK**

SCALE: NONE SHEET NO. 3 OF 18 SHEETS STA. 365+14.15 TO STA. 365+68.01

F.A.P. RTE.	SECTION	COUNTY	TOTAL SHEETS	SHEET NO.
360	49 B-1	KANE	18	3
D-91-237-10			CONTRACT NO. 60J47	
FED. ROAD DIST. NO.		ILLINOIS FED. AID PROJECT		

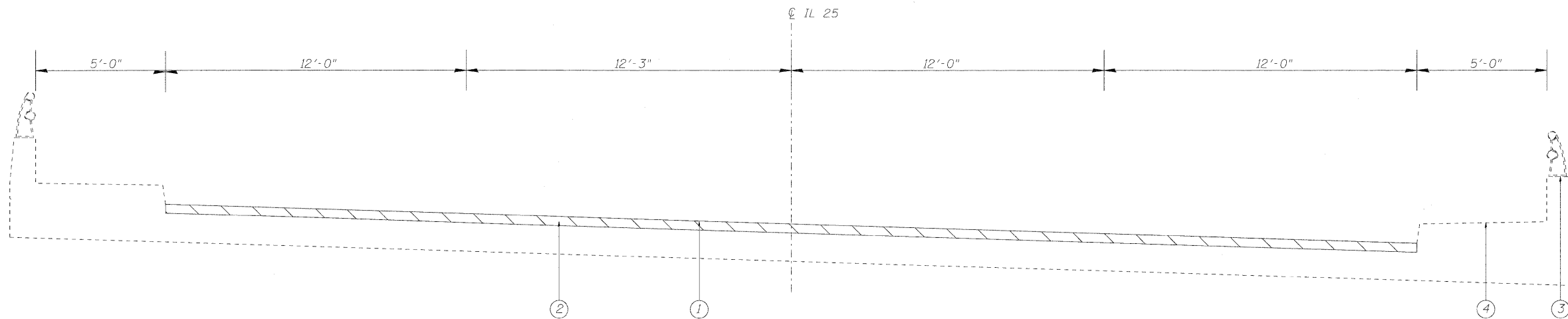

EXISTING TYPICAL SECTION  
STA. 365+14.15 TO STA. 365+68.01

LEGEND

- ① EXISTING HMA OVERLAY
- ② EXISTING BRIDGE DECK HYDRO-SCARIFICATION, 3/8"
- ③ EXISTING PARAPET WALLS
- ④ EXISTING PCC SIDEWALK
- ⑤ PROPOSED BRIDGE DECK THIN POLYMER OVERLAY, 3/8"

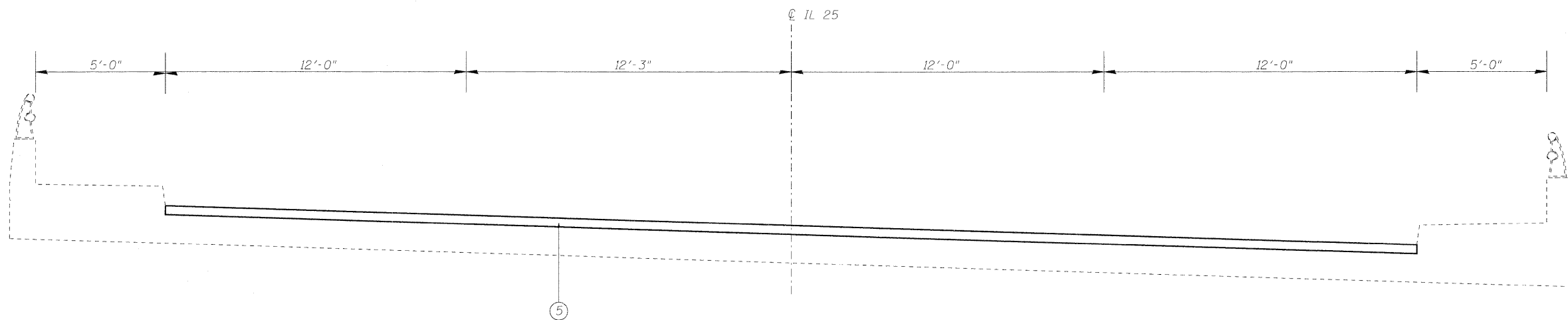

PROPOSED TYPICAL SECTION  
STA. 365+14.15 TO STA. 365+68.01

DESIGNED - MJY	REVISED -
DRAWN - ST, TSC	REVISED -
CHECKED - MJY, DC	REVISED -
DATE - 1/29/2010	REVISED -

F.A.P. RTE.	SECTION	COUNTY	TOTAL SHEETS	SHEET NO.
360	49 B-1	KANE	18	4
D-91-237-10			CONTRACT NO. 60J47	
FED. ROAD DIST. NO.		ILLINOIS FED. AID PROJECT		

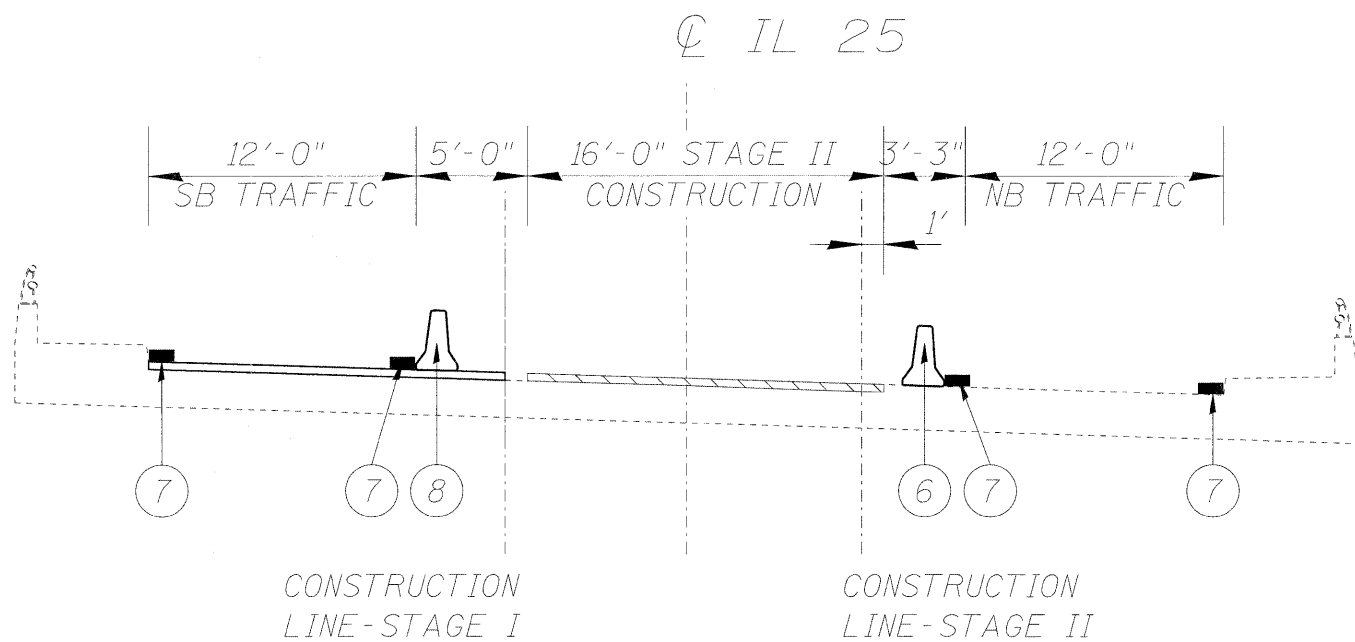
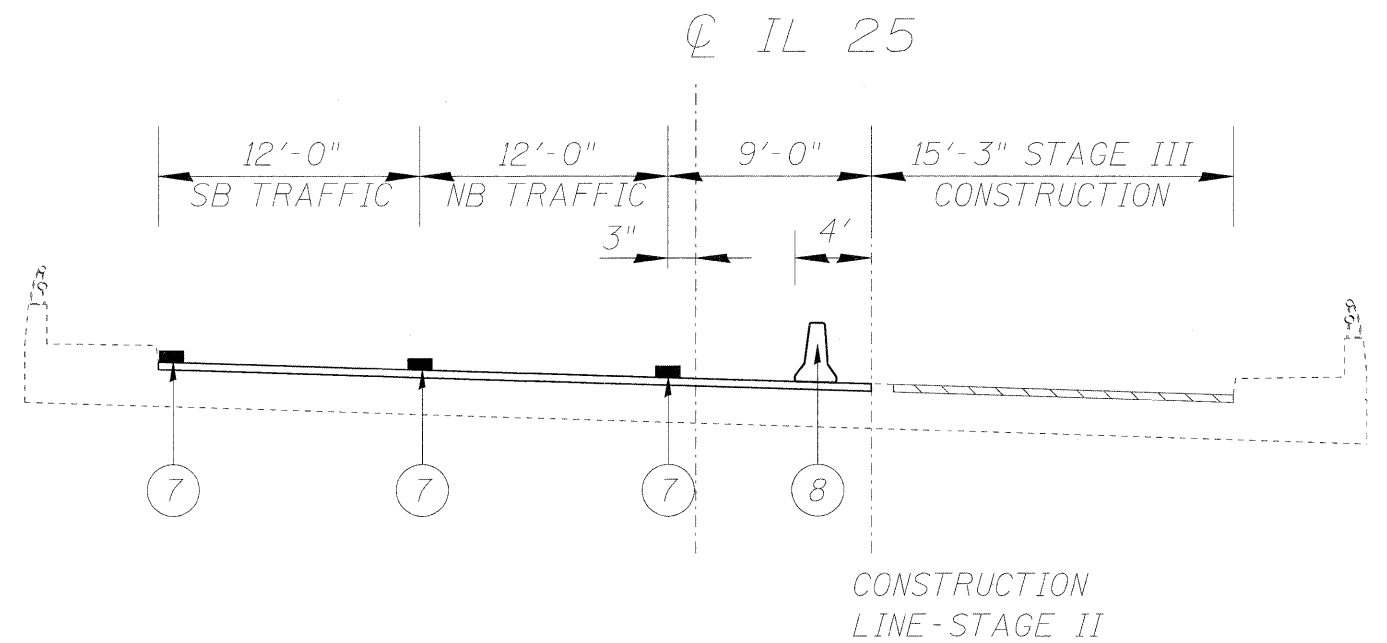
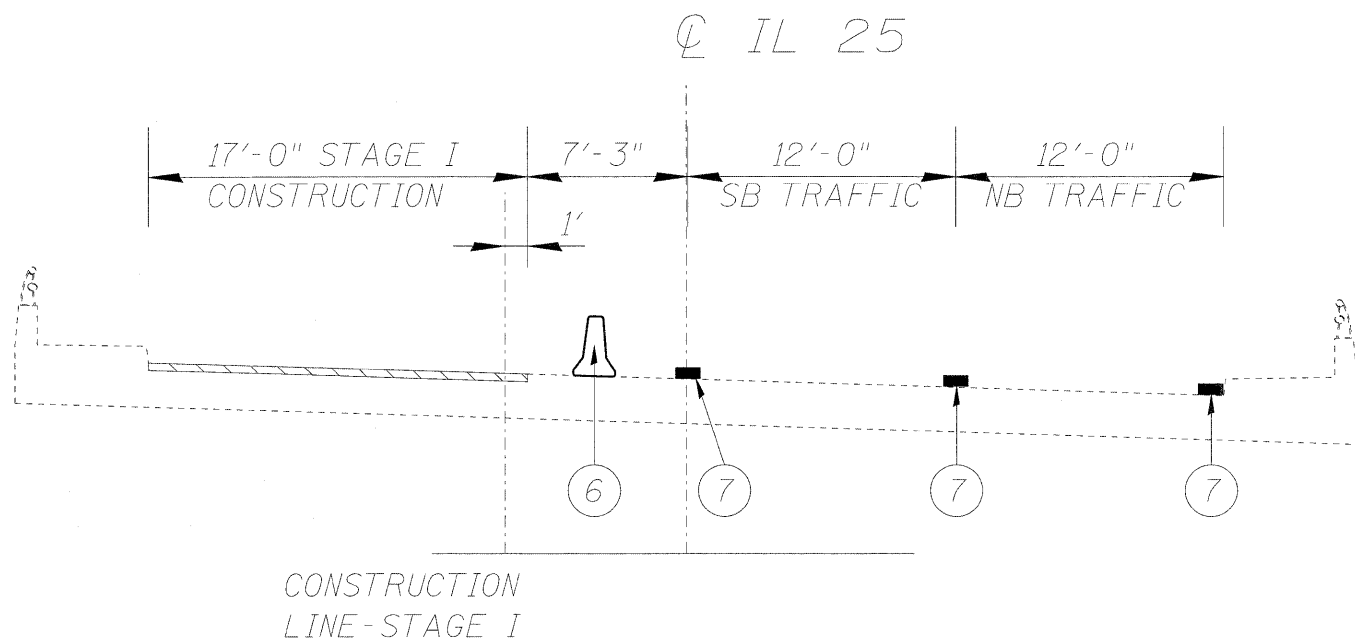

- ⑥ TEMPORARY CONCRETE BARRIER
- ⑦ WET REFLECTIVE TEMPORARY TAPE, TYPE III, 4"
- ⑧ RELOCATE TEMPORARY CONCRETE BARRIER

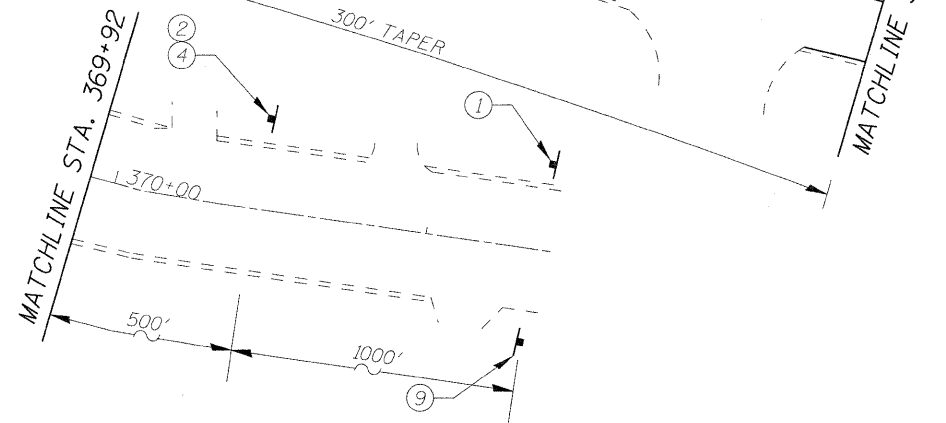
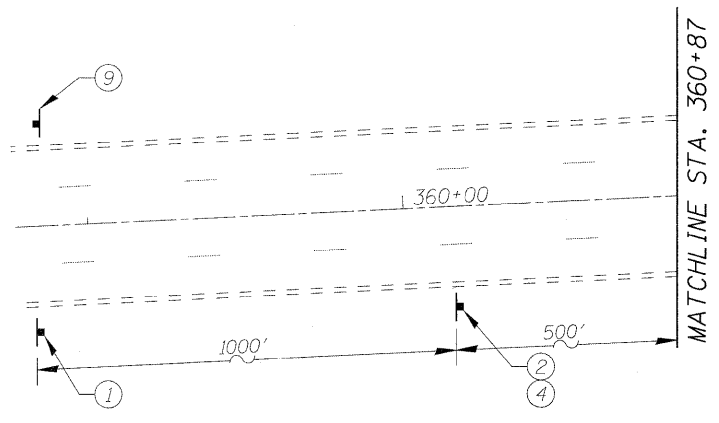
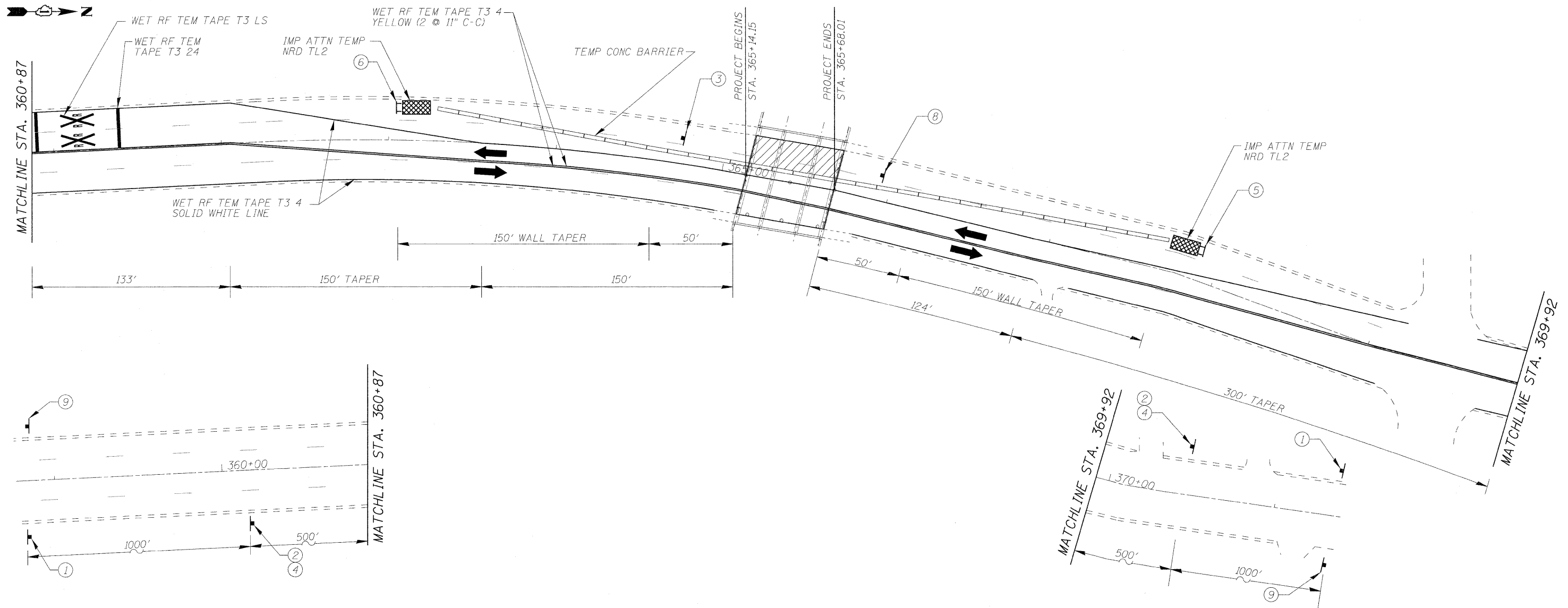

**LEGEND**

- WORK ZONE
- BARRICADE W/ STEADY BURN LIGHT
- TYPE III BARRICADE WITH FLASHING LIGHTS
- SIGN
- IMPACT ATTENUATORS
- CONCRETE BARRIER
- DOUBLE VERTICAL PANEL

**NOTES:**

BARRICADE SPACING SHALL BE 25' CENTERS IN TAPER SECTIONS AND 50' CENTERS IN TANGENT SECTIONS.

VERTICAL PANELS SHALL BE USED WHEN BARRICADES CANNOT BE PLACED ON THE EXISTING PAVEMENT OR PAVED SHOULDER.

ALL SIGNS, BARRICADES AND OTHER TRAFFIC CONTROL DEVICES SHOWN ON THIS SHEET SHALL BE ACCORDING TO SECTION 701 OF THE STANDARD SPECIFICATIONS AND SHALL NOT BE PAID FOR SEPARATELY, BUT SHALL BE PAID FOR AT THE CONTRACT LUMP SUM PRICE FOR "TRAFFIC CONTROL AND PROTECTION, SPECIAL." TEMPORARY AND PERMANENT PAVEMENT STRIPING WILL BE PAID FOR SEPARATELY.

**STAGE 1**

1. INSTALL TRAFFIC CONTROL AND TEMPORARY CONCRETE BARRIER IN ACCORDANCE WITH STAGE 1 MAINTENANCE OF TRAFFIC.
2. REMOVE TOP 3/8" OF THE WEST PORTION OF EXISTING DECK SURFACE.
3. INSTALL NEW THIN POLYMER OVERLAY.
4. INSTALL STRIPING ON WEST SIDE OF IL ROUTE 25 IN ACCORDANCE WITH SHEET 9.

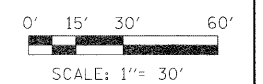
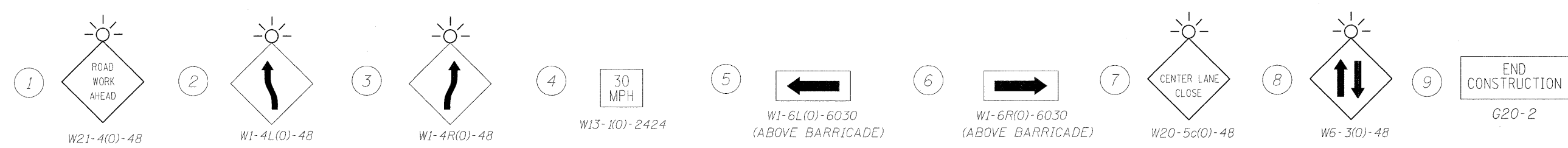

**LOWCO, INC.**  
CONSULTING ENGINEERS  
1560 WALL ST., SUITE 222  
NAPERVILLE, ILLINOIS 60563 PH: (630) 577-9100

DESIGNED - MJY	REVISED -
DRAWN - ST, TSC	REVISED -
CHECKED - MJY, DC	REVISED -
DATE - 01/29/2010	REVISED -

**STATE OF ILLINOIS  
DEPARTMENT OF TRANSPORTATION**

**CONSTRUCTION STAGING PLAN - STAGE 1  
IL ROUTE 25 OVER POPLAR CREEK**

SCALE: 1" = 30' SHEET NO. 6 OF 18 SHEETS STA. 365+14.15 TO STA. 365+68.01

F.A.U. RTE. 360	SECTION 49 B-1	COUNTY KANE	TOTAL SHEETS 18	SHEET NO. 6
D-91-237-10			CONTRACT NO. 60J47	
FED. ROAD DIST. NO. ILLINOIS FED. AID PROJECT				

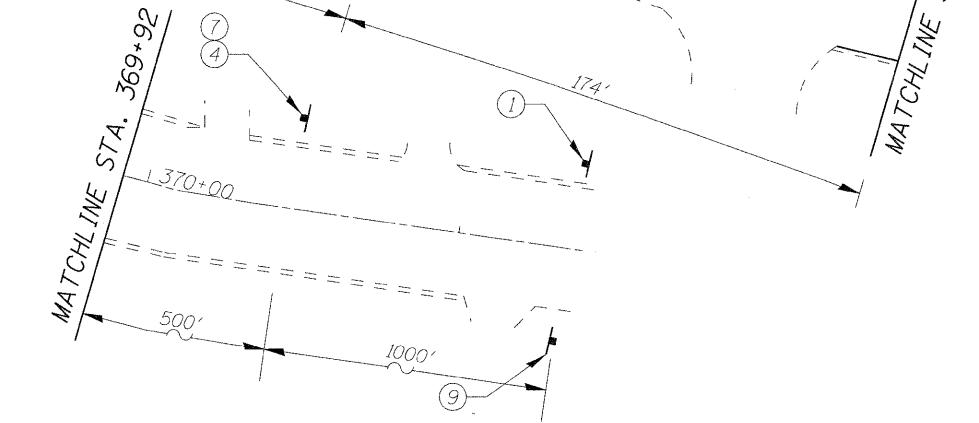
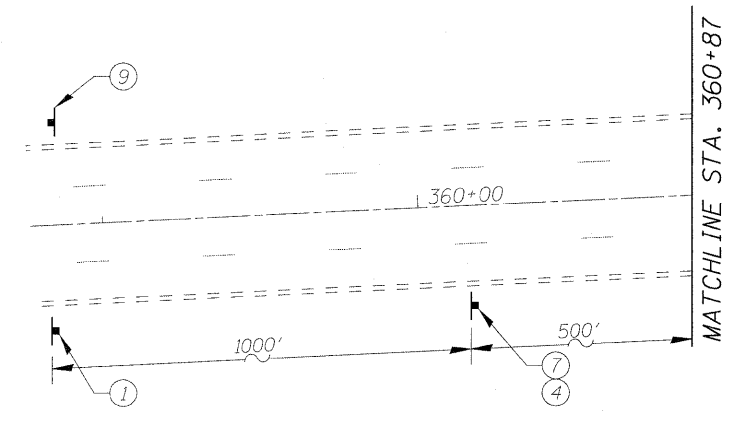
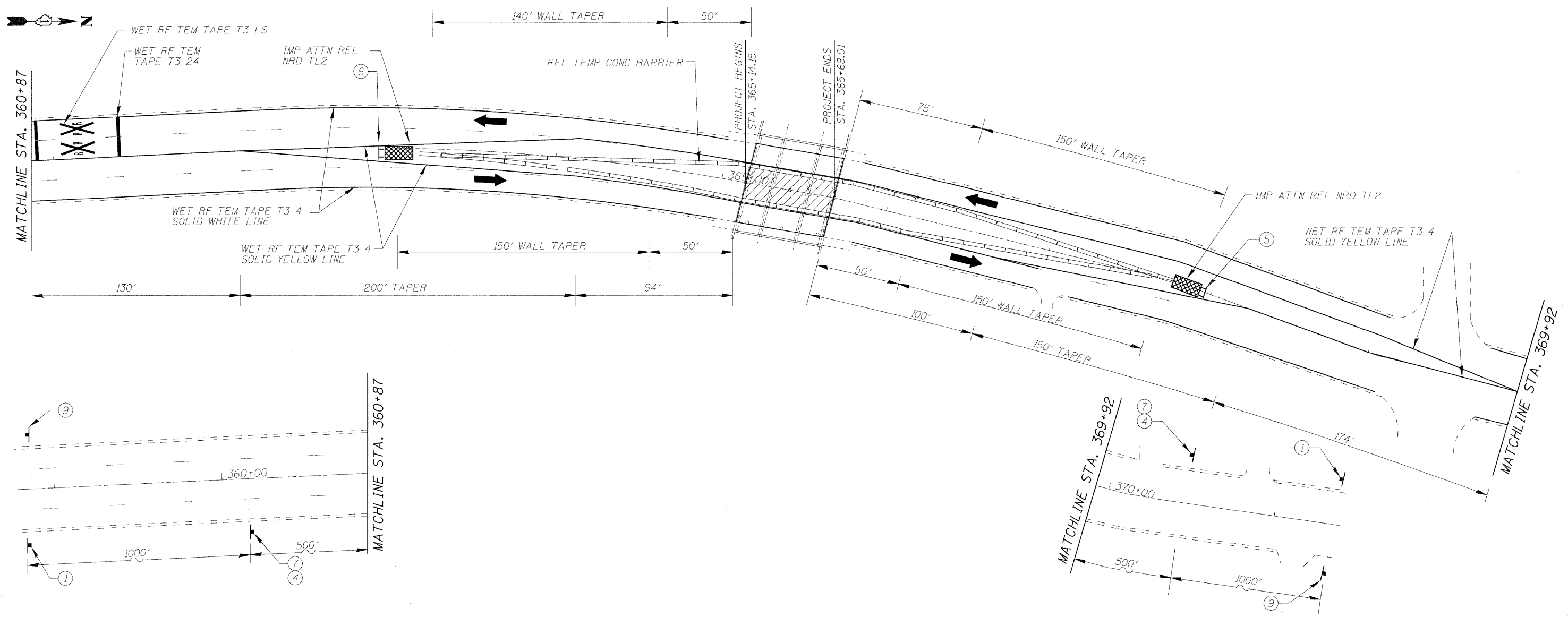

**LEGEND**

- WORK ZONE
- BARRICADE W/ STEADY BURN LIGHT
- TYPE III BARRICADE WITH FLASHING LIGHTS
- SIGN
- IMPACT ATTENUATORS
- CONCRETE BARRIER
- DOUBLE VERTICAL PANEL

**NOTES:**

BARRICADE SPACING SHALL BE 25' CENTERS IN TAPER SECTIONS AND 50' CENTERS IN TANGENT SECTIONS.

VERTICAL PANELS SHALL BE USED WHEN BARRICADES CANNOT BE PLACED ON THE EXISTING PAVEMENT OR PAVED SHOULDER.

ALL SIGNS, BARRICADES AND OTHER TRAFFIC CONTROL DEVICES SHOWN ON THIS SHEET SHALL BE ACCORDING TO SECTION 701 OF THE STANDARD SPECIFICATIONS AND SHALL NOT BE PAID FOR SEPARATELY, BUT SHALL BE PAID FOR AT THE CONTRACT LUMP SUM PRICE FOR "TRAFFIC CONTROL AND PROTECTION, SPECIAL." TEMPORARY AND PERMANENT PAVEMENT STRIPING WILL BE PAID FOR SEPARATELY.

**STAGE 2**

1. INSTALL TRAFFIC CONTROL AND TEMPORARY CONCRETE BARRIER IN ACCORDANCE WITH STAGE 2 MAINTENANCE OF TRAFFIC.
2. REMOVE TOP  $\frac{3}{8}$ " OF THE MIDDLE PORTION OF EXISTING DECK SURFACE.
3. INSTALL NEW THIN POLYMER OVERLAY.
4. INSTALL STRIPING IN STAGE 2 WORK (MIDDLE PORTION) AREA OF IL ROUTE 25 IN ACCORDANCE WITH SHEET 9.

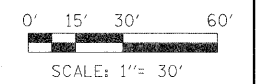
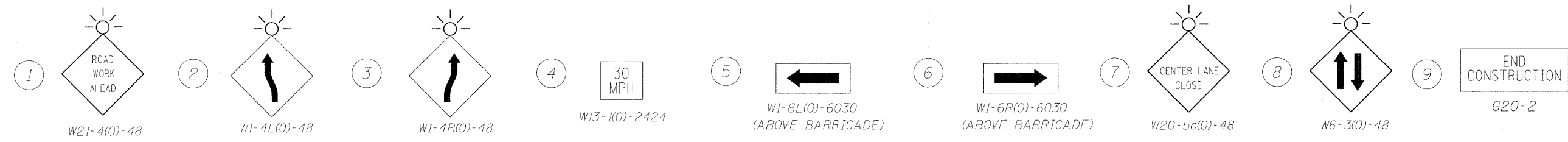

**LOWCO, INC.**  
CONSULTING ENGINEERS  
1560 WALL ST., SUITE 222  
NAPERVILLE, ILLINOIS 60563 PH: (630) 577-9100

DESIGNED - MJY	REVISED -
DRAWN - ST, TSC	REVISED -
CHECKED - MJY, DC	REVISED -
DATE - 01/29/2010	REVISED -

**STATE OF ILLINOIS**  
**DEPARTMENT OF TRANSPORTATION**

**CONSTRUCTION STAGING PLAN - STAGE 2**  
**IL ROUTE 25 OVER POPLAR CREEK**

SCALE: 1" = 30' SHEET NO. 7 OF 18 SHEETS STA. 365+14.15 TO STA. 365+68.01

F.A.U. RTE. 360	SECTION 49 B-1	COUNTY KANE	TOTAL SHEETS 18	SHEET NO. 7
D-91-237-10		CONTRACT NO. 60J47		
FED. ROAD DIST. NO.		ILLINOIS FED. AID PROJECT		

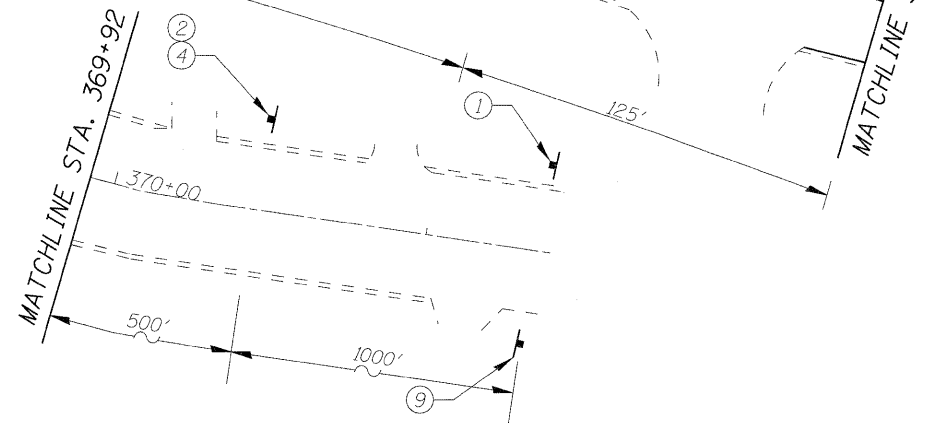
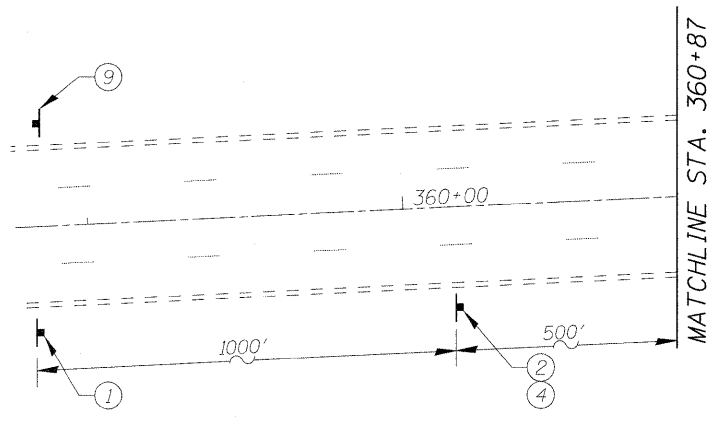
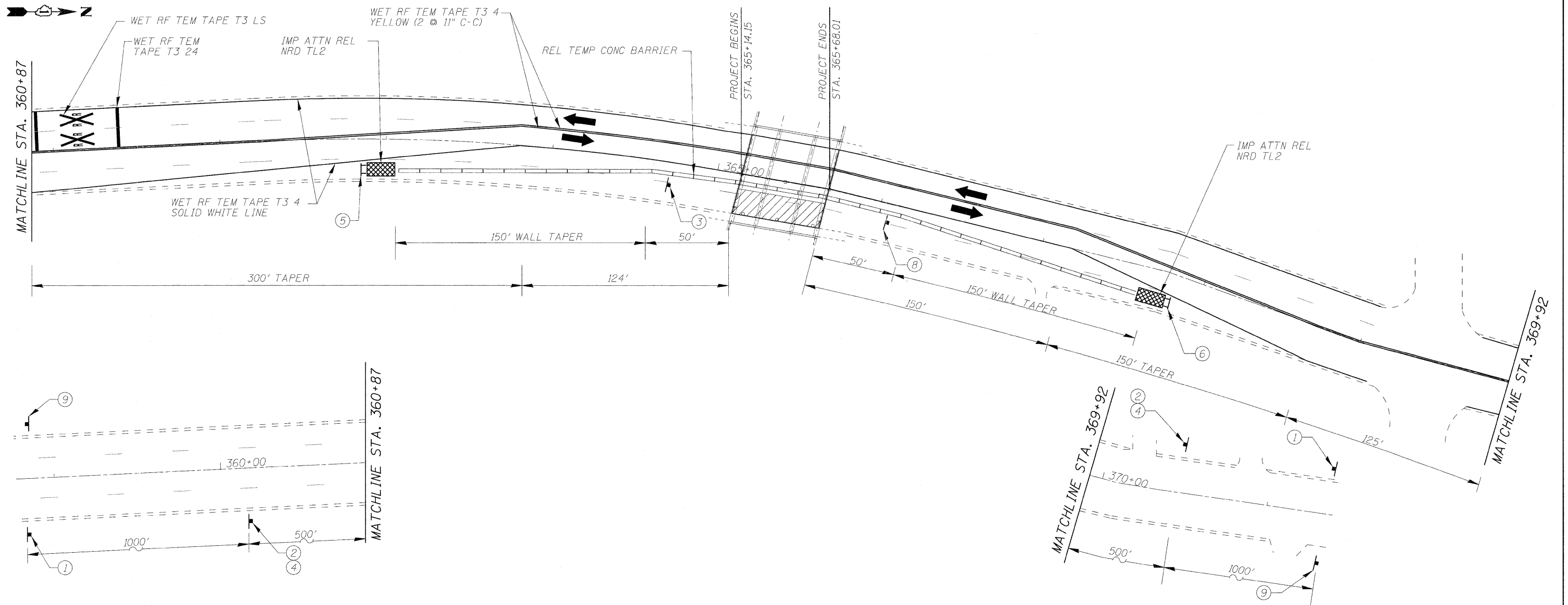

**LEGEND**

- WORK ZONE
- BARRICADE W/ STEADY BURN LIGHT
- TYPE III BARRICADE WITH FLASHING LIGHTS
- SIGN
- IMPACT ATTENUATORS
- CONCRETE BARRIER
- DOUBLE VERTICAL PANEL

**NOTES:**

BARRICADE SPACING SHALL BE 25' CENTERS IN TAPER SECTIONS AND 50' CENTERS IN TANGENT SECTIONS.

VERTICAL PANELS SHALL BE USED WHEN BARRICADES CANNOT BE PLACED ON THE EXISTING PAVEMENT OR PAVED SHOULDER.

ALL SIGNS, BARRICADES AND OTHER TRAFFIC CONTROL DEVICES SHOWN ON THIS SHEET SHALL BE ACCORDING TO SECTION 701 OF THE STANDARD SPECIFICATIONS AND SHALL NOT BE PAID FOR SEPARATELY, BUT SHALL BE PAID FOR AT THE CONTRACT LUMP SUM PRICE FOR "TRAFFIC CONTROL AND PROTECTION, SPECIAL." TEMPORARY AND PERMANENT PAVEMENT STRIPING WILL BE PAID FOR SEPARATELY.

**STAGE 3**

1. INSTALL TRAFFIC CONTROL AND TEMPORARY CONCRETE BARRIER IN ACCORDANCE WITH STAGE 3 MAINTENANCE OF TRAFFIC.
2. REMOVE TOP 3/8" OF THE EAST PORTION OF EXISTING DECK SURFACE.
3. INSTALL NEW THIN POLYMER OVERLAY.
4. INSTALL STRIPING ON EAST SIDE OF IL ROUTE 25 IN ACCORDANCE WITH SHEET 9.

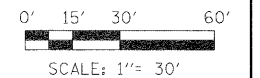
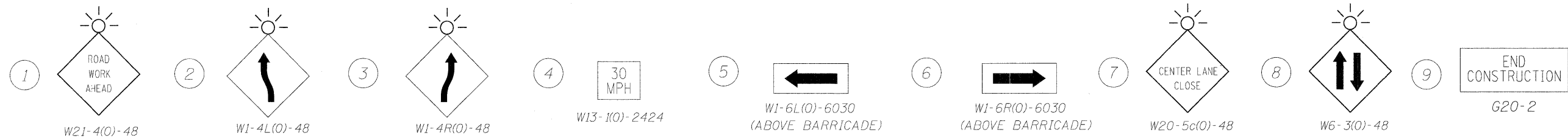

**LOWCO, INC.**  
CONSULTING ENGINEERS  
1560 WALL ST., SUITE 222  
NAPERVILLE, ILLINOIS 60563 PH: (630) 577-9100

DESIGNED - MJY  
DRAWN - ST, TSC  
CHECKED - MJY, DC  
DATE - 01/29/2010

REVISED -  
REVISED -  
REVISED -

**STATE OF ILLINOIS  
DEPARTMENT OF TRANSPORTATION**

**CONSTRUCTION STAGING PLAN - STAGE 3  
IL ROUTE 25 OVER POPLAR CREEK**

SCALE: 1" = 30' SHEET NO. 8 OF 18 SHEETS STA. 365+14.15 TO STA. 365+68.01

F.A.U. RTE. 360	SECTION 49 B-1	COUNTY KANE	TOTAL SHEETS 18	SHEET NO. 8
D-91-237-10		CONTRACT NO. 60J47		
FED. ROAD DIST. NO.		ILLINOIS FED. AID PROJECT		



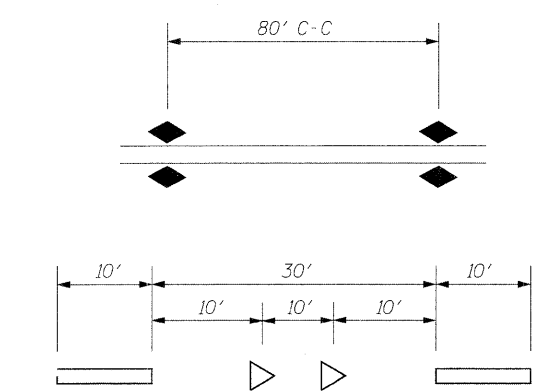
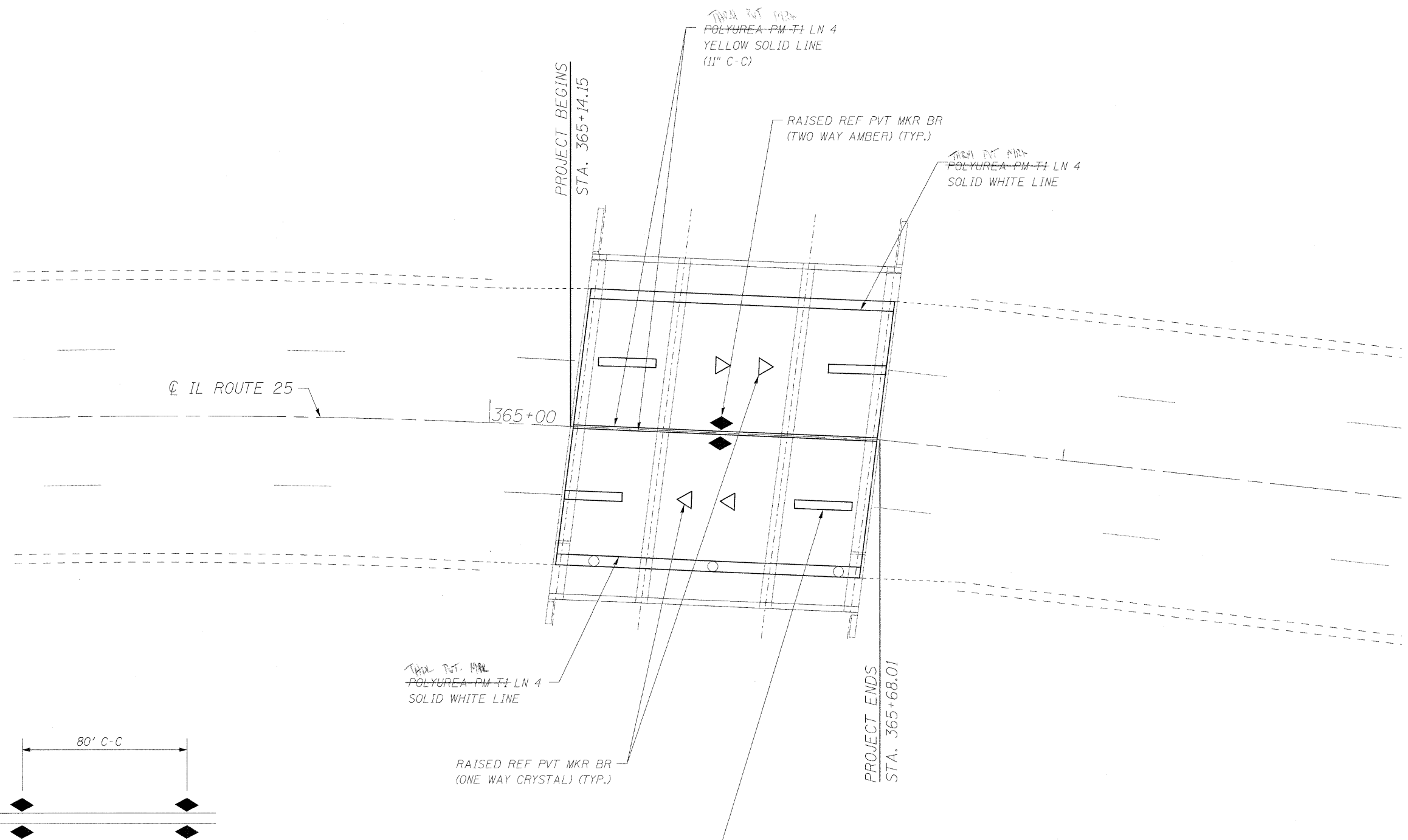

**LANE PAVEMENT MARKER DETAIL**  
SEE DISTRICT STANDARD NO. TC-11

**NOTE:**  
ALL EXISTING PAVEMENT STRIPING REMOVED IN ORDER TO IMPLEMENT TEMPORARY PAVEMENT MARKING FOR STAGE CONSTRUCTION SHALL BE REINSTALLED AS DIRECTED BY THE ENGINEER.

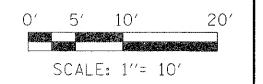

**LOWCO, INC.**  
CONSULTING ENGINEERS  
1560 WALL ST., SUITE 222  
NAPERVILLE, ILLINOIS 60563 Ph: (630) 577-9100

DESIGNED - MJY	REVISED -
DRAWN - SLV	REVISED -
CHECKED - MJY, DC	REVISED -
DATE - 1/29/2010	REVISED -

**STATE OF ILLINOIS**  
**DEPARTMENT OF TRANSPORTATION**

**PAVEMENT MARKING PLAN**  
**IL ROUTE 25 OVER POPLAR CREEK**  
SCALE: 1" = 10' SHEET NO. 9 OF 18 SHEETS STA. 365+14.15 TO STA. 365+68.01

F.A.P. RTE.	SECTION	COUNTY	TOTAL SHEETS	SHEET NO.
360	49 B-1	KANE	18	9
D-91-237-10			CONTRACT NO. 60J47	
FED. ROAD DIST. NO.		ILLINOIS FED. AID PROJECT		



STATE OF ILLINOIS  
DEPARTMENT OF TRANSPORTATION

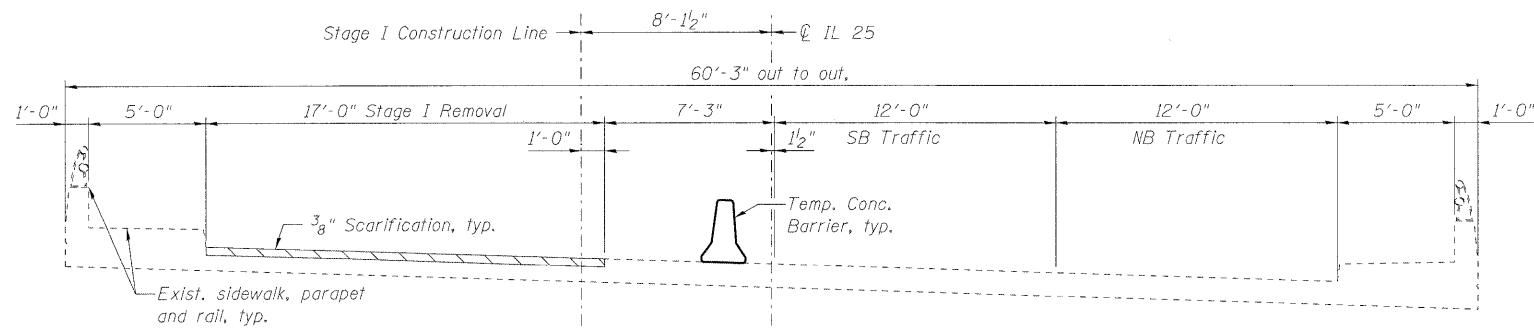

STAGE I REMOVAL

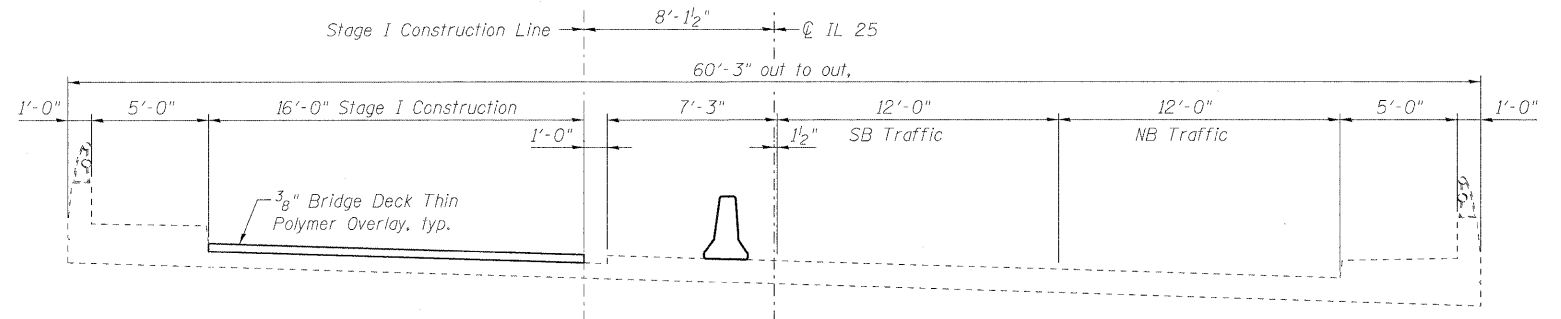

STAGE I CONSTRUCTION

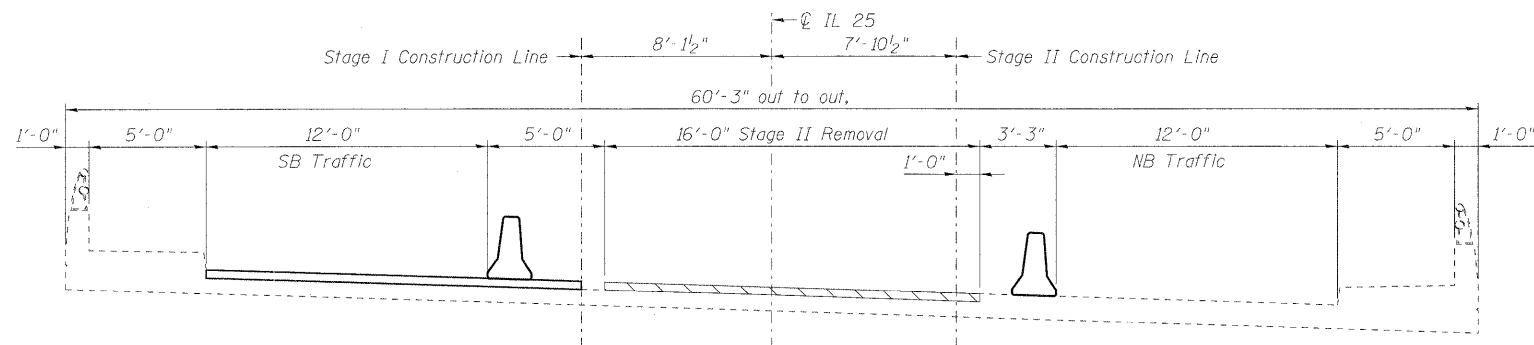

STAGE II REMOVAL

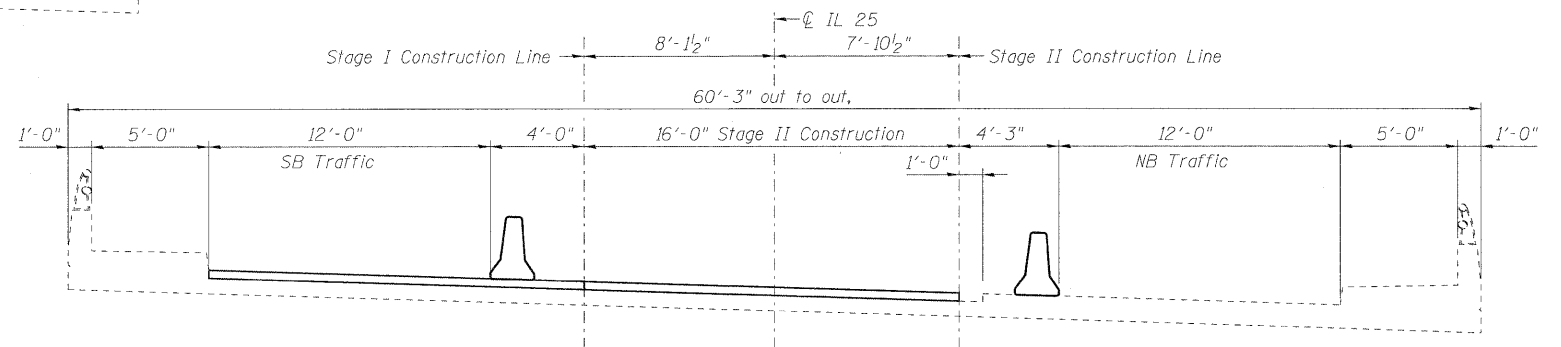

STAGE II CONSTRUCTION

NOTES

All Cross Sections looking North.  
Hatched area indicates Removal of Concrete Bridge Deck Scarification.  
For quantity of Temporary Concrete Barrier see Roadway Plans.  
For Temporary Concrete Barrier details see Sheet 4 of 4.

DESIGNED	-	SLV
CHECKED	-	DJB
DRAWN	-	SLV
CHECKED	-	DJB

**LOWCO, INC.**  
CONSULTING ENGINEERS  
1560 WALL ST., SUITE 222  
NAPERVILLE, ILLINOIS 60563 PH: (630) 577-9100

(Sheet 1 of 2)  
**STAGE CONSTRUCTION DETAILS**  
**STRUCTURE NO. 045-5000**

SHEET NO. 2 OF 4 SHEETS	F.A.P. RTE.	SECTION	COUNTY	TOTAL SHEETS	SHEET NO.
	360	49 B-I	KANE	18	11
	D-91-229-10			CONTRACT NO. 60J47	
FED. ROAD DIST. NO. _		ILLINOIS	FED. AID PROJECT		

STATE OF ILLINOIS  
DEPARTMENT OF TRANSPORTATION

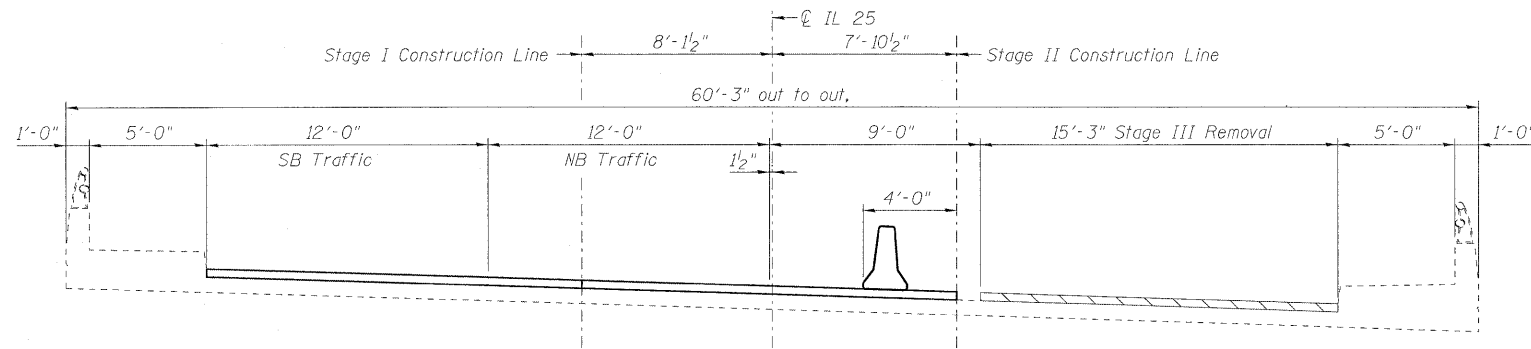

STAGE III REMOVAL

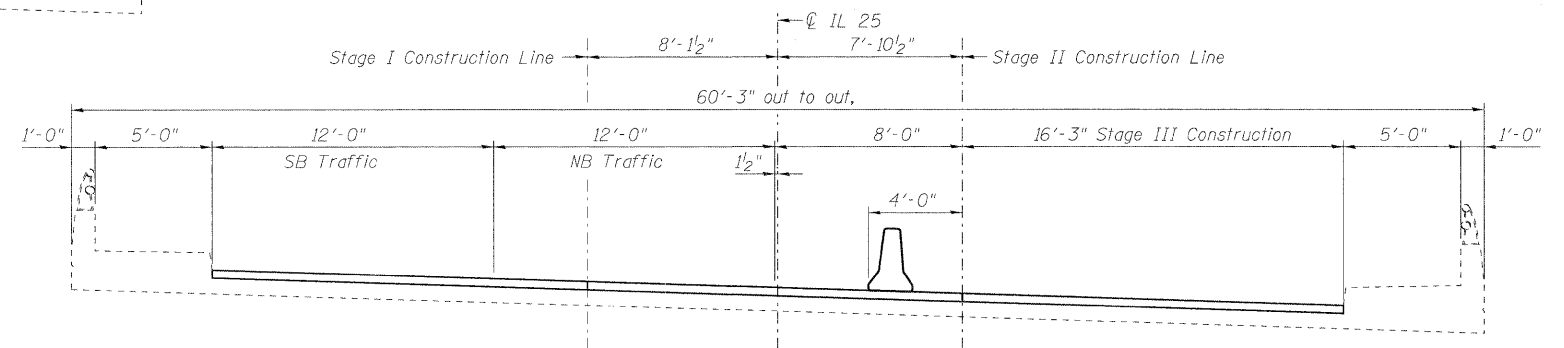

STAGE III CONSTRUCTION

**NOTES**

All Cross Sections looking North.  
Hatched area indicates Removal of Concrete Bridge Deck Scarification.  
For quantity of Temporary Concrete Barrier see Roadway Plans.  
For Temporary Concrete Barrier details see Sheet 4 of 4.

DESIGNED	-	SLV
CHECKED	-	DJB
DRAWN	-	SLV
CHECKED	-	DJB

**LONGCO, INC.**  
CONSULTING ENGINEERS  
1560 WALL ST., SUITE 222  
NAPERVILLE, ILLINOIS 60563 PH: (630) 577-9100

(Sheet 2 of 2)  
**STAGE CONSTRUCTION DETAILS**  
**STRUCTURE NO. 045-5000**

SHEET NO. 3 OF 4 SHEETS	F.A.P. RTE.	SECTION	COUNTY	TOTAL SHEETS	SHEET NO.
	360	49 B-I	KANE	18	12
	D-91-229-10		CONTRACT NO. 60J47		
FED. ROAD DIST. NO. _		ILLINOIS	FED. AID PROJECT		

STATE OF ILLINOIS  
DEPARTMENT OF TRANSPORTATION

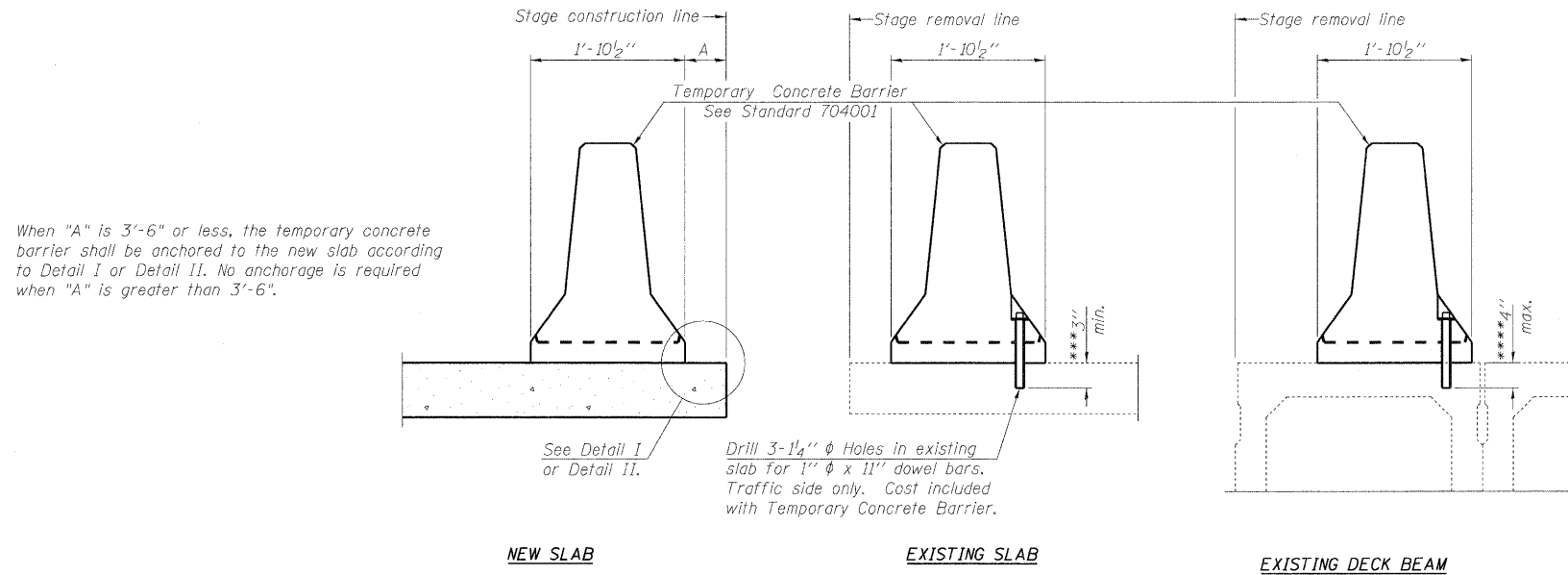

When "A" is 3'-6" or less, the temporary concrete barrier shall be anchored to the new slab according to Detail I or Detail II. No anchorage is required when "A" is greater than 3'-6".

See Detail I or Detail II.  
Drill 3-1/4"  $\phi$  Holes in existing slab for 1"  $\phi$  x 11" dowel bars. Traffic side only. Cost included with Temporary Concrete Barrier.

**NOTES**

Detail I - With Bar Splicer or Couplers:  
Connect one (1) 1"x7"x10" steel  $\bar{P}$  to the top layer of couplers with 2-5/8"  $\phi$  bolts screwed to coupler at approximate  $\bar{C}$  of each barrier panel.

Detail II - With Extended Reinforcement Bars:  
Connect one (1) 1"x7"x10" steel  $\bar{P}$  to the concrete slab or concrete wearing surface with 2-5/8"  $\phi$  Expansion Anchors or cast in place inserts spaced between the top layer of reinforcement at approximate  $\bar{C}$  of each barrier panel.

Cost of anchorage is included with Temporary Concrete Barrier. The 1" x 7" x 10" plate shall not be removed until stage II construction forms and all reinforcement bars are in place and the concrete is ready to be placed.

**SECTIONS THRU SLAB OR DECK BEAM**

\*\*\* Dimension shown is minimum required embedment into concrete. If hot-mix asphalt wearing surface is present, minimum embedment shall be in addition to wearing surface depth.

\*\*\*\* If existing deck beam is to remain in place after stage construction, embedment shall only be into wearing surface and not into existing deck beam concrete.

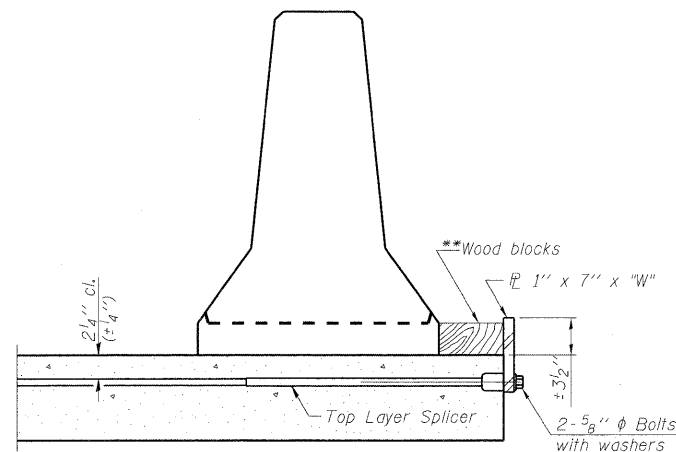

**DETAIL I**

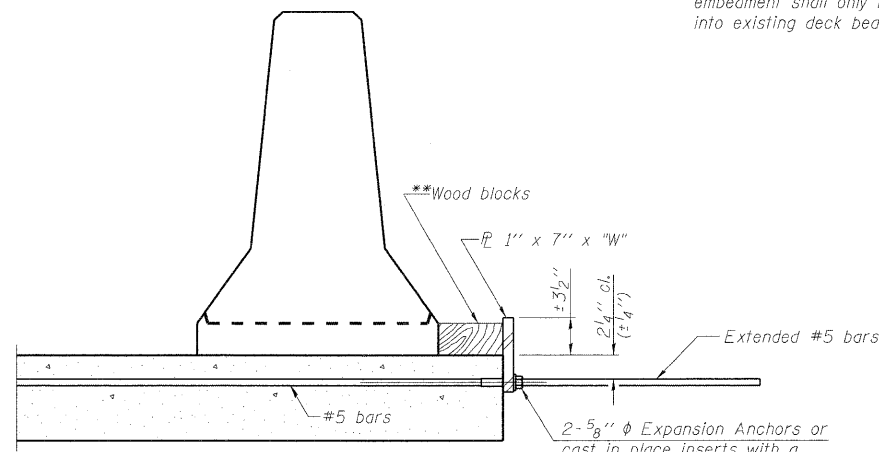

**DETAIL II**

\*\* Wood blocks may be omitted when required to provide minimum stage traffic lane width. When the wood blocks are omitted, the concrete barrier shall be in direct contact with the steel retainer plate.

"W" = Top bars spacing + 4"

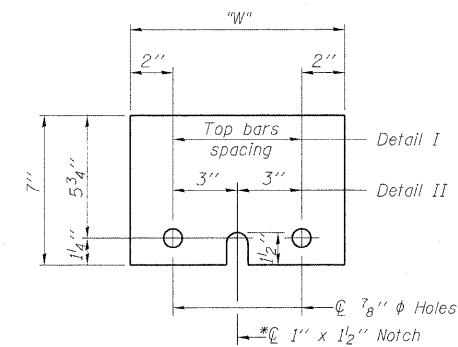

**STEEL RETAINER  $\bar{P}$  1" x 7" x 10"**

\* Required only with Detail II

DESIGNED -	SLV
CHECKED -	DJB
DRAWN -	SLV
CHECKED -	DJB

**LONGCO, INC.**  
CONSULTING ENGINEERS  
1560 WALL ST., SUITE 222  
NAPERVILLE, ILLINOIS 60563 PH: (630) 577-9100

R-27

11-1-09

**TEMPORARY CONCRETE BARRIER  
FOR STAGE CONSTRUCTION  
STRUCTURE NO. 045-5000**

SHEET NO. 4 OF 4 SHEETS	F.A.P. RTE.	SECTION	COUNTY	TOTAL SHEETS	SHEET NO.
	360	49 B-I	KANE	18	13
D-91-229-10			CONTRACT NO. 60J47		
FED. ROAD DIST. NO. ILLINOIS FED. AID PROJECT					

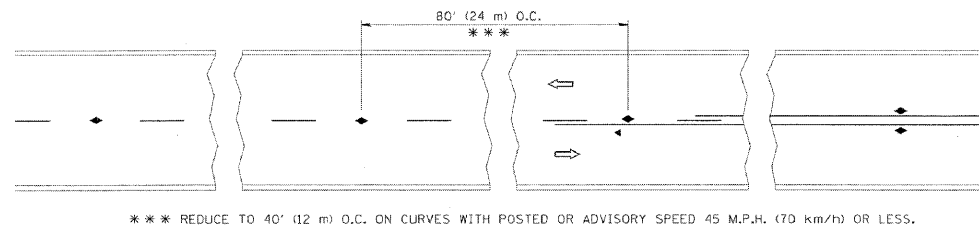

TWO-LANE/TWO-WAY

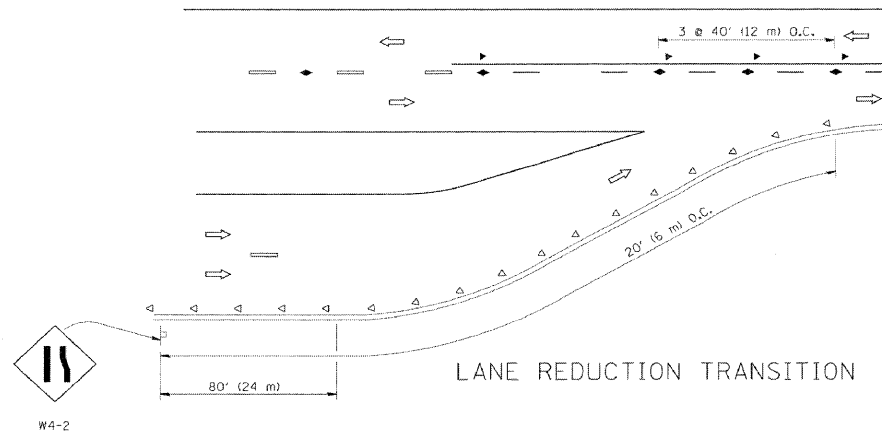

LANE REDUCTION TRANSITION

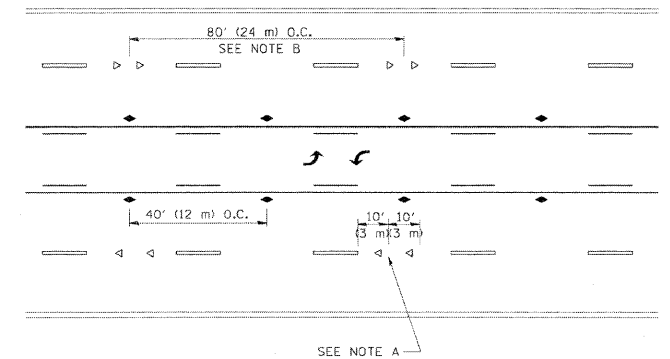

TWO-WAY LEFT TURN

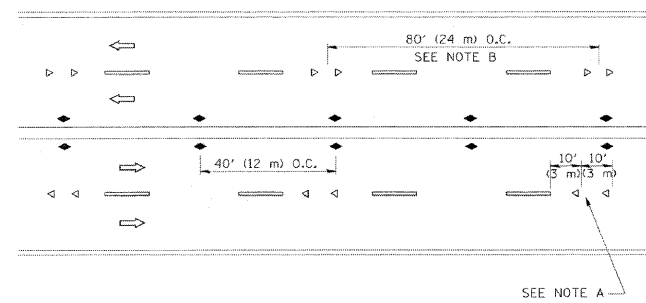

MULTI-LANE/UNDIVIDED

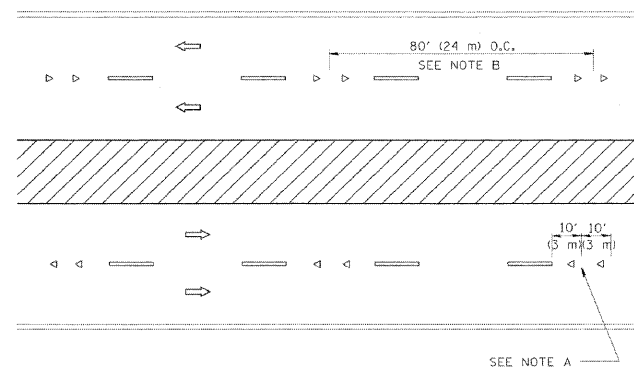

MULTI-LANE/DIVIDED

GENERAL NOTES

1. MARKERS USED WITH DASHED LINES SHALL BE CENTERED IN THE GAP BETWEEN SEGMENTS.
2. MARKERS USED ADJACENT TO SOLID LINES SHALL BE OFFSET 2 TO 3 (50 TO 75) TOWARD TRAFFIC AS SHOWN.
3. MARKERS THROUGH TANGENTS LESS THAN 500' (150 m) IN LENGTH BETWEEN CURVES SHALL BE INSTALLED AT THE LESSER OF THE TWO CURVE SPACINGS.

SYMBOLS

- YELLOW STRIPE
- WHITE STRIPE
- ◀ ONE-WAY AMBER MARKER
- ◁ ONE-WAY CRYSTAL MARKER (W/O)
- ◆ TWO-WAY AMBER MARKER

LANE MARKER NOTES

- A. USE DOUBLE LANE LINE MARKERS SPACED AS SHOWN.
- B. REDUCE TO 40' (12 m) O.C. ON CURVES WHERE ADVISORY SPEEDS ARE 10 M.P.H. (20 km/h) LOWER THAN POSTED SPEEDS.

DESIGN NOTES

1. DOUBLE LANE LINE MARKERS SHALL BE USED UNLESS SPECIFIED OTHERWISE.
2. EXCEPT AS SHOWN ON THE LANE REDUCTION TRANSITION AND FREEWAY EXIT RAMP DETAIL, MARKERS ARE NOT TO BE SPECIFIED ON RIGHT EDGE LINES.
3. THE EXACT MARKER LIMITS, SPACING, AND COLOR SHOULD BE INCLUDED IN THE PLANS.
4. MARKERS SHOULD NOT BE USED ALONGSIDE CURBS EXCEPT FOR EXTREMELY SHORT SECTIONS OF CURBS WHERE NOT MORE THAN TWO MARKERS WOULD BE INVOLVED.

REVISED	T. RAMMACHER	09-19-94
REVISED	T. RAMMACHER	03-12-99
REVISED	T. RAMMACHER	01-06-00
REVISED	C. JUICIUS	09-09-09

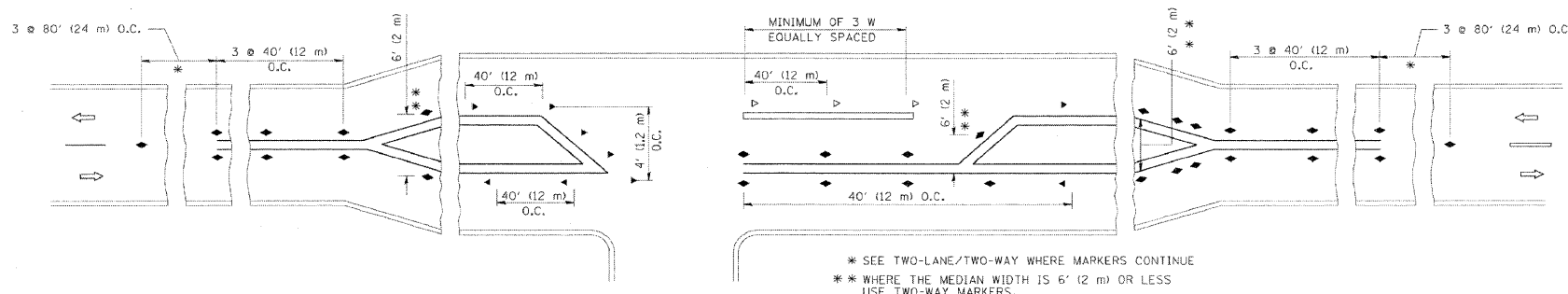

LEFT TURN

TYPICAL APPLICATIONS RAISED REFLECTIVE PAVEMENT MARKERS (SNOW-PLOW RESISTANT)

All dimensions are in inches (millimeters) unless otherwise shown.

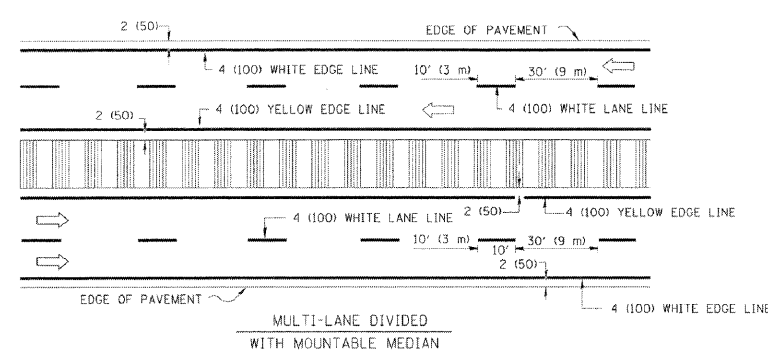
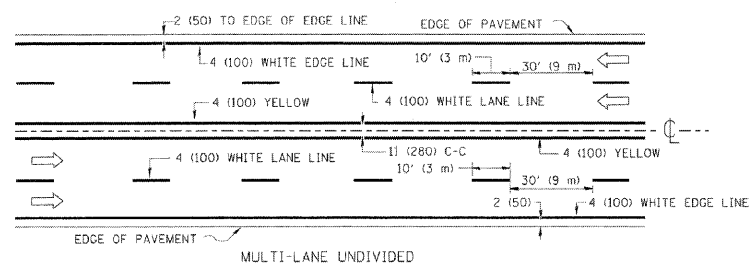
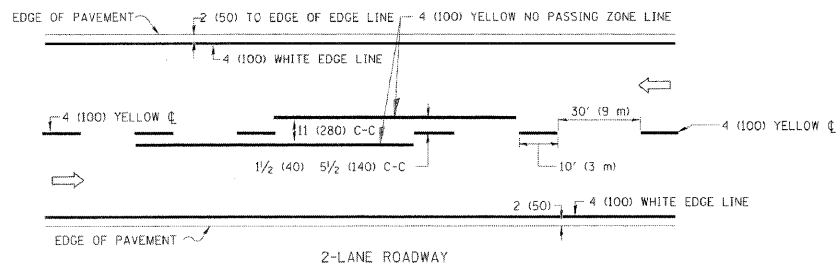

NOTE: MEDIANS WITH BARRIER CURB DO NOT REQUIRE AN EDGE LINE

TYPICAL LANE AND EDGE LINE MARKING

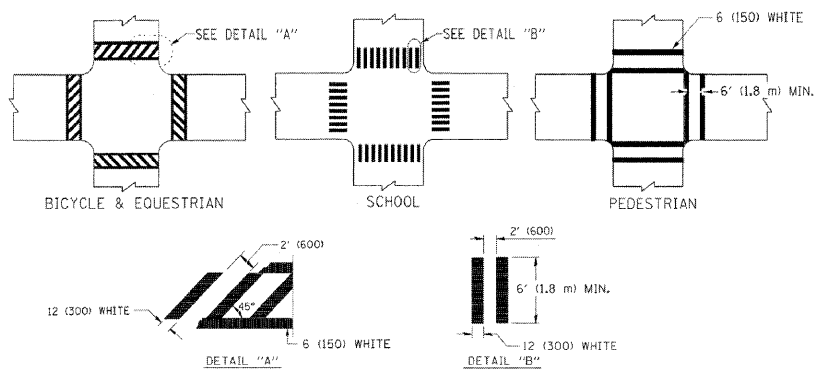

TYPICAL CROSSWALK MARKING

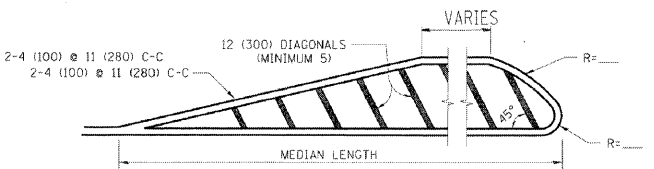
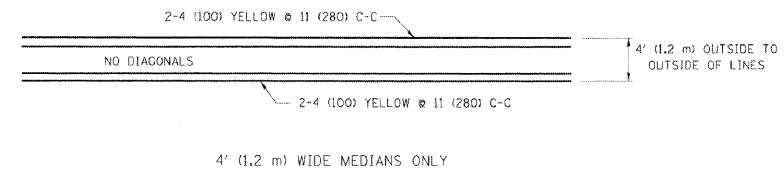

FOR MEDIAN LENGTHS WHERE DIAGONAL SPACING CANNOT BE ATTAINED, USE 5 (FIVE) EQUALLY SPACED DIAGONAL LINES.  
 DIAGONAL LINE SPACING: 50' (15 m) C-C (LESS THAN 30MPH (50 km/h))  
 75' (25 m) C-C 30MPH (50 km/h) TO 45MPH (70 km/h)  
 150' (45 m) C-C (MORE THAN 45MPH (70 km/h))

MEDIANS OVER 4' (1.2 m) WIDE

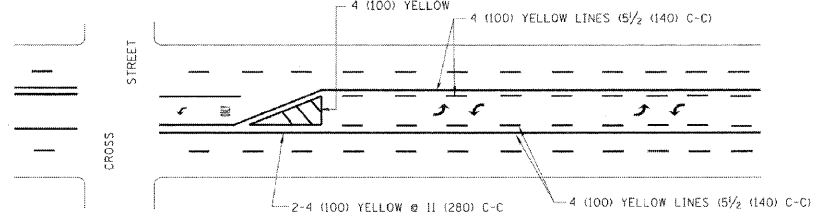

A MINIMUM OF TWO PAIRS OF TURN ARROWS SHALL BE USED, WHITE IN COLOR. ADDITIONAL PAIRS SHALL BE PLACED AT 200' (60 m) TO 300' (90 m) INTERVALS.

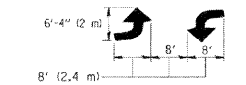

MEDIAN WITH TWO-WAY LEFT TURN LANE

TYPICAL PAINTED MEDIAN MARKING

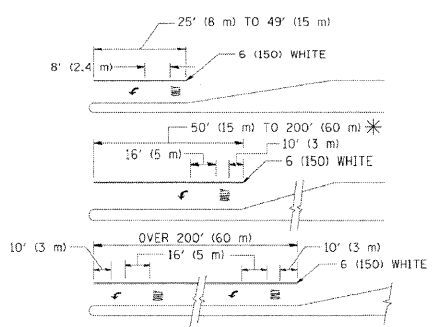

FULL SIZE LETTERS 8' (2.4 m) AND ARROWS SHALL BE USED.  
 AREA = 15.6 SQ. FT. (1.5 m<sup>2</sup>) ONLY AREA = 20.8 SQ. FT. (1.9 m<sup>2</sup>)  
 \* TURN LANES IN EXCESS OF 400' (120 m) IN LENGTH MAY HAVE AN ADDITIONAL SET OF ARROW - "ONLY" INSTALLED MIDWAY BETWEEN THE OTHER TWO SETS OF ARROW - "ONLY".

TYPICAL LEFT (OR RIGHT) TURN LANE

TYPICAL TURN LANE MARKING

REVISED	- T. RAMMACHER	10-27-94
REVISED	- C. JUCIUS	09-09-09
REVISED	-	
REVISED	-	

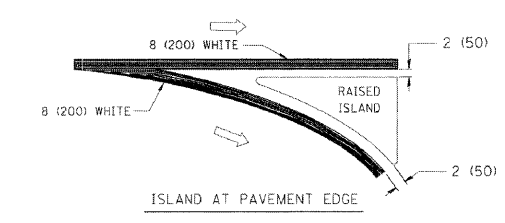
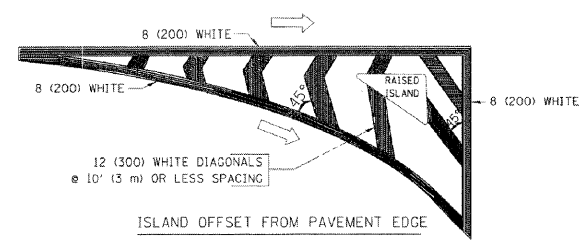

TYPICAL ISLAND MARKING

TYPE OF MARKING	WIDTH OF LINE	PATTERN	COLOR	SPACING / REMARKS
CENTERLINE ON 2 LANE PAVEMENT	4 (100)	SKIP-DASH	YELLOW	10' (3 m) LINE WITH 30' (9 m) SPACE
CENTERLINE ON MULTI-LANE UNDIVIDED PAVEMENT	2 @ 4 (100)	SOLID	YELLOW	11 (280) C-C
NO PASSING ZONE LINES FOR ONE DIRECTION FOR BOTH DIRECTIONS	4 (100) 2 @ 4 (100)	SOLID SOLID	YELLOW YELLOW	5 1/2 (140) C-C FROM SKIP-DASH CENTERLINE 11 (280) C-C OMIT SKIP-DASH CENTERLINE BETWEEN
LANE LINES	4 (100) 5 (125) ON FREEWAYS	SKIP-DASH SKIP-DASH	WHITE WHITE	10' (3 m) LINE WITH 30' (9 m) SPACE
DOTTED LINES (EXTENSIONS OF CENTER, LANE OR TURN LANE MARKINGS)	SAME AS LINE BEING EXTENDED	SKIP-DASH	SAME AS LINE BEING EXTENDED	2' (600) LINE WITH 6' (1.8 m) SPACE
EDGE LINES	4 (100)	SOLID	YELLOW-LEFT WHITE-RIGHT	OUTLINE MOUNTABLE MEDIANS IN YELLOW; EDGE LINES ARE NOT USED NEXT TO BARRIER CURB
TURN LANE MARKINGS	6 (150) LINE; FULL SIZE LETTERS & SYMBOLS (8' (2.4m))	SOLID	WHITE	SEE TYPICAL TURN LANE MARKING DETAIL
TWO WAY LEFT TURN MARKING	2 @ 4 (100) EACH DIRECTION 8' (2.4m) LEFT ARROW	SKIP-DASH AND SOLID IN PAIRS	YELLOW WHITE	10' (3 m) LINE WITH 30' (9 m) SPACE FOR SKIP-DASH; 5 1/2 (140) C-C BETWEEN SOLID LINE AND SKIP-DASH LINE SEE TYPICAL TWO-WAY LEFT TURN MARKING DETAIL
CROSSWALK LINES (PEDESTRIAN) A. DIAGONALS (BIKE & EQUESTRIAN) B. LONGITUDINAL BARS (SCHOOL)	2 @ 6 (150) 12 (300) @ 45° 12 (300) @ 90°	SOLID SOLID SOLID	WHITE WHITE WHITE	NOT LESS THAN 6' (1.8 m) APART 2' (600) APART 2' (600) APART SEE TYPICAL CROSSWALK MARKING DETAILS.
STOP LINES	24 (600)	SOLID	WHITE	PLACE 4' (1.2 m) IN ADVANCE OF AND PARALLEL TO CROSSWALK, IF PRESENT. OTHERWISE, PLACE AT DESIRED STOPPING POINT, PARALLEL TO CROSSROAD CENTERLINE, WHERE POSSIBLE.
PAINTED MEDIANS	2 @ 4 (100) WITH 12 (300) DIAGONALS @ 45° NO DIAGONALS USED FOR 4' (1.2 m) WIDE MEDIANS	SOLID	YELLOW; TWO WAY TRAFFIC WHITE; ONE WAY TRAFFIC	11 (280) C-C FOR THE DOUBLE LINE SEE TYPICAL PAINTED MEDIAN MARKING.
GORE MARKING AND CHANNELIZING LINES	8 (200) WITH 12 (300) DIAGONALS @ 45°	SOLID	WHITE	DIAGONALS: 15' (4.5 m) C-C (LESS THAN 30MPH (50 km/h)) 20' (6 m) C-C 30MPH (50 km/h) TO 45MPH (70 km/h) 30' (9 m) C-C (OVER 45MPH (70 km/h))
RAILROAD CROSSING	24 (600) TRANSVERSE LINES; "RR" 15 6' (1.8 m) LETTERS; 16 (400) LINE FOR "X"	SOLID	WHITE	SEE STATE STANDARD 780001 AREA OF "R"=3.6 SQ. FT. (0.33 m <sup>2</sup> ) EACH "X"=54.0 SQ. FT. (5.0 m <sup>2</sup> )
SHOULDER DIAGONALS	12 (300) @ 45°	SOLID	WHITE - RIGHT YELLOW - LEFT	50' (15 m) C-C (LESS THAN 30MPH (50 km/h)) 75' (25 m) C-C (30 MPH (50 km/h) TO 45MPH (70 km/h)) 150' (45 m) C-C (OVER 45MPH (70 km/h))

FOR FURTHER DETAILS ON PAVEMENT MARKING REFER TO STANDARD SPECIFICATIONS FOR ROAD AND BRIDGE CONSTRUCTION AND STATE STANDARD 780001.

All dimensions are in inches (millimeters) unless otherwise shown.

DISTRICT ONE TYPICAL PAVEMENT MARKINGS

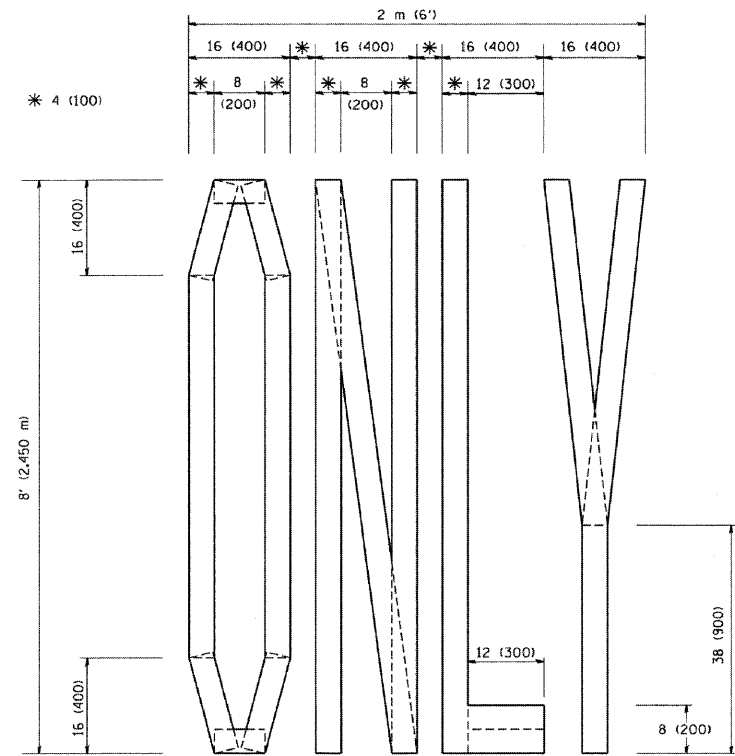

QUANTITY  
 4 (100) LINE = 64.1 ft. (19.7 m)  
 21.1 sq. ft. (1.97 sq. m)

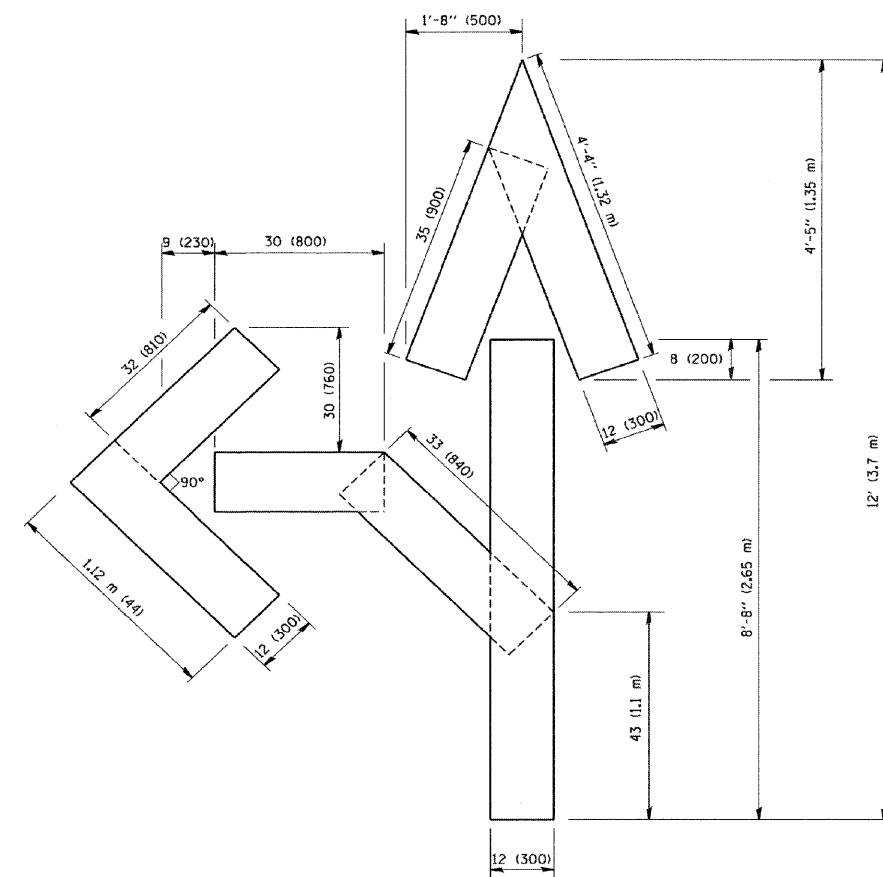

QUANTITY  
 4 (100) LINE = 82.5 ft. (25.3 m)  
 27.5 sq. ft. (2.53 sq. m)

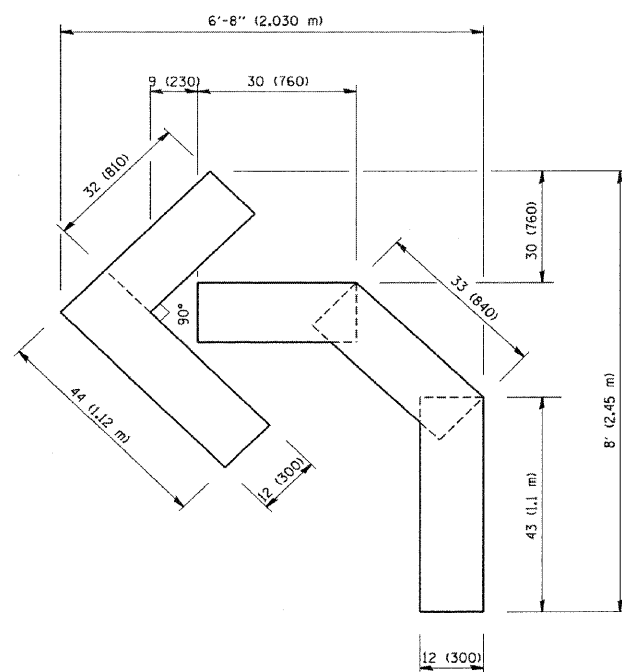

QUANTITY  
 4 (100) LINE = 45.5 ft. (13.9 m)  
 15.2 sq. ft. (1.39 sq. m)

REVISED -T. RAMMACHER 06-05-96  
 REVISED -T. RAMMACHER 11-04-97  
 REVISED -T. RAMMACHER 03-02-98  
 REVISED -E. GOMEZ 08-28-00

### DISTRICT ONE TYPICAL PAVEMENT MARKINGS



SIGNING FOR FLAGGING OPERATIONS AT WORK ZONE OPENINGS

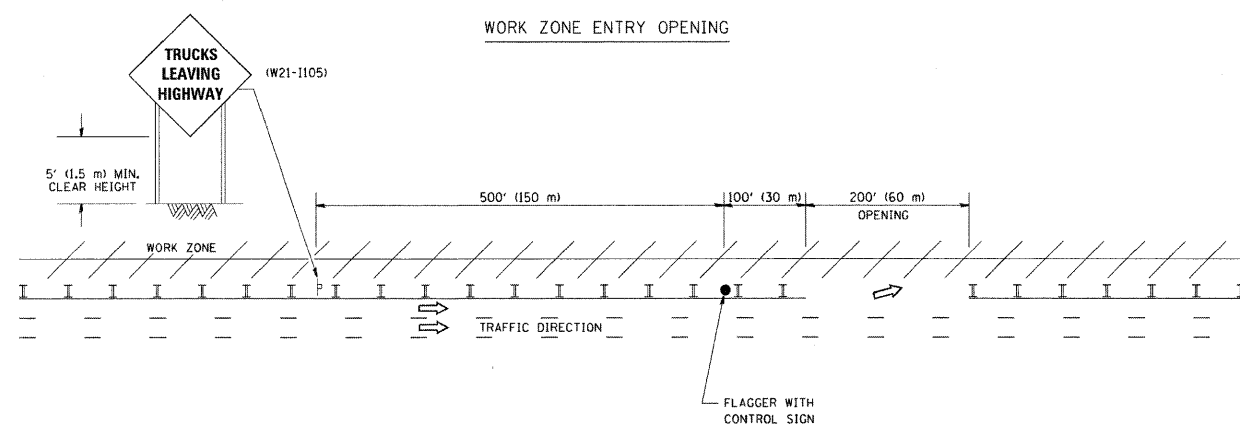
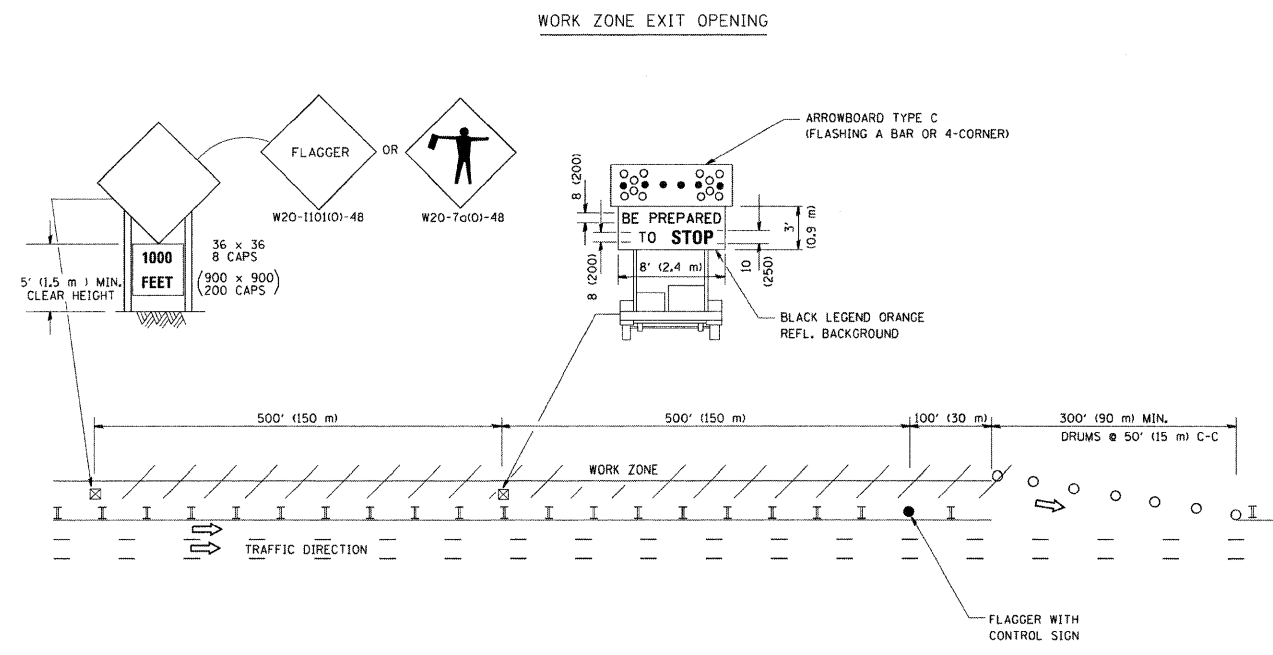

NOTES:

1. The Arrowboard, the Flagger Ahead trailer mounted sign, and the Trucks Leaving Highway sign shall be removed or turned away from traffic and the exit and entry openings shall be closed when the flagging operation ceases.
2. Work Zone Exit Openings should be a minimum of one half mile apart.
3. Exiting the work zone at any place other than at a Work Zone Exit Opening will be prohibited.
4. All vehicles shall enter the work zone at entry openings, using their turn signals to warn motorists

REVISED	-	D.W.S. 08-98
REVISED	-	J.A.F. 04-03
REVISED	-	J.A.F. 02-06
REVISED	-	S.P.B. 01-07

ALL DIMENSIONS ARE IN INCHES (MILLIMETERS) UNLESS OTHERWISE SHOWN

SIGNING FOR FLAGGING OPERATIONS AT WORK ZONE OPENINGS

**LOWCO, INC.**  
CONSULTING ENGINEERS  
1560 WALL ST., SUITE 222  
NAPERVILLE, ILLINOIS 60563 PH: 630/577-9100

USER NAME = #USER#	DESIGNED - MJY	
	DRAWN - ST, TSC	REVISED -
PLOT SCALE = #SCALE#	CHECKED - MJY	REVISED -
PLOT DATE = #DATE#	DATE - 1/29/2010	REVISED -

STATE OF ILLINOIS  
DEPARTMENT OF TRANSPORTATION

DISTRICT ONE DETAIL SHEETS  
IL ROUTE 25 OVER POPLAR CREEK  
SCALE: NONE SHEET NO. 17 OF 18 SHEETS STA. 365+14.15 TO STA. 365+68.01

F.A.P. RTE. 360	SECTION 49 B-1	COUNTY KANE	TOTAL SHEETS 18	SHEET NO. 17
D-91-237-10		CONTRACT NO. 60J47		
FED. ROAD DIST. NO.		ILLINOIS FED. AID PROJECT		

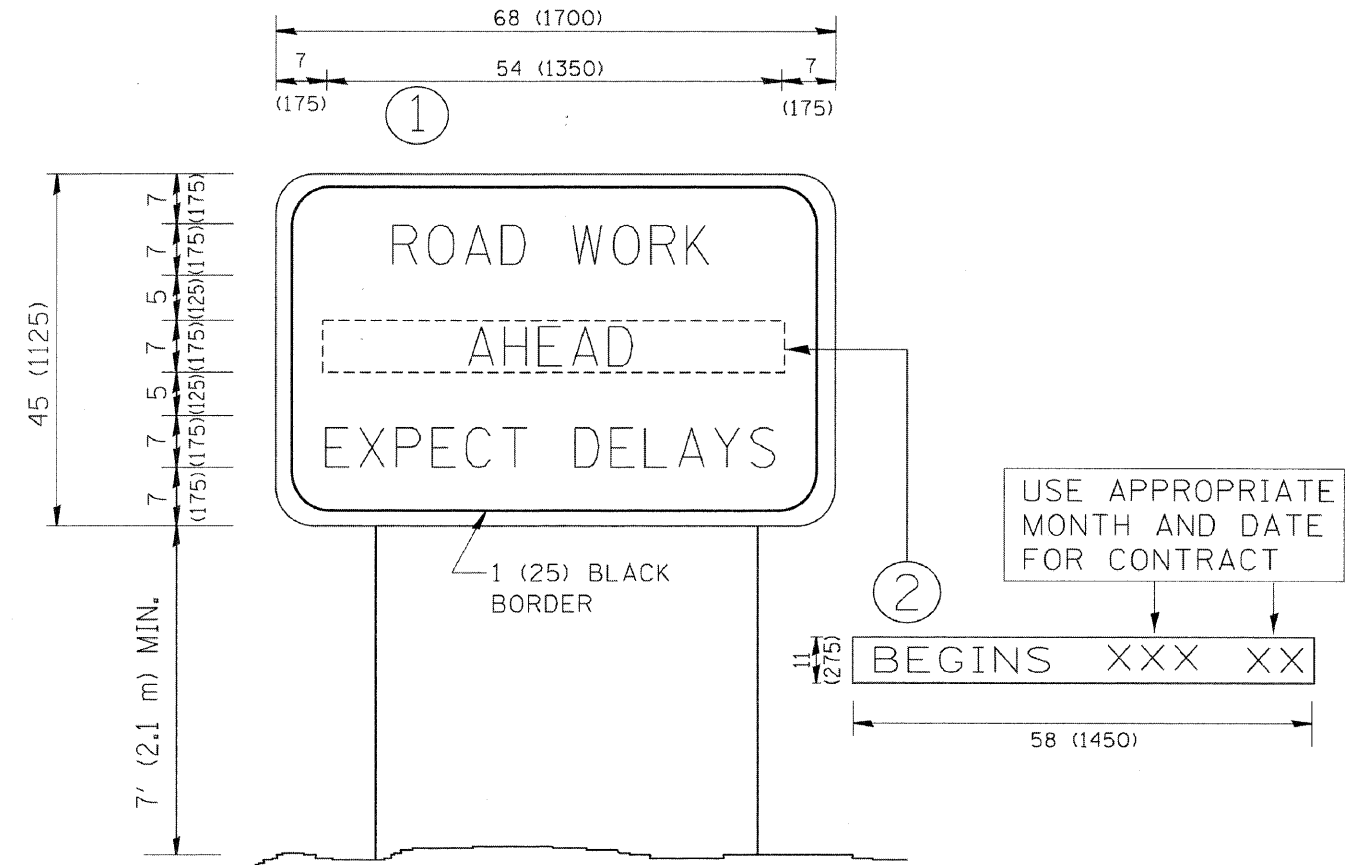

**NOTES:**

1. USE BLACK LETTERING ON ORANGE BACKGROUND.
2. ERECT SIGNS IN ADVANCE OF THE LOCATION FOR THE "ROAD CONSTRUCTION AHEAD" SIGN AT LOCATIONS AS DIRECTED BY THE ENGINEER.
3. ERECT SIGN ① WITH INSTALLED PANEL ② ONE WEEK PRIOR TO THE START OF CONSTRUCTION.
4. REMOVE PANEL ② SOON AFTER THE START OF CONSTRUCTION.
5. SEE SPECIAL PROVISION FOR "TEMPORARY INFORMATION SIGNING" FOR ADDITIONAL INFORMATION.
6. ONE SIGN ASSEMBLY EQUALS 25.70 SQ. FT. (2.3 SQ. M.)
7. SHALL BE PAID FOR AS TEMPORARY INFORMATION SIGNING.

REVISED	-	R. MIRS	09-15-97
REVISED	-	R. MIRS	12-11-97
REVISED	-	T. RAMMACHER	02-02-99
REVISED	-	C. JUCIUS	01-31-07

ALL DIMENSIONS ARE IN INCHES (MILLIMETERS) UNLESS OTHERWISE SHOWN.

**ARTERIAL ROAD INFORMATION SIGN**

USER NAME = #USER#	DESIGNED - MJY	REVISED -
	DRAWN - ST, TSC	REVISED -
PLOT SCALE = #SCALE#	CHECKED - MJY	REVISED -
PLOT DATE = #DATE#	DATE - 1/29/2010	REVISED -

F.A.P. RTE. 360	SECTION 49 B-1	COUNTY KANE	TOTAL SHEETS 18	SHEET NO. 18
D-91-237-10			CONTRACT NO. 60J47	
FED. ROAD DIST. NO. ILLINOIS FED. AID PROJECT				