

STATE OF ILLINOIS  
 DEPARTMENT OF TRANSPORTATION  
 DIVISION OF HIGHWAYS

**PROPOSED  
 HIGHWAY PLANS**

F.A.I. 55 (I-55 W. FRONTAGE RD.)  
 CAVANAUGH RD. TO MURPHY RD.  
 SECTION: 99-2AC-1-RS-2

RESURFACING  
 WILL COUNTY  
 C-91-264-10

F.A.I. RTE.	SECTION	COUNTY	TOTAL SHEETS	SHEET NO.
55	99-2AC-1-RS-2	WILL	15	1
ILLINOIS			CONTRACT NO. 60J74	

FOR INDEX OF SHEETS, SEE SHEET NO. 2

THE PROJECT IS LOCATED IN UNINCORPORATED WILMINGTON TOWNSHIP IN WILL COUNTY.

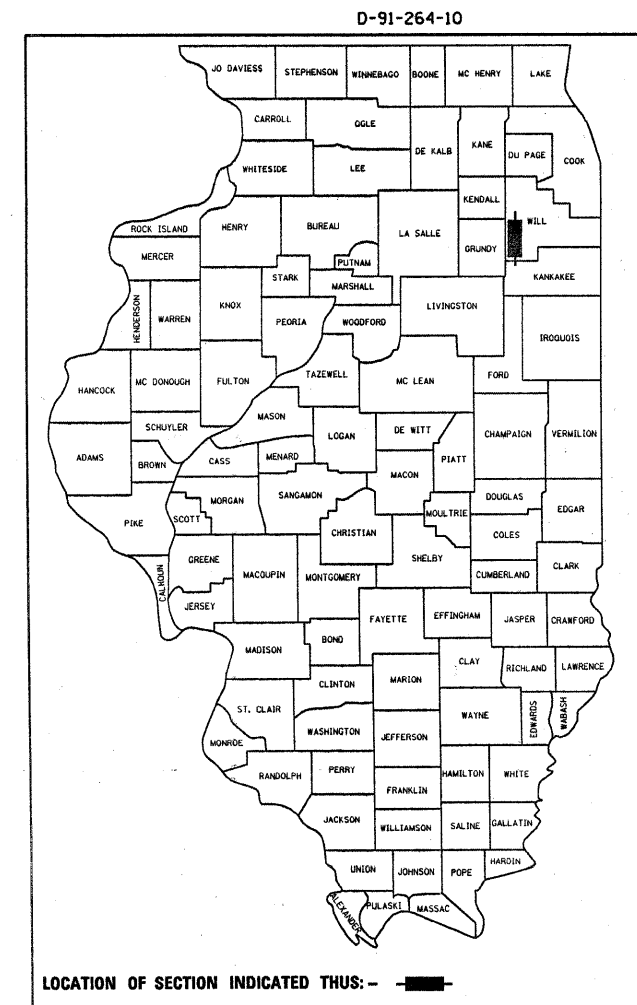

PROJECT ENDS:  
 STA. 107+98

PROJECT BEGINS:  
 STA. 10+11

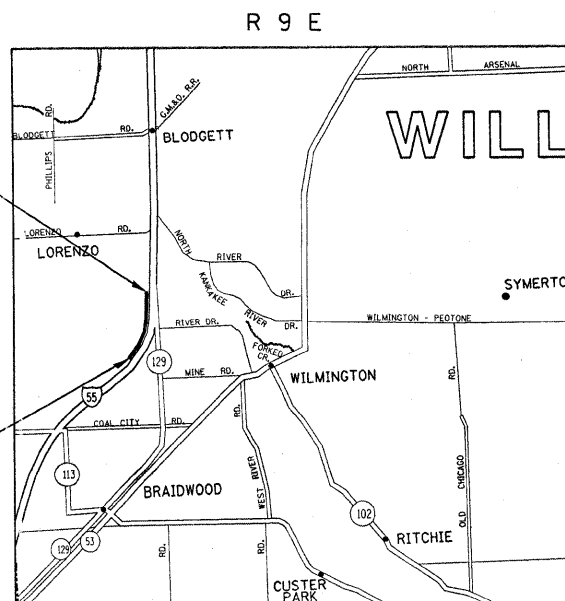

WILMINGTON TOWNSHIP

GROSS AND NET LENGTH OF PROJECT = 9,787 FT. = 1.85 MILE



**TRAFFIC DATA**

2006 ADT = 236  
 SPEED LIMIT = 45 mph

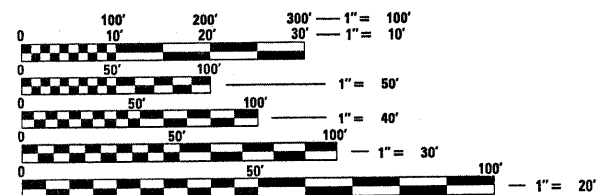

FULL SIZE PLANS HAVE BEEN PREPARED USING STANDARD ENGINEERING SCALES. REDUCED SIZED PLANS WILL NOT

ON REDUCED PLANS, THE ABOVE SCALES MAY BE USED.

J.U.L.I.E.  
 JOINT UTILITY LOCATION INFORMATION FOR EXCAVATION  
 1-800-892-0123  
 OR 811

PROJECT ENGINEER KARI SMITH (847) 705-4437  
 PROJECT MANAGER KEN ENG

CONTRACT NO. 60J74

STATE OF ILLINOIS  
 DEPARTMENT OF TRANSPORTATION  
 DIVISION OF HIGHWAYS

SUBMITTED JANUARY 26, 2010  
Diana M. O'Keefe  
 DEPUTY DIRECTOR OF HIGHWAYS, REGION ENGINEER

March 19, 2010  
Scott E. Stitt, P.E.  
 ACTING ENGINEER OF DESIGN AND ENVIRONMENT

March 19, 2010  
Christine M. Reed  
 DIRECTOR OF HIGHWAYS, CHIEF ENGINEER

**PRINTED BY THE AUTHORITY  
 OF THE STATE OF ILLINOIS**

INDEX OF SHEETS

GENERAL NOTES:

<u>SHEET NO.</u>	<u>DESCRIPTION</u>
1	TITLE SHEET
2	INDEX OF SHEETS, STATE STANDARDS & GENERAL NOTES
3	SUMMARY OF QUANTITIES
4	EXISTING AND PROPOSED TYPICAL SECTIONS
5-8	ROADWAY AND PAVEMENT MARKING PLANS
9	DRIVEWAY DETAILS - DISTANCE BETWEEN R.O.W. AND FACE OF CURB & EDGE OF SHOULDER >= 15'
10	BUTT JOINT AND HMA TAPER
11	TRAFFIC CONTROL AND PROTECTION FOR SIDE ROADS, INTERSECTIONS, AND DRIVEWAYS
12	TYPICAL APPLICATIONS RAISED REFLECTIVE PAVEMENT MARKERS (SNOW-PLOW RESISTANT)
13	DISTRICT ONE TYPICAL PAVEMENT MARKINGS
14	PAVEMENT MARKING LETTERS AND SYMBOLS FOR TRAFFIC STAGING
15	ARTERIAL INFORMATION SIGNING

BEFORE STARTING ANY EXCAVATION, THE CONTRACTOR SHALL CALL "JULIE" AT (800) 892-0123 OR 811 FOR FIELD LOCATIONS OF BURIED ELECTRIC, TELEPHONE, AND GAS FACILITIES. (48 HOUR NOTIFICATION REQUIRED)

THE CONTRACTOR SHALL COORDINATE CONSTRUCTION ACTIVITIES WITH UTILITY COMPANIES.

THE CONTRACTOR WILL NOT BE ABLE TO SET UP A YARD OR FIELD OFFICE ON STATE PROPERTY WITHOUT THE WRITTEN PERMISSION OF THE DEPARTMENT.

HOT-MIX ASPHALT TAPERS SHALL BE INSTALLED AT THE ENDS OF PULVERIZATION (WHERE PULVERIZED PAVEMENT MEETS EXISTING PAVEMENT) IN ACCORDANCE WITH THE "BUTT JOINT AND HMA TAPER DETAILS" SHEET INCLUDED IN THE PLANS UNLESS OTHERWISE SPECIFIED.

THE RESIDENT ENGINEER SHALL CONTACT MS. CORA MATHIS, AREA TRAFFIC FIELD ENGINEER, AT (815) 485-6475 A MINIMUM OF 2 WEEKS PRIOR TO PLACEMENT OF FINAL PAVEMENT MARKINGS.

WHEN MILLED PAVEMENT IS OPEN TO TRAFFIC, THE MAXIMUM GRADE DIFFERENTIAL BETWEEN PASSES OF THE MILLING MACHINE SHALL NOT EXCEED 1 1/2 INCHES WHERE THE SPEED LIMIT IS 45 MPH OR LESS, AND 1 INCH WHERE THE SPEED LIMIT IS OVER 45 MPH. WITH WRITTEN APPROVAL FROM THE RESIDENT ENGINEER, A MAXIMUM GRADE DIFFERENTIAL OF 3 INCHES MAY BE ALLOWED IF THE EDGE OF THE MILLING IS SLOPED A MINIMUM OF 1:3 (V:H).

THE RESIDENT ENGINEER SHALL VERIFY LOCATIONS OF ALL EXISTING PAVEMENT MARKINGS PRIOR TO MILLING OR RESURFACING.

THE RESIDENT ENGINEER SHALL CONTACT THE TRAFFIC CONTROL SUPERVISOR AT (847) 705-4470 A MINIMUM OF 72 HOURS PRIOR TO THE INSTALLATION OF ANY TEMPORARY TRAFFIC CONTROL DEVICES.

STATE STANDARDS:

<u>SHEET NO.</u>	<u>DESCRIPTION:</u>
000001-05	STANDARD SYMBOLS, ABBREVIATIONS, AND PATTERNS
406201-01	MAILBOX TURNOUTS
630001-00	GUARDRAIL STEEL PLATE BEAM
630301-05	TRAFFIC BARRIER TERMINAL, TYPE 1 SPECIAL, SHOULDER WIDENING FOR
635006-03	REFLECTOR AND TERMINAL MARKER PLACEMENT
701301-03	LANE CLOSURE, 2L, 2W, SHORT TIME OPERATIONS
701311-03	LANE CLOSURE, 2L, 2W, MOVING OPERATIONS - DAY ONLY
701501-05	URBAN LANE CLOSURE, 2L, 2W, UNDIVIDED
701901-01	TRAFFIC CONTROL DEVICES

FILE NAME =	USER NAME = rosierem	DESIGNED -	REVISED -	<b>STATE OF ILLINOIS DEPARTMENT OF TRANSPORTATION</b>	<b>I-55 WEST FRONTAGE ROAD (CAVANAUGH ROAD TO MURPHY ROAD) INDEX OF SHEETS, STATE STANDARDS, &amp; GENERAL NOTES</b>	F.A.I. RTE.	SECTION	COUNTY	TOTAL SHEETS	SHEET NO.
ct:\pwwork\pwwid001\rosierejm\20175433\01	6410-sht-plan.dgn	DRAWN -	REVISED -			55	99-2AC-1-RS-2	WIL	15	2
	PLOT SCALE = 50.0000' / IN.	CHECKED -	REVISED -			CONTRACT NO. 60J74				
	PLOT DATE = 1/30/2010	DATE -	REVISED -			SCALE:	SHEET NO. OF SHEETS	STA.	TO STA.	ILLINOIS FED. AID PROJEC

SUMMARY OF QUANTITIES				URBAN CONSTRUCTION TYPE CODE					SUMMARY OF QUANTITIES				URBAN CONSTRUCTION TYPE CODE					
CODE NO	ITEM	UNIT	TOTAL QUANTITIES 100% STATE	1000					CODE NO	ITEM	UNIT	TOTAL QUANTITIES 100% STATE	1000					
20201006	GRADING AND SHAPING SHOULDERS	UNIT	190	190					70300220	TEMPORARY PAVEMENT MARKING - LINE 4"	FOOT	21989	21989					
20201200	REMOVAL AND DISPOSAL OF UNSUITABLE MATERIAL	CU YD	130	130					70301000	WORK ZONE PAVEMENT MARKING REMOVAL	SO FT	885	885					
21400100	GRADING AND SHAPING DITCHES	FOOT	600	600					• 78000200	THERMOPLASTIC PAVEMENT MARKING - LINE 4"	FOOT	21989	21989					
35101400	AGGREGATE BASE COURSE, TYPE B	TON	1295	1295					• 78100100	RAISED REFLECTIVE PAVEMENT MARKER	EACH	124	124					
35102000	AGGREGATE BASE COURSE, TYPE B 8"	SO YD	711	711					* 78200420	GUARDRAIL MARKERS, TYPE B	EACH	2	2					
35501308	HOT-MIX ASPHALT BASE COURSE, 6"	SO YD	167	167					* 78201000	TERMINAL MARKER - DIRECT APPLIED	EACH	2	2					
40600200	BITUMINOUS MATERIALS (PRIME COAT)	TON	19	19					78300200	RAISED REFLECTIVE PAVEMENT MARKER REMOVAL	EACH	80	80					
40600300	AGGREGATE (PRIME COAT)	TON	92	92					X0322256	TEMPORARY INFORMATION SIGNING	SO FT	51.4	51.4					
40600400	MIXTURE FOR CRACKS, JOINTS, AND FLANGEWAYS	TON	35	35					X0326861	PULVERIZATION	SO YD	21394	21394					
40600895	CONSTRUCTING TEST STRIP	EACH	1	1					21101615	TOPSOIL FURNISH AND PLACE 4"	SQ YD	1800	1800					
40603080	HOT-MIX ASPHALT BINDER COURSE, IL-19.0, N50	TON	5319	5319					25000210	SEEDING, CLASS 2A	ACRE	0.4	0.4					
40603310	HOT-MIX ASPHALT SURFACE COURSE, MIX "C", N50	TON	80	80					25000400	NITROGEN FERTILIZER NUTRIENT	POUND	34	34					
40603340	HOT-MIX ASPHALT SURFACE COURSE, MIX "D", N70	TON	1920	1920					25000500	PHOSPHORUS FERTILIZER NUTRIENT	POUND	34	34					
44000200	DRIVEWAY PAVEMENT REMOVAL	SO YD	134	134					25000600	POTASSIUM FERTILIZER NUTRIENT	POUND	34	34					
48101200	AGGREGATE SHOULDERS, TYPE B	TON	1736	1736					25100030	EROSION CONTROL BLANKET	SQ YD	1800	1800					
48203015	HOT-MIX ASPHALT SHOULDERS, 4 1/2"	SO YD	35	35														
50105220	PIPE CULVERT REMOVAL	FOOT	160	160														
54213657	PRECAST REINFORCED CONCRETE FLARED END SECTIONS 12"	EACH	2	2														
54213663	PRECAST REINFORCED CONCRETE FLARED END SECTIONS 18"	EACH	8	8														
54247110	GRATING FOR CONCRETE FLARED END SECTION 18"	EACH	8	8														
542A0217	PIPE CULVERTS, CLASS A, TYPE 1 12"	FOOT	20	20														
542A0223	PIPE CULVERTS, CLASS A, TYPE 1 18"	FOOT	140	140														
* 63000001	STEEL PLATE BEAM GUARDRAIL, TYPE A, 6 FOOT POSTS	FOOT	130	130														
* 63100167	TRAFFIC BARRIER TERMINAL, TYPE 1 (SPECIAL) TANGENT	EACH	2	2														
63200310	GUARDRAIL REMOVAL	FOOT	26	26														
67000400	ENGINEER'S FIELD OFFICE, TYPE A	CAL MO	6	6														
67100100	MOBILIZATION	L SUM	1	1														
70102620	TRAFFIC CONTROL AND PROTECTION, STANDARD 701501	L SUM	1	1														
70300100	SHORT-TERM PAVEMENT MARKING	FOOT	2654	2654														

\* DENOTES SPECIALTY ITEM

Rev

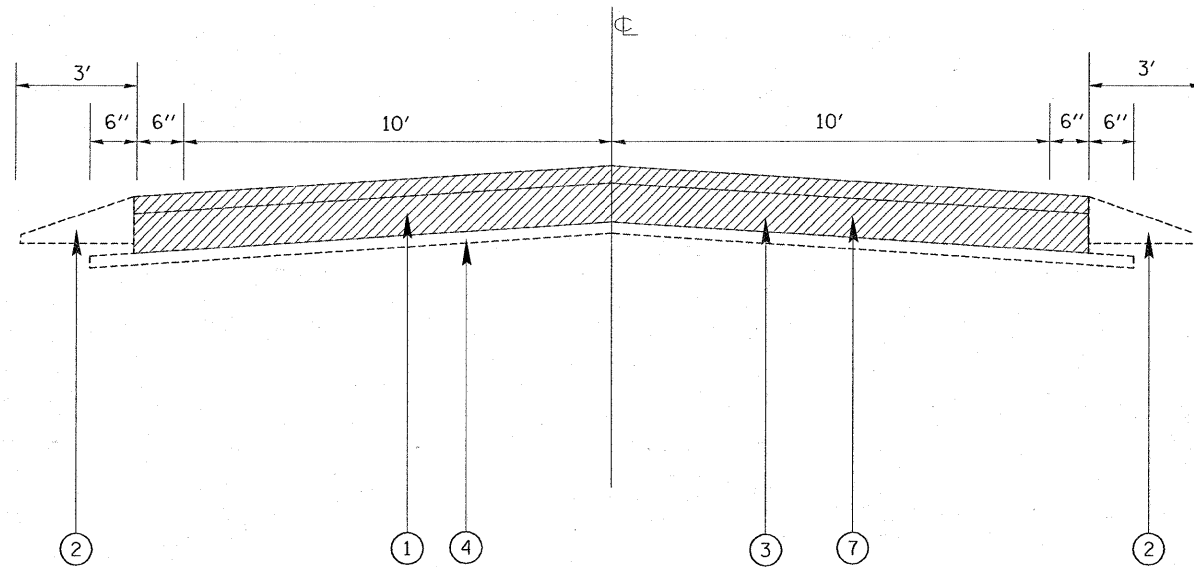

I-55 WEST FRONTAGE ROAD  
EXISTING TYPICAL SECTION  
STA. 10+11 TO STA. 107+18

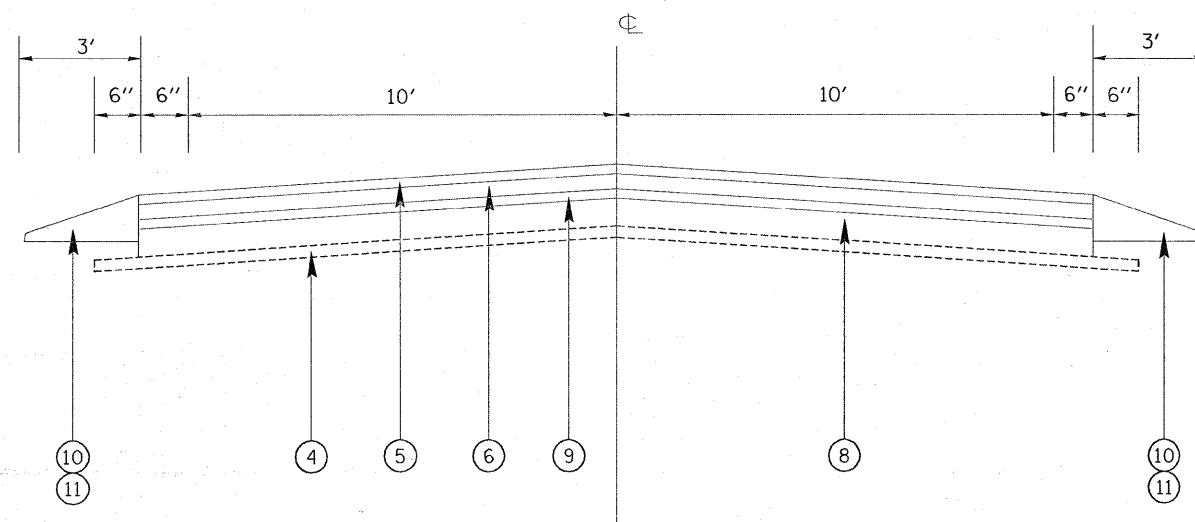

I-55 WEST FRONTAGE ROAD  
TYPICAL PROPOSED SECTION  
STA. 10+11 TO 107+18

**LEGEND**

- ① EXISTING HMA SURFACE, ± 1.5"
- ② EXISTING AGGREGATE SHOULDER
- ③ EXISTING COMPACTED GRAVEL OR CRUSHED STONE BASE COURSE ± 7"
- ④ EXISTING SUB-BASE GRANULAR MATERIAL, ± 5"
- ⑤ PROPOSED HMA SURFACE COURSE, MIX D, N70, (IL 9.5 MM) 1-1/2"
- ⑥ PROPOSED HOT-MIX ASPHALT BINDER IL-19.0, N50, 4-1/2" (IN 1 LIFT)
- ⑦ PROPOSED PULVERIZATION, 8.5"
- ⑧ PROPOSED PULVERIZED MATERIAL, 8.5"
- ⑨ PROPOSED AGGREGATE BASE COURSE, TYPE B, 2"
- ⑩ PROPOSED AGGREGATE SHOULDER, TYPE B
- ⑪ PROPOSED SHAPING AND GRADING SHOULDERS

**HOT-MIX ASPHALT MIXTURE REQUIREMENTS**

	MIXTURE USE	AIR VOIDS (%)
ROADWAY	HOT-MIX ASPHALT SURFACE COURSE, MIX "D", N70 (IL 9.5 MM), 1 1/2"	4% @ 70 GYR
	HOT-MIX ASPHALT BINDER, IL-19.0, N50, 4 1/2"	4% @ 50 GYR
DRIVEWAY	HOT-MIX ASPHALT BASE COURSE, 6" (HMA BINDER, IL-19 MM)	4% @ 50 GYR
	HOT-MIX ASPHALT SURFACE COURSE, MIX "C" N50 (IL 9.5 MM) 2"	4% @ 50 GYR

THE UNIT WEIGHT USED TO CALCULATE ALL HOT-MIX ASPHALT SURFACE MIXTURE QUANTITIES IS 112 LBS/SY/IN.

\* THE "AC TYPE FOR POLYMERIZED HMA MIXES SHALL BE "SBS/SBR PG 70-22" AND FOR NON POLYMERIZED HMA THE "AC TYPE" SHALL BE "PG 64-22" UNLESS MODIFIED BY DISTRICT 1 SPECIAL PROVISIONS.  
FOR "PERCENT OF RAP" SEE DISTRICT 1 SPECIAL PROVISIONS

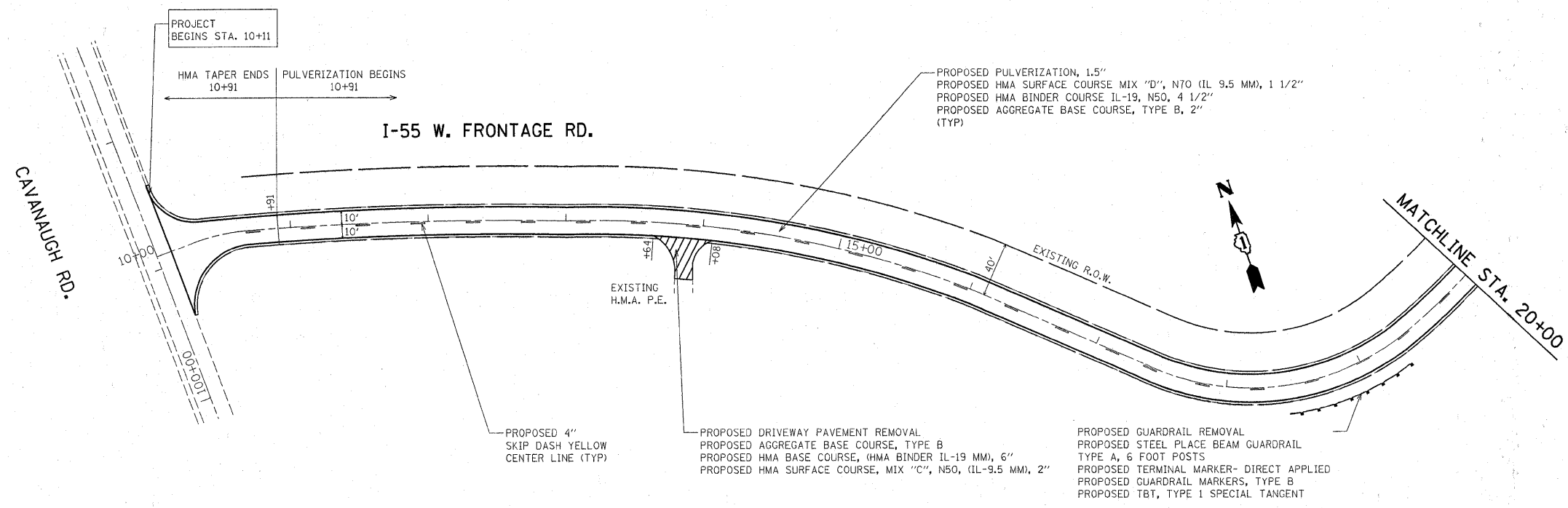

PROPOSED PULVERIZATION, 1.5"  
 PROPOSED HMA SURFACE COURSE MIX "D", N70 (IL 9.5 MM), 1 1/2"  
 PROPOSED HMA BINDER COURSE IL-19, N50, 4 1/2"  
 PROPOSED AGGREGATE BASE COURSE, TYPE B, 2"  
 (TYP)

PROPOSED 4" SKIP DASH YELLOW CENTER LINE (TYP)

PROPOSED DRIVEWAY PAVEMENT REMOVAL  
 PROPOSED AGGREGATE BASE COURSE, TYPE B  
 PROPOSED HMA BASE COURSE, (HMA BINDER IL-19 MM), 6"  
 PROPOSED HMA SURFACE COURSE, MIX "C", N50, (IL-9.5 MM), 2"

PROPOSED GUARDRAIL REMOVAL  
 PROPOSED STEEL PLACE BEAM GUARDRAIL TYPE A, 6 FOOT POSTS  
 PROPOSED TERMINAL MARKER- DIRECT APPLIED  
 PROPOSED GUARDRAIL MARKERS, TYPE B  
 PROPOSED TBT, TYPE 1 SPECIAL TANGENT

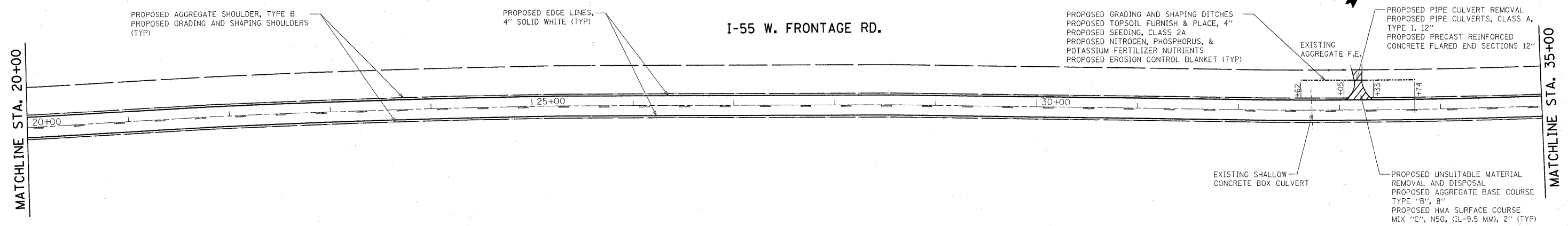

PROPOSED GRADING AND SHAPING DITCHES  
 PROPOSED TOPSOIL FURNISH & PLACE, 4"  
 PROPOSED SEEDING, CLASS 2A  
 PROPOSED NITROGEN, PHOSPHORUS, & POTASSIUM FERTILIZER NUTRIENTS  
 PROPOSED EROSION CONTROL BLANKET (TYP)

PROPOSED PIPE CULVERT REMOVAL  
 PROPOSED PIPE CULVERTS, CLASS A, TYPE 1, 12"  
 PROPOSED PRECAST REINFORCED CONCRETE FLARED END SECTIONS 12"

PROPOSED UNSUITABLE MATERIAL REMOVAL AND DISPOSAL  
 PROPOSED AGGREGATE BASE COURSE TYPE "B", 8"  
 PROPOSED HMA SURFACE COURSE MIX "C", N50, (IL-9.5 MM), 2" (TYP)

FILE NAME =	USER NAME = rosierem	DESIGNED -	REVISED -	<b>STATE OF ILLINOIS DEPARTMENT OF TRANSPORTATION</b>	<b>ROADWAY &amp; PAVEMENT MARKING PLAN I-55 W. FRONTAGE RD. (CAVANAUGH RD TO MURPHY RD)</b>			F.A.I. RTE.	SECTION	COUNTY	TOTAL SHEETS	SHEET NO.
ca:\pwork\PWIDOT\ROSIEREM\0175433\0126410-shr-plan.dgn		DRAWN -	REVISED -		55	99-2AC-1-RS-2	WILL	15	5			
PLOT SCALE = 50.0000' / IN.		CHECKED -	REVISED -		SCALE: 1"=50'    SHEET NO. 1 OF 4 SHEETS    STA. 10+11 TO STA. 35+00			CONTRACT NO. 60J74				
PLOT DATE = 3/12/2010		DATE -	REVISED -		ILLINOIS FED. AID PROJECT							

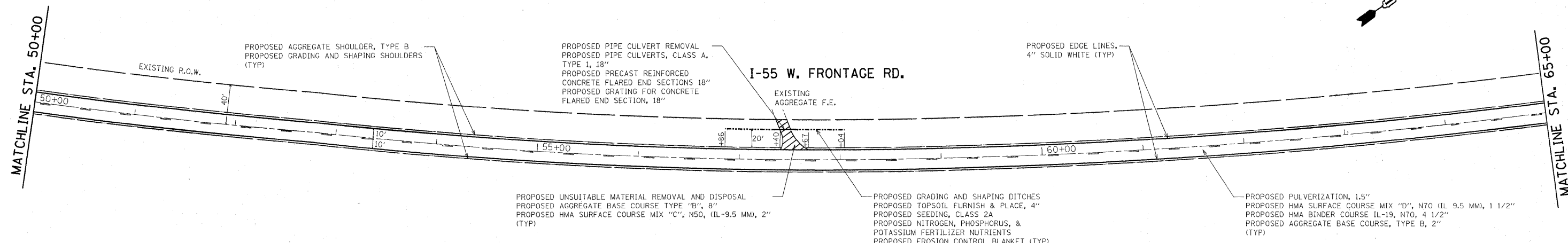
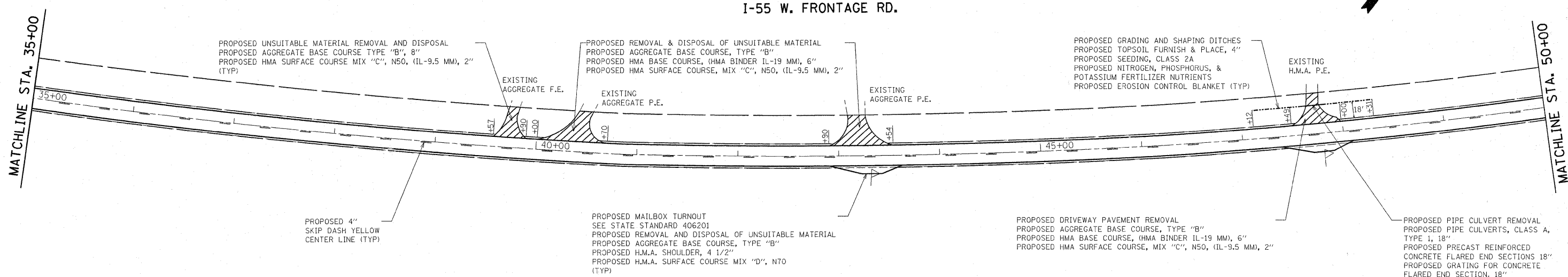

FILE NAME =	USER NAME = rosieremj	DESIGNED -	REVISED -	<b>STATE OF ILLINOIS DEPARTMENT OF TRANSPORTATION</b>	<b>ROADWAY &amp; PAVEMENT MARKING PLAN</b>			F.A.I. RTE.	SECTION	COUNTY	TOTAL SHEETS	SHEET NO.
ca:\pw\work\PWIDOT\ROSIEREMJ\d0175433\DI	26410-sht-plan.dgn	DRAWN -	REVISED -		<b>I-55 W. FRONTAGE RD. (CAVANAUGH RD TO MURPHY RD)</b>			55	99-2AC-1-RS-2	WILL	15	6
	PLOT SCALE = 50,0000 ' / IN.	CHECKED -	REVISED -		SCALE: 1"=50'      SHEET NO. 2 OF 4 SHEETS      STA. 35+00 TO STA. 65+00			CONTRACT NO. 60J74				
	PLOT DATE = 3/12/2010	DATE -	REVISED -		ILLINOIS FED. AID PROJECT							

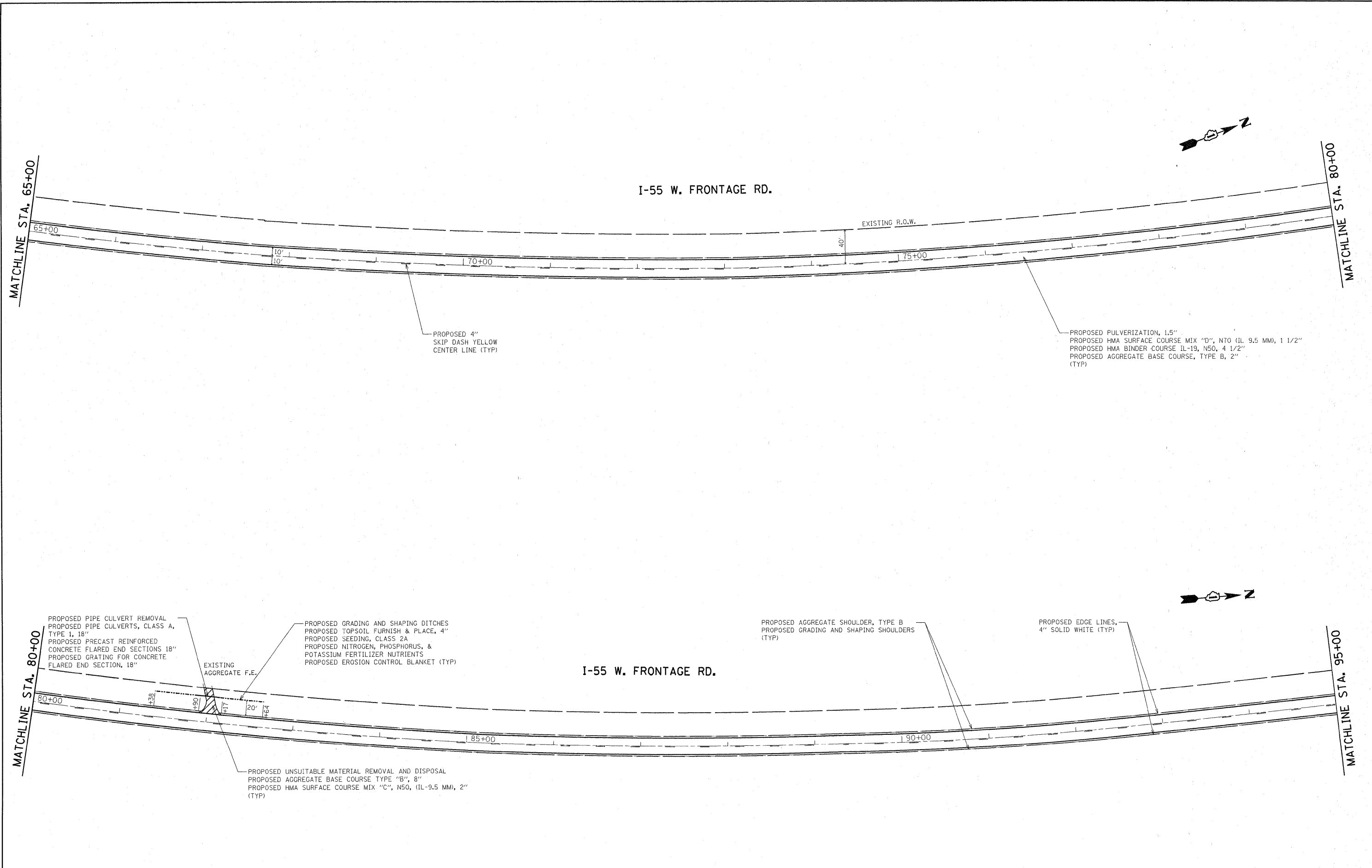

MATCHLINE STA. 65+00

MATCHLINE STA. 80+00

MATCHLINE STA. 80+00

MATCHLINE STA. 95+00

PROPOSED 4"  
SKIP DASH YELLOW  
CENTER LINE (TYP)

PROPOSED PULVERIZATION, 1.5"  
PROPOSED HMA SURFACE COURSE MIX "D", N70 (IL 9.5 MM), 1 1/2"  
PROPOSED HMA BINDER COURSE IL-19, N50, 4 1/2"  
PROPOSED AGGREGATE BASE COURSE, TYPE B, 2"  
(TYP)

PROPOSED PIPE CULVERT REMOVAL  
PROPOSED PIPE CULVERTS, CLASS A,  
TYPE 1, 18"  
PROPOSED PRECAST REINFORCED  
CONCRETE FLARED END SECTIONS 18"  
PROPOSED GRATING FOR CONCRETE  
FLARED END SECTION, 18"

PROPOSED GRADING AND SHAPING DITCHES  
PROPOSED TOPSOIL FURNISH & PLACE, 4"  
PROPOSED SEEDING, CLASS 2A  
PROPOSED NITROGEN, PHOSPHORUS, &  
POTASSIUM FERTILIZER NUTRIENTS  
PROPOSED EROSION CONTROL BLANKET (TYP)

PROPOSED AGGREGATE SHOULDER, TYPE B  
PROPOSED GRADING AND SHAPING SHOULDERS  
(TYP)

PROPOSED EDGE LINES,  
4" SOLID WHITE (TYP)

PROPOSED UNSUITABLE MATERIAL REMOVAL AND DISPOSAL  
PROPOSED AGGREGATE BASE COURSE TYPE "B", 8"  
PROPOSED HMA SURFACE COURSE MIX "C", N50, (IL-9.5 MM), 2"  
(TYP)

FILE NAME =	USER NAME = rosierem	DESIGNED -	REVISED -
ca:\pw\work\PIWIDOT\ROSIEREJM\42175433\DI	6410-shr-plan.dgn	DRAWN -	REVISED -
	PLOT SCALE = 50.0000' / IN.	CHECKED -	REVISED -
	PLOT DATE = 3/12/2010	DATE -	REVISED -

**STATE OF ILLINOIS  
DEPARTMENT OF TRANSPORTATION**

<b>ROADWAY &amp; PAVEMENT MARKING PLAN</b>		
<b>I-55 W. FRONTAGE RD. (CAVANAUGH RD TO MURPHY RD)</b>		
SCALE: 1"=50'	SHEET NO. 3 OF 4 SHEETS	STA. 65+00 TO STA. 95+00

F.A.I. RTE.	SECTION	COUNTY	TOTAL SHEETS	SHEET NO.
55	99-2AC-1-RS-2	WILL	15	7
CONTRACT NO. 60J74				
ILLINOIS FED. AID PROJECT				

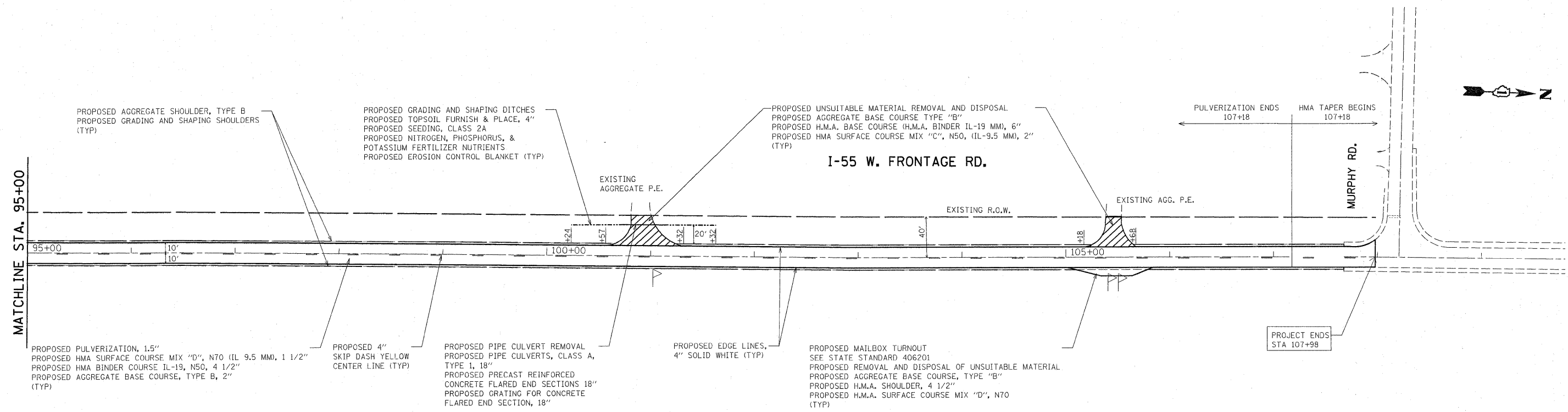

FILE NAME =	USER NAME = rosierjm	DESIGNED -	REVISED -	<b>STATE OF ILLINOIS DEPARTMENT OF TRANSPORTATION</b>	<b>ROADWAY &amp; PAVEMENT MARKING PLAN</b>			F.A.I. RTE.	SECTION	COUNTY	TOTAL SHEETS	SHEET NO.
ca:\pwork\PW100T\ROSIERJM\00175433\01	26410-sht-plan.dgn	DRAWN -	REVISED -		<b>I-55 W. FRONTAGE RD. (CAVANAUGH RD TO MURPHY RD)</b>			55	99-2AC-1-RS-2	WILL	15	8
	PLOT SCALE = 50.0000' / IN.	CHECKED -	REVISED -		SCALE: 1"=50'	SHEET NO. 4 OF 4 SHEETS	STA. 95+00 TO STA. 107+98	CONTRACT NO. 60J74				
	PLOT DATE = 3/12/2010	DATE -	REVISED -		ILLINOIS FED. AID PROJECT							



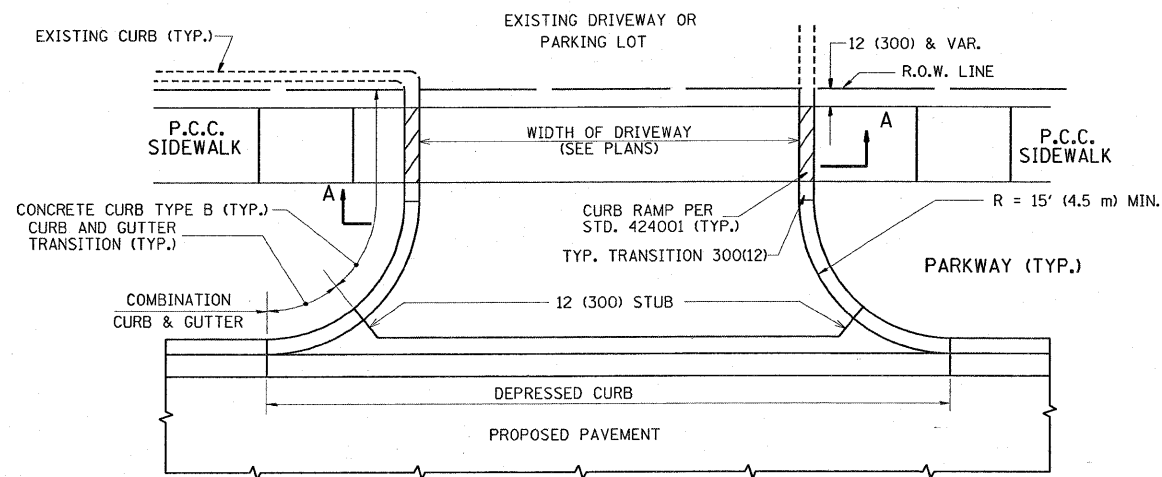

WITH CONCRETE CURB, TYPE B

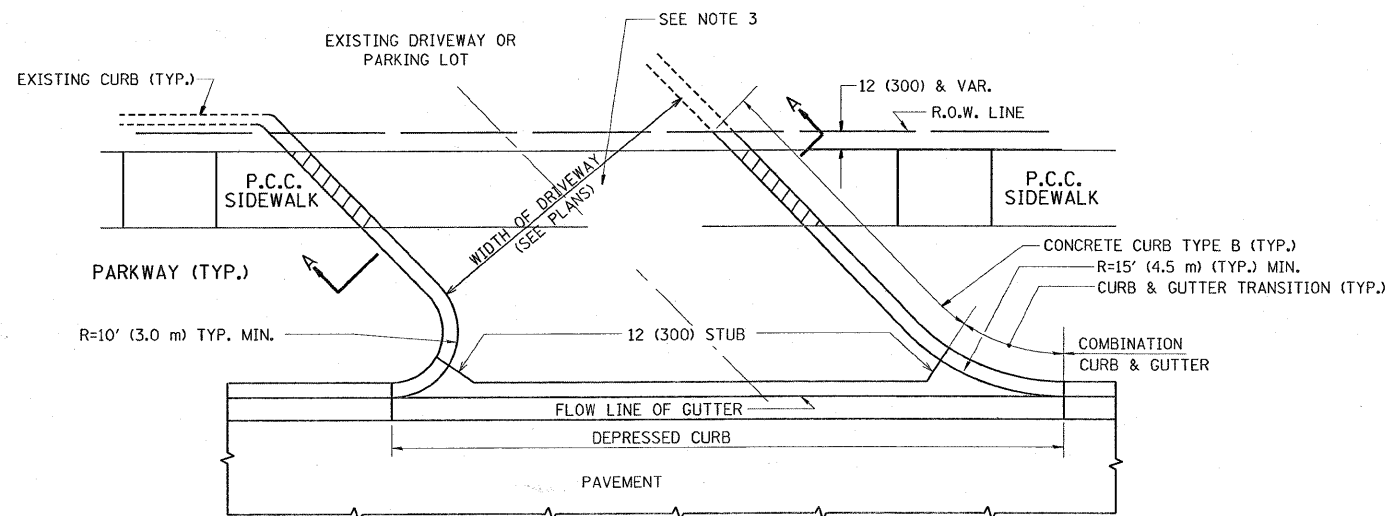

WITH CONCRETE CURB, TYPE B

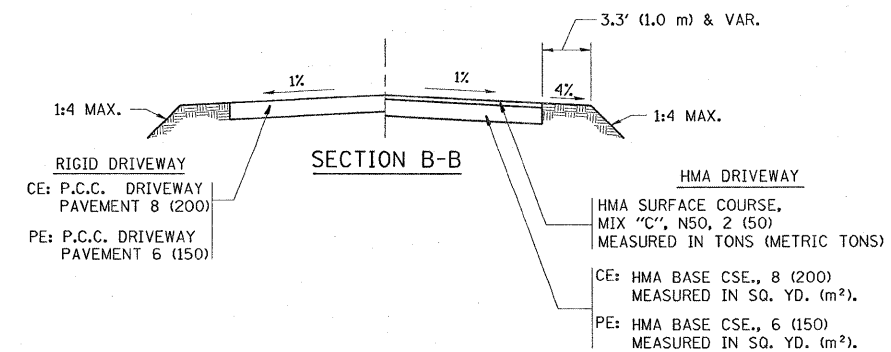
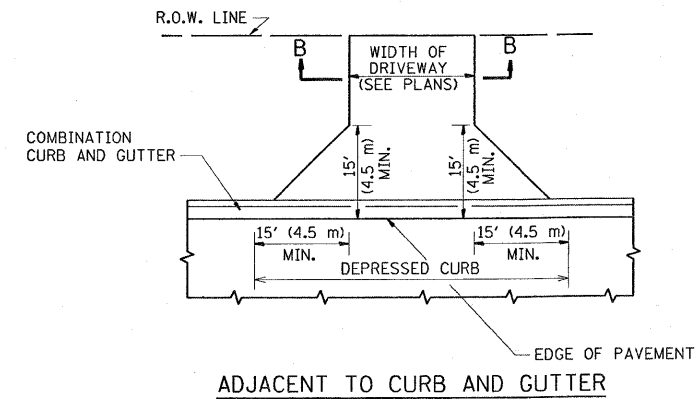
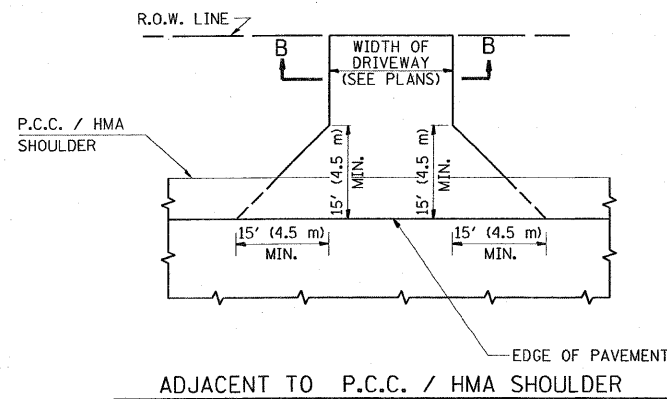

**RURAL FIELD ENTRANCE (FE)**  
 HMA SURFACE COURSE,  
 MIX "C", N50, 2 (50)  
 MEASURED IN TONS (METRIC TONS)  
 AGGREGATE BASE CSE., TYPE B, 8 (200)  
 MEASURED IN SQ. YD. (m<sup>2</sup>).

**GENERAL NOTES:**

DRIVEWAY SLOPES, LOCATIONS, & GEOMETRIC LAYOUT SHALL BE IN ACCORDANCE WITH THE LATEST EDITION OF THE "HANDBOOK FOR POLICY ON PERMITS FOR ACCESS DRIVEWAYS TO STATE HIGHWAYS". FOR FURTHER LAYOUT REQUIREMENTS, REFER TO ILLUSTRATIONS IN THE PERMIT HANDBOOK. DRIVEWAYS SHALL BE REPLACED IN KIND, UNLESS OTHERWISE NOTED ON THE PLANS.

COMMERCIAL DRIVEWAYS SHALL BE CONSTRUCTED WITH CONCRETE CURB, TYPE B RETURNS EXCEPT WHEN THE SIDEWALK EDGE IS 4 FEET (1.2 METERS) OR LESS FROM THE BACK OF CURB, CONSTRUCT A FLARE DRIVEWAY WITHOUT CURB.

THE RESIDENT ENGINEER SHALL CONTACT THE TRAFFIC PERMIT OFFICE AT 847/ 705-4131 FOR ANY QUESTIONS ON DRIVEWAYS SHOWN IN THE PLANS; SPECIFICALLY IN REFERENCE TO ADDITIONAL AND/OR RELOCATION/REMOVAL OF A DRIVEWAY.

COMBINATION CONCRETE CURB & GUTTER SHALL BE MEASURED STRAIGHT ACROSS THE DRIVEWAY. NO ADDITIONAL COMPENSATION WILL BE ALLOWED FOR THE CURB & GUTTER TRANSITION.

1 (25) PREFORMED EXPANSION JOINT FILLER WILL NOT BE PAID SEPARATELY, BUT SHALL BE CONSIDERED INCLUDED IN THE COST OF THE P.C.C. DRIVEWAY PAVEMENT OR P.C.C. SIDEWALK.

WHEN THE P.C.C. SIDEWALK EXTENDS THROUGH THE DRIVEWAY, THE THICKNESS OF THE SIDEWALK IN THE DRIVEWAY AREA SHALL BE THE SAME AS THE DRIVEWAY THICKNESS. SIDEWALK WILL BE PAID FOR AS P.C.C. SIDEWALK OF THE THICKNESS SPECIFIED. SIDEWALK CROSS SLOPE THRU DRIVEWAY AREA TO BE A MAXIMUM OF 1:50.

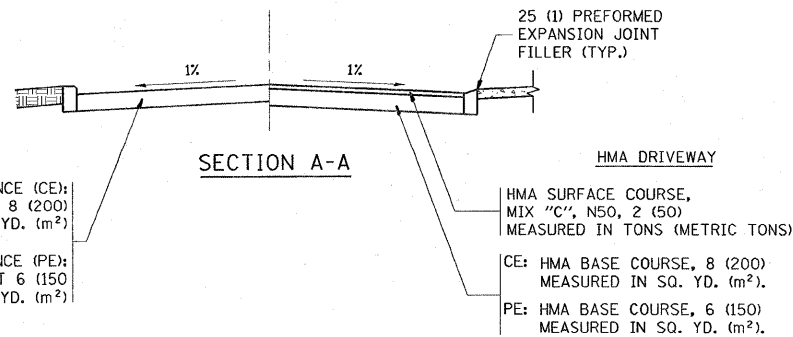

FILE NAME =	USER NAME = rosserejm	DESIGNED - R. SHAH	REVISED - M. GOMEZ 04-06-01
c:\pwork\pwork\rosserejm\80175433\01s	Std.dgn	DRAWN -	REVISED - P. LAFUER 04-15-03
	PLOT SCALE = 50.0000' / IN.	CHECKED -	REVISED - R. BORO 01-01-07
	PLOT DATE = 1/30/2010	DATE - 11-04-95	REVISED - R. BORO 06-11-08

**STATE OF ILLINOIS  
 DEPARTMENT OF TRANSPORTATION**

**DRIVEWAY DETAILS - DISTANCE BETWEEN R.O.W.  
 AND FACE OF CURB & EDGE OF SHOULDER >= 15' (4.5 m)**

SCALE: NONE SHEET NO. 1 OF 1 SHEETS STA. TO STA.

F.A.I. RTE.	SECTION	COUNTY	TOTAL SHEETS	SHEET NO.
55	99-2AC-1-RS-2	WILL	15	9
BD0156-07 (BD-01)			CONTRACT NO. 60J74	
FED. ROAD DIST. NO. 1 ILLINOIS FED. AID PROJECT				

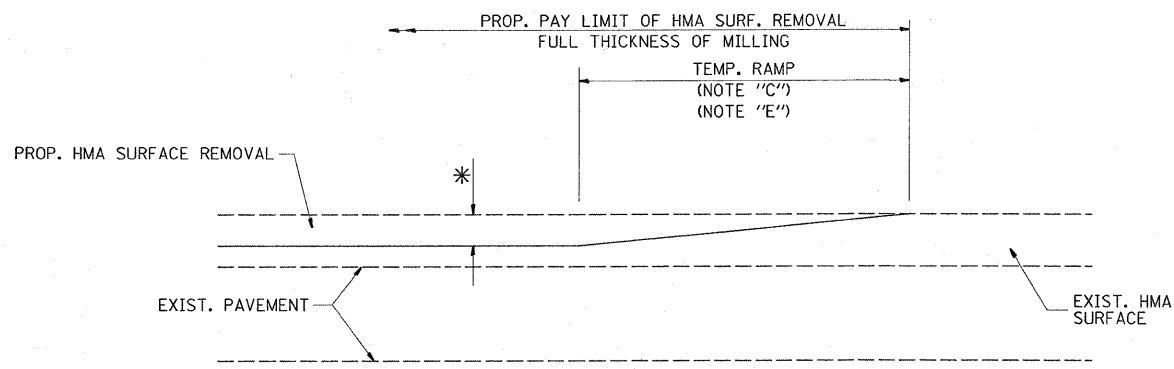

MILLED TEMPORARY RAMP  
(FOR BUTT JOINT AND HMA TAPER SEE DETAIL BELOW)

**OPTION 1**

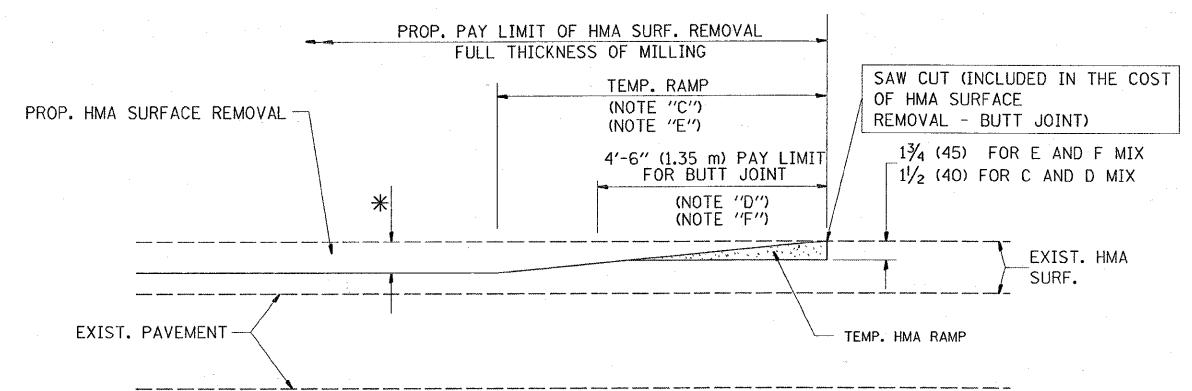

HMA CONSTRUCTED TEMPORARY RAMP  
(FOR BUTT JOINT AND HMA TAPER SEE DETAIL BELOW)

**OPTION 2**  
**TYPICAL TEMPORARY RAMP**

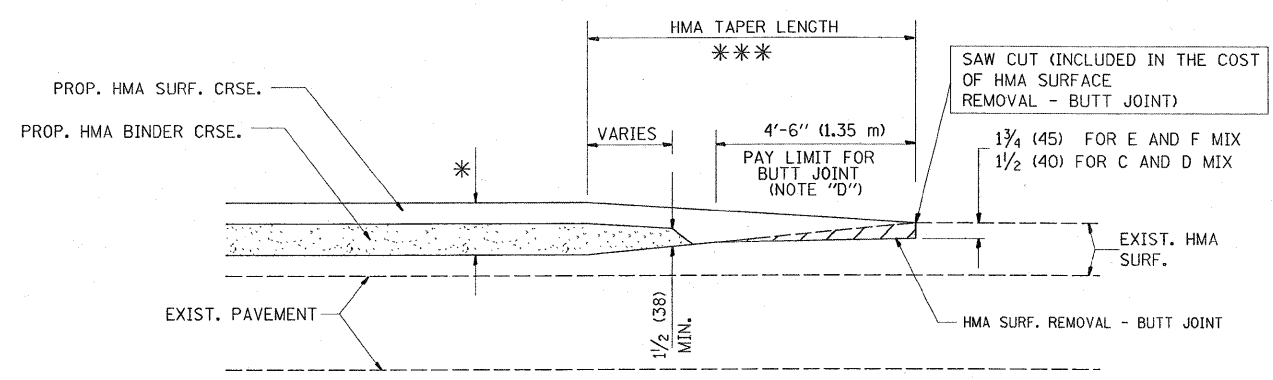

BUTT JOINT AND HMA TAPER  
**TYPICAL BUTT JOINT AND HMA TAPER FOR MILLING AND RESURFACING**

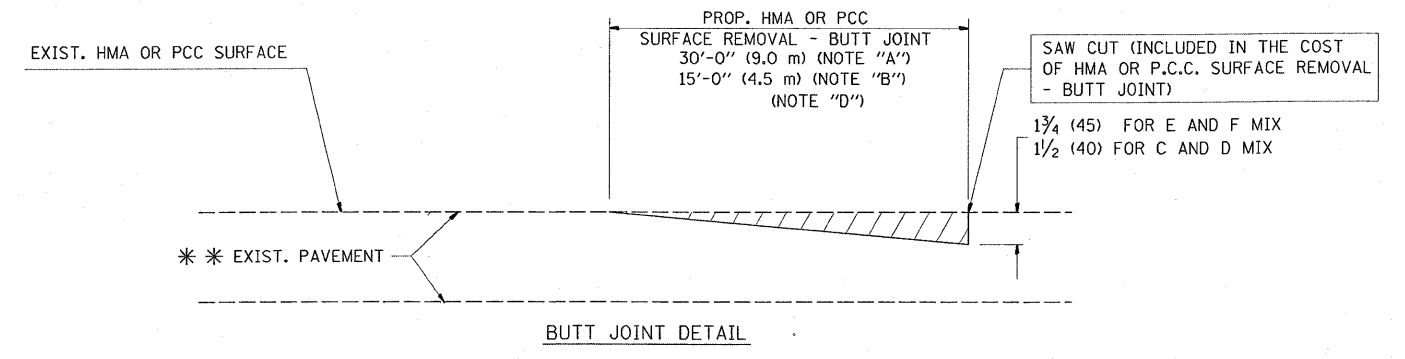

BUTT JOINT DETAIL

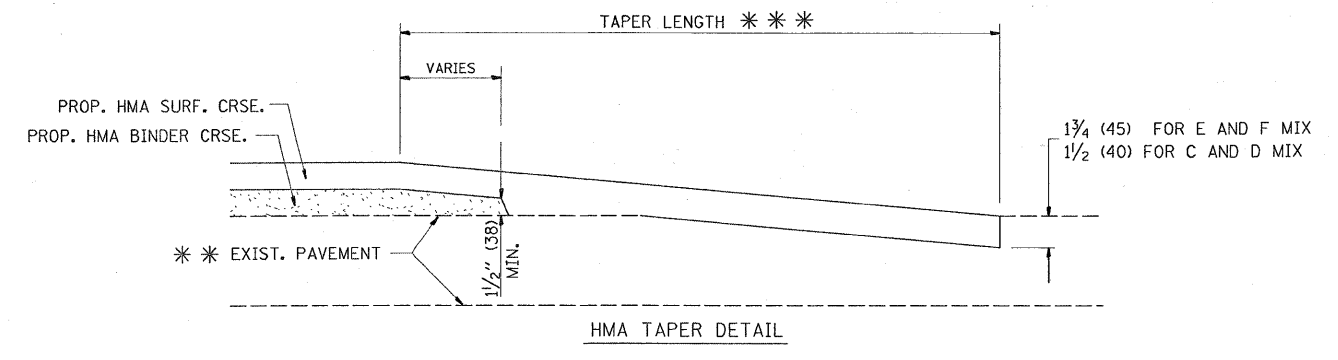

HMA TAPER DETAIL

**TYPICAL BUTT JOINT AND HMA TAPER FOR RESURFACING ONLY**

\*\*\* PC CONCRETE, HMA OR HMA RESURFACED PAVEMENT.

**NOTES**

- A: MAINLINE ROADWAYS AND MAJOR SIDE ROADS.
  - B: MINOR SIDE ROADS.
  - C: THE TEMP. RAMP SHALL BE CONSTRUCTED IMMEDIATELY UPON REMOVAL OF THE EXISTING HMA SURFACE.
  - D: THE BUTT JOINT SHALL BE CONSTRUCTED IMMEDIATELY PRIOR TO PLACING THE PROPOSED HMA COURSES.
  - E: TAPER THE TEMP. RAMP AT A RATE OF 3'-0" (900 mm) PER 1 INCH (25 mm) OF MILLING THICKNESS.
  - F: INSTALLATION AND REMOVAL OF THE 4'-6" (1.35 m) TEMP. RAMP IS INCLUDED IN COST OF HMA SURFACE REMOVAL - BUTT JOINT
  - G: SEE ARTICLE 406.08 AND 406.14 OF THE STANDARD SPECIFICATIONS FOR "HMA AND/OR PCC SURFACE REMOVAL, BUTT JOINT".
- \* SEE TYPICAL SECTIONS FOR MILLING THICKNESS.
- \*\*\* 20'-0" (6.1 m) PER 1 (25) RESURFACING (NOTE "A")  
10'-0" (3.0 m) PER 1 (25) RESURFACING (NOTE "B")

**BASIS OF PAYMENT:**

THE BUTT JOINT WILL BE PAID FOR AT THE CONTRACT UNIT PRICE PER SQUARE YARD (SQUARE METER) FOR "HOT-MIX ASPHALT SURFACE REMOVAL - BUTT JOINT" OR FOR "PORTLAND CEMENT CONCRETE SURFACE REMOVAL - BUTT JOINT".

ALL DIMENSIONS ARE IN INCHES (MILLIMETERS) UNLESS OTHERWISE SHOWN.

FILE NAME =	USER NAME = r0sterejm	DESIGNED - M. DE YONG	REVISED - R. SHAH 10-25-94
ci:\pwr_work\pwidot\rosterejm\d8175433\01s	Std.dgn	DRAWN -	REVISED - A. ABBAS 03-21-97
PLOT SCALE = 50.0000' / IN.	CHECKED -	REVISED - M. GOMEZ 04-06-01	
PLOT DATE = 1/30/2010	DATE - 06-13-90	REVISED - R. BORO 01-01-07	

**STATE OF ILLINOIS**  
**DEPARTMENT OF TRANSPORTATION**

<b>BUTT JOINT AND HMA TAPER DETAILS</b>		F.A.I. RTE. 55	SECTION 99-2AC-1-RS-2	COUNTY WILL	TOTAL SHEETS 15	SHEET NO. 10
SCALE: NONE	SHEET NO. 1 OF 1 SHEETS	STA. TO STA.	CONTRACT NO. 60J74			

BD400-05		BD32		CONTRACT NO. 60J74	
FED. ROAD DIST. NO. 1 ILLINOIS FED. AID PROJECT					

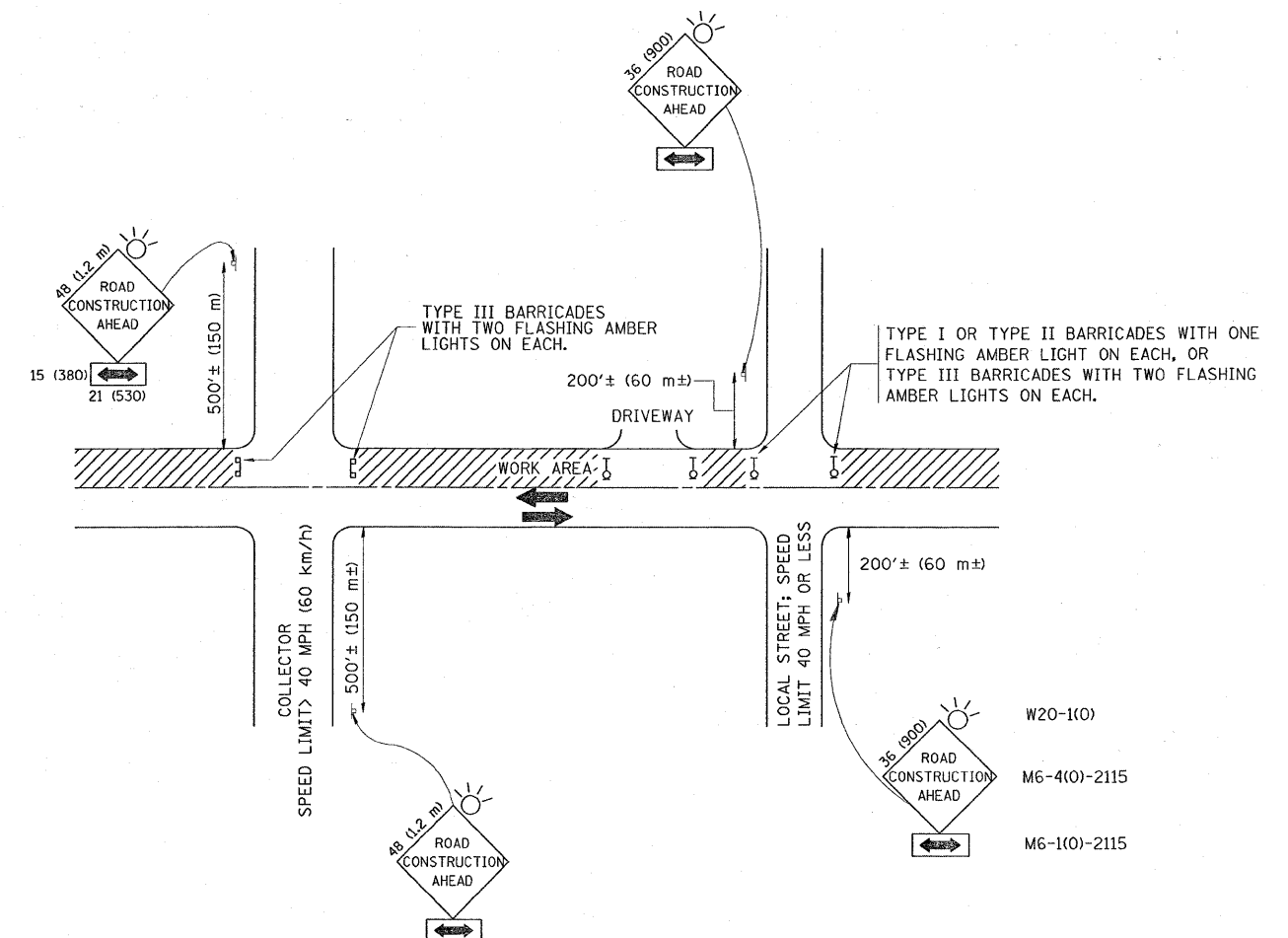

TRAFFIC CONTROL AND PROTECTION FOR SIDE ROADS, INTERSECTIONS, AND DRIVEWAYS

NOTES:

- A. FOR NO LANE RESTRICTION ON THE SIDE ROAD OR DRIVEWAYS
  1. SIDE ROAD WITH A SPEED LIMIT OF 40 MPH (60 km/h) OR LESS AS SHOWN ON THE DRAWING AND AS DIRECTED BY THE ENGINEER:
    - a) ONE ROAD CONSTRUCTION AHEAD SIGN 36 x 36 (900x900) WITH A FLASHER AND FLAG MOUNTED ON IT APPROXIMATELY 200' (60 m) IN ADVANCE OF THE MAIN ROUTE.
    - b) THE CLOSED PORTION OF THE MAIN ROUTE SHALL BE PROTECTED BY BLOCKING WITH TYPE I, TYPE II OR TYPE III BARRICADES, 1/3 OF THE CROSS SECTION OF THE CLOSED PORTION.
  2. SIDE ROAD WITH A SPEED LIMIT GREATER THAN 40 MPH (60 km/h) AS SHOWN ON THE DRAWING AND AS DIRECTED BY THE ENGINEER:
    - a) ONE ROAD CONSTRUCTION AHEAD SIGN 48 x 48 (1.2 m x 1.2 m) WITH A FLASHER MOUNTED ON IT APPROXIMATELY 500' (150 m) IN ADVANCE OF THE MAIN ROUTE.
    - b) THE CLOSED PORTION OF THE MAIN ROUTE SHALL BE PROTECTED BY BLOCKING WITH TYPE III BARRICADES, 1/2 OF THE CROSS SECTION OF THE CLOSED PORTION.
  3. WHEN THE SIDE ROAD LIES BETWEEN THE BEGINNING OF THE MAINLINE SIGNING AND THE WORK ZONE, A SINGLE HEADED ARROW (M6-1) SHALL BE USED IN LIEU OF THE DOUBLE HEADED ARROW (M6-4).
- B. FOR A LANE CLOSURE ON A SIDE ROAD OR DRIVEWAY:
 

USE APPLICABLE PORTIONS OF THE TYPICAL APPLICATION OF TRAFFIC CONTROL DEVICES (STD. 701501, STD. 701606 OR THE APPROPRIATE STANDARD). THE SPACING OF SIGNS AND BARRICADES SHALL BE ADJUSTED FOR FIELD CONDITIONS AS DIRECTED BY THE ENGINEER. THE DIRECTIONAL ARROW SHALL BE COVERED OR REMOVED WHEN NO LONGER CONSISTENT WITH THE SIDE ROAD LANE CLOSURE.
- C. ADVANCE WARNING SIGNS ARE TO BE OMITTED ON DRIVEWAY UNLESS OTHERWISE NOTED.
- D. THE TRAFFIC CONTROL AND PROTECTION FOR SIDE ROADS, INTERSECTIONS, AND DRIVEWAYS SHALL BE INCIDENTAL TO THE COST OF SPECIFIED TRAFFIC CONTROL STANDARDS OR ITEMS.

All dimensions are in millimeters (inches) unless otherwise shown.

FILE NAME =	USER NAME = rosierejm	DESIGNED - LHA	REVISED - J. OBERLE 10-18-95
c:\pwork\pwidot\rosierejm\0175433\d	tStd.dgn	DRAWN -	REVISED - A. HOUSEH 03-06-96
	PLOT SCALE = 50.0000' / IN.	CHECKED -	REVISED - A. HOUSEH 10-15-96
	PLOT DATE = 1/30/2010	DATE - 06-89	REVISED - T. RAMMACHER 01-06-00

STATE OF ILLINOIS  
DEPARTMENT OF TRANSPORTATION

TRAFFIC CONTROL AND PROTECTION FOR  
SIDE ROADS, INTERSECTIONS, AND DRIVEWAYS  
SCALE: NONE SHEET NO. 1 OF 1 SHEETS STA. TO STA.

F.A.I. RTE.	SECTION	COUNTY	TOTAL SHEETS	SHEET NO.
55	99-2AC-1-RS-2	WILL	15	11
TC-10			CONTRACT NO. 60J74	
FED. ROAD DIST. NO. 1 ILLINOIS FED. AID PROJECT				

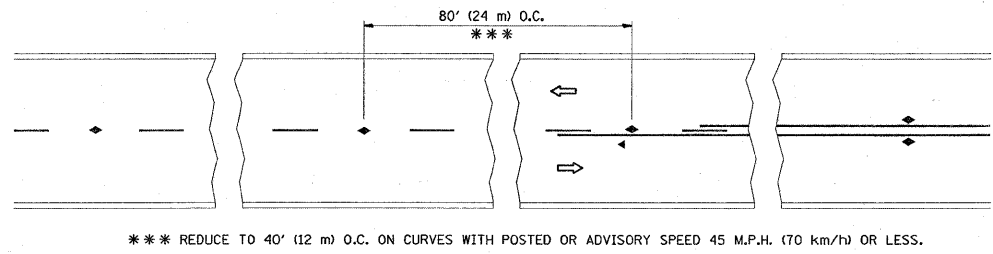

\*\*\* REDUCE TO 40' (12 m) O.C. ON CURVES WITH POSTED OR ADVISORY SPEED 45 M.P.H. (70 km/h) OR LESS.

TWO-LANE/TWO-WAY

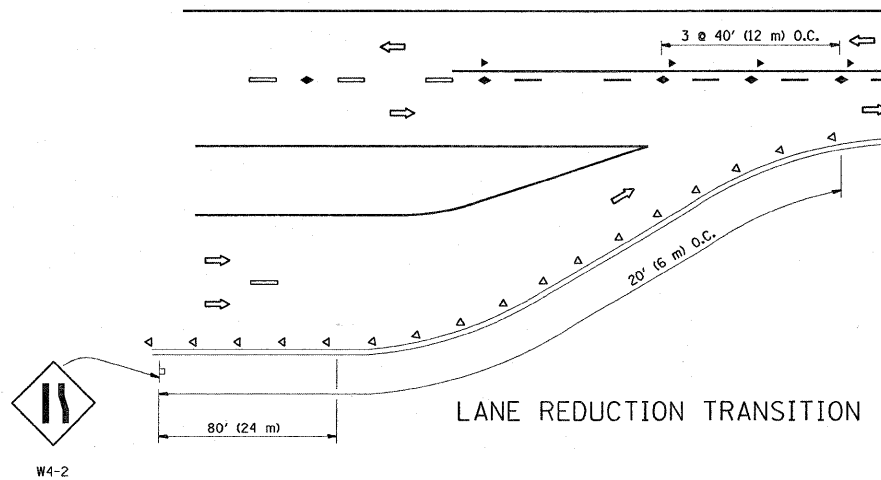

LANE REDUCTION TRANSITION

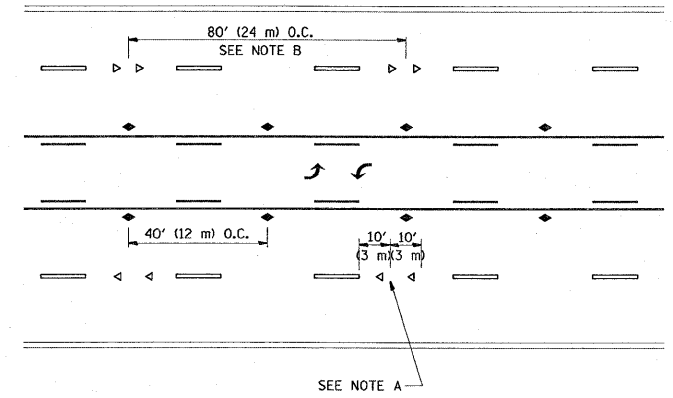

TWO-WAY LEFT TURN

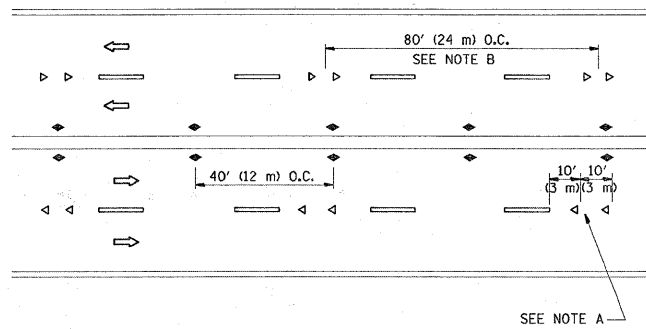

MULTI-LANE/UNDIVIDED

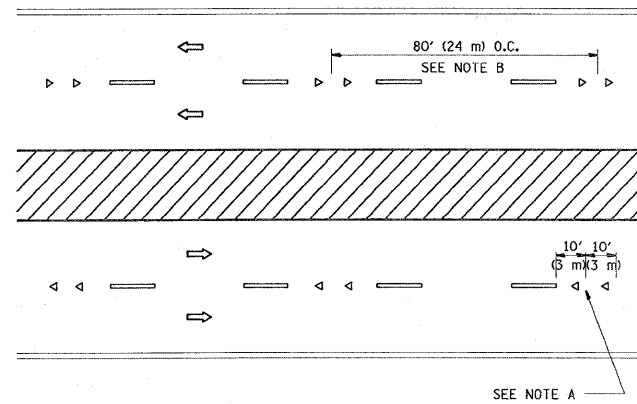

MULTI-LANE/DIVIDED

GENERAL NOTES

1. MARKERS USED WITH DASHED LINES SHALL BE CENTERED IN THE GAP BETWEEN SEGMENTS.
2. MARKERS USED ADJACENT TO SOLID LINES SHALL BE OFFSET 2 TO 3 (50 TO 75) TOWARD TRAFFIC AS SHOWN.
3. MARKERS THROUGH TANGENTS LESS THAN 500' (150 m) IN LENGTH BETWEEN CURVES SHALL BE INSTALLED AT THE LESSER OF THE TWO CURVE SPACINGS.

SYMBOLS

- YELLOW STRIPE
- WHITE STRIPE
- ◀ ONE-WAY AMBER MARKER
- ◀ ONE-WAY CRYSTAL MARKER (W/O)
- ◆ TWO-WAY AMBER MARKER

LANE MARKER NOTES

- A. USE DOUBLE LANE LINE MARKERS SPACED AS SHOWN.
- B. REDUCE TO 40' (12 m) O.C. ON CURVES WHERE ADVISORY SPEEDS ARE 10 M.P.H (20 km/h) LOWER THAN POSTED SPEEDS.

DESIGN NOTES

1. DOUBLE LANE LINE MARKERS SHALL BE USED UNLESS SPECIFIED OTHERWISE.
2. EXCEPT AS SHOWN ON THE LANE REDUCTION TRANSITION AND FREEWAY EXIT RAMP DETAIL, MARKERS ARE NOT TO BE SPECIFIED ON RIGHT EDGE LINES.
3. THE EXACT MARKER LIMITS, SPACING, AND COLOR SHOULD BE INCLUDED IN THE PLANS.
4. MARKERS SHOULD NOT BE USED ALONGSIDE CURBS EXCEPT FOR EXTREMELY SHORT SECTIONS OF CURBS WHERE NOT MORE THAN TWO MARKERS WOULD BE INVOLVED.

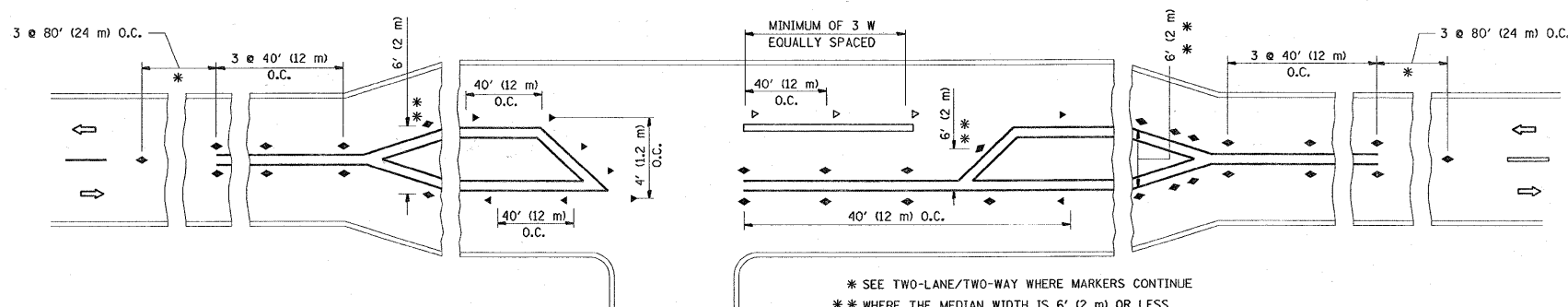

LEFT TURN

\* SEE TWO-LANE/TWO-WAY WHERE MARKERS CONTINUE  
 \*\* WHERE THE MEDIAN WIDTH IS 6' (2 m) OR LESS USE TWO-WAY MARKERS.

All dimensions are in inches (millimeters) unless otherwise shown.

FILE NAME =	USER NAME = rosierejm	DESIGNED -	REVISED - T. RAMMACHER 09-19-94	<b>STATE OF ILLINOIS DEPARTMENT OF TRANSPORTATION</b>	<b>TYPICAL APPLICATIONS</b>			F.A.I. RTE.	SECTION	COUNTY	TOTAL SHEETS	SHEET NO.	
ca:\pwwork\pwwid01\rosierejm\20175433\01	tStd.dgn	DRAWN -	REVISED - T. RAMMACHER 03-12-99		<b>RAISED REFLECTIVE PAVEMENT MARKERS (SNOW-PLOW RESISTANT)</b>			55	99-2AC-1-RS-2	WILL	15	12	
	PLOT SCALE = 50.0000' / 1"	CHECKED -	REVISED - T. RAMMACHER 01-06-00		SCALE: NONE	SHEET NO. 1	OF 1	SHEETS	STA.	TO STA.	<b>TC-11</b>		CONTRACT NO. 60J74
	PLOT DATE = 1/30/2010	DATE -	REVISED - C. JUCIUS 09-09-09									FED. ROAD DIST. NO. 1 ILLINOIS FED. AID PROJECT	

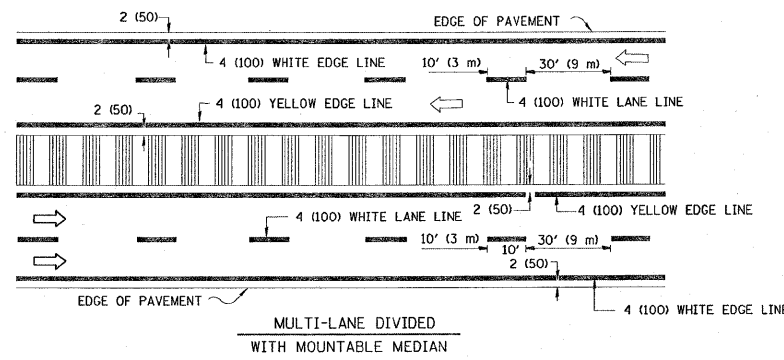
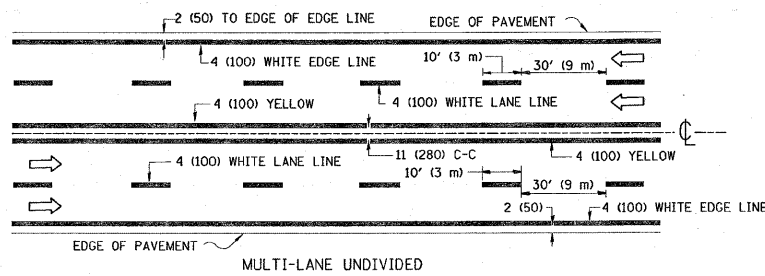
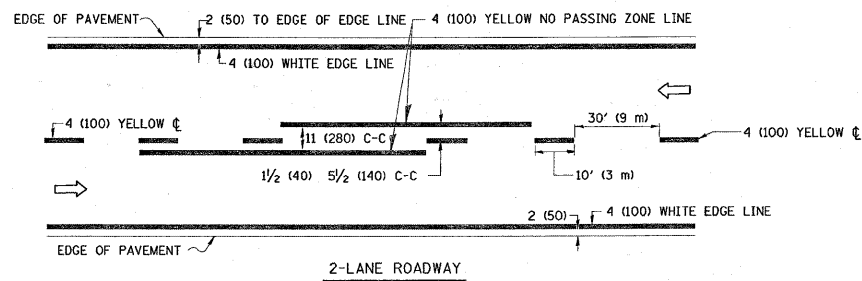

NOTE: MEDIANS WITH BARRIER CURB DO NOT REQUIRE AN EDGE LINE

TYPICAL LANE AND EDGE LINE MARKING

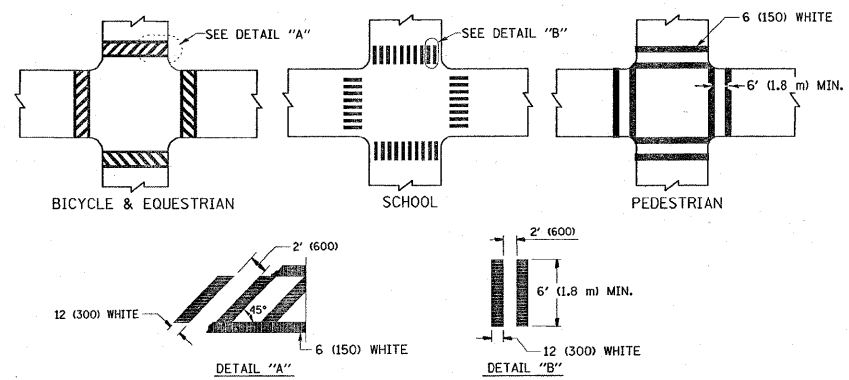

TYPICAL CROSSWALK MARKING

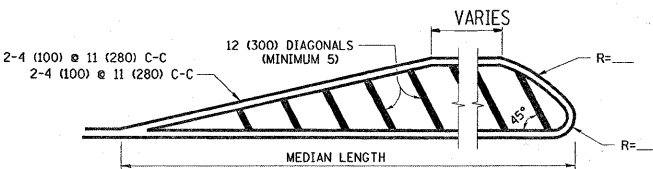
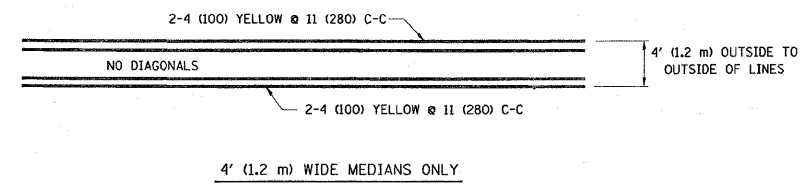

FOR MEDIAN LENGTHS WHERE DIAGONAL SPACING CANNOT BE ATTAINED, USE 5 (FIVE) EQUALLY SPACED DIAGONAL LINES.  
 DIAGONAL LINE SPACING: 50' (15 m) C-C (LESS THAN 30MPH (50 km/h))  
 75' (25 m) C-C 30MPH (50 km/h) TO 45MPH (70 km/h)  
 150' (45 m) C-C (MORE THAN 45MPH (70 km/h))

MEDIANS OVER 4' (1.2 m) WIDE

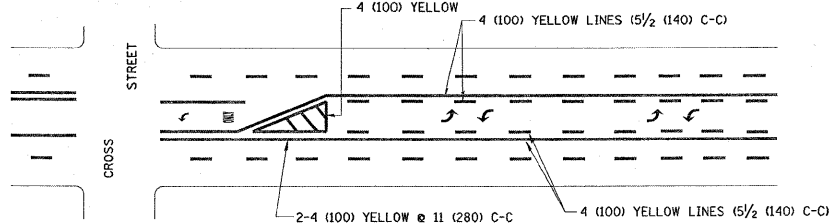

MEDIAN WITH TWO-WAY LEFT TURN LANE

TYPICAL PAINTED MEDIAN MARKING

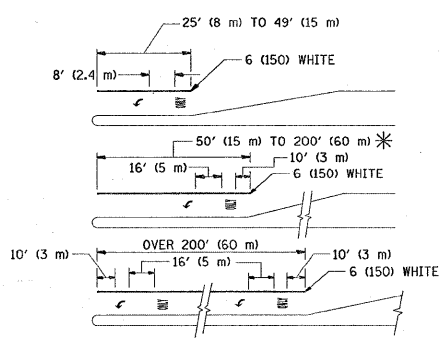

\* TURN LANES IN EXCESS OF 400' (120 m) IN LENGTH MAY HAVE AN ADDITIONAL SET OF ARROW - "ONLY" INSTALLED MIDWAY BETWEEN THE OTHER TWO SETS OF ARROW - "ONLY".

TYPICAL LEFT (OR RIGHT) TURN LANE

TYPICAL TURN LANE MARKING

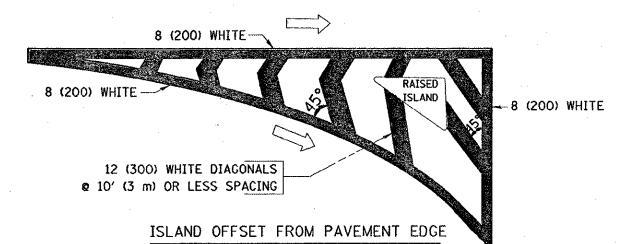

ISLAND OFFSET FROM PAVEMENT EDGE

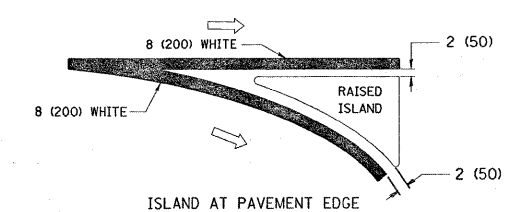

ISLAND AT PAVEMENT EDGE

TYPICAL ISLAND MARKING

TYPE OF MARKING	WIDTH OF LINE	PATTERN	COLOR	SPACING / REMARKS
CENTERLINE ON 2 LANE PAVEMENT	4 (100)	SKIP-DASH	YELLOW	10' (3 m) LINE WITH 30' (9 m) SPACE
CENTERLINE ON MULTI-LANE UNDIVIDED PAVEMENT	2 @ 4 (100)	SOLID	YELLOW	11 (280) C-C
NO PASSING ZONE LINES: FOR ONE DIRECTION	4 (100)	SOLID	YELLOW	5 1/2 (140) C-C FROM SKIP-DASH CENTERLINE
NO PASSING ZONE LINES: FOR BOTH DIRECTIONS	2 @ 4 (100)	SOLID	YELLOW	11 (280) C-C OMIT SKIP-DASH CENTERLINE BETWEEN
LANE LINES	4 (100) 5 (125) ON FREEWAYS	SKIP-DASH SKIP-DASH	WHITE WHITE	10' (3 m) LINE WITH 30' (9 m) SPACE
DOTTED LINES (EXTENSIONS OF CENTER, LANE OR TURN LANE MARKINGS)	SAME AS LINE BEING EXTENDED	SKIP-DASH	SAME AS LINE BEING EXTENDED	2' (600) LINE WITH 6' (1.8 m) SPACE
EDGE LINES	4 (100)	SOLID	YELLOW-LEFT WHITE-RIGHT	OUTLINE MOUNTABLE MEDIANS IN YELLOW; EDGE LINES ARE NOT USED NEXT TO BARRIER CURB
TURN LANE MARKINGS	6 (150) LINE; FULL SIZE LETTERS & SYMBOLS (8' (2.4m))	SOLID	WHITE	SEE TYPICAL TURN LANE MARKING DETAIL
TWO WAY LEFT TURN MARKING	2 @ 4 (100) EACH DIRECTION	SKIP-DASH AND SOLID	YELLOW	10' (3 m) LINE WITH 30' (9 m) SPACE FOR SKIP-DASH; 5 1/2 (140) C-C BETWEEN SOLID LINE AND SKIP-DASH LINE
	8' (2.4m) LEFT ARROW	IN PAIRS	WHITE	SEE TYPICAL TWO-WAY LEFT TURN MARKING DETAIL
CROSSWALK LINES (PEDESTRIAN) A. DIAGONALS (BIKE & EQUESTRIAN) B. LONGITUDINAL BARS (SCHOOL)	2 @ 6 (150) 12 (300) @ 45° 12 (300) @ 90°	SOLID SOLID SOLID	WHITE WHITE WHITE	NOT LESS THAN 6' (1.8 m) APART 2' (600) APART 2' (600) APART SEE TYPICAL CROSSWALK MARKING DETAILS.
STOP LINES	24 (600)	SOLID	WHITE	PLACE 4' (1.2 m) IN ADVANCE OF AND PARALLEL TO CROSSWALK, IF PRESENT. OTHERWISE, PLACE AT DESIRED STOPPING POINT. PARALLEL TO CROSSROAD CENTERLINE, WHERE POSSIBLE
PAINTED MEDIANS	2 @ 4 (100) WITH 12 (300) DIAGONALS @ 45°	SOLID	YELLOW: TWO WAY TRAFFIC WHITE: ONE WAY TRAFFIC	11 (280) C-C FOR THE DOUBLE LINE SEE TYPICAL PAINTED MEDIAN MARKING.
GORE MARKING AND CHANNELIZING LINES	8 (200) WITH 12 (300) DIAGONALS @ 45°	SOLID	WHITE	DIAGONALS: 15' (4.5 m) C-C (LESS THAN 30MPH (50 km/h)) 20' (6 m) C-C 30MPH (50 km/h) TO 45MPH (70 km/h) 30' (9 m) C-C (OVER 45MPH (70 km/h))
RAILROAD CROSSING	24 (600) TRANSVERSE LINES; "RR" IS 6' (1.8 m) LETTERS; 16 (400) LINE FOR "X"	SOLID	WHITE	SEE STATE STANDARD 780001 AREA OF: "R"=3.6 SQ. FT. (0.33 m²) EACH "X"=54.0 SQ. FT. (5.0 m²)
SHOULDER DIAGONALS	12 (300) @ 45°	SOLID	WHITE - RIGHT YELLOW - LEFT	50' (15 m) C-C (LESS THAN 30MPH (50 km/h)) 75' (25 m) C-C (30 MPH (50 km/h) TO 45MPH (70 km/h)) 150' (45 m) C-C (OVER 45MPH (70 km/h))

FOR FURTHER DETAILS ON PAVEMENT MARKING REFER TO STANDARD SPECIFICATIONS FOR ROAD AND BRIDGE CONSTRUCTION AND STATE STANDARD 780001.

All dimensions are in inches (millimeters) unless otherwise shown.

FILE NAME =	USER NAME = rosierjrn	DESIGNED - EVERS	REVISED - T. RAMMACHER 10-27-94
std.dgn		DRAWN -	REVISED - C. JUCIUS 09-09-09
PLOT SCALE = 50.0000' / IN.		CHECKED -	REVISED -
PLOT DATE = 1/30/2010		DATE - 03-19-90	REVISED -

STATE OF ILLINOIS  
DEPARTMENT OF TRANSPORTATION

DISTRICT ONE			
TYPICAL PAVEMENT MARKINGS			
SCALE: NONE	SHEET NO. 1 OF 1 SHEETS	STA.	TO STA.

F.A.I. RTE. 55	SECTION 99-2AC-1-RS-2	COUNTY WILL	TOTAL SHEETS 15	SHEET NO. 13
TC-13		CONTRACT NO. 60J74		
FED. ROAD DIST. NO. 1   ILLINOIS   FED. AID PROJECT				

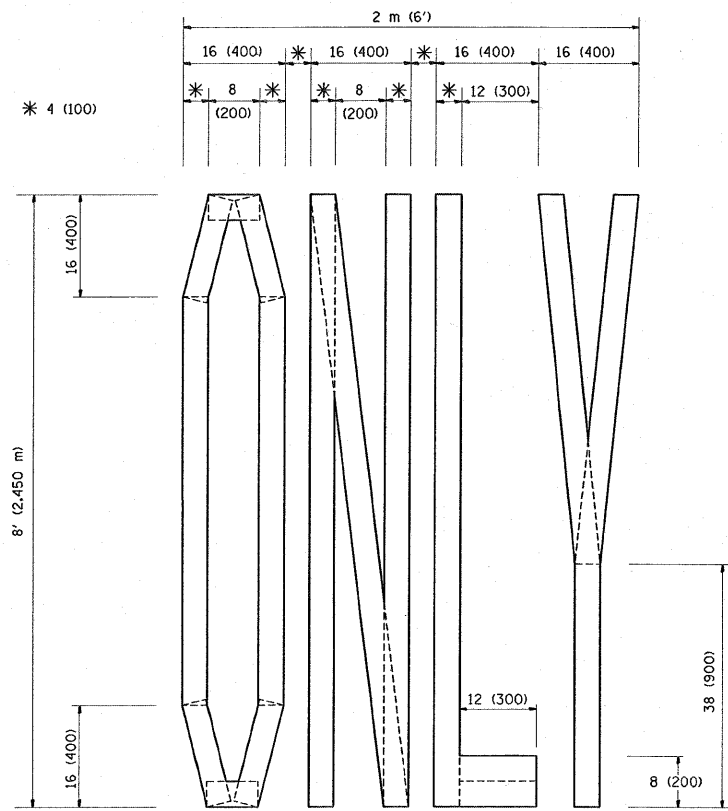

QUANTITY  
 4 (100) LINE = 64.1 ft. (19.7 m)  
 21.1 sq. ft. (1.97 sq. m)

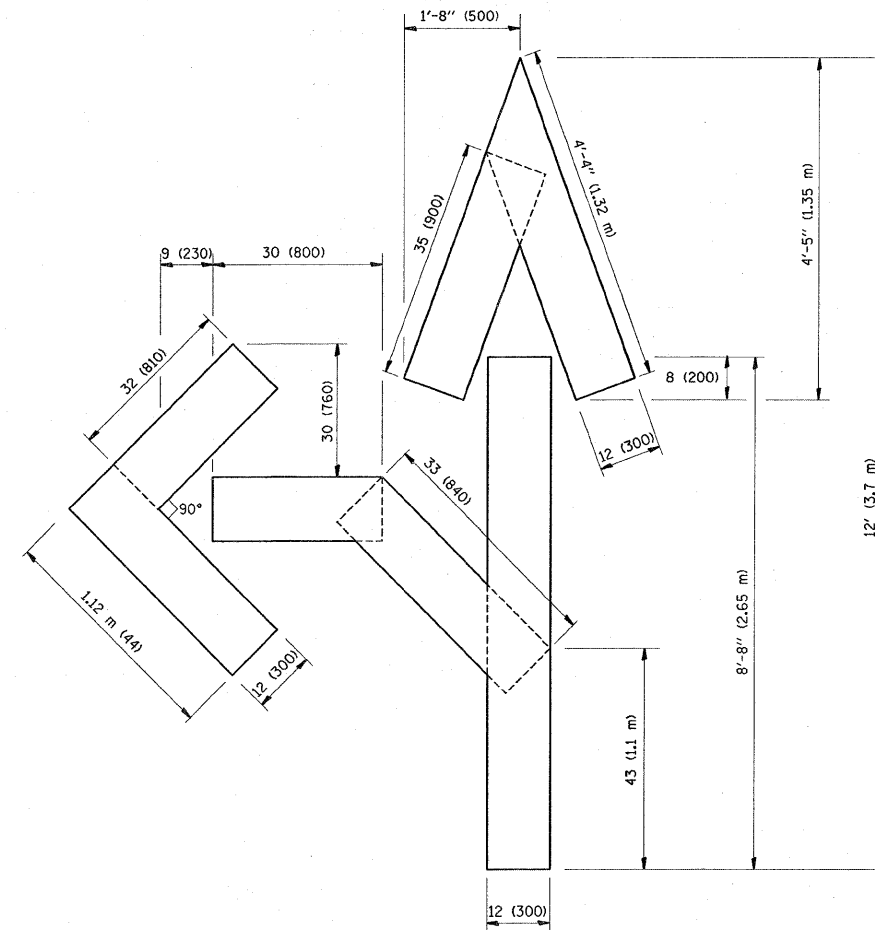

QUANTITY  
 4 (100) LINE = 82.5 ft. (25.3 m)  
 27.5 sq. ft. (2.53 sq. m)

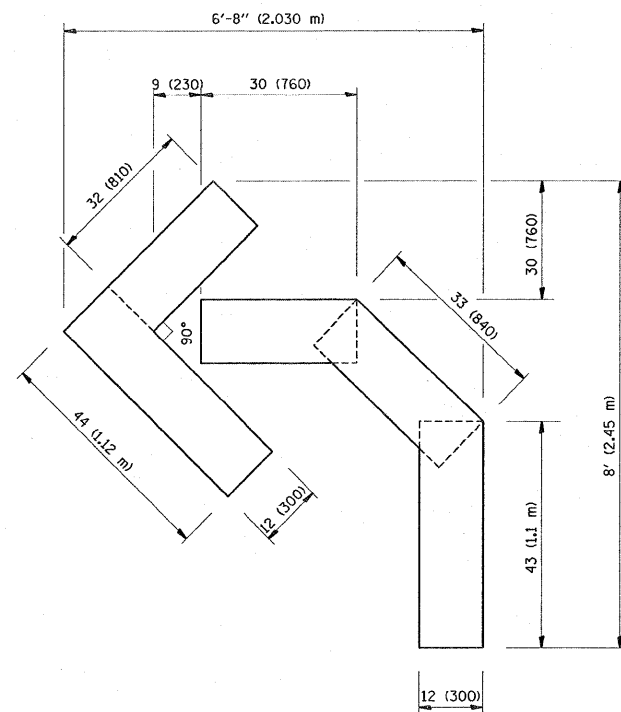

QUANTITY  
 4 (100) LINE = 45.5 ft. (13.9 m)  
 15.2 sq. ft. (1.39 sq. m)

All dimensions are in inches (millimeters) unless otherwise shown.

FILE NAME =	USER NAME = rosiere,jm	DESIGNED -	REVISED -T. RAMMACHER 06-05-96
ca:\pw\work\PW1001\ROSIERE.JM\d0175433\d0175433.dgn		DRAWN -	REVISED -T. RAMMACHER 11-04-97
		CHECKED -	REVISED -T. RAMMACHER 03-02-98
		DATE - 09-18-94	REVISED -E. GOMEZ 08-28-00

STATE OF ILLINOIS  
 DEPARTMENT OF TRANSPORTATION

PAVEMENT MARKING LETTERS AND SYMBOLS  
 FOR TRAFFIC STAGING

SCALE: NONE SHEET NO. 1 OF 1 SHEETS STA. TO STA.

F.A.I. RTE.	SECTION	COUNTY	TOTAL SHEETS	SHEET NO.
55	99-2AC-1-RS-2	WILL	15	14
TC-16			CONTRACT NO. 60J74	
FED. ROAD DIST. NO. 1 ILLINOIS FED. AID PROJECT				

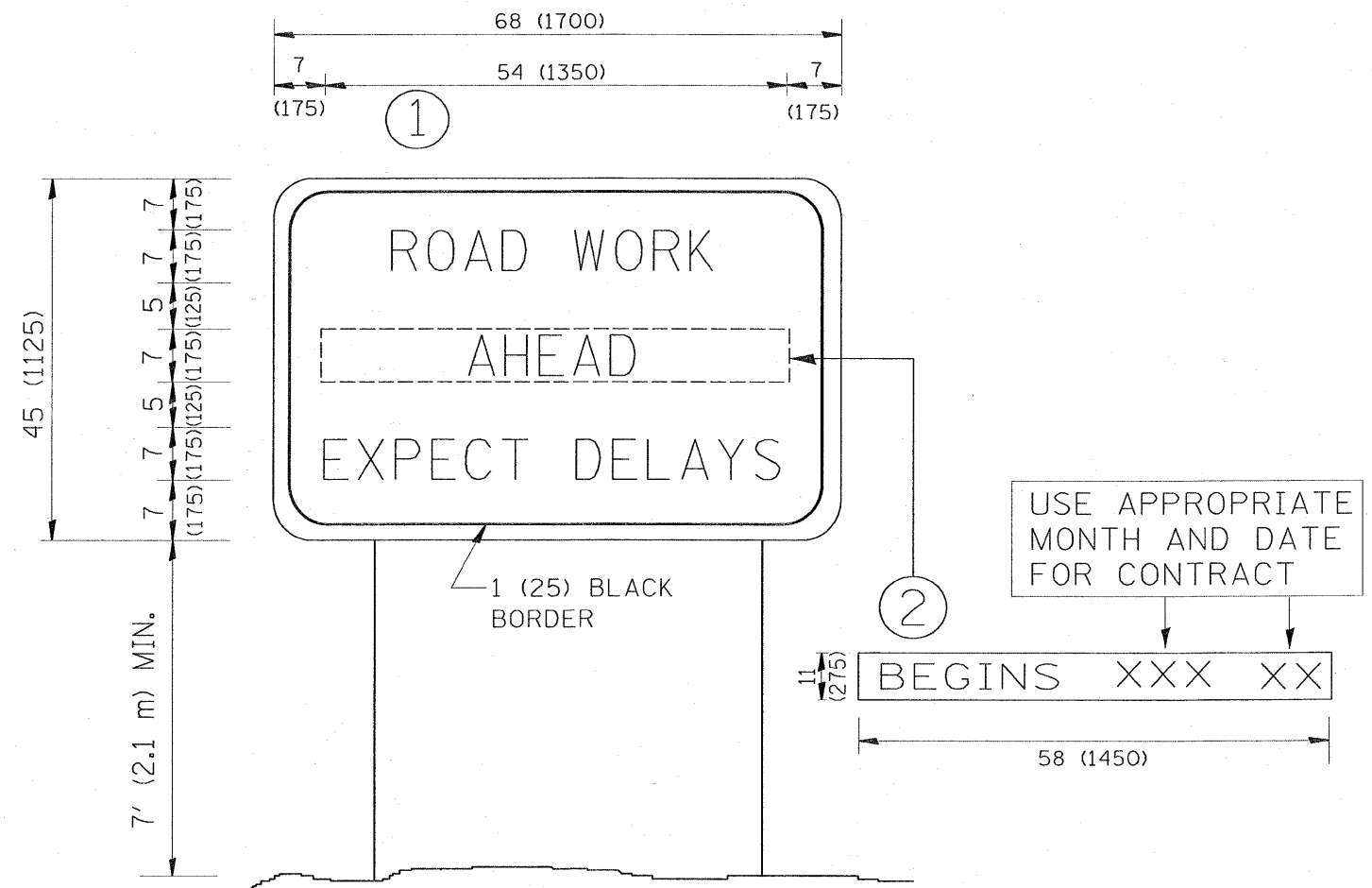

**NOTES:**

1. USE BLACK LETTERING ON ORANGE BACKGROUND.
2. ERECT SIGNS IN ADVANCE OF THE LOCATION FOR THE "ROAD CONSTRUCTION AHEAD" SIGN AT LOCATIONS AS DIRECTED BY THE ENGINEER.
3. ERECT SIGN ① WITH INSTALLED PANEL ② ONE WEEK PRIOR TO THE START OF CONSTRUCTION.
4. REMOVE PANEL ② SOON AFTER THE START OF CONSTRUCTION.
5. SEE SPECIAL PROVISION FOR "TEMPORARY INFORMATION SIGNING" FOR ADDITIONAL INFORMATION.
6. ONE SIGN ASSEMBLY EQUALS 25.70 SQ. FT. (2.3 SQ. M.)
7. SHALL BE PAID FOR AS TEMPORARY INFORMATION SIGNING.

ALL DIMENSIONS ARE IN INCHES (MILLIMETERS) UNLESS OTHERWISE SHOWN.

FILE NAME =	USER NAME = rosierejm	DESIGNED -	REVISED - R. MIRS 09-15-97
ct:\pwork\NF\DOT\ROSIEREJM\0175433\DOT	Std.dgn	DRAWN -	REVISED - R. MIRS 12-11-97
	PLOT SCALE = 50.0000 ' / IN.	CHECKED -	REVISED - T. RAMMACHER 02-02-99
	PLOT DATE = 1/30/2010	DATE -	REVISED - C. JUCIUS 01-31-07

**STATE OF ILLINOIS  
DEPARTMENT OF TRANSPORTATION**

**ARTERIAL ROAD  
INFORMATION SIGN**

SCALE: NONE SHEET NO. 1 OF 1 SHEETS STA. TO STA.

F.A.I. RTE.	SECTION	COUNTY	TOTAL SHEETS	SHEET NO.
55	99-2AC-1-RS-2	WILL	15	15
TC-22			CONTRACT NO. 60J74	
FED. ROAD DIST. NO. 1 [ILLINOIS] FED. AID PROJECT				