

CONSTRUCTION NOTES:

- 1 INSTALL UNINTERRUPTIBLE POWER SUPPLY UNIT.
- 2 INSTALL NEW GROUND CABLE FROM NEW CONTROLLER CABINET TO EXISTING SERVICE INSTALLATION.
- 3 REMOVE EXISTING SIGNAL HEAD, REPLACE WITH NEW SIGNAL HEAD, LED AND BACKPLATE (IF REQUIRED). REUSE EXISTING CABLES.
- 4 REMOVE AND REPLACE EXISTING CONTROLLER AND CABINET. REUSE EXISTING TYPE "D" FOUNDATION. INSTALL NEW CONTROLLER AND TYPE V CABINET, MASTER CONTROLLER, FIBER OPTIC TRANSCEIVER, AND INDUCTIVE LOOP DETECTORS.
- 5 REMOVE EXISTING MAST ARM ASSEMBLY AND TYPE E FOUNDATION AFTER THE PROPOSED MAST ARMS ARE INSTALLED, OPERATING AND APPROVED BY THE IDOT AREA TRAFFIC SIGNAL ENGINEER.
- 6 REMOVE EXISTING NORTHBOUND 3-SECTION SIGNAL HEAD AFTER THE PROPOSED NORTHBOUND MAST ARM IS INSTALLED, OPERATING AND APPROVED BY THE IDOT AREA TRAFFIC SIGNAL ENGINEER.
- 7 THE CONTRACTOR SHALL REMOVE THE EXISTING INCANDESCENT YELLOW FLASHING BEACON LOCATED ON AN EXISTING POST APPROXIMATELY 850 FEET FROM THE EASTBOUND STOP BAR AND REPLACE IT WITH A 12 INCH L.E.D. SINGLE SECTION YELLOW FLASHING BEACON UNIT ON THE EXISTING POST. SEE THE INTERCONNECT PLAN (SHEET 18) FOR LOCATION OF THE EXISTING FLASHING BEACON.
- 8 ALL THE EXISTING ELECTRIC CABLES TO ANY EXISTING SIGNAL HEAD THAT WILL NOT BE REPLACED OR ARE EXISTING MAST ARMS THAT WILL BE REMOVED SHALL BE PULLED FROM THE EXISTING CONDUIT ALL THE WAY TO THE CONTROLLER CABINET.



R8-8
(24" x 30")
(2 REQUIRED)

NOTE:
THE EXISTING CONTROLLER IS AN ECONOLITE ASC/2S-2100 AND THE MASTER CONTROLLER IS AN ECONOLITE ASC/2M-1000 IN A TYPE IV CABINET.

IMPORTANT NOTE:

ALL EXCAVATED SOIL FROM THE INSTALLATION OF ALL FOUNDATIONS SHALL REMAIN ON SITE AND BE USED AS FILL MATERIAL FOR THE REMOVAL OF THE EXISTING FOUNDATIONS.

THE TRAFFIC SIGNAL CONTROL EQUIPMENT FOR THIS PROJECT SHALL BE "NTCIP" COMPLIANT.

Restoration of Work Area. Restoration of the traffic signal work area shall be incidental to the related pay items such as foundation, conduit, handhole, trench and backfill, etc., and no extra compensation shall be allowed. All roadway surfaces such as shoulders, medians, sidewalks, pavement, etc. shall be replaced in kind. All damage to mowed lawns shall be replaced with an approved sod, and all damage to unmowed fields shall be seeded in accordance with Standard Specifications 252 and 250 respectively.

THE FOLLOWING ITEMS SHALL BE REMOVED BY THE CONTRACTOR AND SHALL BE DISPOSED OF BY THEM OUTSIDE THE RIGHT-OF-WAY AT THEIR EXPENSE. THE SALVAGE VALUE OF THE REMOVED EQUIPMENT SHALL BE REFLECTED IN THE CONTRACT BID PRICE.

- 1 EACH CONTROLLER AND CABINET (COMPLETE)
- 1 EACH MASTER CONTROLLER
- 3 EACH SIGNAL HEAD, 1-FACE, 3-SECTION
- 1 EACH SIGNAL HEAD, 1-FACE, 4-SECTION
- 4 EACH SIGNAL HEAD, 1-FACE, 5-SECTION
- 1 EACH SIGNAL HEAD, 2-FACE, 1-3 SECTION, 1-4 SECTION
- 2 EACH SIGNAL HEAD, 2-FACE, 1-3 SECTION, 1-5 SECTION
- 2 EACH MAST ARM ASSEMBLY AND POLE
- 1 EACH SINGLE SECTION YELLOW FLASHING BEACON
- 5 EACH TRAFFIC SIGNAL BACKPLATE
- 4 EACH ILLUMINATED SIGN

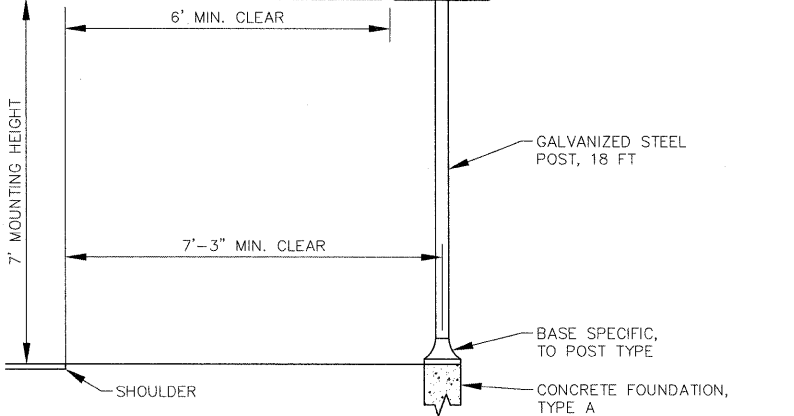
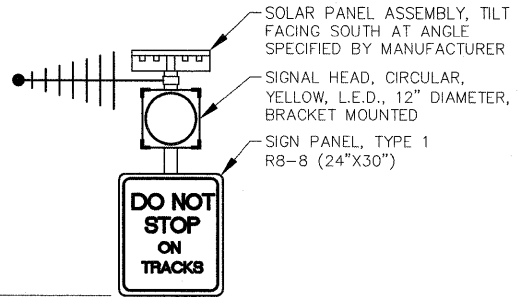
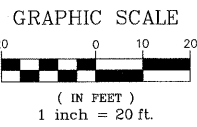

RADIO ACTIVATED SOLAR ADVANCE FLASHING BEACON SYSTEM (COMPLETE)
(NOT TO SCALE)

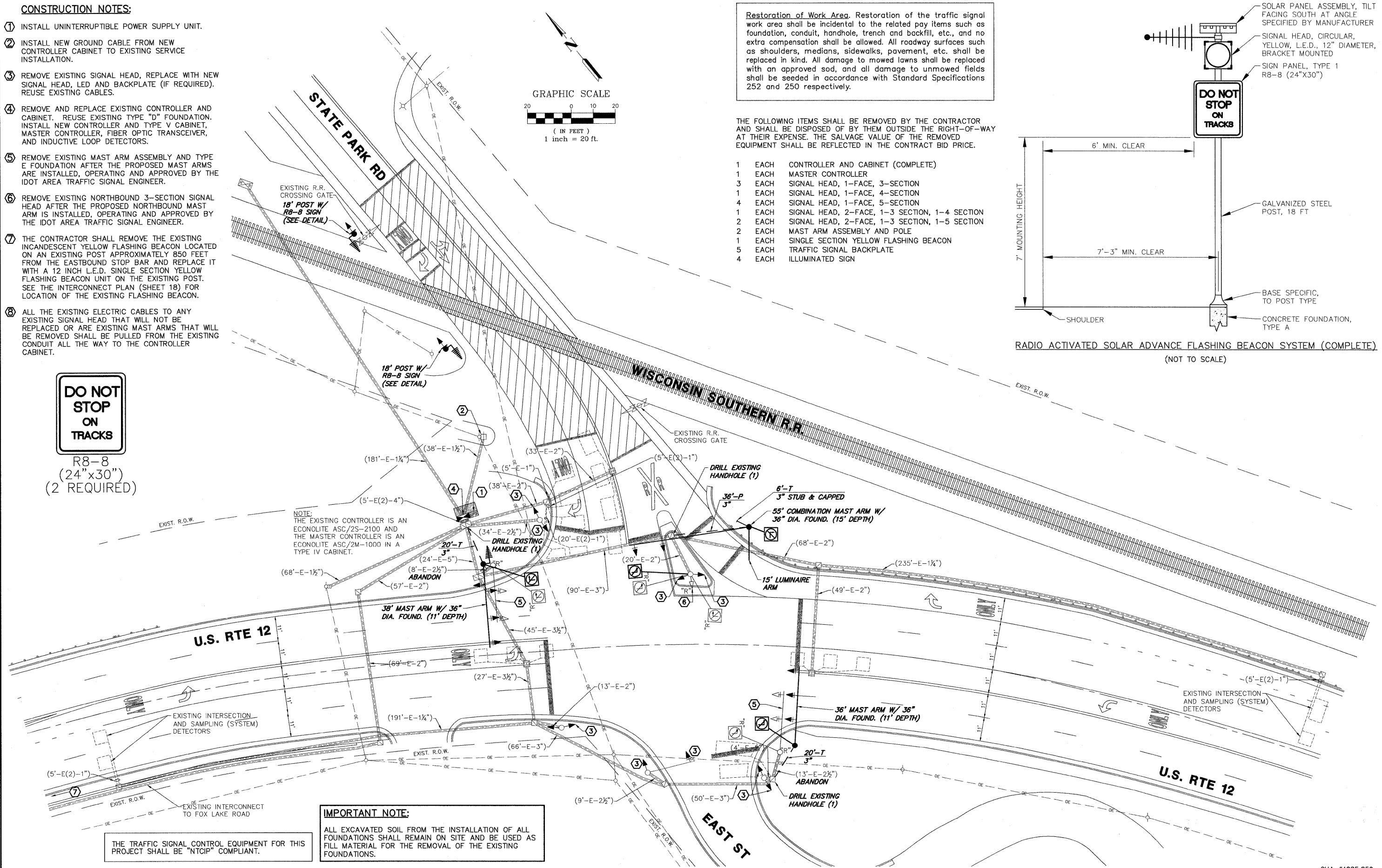

FILE NAME = 4085.859-TR1.dwg	USER NAME = GHA	DESIGNED - JRD	REVISED -	STATE OF ILLINOIS DEPARTMENT OF TRANSPORTATION	TRAFFIC SIGNAL MODERNIZATION PLAN U.S. ROUTE 12 AT STATE PARK ROAD/EAST STREET			F.A.P. RTE 334	SECTION 2009-128-TS	COUNTY LAKE/McHENRY	TOTAL SHEETS 21	SHEET NO. 15
	PLOT SCALE = 1" = .0833'	DRAWN - ZCW	REVISED -		SCALE 1"=20'	SHEET NO.	OF SHEETS	STA.	TO STA.	CONTRACT # 60J88	ILLINOIS FED. AID PROJECT	
	PLOT DATE = 1/27/10	CHECKED - DPB	REVISED -									
		DATE - 1/27/10	REVISED -									

GHA #4085.859