

- NOTES:
1. AREA REFLECTIVE CRACK CONTROL TO BE USED OVER ENTIRE AREA AFTER LEVELING BINDER HAS BEEN PLACED.
 2. PROPOSED GRADE LINE PROFILE 1" ABOVE EXISTING GRADE LINE PROFILE.
 3. CONTRACTOR SHALL TAPER LEVELING BINDER AT ALL DRIVEWAYS SO THAT PROPOSED PAVEMENT MATCHES EXISTING TOP OF DRIVEWAY.

SCALE:
HORIZONTAL 1" = 20'
VERTICAL 1" = 5'

215

INDUSTRIAL DRIVE

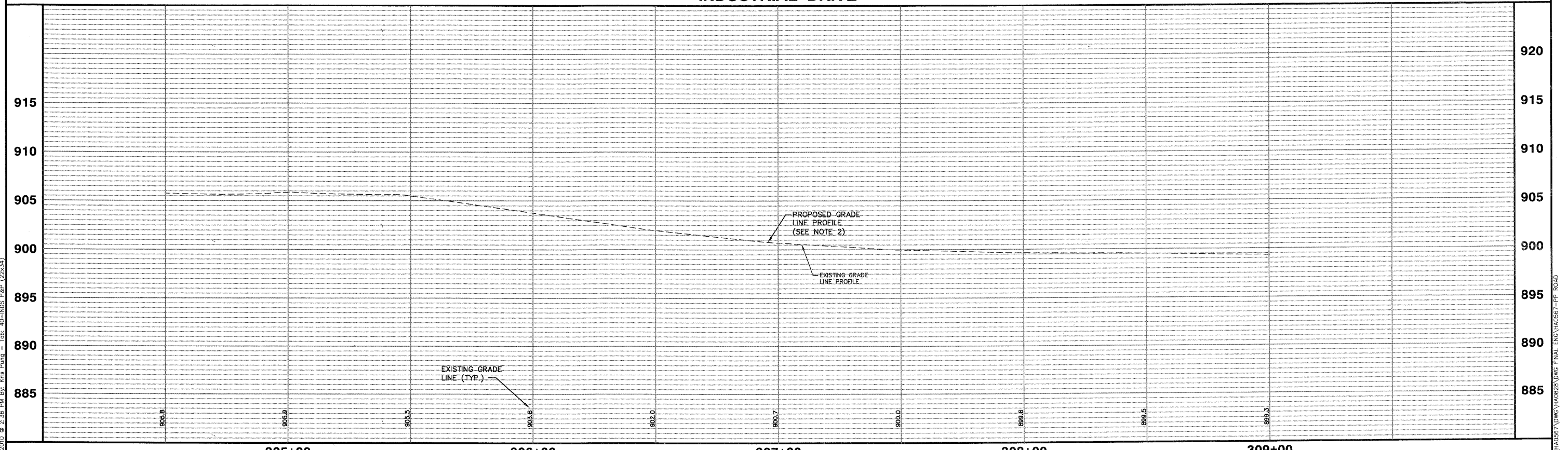

Plotted: February 1, 2010 @ 2:36 PM By: K's Pung - Job: 40-NDS P&P (22x34)

PLOT: 06-00015-00-PV (1/16/09) DWG: 06-00015-00-PV (1/16/09) ENG: JAM/SWM

COPYRIGHT © 2010 ENGINEERING ENTERPRISES, INC.				STATE OF ILLINOIS DEPARTMENT OF TRANSPORTATION				PROPOSED INDUSTRIAL DRIVE PLAN AND PROFILE				F.A. RTE.	SECTION	COUNTY	TOTAL SHEETS	SHEET NO.
FILE NAME	USER NAME = #USER#	DESIGNED - JAM, SWM	REVISED - 12/02/09									N/A	06-00015-00-PV	KANE	97	40
#FILE#		DRAWN - KKP	REVISED - 01/22/10	SCALE: 1"=20'				PROJECT NO. HPP-1468(004)	JOB NO. C-91-175-06		CONTRACT NO. 63406					
	PLOT SCALE = #SCALE#	CHECKED - JAM	REVISED - 02/03/10	SHEET NO. 37 OF 92 SHEETS				STA. N/A	TO STA. N/A		FED. ROAD DIST. NO. [ILLINOIS] FED. AID PROJECT					
	PLOT DATE = #DATE#	DATE - 10/16/09	REVISED -													