

- NOTES:
1. AREA REFLECTIVE CRACK CONTROL TO BE USED OVER ENTIRE AREA AFTER LEVELING BINDER HAS BEEN PLACED.
 2. PROPOSED GRADE LINE PROFILE 1" ABOVE EXISTING GRADE LINE PROFILE.
 3. CONTRACTOR SHALL TAPER LEVELING BINDER AT ALL DRIVEWAYS SO THAT PROPOSED PAVEMENT MATCHES EXISTING TOP OF DRIVEWAY.

SCALE:
HORIZONTAL 1" = 20'
VERTICAL 1" = 5'

INDUSTRIAL DRIVE

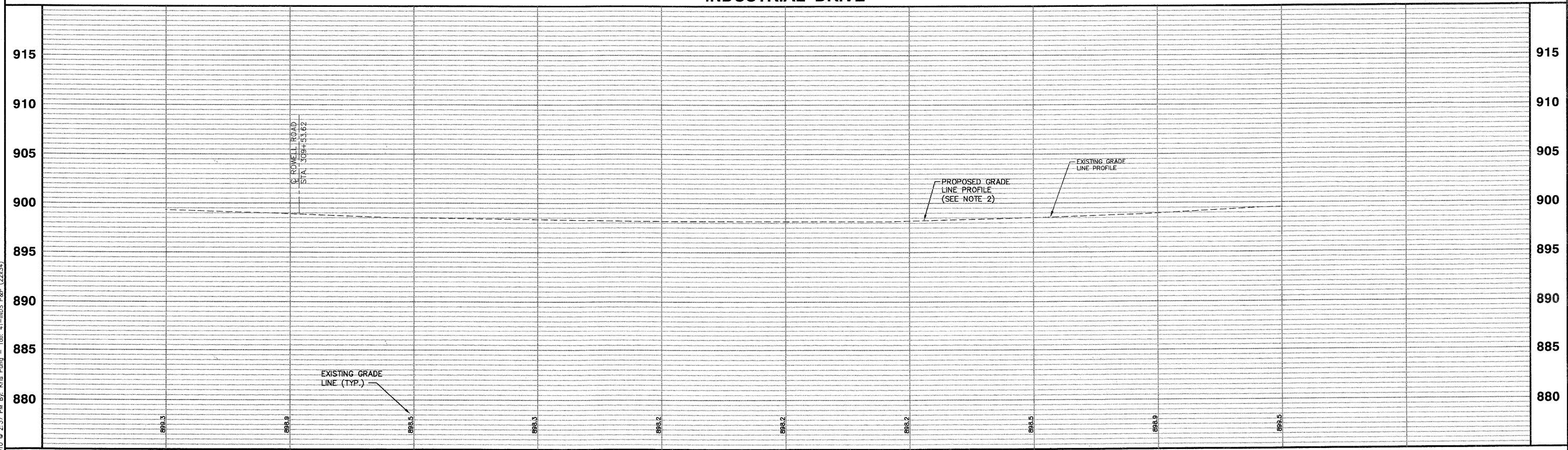

Plotted: February 1, 2010 @ 2:37 PM By: Kris Pung - Tab: 41-INDS P&P (22x34)

Path: \\SBRKRCVA0557\DWG\140828\DWG_FINAL\ENG\140828-PP.ROAD

COPYRIGHT © 2010 ENGINEERING ENTERPRISES, INC.		DESIGNED - JAM, SWM		REVISED - 12/02/09		STATE OF ILLINOIS DEPARTMENT OF TRANSPORTATION		PROPOSED INDUSTRIAL DRIVE PLAN AND PROFILE				F.A. RTE.	SECTION	COUNTY	TOTAL SHEETS	SHEET NO.
FILE NAME	USER NAME = #USER#	DRAWN - KKP	REVISED - 01/22/10	PROJECT NO. HPP-1468(004)								JOB NO. C-91-175-06		N/A	06-00015-00-PV	KANE
#FILE#	PLOT SCALE = #SCALE#	CHECKED - JAM	REVISED - 02/03/10	SHEET NO. 38 OF 92 SHEETS				STA. N/A TO STA. N/A		Contractor No. 63406						
	PLOT DATE = #DATE#	DATE - 10/16/09	REVISED -							FED. ROAD DIST. NO. - [ILLINOIS] FED. AID PROJECT						