

F.A.P. RTE.	SECTION	COUNTY	TOTAL SHEETS	SHEET NO.
301	177-2 (-1A, B-1, VB-1)	STEPHENSON	386	52
STA.	488+00	TO STA.	504+00	
FED. ROAD DIST. NO.	ILLINOIS	FED. AID PROJECT		
P-92-029-02				PLN-03 OF 32
CONTRACT #64799				

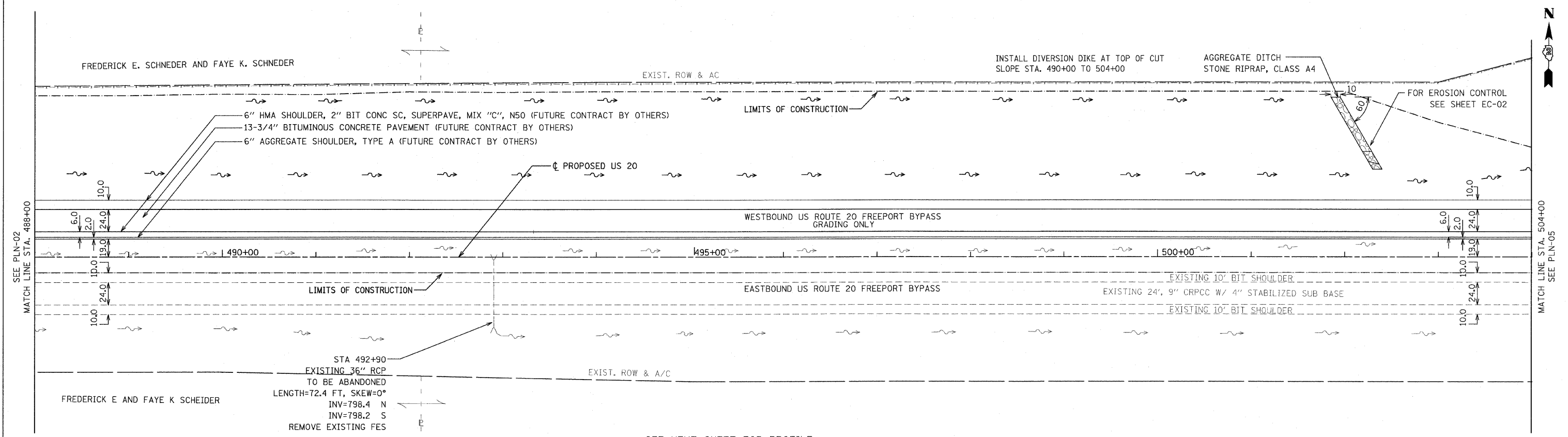

REVISIONS	
NAME	DATE

ILLINOIS DEPARTMENT OF TRANSPORTATION  
 F.A.P. ROUTE 301 (US RTE. 20)  
 FROM BOLTON ROAD TO WEST OF IL RTE. 26  
 PLAN  
 WESTBOUND U.S. ROUTE 20  
 SCALE: 1"=50'  
 DATE: 01-22-10  
 DRAWN BY: RMH  
 CHECKED BY: DM

