

F.A. RTE.	SECTION	COUNTY	TOTAL SHEETS	SHEET NO.
301	177-2 (-1A, B-1, VB-1)	STEPHENSON	386	74
STA.	150+00	TO STA.	165+00	
FED. ROAD DIST. NO.	ILLINOIS	FED. AID PROJECT		
P-92-029-02 CONTRACT #64799				PLN-25 OF 32

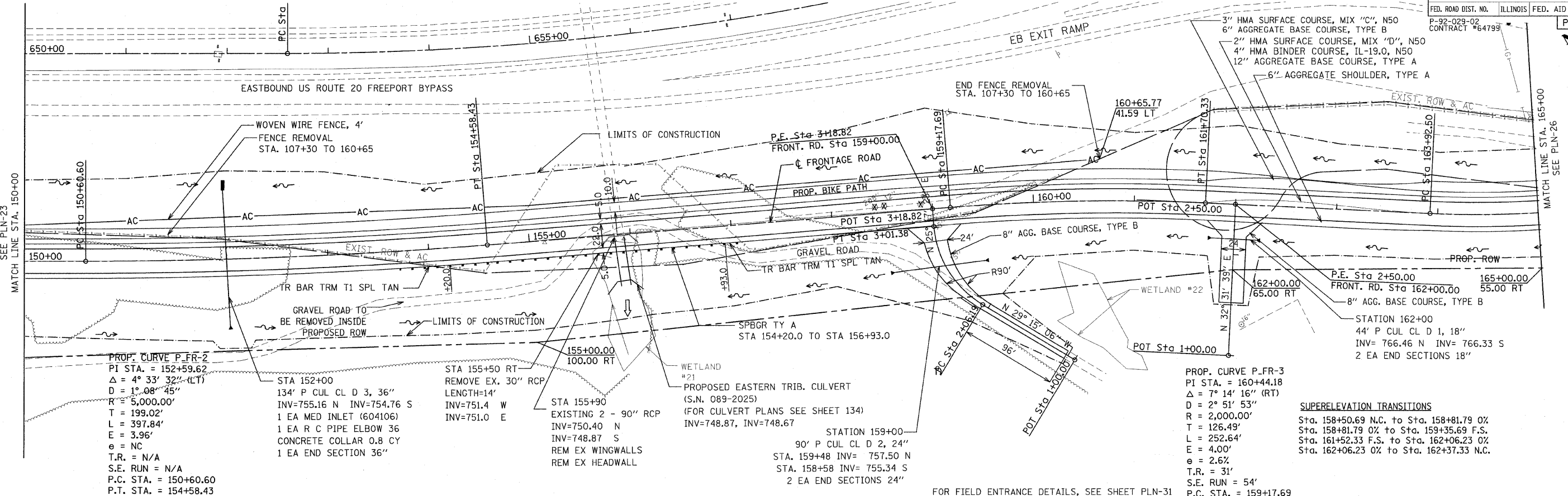

PROP. CURVE P_FR-2
 PI STA. = 152+59.62
 $\Delta = 4^\circ 33' 32''$ (LT)
 $D = 1^\circ 08' 45''$
 $R = 5,000.00'$
 $T = 199.02'$
 $L = 397.84'$
 $E = 3.96'$
 $e = NC$
 T.R. = N/A
 S.E. RUN = N/A
 P.C. STA. = 150+60.60
 P.T. STA. = 154+58.43

STA 152+00
 134' P CUL CL D 3, 36"
 INV=755.16 N INV=754.76 S
 1 EA MED INLET (604106)
 1 EA R C PIPE ELBOW 36
 CONCRETE COLLAR 0.8 CY
 1 EA END SECTION 36"

STA 155+50 RT
 REMOVE EX. 30" RCP
 LENGTH=14'
 INV=751.4 W
 INV=751.0 E

STA 155+90
 EXISTING 2 - 90" RCP
 INV=750.40 N
 INV=748.87 S
 REM EX WINGWALLS
 REM EX HEADWALL

PROPOSED EASTERN TRIB. CULVERT
 (S.N. 089-2025)
 (FOR CULVERT PLANS SEE SHEET 134)
 INV=748.87, INV=748.67

STATION 159+00
 90' P CUL CL D 2, 24"
 STA. 159+48 INV= 757.50 N
 STA. 158+58 INV= 755.34 S
 2 EA END SECTIONS 24"

PROP. CURVE P_FR-3
 PI STA. = 160+44.18
 $\Delta = 7^\circ 14' 16''$ (RT)
 $D = 2^\circ 51' 53''$
 $R = 2,000.00'$
 $T = 126.49'$
 $L = 252.64'$
 $E = 4.00'$
 $e = 2.6\%$
 T.R. = 31'
 S.E. RUN = 54'
 P.C. STA. = 159+17.69

SUPERELEVATION TRANSITIONS
 Sta. 158+50.69 N.C. to Sta. 158+81.79 0%
 Sta. 158+81.79 0% to Sta. 159+35.69 F.S.
 Sta. 161+52.33 F.S. to Sta. 162+06.23 0%
 Sta. 162+06.23 0% to Sta. 162+37.33 N.C.

FOR FIELD ENTRANCE DETAILS, SEE SHEET PLN-31

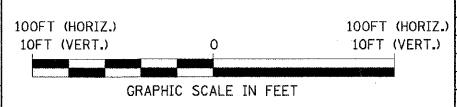
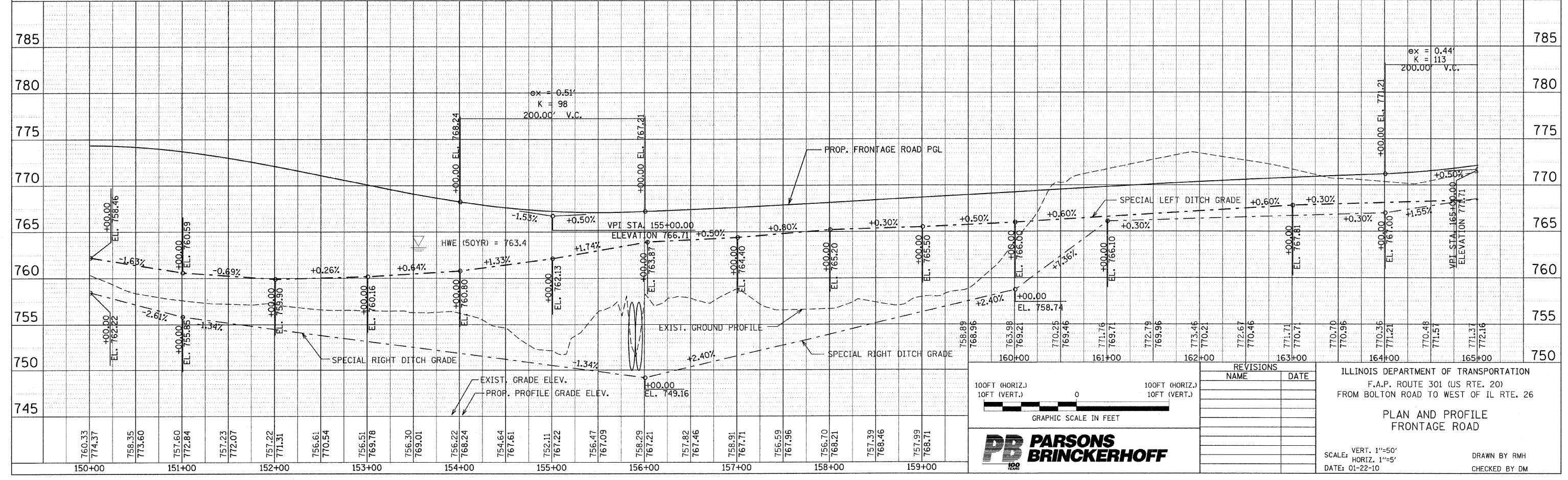

REVISIONS	
NAME	DATE

ILLINOIS DEPARTMENT OF TRANSPORTATION
 F.A.P. ROUTE 301 (US RTE. 20)
 FROM BOLTON ROAD TO WEST OF IL RTE. 26

**PLAN AND PROFILE
 FRONTAGE ROAD**

SCALE: VERT. 1"=50'
 HORIZ. 1"=50'
 DATE: 01-22-10

DRAWN BY RMH
 CHECKED BY DM