

F.A. RTE.	SECTION	COUNTY	TOTAL SHEETS	SHEET NO.
301	177-2 (-1A, B-1, VB-1)	STEPHENSON	386	75
STA.	165+00	TO STA.	175+00	
FED. ROAD DIST. NO.	ILLINOIS	FED. AID PROJECT		
P-92-029-02		CONTRACT #64799		PLN-26 OF 31

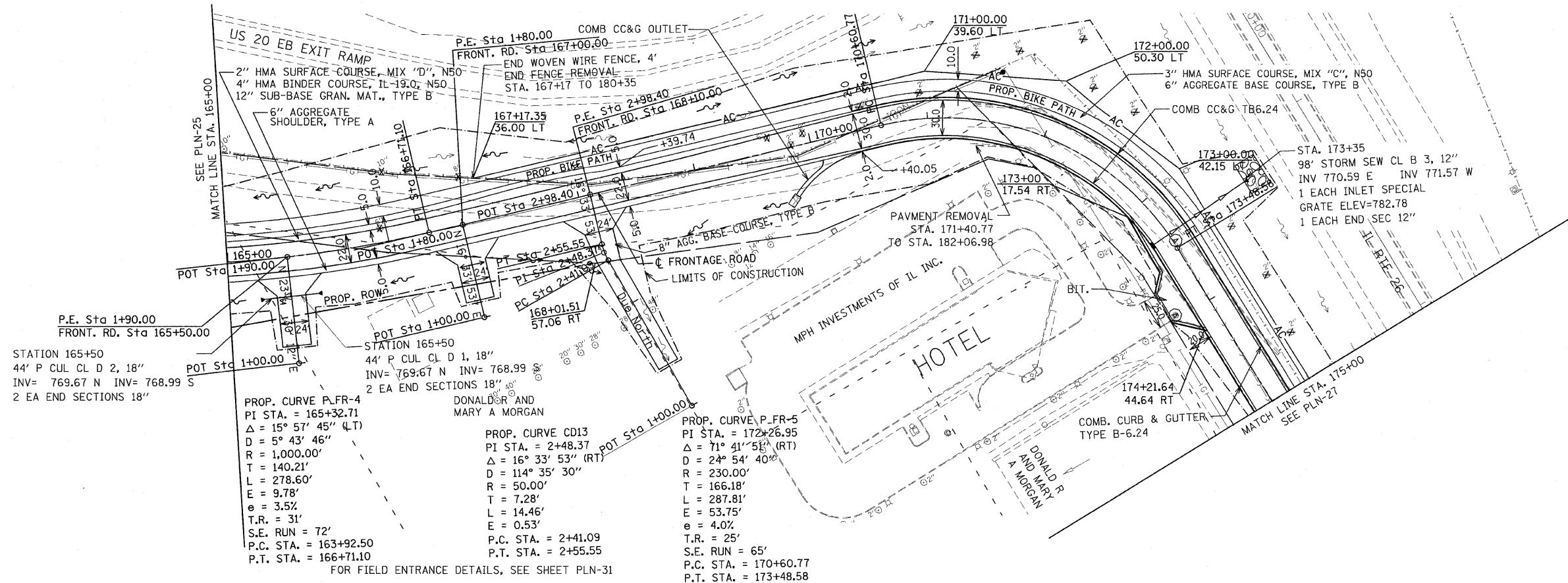

STATION 165+50  
44' P CUL CL D 2, 18"  
INV= 769.67 N INV= 768.99 S  
2 EA END SECTIONS 18"

PROP. CURVE P-FR-4  
PI STA. = 165+32.71  
Δ = 15° 57' 45" (LT)  
D = 5° 43' 46"  
R = 1,000.00'  
T = 140.21'  
L = 278.60'  
E = 9.78'  
e = 3.5%  
T.R. = 31'  
S.E. RUN = 72'  
P.C. STA. = 163+92.50  
P.T. STA. = 166+71.10

PROP. CURVE CD13  
PI STA. = 2+48.37  
Δ = 16° 33' 53" (RT)  
D = 114° 35' 30"  
R = 50.00'  
T = 7.28'  
L = 14.46'  
E = 0.53'

PROP. CURVE P-FR-5  
PI STA. = 172+26.95  
Δ = 71° 41' 58" (RT)  
D = 24° 54' 40"  
R = 230.00'  
T = 166.18'  
L = 287.81'  
E = 53.75'  
e = 4.0%  
T.R. = 25'  
S.E. RUN = 65'  
P.C. STA. = 170+60.77  
P.T. STA. = 173+48.58

FOR FIELD ENTRANCE DETAILS, SEE SHEET PLN-31

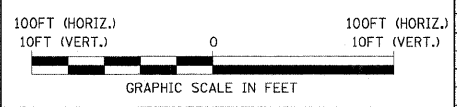
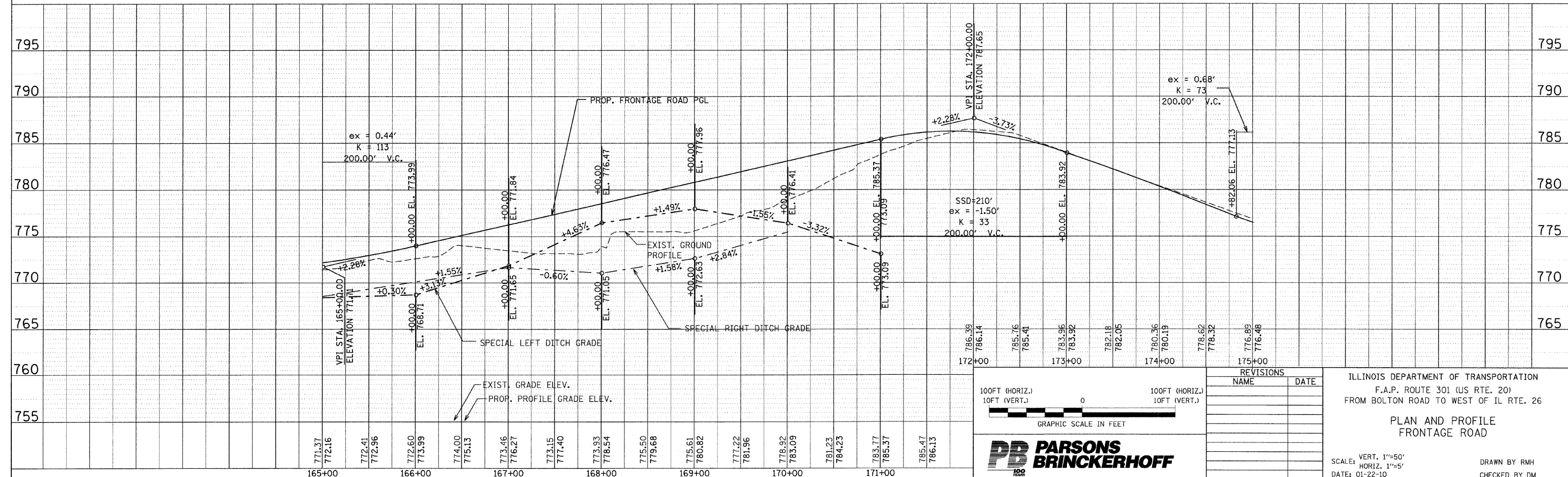

**PB PARSONS BRINCKERHOFF**

REVISIONS	
NAME	DATE

ILLINOIS DEPARTMENT OF TRANSPORTATION  
F.A.P. ROUTE 301 (US RTE. 20)  
FROM BOLTON ROAD TO WEST OF IL RTE. 26

**PLAN AND PROFILE  
FRONTAGE ROAD**

SCALE: VERT. 1"=50'  
HORIZ. 1"=50'  
DATE: 01-22-10

DRAWN BY RMH  
CHECKED BY DM