

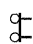

F.A.P. RTE.	SECTION	COUNTY	TOTAL SHEETS	SHEET NO.
301	177-2 (-1A, B-1, VB-1)	STEPHENSON	386	89
STA.	8+00	TO STA.	22+77.35	
FED. ROAD DIST. NO.	ILLINOIS	FED. AID PROJECT		
P-92-029-02 CONTRACT #64799			STG-04 OF 23	

LEGEND

-  Sign on portable or permanent support
-  Type III barricade with flashing lights
-  Direction of Traffic

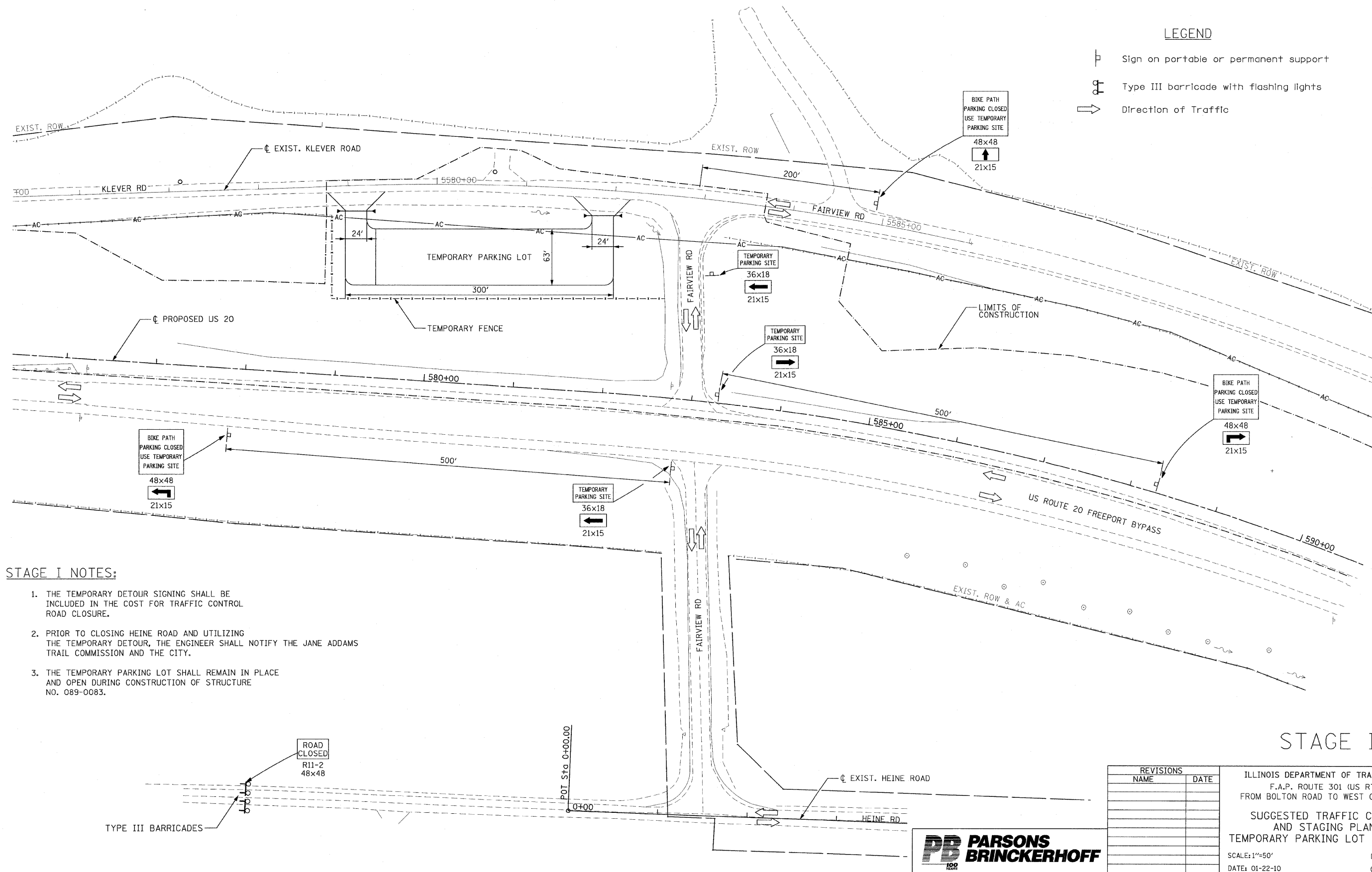

STAGE I NOTES:

1. THE TEMPORARY DETOUR SIGNING SHALL BE INCLUDED IN THE COST FOR TRAFFIC CONTROL ROAD CLOSURE.
2. PRIOR TO CLOSING HEINE ROAD AND UTILIZING THE TEMPORARY DETOUR, THE ENGINEER SHALL NOTIFY THE JANE ADDAMS TRAIL COMMISSION AND THE CITY.
3. THE TEMPORARY PARKING LOT SHALL REMAIN IN PLACE AND OPEN DURING CONSTRUCTION OF STRUCTURE NO. 089-0083.

STAGE IA

REVISIONS	
NAME	DATE

ILLINOIS DEPARTMENT OF TRANSPORTATION
 F.A.P. ROUTE 301 (US RTE. 20)
 FROM BOLTON ROAD TO WEST OF IL RTE. 26

SUGGESTED TRAFFIC CONTROL AND STAGING PLANS
 TEMPORARY PARKING LOT SIGN LAYOUT

SCALE: 1"=50'
 DATE: 01-22-10

DRAWN BY TJR
 CHECKED BY RMH

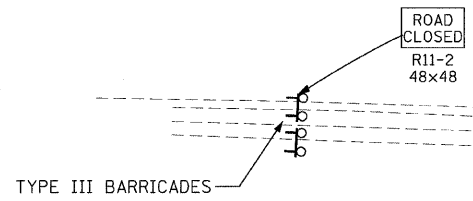

POT Sta. 0+00.00